

BUY & SELL CONVEYANCING SERVICES

Phone: 5968 6431
Fax: 8738 1546
PO BOX 223 EMERALD VIC 3782
annette@buyandsellconveyancing.com.au

Vendor Statement

The vendor makes this statement in respect of the land in accordance with section 32 of the *Sale of Land Act 1962*.

This statement must be signed by the vendor and given to the purchaser before the purchaser signs the contract.
The vendor may sign by electronic signature.

The purchaser acknowledges being given this statement signed by the vendor with the attached documents before the purchaser signed any contract.

24A Neville Street, Cockatoo VIC 3781

Vendor's name Peter David James

Date

/ /

Vendor's signature



Purchaser's name

Date

/ /

Purchaser's signature

Purchaser's name

Date

/ /

Purchaser's signature

The land is in a designated bushfire prone area within the meaning of regulations made under the *Building Act 1993* if the square box is marked with an 'X'



3.4 Planning Scheme

Attached is a certificate with the required specified information.

4. NOTICES

4.1 Notice, Order, Declaration, Report or Recommendation

Particulars of any notice, order, declaration, report or recommendation of a public authority or government department or approved proposal directly and currently affecting the land, being a notice, order, declaration, report, recommendation or approved proposal of which the vendor might reasonably be expected to have knowledge:

Not Applicable.

The Vendor has no means of knowing decisions of all public authorities and government departments affecting the property unless communicated to the Vendor.

The property is in an area in which is classified as an area in which buildings are likely to be subject to infestation of termites.

4.2 Agricultural Chemicals

There are NO notices, property management plans, reports or orders in respect of the land issued by a government department or public authority in relation to livestock disease or contamination by agricultural chemicals affecting the ongoing use of the land for agricultural purposes. However, if this is not the case, the details of any such notices, property management plans, reports or orders, are as follows:

Nil.

4.3 Compulsory Acquisition

The particulars of any notices of intention to acquire that have been served under section 6 of the *Land Acquisition and Compensation Act 1986* are as follows:

Nil.

5. BUILDING PERMITS

Particulars of any building permit issued under the *Building Act 1993* in the preceding 7 years (required only where there is a residence on the land):

Nil.

6. OWNERS CORPORATION

This section 6 only applies if the land is affected by an owners corporation within the meaning of the *Owners Corporations Act 2006*.

Not Applicable.

7. GROWTH AREAS INFRASTRUCTURE CONTRIBUTION ("GAIC")

Words and expressions in this section 7 have the same meaning as in Part 9B of the *Planning and Environment Act 1987*.

Not Applicable

8. SERVICES

The services which are marked with an 'X' in the accompanying square box are NOT connected to the land:

Electricity supply <input type="checkbox"/>	Gas supply <input type="checkbox"/>	Water supply <input type="checkbox"/>	Sewerage <input type="checkbox"/>	Telephone services <input type="checkbox"/>
---	-------------------------------------	---------------------------------------	-----------------------------------	---

- Some services currently noted as connected above may become disconnected prior to settlement. The Purchaser should make their own enquiries in relation to connection and re-connection of services to the land.

PLANNING PROPERTY REPORT



Environment,
Land, Water
and Planning

From www.planning.vic.gov.au at 11 March 2021 01:32 PM

PROPERTY DETAILS

Address: **NEVILLE STREET COCKATOO 3781**
Lot and Plan Number: **Lot 2 PS613814**
Standard Parcel Identifier (SPI): **2\PS613814**
Local Government Area (Council): **CARDINIA**
Council Property Number: **5000007299**
Planning Scheme: **Cardinia**
Directory Reference: **Melway 311 F6**

www.cardinia.vic.gov.au

[Planning Scheme - Cardinia](#)

UTILITIES

Rural Water Corporation: **Southern Rural Water**
Melbourne Water Retailer: **Yarra Valley Water**
Melbourne Water: **Inside drainage boundary**
Power Distributor: **AUSNET**

[View location in VicPlan](#)

STATE ELECTORATES

Legislative Council: **EASTERN VICTORIA**
Legislative Assembly: **GEMBROOK**

Planning Zones

[NEIGHBOURHOOD RESIDENTIAL ZONE \(NRZ\)](#)

[NEIGHBOURHOOD RESIDENTIAL ZONE - SCHEDULE 1 \(NRZ1\)](#)

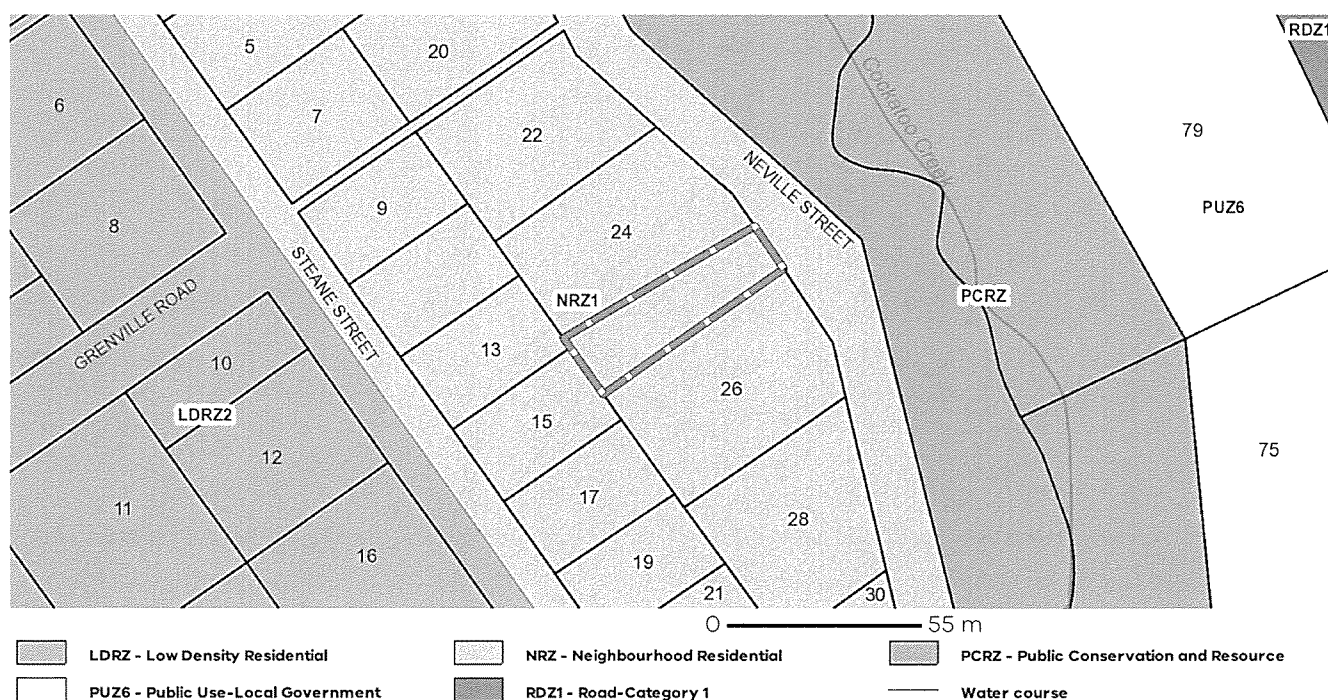

Note: labels for zones may appear outside the actual zone - please compare the labels with the legend

Copyright © - State Government of Victoria

Disclaimer: This content is provided for information purposes only. No claim is made as to the accuracy or authenticity of the content. The Victorian Government does not accept any liability to any person for the information provided.
Read the full disclaimer at <https://www2.delwp.vic.gov.au/disclaimer>

Notwithstanding this disclaimer, a vendor may rely on the information in this report for the purpose of a statement that land is in a bushfire prone area as required by section 32C (b) of the Sale of Land 1962 (Vic)

PLANNING PROPERTY REPORT: NEVILLE STREET COCKATOO 3781

Page 1 of 6

PLANNING PROPERTY REPORT



Environment,
Land, Water
and Planning

Planning Overlays

VEGETATION PROTECTION OVERLAY (VPO)

VEGETATION PROTECTION OVERLAY - SCHEDULE 2 (VPO2)



OTHER OVERLAYS

Other overlays in the vicinity not directly affecting this land

RESTRUCTURE OVERLAY (RO)

SIGNIFICANT LANDSCAPE OVERLAY (SLO)

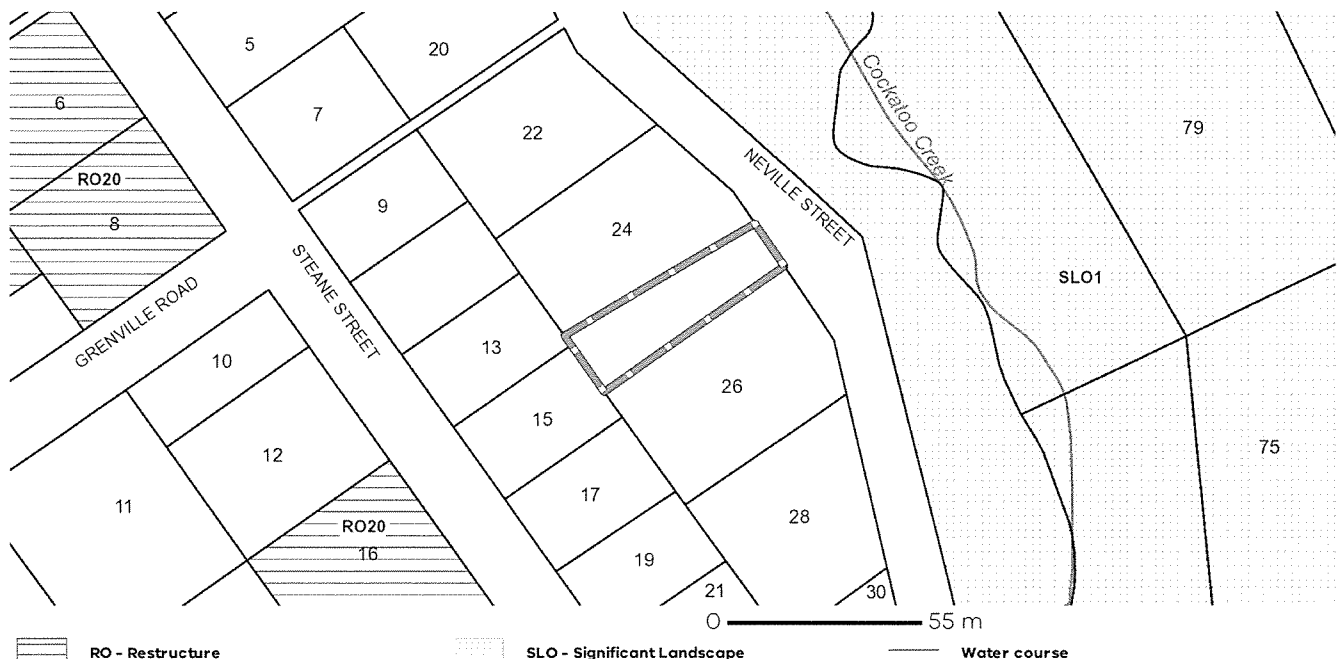

Copyright © - State Government of Victoria

Disclaimer: This content is provided for information purposes only. No claim is made as to the accuracy or authenticity of the content. The Victorian Government does not accept any liability to any person for the information provided. Read the full disclaimer at <https://www2.delwp.vic.gov.au/disclaimer>

Notwithstanding this disclaimer, a vendor may rely on the information in this report for the purpose of a statement that land is in a bushfire prone area as required by section 32C (b) of the Sale of Land 1962 (Vic)

Further Planning Information

Planning scheme data last updated on 4 March 2021.

A **planning scheme** sets out policies and requirements for the use, development and protection of land. This report provides information about the zone and overlay provisions that apply to the selected land. Information about the State and local policy, particular, general and operational provisions of the local planning scheme that may affect the use of this land can be obtained by contacting the local council or by visiting <https://www.planning.vic.gov.au>

This report is NOT a **Planning Certificate** issued pursuant to Section 199 of the **Planning and Environment Act 1987**. It does not include information about exhibited planning scheme amendments, or zonings that may affect the land. To obtain a Planning Certificate go to Titles and Property Certificates at Landata - <https://www.landata.vic.gov.au>

For details of surrounding properties, use this service to get the Reports for properties of interest.

To view planning zones, overlay and heritage information in an interactive format visit <https://mapshare.maps.vic.gov.au/vicplan>

For other information about planning in Victoria visit <https://www.planning.vic.gov.au>

Copyright State of Victoria. This publication is copyright. No part may be reproduced by any process except in accordance with the provisions of the Copyright Act 1968 (Cth) and for the purposes of Section 32 of the Sale of Land Act 1962 (Vic) or pursuant to a written agreement. The information is only valid at the time and in the form obtained from the LANDATA REGD TM System. None of the State of Victoria, LANDATA REGD TM System, Victorian Land Registry Services Pty. Ltd. ABN 86 627 986 396 as trustee for the Victorian Land Registry Services Trust ABN 83 206 746 897 accept responsibility for any subsequent release, publication or reproduction of the information.

REGISTER SEARCH STATEMENT (Title Search) Transfer of Land Act 1958

VOLUME 11208 FOLIO 569

Security no : 124088612676B
Produced 11/03/2021 01:29 PM

LAND DESCRIPTION

Lot 2 on Plan of Subdivision 613814M.
PARENT TITLES :
Volume 09201 Folio 008 to Volume 09201 Folio 010
Created by instrument PS613814M 09/06/2010

REGISTERED PROPRIETOR

Estate Fee Simple
Sole Proprietor
PETER DAVID JAMES of 1516A BURWOOD HIGHWAY TECOMA VIC 3160
AH883686A 07/04/2011

ENCUMBRANCES, CAVEATS AND NOTICES

Any encumbrances created by Section 98 Transfer of Land Act 1958 or Section 24 Subdivision Act 1988 and any other encumbrances shown or entered on the plan set out under DIAGRAM LOCATION below.

DIAGRAM LOCATION

SEE PS613814M FOR FURTHER DETAILS AND BOUNDARIES

ACTIVITY IN THE LAST 125 DAYS

NIL

-----END OF REGISTER SEARCH STATEMENT-----

Additional information: (not part of the Register Search Statement)

Street Address: NEVILLE STREET COCKATOO VIC 3781

DOCUMENT END

Delivered from the LANDATA® System by InfoTrack Pty Ltd.

The information supplied by InfoTrack (Smokeball) has been obtained from InfoTrack Pty Limited by agreement between them. The information supplied has been obtained by InfoTrack Pty Limited who is licensed by the State of Victoria to provide this information via LANDATA® System.

Signed by Council: Cardinia Shire Council, Original Certification: 27/11/2008, S.O.C.: 20/04/2010

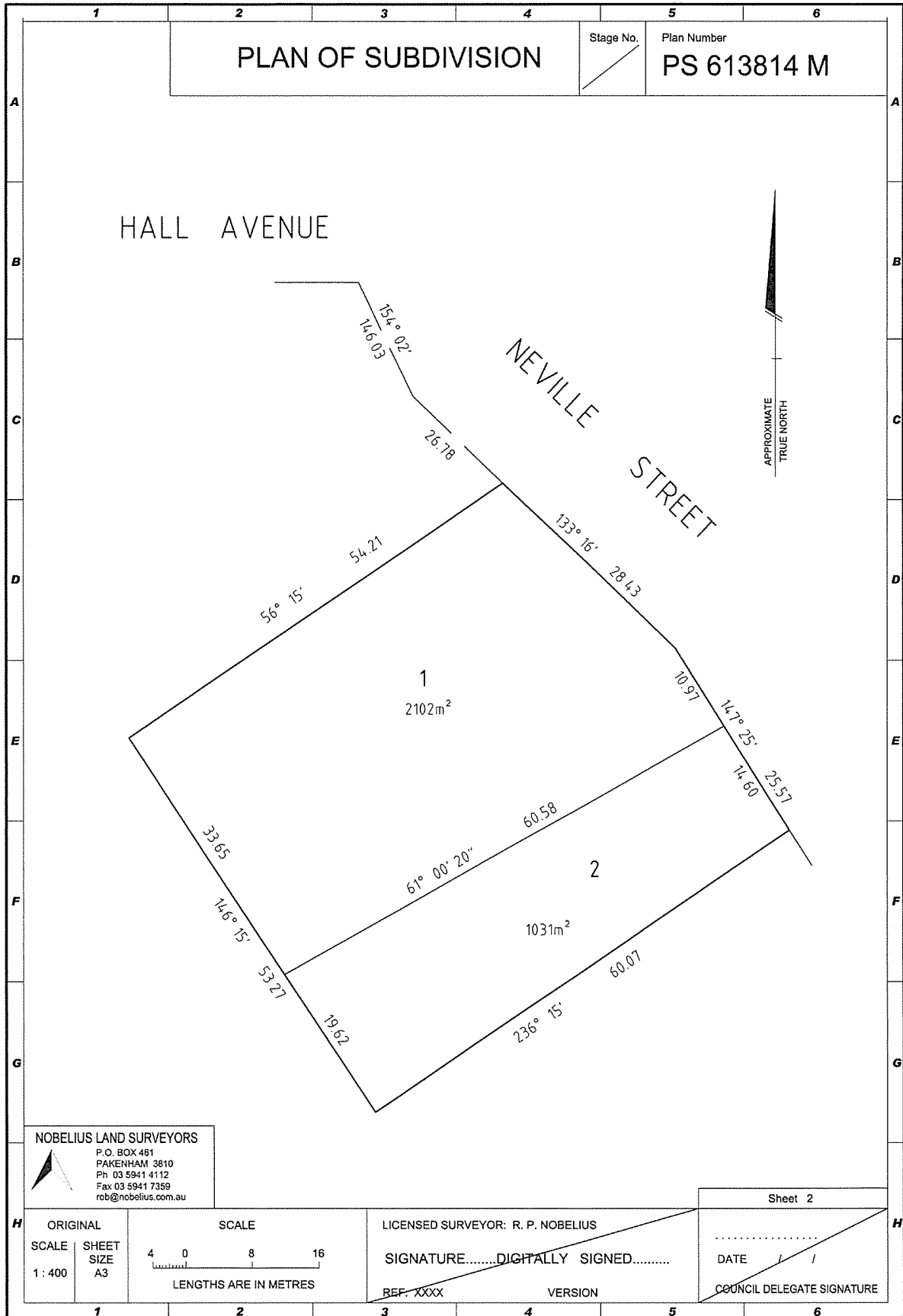

Signed by: Robin Peter Nobelius (Nobelius Land Surveyors Pty Ltd) Surveyor's Plan Version (A) 06/10/2008



YARRA VALLEY WATER
ABN 93 966 902 501

Lucknow Street
Mitcham Victoria 3132

Private Bag 1
Mitcham Victoria 3132

DX 13204

F (03) 9872 1353

E enquiry@yvw.com.au
yvw.com.au

11th March 2021

Buy & Sell Conveyancing Services

Dear Buy & Sell Conveyancing Services,

RE: Application for Water Information Statement

Property Address:	NEVILLE STREET COCKATOO 3781
Applicant	Buy & Sell Conveyancing Services
Information Statement	30587515
Conveyancing Account Number	5757504575
Your Reference	21/4248 James

Thank you for your recent application for a Water Information Statement (WIS). We are pleased to provide you the WIS for the above property address. This statement includes:

- Yarra Valley Water Property Information Statement
- Melbourne Water Property Information Statement
- Asset Plan
- Conditions of Connection and Consent
- Rates Certificate

If you have any questions about Yarra Valley Water information provided, please phone us on **1300 304 688** or email us at the address enquiry@yvw.com.au. For further information you can also refer to the Yarra Valley Water website at www.yvw.com.au.

Yours sincerely,

A handwritten signature in black ink, appearing to read 'Steve Lennox', with a stylized flourish at the end.

Steve Lennox
GENERAL MANAGER
RETAIL SERVICES

Melbourne Water Property Information Statement

Property Address	NEVILLE STREET COCKATOO 3781
------------------	------------------------------

STATEMENT UNDER SECTION 158 WATER ACT 1989

THE FOLLOWING INFORMATION RELATES TO SECTION 158(3)

A detailed hydraulic investigation of Melbourne Water's drainage system in the vicinity of this property has not been undertaken. Please contact Melbourne Water on 9679 7517 to ascertain whether any further information is available.

Please note: Unless prior consent has been obtained, the Water Act prohibits:

1. The erection and/or placement of any building, wall, bridge, fence, embankment, filling, material, machinery or other structure over or under any sewer or drain.
2. The connection of any drain or sewer to, or interference with, any sewer, drain or watercourse.

If you have any questions regarding Melbourne Water encumbrances or advisory information, please contact Melbourne Water on 9679 7517.

9th October 2013

Application ID: 116275

CONDITIONS OF CONNECTION

Approval is subject to payment of all charges and completion of conditions. This approval covers the following services and connections:

Approval Detail

Water

Connection Details

Product	Pipe Material	Pipe Size	Qty	Street where main located
20mm Drinking Water Service Connection	ASBESTO S CEMENT(I NC	100	1	Neville Street

Required Services

Product	Qty
20mm Drinking Water Service Connection	1
Supply 20mm Drinking Water Meter	1
Install 20mm Drinking Water Meter	1

For 20mm and 25mm services and all services where a manifold is to be installed, the service pipe, including a meter assembly with a temporary spacer pipe and any relevant backflow device must be installed by the plumber, prior to the time of the tapping or meter installation. Meters are installed by Yarra Valley Waters plumbing contractor. For 32mm and larger services, the meter will be delivered to you and must be installed on the property prior to the tapping. The service pipe must also be installed prior to the tapping. All manifolds are to be located below ground and must be left exposed for Yarra Valley Water's plumbing contractor to inspect prior to installation of the meters. Failure to comply will result in the tapping being cancelled. A rebooking fee will be applicable when rebooking the tapping.

All tapplings, pluggings and metering products must be arranged by contacting the easyACCESS outlet where the application was made.

Work is to be carried out in accordance with the Water Metering & Servicing Guidelines available on our website.

All meters are supplied by Yarra Valley Water after payment of the relevant fees.

If the tapping and/or plugging is required to be performed outside of business hours, either at your request or as determined by Yarra Valley Water's plumbing contractor, an additional after hours fee will apply.

Meters are not permitted to be installed inside units/dwellings. In all situations where the meter is deemed inaccessible, either by your advice, or as determined by Yarra Valley Water plumbing contractor, remote read meters must be fitted at your cost. Remote read meters must be installed in the following circumstances: high rise developments; any water meter which is located where Yarra Valley Water will have to enter a building to read the meter; where access to the meter will be restricted by gates/fences. If you are aware that remote read meters will be required, please inform the easyACCESS staff at the time of booking.

For all tapplings and/or pluggings, it is the responsibility of the person performing the excavation to obtain a Road Opening Permit from the local municipal authority before any excavation work commences. All traffic management requirements contained in the Road Opening permit must be complied with. The excavation must expose the main at the tapping/plugging point and be made safe prior to the tapping / plugging appointment time. If you choose to have Yarra Valley Water's plumbing contractor carry out the excavation, Yarra Valley Water will organize the necessary permit at an additional cost on a per road opening basis.

Failure to comply with any of these requirements will result in the booking being cancelled and a rebooking fee will apply.

Yarra Valley Water's plumbing contractor can be contacted on 1300 724 858.

Where you have elected for your plumber to provide the excavation, you will be contacted by Yarra Valley Water within 2 working days of your booking to confirm an appointment date and time. If you have elected for Yarra Valley Water to provide the excavation, you will be contacted to confirm your preferred location for the service. Should you wish to reschedule the booking, Yarra Valley Water's plumbing contractor can be contacted on 1300 724 858. If you wish to cancel the booking you will need to return to the easyACCESS store where the booking was made (if applicable) to seek a refund. A cancellation fee may apply.

Stolen meters are to be reported to Yarra Valley Water faults and emergencies:

- Call **13 2762** (24 hrs).
- Replacement of stolen meters can take up to 10 days. If replacement is required more urgently, please advise the operator at the time of the call.
- Until the meter is replaced no connections between the supply and the dwelling are to be reinstated. No straight pieces or alternative connections are allowed to be installed.

AMENDMENTS

We may amend these conditions by writing to you. We may do so if we consider that any change, or proposed change, to relevant laws or our regulatory obligations require an amendment to be made.

We may also amend these conditions from time to time if we consider that it is necessary to:

- ensure that we are able to continue to comply with any law relating to health, safety or the environment, or our agreement with our bulk supplier of sewage transfer and treatment services; or
- the health or safety of anyone; or
- any part of the environment; or
- any of our works.

INDEMNITY

You must indemnify Yarra Valley Water against:

- all damages, losses, penalties, costs and expenses whatsoever, which we suffer or incur; and
- all proceedings, prosecutions or demands brought or made against us by anyone, as a result of you failing to perform any of our obligations under these conditions, except to the extent that the failure has been caused by our negligence.

You must not bring any proceeding or make any demand against us for any damage, loss, cost or expense of any kind whatsoever which you incur, directly or indirectly, as a result of Yarra Valley Water amending these conditions.

You must pay us any costs we reasonably incur in:

- making good any damage to our assets or works directly or indirectly caused by your failure to comply with these conditions; and
- inspecting our assets or works to see if such damage has been caused.

Conditions of Connection Details

GENERAL

In these conditions the terms,

- (a) 'You' and 'Your' refer to the owner of a property connected (or about to be connected) to Yarra Valley Water assets
- (b) 'We', 'Us' and 'Our' refer to Yarra Valley Water.

Section 145 of the Water Act 1989 details the legislative rights and responsibilities of both the applicant and Yarra Valley Water in relation to connection, alteration or removal and discharging to the works of Yarra Valley Water. These Conditions of Connection set out the terms and conditions to be satisfied for connecting a property to sewer, potable and recycled water.

These conditions are binding on successor-in-title of the person who applied for that consent, under section 145 of the Water Act 1989. If you are not the owner of the property, please provide a copy of this letter to the owner.

The Conditions of Connection must be handed to the Licensed Plumber. Any work which these Conditions of Connection require you to undertake must be done by a Licensed Plumber, engaged by you, at your cost. It is the Licensed Plumber's responsibility to ensure that the plumbing and drainage work is completed in accordance with the relevant plumbing regulations and to the satisfaction of the Plumbing Industry Commission.

Any sewer connection branch and the connecting works must be installed so that they comply, in all respects, with the:

- Plumbing Regulations 1998 (Vic);
 - Water Industry Regulations 2006 (Vic);
 - Building Act 1993 (Vic);
 - Relevant AS/NZS series of standards applicable to sewer connection branch and connecting works from time to time,
- and any other technical requirements which we reasonably specify.

If your property is subject to flooding you should contact Melbourne Water to confirm any actual recorded flood level and assess this information for any impact to the proposed development.

It is the responsibility of the person performing any excavation in a road reserve to obtain a Road Opening Permit from the relevant Authority before any excavation work commences. All traffic management requirements contained in the permit must be complied with.

SEWER

Following the completion of new or altered property sewerage drain, a copy of the updated Property Sewerage Plan must be returned within 7 days to Yarra Valley Water. The plan can be uploaded for you at one of the easyACCESS outlets, emailed to easyACCESS@yvw.com.au or faxed to 9872 1413.



YARRA VALLEY WATER
ABN 93 056 902 501

Lucknow Street
Mitcham Victoria 3132

Private Bag 1
Mitcham Victoria 3132

DX 13204

F (03) 9872 1353

E enquiry@yvw.com.au
yvw.com.au

Buy & Sell Conveyancing Services
annette@buyandsellconveyancing.com.au

RATES CERTIFICATE

Account No: 4330029063
Rate Certificate No: 30587515

Date of Issue: 11/03/2021
Your Ref: 21/4248 James

With reference to your request for details regarding:

Property Address	Lot & Plan	Property Number	Property Type
LOT 2, NEVILLE ST, COCKATOO VIC 3781	2\PS613814	1783161	Residential

Agreement Type	Period	Charges	Outstanding
Residential Water Service Charge	01-01-2021 to 31-03-2021	\$19.26	\$19.26
Residential Water Usage Charge Step 1 – 22.000000kL x \$2.64460000 = \$58.18 Estimated Average Daily Usage \$0.61	03-09-2020 to 08-12-2020	\$58.18	\$0.00
Residential Sewer Service Charge	01-01-2021 to 31-03-2021	\$113.00	\$113.00
Residential Sewer Usage Charge 22.000000kL x 0.823328 = 18.113208 x 0.900000 = 16.301887 x \$1.14260000 = \$18.63 Estimated Average Daily Usage \$0.19	03-09-2020 to 08-12-2020	\$18.63	\$0.00
Drainage Fee	01-01-2021 to 31-03-2021	\$14.12	\$14.12
Other Charges:			
Interest	No interest applicable at this time		
	No further charges applicable to this property		
Balance Brought Forward			\$0.00
Total for This Property			\$146.38
Total Due			\$146.38

IMPORTANT NOTICE FOR SOLICITORS AND CONVEYANCERS

We have changed our BPAY biller code. Please refer to the payment options and update your bank details.

GENERAL MANAGER
RETAIL SERVICES

Note:

- Invoices generated with Residential Water Usage during the period 01/07/2017 – 30/09/2017 will include a Government Water Rebate of \$100.
- This statement details all tariffs, charges and penalties due and payable to Yarra Valley Water as at the date of this statement and also includes tariffs and charges (other than for usage charges yet to be billed) which are due and payable to the end of the current financial quarter.



YARRA VALLEY WATER
ABN 93 066 902 501

Lucknow Street
Mitcham Victoria 3132

Private Bag 1
Mitcham Victoria 3132

DX 13204

F (03) 9872 1353

E enquiry@yvw.com.au
yvw.com.au

Property No: 1783161

Address: LOT 2, NEVILLE ST, COCKATOO VIC 3781

Water Information Statement Number: 30587515

HOW TO PAY



Bill Code: 314567
Ref: 43300290636



Mail a Cheque with the Remittance Advice
below to:
Yarra Valley Water
GPO Box 2860 Melbourne VIC 3001

Amount
Paid

Date
Paid

Receipt
Number

Please Note: BPAY is available for individual property settlements.

PROPERTY SETTLEMENT REMITTANCE ADVICE

Property No: 1783161

Address: LOT 2, NEVILLE ST, COCKATOO VIC 3781

Water Information Statement Number: 30587515

Cheque Amount: \$

Land boundaries

Do you know the exact boundary of the property?

You should compare the measurements shown on the title document with actual fences and buildings on the property, to make sure the boundaries match. If you have concerns about this, you can speak to your lawyer or conveyancer, or commission a site survey to establish property boundaries.

Planning controls

Can you change how the property is used, or the buildings on it?

All land is subject to a planning scheme, run by the local council. How the property is zoned and any overlays that may apply, will determine how the land can be used. This may restrict such things as whether you can build on vacant land or how you can alter or develop the land and its buildings over time.

The local council can give you advice about the planning scheme, as well as details of any other restrictions that may apply, such as design guidelines or bushfire safety design. There may also be restrictions – known as encumbrances – on the property's title, which prevent you from developing the property. You can find out about encumbrances by looking at the section 32 statement.

Are there any proposed or granted planning permits?

The local council can advise you if there are any proposed or issued planning permits for any properties close by. Significant developments in your area may change the local 'character' (predominant style of the area) and may increase noise or traffic near the property.

Safety

Is the building safe to live in?

Building laws are in place to ensure building safety. Professional building inspections can help you assess the property for electrical safety, possible illegal building work, adequate pool or spa fencing and the presence of asbestos, termites, or other potential hazards.

Building permits

Have any buildings or retaining walls on the property been altered, or do you plan to alter them?

There are laws and regulations about how buildings and retaining walls are constructed, which you may wish to investigate to ensure any completed or proposed building work is approved. The local council may be able to give you information about any building permits issued for recent building works done to the property, and what you must do to plan new work. You can also commission a private building surveyor's assessment.

Are any recent building or renovation works covered by insurance?

Ask the vendor if there is any owner-builder insurance or builder's warranty to cover defects in the work done to the property.

Utilities and essential services

Does the property have working connections for water, sewerage, electricity, gas, telephone and internet?

Unconnected services may not be available, or may incur a fee to connect. You may also need to choose from a range of suppliers for these services. This may be particularly important in rural areas where some services are not available.

Buyers' rights

Do you know your rights when buying a property?

The contract of sale and section 32 statement contain important information about the property, so you should request to see these and read them thoroughly. Many people engage a lawyer or conveyancer to help them understand the contracts and ensure the sale goes through correctly. If you intend to hire a professional, you should consider speaking to them before you commit to the sale. There are also important rules about the way private sales and auctions are conducted. These may include a cooling-off period and specific rights associated with 'off the plan' sales. The important thing to remember is that, as the buyer, you have rights.