

BUY & SELL CONVEYANCING SERVICES

Phone: 5968 6431
Fax: 8738 1546
PO BOX 223 EMERALD VIC 3782
annette@buyandsellconveyancing.com.au

Vendor Statement

The vendor makes this statement in respect of the land in accordance with section 32 of the *Sale of Land Act 1962*.

This statement must be signed by the vendor and given to the purchaser before the purchaser signs the contract.
The vendor may sign by electronic signature.

The purchaser acknowledges being given this statement signed by the vendor with the attached documents before the purchaser signed any contract.

12 Oxford Downs Road, Macclesfield VIC 3782

Vendor's name Joanna Rachael Miller

Date
2/10/20

Vendor's signature

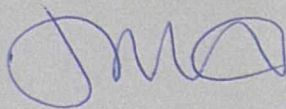

Vendor's name Elliot Christian Miller

Date
2/10/20

Vendor's signature



Vendor's name Alexander William Hunter

Date
2/10/20

Vendor's signature

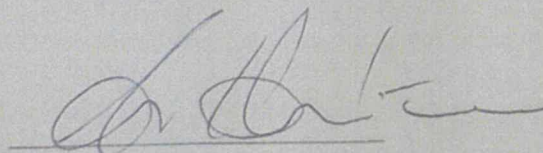

Purchaser's name

Date
/ /

Purchaser's signature

Purchaser's name

Date
/ /

Purchaser's signature

Vendor Statement

The vendor makes this statement in respect of the land in accordance with section 32 of the *Sale of Land Act 1962*.

This statement must be signed by the vendor and given to the purchaser before the purchaser signs the contract.
The vendor may sign by electronic signature.

The purchaser acknowledges being given this statement signed by the vendor with the attached documents before the purchaser signed any contract.

12 Oxford Downs Road, Macclesfield VIC 3782

Vendor's name	Joanna Rachael Miller	Date
		/ /
Vendor's signature	_____	
Vendor's name	Elliot Christian Miller	Date
		/ /
Vendor's signature	_____	
Vendor's name	Alexander William Hunter	Date
		/ /
Vendor's signature	_____	

Purchaser's name		Date
		/ /
Purchaser's signature	_____	
Purchaser's name		Date
		/ /
Purchaser's signature	_____	

1. FINANCIAL MATTERS

1.1 Particulars of any Rates, Taxes, Charges or Other Similar Outgoings (and any interest on them)

At settlement the rates will be adjusted between the parties, so that they each bear the proportion of rates applicable to their respective periods of occupancy in the property.

Yarra Ranges Shire Council
Yarra Valley Water
State Revenue Office (Land Tax)

(a) Their total does not exceed:

\$4,000.00 p.a.

1.2 Particulars of any Charge (whether registered or not) imposed by or under any Act to secure an amount due under that Act, including the amount owing under the charge

Not Applicable

1.3 Terms Contract

This section 1.3 only applies if this vendor statement is in respect of a terms contract where the purchaser is obliged to make 2 or more payments (other than a deposit or final payment) to the vendor after the execution of the contract and before the purchaser is entitled to a conveyance or transfer of the land.

Not Applicable.

1.4 Sale Subject to Mortgage

This section 1.4 only applies if this vendor statement is in respect of a contract which provides that any mortgage (whether registered or unregistered), is NOT to be discharged before the purchaser becomes entitled to possession or receipts of rents and profits.

Not Applicable.

2. INSURANCE

2.1 Damage and Destruction

This section 2.1 only applies if this vendor statement is in respect of a contract which does NOT provide for the land to remain at the risk of the vendor until the purchaser becomes entitled to possession or receipt of rents and profits.

Not Applicable.

2.2 Owner Builder

This section 2.2 only applies where there is a residence on the land that was constructed by an owner-builder within the preceding 6 years and section 137B of the Building Act 1993 applies to the residence.

Not Applicable.

3. LAND USE

3.1 Easements, Covenants or Other Similar Restrictions

(a) A description of any easement, covenant or other similar restriction affecting the land (whether registered or unregistered):

As attached.

(b) Particulars of any existing failure to comply with that easement, covenant or other similar restriction are:

Not Applicable

The Purchaser/s should note sewers, drains, water pipes, underground and/or overhead electricity cables, underground/or overhead telephone cables, underground NBN cables and underground gas pipes if any, may be laid outside registered easements.

3.2 Road Access

There is NO access to the property by road if the square box is marked with an 'X'

3.3 Designated Bushfire Prone Area

The land is in a designated bushfire prone area within the meaning of regulations made under the *Building Act 1993* if the square box is marked with an 'X'

3.4 Planning Scheme

Attached is a certificate with the required specified information.

4. NOTICES

4.1 Notice, Order, Declaration, Report or Recommendation

Particulars of any notice, order, declaration, report or recommendation of a public authority or government department or approved proposal directly and currently affecting the land, being a notice, order, declaration, report, recommendation or approved proposal of which the vendor might reasonably be expected to have knowledge:

Not Applicable.

The Vendor has no means of knowing decisions of all public authorities and government departments affecting the property unless communicated to the Vendor.

The property is in an area in which is classified as an area in which buildings are likely to be subject to infestation of termites.

4.2 Agricultural Chemicals

There are NO notices, property management plans, reports or orders in respect of the land issued by a government department or public authority in relation to livestock disease or contamination by agricultural chemicals affecting the ongoing use of the land for agricultural purposes. However, if this is not the case, the details of any such notices, property management plans, reports or orders, are as follows:

Nil.

4.3 Compulsory Acquisition

The particulars of any notices of intention to acquire that have been served under section 6 of the *Land Acquisition and Compensation Act 1986* are as follows:

Nil.

5. BUILDING PERMITS

Particulars of any building permit issued under the *Building Act 1993* in the preceding 7 years (required only where there is a residence on the land):

Nil.

6. OWNERS CORPORATION

This section 6 only applies if the land is affected by an owners corporation within the meaning of the *Owners Corporations Act 2006*.

Not Applicable.

7. GROWTH AREAS INFRASTRUCTURE CONTRIBUTION ("GAIC")

Words and expressions in this section 7 have the same meaning as in Part 9B of the *Planning and Environment Act 1987*.

Not Applicable

8. SERVICES

The services which are marked with an 'X' in the accompanying square box are NOT connected to the land:

Electricity supply <input type="checkbox"/>	Gas supply <input checked="" type="checkbox"/>	Water supply <input checked="" type="checkbox"/>	Sewerage <input checked="" type="checkbox"/>	Telephone services <input checked="" type="checkbox"/>
---	--	--	--	--

- Some services currently noted as connected above may become disconnected prior to settlement. The Purchaser should make their own enquiries in relation to connection and re-connection of services to the land.

9. TITLE

Attached are copies of the following documents:

9.1 Registered Title

A Register Search Statement and the document, or part of a document, referred to as the 'diagram location' in that statement which identifies the land and its location.

10. SUBDIVISION

10.1 Unregistered Subdivision

This section 10.1 only applies if the land is subject to a subdivision which is not registered.

Not Applicable.

10.2 Staged Subdivision

This section 10.2 only applies if the land is part of a staged subdivision within the meaning of section 37 of the *Subdivision Act 1988*.

Not Applicable.

10.3 Further Plan of Subdivision

This section 10.3 only applies if the land is subject to a subdivision in respect of which a further plan within the meaning of the *Subdivision Act 1988* is proposed.

Not Applicable.

11. DISCLOSURE OF ENERGY INFORMATION

(Disclosure of this information is not required under section 32 of the Sale of Land Act 1962 but may be included in this vendor statement for convenience.)

Details of any energy efficiency information required to be disclosed regarding a disclosure affected building or disclosure area affected area of a building as defined by the *Building Energy Efficiency Disclosure Act 2010* (Cth)

- (a) to be a building or part of a building used or capable of being used as an office for administrative, clerical, professional or similar based activities including any support facilities; and
- (b) which has a net lettable area of at least 2000m²; (but does not include a building under a strata title system or if an occupancy permit was issued less than 2 years before the relevant date);

Not Applicable.

12. DUE DILIGENCE CHECKLIST

(The Sale of Land Act 1962 provides that the vendor or the vendor's licensed estate agent must make a prescribed due diligence checklist available to purchasers before offering land for sale that is vacant residential land or land on which there is a residence. The due diligence checklist is NOT required to be provided with, or attached to, this vendor statement but the checklist may be attached as a matter of convenience.)

Is attached.

13. ATTACHMENTS

(Any certificates, documents and other attachments may be annexed to this section 13)

(Additional information may be added to this section 13 where there is insufficient space in any of the earlier sections)

(Attached is an "Additional Vendor Statement" if section 1.3 (Terms Contract) or section 1.4 (Sale Subject to Mortgage) applies)

Water Information Statement



REGISTER SEARCH STATEMENT (Title Search) Transfer of
Land Act 1958

VOLUME 08633 FOLIO 310

Security no : 124085280552C
Produced 03/09/2020 11:16 AM

LAND DESCRIPTION

Lot 13 on Plan of Subdivision 073129.
PARENT TITLE Volume 06383 Folio 546
Created by instrument LP073129 24/08/1966

REGISTERED PROPRIETOR

Estate Fee Simple
TENANTS IN COMMON
As to 13 of a total of 25 equal undivided shares
Joint Proprietors
JOANNA RACHAEL MILLER
ELLIOT CHRISTIAN MILLER both of 12 OXFORD DOWNS ROAD MACCLESFIELD VIC 3782
AL771977D 24/03/2015
As to 12 of a total of 25 equal undivided shares
Sole Proprietor
ALEXANDER WILLIAM HUNTER of 121 TEAL VALLEY ROAD, RD1, NELSON NEW ZEALAND
AR195390W 02/07/2018

ENCUMBRANCES, CAVEATS AND NOTICES

MORTGAGE AL771978B 24/03/2015
WESTPAC BANKING CORPORATION

Any encumbrances created by Section 98 Transfer of Land Act 1958 or Section 24 Subdivision Act 1988 and any other encumbrances shown or entered on the plan or imaged folio set out under DIAGRAM LOCATION below.

DIAGRAM LOCATION

SEE LP073129 FOR FURTHER DETAILS AND BOUNDARIES

ACTIVITY IN THE LAST 125 DAYS

NIL

-----END OF REGISTER SEARCH STATEMENT-----

Additional information: (not part of the Register Search Statement)

Street Address: 12 OXFORD DOWNS ROAD MACCLESFIELD VIC 3782

ADMINISTRATIVE NOTICES

NIL

eCT Control 16320Q WESTPAC BANKING CORPORATION
Effective from 02/07/2018

DOCUMENT END



Imaged Document Cover Sheet

The document following this cover sheet is an imaged document supplied by LANDATA®, Victorian Land Registry Services.

Document Type	Plan
Document Identification	LP073129
Number of Pages (excluding this cover sheet)	2
Document Assembled	03/09/2020 11:21

Copyright and disclaimer notice:

© State of Victoria. This publication is copyright. No part may be reproduced by any process except in accordance with the provisions of the Copyright Act 1968 (Cth) and for the purposes of Section 32 of the Sale of Land Act 1962 or pursuant to a written agreement. The information is only valid at the time and in the form obtained from the LANDATA® System. None of the State of Victoria, LANDATA®, Victorian Land Registry Services Pty. Ltd. ABN 86 627 986 396 as trustee for the Victorian Land Registry Services Trust ABN 83 206 746 897 accept responsibility for any subsequent release, publication or reproduction of the information.

The document is invalid if this cover sheet is removed or altered.

LP 73129
EDITION 2
APPROVED 22 / 7 / '66

PARISH/T/SHP/CHART
COLOUR CONVERSION
BROWN = R1 & R2

PLAN OF SUBDIVISION
CROWN ALLOTMENT 57

PARISH OF NANGANA

VOL. 6383 Fol. 546
DEPTH LIMITATION: 50 FEET
Measurements are in Links
Conversion Factor
LINKS X 0.201168 = METRES

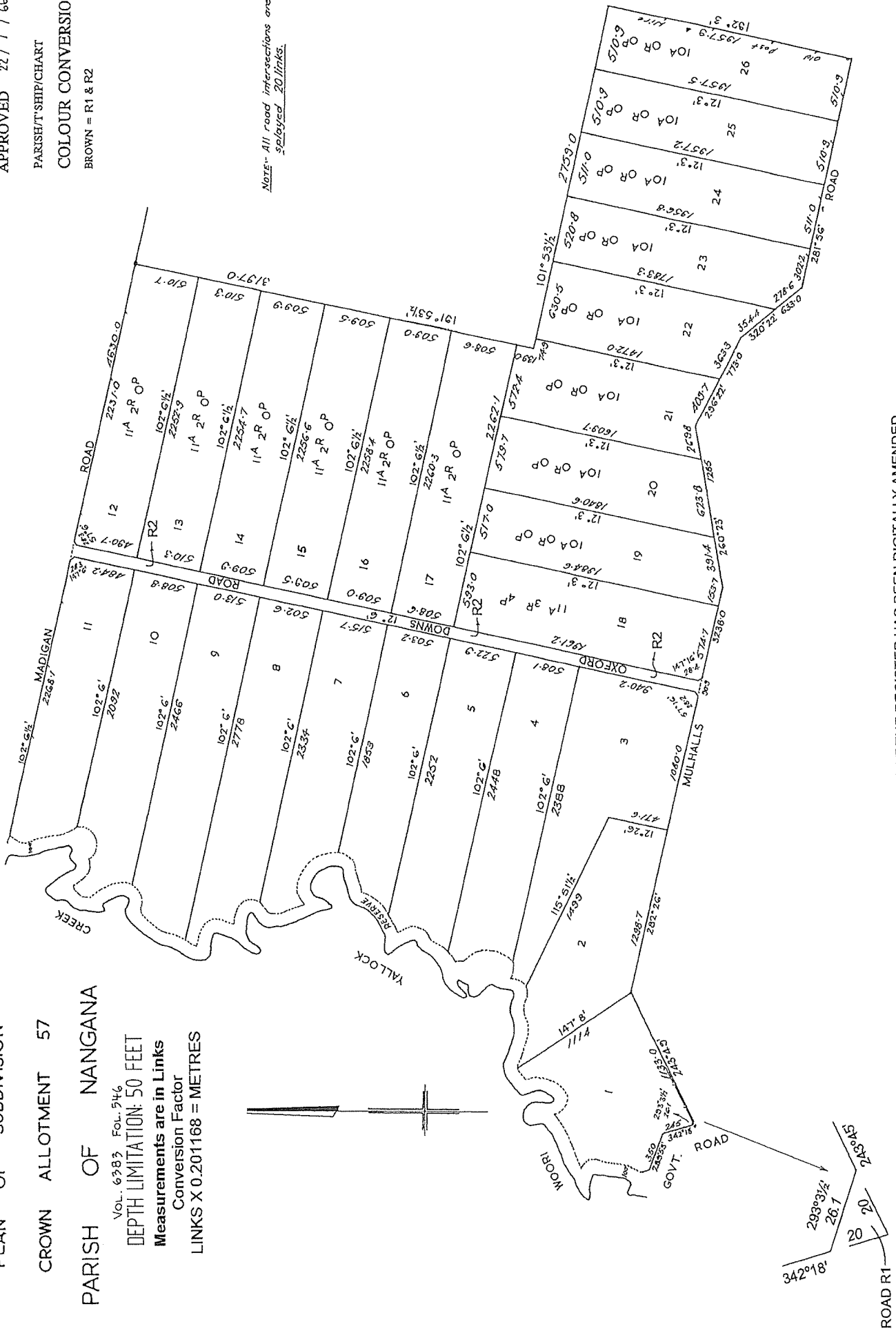

WARNING: THE IMAGE OF THIS DOCUMENT OF THE REGISTER HAS BEEN DIGITALLY AMENDED.
NO FURTHER AMENDMENTS ARE TO BE MADE TO THE ORIGINAL DOCUMENT OF THE REGISTER.

Property Report

from www.land.vic.gov.au on 03 September 2020 11:47 AM

Address: 12 OXFORD DOWNS ROAD MACCLESFIELD 3782

Lot and Plan Number: Lot 13 LP73129

Standard Parcel Identifier (SPI): 13\LP73129

Local Government (Council): YARRA RANGES Council Property Number: 227374

Directory Reference: Melway 309 A1

This property is in a designated bushfire prone area.
Special bushfire construction requirements apply. Planning provisions may apply.

Further information about the building control system and building in bushfire prone areas can be found in the Building Commission section of the Victorian Building Authority website www.vba.vic.gov.au

Site Dimensions

All dimensions and areas are approximate. They may not agree with the values shown on a title or plan.

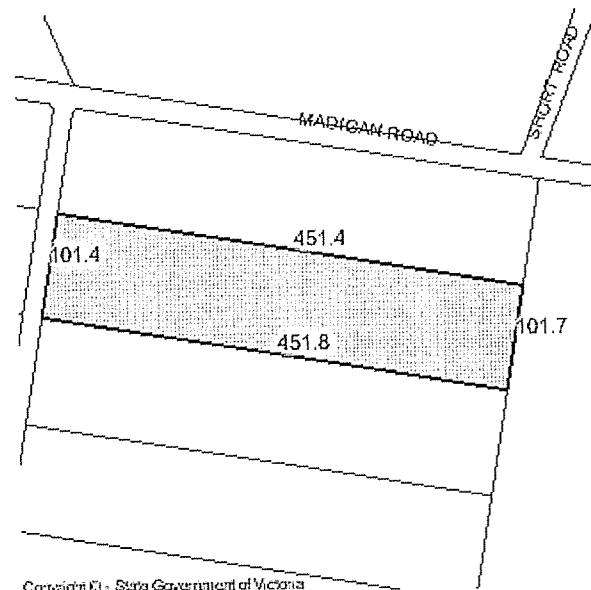

Area: 45855 sq. m
(4.6 ha)

Perimeter: 1106 m

For this property:

- Site boundaries
- Road frontages

Dimensions for individual parcels require a separate search, but dimensions for individual units are generally not available.

For more accurate dimensions get copy of plan at [Title and Property Certificates](#)

State Electorates

Legislative Council: EASTERN VICTORIA

Legislative Assembly: MONBULK

Utilities

Rural Water Corporation: Southern Rural Water

Melbourne Water Retailer: Yarra Valley Water

Melbourne Water: inside drainage boundary

Power Distributor: AUSNET ([Information about choosing an electricity retailer](#))

Planning information continued on next page

Copyright © - State Government of Victoria

Disclaimer: This content is provided for information purposes only. No claim is made as to the accuracy or authenticity of the content. The Victorian Government does not accept any liability to any person for the information provided. Read the full disclaimer at www.land.vic.gov.au/home/copyright-and-disclaimer

Planning Zone Summary

- Planning Zone: [GREEN WEDGE ZONE \(GWZ\)](#)
[GREEN WEDGE ZONE - SCHEDULE 2 \(GWZ2\)](#)
- Planning Overlays: [BUSHFIRE MANAGEMENT OVERLAY \(BMO\)](#)
[ENVIRONMENTAL SIGNIFICANCE OVERLAY \(ESO\)](#)
[ENVIRONMENTAL SIGNIFICANCE OVERLAY - SCHEDULE 1 \(SITE B4\) \(ESO1-B4\)](#)
[ENVIRONMENTAL SIGNIFICANCE OVERLAY - SCHEDULE 1 \(SITE Z24\) \(ESO1-Z24\)](#)

Planning scheme data last updated on 2 September 2020.

A **planning scheme** sets out policies and requirements for the use, development and protection of land. This report provides information about the zone and overlay provisions that apply to the selected land. Information about the State and local policy, particular, general and operational provisions of the local planning scheme that may affect the use of this land can be obtained by contacting the local council or by visiting [Planning Schemes Online](#)

This report is NOT a **Planning Certificate** issued pursuant to Section 199 of the *Planning and Environment Act 1987*. It does not include information about exhibited planning scheme amendments, or zonings that may affect the land. To obtain a Planning Certificate go to [Titles and Property Certificates](#)

The Planning Property Report includes separate maps of zones and overlays

For details of surrounding properties, use this service to get the Reports for properties of interest

To view planning zones, overlay and heritage information in an interactive format visit [Planning Maps Online](#)

For other information about planning in Victoria visit www.planning.vic.gov.au

Area Map

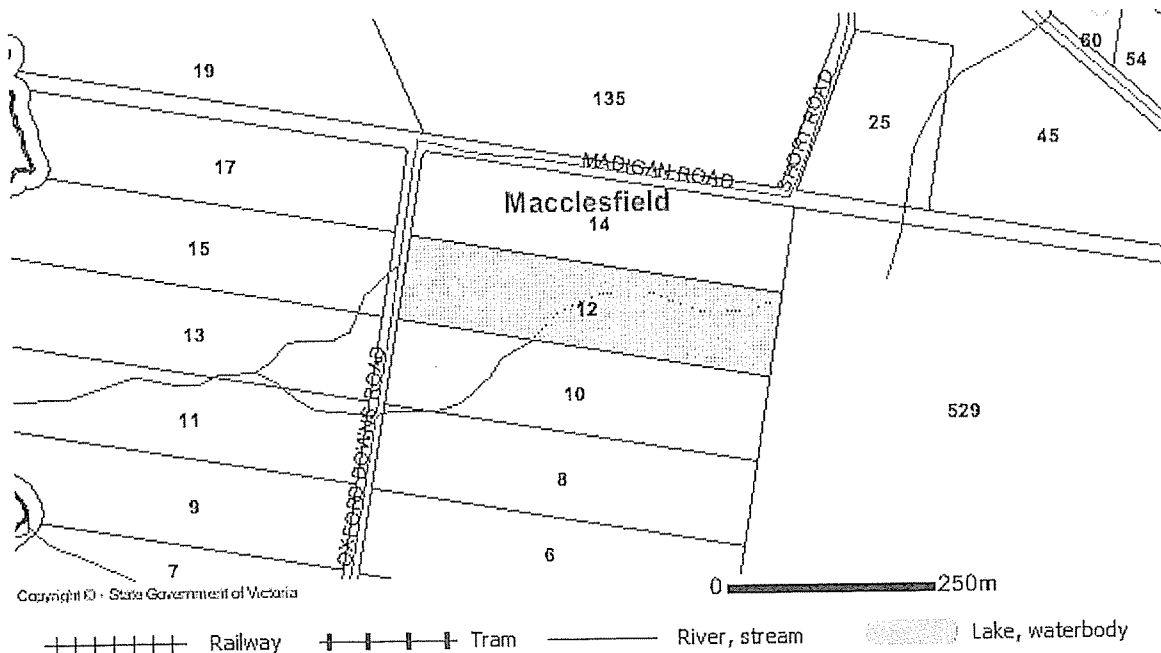

Copyright © - State Government of Victoria

Disclaimer: This content is provided for information purposes only. No claim is made as to the accuracy or authenticity of the content. The Victorian Government does not accept any liability to any person for the information provided. Read the full disclaimer at www.land.vic.gov.au/home/copyright-and-disclaimer

PLANNING PROPERTY REPORT

From www.planning.vic.gov.au at 03 September 2020 11:47 AM

PROPERTY DETAILS

Address: **12 OXFORD DOWNS ROAD MACCLESFIELD 3782**
 Lot and Plan Number: **Lot 13 LP73129**
 Standard Parcel Identifier (SPI): **13\LP73129**
 Local Government Area (Council): **YARRA RANGES**
 Council Property Number: **227374**
 Planning Scheme: **Yarra Ranges**
 Directory Reference: **Melway 309 A1**

www.yarraranges.vic.gov.au

[Planning Scheme - Yarra Ranges](#)

UTILITIES

Rural Water Corporation: **Southern Rural Water**
 Melbourne Water Retailer: **Yarra Valley Water**
 Melbourne Water: **Inside drainage boundary**
 Power Distributor: **AUSNET**
[View location in VicPlan](#)

STATE ELECTORATES

Legislative Council: **EASTERN VICTORIA**
 Legislative Assembly: **MONBULK**

Planning Zones

GREEN WEDGE ZONE (GWZ)

GREEN WEDGE ZONE - SCHEDULE 2 (GWZ2)

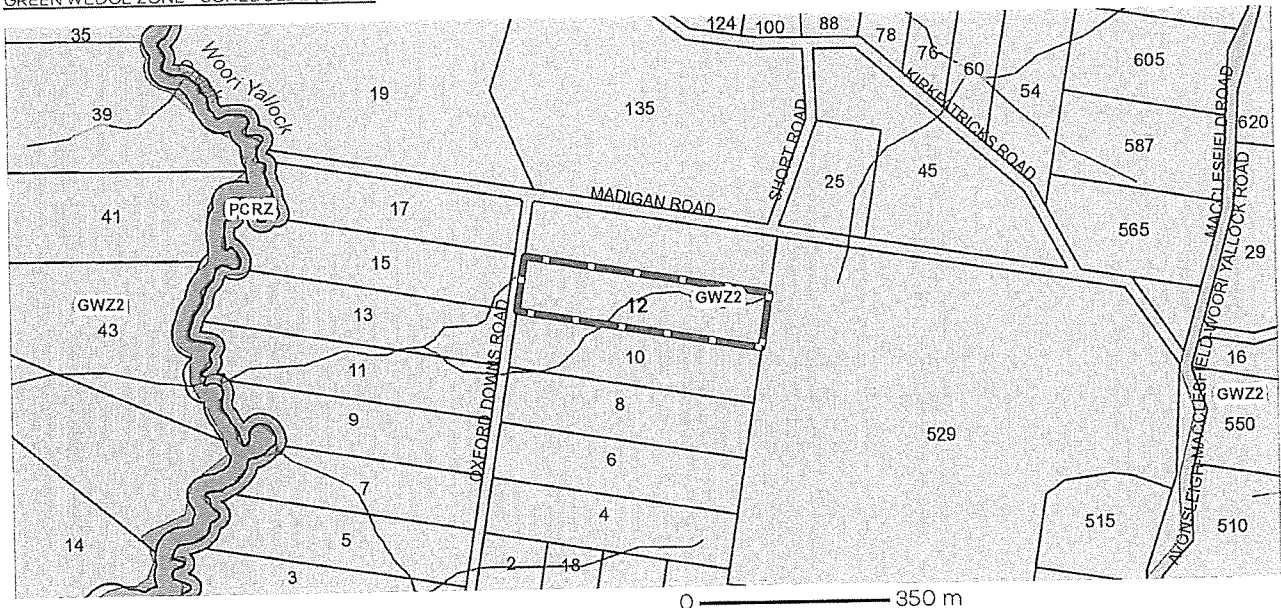

GWZ - Green Wedge
 PCRZ - Public Conservation and Resource
 RDZ2 - Road-Category 2

Water area
 Watercourses

Note: labels for zones may appear outside the actual zone - please compare the labels with the legend.

Copyright © - State Government of Victoria
 Disclaimer: This content is provided for information purposes only. No claim is made as to the accuracy or authenticity of the content. The Victorian Government does not accept any liability to any person for the information provided.
 Read the full disclaimer at <https://www2.delwp.vic.gov.au/disclaimer>
 Notwithstanding this disclaimer, a vendor may rely on the information in this report for the purpose of a statement that land is in a bushfire prone area as required by section 32C (b) of the Sale of Land 1962 (Vic).

Planning Overlays

BUSHFIRE MANAGEMENT OVERLAY (BMO)

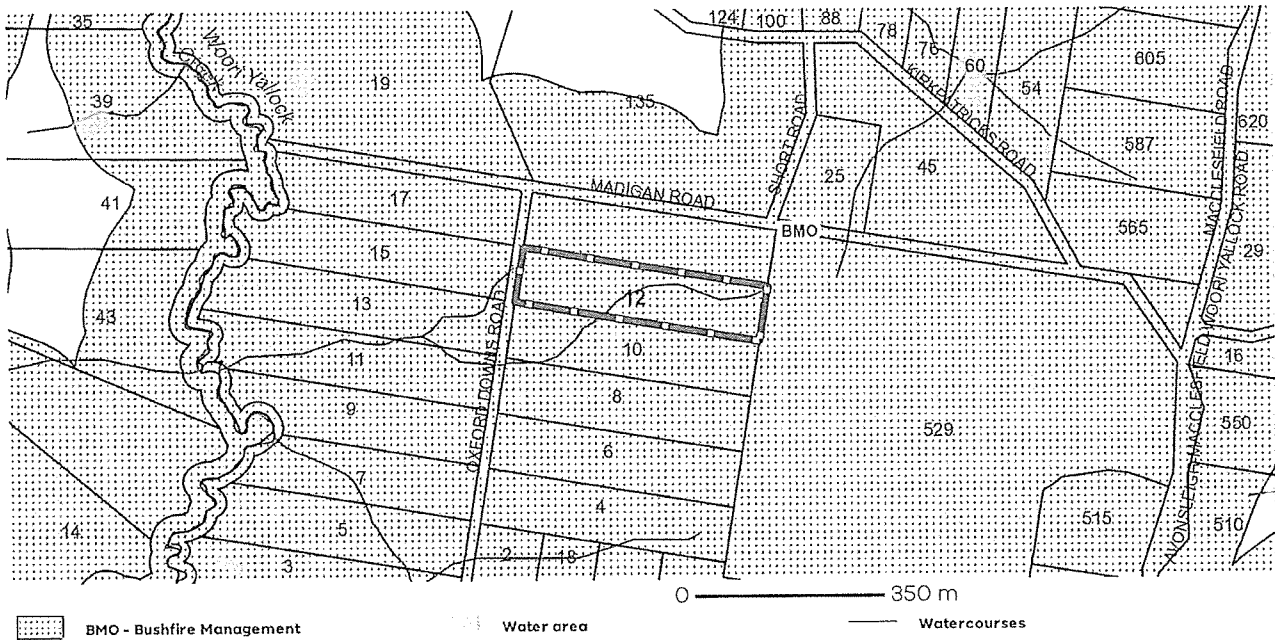

Note: due to overlaps, some overlays may not be visible, and some colours may not match those in the legend

ENVIRONMENTAL SIGNIFICANCE OVERLAY (ESO)

ENVIRONMENTAL SIGNIFICANCE OVERLAY - SCHEDULE 1(SITE B4) (ESO1-B4)

ENVIRONMENTAL SIGNIFICANCE OVERLAY - SCHEDULE 1(SITE Z24) (ESO1-Z24)

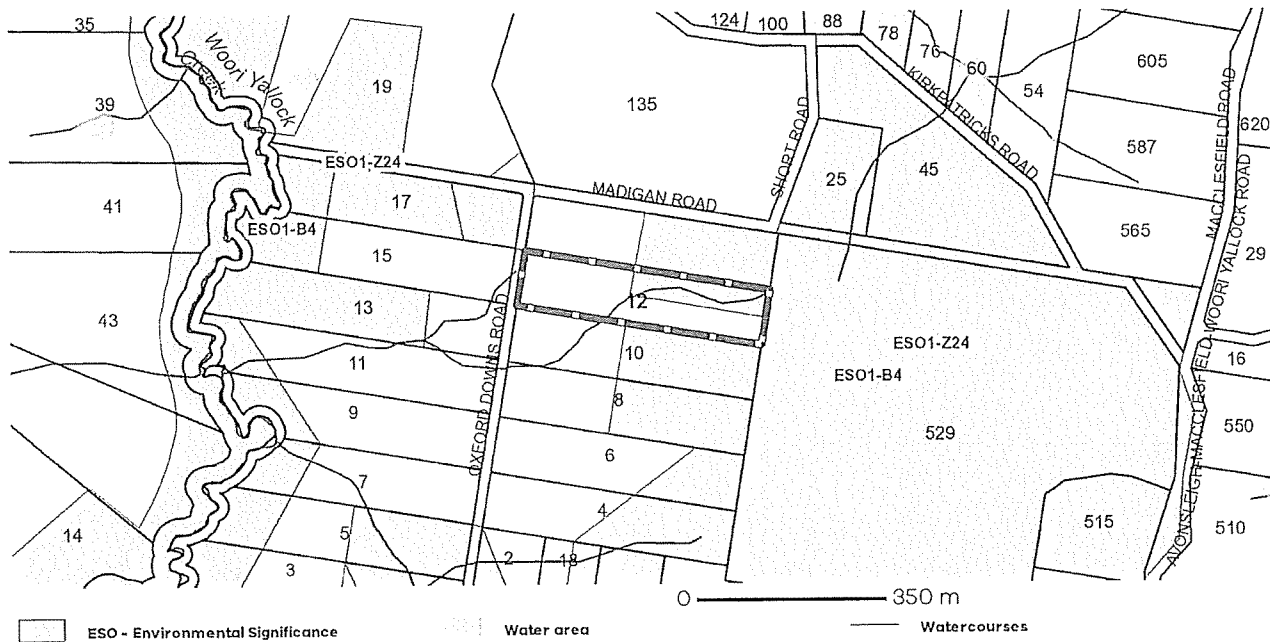

Note: due to overlaps, some overlays may not be visible, and some colours may not match those in the legend

Copyright © - State Government of Victoria

Disclaimer: This content is provided for information purposes only. No claim is made as to the accuracy or authenticity of the content. The Victorian Government does not accept any liability to any person for the information provided. Read the full disclaimer at <https://www2.delwp.vic.gov.au/disclaimer>

Notwithstanding this disclaimer, a vendor may rely on the information in this report for the purpose of a statement that land is in a bushfire prone area as required by section 32C (b) of the Sale of Land 1962 (Vic).

Planning Overlays

OTHER OVERLAYS

Other overlays in the vicinity not directly affecting this land

EROSION MANAGEMENT OVERLAY (EMO)

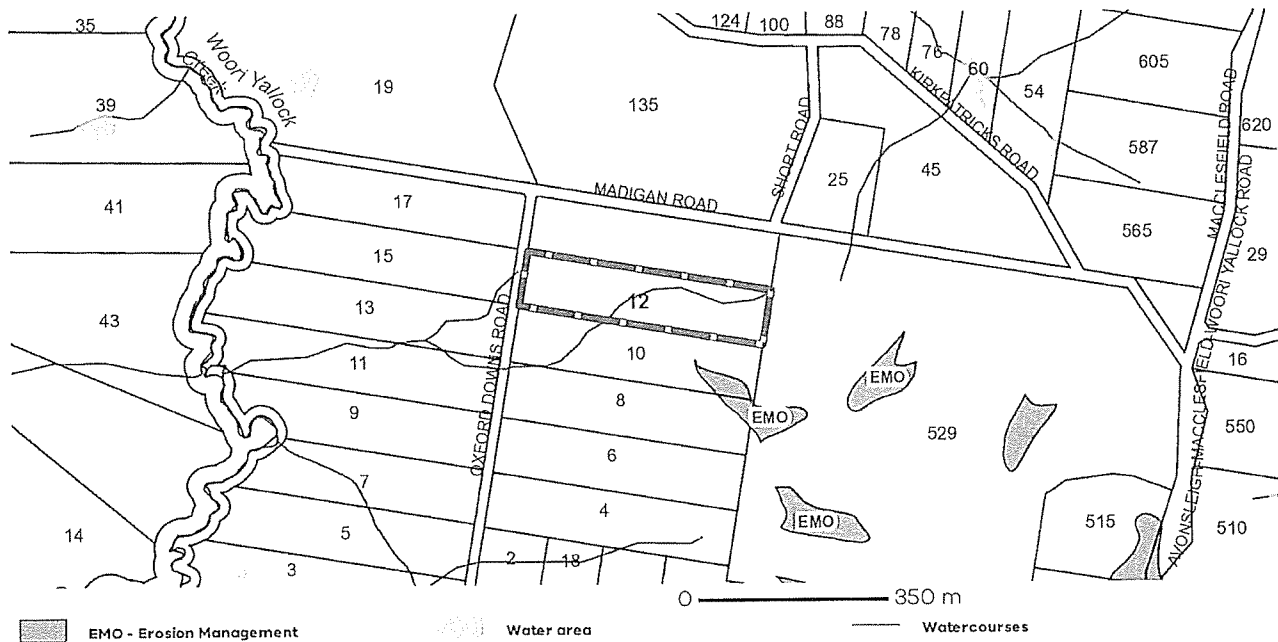

Note: due to overlaps, some overlays may not be visible, and some colours may not match those in the legend

Further Planning Information

Planning scheme data last updated on 2 September 2020.

A **planning scheme** sets out policies and requirements for the use, development and protection of land. This report provides information about the zone and overlay provisions that apply to the selected land. Information about the State and local policy, particular, general and operational provisions of the local planning scheme that may affect the use of this land can be obtained by contacting the local council or by visiting <https://www.planning.vic.gov.au>

This report is NOT a **Planning Certificate** issued pursuant to Section 199 of the **Planning and Environment Act 1987**. It does not include information about exhibited planning scheme amendments, or zonings that may affect the land. To obtain a Planning Certificate go to Titles and Property Certificates at Landata - <https://www.landata.vic.gov.au>

For details of surrounding properties, use this service to get the Reports for properties of interest.

To view planning zones, overlay and heritage information in an interactive format visit <https://mapshare.maps.vic.gov.au/vicplan>

For other information about planning in Victoria visit <https://www.planning.vic.gov.au>

Designated Bushfire Prone Areas

This property is in a designated bushfire prone area.
Special bushfire construction requirements apply. Planning provisions may apply.

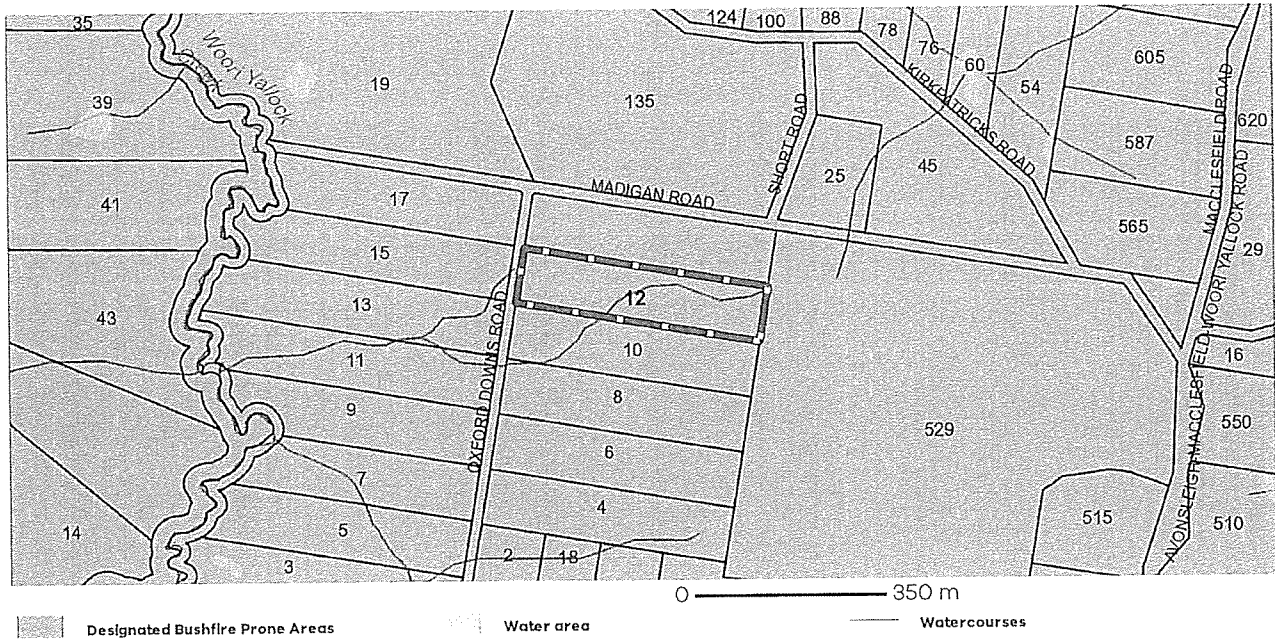

Designated bushfire prone areas as determined by the Minister for Planning are in effect from 8 September 2011 and amended from time to time.

The Building Regulations 2018 through application of the Building Code of Australia, apply bushfire protection standards for building works in designated bushfire prone areas.

Designated bushfire prone areas maps can be viewed on VicPlan at <https://mapshare.maps.vic.gov.au/vicplan> or at the relevant local council.

Note: prior to 8 September 2011, the whole of Victoria was designated as bushfire prone area for the purposes of the building control system.

Further information about the building control system and building in bushfire prone areas can be found on the Victorian Building Authority website <https://www.vba.vic.gov.au>

Copies of the Building Act and Building Regulations are available from <http://www.legislation.vic.gov.au>

For Planning Scheme Provisions in bushfire areas visit <https://www.planning.vic.gov.au>



YARRA VALLEY WATER
ABN 93 086 992 501

Lucknow Street
Mitcham Victoria 3132

Private Bag 1
Mitcham Victoria 3132

DX 13204

F (03) 9872 1353

E enquiry@yvw.com.au
yvw.com.au

3rd September 2020

Buy & Sell Conveyancing Services

Dear Buy & Sell Conveyancing Services,

RE: Application for Water Information Statement

Property Address:	12 OXFORD DOWNS ROAD MACCLESFIELD 3782
Applicant	Buy & Sell Conveyancing Services
Information Statement	30551318
Conveyancing Account Number	5757504575
Your Reference	20/3844 Miller (S)

Thank you for your recent application for a Water Information Statement (WIS). We are pleased to provide you the WIS for the above property address. This statement includes:

- Yarra Valley Water Property Information Statement
- Melbourne Water Property Information Statement
- Asset Plan
- Rates Certificate

If you have any questions about Yarra Valley Water information provided, please phone us on **1300 304 688** or email us at the address enquiry@yvw.com.au. For further information you can also refer to the Yarra Valley Water website at www.yvw.com.au.

Yours sincerely,

Steve Lennox
GENERAL MANAGER
RETAIL SERVICES



YARRA VALLEY WATER
ABN 83 086 902 501

Luoknow Street
Mitcham Victoria 3132

Private Bag 1
Mitcham Victoria 3132

DX 13204

F (03) 9872 1353

E enquiry@yvw.com.au
yvw.com.au

Yarra Valley Water Encumbrance

Property Address	12 OXFORD DOWNS ROAD MACCLESFIELD 3782
------------------	--

STATEMENT UNDER SECTION 158 WATER ACT 1989

THE FOLLOWING ENCUMBRANCES RELATE TO SECTION 158(3)

Existing sewer mains will be shown on the Asset Plan.

Please note: Unless prior consent has been obtained, the Water Act prohibits:

1. The erection and/or placement of any building, wall, bridge, fence, embankment, filling, material, machinery or other structure over or under any sewer or drain.
2. The connection of any drain or sewer to, or interference with, any sewer, drain or watercourse.



YARRA VALLEY WATER
ABN 83 066 802 501

Lucknow Street
Mitcham Victoria 3132

Private Bag 1
Mitcham Victoria 3132

DX 13204

F (03) 9872 1353

E enquiry@yvw.com.au
yvw.com.au

Melbourne Water Property Information Statement

Property Address	12 OXFORD DOWNS ROAD MACCLESFIELD 3782
------------------	--

STATEMENT UNDER SECTION 158 WATER ACT 1989

THE FOLLOWING INFORMATION RELATES TO SECTION 158(4)

Information available at Melbourne Water indicates that this property is not subject to flooding from Melbourne Water's drainage system, based on a flood level that has a probability of occurrence of 1% in any one year.

Please note: Unless prior consent has been obtained, the Water Act prohibits:

1. The erection and/or placement of any building, wall, bridge, fence, embankment, filling, material, machinery or other structure over or under any sewer or drain.
2. The connection of any drain or sewer to, or interference with, any sewer, drain or watercourse.

If you have any questions regarding Melbourne Water encumbrances or advisory information, please contact Melbourne Water on 9679 7517.

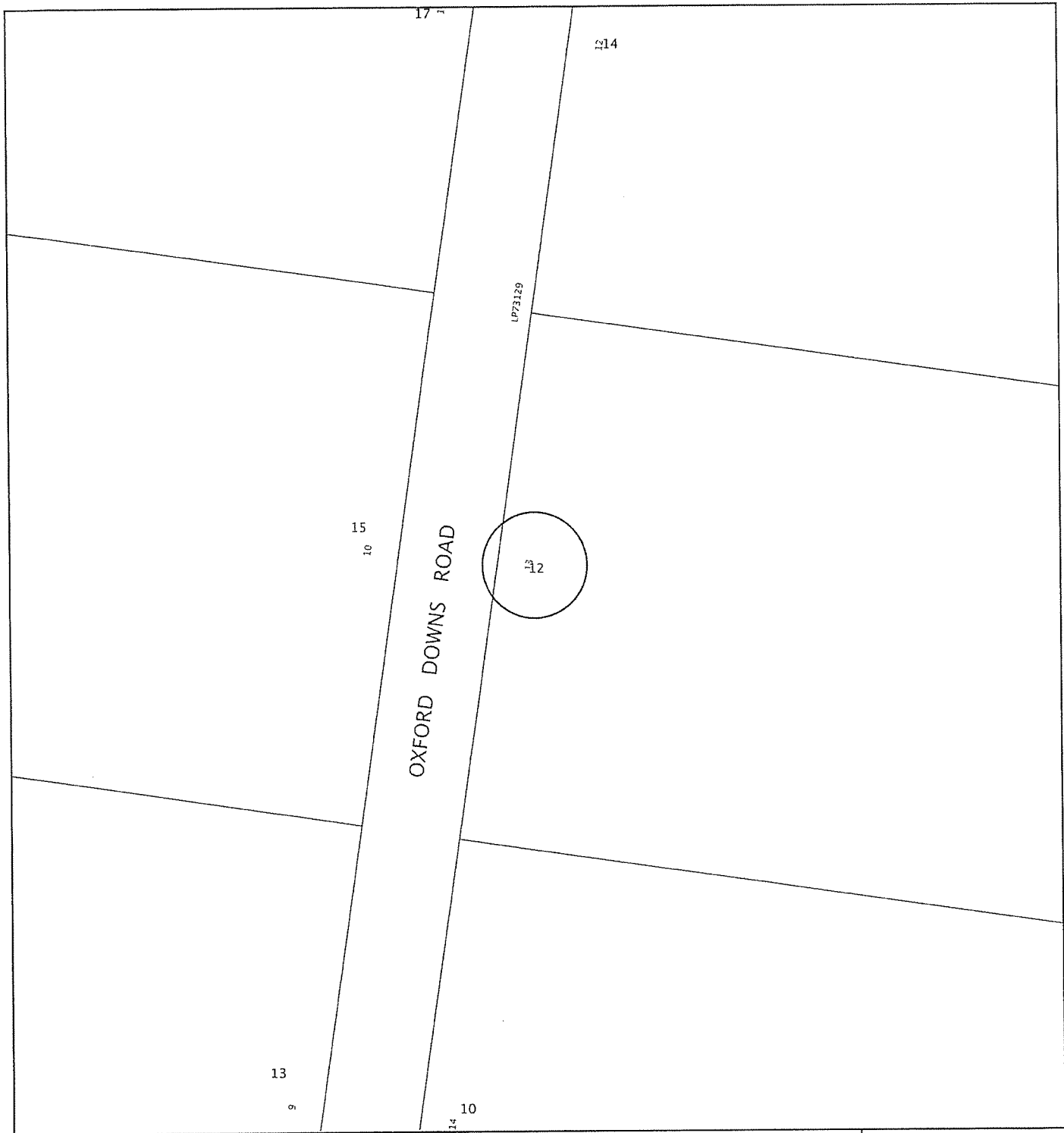

**Yarra Valley Water
Information Statement
Number: 30551318**

Address	12 OXFORD DOWNS ROAD MACCLESFIELD 3782
Date	03/09/2020
Scale	1:1000



Existing Title	Access Point Number	GLV2-42	MW Drainage Channel Centreline	
Proposed Title	Sewer Manhole		MW Drainage Underground Centreline	
Easement	Sewer Pipe Flow		MW Drainage Manhole	
Existing Sewer	Sewer Offset		MW Drainage Natural Waterway	
Abandoned Sewer	Sewer Branch			

Disclaimer: This information is supplied on the basis Yarra Valley Water Ltd:
 - Does not warrant the accuracy or completeness of the information supplied, including, without limitation, the location of Water and Sewer Assets;
 - Does not accept any liability for loss or damage of any nature, suffered or incurred by the recipient or any other persons relying on this information;
 - Recommends recipients and other persons using this information make their own site investigations and accommodate their works accordingly;



YARRA VALLEY WATER
ABN 93 068 502 501

Lucknow Street
Mitcham Victoria 3132

Private Bag 1
Mitcham Victoria 3132

DX 13204

F (03) 9872 1353

E enquiry@yvw.com.au
yvw.com.au

Buy & Sell Conveyancing Services
annette@buyandsellconveyancing.com.au

RATES CERTIFICATE

Account No: 9212458767
Rate Certificate No: 30551318

Date of Issue: 03/09/2020
Your Ref: 20/3844 Miller (S)

With reference to your request for details regarding:

Property Address	Lot & Plan	Property Number	Property Type
12 OXFORD DOWNS RD, MACCLESFIELD VIC 3782	13/LP73129	1383740	Residential

Agreement Type	Period	Charges	Outstanding
Parks Fee	01-07-2020 to 30-06-2021	\$79.02	\$79.02
Drainage Fee	01-07-2020 to 30-09-2020	\$14.44	\$14.44
Other Charges:			
Interest	No interest applicable at this time		
No further charges applicable to this property			
Balance Brought Forward			\$0.00
Total for This Property			\$93.46
Total Due			\$93.46

IMPORTANT NOTICE FOR SOLICITORS AND CONVEYANCERS

We have changed our BPAY biller code. Please refer to the payment options and update your bank details.

GENERAL MANAGER
RETAIL SERVICES

Note:

1. Invoices generated with Residential Water Usage during the period 01/07/2017 – 30/09/2017 will include a Government Water Rebate of \$100.
2. This statement details all tariffs, charges and penalties due and payable to Yarra Valley Water as at the date of this statement and also includes tariffs and charges (other than for usage charges yet to be billed) which are due and payable to the end of the current financial quarter.
3. All outstanding debts are due to be paid to Yarra Valley Water at settlement. Any debts that are unpaid at settlement will carry over onto the purchaser's first quarterly account and follow normal credit and collection activities - pursuant to section 275 of the Water Act 1989.
4. If the total due displays a (-\$ cr), this means the account is in credit. Credit amounts will be transferred to the purchasers account at settlement.
5. Any deferred property debt is included in the arrears figures.

6. Yarra Valley Water provides information in this Rates Certificate relating to waterways and drainage as an agent for Melbourne Water and relating to parks as an agent for Parks Victoria - pursuant to section 158 of the Water Act 1989.

7. The charges on this rates certificate are calculated and valid at the date of issue. To obtain up to date financial information, please order a Rates Settlement Statement prior to settlement.

8. From 01/07/2019, Residential Water Usage is billed using the following step pricing system: 266.20 cents per kilolitre for the first 44 kilolitres; 317.87 cents per kilolitre for 44-88 kilolitres and 472.77 cents per kilolitre for anything more than 88 kilolitres

9. From 01/07/2019, Residential Recycled Water Usage is billed 186.34 cents per kilolitre

10. From 01/07/2019, Residential Sewage Disposal is calculated using the following equation: Water Usage (kl) x Seasonal Factor x Discharge Factor x Price (cents/kl) 114.26 cents per kilolitre

11. From 01/07/2019, Residential Recycled Sewage Disposal is calculated using the following equation: Recycled Water Usage (kl) x Seasonal Factor x Discharge Factor x Price (cents/kl) 114.26 cents per kilolitre

12. The property is a serviced property with respect to all the services, for which charges are listed in the Statement of Fees above.

To ensure you accurately adjust the settlement amount, we strongly recommend you book a Special Meter Reading:

- Special Meter Readings ensure that actual water use is adjusted for at settlement.
- Without a Special Meter Reading, there is a risk your client's settlement adjustment may not be correct.



YARRA VALLEY WATER
ABN 93 066 902 501

Lucknow Street
Mitcham Victoria 3132

Private Bag 1
Mitcham Victoria 3132

DX 13204

F (03) 9872 1353

E enquiry@yvw.com.au
yvw.com.au

Property No: 1383740

Address: 12 OXFORD DOWNS RD, MACCLESFIELD VIC 3782

Water Information Statement Number: 30551318

HOW TO PAY



Bill Code: 314567
Ref: 92124587676



Mail a Cheque with the Remittance Advice below to:
Yarra Valley Water
GPO Box 2860 Melbourne VIC 3001

Amount Paid

Date Paid

Receipt Number

Please Note: BPAY is available for individual property settlements.

PROPERTY SETTLEMENT REMITTANCE ADVICE

Property No: 1383740

Address: 12 OXFORD DOWNS RD, MACCLESFIELD VIC 3782

Water Information Statement Number: 30551318

Cheque Amount: \$



YARRA VALLEY WATER
ABN 93 066 902 601

Lucknow Street
Mitcham Victoria 3132

Private Bag 1
Mitcham Victoria 3132

DX 13204

F (03) 9872 1353

E enquiry@yvw.com.au
yvw.com.au

Did you know?

PEXA is a property exchange network that allows secure, online lodgment and Financial Settlement.

Property Land Titles are lodged online at settlement, whilst funds are settled through the Reserve Bank of Australia, meaning that the vendor will usually receive their cleared funds on the same day.

There's no need to wait on the phone for payout figures as transfer and Electronic Notice of Sale documents are transmitted automatically at settlement.

Key benefits for you

- Free to register
- Fast, immediate updates
- Potential to settle in minutes (not days)
- Pre-lodgement verification improves information accuracy
- Conveyancers, banks, legal firms and land registries share information
- No need to physically attend settlement
- Funds settle through the Reserve Bank of Australia

Want to know more or register?

Please visit the PEXA website or contact them directly:

<https://www.pexa.com.au/howpexaworks>

Phone: 1300 084 515 between 7am-10pm AEST/AEDT Monday to Friday excluding national public holidays

Email: support@pexa.com.au

Due diligence checklist

What you need to know before buying a residential property

Before you buy a home, you should be aware of a range of issues that may affect that property and impose restrictions or obligations on you, if you buy it. This checklist aims to help you identify whether any of these issues will affect you. The questions are a starting point only and you may need to seek professional advice to answer some of them. You can find links to organisations and web pages that can help you learn more, by visiting the [Due diligence checklist page](http://consumer.vic.gov.au/duediligencechecklist) on the [Consumer Affairs Victoria website](http://consumer.vic.gov.au/duediligencechecklist) (consumer.vic.gov.au/duediligencechecklist).

Urban living

Moving to the inner city?

High density areas are attractive for their entertainment and service areas, but these activities create increased traffic as well as noise and odours from businesses and people. Familiarising yourself with the character of the area will give you a balanced understanding of what to expect.

Is the property subject to an owners corporation?

If the property is part of a subdivision with common property such as driveways or grounds, it may be subject to an owners corporation. You may be required to pay fees and follow rules that restrict what you can do on your property, such as a ban on pet ownership.

Growth areas

Are you moving to a growth area?

You should investigate whether you will be required to pay a growth areas infrastructure contribution.

Flood and fire risk

Does this property experience flooding or bushfire?

Properties are sometimes subject to the risk of fire and flooding due to their location. You should properly investigate these risks and consider their implications for land management, buildings and insurance premiums.

Rural properties

Moving to the country?

If you are looking at property in a rural zone, consider:

- Is the surrounding land use compatible with your lifestyle expectations? Farming can create noise or odour that may be at odds with your expectations of a rural lifestyle.
- Are you considering removing native vegetation? There are regulations which affect your ability to remove native vegetation on private property.
- Do you understand your obligations to manage weeds and pest animals?

Can you build new dwellings?

Does the property adjoin crown land, have a water frontage, contain a disused government road, or are there any crown licences associated with the land?

Is there any earth resource activity such as mining in the area?

You may wish to find out more about exploration, mining and quarrying activity on or near the property and consider the issue of petroleum, geothermal and greenhouse gas sequestration permits, leases and licences, extractive industry authorisations and mineral licences.

Soil and groundwater contamination

Has previous land use affected the soil or groundwater?

You should consider whether past activities, including the use of adjacent land, may have caused contamination at the site and whether this may prevent you from doing certain things to or on the land in the future.

(04/10/2016)

Land boundaries

Do you know the exact boundary of the property?

You should compare the measurements shown on the title document with actual fences and buildings on the property, to make sure the boundaries match. If you have concerns about this, you can speak to your lawyer or conveyancer, or commission a site survey to establish property boundaries.

Planning controls

Can you change how the property is used, or the buildings on it?

All land is subject to a planning scheme, run by the local council. How the property is zoned and any overlays that may apply, will determine how the land can be used. This may restrict such things as whether you can build on vacant land or how you can alter or develop the land and its buildings over time.

The local council can give you advice about the planning scheme, as well as details of any other restrictions that may apply, such as design guidelines or bushfire safety design. There may also be restrictions – known as encumbrances – on the property's title, which prevent you from developing the property. You can find out about encumbrances by looking at the section 32 statement.

Are there any proposed or granted planning permits?

The local council can advise you if there are any proposed or issued planning permits for any properties close by. Significant developments in your area may change the local 'character' (predominant style of the area) and may increase noise or traffic near the property.

Safety

Is the building safe to live in?

Building laws are in place to ensure building safety. Professional building inspections can help you assess the property for electrical safety, possible illegal building work, adequate pool or spa fencing and the presence of asbestos, termites, or other potential hazards.

Building permits

Have any buildings or retaining walls on the property been altered, or do you plan to alter them?

There are laws and regulations about how buildings and retaining walls are constructed, which you may wish to investigate to ensure any completed or proposed building work is approved. The local council may be able to give you information about any building permits issued for recent building works done to the property, and what you must do to plan new work. You can also commission a private building surveyor's assessment.

Are any recent building or renovation works covered by insurance?

Ask the vendor if there is any owner-builder insurance or builder's warranty to cover defects in the work done to the property.

Utilities and essential services

Does the property have working connections for water, sewerage, electricity, gas, telephone and internet?

Unconnected services may not be available, or may incur a fee to connect. You may also need to choose from a range of suppliers for these services. This may be particularly important in rural areas where some services are not available.

Buyers' rights

Do you know your rights when buying a property?

The contract of sale and section 32 statement contain important information about the property, so you should request to see these and read them thoroughly. Many people engage a lawyer or conveyancer to help them understand the contracts and ensure the sale goes through correctly. If you intend to hire a professional, you should consider speaking to them before you commit to the sale. There are also important rules about the way private sales and auctions are conducted. These may include a cooling-off period and specific rights associated with 'off the plan' sales. The important thing to remember is that, as the buyer, you have rights.