

Contract for the sale and purchase of land 2019 edition

TERM	MEANING OF TERM	NSW DAN:
vendor's agent	COLLIE & TIERNEY REAL ESTATE 67 Lime Avenue Mildura Vic 3500	phone 03 5021 2200 fax 03 5021 1213 ref Brenton Love
co-agent	Not Applicable	phone fax ref
vendor	PETER RICHARD KELLEHER and SHARON MARGARET KELLEHER PO Box 10044, Mildura Vic 3502	
vendor's solicitor	MARTIN IRWIN & RICHARDS LAWYERS 61 Deakin Avenue, Mildura VIC 3500 PO Box 4101, Mildura VIC 3502 DX 50022 Mildura email: enquiries@mirlawyers.com.au	phone 03 5023 7900 fax 03 5023 7560 ref DCON/DS/321176-1
date for completion	42nd day after the contract date (clause 15)	
land (address, plan details and title reference)	12 BURNS STREET, GOL GOL NSW 2738 Registered Plan: Lot 1 in Deposited Plan DP1251938 Folio Identifier 1/1251938 <input checked="" type="checkbox"/> VACANT POSSESSION <input type="checkbox"/> subject to existing tenancies	
improvements	<input type="checkbox"/> HOUSE <input type="checkbox"/> garage <input type="checkbox"/> carport <input type="checkbox"/> home unit <input type="checkbox"/> carspace <input type="checkbox"/> storage space <input type="checkbox"/> none <input checked="" type="checkbox"/> other: 12m x 7 m shed and 6m x 5m shed	
attached copies	<input checked="" type="checkbox"/> documents in the List of Documents as marked or numbered: <input type="checkbox"/> other documents:	

A real estate agent is permitted by legislation to fill up the items in this box in a sale of residential property.

inclusions	<input type="checkbox"/> blinds <input type="checkbox"/> built-in wardrobes <input type="checkbox"/> clothes line <input type="checkbox"/> curtains	<input type="checkbox"/> dishwasher <input type="checkbox"/> fixed floor coverings <input type="checkbox"/> insect screens <input type="checkbox"/> other:	<input type="checkbox"/> light fittings <input type="checkbox"/> range hood <input type="checkbox"/> solar panels	<input type="checkbox"/> stove <input type="checkbox"/> pool equipment <input type="checkbox"/> TV antenna
exclusions				
purchaser				
purchaser's				
<input type="checkbox"/> solicitor				
<input type="checkbox"/> conveyancer	email:	phone fax ref		
price	\$			
deposit	\$	(10% of the price, unless otherwise stated)		
balance	\$			
contract date	(if not stated, the date this contract was made)			

buyer's agent

vendor

witness

GST AMOUNT (optional)
 The price includes
 GST of: \$

purchaser

☐ JOINT TENANTS ☐ tenants in common ☐ in unequal shares

witness

Choices

Vendor agrees to accept a **deposit bond** (clause 3) ☒ NO ☐ yes

Nominated Electronic Lodgment Network (ELN) (clause 30)

Electronic transaction (clause 30) ☐ no ☒ YES

(if no, vendor must provide further details, such as the proposed applicable waiver, in the space below, or serve within 14 days of the contract date):

Parties agree that the deposit be invested (clause 2.9) ☒ NO ☐ yes

Tax information (the parties promise this is correct as far as each party is aware)

Land tax is adjustable ☒ NO ☐ yes

GST: Taxable supply ☒ NO ☐ yes in full ☐ yes to an extent

Margin scheme will be used in making the taxable supply ☒ NO ☐ yes

This sale is not a taxable supply because (one or more of the following may apply) the sale is:

- ☐ not made in the course or furtherance of an enterprise that the vendor carries on (section 9-5(b))
- ☒ by a vendor who is neither registered nor required to be registered for GST (section 9-5(d))
- ☐ GST-free because the sale is the supply of a going concern under section 38-325
- ☐ GST-free because the sale is subdivided farm land or farm land supplied for farming under Subdivision 38-O
- ☐ input taxed because the sale is of eligible residential premises (sections 40-65, 40-75(2) and 195-1)

Purchaser must make an **GSTRW payment**: (residential withholding payment) ☒ NO ☐ yes
(if yes, vendor must provide further details)

If the further details below are not fully completed at the contract date, the vendor must provide all these details in a separate notice *within* 14 days of the contract date.

GSTRW payment (GST residential withholding payment) – further details

Frequently the supplier will be the vendor. However, sometimes further information will be required as to which entity is liable for GST, for example, if the supplier is a partnership, a trust, part of a GST group or a participant in a GST joint venture.

Supplier's name:

Supplier's ABN:

Supplier's GST branch number (if applicable):

Supplier's business address:

Supplier's email address:

Supplier's phone number:

Supplier's proportion of **GSTRW payment**:

If more than one supplier, provide the above details for each supplier.

Amount purchaser must pay – price multiplied by the **GSTRW rate** (residential withholding rate): \$

Amount must be paid: ☐ AT COMPLETION ☐ at another time (specify):

Is any of the consideration not expressed as an amount in money? ☐ NO ☐ yes

If "yes", the GST inclusive market value of the non-monetary consideration: \$

Other details (including those required by regulation or the ATO forms):

List of Documents

<p>General</p> <p><input checked="" type="checkbox"/> 1 property certificate for the land</p> <p><input checked="" type="checkbox"/> 2 plan of the land</p> <p><input type="checkbox"/> 3 unregistered plan of the land</p> <p><input type="checkbox"/> 4 plan of land to be subdivided</p> <p><input type="checkbox"/> 5 document that is to be lodged with a relevant plan</p> <p><input checked="" type="checkbox"/> 6 section 10.7(2) planning certificate (Environmental Planning and Assessment Act 1979)</p> <p><input type="checkbox"/> 7 additional information included in that certificate under section 10.7(5)</p> <p><input type="checkbox"/> 8 sewerage infrastructure location diagram (service location diagram)</p> <p><input type="checkbox"/> 9 sewerage lines location diagram (sewerage service diagram)</p> <p><input checked="" type="checkbox"/> 10 document that created or may have created an easement, profit à prendre, restriction on use or positive covenant disclosed in this contract</p> <p><input type="checkbox"/> 11 <i>planning agreement</i></p> <p><input type="checkbox"/> 12 section 88G certificate (positive covenant)</p> <p><input type="checkbox"/> 13 survey report</p> <p><input type="checkbox"/> 14 building information certificate or building certificate given under <i>legislation</i></p> <p><input type="checkbox"/> 15 lease (with every relevant memorandum or variation)</p> <p><input type="checkbox"/> 16 other document relevant to tenancies</p> <p><input type="checkbox"/> 17 licence benefiting the land</p> <p><input type="checkbox"/> 18 old system document</p> <p><input type="checkbox"/> 19 Crown purchase statement of account</p> <p><input type="checkbox"/> 20 building management statement</p> <p><input type="checkbox"/> 21 form of requisitions</p> <p><input type="checkbox"/> 22 <i>clearance certificate</i></p> <p><input checked="" type="checkbox"/> 23 land tax certificate</p> <p>Home Building Act 1989</p> <p><input type="checkbox"/> 24 insurance certificate</p> <p><input type="checkbox"/> 25 brochure or warning</p> <p><input type="checkbox"/> 26 evidence of alternative indemnity cover</p> <p>Swimming Pools Act 1992</p> <p><input type="checkbox"/> 27 certificate of compliance</p> <p><input type="checkbox"/> 28 evidence of registration</p> <p><input type="checkbox"/> 29 relevant occupation certificate</p> <p><input type="checkbox"/> 30 certificate of non-compliance</p> <p><input type="checkbox"/> 31 detailed reasons of non-compliance</p>	<p>Strata or community title (clause 23 of the contract)</p> <p><input type="checkbox"/> 32 property certificate for strata common property</p> <p><input type="checkbox"/> 33 plan creating strata common property</p> <p><input type="checkbox"/> 34 strata by-laws</p> <p><input type="checkbox"/> 35 strata development contract or statement</p> <p><input type="checkbox"/> 36 strata management statement</p> <p><input type="checkbox"/> 37 strata renewal proposal</p> <p><input type="checkbox"/> 38 strata renewal plan</p> <p><input type="checkbox"/> 39 leasehold strata - lease of lot and common property</p> <p><input type="checkbox"/> 40 property certificate for neighbourhood property</p> <p><input type="checkbox"/> 41 plan creating neighbourhood property</p> <p><input type="checkbox"/> 42 neighbourhood development contract</p> <p><input type="checkbox"/> 43 neighbourhood management statement</p> <p><input type="checkbox"/> 44 property certificate for precinct property</p> <p><input type="checkbox"/> 45 plan creating precinct property</p> <p><input type="checkbox"/> 46 precinct development contract</p> <p><input type="checkbox"/> 47 precinct management statement</p> <p><input type="checkbox"/> 48 property certificate for community property</p> <p><input type="checkbox"/> 49 plan creating community property</p> <p><input type="checkbox"/> 50 community development contract</p> <p><input type="checkbox"/> 51 community management statement</p> <p><input type="checkbox"/> 52 document disclosing a change of by-laws</p> <p><input type="checkbox"/> 53 document disclosing a change in a development or management contract or statement</p> <p><input type="checkbox"/> 54 document disclosing a change in boundaries</p> <p><input type="checkbox"/> 55 information certificate under Strata Schemes Management Act 2015</p> <p><input type="checkbox"/> 56 information certificate under Community Land Management Act 1989</p> <p><input type="checkbox"/> 57 disclosure statement - off the plan contract</p> <p>Other</p> <p><input type="checkbox"/> 58 Other:</p>
--	---

HOLDER OF STRATA OR COMMUNITY TITLE RECORDS – Name, address, email address and telephone number

IMPORTANT NOTICE TO VENDORS AND PURCHASERS

Before signing this contract you should ensure that you understand your rights and obligations, some of which are not written in this contract but are implied by law.

WARNING—SMOKE ALARMS

The owners of certain types of buildings and strata lots must have smoke alarms (or in certain cases heat alarms) installed in the building or lot in accordance with regulations under the *Environmental Planning and Assessment Act 1979*. It is an offence not to comply. It is also an offence to remove or interfere with a smoke alarm or heat alarm. Penalties apply.

WARNING—LOOSE-FILL ASBESTOS INSULATION

Before purchasing land that includes any residential premises (within the meaning of Division 1A of Part 8 of the *Home Building Act 1989*) built before 1985, a purchaser is strongly advised to consider the possibility that the premises may contain loose-fill asbestos insulation (within the meaning of Division 1A of Part 8 of the *Home Building Act 1989*). In particular, a purchaser should:

- (a) search the Register required to be maintained under Division 1A of Part 8 of the *Home Building Act 1989*, and
- (b) ask the relevant local council whether it holds any records showing that the residential premises contain loose-fill asbestos insulation.

For further information about loose-fill asbestos insulation (including areas in which residential premises have been identified as containing loose-fill asbestos insulation), contact NSW Fair Trading.

COOLING OFF PERIOD (PURCHASER'S RIGHTS)

1. This is the statement required by section 66X of the *Conveyancing Act 1919* and applies to a contract for the sale of residential property.
2. **EXCEPT** in the circumstances listed in paragraph 3, the purchaser may rescind the contract at any time before 5 pm on—
 - (a) the tenth business day after the day on which the contract was made—in the case of an off the plan contract, or
 - (b) the fifth business day after the day on which the contract was made—in any other case.
3. There is **NO COOLING OFF PERIOD**:
 - (a) if, at or before the time the contract is made, the purchaser gives to the vendor (or the vendor's solicitor or agent) a certificate that complies with section 66W of the Act, or
 - (b) if the property is sold by public auction, or
 - (c) if the contract is made on the same day as the property was offered for sale by public auction but passed in, or
 - (d) if the contract is made in consequence of the exercise of an option to purchase the property, other than an option that is void under section 66ZG of the Act.
4. A purchaser exercising the right to cool off by rescinding the contract will forfeit to the vendor 0.25% of the purchase price of the property. The vendor is entitled to recover the amount forfeited from any amount paid by the purchaser as a deposit under the contract and the purchaser is entitled to a refund of any balance.

DISPUTES

If you get into a dispute with the other party, the Law Society and Real Estate Institute encourage you to use informal procedures such as negotiation, independent expert appraisal, the Law Society Conveyancing Dispute Resolution Scheme or mediation (for example mediation under the Law Society Mediation Program).

AUCTIONS

Regulations made under the Property, Stock and Business Agents Act 2002 prescribe a number of conditions applying to sales by auction.

WARNINGS

1. Various Acts of Parliament and other matters can affect the rights of the parties to this contract. Some important matters are actions, claims, decisions, licences, notices, orders, proposals or rights of way involving:

APA Group	NSW Department of Education
Australian Taxation Office	NSW Fair Trading
Council	Owner of adjoining land
County Council	Privacy
Department of Planning, Industry and Environment	Public Works Advisory
Department of Primary Industries	Subsidence Advisory NSW
Electricity and gas	Telecommunications
Land & Housing Corporation	Transport for NSW
Local Land Services	Water, sewerage or drainage authority

If you think that any of these matters affects the property, tell your solicitor.
2. A lease may be affected by the Agricultural Tenancies Act 1990, the Residential Tenancies Act 2010 or the Retail Leases Act 1994.
3. If any purchase money is owing to the Crown, it will become payable before obtaining consent, or if no consent is needed, when the transfer is registered.
4. If a consent to transfer is required under legislation, see clause 27 as to the obligations of the parties.
5. The vendor should continue the vendor's insurance until completion. If the vendor wants to give the purchaser possession before completion, the vendor should first ask the insurer to confirm this will not affect the insurance.
6. The purchaser will usually have to pay transfer duty (and sometimes surcharge purchaser duty) on this contract. If duty is not paid on time, a purchaser may incur penalties.
7. If the purchaser agrees to the release of deposit, the purchaser's right to recover the deposit may stand behind the rights of others (for example the vendor's mortgagee).
8. The purchaser should arrange insurance as appropriate.
9. Some transactions involving personal property may be affected by the Personal Property Securities Act 2009.
10. A purchaser should be satisfied that finance will be available at the time of completing the purchase.
11. Where the market value of the property is at or above a legislated amount, the purchaser may have to comply with a foreign resident capital gains withholding payment obligation (even if the vendor is not a foreign resident). If so, this will affect the amount available to the vendor on completion.
12. Purchasers of some residential properties may have to withhold part of the purchase price to be credited towards the GST liability of the vendor. If so, this will also affect the amount available to the vendor. More information is available from the ATO.

The vendor sells and the purchaser buys the *property* for the price under these provisions instead of Schedule 3 Conveyancing Act 1919, subject to any *legislation* that cannot be excluded.

1 Definitions (a term in italics is a defined term)

In this contract, these terms (in any form) mean –

<i>adjustment date</i>	the earlier of the giving of possession to the purchaser or completion;
<i>bank</i>	the Reserve Bank of Australia or an authorised deposit-taking institution which is a bank, a building society or a credit union;
<i>business day</i>	any day except a bank or public holiday throughout NSW or a Saturday or Sunday;
<i>cheque</i>	a cheque that is not postdated or stale;
<i>clearance certificate</i>	a certificate within the meaning of s14-220 of Schedule 1 to the <i>TA Act</i> , that covers one or more days falling within the period from and including the contract date to completion;
<i>deposit-bond</i>	a deposit bond or guarantee from an issuer, with an expiry date and for an amount each approved by the vendor;
<i>depositholder</i>	vendor's agent (or if no vendor's agent is named in this contract, the vendor's <i>solicitor</i> , or if no vendor's <i>solicitor</i> is named in this contract, the buyer's agent);
<i>document of title</i>	document relevant to the title or the passing of title;
<i>FRCGW percentage</i>	the percentage mentioned in s14-200(3)(a) of Schedule 1 to the <i>TA Act</i> (12.5% as at 1 July 2017);
<i>FRCGW remittance</i>	a remittance which the purchaser must make under s14-200 of Schedule 1 to the <i>TA Act</i> , being the lesser of the <i>FRCGW percentage</i> of the price (inclusive of GST, if any) and the amount specified in a <i>variation served</i> by a <i>party</i> ;
<i>GST Act</i>	A New Tax System (Goods and Services Tax) Act 1999;
<i>GST rate</i>	the rate mentioned in s4 of A New Tax System (Goods and Services Tax Imposition - General) Act 1999 (10% as at 1 July 2000);
<i>GSTRW payment</i>	a payment which the purchaser must make under s14-250 of Schedule 1 to the <i>TA Act</i> (the price multiplied by the <i>GSTRW rate</i>);
<i>GSTRW rate</i>	the rate determined under ss14-250(6), (8) or (9) of Schedule 1 to the <i>TA Act</i> (as at 1 July 2018, usually 7% of the price if the margin scheme applies, 1/11 th if not);
<i>legislation</i>	an Act or a by-law, ordinance, regulation or rule made under an Act;
<i>normally</i>	subject to any other provision of this contract;
<i>party</i>	each of the vendor and the purchaser;
<i>property</i>	the land, the improvements, all fixtures and the inclusions, but not the exclusions;
<i>planning agreement</i>	a valid voluntary agreement within the meaning of s7.4 of the Environmental Planning and Assessment Act 1979 entered into in relation to the <i>property</i> ;
<i>requisition</i>	an objection, question or requisition (but the term does not include a claim);
<i>rescind</i>	rescind this contract from the beginning;
<i>serve</i>	serve in writing on the other <i>party</i> ;
<i>settlement cheque</i>	an unendorsed <i>cheque</i> made payable to the person to be paid and – <ul style="list-style-type: none"> • issued by a <i>bank</i> and drawn on itself; or • if authorised in writing by the vendor or the vendor's <i>solicitor</i>, some other <i>cheque</i>;
<i>solicitor</i>	in relation to a <i>party</i> , the <i>party's</i> solicitor or licensed conveyancer named in this contract or in a notice <i>served</i> by the <i>party</i> ;
<i>TA Act</i>	Taxation Administration Act 1953;
<i>terminate</i>	terminate this contract for breach;
<i>variation</i>	a variation made under s14-235 of Schedule 1 to the <i>TA Act</i> ;
<i>within</i>	in relation to a period, at any time before or during the period; and
<i>work order</i>	a valid direction, notice or order that requires work to be done or money to be spent on or in relation to the <i>property</i> or any adjoining footpath or road (but the term does not include a notice under s22E of the Swimming Pools Act 1992 or clause 22 of the Swimming Pools Regulation 2018).

2 Deposit and other payments before completion

- 2.1 The purchaser must pay the deposit to the *depositholder* as stakeholder.
- 2.2 *Normally*, the purchaser must pay the deposit on the making of this contract, and this time is essential.
- 2.3 If this contract requires the purchaser to pay any of the deposit by a later time, that time is also essential.
- 2.4 The purchaser can pay any of the deposit by giving cash (up to \$2,000) or by unconditionally giving a *cheque* to the *depositholder* or to the vendor, vendor's agent or vendor's *solicitor* for sending to the *depositholder* or by payment by electronic funds transfer to the *depositholder*.
- 2.5 If any of the deposit is not paid on time or a *cheque* for any of the deposit is not honoured on presentation, the vendor can *terminate*. This right to *terminate* is lost as soon as the deposit is paid in full.
- 2.6 If the vendor accepts a bond or guarantee for the deposit, clauses 2.1 to 2.5 do not apply.

BREACH OF COPYRIGHT MAY RESULT IN LEGAL ACTION

70619771

- 2.7 If the vendor accepts a bond or guarantee for part of the deposit, clauses 2.1 to 2.5 apply only to the balance.
- 2.8 If any of the deposit or of the balance of the price is paid before completion to the vendor or as the vendor directs, it is a charge on the land in favour of the purchaser until *termination* by the vendor or completion, subject to any existing right.
- 2.9 If each *party* tells the *depositholder* that the deposit is to be invested, the *depositholder* is to invest the deposit (at the risk of the *party* who becomes entitled to it) with a *bank*, in an interest-bearing account in NSW, payable at call, with interest to be reinvested, and pay the interest to the *parties* equally, after deduction of all proper government taxes and financial institution charges and other charges.

3 Deposit-bond

- 3.1 This clause applies only if this contract says the vendor has agreed to accept a *deposit-bond* for the deposit (or part of it).
- 3.2 The purchaser must provide the original *deposit-bond* to the vendor's *solicitor* (or if no *solicitor* the *depositholder*) at or before the making of this contract and this time is essential.
- 3.3 If the *deposit-bond* has an expiry date and completion does not occur by the date which is 14 days before the expiry date, the purchaser must *serve* a replacement *deposit-bond* at least 7 days before the expiry date. The time for service is essential.
- 3.4 The vendor must approve a replacement *deposit-bond* if –
 - 3.4.1 it is from the same issuer and for the same amount as the earlier *deposit-bond*; and
 - 3.4.2 it has an expiry date at least three months after its date of issue.
- 3.5 A breach of clauses 3.2 or 3.3 entitles the vendor to *terminate*. The right to *terminate* is lost as soon as –
 - 3.5.1 the purchaser *serves* a replacement *deposit-bond*; or
 - 3.5.2 the deposit is paid in full under clause 2.
- 3.6 Clauses 3.3 and 3.4 can operate more than once.
- 3.7 If the purchaser *serves* a replacement *deposit-bond*, the vendor must *serve* the earlier *deposit-bond*.
- 3.8 The amount of any *deposit-bond* does not form part of the price for the purposes of clause 16.7.
- 3.9 The vendor must give the purchaser the *deposit-bond* –
 - 3.9.1 on completion; or
 - 3.9.2 if this contract is *rescinded*.
- 3.10 If this contract is *terminated* by the vendor –
 - 3.10.1 *normally*, the vendor can immediately demand payment from the issuer of the *deposit-bond*; or
 - 3.10.2 if the purchaser *serves* prior to *termination* a notice disputing the vendor's right to *terminate*, the vendor must forward the *deposit-bond* (or its proceeds if called up) to the *depositholder* as stakeholder.
- 3.11 If this contract is *terminated* by the purchaser –
 - 3.11.1 *normally*, the vendor must give the purchaser the *deposit-bond*; or
 - 3.11.2 if the vendor *serves* prior to *termination* a notice disputing the purchaser's right to *terminate*, the vendor must forward the *deposit-bond* (or its proceeds if called up) to the *depositholder* as stakeholder.

4 Transfer

- 4.1 *Normally*, the purchaser must *serve* at least 14 days before the date for completion –
 - 4.1.1 the form of transfer; and
 - 4.1.2 particulars required to register any mortgage or other dealing to be lodged with the transfer by the purchaser or the purchaser's mortgagee.
- 4.2 If any information needed for the form of transfer is not disclosed in this contract, the vendor must *serve* it.
- 4.3 If the purchaser *serves* a form of transfer and the transferee is not the purchaser, the purchaser must give the vendor a direction signed by the purchaser personally for this form of transfer.
- 4.4 The vendor can require the purchaser to include a form of covenant or easement in the transfer only if this contract contains the wording of the proposed covenant or easement, and a description of the land benefited.

5 Requisitions

- 5.1 If a form of *requisitions* is attached to this contract, the purchaser is taken to have made those *requisitions*.
- 5.2 If the purchaser is or becomes entitled to make any other *requisition*, the purchaser can make it only by *serving* it –
 - 5.2.1 if it arises out of this contract or it is a general question about the *property* or title - *within* 21 days after the contract date;
 - 5.2.2 if it arises out of anything *served* by the vendor - *within* 21 days after the later of the contract date and that *service*; and
 - 5.2.3 in any other case - *within* a reasonable time.

6 Error or misdescription

- 6.1 *Normally*, the purchaser can (but only before completion) claim compensation for an error or misdescription in this contract (as to the *property*, the title or anything else and whether substantial or not).
- 6.2 This clause applies even if the purchaser did not take notice of or rely on anything in this contract containing or giving rise to the error or misdescription.
- 6.3 However, this clause does not apply to the extent the purchaser knows the true position.

7 Claims by purchaser

Normally, the purchaser can make a claim (including a claim under clause 6) before completion only by *serving* it with a statement of the amount claimed, and if the purchaser makes one or more claims before completion –

- 7.1 the vendor can *rescind* if in the case of claims that are not claims for delay –
 - 7.1.1 the total amount claimed exceeds 5% of the price;
 - 7.1.2 the vendor *serves* notice of intention to *rescind*; and
 - 7.1.3 the purchaser does not *serve* notice waiving the claims *within* 14 days after that *service*; and
- 7.2 if the vendor does not *rescind*, the *parties* must complete and if this contract is completed –
 - 7.2.1 the lesser of the total amount claimed and 10% of the price must be paid out of the price to and held by the *depositholder* until the claims are finalised or lapse;
 - 7.2.2 the amount held is to be invested in accordance with clause 2.9;
 - 7.2.3 the claims must be finalised by an arbitrator appointed by the *parties* or, if an appointment is not made *within* 1 month of completion, by an arbitrator appointed by the President of the Law Society at the request of a *party* (in the latter case the *parties* are bound by the terms of the Conveyancing Arbitration Rules approved by the Law Society as at the date of the appointment);
 - 7.2.4 the purchaser is not entitled, in respect of the claims, to more than the total amount claimed and the costs of the purchaser;
 - 7.2.5 net interest on the amount held must be paid to the *parties* in the same proportion as the amount held is paid; and
 - 7.2.6 if the *parties* do not appoint an arbitrator and neither *party* requests the President to appoint an arbitrator *within* 3 months after completion, the claims lapse and the amount belongs to the vendor.

8 Vendor's rights and obligations

- 8.1 The vendor can *rescind* if –
 - 8.1.1 the vendor is, on reasonable grounds, unable or unwilling to comply with a *requisition*;
 - 8.1.2 the vendor *serves* a notice of intention to *rescind* that specifies the *requisition* and those grounds; and
 - 8.1.3 the purchaser does not *serve* a notice waiving the *requisition* *within* 14 days after that *service*.
- 8.2 If the vendor does not comply with this contract (or a notice under or relating to it) in an essential respect, the purchaser can *terminate* by *serving* a notice. After the *termination* –
 - 8.2.1 the purchaser can recover the deposit and any other money paid by the purchaser under this contract;
 - 8.2.2 the purchaser can sue the vendor to recover damages for breach of contract; and
 - 8.2.3 if the purchaser has been in possession a *party* can claim for a reasonable adjustment.

9 Purchaser's default

If the purchaser does not comply with this contract (or a notice under or relating to it) in an essential respect, the vendor can *terminate* by *serving* a notice. After the *termination* the vendor can –

- 9.1 keep or recover the deposit (to a maximum of 10% of the price);
- 9.2 hold any other money paid by the purchaser under this contract as security for anything recoverable under this clause –
 - 9.2.1 for 12 months after the *termination*; or
 - 9.2.2 if the vendor commences proceedings under this clause *within* 12 months, until those proceedings are concluded; and
- 9.3 sue the purchaser either –
 - 9.3.1 where the vendor has resold the *property* under a contract made *within* 12 months after the *termination*, to recover –
 - the deficiency on resale (with credit for any of the deposit kept or recovered and after allowance for any capital gains tax or goods and services tax payable on anything recovered under this clause); and
 - the reasonable costs and expenses arising out of the purchaser's non-compliance with this contract or the notice and of resale and any attempted resale; or
 - 9.3.2 to recover damages for breach of contract.

10 Restrictions on rights of purchaser

- 10.1 The purchaser cannot make a claim or *requisition* or *rescind* or *terminate* in respect of –
 - 10.1.1 the ownership or location of any fence as defined in the Dividing Fences Act 1991;
 - 10.1.2 a service for the *property* being a joint service or passing through another property, or any service for another property passing through the *property* ('service' includes air, communication, drainage, electricity, garbage, gas, oil, radio, sewerage, telephone, television or water service);
 - 10.1.3 a wall being or not being a party wall in any sense of that term or the *property* being affected by an easement for support or not having the benefit of an easement for support;
 - 10.1.4 any change in the *property* due to fair wear and tear before completion;
 - 10.1.5 a promise, representation or statement about this contract, the *property* or the title, not set out or referred to in this contract;
 - 10.1.6 a condition, exception, reservation or restriction in a Crown grant;

- 10.1.7 the existence of any authority or licence to explore or prospect for gas, minerals or petroleum;
- 10.1.8 any easement or restriction on use the substance of either of which is disclosed in this contract or any non-compliance with the easement or restriction on use; or
- 10.1.9 anything the substance of which is disclosed in this contract (except a caveat, charge, mortgage, priority notice or writ).
- 10.2 The purchaser cannot *rescind* or *terminate* only because of a defect in title to or quality of the inclusions.
- 10.3 *Normally*, the purchaser cannot make a claim or *requisition* or *rescind* or *terminate* or require the vendor to change the nature of the title disclosed in this contract (for example, to remove a caution evidencing qualified title, or to lodge a plan of survey as regards limited title).
- 11 Compliance with work orders**
- 11.1 *Normally*, the vendor must by completion comply with a *work order* made on or before the contract date and if this contract is completed the purchaser must comply with any other *work order*.
- 11.2 If the purchaser complies with a *work order*, and this contract is *rescinded* or *terminated*, the vendor must pay the expense of compliance to the purchaser.
- 12 Certificates and inspections**
- The vendor must do everything reasonable to enable the purchaser, subject to the rights of any tenant –
- 12.1 to have the *property* inspected to obtain any certificate or report reasonably required;
- 12.2 to apply (if necessary in the name of the vendor) for –
- 12.2.1 any certificate that can be given in respect of the *property* under *legislation*; or
- 12.2.2 a copy of any approval, certificate, consent, direction, notice or order in respect of the *property* given under *legislation*, even if given after the contract date; and
- 12.3 to make 1 inspection of the *property* in the 3 days before a time appointed for completion.
- 13 Goods and services tax (GST)**
- 13.1 Terms used in this clause which are not defined elsewhere in this contract and have a defined meaning in the *GST Act* have the same meaning in this clause.
- 13.2 *Normally*, if a *party* must pay the price or any other amount to the other *party* under this contract, GST is not to be added to the price or amount.
- 13.3 If under this contract a *party* must make an adjustment or payment for an expense of another party or pay an expense payable by or to a third party (for example, under clauses 14 or 20.7) –
- 13.3.1 the *party* must adjust or pay on completion any GST added to or included in the expense; but
- 13.3.2 the amount of the expense must be reduced to the extent the party receiving the adjustment or payment (or the representative member of a GST group of which that party is a member) is entitled to an input tax credit for the expense; and
- 13.3.3 if the adjustment or payment under this contract is consideration for a taxable supply, an amount for GST must be added at the *GST rate*.
- 13.4 If this contract says this sale is the supply of a going concern –
- 13.4.1 the *parties* agree the supply of the *property* is a supply of a going concern;
- 13.4.2 the vendor must, between the contract date and completion, carry on the enterprise conducted on the land in a proper and business-like way;
- 13.4.3 if the purchaser is not registered by the date for completion, the *parties* must complete and the purchaser must pay on completion, in addition to the price, an amount being the price multiplied by the *GST rate* ("the retention sum"). The retention sum is to be held by the *depositholder* and dealt with as follows –
- if *within* 3 months of completion the purchaser *serves* a letter from the Australian Taxation Office stating the purchaser is registered with a date of effect of registration on or before completion, the *depositholder* is to pay the retention sum to the purchaser; but
 - if the purchaser does not *serve* that letter *within* 3 months of completion, the *depositholder* is to pay the retention sum to the vendor; and
- 13.4.4 if the vendor, despite clause 13.4.1, *serves* a letter from the Australian Taxation Office stating the vendor has to pay GST on the supply, the purchaser must pay to the vendor on demand the amount of GST assessed.
- 13.5 *Normally*, the vendor promises the margin scheme will not apply to the supply of the *property*.
- 13.6 If this contract says the margin scheme is to apply in making the taxable supply, the *parties* agree that the margin scheme is to apply to the sale of the *property*.
- 13.7 If this contract says the sale is not a taxable supply –
- 13.7.1 the purchaser promises that the *property* will not be used and represents that the purchaser does not intend the *property* (or any part of the *property*) to be used in a way that could make the sale a taxable supply to any extent; and
- 13.7.2 the purchaser must pay the vendor on completion in addition to the price an amount calculated by multiplying the price by the *GST rate* if this sale is a taxable supply to any extent because of –
- a breach of clause 13.7.1; or
 - something else known to the purchaser but not the vendor.
- 13.8 If this contract says this sale is a taxable supply in full and does not say the margin scheme applies to the *property*, the vendor must pay the purchaser on completion an amount of one-eleventh of the price if –

- 13.8.1 this sale is not a taxable supply in full; or
 13.8.2 the margin scheme applies to the *property* (or any part of the *property*).
- 13.9 If this contract says this sale is a taxable supply to an extent –
 13.9.1 clause 13.7.1 does not apply to any part of the *property* which is identified as being a taxable supply; and
 13.9.2 the payments mentioned in clauses 13.7 and 13.8 are to be recalculated by multiplying the relevant payment by the proportion of the price which represents the value of that part of the *property* to which the clause applies (the proportion to be expressed as a number between 0 and 1). Any evidence of value must be obtained at the expense of the vendor.
- 13.10 *Normally*, on completion the vendor must give the recipient of the supply a tax invoice for any taxable supply by the vendor by or under this contract.
- 13.11 The vendor does not have to give the purchaser a tax invoice if the margin scheme applies to a taxable supply.
- 13.12 If the vendor is liable for GST on rents or profits due to issuing an invoice or receiving consideration before completion, any adjustment of those amounts must exclude an amount equal to the vendor's GST liability.
- 13.13 If the purchaser must make a *GSTRW payment* the purchaser must –
 13.13.1 at least 5 days before the date for completion, *serve* evidence of submission of a *GSTRW payment* notification form to the Australian Taxation Office by the purchaser or, if a direction under clause 4.3 has been *served*, by the transferee named in the transfer *served* with that direction;
 13.13.2 produce on completion a *settlement cheque* for the *GSTRW payment* payable to the Deputy Commissioner of Taxation;
 13.13.3 forward the *settlement cheque* to the payee immediately after completion; and
 13.13.4 *serve* evidence of receipt of payment of the *GSTRW payment* and a copy of the settlement date confirmation form submitted to the Australian Taxation Office.

14 Adjustments

- 14.1 *Normally*, the vendor is entitled to the rents and profits and will be liable for all rates, water, sewerage and drainage service and usage charges, land tax, levies and all other periodic outgoings up to and including the *adjustment date* after which the purchaser will be entitled and liable.
- 14.2 The *parties* must make any necessary adjustment on completion.
- 14.3 If an amount that is adjustable under this contract has been reduced under *legislation*, the *parties* must on completion adjust the reduced amount.
- 14.4 The *parties* must not adjust surcharge land tax (as defined in the Land Tax Act 1956) but must adjust any other land tax for the year current at the *adjustment date* –
 14.4.1 only if land tax has been paid or is payable for the year (whether by the vendor or by a predecessor in title) and this contract says that land tax is adjustable;
 14.4.2 by adjusting the amount that would have been payable if at the start of the year –
 • the person who owned the land owned no other land;
 • the land was not subject to a special trust or owned by a non-concessional company; and
 • if the land (or part of it) had no separate taxable value, by calculating its separate taxable value on a proportional area basis.
- 14.5 If any other amount that is adjustable under this contract relates partly to the land and partly to other land, the *parties* must adjust it on a proportional area basis.
- 14.6 *Normally*, the vendor can direct the purchaser to produce a *settlement cheque* on completion to pay an amount adjustable under this contract and if so –
 14.6.1 the amount is to be treated as if it were paid; and
 14.6.2 the *cheque* must be forwarded to the payee immediately after completion (by the purchaser if the *cheque* relates only to the *property* or by the vendor in any other case).
- 14.7 If on completion the last bill for a water, sewerage or drainage usage charge is for a period ending before the *adjustment date*, the vendor is liable for an amount calculated by dividing the bill by the number of days in the period then multiplying by the number of unbilled days up to and including the *adjustment date*.
- 14.8 The vendor is liable for any amount recoverable for work started on or before the contract date on the *property* or any adjoining footpath or road.

15 Date for completion

The *parties* must complete by the date for completion and, if they do not, a *party* can serve a notice to complete if that *party* is otherwise entitled to do so.

16 Completion

• Vendor

- 16.1 On completion the vendor must give the purchaser any *document of title* that relates only to the *property*.
- 16.2 If on completion the vendor has possession or control of a *document of title* that relates also to other property, the vendor must produce it as and where necessary.
- 16.3 *Normally*, on completion the vendor must cause the legal title to the *property* (being an estate in fee simple) to pass to the purchaser free of any mortgage or other interest, subject to any necessary registration.
- 16.4 The legal title to the *property* does not pass before completion.

- 16.5 If the vendor gives the purchaser a document (other than the transfer) that needs to be lodged for registration, the vendor must pay the lodgment fee to the purchaser.
- 16.6 If a *party serves* a land tax certificate showing a charge on any of the land, by completion the vendor must do all things and pay all money required so that the charge is no longer effective against the land.
- **Purchaser**
- 16.7 On completion the purchaser must pay to the vendor, by cash (up to \$2,000) or *settlement cheque* –
- 16.7.1 the price less any:
- deposit paid;
 - *FRCGW remittance* payable;
 - *GSTRW payment*; and
 - amount payable by the vendor to the purchaser under this contract; and
- 16.7.2 any other amount payable by the purchaser under this contract.
- 16.8 If the vendor requires more than 5 *settlement cheques*, the vendor must pay \$10 for each extra *cheque*.
- 16.9 If any of the deposit is not covered by a bond or guarantee, on completion the purchaser must give the vendor an order signed by the purchaser authorising the *depositholder* to account to the vendor for the deposit.
- 16.10 On completion the deposit belongs to the vendor.
- **Place for completion**
- 16.11 *Normally*, the *parties* must complete at the completion address, which is –
- 16.11.1 if a special completion address is stated in this contract - that address; or
- 16.11.2 if none is stated, but a first mortgagee is disclosed in this contract and the mortgagee would usually discharge the mortgage at a particular place - that place; or
- 16.11.3 in any other case - the vendor's *solicitor's* address stated in this contract.
- 16.12 The vendor by reasonable notice can require completion at another place, if it is in NSW, but the vendor must pay the purchaser's additional expenses, including any agency or mortgagee fee.
- 16.13 If the purchaser requests completion at a place that is not the completion address, and the vendor agrees, the purchaser must pay the vendor's additional expenses, including any agency or mortgagee fee.
- 17 Possession**
- 17.1 *Normally*, the vendor must give the purchaser vacant possession of the *property* on completion.
- 17.2 The vendor does not have to give vacant possession if –
- 17.2.1 this contract says that the sale is subject to existing tenancies; and
- 17.2.2 the contract discloses the provisions of the tenancy (for example, by attaching a copy of the lease and any relevant memorandum or variation).
- 17.3 *Normally*, the purchaser can claim compensation (before or after completion) or *rescind* if any of the land is affected by a protected tenancy (a tenancy affected by Schedule 2, Part 7 of the Residential Tenancies Act 2010).
- 18 Possession before completion**
- 18.1 This clause applies only if the vendor gives the purchaser possession of the *property* before completion.
- 18.2 The purchaser must not before completion –
- 18.2.1 let or part with possession of any of the *property*;
- 18.2.2 make any change or structural alteration or addition to the *property*; or
- 18.2.3 contravene any agreement between the *parties* or any direction, document, *legislation*, notice or order affecting the *property*.
- 18.3 The purchaser must until completion –
- 18.3.1 keep the *property* in good condition and repair having regard to its condition at the giving of possession; and
- 18.3.2 allow the vendor or the vendor's authorised representative to enter and inspect it at all reasonable times.
- 18.4 The risk as to damage to the *property* passes to the purchaser immediately after the purchaser enters into possession.
- 18.5 If the purchaser does not comply with this clause, then without affecting any other right of the vendor –
- 18.5.1 the vendor can before completion, without notice, remedy the non-compliance; and
- 18.5.2 if the vendor pays the expense of doing this, the purchaser must pay it to the vendor with interest at the rate prescribed under s101 Civil Procedure Act 2005.
- 18.6 If this contract is *rescinded* or *terminated* the purchaser must immediately vacate the *property*.
- 18.7 If the *parties* or their *solicitors* on their behalf do not agree in writing to a fee or rent, none is payable.
- 19 Rescission of contract**
- 19.1 If this contract expressly gives a *party* a right to *rescind*, the *party* can exercise the right –
- 19.1.1 only by *serving* a notice before completion; and
- 19.1.2 in spite of any making of a claim or *requisition*, any attempt to satisfy a claim or *requisition*, any arbitration, litigation, mediation or negotiation or any giving or taking of possession.
- 19.2 *Normally*, if a *party* exercises a right to *rescind* expressly given by this contract or any *legislation* –
- 19.2.1 the deposit and any other money paid by the purchaser under this contract must be refunded;
- 19.2.2 a *party* can claim for a reasonable adjustment if the purchaser has been in possession;
- 19.2.3 a *party* can claim for damages, costs or expenses arising out of a breach of this contract; and
- 19.2.4 a *party* will not otherwise be liable to pay the other *party* any damages, costs or expenses.

20 Miscellaneous

- 20.1 The *parties* acknowledge that anything stated in this contract to be attached was attached to this contract by the vendor before the purchaser signed it and is part of this contract.
- 20.2 Anything attached to this contract is part of this contract.
- 20.3 An area, bearing or dimension in this contract is only approximate.
- 20.4 If a *party* consists of 2 or more persons, this contract benefits and binds them separately and together.
- 20.5 A *party's solicitor* can receive any amount payable to the *party* under this contract or direct in writing that it is to be paid to another person.
- 20.6 A document under or relating to this contract is –
- 20.6.1 signed by a *party* if it is signed by the *party* or the *party's solicitor* (apart from a direction under clause 4.3);
 - 20.6.2 served if it is served by the *party* or the *party's solicitor*;
 - 20.6.3 served if it is served on the *party's solicitor*, even if the *party* has died or any of them has died;
 - 20.6.4 served if it is served in any manner provided in s170 of the Conveyancing Act 1919;
 - 20.6.5 served if it is sent by email or fax to the *party's solicitor*, unless in either case it is not received;
 - 20.6.6 served on a person if it (or a copy of it) comes into the possession of the person; and
 - 20.6.7 served at the earliest time it is served, if it is served more than once.
- 20.7 An obligation to pay an expense of another *party* of doing something is an obligation to pay –
- 20.7.1 if the *party* does the thing personally - the reasonable cost of getting someone else to do it; or
 - 20.7.2 if the *party* pays someone else to do the thing - the amount paid, to the extent it is reasonable.
- 20.8 Rights under clauses 11, 13, 14, 17, 24, 30 and 31 continue after completion, whether or not other rights continue.
- 20.9 The vendor does not promise, represent or state that the purchaser has any cooling off rights.
- 20.10 The vendor does not promise, represent or state that any attached survey report is accurate or current.
- 20.11 A reference to any *legislation* (including any percentage or rate specified in *legislation*) is also a reference to any corresponding later *legislation*.
- 20.12 Each *party* must do whatever is necessary after completion to carry out the *party's* obligations under this contract.
- 20.13 Neither taking possession nor *serving* a transfer of itself implies acceptance of the *property* or the title.
- 20.14 The details and information provided in this contract (for example, on pages 1 - 3) are, to the extent of each *party's* knowledge, true, and are part of this contract.
- 20.15 Where this contract provides for choices, a choice in BLOCK CAPITALS applies unless a different choice is marked.

21 Time limits in these provisions

- 21.1 If the time for something to be done or to happen is not stated in these provisions, it is a reasonable time.
- 21.2 If there are conflicting times for something to be done or to happen, the latest of those times applies.
- 21.3 The time for one thing to be done or to happen does not extend the time for another thing to be done or to happen.
- 21.4 If the time for something to be done or to happen is the 29th, 30th or 31st day of a month, and the day does not exist, the time is instead the last day of the month.
- 21.5 If the time for something to be done or to happen is a day that is not a *business day*, the time is extended to the next *business day*, except in the case of clauses 2 and 3.2.
- 21.6 *Normally*, the time by which something must be done is fixed but not essential.

22 Foreign Acquisitions and Takeovers Act 1975

- 22.1 The purchaser promises that the Commonwealth Treasurer cannot prohibit and has not prohibited the transfer under the Foreign Acquisitions and Takeovers Act 1975.
- 22.2 This promise is essential and a breach of it entitles the vendor to *terminate*.

23 Strata or community title**• Definitions and modifications**

- 23.1 This clause applies only if the land (or part of it) is a lot in a strata, neighbourhood, precinct or community scheme (or on completion is to be a lot in a scheme of that kind).
- 23.2 In this contract –
- 23.2.1 'change', in relation to a scheme, means –
 - a registered or registrable change from by-laws set out in this contract;
 - a change from a development or management contract or statement set out in this contract; or
 - a change in the boundaries of common property;
 - 23.2.2 'common property' includes association property for the scheme or any higher scheme;
 - 23.2.3 'contribution' includes an amount payable under a by-law;
 - 23.2.4 'information certificate' includes a certificate under s184 Strata Schemes Management Act 2015 and s26 Community Land Management Act 1989;
 - 23.2.5 'information notice' includes a strata information notice under s22 Strata Schemes Management Act 2015 and a notice under s47 Community Land Management Act 1989;

- 23.2.6 'normal expenses', in relation to an owners corporation for a scheme, means normal operating expenses usually payable from the administrative fund of an owners corporation for a scheme of the same kind;
- 23.2.7 'owners corporation' means the owners corporation or the association for the scheme or any higher scheme;
- 23.2.8 'the *property*' includes any interest in common property for the scheme associated with the lot; and
- 23.2.9 'special expenses', in relation to an owners corporation, means its actual, contingent or expected expenses, except to the extent they are –
- normal expenses;
 - due to fair wear and tear;
 - disclosed in this contract; or
 - covered by moneys held in the capital works fund.
- 23.3 Clauses 11, 14.8 and 18.4 do not apply to an obligation of the owners corporation, or to property insurable by it.
- 23.4 Clauses 14.4.2 and 14.5 apply but on a unit entitlement basis instead of an area basis.
- **Adjustments and liability for expenses**
- 23.5 The *parties* must adjust under clause 14.1 –
- 23.5.1 a regular periodic contribution;
- 23.5.2 a contribution which is not a regular periodic contribution but is disclosed in this contract; and
- 23.5.3 on a unit entitlement basis, any amount paid by the vendor for a normal expense of the owners corporation to the extent the owners corporation has not paid the amount to the vendor.
- 23.6 If a contribution is not a regular periodic contribution and is not disclosed in this contract –
- 23.6.1 the vendor is liable for it if it was determined on or before the contract date, even if it is payable by instalments; and
- 23.6.2 the purchaser is liable for all contributions determined after the contract date.
- 23.7 The vendor must pay or allow to the purchaser on completion the amount of any unpaid contributions for which the vendor is liable under clause 23.6.1.
- 23.8 *Normally*, the purchaser cannot make a claim or *requisition* or *rescind* or *terminate* in respect of –
- 23.8.1 an existing or future actual, contingent or expected expense of the owners corporation;
- 23.8.2 a proportional unit entitlement of the lot or a relevant lot or former lot, apart from a claim under clause 6; or
- 23.8.3 a past or future change in the scheme or a higher scheme.
- 23.9 However, the purchaser can *rescind* if –
- 23.9.1 the special expenses of the owners corporation at the later of the contract date and the creation of the owners corporation when calculated on a unit entitlement basis (and, if more than one lot or a higher scheme is involved, added together), less any contribution paid by the vendor, are more than 1% of the price;
- 23.9.2 in the case of the lot or a relevant lot or former lot in a higher scheme, a proportional unit entitlement for the lot is disclosed in this contract but the lot has a different proportional unit entitlement at the contract date or at any time before completion;
- 23.9.3 a change before the contract date or before completion in the scheme or a higher scheme materially prejudices the purchaser and is not disclosed in this contract; or
- 23.9.4 a resolution is passed by the owners corporation before the contract date or before completion to give to the owners in the scheme for their consideration a strata renewal plan that has not lapsed at the contract date and there is not attached to this contract a strata renewal proposal or the strata renewal plan.
- **Notices, certificates and inspections**
- 23.10 The purchaser must give the vendor 2 copies of an information notice addressed to the owners corporation and signed by the purchaser.
- 23.11 The vendor must complete and sign 1 copy of the notice and give it to the purchaser on completion.
- 23.12 Each *party* can sign and give the notice as agent for the other.
- 23.13 The vendor must *serve* an information certificate issued after the contract date in relation to the lot, the scheme or any higher scheme at least 7 days before the date for completion.
- 23.14 The purchaser does not have to complete earlier than 7 days after *service* of the certificate and clause 21.3 does not apply to this provision. On completion the purchaser must pay the vendor the prescribed fee for the certificate.
- 23.15 The vendor authorises the purchaser to apply for the purchaser's own certificate.
- 23.16 The vendor authorises the purchaser to apply for and make an inspection of any record or other document in the custody or control of the owners corporation or relating to the scheme or any higher scheme.
- **Meetings of the owners corporation**
- 23.17 If a general meeting of the owners corporation is convened before completion –
- 23.17.1 if the vendor receives notice of it, the vendor must immediately notify the purchaser of it; and
- 23.17.2 after the expiry of any cooling off period, the purchaser can require the vendor to appoint the purchaser (or the purchaser's nominee) to exercise any voting rights of the vendor in respect of the lot at the meeting.

24 Tenancies

- 24.1 If a tenant has not made a payment for a period preceding or current at the *adjustment date* –
- 24.1.1 for the purposes of clause 14.2, the amount is to be treated as if it were paid; and
- 24.1.2 the purchaser assigns the debt to the vendor on completion and will if required give a further assignment at the vendor's expense.
- 24.2 If a tenant has paid in advance of the *adjustment date* any periodic payment in addition to rent, it must be adjusted as if it were rent for the period to which it relates.
- 24.3 If the *property* is to be subject to a tenancy on completion or is subject to a tenancy on completion –
- 24.3.1 the vendor authorises the purchaser to have any accounting records relating to the tenancy inspected and audited and to have any other document relating to the tenancy inspected;
- 24.3.2 the vendor must *serve* any information about the tenancy reasonably requested by the purchaser before or after completion; and
- 24.3.3 *normally*, the purchaser can claim compensation (before or after completion) if –
- a disclosure statement required by the Retail Leases Act 1994 was not given when required;
 - such a statement contained information that was materially false or misleading;
 - a provision of the lease is not enforceable because of a non-disclosure in such a statement; or
 - the lease was entered into in contravention of the Retail Leases Act 1994.
- 24.4 If the *property* is subject to a tenancy on completion –
- 24.4.1 the vendor must allow or transfer –
- any remaining bond money or any other security against the tenant's default (to the extent the security is transferable);
 - any money in a fund established under the lease for a purpose and compensation for any money in the fund or interest earned by the fund that has been applied for any other purpose; and
 - any money paid by the tenant for a purpose that has not been applied for that purpose and compensation for any of the money that has been applied for any other purpose;
- 24.4.2 if the security is not transferable, each *party* must do everything reasonable to cause a replacement security to issue for the benefit of the purchaser and the vendor must hold the original security on trust for the benefit of the purchaser until the replacement security issues;
- 24.4.3 the vendor must give to the purchaser –
- a proper notice of the transfer (an attornment notice) addressed to the tenant;
 - any certificate given under the Retail Leases Act 1994 in relation to the tenancy;
 - a copy of any disclosure statement given under the Retail Leases Act 1994;
 - a copy of any document served on the tenant under the lease and written details of its service, if the document concerns the rights of the landlord or the tenant after completion; and
 - any document served by the tenant under the lease and written details of its service, if the document concerns the rights of the landlord or the tenant after completion;
- 24.4.4 the vendor must comply with any obligation to the tenant under the lease, to the extent it is to be complied with by completion; and
- 24.4.5 the purchaser must comply with any obligation to the tenant under the lease, to the extent that the obligation is disclosed in this contract and is to be complied with after completion.

25 Qualified title, limited title and old system title

- 25.1 This clause applies only if the land (or part of it) –
- 25.1.1 is under qualified, limited or old system title; or
- 25.1.2 on completion is to be under one of those titles.
- 25.2 The vendor must *serve* a proper abstract of title *within 7 days* after the contract date.
- 25.3 If an abstract of title or part of an abstract of title is attached to this contract or has been lent by the vendor to the purchaser before the contract date, the abstract or part is *served* on the contract date.
- 25.4 An abstract of title can be or include a list of documents, events and facts arranged (apart from a will or codicil) in date order, if the list in respect of each document –
- 25.4.1 shows its date, general nature, names of parties and any registration number; and
- 25.4.2 has attached a legible photocopy of it or of an official or registration copy of it.
- 25.5 An abstract of title –
- 25.5.1 must start with a good root of title (if the good root of title must be at least 30 years old, this means 30 years old at the contract date);
- 25.5.2 in the case of a leasehold interest, must include an abstract of the lease and any higher lease;
- 25.5.3 *normally*, need not include a Crown grant; and
- 25.5.4 need not include anything evidenced by the Register kept under the Real Property Act 1900.
- 25.6 In the case of land under old system title –
- 25.6.1 in this contract 'transfer' means conveyance;
- 25.6.2 the purchaser does not have to *serve* the form of transfer until after the vendor has *served* a proper abstract of title; and
- 25.6.3 each vendor must give proper covenants for title as regards that vendor's interest.
- 25.7 In the case of land under limited title but not under qualified title –

- 25.7.1 normally, the abstract of title need not include any document which does not show the location, area or dimensions of the land (for example, by including a metes and bounds description or a plan of the land);
- 25.7.2 clause 25.7.1 does not apply to a document which is the good root of title; and
- 25.7.3 the vendor does not have to provide an abstract if this contract contains a delimitation plan (whether in registrable form or not).
- 25.8 The vendor must give a proper covenant to produce where relevant.
- 25.9 The vendor does not have to produce or covenant to produce a document that is not in the possession of the vendor or a mortgagee.
- 25.10 If the vendor is unable to produce an original document in the chain of title, the purchaser will accept a photocopy from the Registrar-General of the registration copy of that document.
- 26 Crown purchase money**
- 26.1 This clause applies only if purchase money is payable to the Crown, whether or not due for payment.
- 26.2 The vendor is liable for the money, except to the extent this contract says the purchaser is liable for it.
- 26.3 To the extent the vendor is liable for it, the vendor is liable for any interest until completion.
- 26.4 To the extent the purchaser is liable for it, the *parties* must adjust any interest under clause 14.1.
- 27 Consent to transfer**
- 27.1 This clause applies only if the land (or part of it) cannot be transferred without consent under *legislation* or a *planning agreement*.
- 27.2 The purchaser must properly complete and then *serve* the purchaser's part of an application for consent to transfer of the land (or part of it) *within 7 days* after the contract date.
- 27.3 The vendor must apply for consent *within 7 days* after *service* of the purchaser's part.
- 27.4 If consent is refused, either *party* can *rescind*.
- 27.5 If consent is given subject to one or more conditions that will substantially disadvantage a *party*, then that *party* can *rescind within 7 days* after receipt by or *service* upon the *party* of written notice of the conditions.
- 27.6 If consent is not given or refused –
- 27.6.1 *within 42 days* after the purchaser *serves* the purchaser's part of the application, the purchaser can *rescind*; or
- 27.6.2 *within 30 days* after the application is made, either *party* can *rescind*.
- 27.7 Each period in clause 27.6 becomes 90 days if the land (or part of it) is –
- 27.7.1 under a *planning agreement*; or
- 27.7.2 in the Western Division.
- 27.8 If the land (or part of it) is described as a lot in an unregistered plan, each time in clause 27.6 becomes the later of the time and 35 days after creation of a separate folio for the lot.
- 27.9 The date for completion becomes the later of the date for completion and 14 days after *service* of the notice granting consent to transfer.
- 28 Unregistered plan**
- 28.1 This clause applies only if some of the land is described as a lot in an unregistered plan.
- 28.2 The vendor must do everything reasonable to have the plan registered *within 6 months* after the contract date, with or without any minor alteration to the plan or any document to be lodged with the plan validly required or made under *legislation*.
- 28.3 If the plan is not registered *within* that time and in that manner –
- 28.3.1 the purchaser can *rescind*; and
- 28.3.2 the vendor can *rescind*, but only if the vendor has complied with clause 28.2 and with any *legislation* governing the rescission.
- 28.4 Either *party* can *serve* notice of the registration of the plan and every relevant lot and plan number.
- 28.5 The date for completion becomes the later of the date for completion and 21 days after *service* of the notice.
- 28.6 Clauses 28.2 and 28.3 apply to another plan that is to be registered before the plan is registered.
- 29 Conditional contract**
- 29.1 This clause applies only if a provision says this contract or completion is conditional on an event.
- 29.2 If the time for the event to happen is not stated, the time is 42 days after the contract date.
- 29.3 If this contract says the provision is for the benefit of a *party*, then it benefits only that *party*.
- 29.4 If anything is necessary to make the event happen, each *party* must do whatever is reasonably necessary to cause the event to happen.
- 29.5 A *party* can *rescind* under this clause only if the *party* has substantially complied with clause 29.4.
- 29.6 If the event involves an approval and the approval is given subject to a condition that will substantially disadvantage a *party* who has the benefit of the provision, the *party* can *rescind within 7 days* after either *party* *serves* notice of the condition.
- 29.7 If the *parties* can lawfully complete without the event happening –
- 29.7.1 if the event does not happen *within* the time for it to happen, a *party* who has the benefit of the provision can *rescind within 7 days* after the end of that time;
- 29.7.2 if the event involves an approval and an application for the approval is refused, a *party* who has the benefit of the provision can *rescind within 7 days* after either *party* *serves* notice of the refusal; and

- 29.7.3 the date for completion becomes the later of the date for completion and 21 days after the earliest of –
- either *party serving* notice of the event happening;
 - every *party* who has the benefit of the provision *serving* notice waiving the provision; or
 - the end of the time for the event to happen.
- 29.8 If the *parties* cannot lawfully complete without the event happening –
- 29.8.1 if the event does not happen *within* the time for it to happen, either *party* can *rescind*;
- 29.8.2 if the event involves an approval and an application for the approval is refused, either *party* can *rescind*;
- 29.8.3 the date for completion becomes the later of the date for completion and 21 days after either *party* serves notice of the event happening.
- 29.9 A *party* cannot *rescind* under clauses 29.7 or 29.8 after the event happens.
- 30 Electronic transaction**
- 30.1 This *Conveyancing Transaction* is to be conducted as an *electronic transaction* if –
- 30.1.1 this contract says that it is an *electronic transaction*;
- 30.1.2 the *parties* otherwise agree that it is to be conducted as an *electronic transaction*; or
- 30.1.3 the *conveyancing rules* require it to be conducted as an *electronic transaction*.
- 30.2 However, this *Conveyancing Transaction* is not to be conducted as an *electronic transaction* –
- 30.2.1 if the land is not *electronically tradeable* or the transfer is not eligible to be lodged electronically; or
- 30.2.2 if, at any time after the *effective date*, but at least 14 days before the date for completion, a *party* serves a notice stating a valid reason why it cannot be conducted as an *electronic transaction*.
- 30.3 If, because of clause 30.2.2, this *Conveyancing Transaction* is not to be conducted as an *electronic transaction* –
- 30.3.1 each *party* must –
- bear equally any disbursements or fees; and
 - otherwise bear that *party's* own costs;
- incurred because this *Conveyancing Transaction* was to be conducted as an *electronic transaction*; and
- 30.3.2 if a *party* has paid all of a disbursement or fee which, by reason of this clause, is to be borne equally by the *parties*, that amount must be adjusted under clause 14.2.
- 30.4 If this *Conveyancing Transaction* is to be conducted as an *electronic transaction* –
- 30.4.1 to the extent that any other provision of this contract is inconsistent with this clause, the provisions of this clause prevail;
- 30.4.2 *normally*, words and phrases used in this clause 30 (italicised and in Title Case, such as *Electronic Workspace* and *Lodgment Case*) have the same meaning which they have in the *participation rules*;
- 30.4.3 the *parties* must conduct the *electronic transaction* –
- in accordance with the *participation rules* and the *ECNL*; and
 - using the nominated *ELN*, unless the *parties* otherwise agree;
- 30.4.4 a *party* must pay the fees and charges payable by that *party* to the *ELNO* and the *Land Registry* as a result of this transaction being an *electronic transaction*;
- 30.4.5 any communication from one *party* to another *party* in the *Electronic Workspace* made –
- after the *effective date*; and
 - before the receipt of a notice given under clause 30.2.2;
- is taken to have been received by that *party* at the time determined by s13A of the *Electronic Transactions Act 2000*; and
- 30.4.6 a document which is an *electronic document* is served as soon as it is first *Digitally Signed* in the *Electronic Workspace* on behalf of the *party* required to serve it.
- 30.5 *Normally*, the vendor must *within 7 days of the effective date* –
- 30.5.1 create an *Electronic Workspace*;
- 30.5.2 *populate* the *Electronic Workspace* with *title data*, the date for completion and, if applicable, *mortgagee details*; and
- 30.5.3 invite the purchaser and any *discharging mortgagee* to the *Electronic Workspace*.
- 30.6 If the vendor has not created an *Electronic Workspace* in accordance with clause 30.5, the purchaser may create an *Electronic Workspace*. If the purchaser creates the *Electronic Workspace* the purchaser must –
- 30.6.1 *populate* the *Electronic Workspace* with *title data*;
- 30.6.2 create and *populate* an *electronic transfer*;
- 30.6.3 *populate* the *Electronic Workspace* with the date for completion and a nominated *completion time*; and
- 30.6.4 invite the vendor and any *incoming mortgagee* to join the *Electronic Workspace*.
- 30.7 *Normally*, *within 7 days of receiving an invitation from the vendor to join the Electronic Workspace*, the purchaser must –
- 30.7.1 join the *Electronic Workspace*;
- 30.7.2 create and *populate* an *electronic transfer*;
- 30.7.3 invite any *incoming mortgagee* to join the *Electronic Workspace*; and
- 30.7.4 *populate* the *Electronic Workspace* with a nominated *completion time*.

- 30.8 If the purchaser has created the *Electronic Workspace* the vendor must *within 7 days* of being invited to the *Electronic Workspace* –
- 30.8.1 join the *Electronic Workspace*;
 - 30.8.2 *populate* the *Electronic Workspace* with *mortgagee details*, if applicable; and
 - 30.8.3 invite any *discharging mortgagee* to join the *Electronic Workspace*.
- 30.9 To complete the financial settlement schedule in the *Electronic Workspace* –
- 30.9.1 the purchaser must provide the vendor with *adjustment figures* at least *2 business days* before the date for completion;
 - 30.9.2 the vendor must confirm the *adjustment figures* at least *1 business day* before the date for completion; and
 - 30.9.3 if the purchaser must make a *GSTRW payment* or an *FRCGW remittance*, the purchaser must *populate* the *Electronic Workspace* with the payment details for the *GSTRW payment* or *FRCGW remittance* payable to the Deputy Commissioner of Taxation at least *2 business days* before the date for completion.
- 30.10 Before completion, the *parties* must ensure that –
- 30.10.1 all *electronic documents* which a *party* must *Digitally Sign* to complete the *electronic transaction* are *populated* and *Digitally Signed*;
 - 30.10.2 all certifications required by the *ECNL* are properly given; and
 - 30.10.3 they do everything else in the *Electronic Workspace* which that *party* must do to enable the *electronic transaction* to proceed to completion.
- 30.11 If completion takes place in the *Electronic Workspace* –
- 30.11.1 payment electronically on completion of the price in accordance with clause 16.7 is taken to be payment by a single *settlement cheque*;
 - 30.11.2 the completion address in clause 16.11 is the *Electronic Workspace*; and
 - 30.11.3 clauses 13.13.2 to 13.13.4, 16.8, 16.12, 16.13 and 31.2.2 to 31.2.4 do not apply.
- 30.12 If the computer systems of any of the *Land Registry*, the *ELNO* or the Reserve Bank of Australia are inoperative for any reason at the *completion time* agreed by the *parties*, a failure to complete this contract for that reason is not a default under this contract on the part of either *party*.
- 30.13 If the computer systems of the *Land Registry* are inoperative for any reason at the *completion time* agreed by the *parties*, and the *parties* choose that financial settlement is to occur despite this, then on financial settlement occurring –
- 30.13.1 all *electronic documents Digitally Signed* by the vendor, the *certificate of title* and any discharge of mortgage, withdrawal of caveat or other *electronic document* forming part of the *Lodgment Case* for the *electronic transaction* shall be taken to have been unconditionally and irrevocably delivered to the purchaser or the purchaser's mortgagee at the time of financial settlement together with the right to deal with the land comprised in the *certificate of title*; and
 - 30.13.2 the vendor shall be taken to have no legal or equitable interest in the *property*.
- 30.14 A *party* who holds a *certificate of title* must act in accordance with any *Prescribed Requirement* in relation to the *certificate of title* but if there is no *Prescribed Requirement*, the vendor must serve the *certificate of title* after completion.
- 30.15 If the *parties* do not agree about the delivery before completion of one or more documents or things that cannot be delivered through the *Electronic Workspace*, the *party* required to deliver the documents or things –
- 30.15.1 holds them on completion in escrow for the benefit of; and
 - 30.15.2 must immediately after completion deliver the documents or things to, or as directed by; the *party* entitled to them.
- 30.16 In this clause 30, these terms (in any form) mean –
- | | |
|------------------------------|---|
| <i>adjustment figures</i> | details of the adjustments to be made to the price under clause 14; |
| <i>certificate of title</i> | the paper duplicate of the folio of the register for the land which exists immediately prior to completion and, if more than one, refers to each such paper duplicate; |
| <i>completion time</i> | the time of day on the date for completion when the <i>electronic transaction</i> is to be settled; |
| <i>conveyancing rules</i> | the rules made under s12E of the Real Property Act 1900; |
| <i>discharging mortgagee</i> | any discharging mortgagee, chargee, covenant chargee or caveator whose provision of a <i>Digitally Signed</i> discharge of mortgage, discharge of charge or withdrawal of caveat is required in order for unencumbered title to the <i>property</i> to be transferred to the purchaser; |
| <i>ECNL</i> | the Electronic Conveyancing National Law (NSW); |
| <i>effective date</i> | the date on which the <i>Conveyancing Transaction</i> is agreed to be an <i>electronic transaction</i> under clause 30.1.2 or, if clauses 30.1.1 or 30.1.3 apply, the contract date; |
| <i>electronic document</i> | a dealing as defined in the Real Property Act 1900 which may be created and <i>Digitally Signed</i> in an <i>Electronic Workspace</i> ; |
| <i>electronic transfer</i> | a transfer of land under the Real Property Act 1900 for the <i>property</i> to be prepared and <i>Digitally Signed</i> in the <i>Electronic Workspace</i> established for the purposes of the <i>parties' Conveyancing Transaction</i> ; |

<i>electronic transaction</i>	a <i>Conveyancing Transaction</i> to be conducted for the <i>parties</i> by their legal representatives as <i>Subscribers</i> using an <i>ELN</i> and in accordance with the <i>ECNL</i> and the <i>participation rules</i> ;
<i>electronically tradeable</i>	a land title that is Electronically Tradeable as that term is defined in the <i>conveyancing rules</i> ;
<i>incoming mortgagee</i>	any mortgagee who is to provide finance to the purchaser on the security of the <i>property</i> and to enable the purchaser to pay the whole or part of the price;
<i>mortgagee details</i>	the details which a <i>party</i> to the <i>electronic transaction</i> must provide about any <i>discharging mortgagee</i> of the <i>property</i> as at completion;
<i>participation rules</i>	the participation rules as determined by the <i>ECNL</i> ;
<i>populate</i>	to complete data fields in the <i>Electronic Workspace</i> ; and
<i>title data</i>	the details of the title to the <i>property</i> made available to the <i>Electronic Workspace</i> by the <i>Land Registry</i> .

31 Foreign Resident Capital Gains Withholding

- 31.1 This clause applies only if –
- 31.1.1 the sale is not an excluded transaction within the meaning of s14-215 of Schedule 1 to the *TA Act*; and
- 31.1.2 a *clearance certificate* in respect of every vendor is not attached to this contract.
- 31.2 The purchaser must –
- 31.2.1 at least 5 days before the date for completion, *serve* evidence of submission of a purchaser payment notification to the Australian Taxation Office by the purchaser or, if a direction under clause 4.3 has been *served*, by the transferee named in the transfer *served* with that direction;
- 31.2.2 produce on completion a *settlement cheque* for the *FRCGW remittance* payable to the Deputy Commissioner of Taxation;
- 31.2.3 forward the *settlement cheque* to the payee immediately after completion; and
- 31.2.4 *serve* evidence of receipt of payment of the *FRCGW remittance*.
- 31.3 The vendor cannot refuse to complete if the purchaser complies with clauses 31.2.1 and 31.2.2.
- 31.4 If the vendor *serves* any *clearance certificate* or *variation*, the purchaser does not have to complete earlier than 7 days after that *service* and clause 21.3 does not apply to this provision.
- 31.5 If the vendor *serves* in respect of every vendor either a *clearance certificate* or a *variation* to 0.00 percent, clauses 31.2 and 31.3 do not apply.

32 Residential off the plan contract

- 32.1 This clause applies if this contract is an off the plan contract within the meaning of Division 10 of Part 4 of the *Conveyancing Act 1919* (the *Division*).
- 32.2 No provision of this contract has the effect of excluding, modifying or restricting the operation of the *Division*.
- 32.3 If the purchaser makes a claim for compensation under the terms prescribed by clause 6A of the *Conveyancing (Sale of Land) Regulation 2017* –
- 32.3.1 the purchaser cannot make a claim under this contract about the same subject matter, including a claim under clauses 6 or 7; and
- 32.3.2 the claim for compensation is not a claim under this contract.
- 32.4 This clause does not apply to a contract made before the commencement of the amendments to the *Division* under the *Conveyancing Legislation Amendment Act 2018*.

SPECIAL CONDITIONS NSW:

1. In the event of any discrepancy between these Special Conditions and the printed form of Contract these Special Conditions shall prevail.
2. No Clause or Special Condition hereof shall merge on completion where such clause may reasonably be construed as intended to have a continuing effect after completion.
3. The Purchaser acknowledges that in entering into this agreement the Purchaser does not rely upon any warranty or representation made by the Vendor or by any person on behalf of the Vendor except such as may be expressly provided herein or implied by virtue of Section 52A of the Conveyancing Act 1919 (as amended) but instead has relied entirely upon the Purchaser's own inquiries and inspection of the property and in consideration of the Vendor entering into this Contract, the parties expressly agree that this acknowledgment may be pleaded in bar to any action by the Purchaser against the Vendor at law or in equity for breach of any such warranty or representation.
4. Subject to the provisions of this Contract (and where not inconsistent with the provisions of Section 66L of the Conveyancing Act, 1919 as amended) the Purchaser acknowledges that he is purchasing the property in its present condition and state of repair subject to fair wear and tear pending completion.
5. The Purchaser having had the opportunity of comparing the land inspected by him with that described in the particulars of Title as the Title to such land shall take no objection make no requisition and claim no compensation by reason of any discrepancies between the actual area, boundaries, measurements or position of the land as occupied and the same as shown or described in the said particulars of title nor shall the Purchaser be entitled to call upon the Vendor to amend title or to bear or to contribute to the expense of any amendment of title.
6. This sale is subject to the property and the chattels being delivered to the Purchaser on the settlement date in their present state of repair (fair wear and tear excepted) but failure so to deliver the chattels shall only create a right to compensation.
7. Without in any manner negating, limiting or restricting any rights or remedies which would have been available to either party at law or in equity had this clause not been included herein should either party prior to completion:-
 - (a) Die or become so mentally ill that his or her affairs are liable to be administered by the Protective Commissioner prior to completion of this Contract, then the other party may by notice in writing to the Vendor or Purchaser as the case may be, rescind this Contract whereupon the provisions of Condition 19 shall apply and where there are more than one Vendor or Purchaser, then the provisions of this further condition shall apply where either the Vendor or Purchaser as the case may be shall die or become bankrupt prior to completion hereof.
 - (b) Be declared bankrupt or enter into any scheme or make any assignment for the benefit of creditors or being a company resolve to go into

liquidation or have a petition for winding up presented or enter into any scheme or arrangement with its creditors or should any liquidator, receiver or official manager be appointed in respect of the affairs of either party then that party shall be deemed to be in default hereunder whereupon the provisions of Condition 19 shall apply.

8. It is hereby expressly agreed between the parties that in the event of either party failing to complete this Contract by the due date then that party not in default shall be entitled to serve on the other party a Notice to Complete requiring that other party to so complete this agreement within fourteen (14) days from the date of service of such notice. For the purpose of this Agreement any such Notice to Complete shall be deemed both at law and in equity to be sufficient notice to make time of the essence of this agreement.
9. The Purchaser acknowledges that he is purchasing the property and shall take title thereto subject to existing Water, Sewerage, Drainage, Gas and Electricity, Telephone or other installations or services (hereinafter in the condition referred to as "any service") and shall not make any requisition, objection or claim for compensation in respect of:-
 - (a) the nature, location, availability or non availability of any service; or
 - (b) if any such service is a joint service with any other property or properties; or
 - (c) if any service for any other property or properties of the main, pipes, wires of connection therefore pass through or over the property and vice versa; or
 - (d) whether or not the property is subject to or has the benefit of any rights, easements or agreements in respect of any service of the mains, pipes or connections therefore.
10. The Purchaser agrees that for the purpose of printed condition 4.3 for this Contract:-
 - (a) that sufficient particulars of title for the preparation of the Transfer (and any covenant or easement agreed to be created by or with the Transfer) are contained in this Contract;
 - (b) that he shall not request the Vendor to provide a statement of the Vendor's title to the land;
11. Upon completion, if applicable, the Vendor will hand to the Purchaser a proper form of Discharge of Mortgage or Withdrawal of Caveat as the case may be in registrable form in respect of any Mortgage or Caveat registered on the title to the property and will allow the Purchaser the registration fee payable on such Discharge of Mortgage or Withdrawal of Caveat and the Purchaser shall make no requisition or objection requiring the registration of such Discharge of Mortgage or Withdrawal of Caveat prior to completion.
12. If the Purchaser defaults in payment of the purchase money or any part of it or of any interest thereon or any other moneys payable to the Vendor under this Contract he shall pay interest at the rate of 12 % per annum on the amount in default from the date of such default until the default ceases without prejudice

however to the clause only time shall be, and be deemed to be, of the essence of this Agreement.

13. Notwithstanding any other provision of this agreement, if:
- (a) the deposit agreed to be paid or actually paid by the Purchaser is less than 10 per cent (10%) of the purchase price and;
 - (b) by reason of default by the Purchaser, the Vendor becomes entitled to the deposit actually paid

the Purchaser will immediately upon demand pay to the Vendor the difference between ten percent (10%) of the purchase price and the amount actually paid to the intent that a full ten percent (10%) of the purchase price is forfeitable by way of deposit on default.

14. If the Purchaser shall be a company then the Purchaser shall ensure that all Directors of the Purchaser shall guarantee to the Vendor the due and punctual performance of the obligations of the Purchaser under the Contract in the form annexed hereto.

.....

.....

DATED this day of 2020.

SIGNED SEALED AND DELIVERED by _____)
 _____)
 in the presence of: _____)



LAND
REGISTRY
SERVICES

Title Search



NEW SOUTH WALES LAND REGISTRY SERVICES - TITLE SEARCH

FOLIO: 1/1251938

SEARCH DATE	TIME	EDITION NO	DATE
21/7/2020	11:54 AM	1	26/7/2019

NO CERTIFICATE OF TITLE HAS ISSUED FOR THE CURRENT EDITION OF THIS FOLIO.
CONTROL OF THE RIGHT TO DEAL IS HELD BY NATIONAL AUSTRALIA BANK LIMITED.

LAND

LOT 1 IN DEPOSITED PLAN 1251938
AT GOL GOL
LOCAL GOVERNMENT AREA WENTWORTH
PARISH OF GOL GOL COUNTY OF WENTWORTH
TITLE DIAGRAM DP1251938

FIRST SCHEDULE

PETER RICHARD KELLEHER
SHARON MARGARET KELLEHER
AS JOINT TENANTS

SECOND SCHEDULE (4 NOTIFICATIONS)

- 1 RESERVATIONS AND CONDITIONS IN THE CROWN GRANT(S)
- 2 AJ363132 MORTGAGE TO NATIONAL AUSTRALIA BANK LIMITED
- 3 DP1251938 EASEMENT TO DRAIN SEWAGE 2 METRE(S) WIDE AFFECTING
THE PART(S) SHOWN SO BURDENED IN THE TITLE DIAGRAM
- 4 DP1251938 EASEMENT TO DRAIN SEWAGE 2 METRE(S) WIDE APPURTENANT
TO THE LAND ABOVE DESCRIBED

NOTATIONS

UNREGISTERED DEALINGS: NIL

*** END OF SEARCH ***



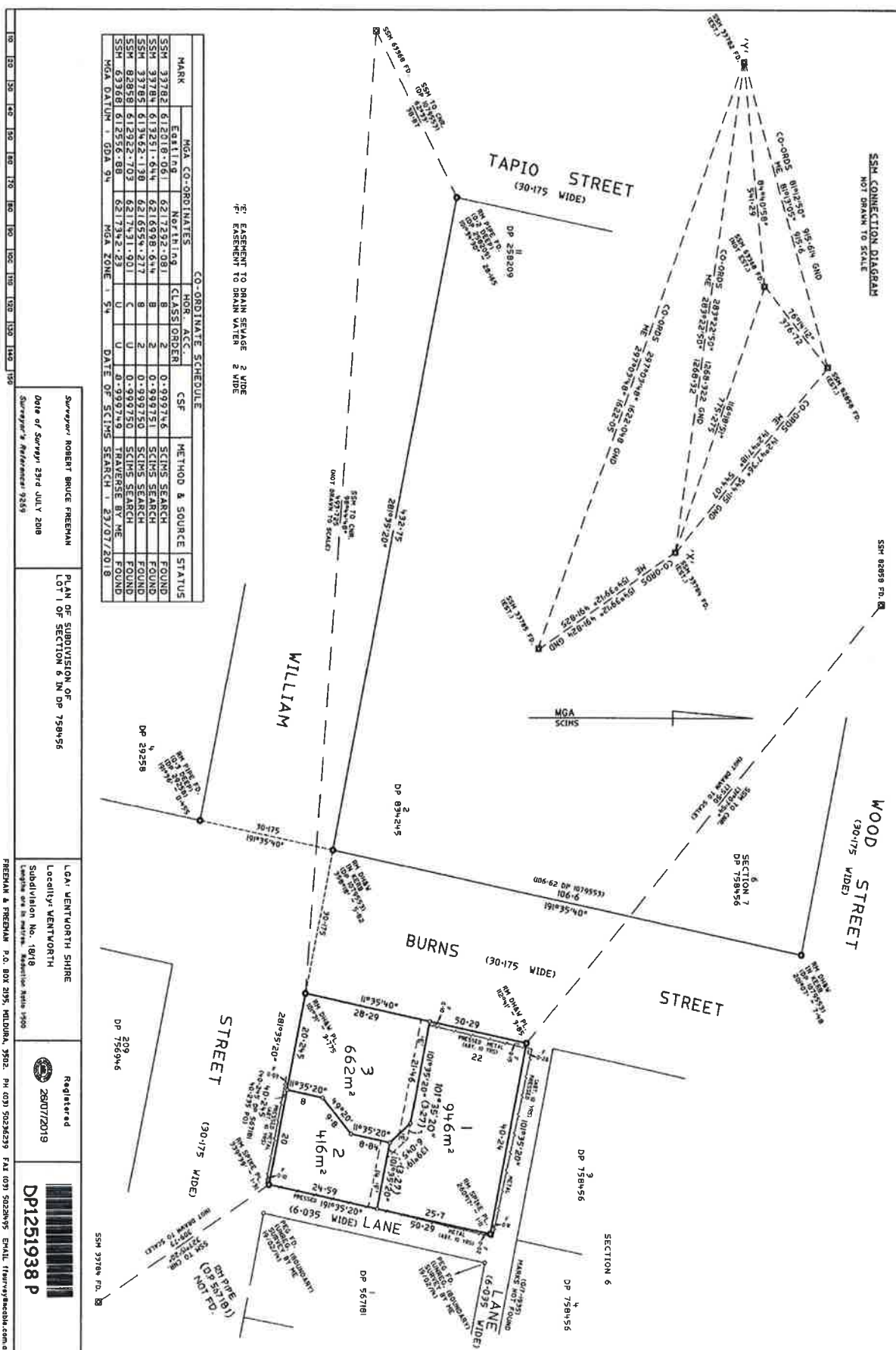

321176-1

PRINTED ON 21/7/2020



* Any entries preceded by an asterisk do not appear on the current edition of the Certificate of Title. Warning: the information appearing under notations has not been formally recorded in the Register. InfoTrack an approved NSW Information Broker hereby certifies that the information contained in this document has been provided electronically by the Registrar General in accordance with Section 96B(2) of the Real Property Act 1900.

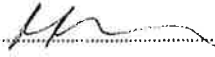

PLAN AMENDED BY ALAN BROWNE 19.7.19

PLAN FORM 6 (2017)		DEPOSITED PLAN ADMINISTRATION SHEET		Sheet 1 of 2 sheet(s)	
Registered:  26/07/2019 Title System: TORRENS		Office Use Only  DP1251938 S		Use Only	
PLAN OF SUBDIVISION OF LOT 1 OF SECTION 6 IN DP 758456		LGA : WENTWORTH SHIRE. LOCALITY: GOL GOL. PARISH: GOL GOL. COUNTY: WENTWORTH.			
Survey Certificate I, ROBERT BRUCE FREEMAN of 130 LANGTREE AVENUE, MILDURA, VIC. 3500. a surveyor registered under the <i>Surveying and Spatial Information Act 2002</i> , certify that: *(a) The land shown in the plan was surveyed in accordance with the <i>Surveying and Spatial Information Regulation 2017</i> , is accurate and the survey was completed on 23 rd July 2018, or *(b) The part of the land shown in the plan (being <i>excluding</i> was surveyed in accordance with the Surveying and Spatial Information Regulation 2017, the part surveyed is accurate and the survey was completed on <i>the part not surveyed was compiled in accordance with that Regulation, or</i> *(c) The land shown in this plan was compiled in accordance with the <i>Surveying and Spatial Information Regulation 2017</i> . Datum Line: 'X' - 'Y' Type: *Urban/*Rural The terrain is *Level-Undulating / *Steep-Mountainous. Signature:  Dated: 09/11/2018 Surveyor Identification No: 2461 Surveyor registered under the <i>Surveying and Spatial Information Act 2002</i> *Strike out inappropriate words. **Specify the land actually surveyed or specify any land shown in the plan that is not the subject of the survey.		Crown Lands NSW/Western Lands Office Approval I, (Authorised Officer) in approving this plan certify that all necessary approvals in regard to the allocation of the land shown herein have been given. Signature: Date: File Number: Office:			
Plans used in the preparation of survey/compilation. DP 29258, DP 567181, DP 258209, DP 435513, DP 834245, DP 1079553, CP 2-1935 & CP G17-1935		Subdivision Certificate I, <u>Michele Bos</u> *Authorised Person/*General Manager/*Accredited Certifier, certify that the provisions of s.109J of the <i>Environmental Planning and Assessment Act 1979</i> have been satisfied in relation to the proposed subdivision, new road or reserve set out herein. Signature:  Accreditation number: Consent Authority: <u>Wentworth Shire Council</u> Date of endorsement: <u>28 November 2018</u> Subdivision Certificate number: <u>18/18</u> File number: <u>DA15/127</u> *Strike through if inapplicable.			
Surveyor's Reference: 9269		Statements of intention to dedicate public roads, create public reserves and drainage reserves, acquire/resume land. Signatures, Seals and Section 88B Statements should appear on PLAN FORM 6A			

AMENDED BY ALAN BROWNE 19-7-19

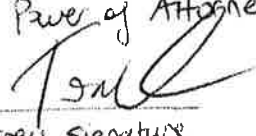
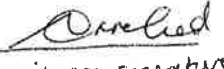
PLAN FORM 6A (2017) DEPOSITED PLAN ADMINISTRATION SHEET		Sheet 2 of 2 sheet(s)
<div>Office Use Only</div> <div>Registered:  26/07/2019</div> <div>PLAN OF SUBDIVISION OF LOT 1 OF SECTION 6 IN DP 758456</div> <div>Subdivision Certificate number: <u>18/18</u> Date of Endorsement: <u>28 November 2018</u></div>		<div>Office Use Only</div> <div>DP1251938</div> <div>This sheet is for the provision of the following information as required:<ul style="list-style-type: none">• A schedule of lots and addresses - See 60(c) <i>SSI Regulation 2017</i>• Statements of intention to create and release affecting interests in accordance with section 88B <i>Conveyancing Act 1919</i>• Signatures and seals- see 195D <i>Conveyancing Act 1919</i>• Any information which cannot fit in the appropriate panel of sheet 1 of the administration sheets.</div>
<p>Clause 60(c) Surveying and Spatial Information Regulation 2017:</p> <p>LOT 1 : 12 BURNS STREET, GOL GOL, 2738 LOT 2 : 10 WILLIAM STREET, GOL GOL, 2738 LOT 3 : 12 WILLIAM STREET, GOL GOL, 2738</p> <p>PURSUANT TO SECTION 88B OF THE CONVEYANCING ACT 1919 - 1964, IT IS INTENDED TO CREATE;</p> <p>1. EASEMENT TO DRAIN SEWAGE 2 WIDE 2. EASEMENT TO DRAIN WATER 2 WIDE</p> <p> </p> <p>Mortgagee under Mortgage No. AJ363132 Signed at 800 Bourke St Docklands VIC 3008 this 26th day of February 2019 for National Australia Bank Limited ABN 12 004 044 937 by Tom Kowal its duly appointed Attorney under Power of Attorney No. 39 Book 4512</p> <p> Attorney Signature Level 3 Attorney</p> <p> witness signature ANNE CLAY witness name 800 Bourke St Docklands VIC 3008 witness address</p> <p>If space is insufficient use additional annexure sheet</p> <p>Surveyor's Reference: 9269</p>		

**INSTRUMENT SETTING OUT TERMS OF EASEMENTS AND RESTRICTION AS
 TO USER INTENDED TO BE CREATED PURSUANT TO SECTION 88B
 CONVEYANCING ACT 1919**



DP1251938 B

(Sheet 1 of 2 Sheets)

PLAN OF SUBDIVISION OF LOT 1 IN
 SECTION 6 DP 758456 COVERED BY
 SUBDIVISION CERTIFICATE NO. 18/18

**Full name and address of Registered
 Proprietor of Lot 1 Section 6 in DP
 758456**

**PETER RICHARD KELLEHER &
 SHARON MARGARET KELLEHER** both
 of 10-12 William Street, Gol Gol NSW
 2738

PART 1 (Creation)

Number of item shown in the intention panel on the plan	Identity of easement, profit a` prendre, restriction of positive covenant to be created and referred to in the plan.	Burdened lot(s) or parcel(s):	Benefited lot(s), road(s), bodies or Prescribed Authorities:
1.	Easement to drain sewage 1 wide 2	Lot 1 Lot 3	Lot 2 & Lot 3 Lot 1 & Lot 2
2.	Easement to drain water 2 wide	Lot 2	Lot 3

Signed by the said **PETER RICHARD
 KELLEHER & SHARON MARGARET
 KELLEHER** in my presence of who is
 personally known to me or whose identity
 I am otherwise satisfied with:







 Signature of Witness

Loren Caulfield
 Maloney Anderson Legal
 70 Deakin Avenue, Mildura
 who is an Australian Legal Practitioner
 within the meaning of the
 Legal Profession Uniform Law (Victoria)

**INSTRUMENT SETTING OUT TERMS OF EASEMENTS AND RESTRICTION AS
TO USER INTENDED TO BE CREATED PURSUANT TO SECTION 88B
CONVEYANCING ACT 1919**

(Sheet 2 of 2 Sheets)

Plan: **DP1251938**

PLAN OF SUBDIVISION OF LOT 1 IN
SECTION 6 DP 758456 COVERED BY
SUBDIVISION CERTIFICATE NO. 18/18

National Australia Bank Limited consent as mortgagee:

Mortgagee under Mortgage No. AJ363132
Signed at 800 Bourke St Docklands VIC 3008
this 26th day of February 2019 for
National Australia Bank Limited
ABN 12004 044937 by Tom Kaval
its duly appointed Attorney under
Power of Attorney No. 39 Book 4512



Attorney Signature
Level 3 Attorney

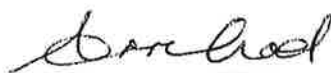

Witness signature

ANNE CUMY

Witness name

800 Bourke St Docklands VIC 3008
Witness address

REGISTERED



26/07/2019



Our Reference: DOC/20/15272
Your Reference: N/a
Contact: Health & Planning Division
Phone: 03 5027 5027
Date: 20 July 2020

Your Reference:	N/a
Applicant name:	Sharon Kelleher
Applicant address:	PO Box 10044 MILDURA Private Boxes Vic 3502
Applicant email:	sales@kelleherhomes.com.au
Certificate no:	2020-278
Subject land:	12 Burns Street Lot 1 DP 1251938 Gol Gol
Date of certificate:	20 July 2020

Wentworth Shire Council gives notice and points out to all users of the information supplied herein, that the information herein has been compiled by Council from sources outside of Council's control. While the information herein is provided with all due care and in good faith, it is provided on the basis that Council will not accept any responsibility for and will not be liable for its contents or for any consequence arising from its use, and every user of such information is advised to make all necessary enquiries from the appropriate organisations, institutions and the like.

<p>1. Names of relevant planning instruments and DCPs</p> <p>a) The name of each environmental planning instrument that applies to the carrying out of development on the land.</p> <p>b) The name of each proposed environmental planning instrument that will apply to the carrying out of development on the land and that is or has been the subject of community consultation or on public exhibition under the Act (unless the Director-General has notified the council that the making of the proposed instrument has been deferred indefinitely or has not been approved).</p> <p>c) The name of each development control plan that applies to the carrying out of development on the land.</p> <p>d) In this clause, proposed environmental planning instrument includes a planning proposal for a LEP or a draft environmental planning instrument.</p>	<p>a) <i>Wentworth Local Environmental Plan 2011</i> applies to this land.</p> <p>b) See Annexure 1.</p> <p>c) Wentworth Development Control Plan December 2011.</p> <p>d) Not applicable.</p>
<p>2. Zoning and land use under relevant LEPs</p> <p>For each environmental planning instrument or proposed instrument referred to in clause 1 (other than a SEPP or proposed SEPP) that includes the land in any zone (however described):</p> <p>a) the identity of the zone, whether by reference to a name (such as “Residential Zone” or “Heritage Area”) or by reference to a number (such as “Zone</p>	<p>The following information will assist in determining how the subject land may be developed. It is recommended that you read this section in conjunction with a full copy of any relevant environmental planning instrument as there may be additional provisions that affect how the land may be developed.</p> <p>a) Wentworth Local Environmental Plan (WLEP) 2011 ZONE: RUS - Village</p>

<p>No 2 (a)”)</p> <p>b) the purposes for which the instrument provides that development may be carried out within the zone without the need for development consent,</p> <p>c) the purposes for which the instrument provides that development may not be carried out within the zone except with development consent,</p> <p>d) the purposes for which the instrument provides that development is prohibited within the zone,</p> <p>e) whether any development standards applying to the land fix minimum land dimensions for the erection of a dwelling-house on the land and, if so, the minimum land dimensions so fixed,</p> <p>f) whether the land includes or comprises critical habitat,</p> <p>g) whether the land is in a conservation area (however described),</p> <p>h) whether an item of environmental heritage (however described) is situated on the land.</p>	<p>b) In addition to the controls contained in the <i>Wentworth Local Environmental Plan 2011</i>, State Environmental Planning Policy (Exempt and Complying Development Codes) 2008 sets out further circumstances where development consent will be required for development involving certain types of buildings, the demolition of buildings or the subdivision of land. These circumstances may include development that does not require consent under the <i>Wentworth Local Environmental Plan 2011</i>.</p> <p>c) See Annexure 1.</p> <p>d) See Annexure 1.</p> <p>e) Not applicable.</p> <p>f) No. This information has been sourced from mapping provided by NSW Environment & Heritage.</p> <p>g) No. This information has been sourced from mapping provided by NSW Environment & Heritage.</p> <p>h) No.</p>
<p>3. Complying development</p> <p>a) The extent to which the land is land on which complying development may be carried out under each of the codes for complying development because of the provisions of clauses 1.17A (1) (c) to (e), (2), (3) and (4), 1.18 (1) (c3) and 1.19 of <u><i>State Environmental Planning Policy (Exempt and Complying Development Codes) 2008</i></u>.</p> <p>b) The extent to which complying development may not be carried out on that land because of the provisions of clauses 1.17A (1) (c) to (e), (2), (3) and (4), 1.18 (1) (c3) and 1.19 of that Policy and the reasons why it may not be carried out under that clause.</p> <p>c) If the council does not have sufficient information to ascertain the extent to which complying development may or may not be carried out on the land, a statement that a restriction applies to the land, but it may not apply to all of the land, and that council does not have sufficient information to ascertain the extent to which complying development may or may not be carried out on the land.</p>	<p>a) Yes - The land is land on which complying development may be carried out.</p> <p>b) Not applicable.</p> <p>c) Not applicable.</p>
<p>4. Mine subsidence</p> <p>Whether or not the land is proclaimed to be a mine subsidence district within the meaning of the <u><i>Coal Mine Subsidence Compensation Act 2017</i></u>.</p>	<p>Not applicable.</p>
<p>5. Road widening and road realignment</p> <p>Whether or not the land is affected by any road widening or road realignment under:</p> <p>a) Division 2 of Part 3 of the <u><i>Roads Act 1993</i></u>, or</p>	<p>Not applicable.</p>

<p>b) any environmental planning instrument, or c) any resolution of the council.</p>	
<p>6. Council and other public authority policies on hazard risk restrictions Whether or not the land is affected by a policy: a) adopted by the council, or b) adopted by any other public authority and notified to the council for the express purpose of its adoption by that authority being referred to in planning certificates issued by the council, that restricts the development of the land because of the likelihood of land slip, bushfire, tidal inundation, subsidence, acid sulphate soils or any other risk (other than flooding).</p>	<p>Not applicable.</p>
<p>7A. Flood related development controls information a) Whether or not development on that land or part of the land for the purposes of dwelling houses, dual occupancies, multi dwelling housing or residential flat buildings (not including development for the purposes of group homes or seniors housing) is subject to flood related development controls. b) Whether or not development on that land or part of the land for any other purpose is subject to flood related development controls. c) Words and expressions in this clause have the same meanings as in the Standard Instrument.</p>	<p>a) Not applicable. b) Not applicable.</p>
<p>7. Land reserved for acquisition Whether or not any environmental planning instrument or proposed environmental planning instrument referred to in clause 1 makes provision in relation to the acquisition of the land by a public authority, as referred to in section 3.15 of the Act.</p>	<p>Not applicable.</p>
<p>8. Contribution plans The name of each contributions plan applying to the land.</p>	<p>Development Contribution Plan Development Servicing Plan No 1 Development Servicing Plan No 2</p>
<p>9A. Biodiversity certified land If the land is biodiversity certified land under Part 8 of the <u>Biodiversity Conservation Act 2016</u>, a statement to that effect. Note: Biodiversity certified land includes land certified under Part 7AA of the <u>Threatened Species Conservation Act 1995</u> that is taken to be certified under Part 8 of the <u>Biodiversity Conservation Act 2016</u>.</p>	<p>Not applicable.</p>
<p>9. Biodiversity stewardship sites If the land is a biodiversity stewardship site under a biodiversity stewardship agreement under Part 5 of the <u>Biodiversity Conservation Act 2016</u>, a statement to that effect (but only if the council has been notified of the existence of the agreement by the Chief Executive of the Office of Environment and Heritage).</p>	<p>No, Wentworth Shire Council has not been notified of the existence of a biodiversity stewardship agreement by the Office of Environment & Heritage in relation to this property.</p>

<p>Note: Biodiversity stewardship agreements include biobanking agreements under Part 7A of the <u>Threatened Species Conservation Act 1995</u> that are taken to be biodiversity stewardship agreements under Part 5 of the <u>Biodiversity Conservation Act 2016</u>.</p>	
<p>10A. Native vegetation clearing set asides If the land contains a set aside area under section 60ZC of the <u>Local Land Services Act 2013</u>, a statement to that effect (but only if the council has been notified of the existence of the set aside area by Local Land Services or it is registered in the public register under that section).</p>	<p>Not applicable.</p>
<p>10. Bush fire prone land If any of the land is bush fire prone land (as defined in the Act), a statement that all or, as the case may be, some of the land is bush fire prone land. If none of the land is bush fire prone land, a statement to that effect.</p>	<p>Not applicable. This information has been sourced from mapping provided by the NSW Rural Fire Service.</p>
<p>11. Property vegetation plans If the land is land to which a property vegetation plan approved under Part 4 of the <u>Native Vegetation Act 2003</u> (and that continues in force) applies, a statement to that effect (but only if the council has been notified of the existence of the plan by the person or body that approved the plan under that Act).</p>	<p>Not applicable. This information has been sourced from NSW Local Land Services.</p>
<p>12. Orders under Trees (Disputes Between Neighbours) Act 2006 Whether an order has been made under the <u>Trees (Disputes Between Neighbours) Act 2006</u> to carry out work in relation to a tree on the land (but only if the council has been notified of the order).</p>	<p>Not applicable.</p>
<p>13. Directions under Part 3A If there is a direction by the Minister in force under section 75P (2) (c1) of the Act that a provision of an environmental planning instrument prohibiting or restricting the carrying out of a project or a stage of a project on the land under Part 4 of the Act does not have effect, a statement to that effect identifying the provision that does not have effect</p>	<p>No, there is no direction in force from the Minister under Section 75P (2) (c1) in relation to this property.</p>
<p>14. Site compatibility certificates and conditions for seniors housing If the land is land to which <u>State Environmental Planning Policy (Housing for Seniors or People with a Disability) 2004</u> applies: a) A statement of whether there is a current site compatibility certificate (seniors housing), of which the council is aware, in respect of proposed development on the land and, if there is a certificate, the statement is to include: (i) the period for which the certificate is current, and (ii) that a copy may be obtained from the head</p>	<p>Not applicable.</p>

<p>office of the Department, and</p> <p>b) A statement setting out any terms of a kind referred to in clause 18 (2) of that Policy that have been imposed as a condition of consent to a development application granted after 11 October 2007 in respect of the land.</p>	Not applicable.
<p>15. Site compatibility certificates for infrastructure</p> <p>a) A statement of whether there is a valid site compatibility certificate (infrastructure) or site compatibility certificate of which the council is aware, in respect of proposed development on the land and, if there is a certificate, the statement is to include:</p> <p>(i) the period for which the certificate is valid, and</p> <p>(ii) that a copy may be obtained from the head office of the Department.</p>	Council is not aware of any site compatibility certificate for infrastructure applying to this land.
<p>16. Site compatibility certificates and conditions for affordable rental housing</p> <p>a) A statement of whether there is a current site compatibility certificate (affordable rental housing), of which the council is aware, in respect of proposed development on the land and, if there is a certificate, the statement is to include:</p> <p>(i) the period for which the certificate is current, and</p> <p>(ii) that a copy may be obtained from the head office of the Department.</p> <p>b) A statement setting out any terms of a kind referred to in clause 17 (1) or 38 (1) of <i>State Environmental Planning Policy (Affordable Rental Housing) 2009</i> that have been imposed as a condition of consent to a development application in respect of the land.</p>	Council is not aware of any site compatibility certificate for affordable rental housing applying to this land.
<p>17. Paper subdivision information</p> <p>a) The name of any development plan adopted by a relevant authority applies to the land or that is proposed to be subject to a consent ballot.</p> <p>b) The date of any subdivision order that applies to the land.</p> <p>c) Words and expressions used in this clause have the same meaning as they have in Part 16C of the Environmental Planning & Assessment Regulation.</p>	<p>Not applicable.</p> <p>Not applicable.</p>
<p>18. Site verification certificates</p> <p>A statement of whether there is a current site verification certificate, of which the council is aware, in respect of the land and, if there is a certificate, the statement is to include:</p> <p>a) The matter certified by the certificate, and</p> <p>Note: A site verification certificate sets out the Secretary's opinion as to whether the land concerned is or is not biophysical strategic agricultural land or critical industry cluster land – see Division 3 of Part 4AA of State Environmental Planning Policy (Mining, Petroleum Production</p>	Not applicable.

<p>and Extractive Industries) 2007.</p> <p>b) The date on which the certificate ceases to be current (if any), and</p> <p>c) That a copy may be obtained from the head office of the Department.</p>	
<p>19. Loose-fill asbestos insulation</p> <p>If the land includes any residential premises (within the meaning of Division 1A of Part 8 of the <i>Home Building Act 1989</i>) that are listed on the register that is required to be maintained under that Division, a statement to that effect.</p>	Not applicable.
<p>20. Affected building notices and building product rectification orders</p> <p>(1) A statement of whether there is any affected building notice of which the council is aware that is in force in respect of the land.</p> <p>(2) A statement of:</p> <p>a) Whether there is any building product rectification order of which the council is aware that is in force in respect of the land and has not been fully complied with, and</p> <p>b) Whether any notice of intention to make a building product rectification order of which the council is aware has been given in respect of the land and is outstanding.</p>	<p>Not applicable.</p> <p>Not applicable.</p>
<p>(3) In this clause:</p> <p>Affected building notice has the same meaning as in Part 4 of the <i>Building Products (Safety) Act 2017</i>.</p> <p>Building product rectification order has the same meaning as in the <i>Building Products (Safety) Act 2017</i>.</p>	
<p>21. Information regarding Contaminated Land as prescribed by section 59 (2) of the Contaminated Lands Management Act 1997</p> <p>(a) Is the land to which the certificate relates significantly contaminated land within the meaning of that Act?</p> <p>(b) Is the land to which the certificate relates subject to a management order within the meaning of that Act?</p> <p>(c) Is the land to which the certificate relates the subject of an approved voluntary management proposal within the meaning of that Act?</p> <p>(d) Is the land to which the certificate relates subject to an ongoing maintenance order within the meaning of that Act?</p> <p>(e) Is the land to which the certificate relates the subject of a site audit statement within the meaning of that Act?</p>	<p>No.</p> <p>No.</p> <p>No.</p> <p>No.</p> <p>No.</p>



**CERTIFICATE UNDER SECTION 10.7(1) PURSUANT TO SECTION 10.7(5) OF THE
ENVIRONMENTAL PLANNING & ASSESSMENT ACT 1979**

You are advised that at the date of this certificate the subject land is affected by the following matters:-

Information Requested	Reply
a) Has the Council information which would indicate that the land is subject to slip or of flooding or tidal inundation?	No.
b) Has the Council information which would indicate that the land is subject to slip or subsidence?	No.
c) Is the land subject to a Tree Preservation Order?	No.
d) Has any development consent with respect to the land been granted within the previous five years?	No.
e) Any known non-compliance with matters relating to development approval?	No.
f) Any known non-compliance on matters relating to, or delegated to Council and notices requiring work to be carried out in relation to building and/or health items?	No
g) Any other known matter of which Council is aware that applies to the subject land?	Yes *Filtered water is available to this lot. *Unfiltered water is available to this lot. *Sewer connection is available to this lot. *The comments and information contained in this certificate relate to the property described in the section "Description of Land". *The information contained in this certificate has been compiled from Council's records – no physical inspection of the property was carried out.

The above information has been taken from the Council's records but Council cannot accept responsibility for any omission or inaccuracy.

Signed:

GEORGE KENENDE
DEVELOPMENT ASSESSMENT OFFICER
under delegation on behalf of the Shire of Wentworth

**ANNEXURE 1 TO CERTIFICATE PURSUANT TO SECTION 10.7(1) OF THE ENVIRONMENTAL
PLANNING & ASSESSMENT ACT 1979**

RU5 Village Zone as at 16 December 2011

You are advised that as at the date of this Certificate the subject land is affected by the following matters:-

(a) **STATE ENVIRONMENTAL PLANNING POLICIES**

No 21 - Caravan Parks – Ensures that where caravan parks or camping grounds are permitted under an environmental planning instrument, movable dwellings, as defined in the Local Government Act 1993, are also permitted. The specific kinds of movable dwellings allowed under the Local Government Act in caravan parks and camping grounds are subject to the provisions of the Caravan Parks Regulation. The policy ensures that development consent is required for new caravan parks and camping grounds and for additional long-term sites in existing caravan parks. It also enables, with the council's consent, long-term sites in caravan parks to be subdivided by leases of up to 20 years.

No 33 - Hazardous and Offensive Development – Provides new definitions for 'hazardous industry', 'hazardous storage establishment', 'offensive industry' and 'offensive storage establishment'. The definitions apply to all planning instruments, existing and future. The new definitions enable decisions to approve or refuse a development to be based on the merit of proposal. The consent authority must carefully consider the specifics of the case, the location and the way in which the proposed activity is to be carried out. The policy also requires specified matters to be considered for proposals that are 'potentially hazardous' or 'potentially offensive' as defined in the policy. For example, any application to carry out a potentially hazardous or potentially offensive development is to be advertised for public comment and applications to carry out potentially hazardous development must be supported by a preliminary hazard analysis (PHA). The policy does not change the role of councils as consent authorities, land zoning, or the designated development provisions of the Environmental Planning and Assessment Act 1979.

No 36 - Manufactured Home Estates – Helps establish well-designed and properly serviced manufactured home estates (MHEs) in suitable locations. Affordability and security of tenure for residents are important aspects. The policy applies to Gosford, Wyong and all local government areas outside the Sydney Region. To enable the immediate development of estates, the policy allows MHEs to be located on certain land where caravan parks are permitted. There are however, criteria that a proposal must satisfy before the local council can approve development. The policy also permits, with consent, the subdivision of estates either by community title or by leases of up to 20 years. A section 117 direction issued in conjunction with the policy guides councils in preparing local environmental plans for MHEs, enabling them to be excluded from the policy.

No 50 - Canal Estate Development – Bans new canal estates from the date of gazettal (10th November 1997), to ensure coastal and aquatic environments are not affected by these developments.

No 55 - Remediation of Land – Introduces state-wide planning controls for the remediation of contaminated land. The policy states that land must not be developed if it is unsuitable for a proposed use because it is contaminated. If the land is unsuitable, remediation must take place before the land is developed. The policy makes remediation permissible across the State, defines when consent is required, requires all remediation to comply with standards, ensures land is investigated if contamination is suspected, and requires councils to be notified of all remediation proposals. To assist councils and developers, the Department, in conjunction with the Environment Protection Authority, has prepared [Managing Land Contamination: Planning Guidelines](#).

No 64 - Advertising and Signage - Aims to ensure that outdoor advertising is compatible with the desired amenity and visual character of an area, provides effective communication in suitable locations and is of high quality design and finish. The SEPP was amended in August 2007 to permit and regulate outdoor advertising in transport corridors (e.g. freeways, tollways and rail corridors). The amended SEPP also aims to ensure that public benefits may be derived from advertising along and adjacent to transport corridors. [Transport](#)

Corridor Outdoor Advertising and Signage Guidelines (DOP July 2007) provides information on design criteria, road safety and public benefit requirements for SEPP 64 development applications.

No 65 - Design Quality of Residential Apartment Development - Improves the design quality of residential apartment development across the state through the application of a series of design principles. The SEPP recognises that the design quality of residential apartment development is of significance for environmental planning for the State due to the economic, environmental, cultural and social benefits of high quality design. The SEPP operates to ensure that residential apartment development contributes to sustainable development of the state, achieves better built form and aesthetics of buildings and streetscapes, supports housing affordability for wide range of people, better satisfies the increasing demand, the changing social and demographic profile of the community, and maximises amenity, safety and security for the benefit of its occupants and the wider community. The SEPP facilitates timely and efficient assessment of applications for residential apartment development by providing a consistent policy framework and mechanism across the State. The policy provides for the establishment of design Review Panels to provide independent expert advice to councils on the merit of residential flat development.

SEPP (Affordable Rental Housing) 2009 – Establishes a consistent planning regime for the provision of affordable rental housing. The SEPP facilitates the effective delivery of new affordable rental housing by providing planning control incentives and expanding the role for not-for-profit-providers of affordable rental housing. The SEPP also establishes approaches to facilitate the retention and mitigate the loss of existing affordable rental housing. The SEPP aims to support local centres by providing housing for workers close to places of work, and facilitate development of housing for the homeless and other disadvantaged people.

SEPP (Building Sustainability Index: BASIX) 2004 - This SEPP operates in conjunction with Environmental Planning and Assessment Amendment (Building Sustainability Index: BASIX) Regulation 2004 to ensure the effective introduction of BASIX in NSW. The SEPP ensures consistency in the implementation of BASIX throughout the State by overriding competing provisions in other environmental planning instruments and development control plans and specifying that SEPP 1 does not apply in relation to any development standard arising under BASIX.

SEPP (Concurrences) 2018 – Authorises the Planning Secretary to elect to act in place of a concurrence authority for the for the purposes of deciding whether to grant concurrence to a development if the concurrence authority fails to inform a consent authority of the decision concerning concurrence within the time allowed for doing so.

SEPP (Educational Establishments and Child Care Facilities) 2017 - Facilitates the effective delivery of educational establishments and early education and care facilities across the State. The SEPP improves regulatory certainty and efficiency for educational establishments and early education and care facilities through a consistent planning regime that simplifies and standardises planning approval pathways and establishes consistent State-wide assessment requirements and design considerations for these developments. The policy provides for the consultation with relevant public authorities during the assessment process or prior to development commencing for educational establishments and early education and care facilities. The SEPP also aligns the NSW planning framework with the National Quality Framework for early education and care services to enable proponents and consent authorities ensure that new developments or modified premises meet the applicable requirements of the National Quality Framework for the services. The policy supports joint and shared use of the facilities of educational establishments with the community through appropriate design.

SEPP (Exempt and Complying Development Codes) 2008 - Streamlines assessment processes for development that complies with specified development standards. The policy provides exempt and complying development codes that have State-wide application, identifying, in the General Exempt Development Code, types of development that are of minimal environmental impact that may be carried out without the need for development consent; and, in the General Housing Code, types of complying development that may be carried out in accordance with a complying development certificate as defined in the Environmental Planning and Assessment Act 1979.

SEPP (Housing for Seniors or People with a Disability) 2004 – Encourages the provision of adequate, diverse and high quality housing for aged persons and people with disabilities. The SEPP achieves its aims by overriding local planning controls that would prevent the development of housing for seniors or people with

a disability and setting out design principles to achieving built form that is in keeping with the site and local neighbourhood.

SEPP (Infrastructure) 2007 - Provides a consistent planning regime for infrastructure and the provision of services across NSW, along with providing for consultation with relevant public authorities during the assessment process. The SEPP supports greater flexibility in the location of infrastructure and service facilities along with improved regulatory certainty and efficiency. More details about the SEPP, including a guide, are available at www.planning.nsw.gov.au.

SEPP (Mining, Petroleum Production and Extractive Industries) 2007 – Provides for the proper management and development of mineral, petroleum and extractive material resources for the social and economic welfare of the State. This Policy establishes appropriate planning controls to encourage ecologically sustainable development.

SEPP (Miscellaneous Consent Provisions) 2007 - Permits the erection of temporary structures with development consent across the state. The SEPP aims to ensure the safety of persons using temporary structures and protect the environment at the location, and in the vicinity, of temporary structures by specifying relevant matters for consideration.

SEPP (Primary Production and Rural Development) 2019 - Facilitates the orderly and economic use and development of lands for primary production. The aims to reduce land use conflict and sterilisation of rural land by balancing primary production, residential development and the protection of native vegetation, biodiversity and water resources. The SEPP encourages sustainable aquaculture and outlines the criteria for categorising aquaculture as designated development. The SEPP identifies State significant agricultural land, simplifies the regulatory process for water supply in irrigation areas and districts and sets out the considerations for assessing the impact of all proposed development oyster aquaculture.

SEPP (State and Regional Development) 2011 – Identifies and declares development as a State significant development, State significant infrastructure, critical State significant infrastructure or regionally significant development based on a number of factors including location, purpose and capital investment value etc.

SEPP (State Significant Precincts) 2005 - Facilitates the orderly development, redevelopment or protection of important urban, coastal and regional sites of economic, environmental or social significance to the State for the benefit of the state. The SEPP aims to facilitate service delivery outcomes for a range of public services, the development of major sites for a public purpose and redevelopment of major sites no longer appropriate or suitable for public purposes.

SEPP (Urban Renewal) 2010 - Establishes the process for assessing and identifying sites as urban renewal precincts and facilitates the orderly and economic development and redevelopment of sites in and around such precincts. The SEPP aims to facilitate delivery of the objectives of any applicable government State, regional or metropolitan strategies connected with the renewal of urban areas that are accessible by public transport.

SEPP (Vegetation in Non-Rural Areas) 2017 - Protects the biodiversity values of trees and other vegetation in non-rural areas of the State. The SEPP aims to preserve the amenity of non-rural areas through the preservation of trees and other vegetation. The policy establishes the approval pathways for clearing in non-rural areas.

SEPP (Koala Habitat Protection) 2019 – Encourages the conservation and management of areas of natural vegetation that provide habitat for koalas to support a permanent free-living population over their present range and reverse the current trend of koala population decline. The policy provides the state-wide approach needed to enable appropriate development to continue, while ensuring there is ongoing protection of koalas and their habitat. Local councils must ensure approvals for development on a land affected by this policy is consistent with the approved koala plan of management for the land. If there is no approved koala plan of management for a land affected by the policy, local councils must consider requirements of the koala habitat protection

guideline or information prepared by a suitably qualified and experienced person in accordance with the guideline before approving development on the land.

(b) **REGIONAL ENVIRONMENTAL PLANS**

Willandra Lakes REP No 1 - World Heritage Property - Applies to the Willandra Lakes Region in the Shires of Wentworth and Balranald. The purpose of the plans is to protect, conserve and manage this World Heritage Property in accordance with any strategic plan of management. The plan also aims to provide a process of consultation with stakeholders on development and related decisions.

Murray REP 2 - Riverine Land - Ensures the river and its floodplain are able to support a range of productive land uses. The plan coordinates planning along the Murray River and the implementation of planning related aspects of the Murray Darling Basin Commission strategies. It simplifies the consultation process between agencies and councils established in REP No. 1. It also promotes consistency between NSW and Victoria planning in relation to the river and its floodplain.

(c) **LOCAL ENVIRONMENTAL PLANS – RUS VILLAGE ZONE**

1. Objectives of zone

- To provide for a range of land uses, services and facilities that are associated with a rural village.
- To promote development in existing towns and villages in a manner that is compatible with their urban function.
- To encourage well-serviced sustainable development
- To ensure there are opportunities for economic development
- To deliver new residential and employment growth in Buronga and Gol Gol.
- To ensure business and retail land uses are grouped within and around existing activity centres.

2. Permitted without consent

Environmental protection works; Home-based child care; Home businesses; Home occupations; Roads; Water reticulation systems

3. Permitted with consent

Centre-based child care facilities; Community facilities; Dwelling houses; Home industries; Liquid fuel depots; Neighbourhood shops; Oyster aquaculture; Places of public worship; Recreation areas; Recreation facilities (indoor); Recreation facilities (outdoor); Respite day care centres; Schools; Tank-based aquaculture; Any other development not specified in item 2 or 4

4. Prohibited

Agriculture; Air transport facilities; Airstrips; Animal boarding or training establishments; Cellar door premises; Correctional centres; Crematoria; Farm buildings; Farm stay accommodation; Forestry; Freight transport facilities; Heavy industrial storage establishments; Industrial training facilities; Industries; Pond-based aquaculture Port facilities; Rural industries; Rural workers' dwellings; Sex services premises; Vehicle body repair workshops; Wharf or boating facilities

ISSUED: 13th APR' 2017

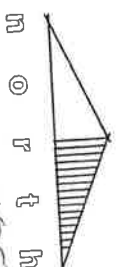

Shed we erected
when we built 3 years
ago.

existing shed was
on the property when
we purchased it. Shed
is approx 30 years old.

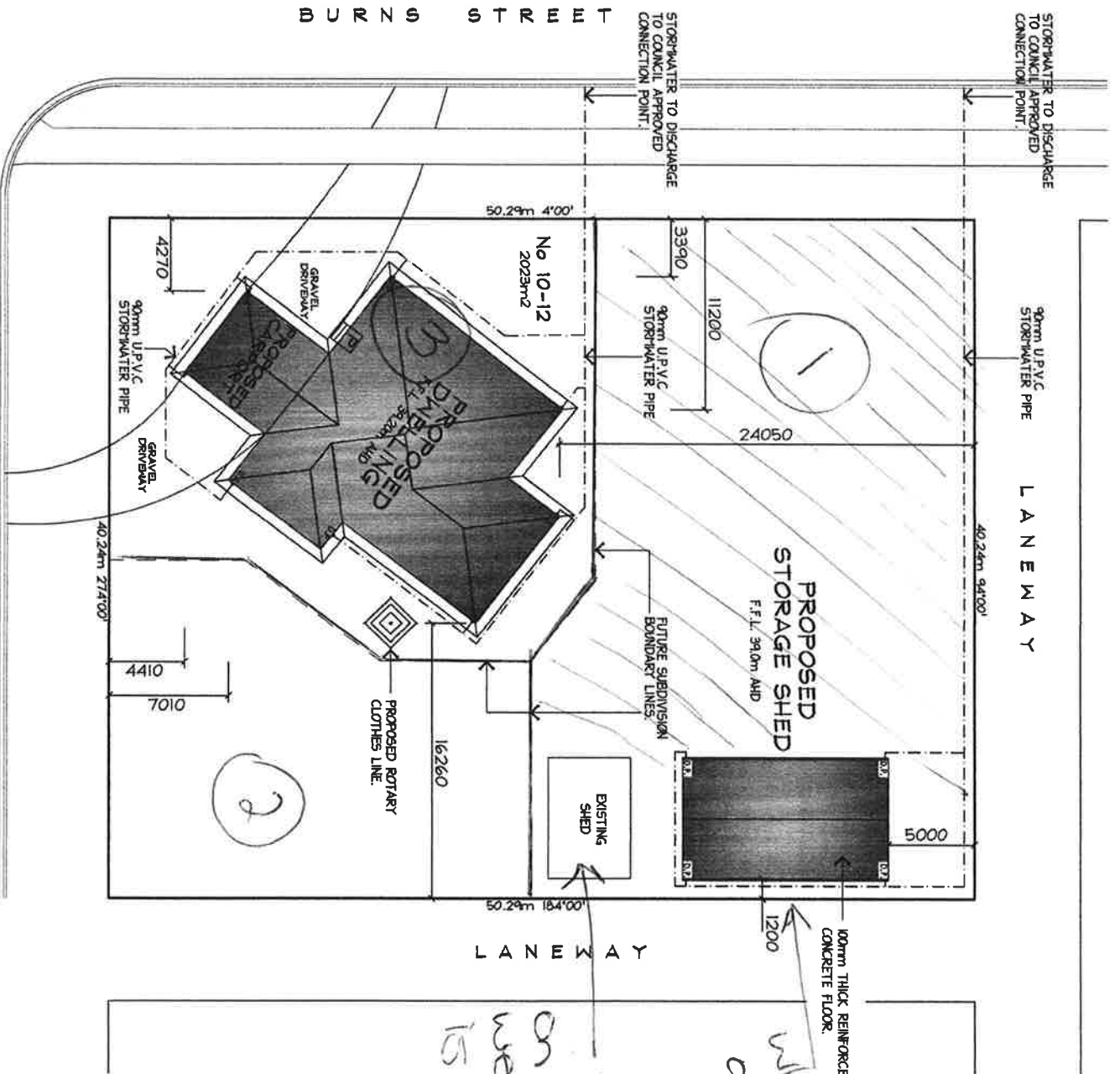

SITE PLAN 1:250

SHEET NO: 9 OF 12 DRG NO: MH 2016-084
PROJECT: PROPOSED DWELLING & STORAGE SHED
CLIENT: P. KELLER & S. ALDERTON
ADDRESS: No 10-12, WILLIAMS STREET, GOL GOL NSW.
SCALE: AS SHOWN DATE: DEC 16

markhooper3@bigpond.com
P.O. BOX 414, GOL GOL, N.S.W. 2738
PHONE: 5024 8606 MOBILE: 0438 210 139
ABN: 79 134 008 701 DP No: AD 26770

FORM 11

CONSTRUCTION CERTIFICATE*Issued under the Environmental Planning & Assessment Act 1979 Sections 109c(1)(b), 81a(2) and 81a(4)***Applicant:**

Name: Peter Kelleher & Sharon Alderton
 Postal Address: PO Box 10044 MILDURA VIC 3502
 Contact No: 0418 504 398

Owner:

Name: Peter Kelleher & Sharon Alderton
 Postal Address: PO Box 10044 MILDURA VIC 3502
 Contact No: 0418 504 398

Subject Land:

Street No: 10-12
 Lot No: 1
 DP No: DP758456
 Street Name: William Street
 Town: GOL GOL
 State: NSW
 Postcode: 2738
 Section: N/A

Description of Development: Construction of Dwelling, Carport, Outdoor Area and Storage Shed**Development Consent:**

Date of Development Consent: 21/02/2017
 Development Consent No: DA2017/002
 Name of Council: Wentworth Shire Council

Construction Certificate Application:

Date of Application of Construction Certificate: 14/03/2017
 Date Application Received by the Certifying Authority: 14/03/2017

Builder/Owner Builder Details:

Name: Peter Kelleher Homes Pty Ltd
 Registered Builder License No: 251582C

Decision of the Certifying**Authority:**

The certificate is issued: ☒ Subject to conditions of the kind referred to in Clause 187 or 188 of the Environmental Planning & Assessment Regulation 2000. Conditions have been placed on the Certificate for the following reasons:-
 Refer to Development Consent No.DA2017/002 issued on 21/02/2017
☒ The issue of this certificate has been endorsed on the plans and specifications that were lodged with the application:-

Document Type

Working Drawings
 Sub Floor Design
 Basix Certificate
 Soil Report
 Shed Specifications

Prepared By

Mark Hooper
 Mark Hooper
 Phil Maw Designs
 CivilTest Pty Ltd
 Emmanuel Dellas Pty Ltd

Date

Dec16
 Dec16
 22Dec16
 Nov11

Reference No.

MH2015-084 Pgs 1-12
 MH2015-084 Pg 6
 782714S
 Dwg No S1, S2 & S5

Value of Work and BCA Classification/s:

Value: \$250,000
 Classification: 1a, 10a

Build with confidence!



ANDERSON GROUP
BUILDING SURVEYORS AND CONSULTANTS

Development Consent:

Development Approval No:

DA2017/002

Issue Date:

21/02/2017

Certification:

I, Timothy Anderson, certify that work completed in accordance with the documentation accompanying the application for this certificate (with such modifications, if any, verify by me as may be shown on that documentation) will comply with the requirements of the Environmental Planning & Assessment Regulations 2000 as referred to in s.81a(5) of the Environmental Planning & Assessment Act 1979.

Construction Certificate No:

20170091/0

Date:

24/04/2017

Certifying Authority:

Signature:

Accredited Certifier:

Tim Anderson

Accreditation No

BPB 1769

Accreditation Body:

Planning NSW

Contact No:

03 5022 8196

Postal Address:

133b Lime Avenue MILDURA VIC 3500

ACCREDITED CERTIFIER

TIM ANDERSON
BPB 1769

Anderson Group
133b Lime Avenue
MILDURA VIC 3500
Phone 03 5022 8196

PROPERTY ADDRESS:

Lot 1, 10-12 William Street GOL GOL

CONSTRUCTION CERTIFICATE NO: 20170091/0

ISSUE DATE: 24/04/2017

BUILDER DETAILS

Peter Kelleher

Registration No. 251582C

Phone 03 5022 7437

UNAUTHORISED ENTRY INTO THIS SITE
IS PROHIBITED



Revenue

Enquiry ID	3293265
Agent ID	81429403
Issue Date	21 Jul 2020
Correspondence ID	1710163609
Your reference	321176-1

INFOTRACK PTY LIMITED
DX Box 578
SYDNEY

Land Tax Certificate under section 47 of the *Land Tax Management Act, 1956*.

This information is based on data held by Revenue NSW.

Land ID	Land address	Taxable land value
D1251938/1	12 WILLIAM ST GOL GOL 2738	NOT AVAILABLE

There is **no land tax** (including surcharge land tax) charged on the land up to and including the 2020 tax year.

Yours sincerely,

Scott Johnston
Chief Commissioner of State Revenue

Important information

Who is protected by a clearance certificate?

A clearance certificate states whether there is any land tax (including surcharge land tax) owing on a property. The certificate protects a purchaser from outstanding land tax liability by a previous owner, however it does not provide protection to the owner of the land.

When is a certificate clear from land tax?

A certificate may be issued as 'clear' if:

- the land is not liable or is exempt from land tax
- the land tax has been paid
- Revenue NSW is satisfied payment of the tax is not at risk, or
- the owner of the land failed to lodge a land tax return when it was due, and the liability was not detected at the time the certificate was issued.

Note: A clear certificate does not mean that land tax was not payable, or that there is no land tax adjustment to be made on settlement if the contract for sale allows for it.

When is a certificate not clear from land tax?

Under section 47 of the *Land Tax Management Act 1956*, land tax is a charge on land owned in NSW at midnight on 31 December of each year. The charge applies from the taxing date and does not depend on the issue of a land tax assessment notice. Land tax is an annual tax so a new charge may occur on the taxing date each year.

How do I clear a certificate?

A charge is removed for this property when the outstanding land tax amount is processed and paid in full. Payment can be made during settlement via an accepted Electronic Lodgement Network or at an approved settlement room.

To determine the land tax amount payable, you must use one of the following approved supporting documents:

- Current year land tax assessment notice. This can only be used if the settlement date is no later than the first instalment date listed on the notice. If payment is made after this date interest may apply.
- Clearance quote or settlement letter which shows the amount to clear.

The charge on the land will be considered removed upon payment of the amount shown on these documents

How do I get an updated certificate?

A certificate can be updated by re-processing the certificate through your Client Service Provider (CSP), or online at www.revenue.nsw.gov.au.

Please allow sufficient time for any payment to be processed prior to requesting a new version of the clearance certificate.

Land value, tax rates and thresholds

The taxable land value shown on the clearance certificate is the value used by Revenue NSW when assessing land tax. Details on land tax rates and thresholds are available at www.revenue.nsw.gov.au.

Contact details



Read more about Land Tax and use our online service at www.revenue.nsw.gov.au



1300 139 816*



Phone enquiries
8:30 am - 5:00 pm, Mon. to Fri.



landtax@revenue.nsw.gov.au

* Overseas customers call +61 2 7808 6906
Help in community languages is available.