

SPECIAL CONDITIONS

The following condition is part of the contract to which this Vendors Statement is annexed and subsequently entered into between the Vendor and any Purchaser. The condition shall take effect as a Special Condition notwithstanding any conflicting General Conditions set out in or incorporated by reference to the Contract

1. As Executors

The Vendors sell in their capacity as Executors in the Estate of Edward Wayne Roberts Deceased. Settlement will be on the due date or within 14 days of the Grant of Probate whichever is the later to occur.

2. IF THE PURCHASER IS A COMPANY:

The Guarantee referred to in General Condition 3 shall be in the form set out hereunder.

FORM OF GUARANTEE

(hereinafter called "the Guarantors") in consideration of the within named Vendor selling to the within named Purchaser at our request the land described in the within Contract for the price and upon the terms and conditions therein set forth do hereby for ourselves our respective executors and administrators jointly and severally covenant with the said Vendor that if at any time default shall be made in the payment of the deposit or residue of purchase money or interest or other monies payable by the Purchaser to the Vendor under the within Contract or in the performance or observance of any term or condition of the within Contract to be performed or observed by the Purchaser we will forthwith on demand by the Vendor pay to the Vendor the whole of such deposit residue of purchase money interest or other monies which shall then be due and payable to the Vendor and will keep the Vendor indemnified against all loss of purchase money interest and other monies payable under the within Contract and all losses costs charges and expenses whatsoever which the Vendor may incur by reason of any default as aforesaid on the part of the Purchaser. This Guarantee shall be a continuing Guarantee and shall not be released by any neglect or forbearance on the part of the Vendor in enforcing payment of any of the monies payable under the within Contract or the performance or observance of any of the agreements obligations or conditions under the within Contract or by time being given to the Purchaser for any such payment performance or observance or by any other thing which under the law relating to sureties would but for this provision have the effect of releasing us our executors or administrators.

DATED this day of 2021.

SIGNED SEALED AND DELIVERED by _____)

in the presence of: _____)

SIGNED SEALED AND DELIVERED by _____)

in the presence of: _____)

**VENDOR'S STATEMENT PURSUANT TO SECTION 32
OF THE SALE OF LAND ACT 1962**

This statement must be signed by the vendor and given to the purchaser before the purchaser signs the contract.

VENDOR **LISA GAY MITSON AND WAYNE GARETH ROBERTS AS EXECUTORS OF THE ESTATE OF EDWARD WAYNE ROBERTS**

PROPERTY **8 Evergreen Court, Mildura
(Lot 23 in Plan of Subdivision 212787N and being the land more particularly described in
Certificate of Title Volume 9835 Folio 184)**

1. FINANCIAL MATTERS

1.1 Particulars of any Rates, Taxes, Charges or Other Similar Outgoings (and any interest on them):

(a) Their amounts are as follows:

Authority	Amount	Interest (if any)
Lower Murray Water per quarter	\$175.05	
Mildura Rural City Council per annum	\$2,488.41	

(b) Amounts for which the purchaser may become liable as a consequence of the sale of which the vendor might reasonably be expected to have knowledge of, are as follows:

- (i) The purchaser will be liable for municipal, water, sewerage and drainage rates and charges from the date of settlement.
- (ii) The purchaser may also become liable for State Land Tax depending on the use to which the property is put and other properties owned by the purchaser.

1.2 Particulars of any Charges (whether registered or not) over the land imposed by or under an Act to secure an amount due under that Act, including the amount owing under the charge.

Nil.

1.3 Terms Contract

This section 1.3 only applies if the vendor statement is in respect of a terms contract where the purchaser is obliged to make 2 or more payments (other than a deposit or final payment) to the vendor after the execution of the contract and before the purchaser is entitled to a conveyance or transfer of the land, particulars are as follows:

Not applicable.

1.4 Sale Subject to Mortgage

This section 1.4 only applies if this vendor statement is in respect of a contract which provides that any mortgage (whether registered or unregistered), is NOT to be discharged before the purchaser becomes entitled to possession or to the receipt of rents and profits, are as follows:

Nil.

2. INSURANCE

2.1 Damage and Destruction

This section 2.1 only applies if this vendor statement is in respect of a contract which does NOT provide the land to remain at the risk of the vendor until the purchaser becomes entitled to possession or receipt of rents and profits.

Not applicable.

2.2 Owner-Builder

This section 2.2 only applies where there is a residence on the land that was constructed by an owner builder within the preceding 6 years and section 137B of the *Building Act 1993* applies to the residence.

Not applicable.

3. LAND USE

3.1 Easements, Covenants or Other Similar Restrictions

A description of any easement, covenant or other similar restriction affecting the land (whether registered or unregistered):

- (a) Are as set out in the attached copies of title documents otherwise none known to the vendor.
- (b) Particulars of any existing failure to comply with the terms of that easement, covenant or restriction are as follows:

To the best of the vendor's knowledge there is no existing failure to comply with the terms of any easement, covenant or similar restriction.

3.2 Road Access

There is access to the property by road.

3.3 Designated Bushfire Prone Area

The land is not in a bushfire prone area under section 192A of the *Building Act 1993*.

3.4 Planning Scheme

The required specified information is Attached is a certificate with the required specified information.

4. NOTICES

4.1 Notice, Order, Declaration, Report or Recommendation

Particulars of any notice, order, declaration, report or recommendation of a public authority or government department or approved proposal directly and currently affecting the land, being a notice, order, declaration, report, recommendation or approved proposal of which the vendor might reasonably be expected to have knowledge are as follows:

Nil.

4.2 Agricultural Chemicals

There are NO notices, property management plans, reports or orders in respect of the land issued by a government department or public authority in relation to livestock disease or contamination by agricultural chemicals affecting the ongoing use of the land for agricultural purposes. However, if this is not the case, the details of any such notices, property management plans, reports or orders, are as follows:

Nil.

4.3 Compulsory Acquisition

The particulars of any notice of intention to acquire served under section 6 of the *Land Acquisition and Compensation Act 1986* are as follows:

Nil.

5. BUILDING PERMITS

No building permits have been issued under the *Building Act 1993* in the preceding 7 years (required only where there is a residence on the land).

6. OWNERS CORPORATION

The land is not affected by an Owners Corporation within the meaning of the *Owners Corporations Act 2006*.

7. GROWTH AREAS INFRASTRUCTURE CONTRIBUTION ("GAIC")

Words and expressions in this section 7 have the same meaning as in Part 9B of the *Planning and Environment Act 1987*.

7.1 Work-in-Kind Agreement

There is no work-in-kind agreement (within the meaning of Part 9B of the *Planning and Environment Act 1987*).

7.2 GAIC Recording

The land is not affected by the GAIC.

8. SERVICES

The following services are **not** connected to the land:

- (a) gas supply
- (b) telephone services

9. TITLE

- 9.1 Attached is a copy of the Register Search Statement and the document, or part of the document, referred to as a "diagram location" in the Statement that identifies the land and its location.

10. DISCLOSURE OF ENERGY EFFICIENCY INFORMATION

There is no certificate relating to Energy Efficiency Information applicable.

11. DUE DILIGENCE CHECKLIST

The Sale of Land Act 1962 provides that the vendor or the vendor's licensed estate agent must make a prescribed due diligence checklist available to the purchasers before offering land for sale that is vacant residential land or land on which there is a residence. The due diligence checklist is NOT required to be provided with, or attached to, this vendor statement but the checklist may be attached as a matter of convenience.

The vendor makes this statement in respect of the land in accordance with section 32 of the *Sale of Land Act 1962*.

Date of this Statement: / /

Signature of the vendor:
Signed by Director/Secretary on behalf of Lisa Gay Mitson and Wayne Gareth Roberts
as Executors of the Estate of Edward Wayne Roberts

The purchaser acknowledges being given a duplicate of this statement signed by the vendor with the attached documents before the purchaser signed any contract.

Date of this Acknowledgment: / /

Signature of the purchaser:

Copyright State of Victoria. This publication is copyright. No part may be reproduced by any process except in accordance with the provisions of the Copyright Act 1968 (Cth) and for the purposes of Section 32 of the Sale of Land Act 1962 (Vic) or pursuant to a written agreement. The information is only valid at the time and in the form obtained from the LANDATA REGD TM System. None of the State of Victoria, LANDATA REGD TM System, Victorian Land Registry Services Pty. Ltd. ABN 86 627 986 396 as trustee for the Victorian Land Registry Services Trust ABN 83 206 746 897 accept responsibility for any subsequent release, publication or reproduction of the information.

REGISTER SEARCH STATEMENT (Title Search) Transfer of Land Act 1958

VOLUME 09835 FOLIO 184

Security no : 124088853876D
Produced 23/03/2021 03:43 PM

LAND DESCRIPTION

Lot 23 on Plan of Subdivision 212787N.
PARENT TITLES :
Volume 09772 Folio 417 Volume 09792 Folio 569
Created by instrument LP212787N 26/09/1988

REGISTERED PROPRIETOR

Estate Fee Simple
Sole Proprietor
EDWARD WAYNE ROBERTS of 16 GILBERT PLACE ALICE SPRINGS NT 0870
AC754276L 23/03/2004

ENCUMBRANCES, CAVEATS AND NOTICES

COVENANT N788617D 21/10/1988

Any encumbrances created by Section 98 Transfer of Land Act 1958 or Section 24 Subdivision Act 1988 and any other encumbrances shown or entered on the plan or imaged folio set out under DIAGRAM LOCATION below.

DIAGRAM LOCATION

SEE LP212787N FOR FURTHER DETAILS AND BOUNDARIES

ACTIVITY IN THE LAST 125 DAYS

NIL

-----END OF REGISTER SEARCH STATEMENT-----

Additional information: (not part of the Register Search Statement)

Street Address: 8 EVERGREEN COURT MILDURA VIC 3500

DOCUMENT END

Delivered from the LANDATA® System by InfoTrack Pty Ltd.

The information supplied by InfoTrack (InfinityLaw) has been obtained from InfoTrack Pty Limited by agreement between them. The information supplied has been obtained by InfoTrack Pty Limited who is licensed by the State of Victoria to provide this information via LANDATA® System.

[illegible]

MODIFICATION TABLE

RECORD OF ALL ADDITIONS OR CHANGES TO THE PLAN

PLAN NUMBER

LP212787N

[illegible]

Lodged at the Titles Office by

DAVID MESSENGER

Code 1252P

MADE AVAILABLE

TO ISSUE TO

DAVID MESSENGER

REGD

211088 1334 45 22 N788617D

VICTORIA

TRANSFER OF LAND

Subject to the encumbrances affecting the land including any created by dealings lodged for registration prior to the lodging of this instrument the transferor for the consideration expressed at the request and by the direction of the directing party (if any) transfers to the transferee the estate and the interest specified in the land described together with any easement hereby created and subject to any easement hereby reserved or restrictive covenant herein contained or covenant created pursuant to statute and included herein. (Notes 1-4)

Land

(Note 5)

Lot 23 on Plan of Subdivision No. 212787N Parish of Mildura being the whole of the land in Certificate of Title Volume 9835 Folio 184

Consideration

(Note 6)

Transferor

IBEL PTY. LTD.

STAMP DUTY VICTORIA (Note 7)
U#04C#1 S#1 T#000583 00096912 21/10/88
R#003121 D#44 \$346.00

Transferee

(Note 8)

MICHAEL WILLIAM KELLY and JEANETTE SUZANNE KELLY both of
28 Kiata Drive, Mildura as joint tenants

Estate and Interest

(Note 9)

All its estate and interest in the fee simple

Directing Party

(Note 10)

CODE: 44	Comptroller of Stamps Office of Titles Victoria
DUTY: 346	
\$...	
STATUS: ✓	
TYPE:	
VALUE: \$...	
ASSESSOR: [Signature]	

Creation (or Reservation) of Easement
and/or
Covenant

(Notes 11-12)

(Continued over page)

T2

Office Use Only



DN788617D-1-6

Approval No. T2/1

A memorandum of this instrument
has been entered in the Register Book.

AND THE SAID MICHAEL WILLIAM KELLY and JEANETTE SUZANNE KELLY shall enter into a Covenant with the said IBEL PTY. LTD. that they for themselves and their transferees the registered proprietors for the time being of the lot hereby transferred and of every part thereof DO HEREBY as a separate covenant COVENANT with the said IBEL PTY. LTD. and other the registered proprietor or proprietors for the time being of the land comprised in the said Plan of Subdivision and of every part thereof (other than the lot hereby transferred) as follows:

THAT they will not erect or cause or suffer to be erected upon the said Lot more than one main building being a dwelling house together with the usual outbuildings and that such building shall not be an apartment house, boarding house, hostel, lodging house, motel, residential club, residential hotel, office building, shop, warehouse, factory, public building or residential Flats or Units (save for a Two Flats Residential Development or Two units Residential Development on Lots 19, 24, 33) as defined in Part Six of the Victorian Building Regulations 1983 or any amendment modification or re-enactment thereof or any regulation made in substitution thereof whether made under the Local Government Act 1958 or otherwise howsoever and that such building and Lot or any part thereof (save for Lots 19, 24, 33) shall not be registered under the provisions of the Strata Titles Act 1967 or the Cluster Titles Act 1974 or any amendment, modification or re-enactment of or substitution for either of such Acts and that they will not at any time erect, construct, or build or cause to be erected or constructed or built on the said Lot or any part thereof any dwelling house (except for the usual outbuildings) with exterior walls of any material other than brick, brick veneer, stone, terra cotta block, solid or hollow concrete block or other similar building unit or a combination of same laid up unit by unit and set in mortar.

AND IT IS HEREBY AGREED AS FOLLOWS:

THAT the benefit of the foregoing covenant shall be attached to and run at law and in equity with the land comprised in the said Plan of Subdivision other than the land hereby transferred and that the burden thereof shall be annexed to and run at law and equity to the said land hereby transferred and that the same shall be noted and appear on every future Certificate of Title to the said Lot and every part thereof as an encumbrance affecting the said land and every part thereof.

Date 20TH OCTOBER 1988

(Note 13)

Execution and Attestation

(Note 14)

THE COMMON SEAL of IBEL PTY. LTD.

was hereunto affixed in the

presence of:

Donald O'Reilly
.....DIRECTOR

W. T. ...
.....SECRETARY



SIGNED by the Transferees in the)
presence of: .)

W. T. ...

W. Kelly
James ...



To The Registrar of Titles
Melbourne

Please register this dealing and on completion deliver C.T.V. 9835 F. 184

to lodging party,

return

to

GALLAGHER RYAN & MALONEY

per: *[Signature]*

NOTES

1. This form must be used for any transfer by the registered proprietor—
 - (a) of other than the whole of an estate and interest in fee simple
 - (b) by direction
 - (c) in which an easement is created or reserved
 - (d) which contains a restrictive covenant or a covenant created pursuant to statute.
2. Transfers may be lodged as an original only and must be typed or completed in ink.
3. All signatures must be in ink.
4. If there is insufficient space in any panel to accommodate the required information use an annexure sheet (Form A1) or (if there is space available) enter the information under the appropriate heading after any creation or reservation of easement or covenant. Insert only the words "See Annexure A" (or as the case may be) or "See overleaf" in the panel as appropriate.
Multiple annexures may appear on the same annexure sheet but each must be correctly headed.
All annexure sheets should be properly identified and signed by the parties and securely attached to the instrument.
5. Volume and folio references must be given. If the whole of the land in a title is to be transferred no other description should be used. If the transfer affects part only of the land in a title the lot and plan number or Crown description should also be given. Any necessary diagram should be endorsed hereon or on an annexure sheet (Form A1).
6. Set out the amount (in figures) or the nature of the consideration. If the transfer is by direction show the various considerations
e.g. \$ paid by B to A
\$ paid by C to B
In a transfer on sale of land subject to a mortgage it should be clearly shown whether or not the amount owing under the mortgage is included in the consideration e.g. \$ which includes the amount owing under mortgage No.
7. Insert full name. Address is not required.
8. Insert full name and address. If two or more transferees state whether as joint tenants or tenants in common. If tenants in common specify shares.
9. Set out "All my estate and interest in the fee simple" (or other as the case may be).
10. If the transfer is by direction give the full name of any directing party and show the various considerations under the consideration heading.
11. Set out any easement being created or reserved and define the dominant and servient tenements.
12. Set out full details of any covenant and define the covenantee and the land to bear the burden and to take the benefit of the covenant.
13. The transfer must be dated.
14. If an executing party is a natural person execution should read "Signed by the transferor (transferee, directing party) in the presence of". The witness must be an independent person. If an executing party is a body corporate execution should conform to any prescribed formalities relating to the affixing of the common seal.

Application by Legal Personal Representative

Section 49 Transfer of Land Act 1958

Privacy Collection Statement

The information from this form is collected under statutory authority and is used for the purpose of maintaining publicly searchable registers and indexes.

Lodged by:

Name: MARTIN MIDDLETON OATES LAWYERS

Phone: 03 5023 7900

Address: 61 Deakin Avenue
Mildura VIC 3500

Reference: IDS/LF/329854-1

Customer Code:

The applicant applies as legal personal representative of the deceased registered proprietor to be registered as the proprietor of the estate and interest of the deceased in the land described.

Land: (*volume and folio and if applicable mortgage, charge or lease*)

Volume 9835 Folio 184

Applicant: (*full name and address including postcode*)

LISA GAY MITSON of 20 Hull Place, Gunn, NT 0832 and WAYNE GARETH ROBERTS of 65 Wulagi Crescent, Wulagi, NT 0812

Representative capacity:

As Executors of the estate of the deceased

Deceased Registered Proprietor: (*full name*)

EDWARD WAYNE ROBERTS

Dated:

Signature of an Australian Legal Practitioner under the
Legal Profession Uniform Law (Vic) for the applicants

.....

Order to Register

Please register and issue the Certificate of Title to

APR

Signed

Customer Code

Page 1 of 1

THE BACK OF THIS FORM MUST NOT BE USED

Land Victoria, 570 Bourke Street, Melbourne, 3000. Phone: 8636-2010

Property Report from www.land.vic.gov.au on 24 March 2021 02:37 PM

Address: 8 EVERGREEN COURT MILDURA 3500

Lot and Plan Number: Lot 23 LP212787

Standard Parcel Identifier (SPI): 23\LP212787

Local Government (Council): MILDURA **Council Property Number:** 22436

Directory Reference: VicRoads 534 J8

This property is not in a designated bushfire prone area.

No special bushfire construction requirements apply. Planning provisions may apply.

Further information about the building control system and building in bushfire prone areas can be found in the Building Commission section of the Victorian Building Authority website www.vba.vic.gov.au

Site Dimensions

All dimensions and areas are approximate. They may not agree with the values shown on a title or plan.

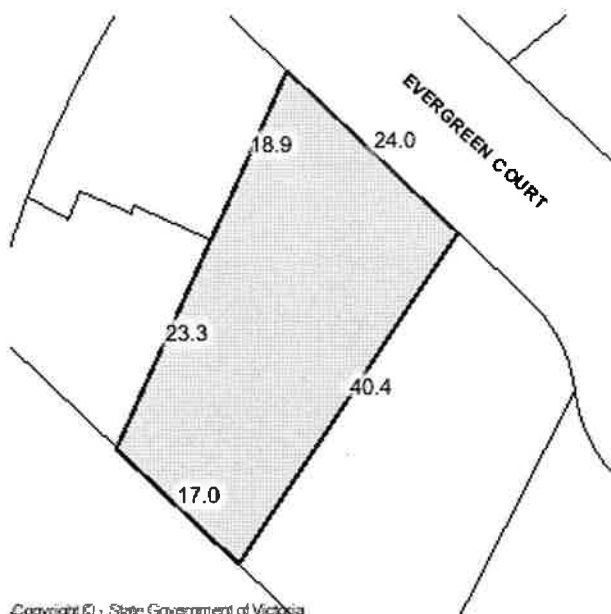

Area: 815 sq. m

Perimeter: 123 m

For this property:

- Site boundaries
- - - Road frontages

Dimensions for individual parcels require a separate search, but dimensions for individual units are generally not available.

For more accurate dimensions get copy of plan at [Title and Property Certificates](#)

State Electorates

Legislative Council: NORTHERN VICTORIA

Legislative Assembly: MILDURA

Utilities

Rural Water Corporation: Lower Murray Water

Urban Water Corporation: Lower Murray Water

Melbourne Water: outside drainage boundary

Power Distributor: POWERCOR (Information about [choosing an electricity retailer](#))

Planning information continued on next page

Copyright © - State Government of Victoria

Disclaimer: This content is provided for information purposes only. No claim is made as to the accuracy or authenticity of the content. The Victorian Government does not accept any liability to any person for the information provided. Read the full disclaimer at www.land.vic.gov.au/home/copyright-and-disclaimer

Planning Zone Summary

Planning Zone: GENERAL RESIDENTIAL ZONE (GRZ)
GENERAL RESIDENTIAL ZONE - SCHEDULE 1 (GRZ1)

Planning Overlays: DEVELOPMENT CONTRIBUTIONS PLAN OVERLAY (DCPO)
DEVELOPMENT CONTRIBUTIONS PLAN OVERLAY - SCHEDULE 1 (DCPO1)
DEVELOPMENT CONTRIBUTIONS PLAN OVERLAY - SCHEDULE 2 (DCPO2)
SPECIFIC CONTROLS OVERLAY (SCO)
SPECIFIC CONTROLS OVERLAY - SCHEDULE 1 (SCO1)

Planning scheme data last updated on 17 March 2021.

A **planning scheme** sets out policies and requirements for the use, development and protection of land. This report provides information about the zone and overlay provisions that apply to the selected land. Information about the State and local policy, particular, general and operational provisions of the local planning scheme that may affect the use of this land can be obtained by contacting the local council or by visiting [Planning Schemes Online](#). This report is NOT a **Planning Certificate** issued pursuant to Section 199 of the *Planning and Environment Act 1987*. It does not include information about exhibited planning scheme amendments, or zonings that may affect the land. To obtain a Planning Certificate go to [Titles and Property Certificates](#)

The Planning Property Report includes separate maps of zones and overlays
 For details of surrounding properties, use this service to get the Reports for properties of interest
 To view planning zones, overlay and heritage information in an interactive format visit [Planning Maps Online](#)
 For other information about planning in Victoria visit www.planning.vic.gov.au

Area Map

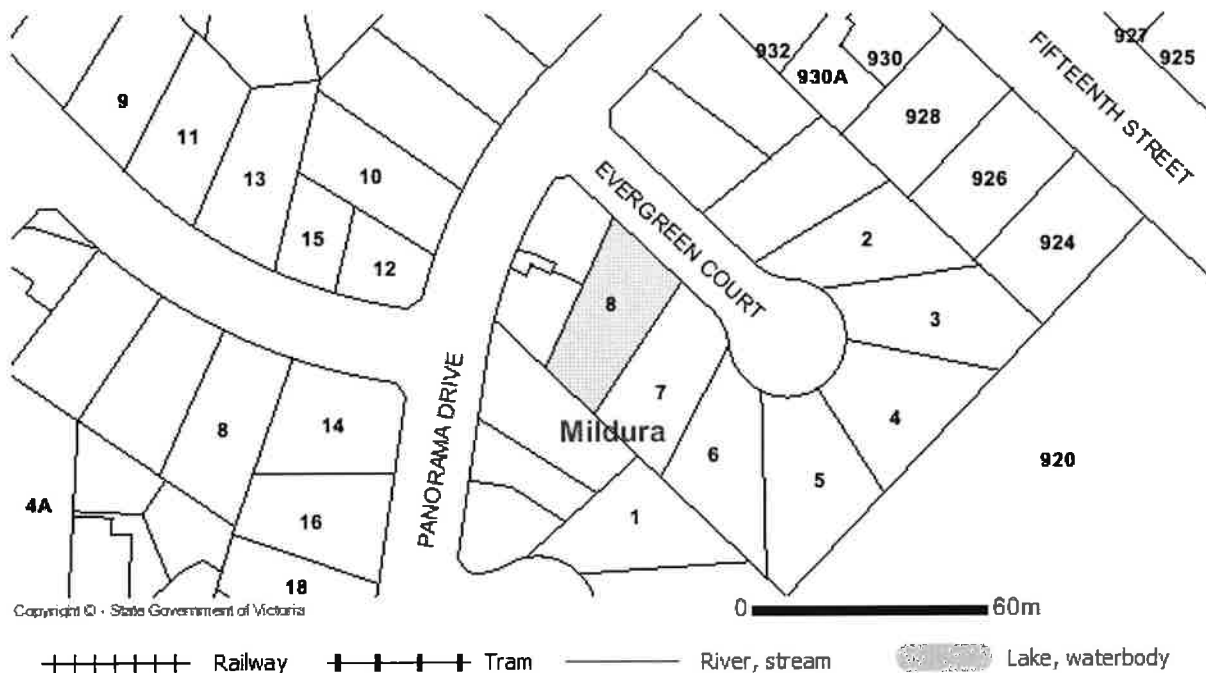

Copyright © - State Government of Victoria

Disclaimer: This content is provided for information purposes only. No claim is made as to the accuracy or authenticity of the content. The Victorian Government does not accept any liability to any person for the information provided. Read the full disclaimer at www.land.vic.gov.au/home/copyright-and-disclaimer

PLANNING PROPERTY REPORT



State
Government

Environment,
Land, Water
and Planning

From www.planning.vic.gov.au on 24 March 2021 02:35 PM

PROPERTY DETAILS

Address: **8 EVERGREEN COURT MILDURA 3500**
Lot and Plan Number: **Lot 23 LP212787**
Standard Parcel Identifier (SPI): **23\LP212787**
Local Government Area (Council): **MILDURA**
Council Property Number: **22436**
Planning Scheme: **Mildura**
Directory Reference: **VicRoads 534 J8**

www.mildura.vic.gov.au

planning-schemes.delwp.vic.gov.au/schemes/mildura

UTILITIES

Rural Water Corporation: **Lower Murray Water**
Urban Water Corporation: **Lower Murray Water**
Melbourne Water: **outside drainage boundary**
Power Distributor: **POWERCOR**

STATE ELECTORATES

Legislative Council: **NORTHERN VICTORIA**
Legislative Assembly: **MILDURA**

Planning Zones

GENERAL RESIDENTIAL ZONE (GRZ)

GENERAL RESIDENTIAL ZONE - SCHEDULE 1 (GRZ1)

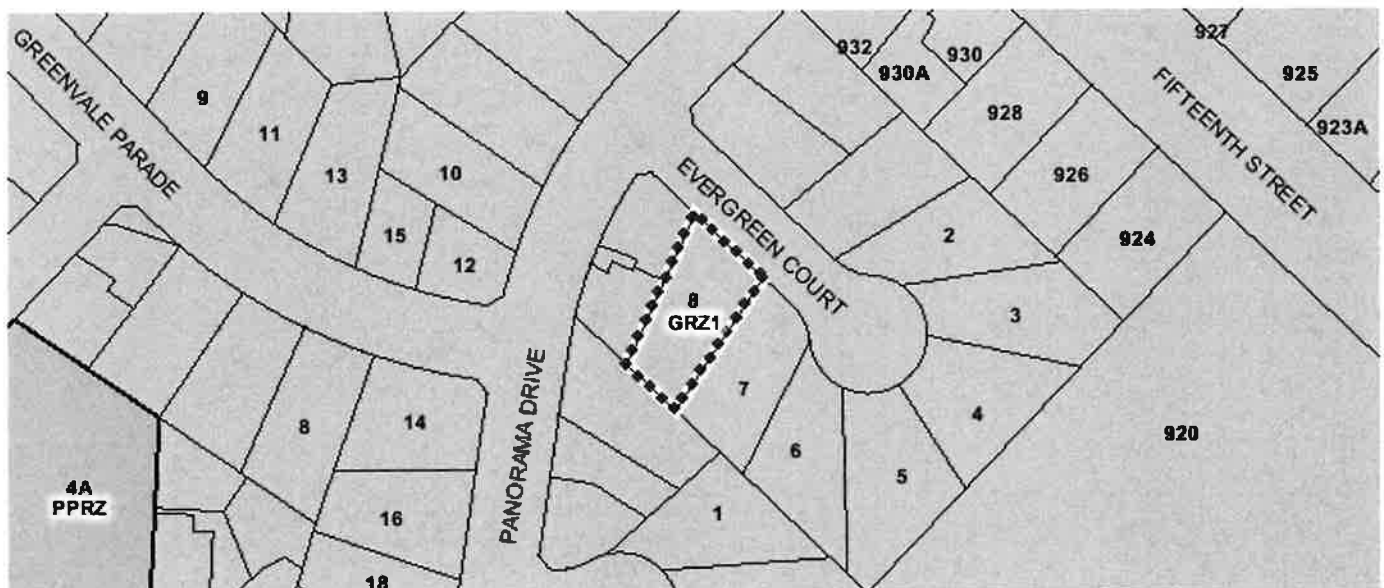

Copyright © - State Government of Victoria

0 60m

GRZ - General Residential PPRZ - Public Park & Recreation

Note: labels for zones may appear outside the actual zone - please compare the labels with the legend.

Copyright © - State Government of Victoria

Disclaimer: This content is provided for information purposes only. No claim is made as to the accuracy or authenticity of the content. The Victorian Government does not accept any liability to any person for the information provided. Read the full disclaimer at www.land.vic.gov.au/home/copyright-and-disclaimer

Notwithstanding this disclaimer, a vendor may rely on the information in this report for the purpose of a statement that land is in a bushfire prone area as required by section 32C (b) of the Sale of Land 1962 (Vic).

PLANNING PROPERTY REPORT: 8 EVERGREEN COURT MILDURA 3500

Page 1 of 4

Planning Overlays

DEVELOPMENT CONTRIBUTIONS PLAN OVERLAY (DCPO)

DEVELOPMENT CONTRIBUTIONS PLAN OVERLAY - SCHEDULE 1 (DCPO1)

DEVELOPMENT CONTRIBUTIONS PLAN OVERLAY - SCHEDULE 2 (DCPO2)

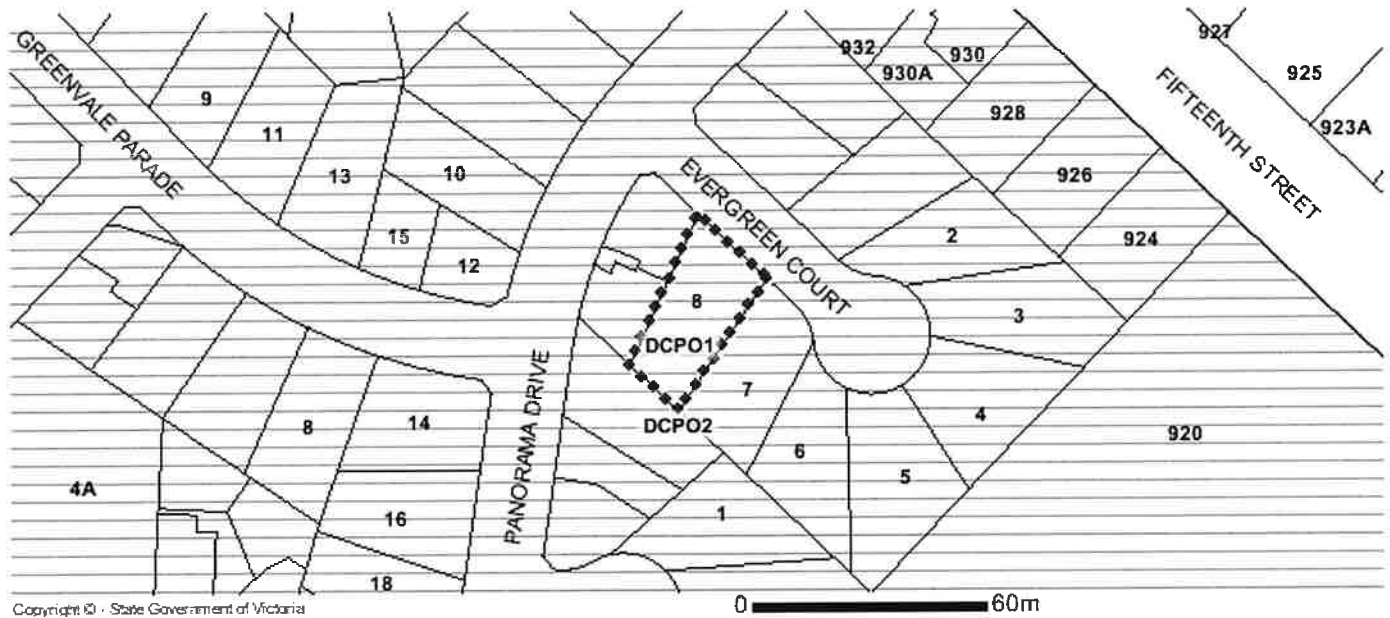

 DCPO - Development Contributions Plan

Note: due to overlaps, some overlays may not be visible, and some colours may not match those in the legend.

SPECIFIC CONTROLS OVERLAY (SCO)

SPECIFIC CONTROLS OVERLAY - SCHEDULE 1 (SCO1)

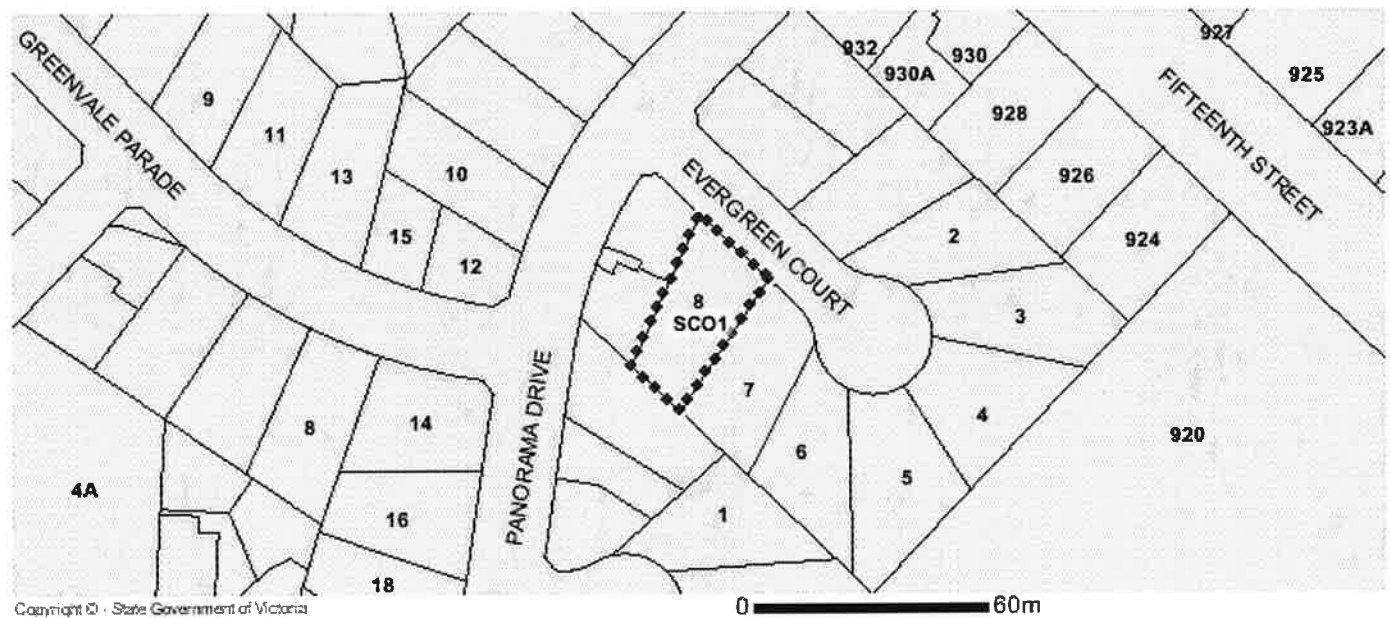

 SCO - Specific Controls

Note: due to overlaps, some overlays may not be visible, and some colours may not match those in the legend.

Further Planning Information

Planning scheme data last updated on 17 March 2021.

A **planning scheme** sets out policies and requirements for the use, development and protection of land. This report provides information about the zone and overlay provisions that apply to the selected land. Information about the State and local policy, particular, general and operational provisions of the local planning scheme that may affect the use of this land can be obtained by contacting the local council or by visiting <https://www.planning.vic.gov.au>

This report is NOT a **Planning Certificate** issued pursuant to Section 199 of the *Planning and Environment Act 1987*. It does not include information about exhibited planning scheme amendments, or zonings that may abut the land. To obtain a Planning Certificate go to Titles and Property Certificates at Landata - <https://www.landata.vic.gov.au>

For details of surrounding properties, use this service to get the Reports for properties of interest.

To view planning zones, overlay and heritage information in an interactive format visit <http://mapshare.maps.vic.gov.au/vicplan>

For other information about planning in Victoria visit <https://www.planning.vic.gov.au>

Designated Bushfire Prone Area

**This property is not in a designated bushfire prone area.
No special bushfire construction requirements apply. Planning provisions may apply.**

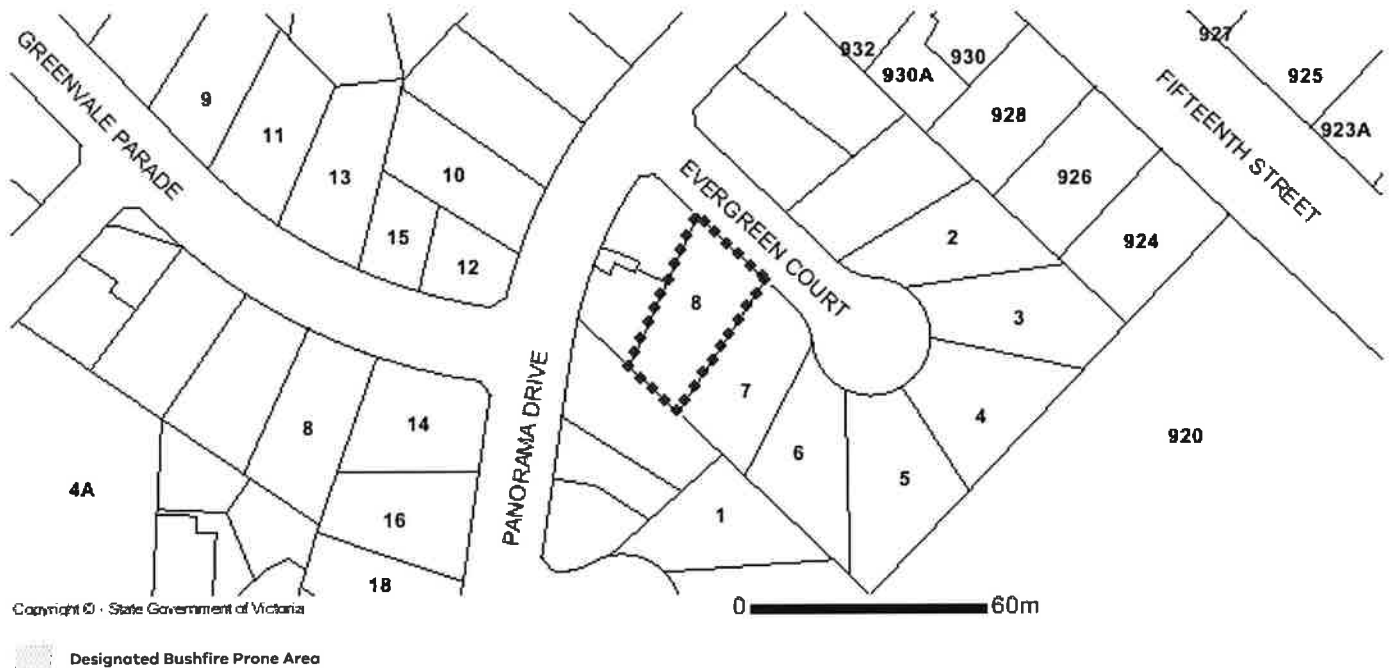

Designated bushfire prone areas as determined by the Minister for Planning are in effect from 8 September 2011 and amended from time to time.

The Building Regulations 2018 through application of the Building Code of Australia, apply bushfire protection standards for building works in designated bushfire prone areas.

Designated bushfire prone areas maps can be viewed on VicPlan at <http://mapshare.maps.vic.gov.au/vicplan> or at the relevant local council.

Note: prior to 8 September 2011, the whole of Victoria was designated as bushfire prone area for the purposes of the building control system.

Further information about the building control system and building in bushfire prone areas can be found on the Victorian Building Authority website www.vba.vic.gov.au

Copies of the Building Act and Building Regulations are available from www.legislation.vic.gov.au

For Planning Scheme Provisions in bushfire areas visit <https://www.planning.vic.gov.au>

Due diligence checklist

What you need to know before buying a residential property

Before you buy a home, you should be aware of a range of issues that may affect that property and impose restrictions or obligations on you, if you buy it. This checklist aims to help you identify whether any of these issues will affect you. The questions are a starting point only and you may need to seek professional advice to answer some of them. You can find links to organisations and web pages that can help you learn more, by visiting the [Due diligence checklist page on the Consumer Affairs Victoria website](http://consumer.vic.gov.au/duediligencechecklist) (consumer.vic.gov.au/duediligencechecklist).

Urban living

Moving to the inner city?

High density areas are attractive for their entertainment and service areas, but these activities create increased traffic as well as noise and odours from businesses and people. Familiarising yourself with the character of the area will give you a balanced understanding of what to expect.

Is the property subject to an owners corporation?

If the property is part of a subdivision with common property such as driveways or grounds, it may be subject to an owners corporation. You may be required to pay fees and follow rules that restrict what you can do on your property, such as a ban on pet ownership.

Growth areas

Are you moving to a growth area?

You should investigate whether you will be required to pay a growth areas infrastructure contribution.

Flood and fire risk

Does this property experience flooding or bushfire?

Properties are sometimes subject to the risk of fire and flooding due to their location. You should properly investigate these risks and consider their implications for land management, buildings and insurance premiums.

Rural properties

Moving to the country?

If you are looking at property in a rural zone, consider:

- Is the surrounding land use compatible with your lifestyle expectations? Farming can create noise or odour that may be at odds with your expectations of a rural lifestyle.
- Are you considering removing native vegetation? There are regulations which affect your ability to remove native vegetation on private property.
- Do you understand your obligations to manage weeds and pest animals?

Can you build new dwellings?

Does the property adjoin crown land, have a water frontage, contain a disused government road, or are there any crown licences associated with the land?

Is there any earth resource activity such as mining in the area?

You may wish to find out more about exploration, mining and quarrying activity on or near the property and consider the issue of petroleum, geothermal and greenhouse gas sequestration permits, leases and licences, extractive industry authorisations and mineral licences.

Soil and groundwater contamination

Has previous land use affected the soil or groundwater?

You should consider whether past activities, including the use of adjacent land, may have caused contamination at the site and whether this may prevent you from doing certain things to or on the land in the future.

Land boundaries

Do you know the exact boundary of the property?

You should compare the measurements shown on the title document with actual fences and buildings on the property, to make sure the boundaries match. If you have concerns about this, you can speak to your lawyer or conveyancer, or commission a site survey to establish property boundaries.

Planning controls

Can you change how the property is used, or the buildings on it?

All land is subject to a planning scheme, run by the local council. How the property is zoned and any overlays that may apply, will determine how the land can be used. This may restrict such things as whether you can build on vacant land or how you can alter or develop the land and its buildings over time.

The local council can give you advice about the planning scheme, as well as details of any other restrictions that may apply, such as design guidelines or bushfire safety design. There may also be restrictions – known as encumbrances – on the property's title, which prevent you from developing the property. You can find out about encumbrances by looking at the section 32 statement.

Are there any proposed or granted planning permits?

The local council can advise you if there are any proposed or issued planning permits for any properties close by. Significant developments in your area may change the local 'character' (predominant style of the area) and may increase noise or traffic near the property.

Safety

Is the building safe to live in?

Building laws are in place to ensure building safety. Professional building inspections can help you assess the property for electrical safety, possible illegal building work, adequate pool or spa fencing and the presence of asbestos, termites or other potential hazards.

Building permits

Have any buildings or retaining walls on the property been altered, or do you plan to alter them?

There are laws and regulations about how buildings and retaining walls are constructed, which you may wish to investigate to ensure any completed or proposed building work is approved. The local council may be able to give you information about any building permits issued for recent building works done to the property, and what you must do to plan new work. You can also commission a private building surveyor's assessment.

Are any recent building or renovation works covered by insurance?

Ask the vendor if there is any owner-builder insurance or builder's warranty to cover defects in the work done to the property.

Utilities and essential services

Does the property have working connections for water, sewerage, electricity, gas, telephone and internet?

Unconnected services may not be available, or may incur a fee to connect. You may also need to choose from a range of suppliers for these services. This may be particularly important in rural areas where some services are not available.

Buyers' rights

Do you know your rights when buying a property?

The contract of sale and section 32 statement contain important information about the property, so you should request to see these and read them thoroughly. Many people engage a lawyer or conveyancer to help them understand the contracts and ensure the sale goes through correctly. If you intend to hire a professional, you should consider speaking to them before you commit to the sale. There are also important rules about the way private sales and auctions are conducted. These may include a cooling-off period and specific rights associated with 'off the plan' sales. The important thing to remember is that, as the buyer, you have rights.

DATED

2021

LISA GAY MITSON AND WAYNE GARETH ROBERTS AS EXECUTORS OF THE ESTATE OF EDWARD WAYNE ROBERTS

VENDOR'S STATEMENT

Property
8 Evergreen Court, Mildura

MARTIN MIDDLETON OATES LAWYERS
61 Deakin Avenue
MILDURA VIC 3500
DX 50022 MILDURA
Tel: 03 5023 7900
Fax: 03 5023 7560
Ref: DCON/DS/333231-1