

32860 exclusive use – Triton Street Palm Cove

27. Carparking – Exclusive Use

27.1 In this by-law “Exclusive Use Area” means those areas specified in the attached plans marked 101 to 422.

27.2 Those Exclusive Use Areas identified in Schedule E are allocated to the Lots shown in Schedule E.

27.3 In respect of those Exclusive Use Areas which have not been allocated in Schedule E, the Original Owner will nominate to the Body Corporate within twelve (12) months after the date of registration of the Community Management Statement a Lot or Lots and the Exclusive Use Area allocated to each Lot or Lots.

27.4 An Owner of a Lot to which an Exclusive Use Area has been allocated is entitled to the exclusive use and enjoyment of the Exclusive Use Area allocated to that Lot for the purpose of Carparking only and:

- (1) are responsible for any maintenance or operating costs associated with this Exclusive Use area;
- (2) must not use the Exclusive Use Area for a workshop, trade or cottage industry purposes;
- (3) must not litter or use the Exclusive Use Area to create a nuisance to other Owners;
- (4) must regularly treat the Exclusive Use Area for vermin;
- (5) must maintain the Exclusive Use Area in good order and condition;
- (6) must not do anything in the Exclusive Use Area which would interfere to an unreasonably extent with the use and enjoyment of a Lot or the Common Property by an Owner; and
- (7) must not enclose the Exclusive Use Area.

Body Corporate for Triton Street - Palm Cove Community Titles Scheme 32860

SCHEDULE E DESCRIPTION OF LOTS ALLOCATED EXCLUSIVE USE AREAS OF COMMON PROPERTY

Lot on Plan	Exclusive Use of Area	Use	By-Law Requirement
Lot 101 on SP 167719	Area 101 on Level A on attached Sketch Plan marked "A"	Carparking	27
Lot 102 on SP 167719	Area 102 Level A on attached Sketch Plan marked "A"	Carparking	27
Lot 103 on SP 167719	Area 103 on Level A on attached Sketch Plan marked "A"	Carparking	27
Lot 104 on SP 167719	Area 104 on Level A on attached Sketch Plan marked "A"	Carparking	27
Lot 105 on SP 167719	Area 105 on Level A on attached Sketch Plan marked "A"	Carparking	27
Lot 106 on SP 167719	Area 106 on Level A on attached Sketch Plan marked "A"	Carparking	27
Lot 107 on SP 167719	Area 107 on Level A on attached Sketch Plan marked "A"	Carparking	27
Lot 108 on SP 167719	Area 108 on Level A on attached Sketch Plan marked "A"	Carparking	27
Lot 109 on SP 167719	Area 109 on Level A on attached Sketch Plan marked "A"	Carparking	27
Lot 110 on SP 167719	Area 110 on Level A on attached Sketch Plan marked "A"	Carparking	27
Lot 111 on SP 167719	Area 111 on Level A on attached Sketch Plan marked "A"	Carparking	27
Lot 112 on SP 167719	Area 112 on Level A on attached Sketch Plan marked "A"	Carparking	27
Lot 113 on SP 167719	Area 113 on Level A on attached Sketch Plan marked "A"	Carparking	27
Lot 114 on SP 167719	Area 114 on Level A on attached Sketch Plan marked "A"	Carparking	27
Lot 115 on SP 167719	Area 115 on Level A on attached Sketch Plan marked "A"	Carparking	27
Lot 116 on SP 167719	Area 116 on Level A on attached Sketch Plan marked "A"	Carparking	27
Lot 117 on SP 167719	Area 117 on Level A on attached Sketch Plan marked "A"	Carparking	27
Lot 118 on SP 167719	Area 118 on Level A on attached Sketch Plan marked "A"	Carparking	27
Lot 201 on SP 167719	Area 201 on Level A on attached Sketch Plan marked "A"	Carparking	27
Lot 202 on SP 167719	Area 202 on Level A on attached Sketch Plan marked "A"	Carparking	27
Lot 203 on SP 167719	Area 203 on Level A on attached Sketch Plan marked "A"	Carparking	27
Lot 204 on SP 167719	Area 204 on Level A on attached Sketch Plan marked "A"	Carparking	27
Lot 205 on SP 167719	Area 205 on Level A on attached Sketch Plan marked "A"	Carparking	27
Lot 206 on SP 167719	Area 206 on Level A on attached Sketch Plan marked "A"	Carparking	27
Lot 207 on SP 167719	Area 207 on Level A on attached Sketch Plan marked "A"	Carparking	27
Lot 208 on SP 167719	Area 208 on Level A on attached Sketch Plan marked "A"	Carparking	27
Lot 209 on SP 167719	Area 209 on Level A on attached Sketch Plan marked "A"	Carparking	27
Lot 210 on SP 167719	Area 210 on Level A on attached Sketch Plan marked "A"	Carparking	27

Body Corporate for Triton Street - Palm Cove Community Titles Scheme 32860

Lot 211 on SP 167719	Area 211 on Level A on attached Sketch Plan marked "A"	Carparking	27
Lot 212 on SP 167719	Area 212 on Level A on attached Sketch Plan marked "A"	Carparking	27
Lot 213 on SP 167719	Area 213 on Level A on attached Sketch Plan marked "A"	Carparking	27
Lot 214 on SP 167719	Area 214 on Level A on attached Sketch Plan marked "A"	Carparking	27
Lot 215 on SP 167719	Area 215 on Level A on attached Sketch Plan marked "A"	Carparking	27
Lot 216 on SP 167719	Area 216 on Level A on attached Sketch Plan marked "A"	Carparking	27
Lot 217 on SP 167719	Area 217 on Level A on attached Sketch Plan marked "A"	Carparking	27
Lot 218 on SP 167719	Area 218 on Level A on attached Sketch Plan marked "A"	Carparking	27
Lot 219 on SP 167719	Area 219 on Level A on attached Sketch Plan marked "A"	Carparking	27
Lot 220 on SP 167719	Area 220 on Level A on attached Sketch Plan marked "A"	Carparking	27
Lot 221 on SP 167719	Area 221 on Level A on attached Sketch Plan marked "A"	Carparking	27
Lot 222 on SP 167719	Area 222 on Level A on attached Sketch Plan marked "A"	Carparking	27
Lot 301 on SP 167719	Area 301 on Level A on attached Sketch Plan marked "A"	Carparking	27
Lot 302 on SP 167719	Area 302 on Level A on attached Sketch Plan marked "A"	Carparking	27
Lot 303 on SP 167719	Area 303 on Level A on attached Sketch Plan marked "A"	Carparking	27
Lot 304 on SP 167719	Area 304 on Level A on attached Sketch Plan marked "A"	Carparking	27
Lot 305 on SP 167719	Area 305 on Level A on attached Sketch Plan marked "A"	Carparking	27
Lot 306 on SP 167719	Area 306 on Level A on attached Sketch Plan marked "A"	Carparking	27
Lot 307 on SP 167719	Area 307 on Level A on attached Sketch Plan marked "A"	Carparking	27
Lot 308 on SP 167719	Area 308 on Level A on attached Sketch Plan marked "A"	Carparking	27
Lot 309 on SP 167719	Area 309 on Level A on attached Sketch Plan marked "A"	Carparking	27
Lot 310 on SP 167719	Area 310 on Level A on attached Sketch Plan marked "A"	Carparking	27
Lot 311 on SP 167719	Area 311 on Level A on attached Sketch Plan marked "A"	Carparking	27
Lot 312 on SP 167719	Area 312 on Level A on attached Sketch Plan marked "A"	Carparking	27
Lot 313 on SP 167719	Area 313 on Level A on attached Sketch Plan marked "A"	Carparking	27
Lot 314 on SP 167719	Area 314 on Level A on attached Sketch Plan marked "A"	Carparking	27
Lot 315 on SP 167719	Area 315 on Level A on attached Sketch Plan marked "A"	Carparking	27
Lot 316 on SP 167719	Area 316 on Level A on attached Sketch Plan marked "A"	Carparking	27
Lot 317 on SP 167719	Area 317 on Level A on attached Sketch Plan marked "A"	Carparking	27

Body Corporate for Triton Street - Palm Cove Community Titles Scheme 32860

Lot 318 on SP 167719	Area 318 on Level A on attached Sketch Plan marked "A"	Carparking	27
Lot 319 on SP 167719	Area 319 on Level A on attached Sketch Plan marked "A"	Carparking	27
Lot 320 on SP 167719	Area 320 on Level A on attached Sketch Plan marked "A"	Carparking	27
Lot 321 on SP 167719	Area 321 on Level A on attached Sketch Plan marked "A"	Carparking	27
Lot 322 on SP 167719	Area 322 on Level A on attached Sketch Plan marked "A"	Carparking	27
Lot 401 on SP 167719	Area 401 on Level A on attached Sketch Plan marked "A"	Carparking	27
Lot 402 on SP 167719	Area 402 on Level A on attached Sketch Plan marked "A"	Carparking	27
Lot 403 on SP 167719	Area 403 on Level A on attached Sketch Plan marked "A"	Carparking	27
Lot 404 on SP 167719	Area 404 on Level A on attached Sketch Plan marked "A"	Carparking	27
Lot 405 on SP 167719	Area 405 on Level A on attached Sketch Plan marked "A"	Carparking	27
Lot 406 on SP 167719	Area 406 on Level A on attached Sketch Plan marked "A"	Carparking	27
Lot 407 on SP 167719	Area 407 on Level A on attached Sketch Plan marked "A"	Carparking	27
Lot 408 on SP 167719	Area 408 on Level A on attached Sketch Plan marked "A"	Carparking	27
Lot 409 on SP 167719	Area 409 on Level A on attached Sketch Plan marked "A"	Carparking	27
Lot 410 on SP 167719	Area 410 on Level A on attached Sketch Plan marked "A"	Carparking	27
Lot 411 on SP 167719	Area 411 on Level A on attached Sketch Plan marked "A"	Carparking	27
Lot 412 on SP 167719	Area 412 on Level A on attached Sketch Plan marked "A"	Carparking	27
Lot 413 on SP 167719	Area 413 on Level A on attached Sketch Plan marked "A"	Carparking	27
Lot 414 on SP 167719	Area 414 on Level A on attached Sketch Plan marked "A"	Carparking	27
Lot 415 on SP 167719	Area 415 on Level A on attached Sketch Plan marked "A"	Carparking	27
Lot 416 on SP 167719	Area 416 on Level A on attached Sketch Plan marked "A"	Carparking	27
Lot 417 on SP 167719	Area 417 on Level A on attached Sketch Plan marked "A"	Carparking	27
Lot 418 on SP 167719	Area 418 on Level A on attached Sketch Plan marked "A"	Carparking	27
Lot 419 on SP 167719	Area 419 on Level A on attached Sketch Plan marked "A"	Carparking	27
Lot 420 on SP 167719	Area 420 on Level A on attached Sketch Plan marked "A"	Carparking	27
Lot 421 on SP 167719	Area 421 on Level A on attached Sketch Plan marked "A"	Carparking	27
Lot 422 on SP 167719	Area 422 on Level A on attached Sketch Plan marked "A"	Carparking	27

Sheet 1 of 3

SHEET _ OF _

"TRITON STREET - PALM COVE"
Community Titles Scheme
No. 32860

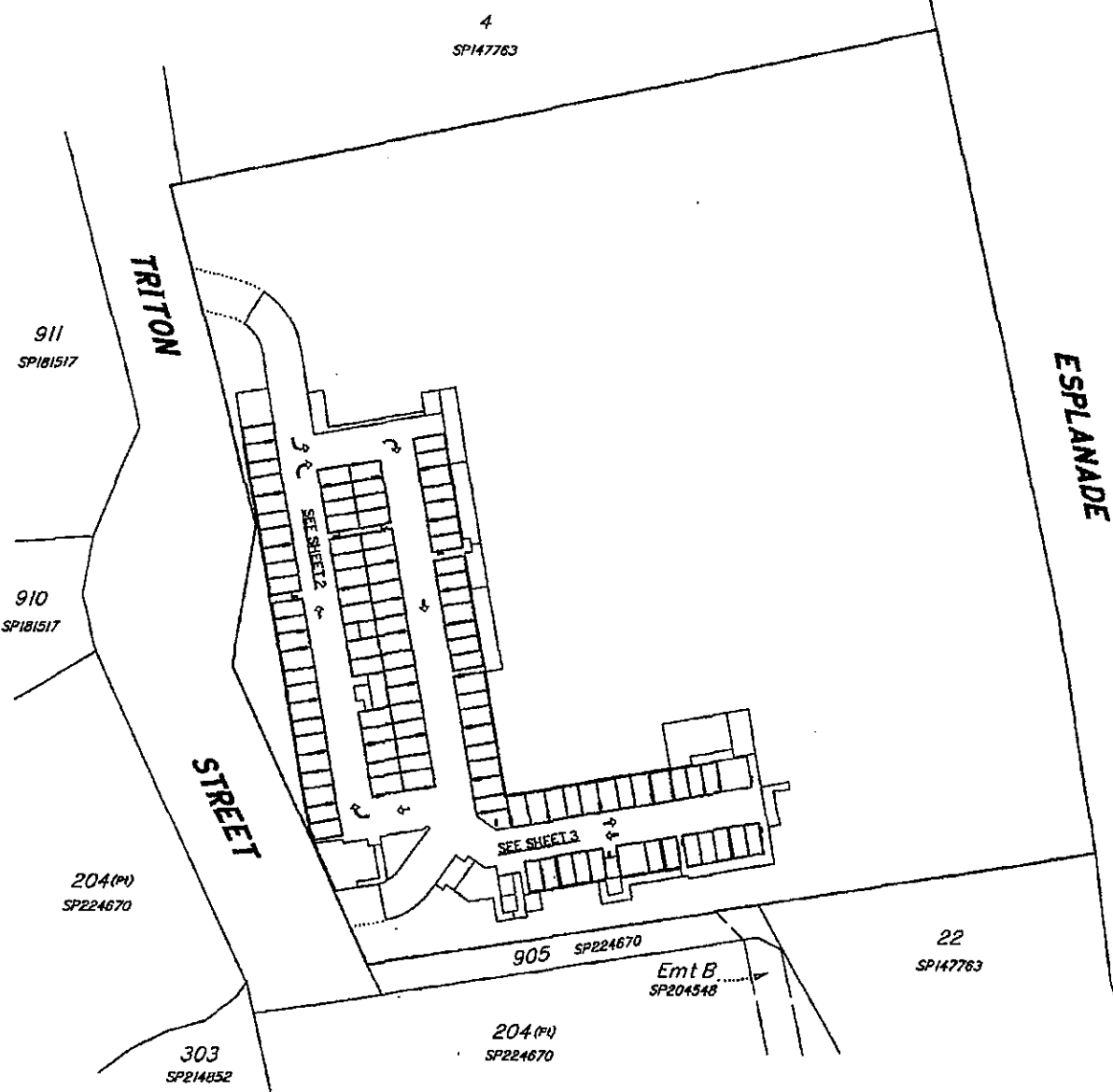

M. D. Dalgata
Authorised Delegate
12/07/10
Date

Scale 1:750 - Lengths are in Metres.

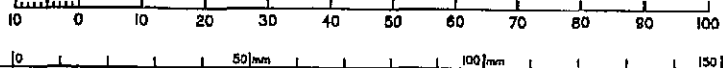

RPS Australia East Pty Ltd : ACN 140 292 762
135 Abbott St : PO Box 1949 : CAIRNS QLD 4870
T +61 7 4031 1336 : F +61 7 4031 2942
W rpsgroup.com.au

Sketch Plan of Exclusive Use Areas for Carpark Allocation

being part of Level A Common Property on SPI67719 for inclusion in Triton Street - Palm Cove Community Title Scheme No.

PARISH: **SMITHFIELD** COUNTY: **Nares**

Meridian: *Vide RP804083 Subtract 0°0'30" for CAM vide NR6114 Add 5°38'30" for AMG Zone 55*

F/N's: No

Scale: **1:750**

Format: **SKETCH**

Drawing No:
PR102845_01

Drawing File:
PR102845_01.DWG

SHEET OF

"TRITON STREET - PALM COVE"
Community Titles Scheme
No. 32860



Exclusive Use Areas are bounded by structural elements, unless otherwise stated.

TRITON STREET

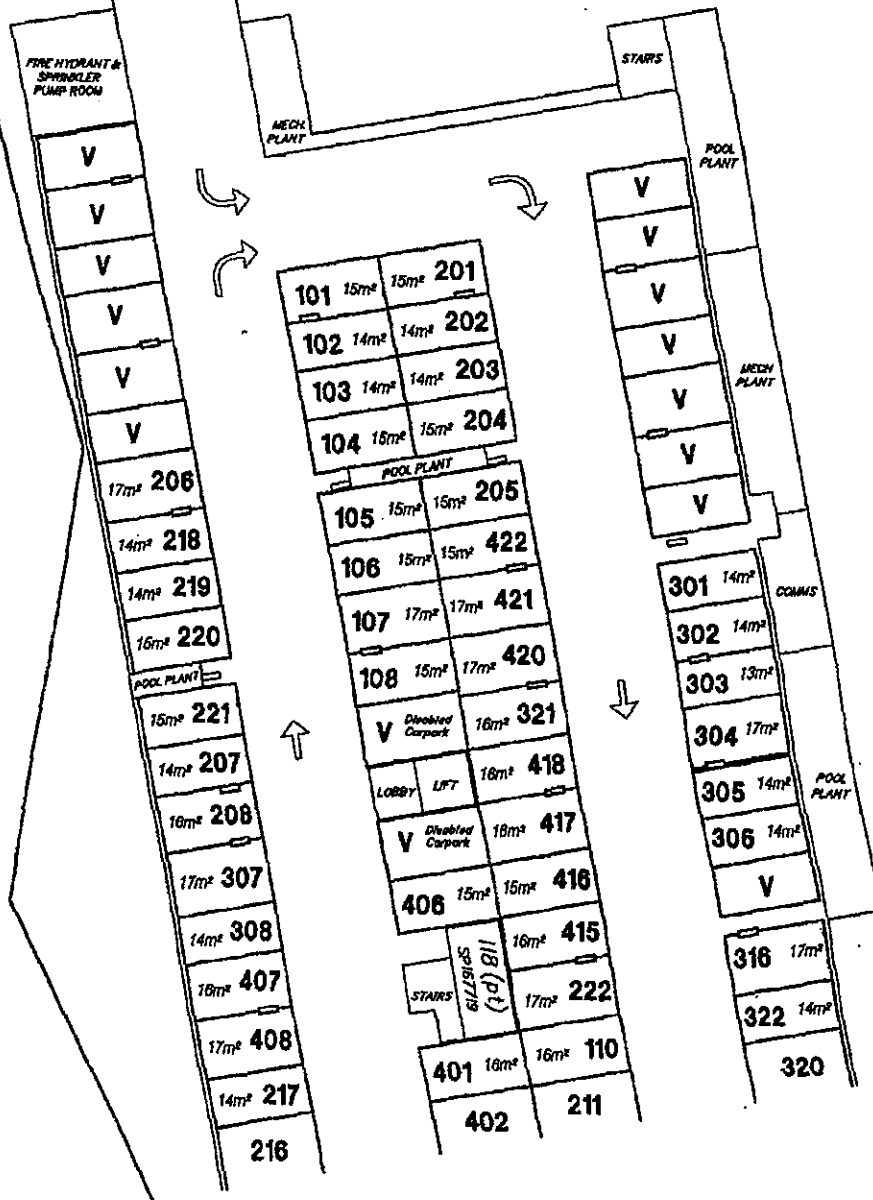

V - denotes Visitor Carpark

Scale 1:250 - Lengths are in Metres.

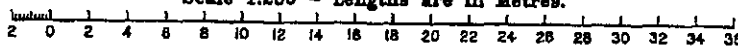

SHEET OF

"TRITON STREET - PALM COVE"
Community Titles Scheme
No. 32860

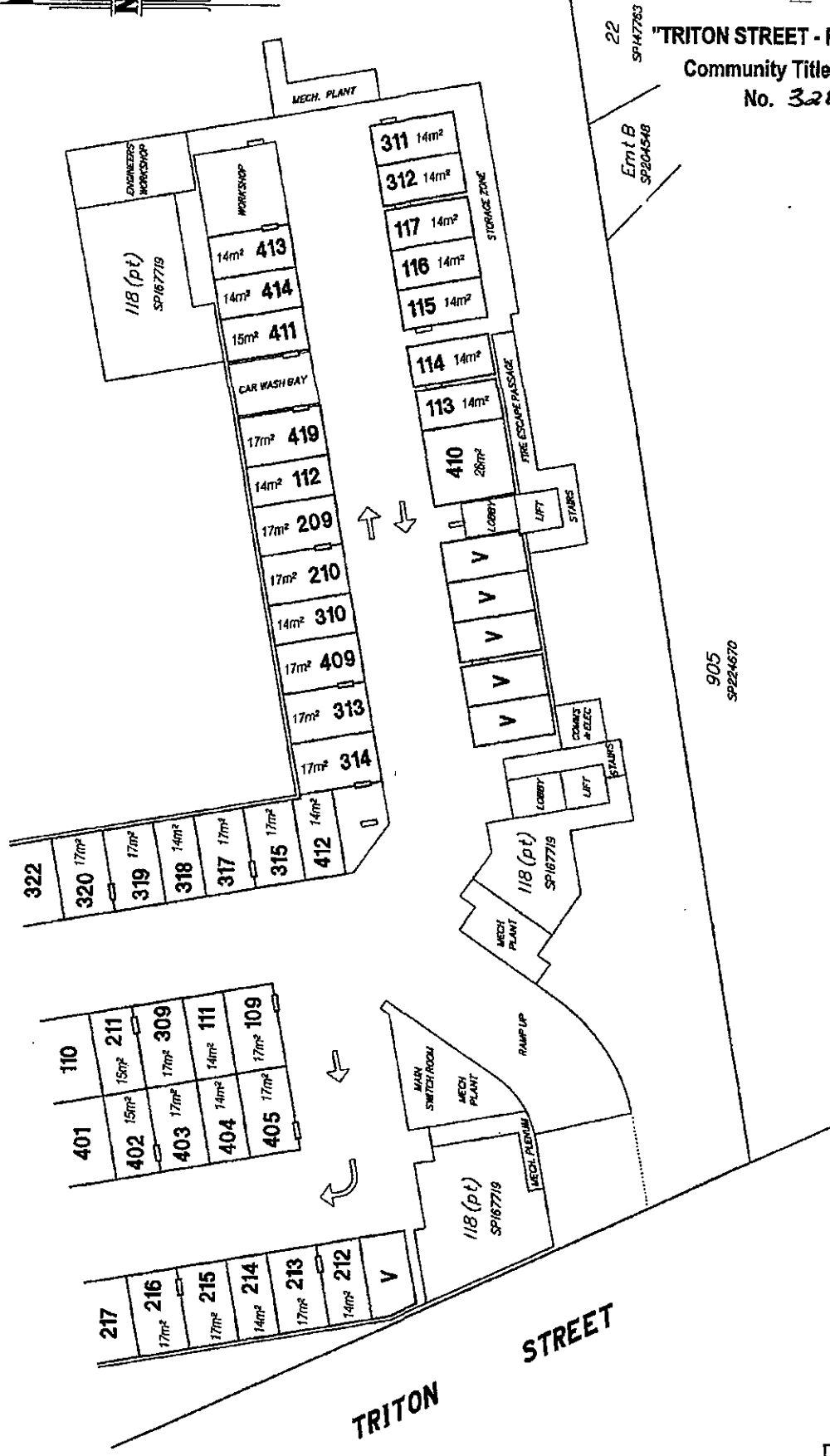

Exclusive Use Areas are bounded by structural elements, unless otherwise stated.

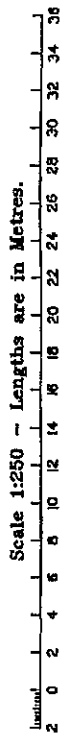

V - denotes Visitor Carpark