

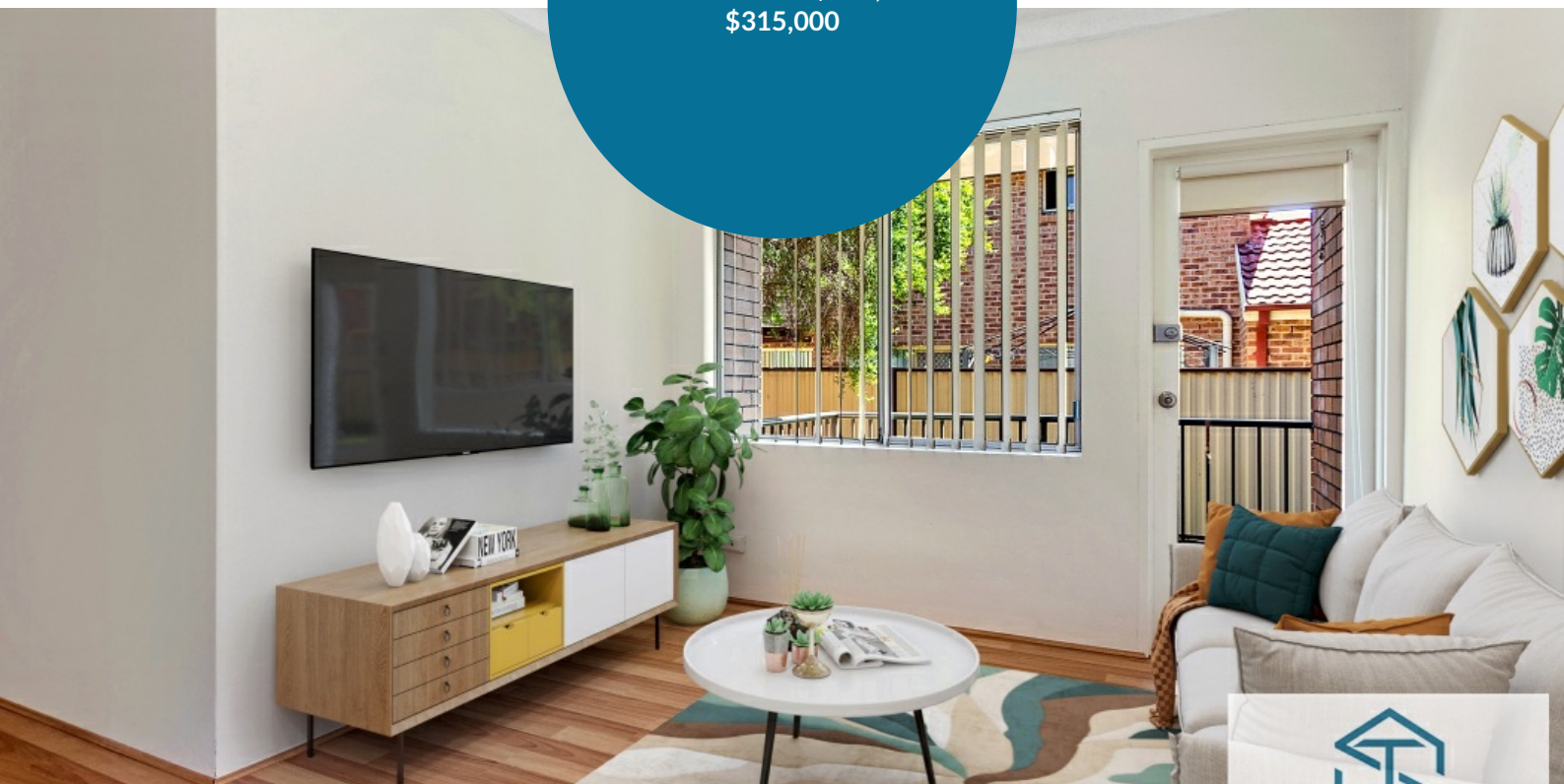

BUYERS GUIDE \$290,000 -
\$315,000



Lovely two-bedroom unit featuring lovely light timber floors, freshly renovated throughout including new Kitchen and bathroom.

4/45-47 Victoria Street, Werrington, NSW 2747



Greg
Taylor

0418 235 333



Justin
Cohen

0481 147 841

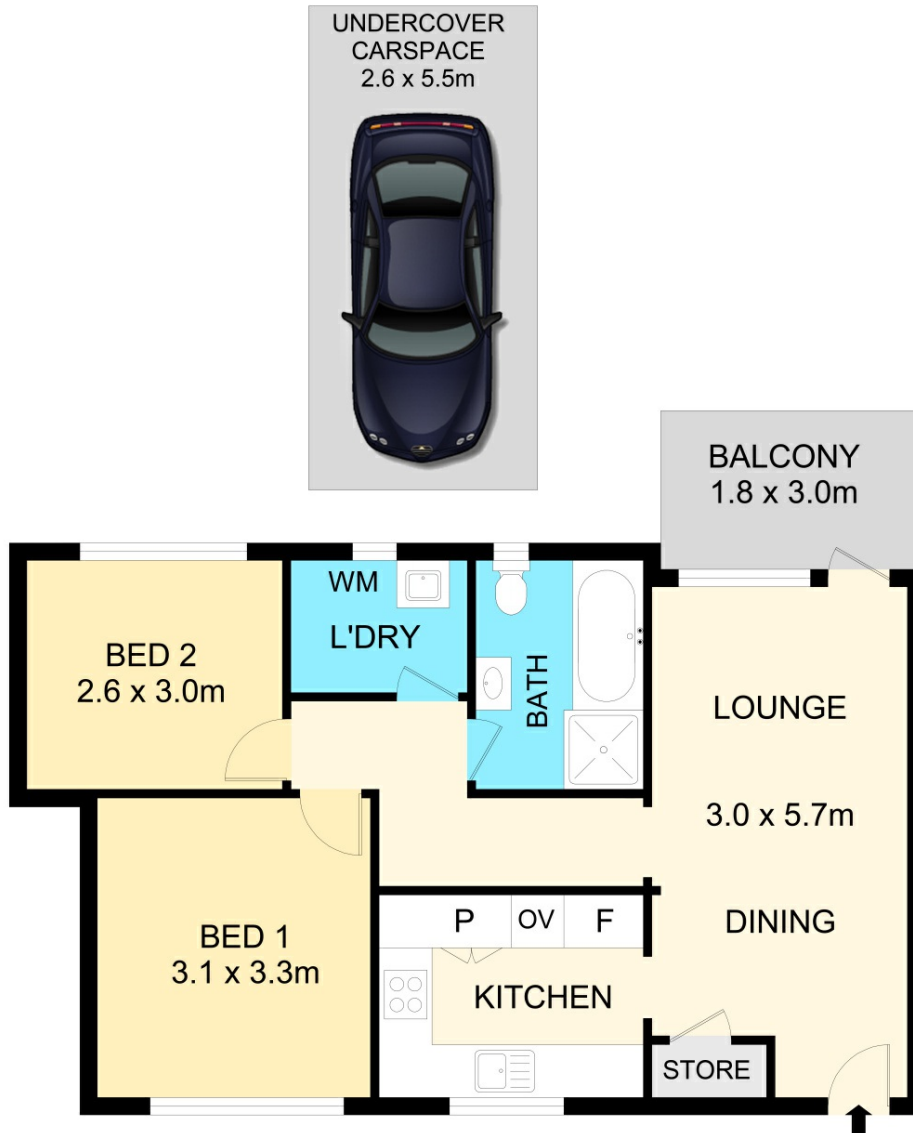

4/45-47 VICTORIA STREET,
WERRINGTON 2747

BALCONY AREA	:-	5 SQM
CARSPACE AREA	:-	14 SQM
RESIDENCE AREA	:-	57 SQM
TOTAL AREA	:-	76 SQM



Not to scale . All measurements are approximate . Drawn for marketing purposes only

4/45-47 Victoria Street, Werrington,
NSW 2747

2 1 1

* New kitchen and bathroom * Secure underground car space * located only 400m walk to Werrington Station * 83.5sqm total space including car space * Built in 1970 *Strata \$646.83 per quarter *Rent appraisal \$300 per week