

Contract for the sale and purchase of land 2019 edition

TERM	MEANING OF TERM	NSW DAN:
vendor's agent	Waters & Carpenter Auburn 112 South Parade, Auburn, NSW 2144	Phone: 02 9649 0238 Fax: 02 9643 1400
co-agent		
vendor	Melinda Ner 16 Manuka Street, Constitution Hill, NSW 2145	
vendor's solicitor	Auburn Lawyers 1, 115 Auburn Road, Auburn NSW 2144 PO Box 406, Auburn NSW 1835	Phone: 0416077696 Email: mhasan@auburnlawyers.com.au Fax: 02 8065 9243 Ref: MH:00111052/21
date for completion	42nd day after the contract date	(clause 15)
land (address, plan details and title reference)	16 Manuka Street, Constitution Hill, New South Wales 2145 Registered Plan: Lot 3 Plan DP 568438 Folio Identifier 3/568438	
improvements	<input type="checkbox"/> VACANT POSSESSION <input type="checkbox"/> subject to existing tenancies <input checked="" type="checkbox"/> HOUSE <input type="checkbox"/> garage <input type="checkbox"/> carport <input type="checkbox"/> home unit <input type="checkbox"/> carspace <input type="checkbox"/> storage space <input type="checkbox"/> none <input type="checkbox"/> other:	
attached copies	<input type="checkbox"/> documents in the List of Documents as marked or as numbered: <input type="checkbox"/> other documents:	

A real estate agent is permitted by legislation to fill up the items in this box in a sale of residential property.

inclusions	<input type="checkbox"/> blinds <input type="checkbox"/> dishwasher <input type="checkbox"/> light fittings <input type="checkbox"/> stove <input type="checkbox"/> built-in wardrobes <input type="checkbox"/> fixed floor coverings <input type="checkbox"/> range hood <input type="checkbox"/> pool equipment <input type="checkbox"/> clothes line <input type="checkbox"/> insect screens <input type="checkbox"/> solar panels <input type="checkbox"/> TV antenna <input type="checkbox"/> curtains <input type="checkbox"/> other:
exclusions	
purchaser	
purchaser's solicitor	
price	\$
deposit	\$ (10% of the price, unless otherwise stated)
balance	\$
contract date	(if not stated, the date this contract was made)

buyer's agent

vendor <hr/> purchaser	<div style="border: 1px solid black; padding: 5px; width: fit-content;"> GST AMOUNT (optional) The price includes GST of: \$ </div>	witness <hr/> witness
<input type="checkbox"/> JOINT TENANTS <input type="checkbox"/> tenants in common <input type="checkbox"/> in unequal shares		

Choices

Vendor agrees to accept a *deposit-bond* (clause 3) NO yes

Nominated *Electronic Lodgment Network (ELN)* (clause 30): _____

Electronic transaction (clause 30)

no YES

(if no, vendor must provide further details, such as the proposed applicable waiver, in the space below, or *serve within 14 days* of the contract date):

Tax information (the parties promise this is correct as far as each party is aware)

Land tax is adjustable

NO yes

GST: Taxable supply

NO yes in full yes to an extent

Margin scheme will be used in making the taxable supply

NO yes

This sale is not a taxable supply because (one or more of the following may apply) the sale is:

- not made in the course or furtherance of an enterprise that the vendor carries on (section 9-5(b))
- by a vendor who is neither registered nor required to be registered for GST (section 9-5(d))
- GST-free because the sale is the supply of a going concern under section 38-325
- GST-free because the sale is subdivided farm land or farm land supplied for farming under Subdivision 38-O
- input taxed because the sale is of eligible residential premises (sections 40-65, 40-75(2) and 195-1)

Purchaser must make a *GSTRW payment* (GST residential withholding payment)

NO yes (if yes, vendor must provide further details)

If the further details below are not fully completed at the contract date, the vendor must provide all these details in a separate notice *within 14 days* of the contract date.

GSTRW payment (GST residential withholding payment) – further details

Frequently the supplier will be the vendor. However, sometimes further information will be required as to which entity is liable for GST, for example, if the supplier is a partnership, a trust, part of a GST group or a participant in a GST joint venture.

Supplier's name:

Supplier's ABN:

Supplier's GST branch address (if applicable):

Supplier's business address:

Supplier's email address:

Supplier's phone number:

Supplier's proportion of *GSTRW payment*:

If more than one supplier, provide the above details for each supplier.

Amount purchaser must pay – price multiplied by the *GSTRW rate* (residential withholding rate):

Amount must be paid: AT COMPLETION at another time (specify):

Is any of the consideration not expressed as an amount in money? NO yes

If "yes", the GST inclusive market value of the non-monetary consideration: \$

Other details (including those required by regulation or the ATO forms):

List of Documents

General	Strata or community title (clause 23 of the contract)
<input type="checkbox"/> 1 property certificate for the land	<input type="checkbox"/> 32 property certificate for strata common property
<input type="checkbox"/> 2 plan of the land	<input type="checkbox"/> 33 plan creating strata common property
<input type="checkbox"/> 3 unregistered plan of the land	<input type="checkbox"/> 34 strata by-laws
<input type="checkbox"/> 4 plan of land to be subdivided	<input type="checkbox"/> 35 strata development contract or statement
<input type="checkbox"/> 5 document that is to be lodged with a relevant plan	<input type="checkbox"/> 36 strata management statement
<input type="checkbox"/> 6 section 10.7(2) planning certificate under Environmental Planning and Assessment Act 1979	<input type="checkbox"/> 37 strata renewal proposal
<input type="checkbox"/> 7 additional information included in that certificate under section 10.7(5)	<input type="checkbox"/> 38 strata renewal plan
<input type="checkbox"/> 8 sewerage infrastructure location diagram (service location diagram)	<input type="checkbox"/> 39 leasehold strata - lease of lot and common property
<input type="checkbox"/> 9 sewer lines location diagram (sewerage service diagram)	<input type="checkbox"/> 40 property certificate for neighbourhood property
<input type="checkbox"/> 10 document that created or may have created an easement, profit à prendre, restriction on use or positive covenant disclosed in this contract	<input type="checkbox"/> 41 plan creating neighbourhood property
<input type="checkbox"/> 11 <i>planning agreement</i>	<input type="checkbox"/> 42 neighbourhood development contract
<input type="checkbox"/> 12 section 88G certificate (positive covenant)	<input type="checkbox"/> 43 neighbourhood management statement
<input type="checkbox"/> 13 survey report	<input type="checkbox"/> 44 property certificate for precinct property
<input type="checkbox"/> 14 building information certificate or building certificate given under <i>legislation</i>	<input type="checkbox"/> 45 plan creating precinct property
<input type="checkbox"/> 15 lease (with every relevant memorandum or variation)	<input type="checkbox"/> 46 precinct development contract
<input type="checkbox"/> 16 other document relevant to tenancies	<input type="checkbox"/> 47 precinct management statement
<input type="checkbox"/> 17 licence benefiting the land	<input type="checkbox"/> 48 property certificate for community property
<input type="checkbox"/> 18 old system document	<input type="checkbox"/> 49 plan creating community property
<input type="checkbox"/> 19 Crown purchase statement of account	<input type="checkbox"/> 50 community development contract
<input type="checkbox"/> 20 building management statement	<input type="checkbox"/> 51 community management statement
<input type="checkbox"/> 21 form of requisitions	<input type="checkbox"/> 52 document disclosing a change of by-laws
<input type="checkbox"/> 22 <i>clearance certificate</i>	<input type="checkbox"/> 53 document disclosing a change in a development or management contract or statement
<input type="checkbox"/> 23 land tax certificate	<input type="checkbox"/> 54 document disclosing a change in boundaries
Home Building Act 1989	<input type="checkbox"/> 55 information certificate under Strata Schemes Management Act 2015
<input type="checkbox"/> 24 insurance certificate	<input type="checkbox"/> 56 information certificate under Community Land Management Act 1989
<input type="checkbox"/> 25 brochure or warning	<input type="checkbox"/> 57 disclosure statement - off the plan contract
<input type="checkbox"/> 26 evidence of alternative indemnity cover	<input type="checkbox"/> 58 other document relevant to off the plan contract
Swimming Pools Act 1992	Other
<input type="checkbox"/> 27 certificate of compliance	<input type="checkbox"/> 59
<input type="checkbox"/> 28 evidence of registration	
<input type="checkbox"/> 29 relevant occupation certificate	
<input type="checkbox"/> 30 certificate of non-compliance	
<input type="checkbox"/> 31 detailed reasons of non-compliance	

HOLDER OF STRATA OR COMMUNITY TITLE RECORDS – Name, address, email address and telephone number

IMPORTANT NOTICE TO VENDORS AND PURCHASERS

Before signing this contract you should ensure that you understand your rights and obligations, some of which are not written in this contract but are implied by law.

WARNING—SMOKE ALARMS

The owners of certain types of buildings and strata lots must have smoke alarms (or in certain cases heat alarms) installed in the building or lot in accordance with regulations under the *Environmental Planning and Assessment Act 1979*. It is an offence not to comply. It is also an offence to remove or interfere with a smoke alarm or heat alarm. Penalties apply.

WARNING—LOOSE-FILL ASBESTOS INSULATION

Before purchasing land that includes any residential premises (within the meaning of Division 1A of Part 8 of the *Home Building Act 1989*) built before 1985, a purchaser is strongly advised to consider the possibility that the premises may contain loose-fill asbestos insulation (within the meaning of Division 1A of Part 8 of the *Home Building Act 1989*). In particular, a purchaser should:

- (a) search the Register required to be maintained under Division 1A of Part 8 of the *Home Building Act 1989*, and
- (b) ask the relevant local council whether it holds any records showing that the residential premises contain loose-fill asbestos insulation.

For further information about loose-fill asbestos insulation (including areas in which residential premises have been identified as containing loose-fill asbestos insulation), contact NSW Fair Trading.

76 MANUKA

COOLING OFF PERIOD (PURCHASER'S RIGHTS)

1. This is the statement required by section 66X of the *Conveyancing Act 1919* and applies to a contract for the sale of residential property.
2. EXCEPT in the circumstances listed in paragraph 3, the purchaser may rescind the contract at any time before 5 pm on—
 - (a) the tenth business day after the day on which the contract was made—in the case of an off the plan contract, or
 - (b) the fifth business day after the day on which the contract was made—in any other case.
3. There is NO COOLING OFF PERIOD:
 - (a) if, at or before the time the contract is made, the purchaser gives to the vendor (or the vendor's solicitor or agent) a certificate that complies with section 66W of the Act, or
 - (b) if the property is sold by public auction, or
 - (c) if the contract is made on the same day as the property was offered for sale by public auction but passed in, or
 - (d) if the contract is made in consequence of the exercise of an option to purchase the property, other than an option that is void under section 66ZG of the Act.
4. A purchaser exercising the right to cool off by rescinding the contract will forfeit to the vendor 0.25% of the purchase price of the property. The vendor is entitled to recover the amount forfeited from any amount paid by the purchaser as a deposit under the contract and the purchaser is entitled to a refund of any balance.

DISPUTES

If you get into a dispute with the other party, the Law Society and Real Estate Institute encourage you to use informal procedures such as negotiation, independent expert appraisal, the Law Society Conveyancing Dispute Resolution Scheme or mediation (for example mediation under the Law Society Mediation Program).

AUCTIONS

Regulations made under the Property, Stock and Business Agents Act 2002 prescribe a number of conditions applying to sales by auction.

WARNINGS

1. Various Acts of Parliament and other matters can affect the rights of the parties to this contract. Some important matters are actions, claims, decisions, licences, notices, orders, proposals or rights of way involving:

<p>APA Group Australian Taxation Office Council County Council Department of Planning, Industry and Environment Department of Primary Industries Electricity and gas Land & Housing Corporation Local Land Services</p>	<p>NSW Department of Education NSW Fair Trading Owner of adjoining land Privacy Public Works Advisory Subsidence Advisory NSW Telecommunications Transport for NSW Water, sewerage or drainage authority</p>
---	--

If you think that any of these matters affects the property, tell your solicitor.
2. A lease may be affected by the Agricultural Tenancies Act 1990, the Residential Tenancies Act 2010 or the Retail Leases Act 1994.
3. If any purchase money is owing to the Crown, it will become payable before obtaining consent, or if no consent is needed, when the transfer is registered.
4. If a consent to transfer is required under legislation, see clause 27 as to the obligations of the parties.
5. The vendor should continue the vendor's insurance until completion. If the vendor wants to give the purchaser possession before completion, the vendor should first ask the insurer to confirm this will not affect the insurance.
6. The purchaser will usually have to pay transfer duty (and sometimes surcharge purchaser duty) on this contract. If duty is not paid on time, a purchaser may incur penalties.
7. If the purchaser agrees to the release of deposit, the purchaser's right to recover the deposit may stand behind the rights of others (for example the vendor's mortgagee).
8. The purchaser should arrange insurance as appropriate.
9. Some transactions involving personal property may be affected by the Personal Property Securities Act 2009.
10. A purchaser should be satisfied that finance will be available at the time of completing the purchase.
11. Where the market value of the property is at or above a legislated amount, the purchaser may have to comply with a foreign resident capital gains withholding payment obligation (even if the vendor is not a foreign resident). If so, this will affect the amount available to the vendor on completion.
12. Purchasers of some residential properties may have to withhold part of the purchase price to be credited towards the GST liability of the vendor. If so, this will also affect the amount available to the vendor. More information is available from the ATO.

The vendor sells and the purchaser buys the *property* for the price under these provisions instead of Schedule 3 Conveyancing Act 1919, subject to any *legislation* that cannot be excluded.

1 Definitions (a term in italics is a defined term)

In this contract, these terms (in any form) mean –

<i>adjustment date</i>	the earlier of the giving of possession to the purchaser or completion;
<i>bank</i>	the Reserve Bank of Australia or an authorised deposit-taking institution which is a bank, a building society or a credit union;
<i>business day</i>	any day except a bank or public holiday throughout NSW or a Saturday or Sunday;
<i>cheque</i>	a cheque that is not postdated or stale;
<i>clearance certificate</i>	a certificate within the meaning of s14-220 of Schedule 1 to the <i>TA Act</i> , that covers one or more days falling within the period from and including the contract date to completion;
<i>deposit-bond</i>	a deposit bond or guarantee from an issuer, with an expiry date and for an amount each approved by the vendor;
<i>depositholder</i>	vendor's agent (or if no vendor's agent is named in this contract, the vendor's <i>solicitor</i> , or if no vendor's <i>solicitor</i> is named in this contract, the buyer's agent);
<i>document of title</i>	document relevant to the title or the passing of title;
<i>FRCGW percentage</i>	the percentage mentioned in s14-200(3)(a) of Schedule 1 to the <i>TA Act</i> (12.5% as at 1 July 2017);
<i>FRCGW remittance</i>	a remittance which the purchaser must make under s14-200 of Schedule 1 to the <i>TA Act</i> , being the lesser of the <i>FRCGW percentage</i> of the price (inclusive of GST, if any) and the amount specified in a <i>variation served by a party</i> ;
<i>GST Act</i>	A New Tax System (Goods and Services Tax) Act 1999;
<i>GST rate</i>	the rate mentioned in s4 of A New Tax System (Goods and Services Tax Imposition - General) Act 1999 (10% as at 1 July 2000);
<i>GSTRW payment</i>	a payment which the purchaser must make under s14-250 of Schedule 1 to the <i>TA Act</i> (the price multiplied by the <i>GSTRW rate</i>);
<i>GSTRW rate</i>	the rate determined under ss14-250(6), (8) or (9) of Schedule 1 to the <i>TA Act</i> (as at 1 July 2018, usually 7% of the price if the margin scheme applies, 1/11 th if not);
<i>legislation</i>	an Act or a by-law, ordinance, regulation or rule made under an Act;
<i>normally</i>	subject to any other provision of this contract;
<i>party</i>	each of the vendor and the purchaser;
<i>property</i>	the land, the improvements, all fixtures and the inclusions, but not the exclusions;
<i>planning agreement</i>	a valid voluntary agreement within the meaning of s7.4 of the Environmental Planning and Assessment Act 1979 entered into in relation to the <i>property</i> ;
<i>requisition</i>	an objection, question or requisition (but the term does not include a claim);
<i>rescind</i>	rescind this contract from the beginning;
<i>serve</i>	serve in writing on the other <i>party</i> ;
<i>settlement cheque</i>	an unendorsed <i>cheque</i> made payable to the person to be paid and – <ul style="list-style-type: none"> • issued by a <i>bank</i> and drawn on itself; or • if authorised in writing by the vendor or the vendor's <i>solicitor</i>, some other <i>cheque</i>;
<i>solicitor</i>	in relation to a <i>party</i> , the <i>party's</i> solicitor or licensed conveyancer named in this contract or in a notice <i>served by the party</i> ;
<i>TA Act</i>	Taxation Administration Act 1953;
<i>terminate</i>	terminate this contract for breach;
<i>variation</i>	a variation made under s14-235 of Schedule 1 to the <i>TA Act</i> ;
<i>within</i>	in relation to a period, at any time before or during the period; and
<i>work order</i>	a valid direction, notice or order that requires work to be done or money to be spent on or in relation to the <i>property</i> or any adjoining footpath or road (but the term does not include a notice under s22E of the Swimming Pools Act 1992 or clause 22 of the Swimming Pools Regulation 2018).

2 Deposit and other payments before completion

- 2.1 The purchaser must pay the deposit to the *depositholder* as stakeholder.
- 2.2 *Normally*, the purchaser must pay the deposit on the making of this contract, and this time is essential.
- 2.3 If this contract requires the purchaser to pay any of the deposit by a later time, that time is also essential.
- 2.4 The purchaser can pay any of the deposit by giving cash (up to \$2,000) or by unconditionally giving a *cheque* to the *depositholder* or to the vendor, vendor's agent or vendor's *solicitor* for sending to the *depositholder* or by payment by electronic funds transfer to the *depositholder*.
- 2.5 If any of the deposit is not paid on time or a *cheque* for any of the deposit is not honoured on presentation, the vendor can *terminate*. This right to *terminate* is lost as soon as the deposit is paid in full.
- 2.6 If the vendor accepts a bond or guarantee for the deposit, clauses 2.1 to 2.5 do not apply.

BREACH OF COPYRIGHT MAY RESULT IN LEGAL ACTION

- 2.7 If the vendor accepts a bond or guarantee for part of the deposit, clauses 2.1 to 2.5 apply only to the balance.
- 2.8 If any of the deposit or of the balance of the price is paid before completion to the vendor or as the vendor directs, it is a charge on the land in favour of the purchaser until *termination* by the vendor or completion, subject to any existing right.
- 2.9 If each *party* tells the *depositholder* that the deposit is to be invested, the *depositholder* is to invest the deposit (at the risk of the *party* who becomes entitled to it) with a *bank*, in an interest-bearing account in NSW, payable at call, with interest to be reinvested, and pay the interest to the *parties* equally, after deduction of all proper government taxes and financial institution charges and other charges.
- 3 Deposit-bond**
- 3.1 This clause applies only if this contract says the vendor has agreed to accept a *deposit-bond* for the deposit (or part of it).
- 3.2 The purchaser must provide the original *deposit-bond* to the vendor's *solicitor* (or if no *solicitor* the *depositholder*) at or before the making of this contract and this time is essential.
- 3.3 If the *deposit-bond* has an expiry date and completion does not occur by the date which is 14 days before the expiry date, the purchaser must *serve* a replacement *deposit-bond* at least 7 days before the expiry date. The time for service is essential.
- 3.4 The vendor must approve a replacement *deposit-bond* if –
- 3.4.1 it is from the same issuer and for the same amount as the earlier *deposit-bond*; and
- 3.4.2 it has an expiry date at least three months after its date of issue.
- 3.5 A breach of clauses 3.2 or 3.3 entitles the vendor to *terminate*. The right to *terminate* is lost as soon as –
- 3.5.1 the purchaser *serves* a replacement *deposit-bond*; or
- 3.5.2 the deposit is paid in full under clause 2.
- 3.6 Clauses 3.3 and 3.4 can operate more than once.
- 3.7 If the purchaser *serves* a replacement *deposit-bond*, the vendor must *serve* the earlier *deposit-bond*.
- 3.8 The amount of any *deposit-bond* does not form part of the price for the purposes of clause 16.7.
- 3.9 The vendor must give the purchaser the *deposit-bond* –
- 3.9.1 on completion; or
- 3.9.2 if this contract is *rescinded*.
- 3.10 If this contract is *terminated* by the vendor –
- 3.10.1 *normally*, the vendor can immediately demand payment from the issuer of the *deposit-bond*; or
- 3.10.2 if the purchaser *serves* prior to *termination* a notice disputing the vendor's right to *terminate*, the vendor must forward the *deposit-bond* (or its proceeds if called up) to the *depositholder* as stakeholder.
- 3.11 If this contract is *terminated* by the purchaser –
- 3.11.1 *normally*, the vendor must give the purchaser the *deposit-bond*; or
- 3.11.2 if the vendor *serves* prior to *termination* a notice disputing the purchaser's right to *terminate*, the vendor must forward the *deposit-bond* (or its proceeds if called up) to the *depositholder* as stakeholder.
- 4 Transfer**
- 4.1 *Normally*, the purchaser must *serve* at least 14 days before the date for completion –
- 4.1.1 the form of transfer; and
- 4.1.2 particulars required to register any mortgage or other dealing to be lodged with the transfer by the purchaser or the purchaser's mortgagee.
- 4.2 If any information needed for the form of transfer is not disclosed in this contract, the vendor must *serve* it.
- 4.3 If the purchaser *serves* a form of transfer and the transferee is not the purchaser, the purchaser must give the vendor a direction signed by the purchaser personally for this form of transfer.
- 4.4 The vendor can require the purchaser to include a form of covenant or easement in the transfer only if this contract contains the wording of the proposed covenant or easement, and a description of the land benefited.
- 5 Requisitions**
- 5.1 If a form of *requisitions* is attached to this contract, the purchaser is taken to have made those *requisitions*.
- 5.2 If the purchaser is or becomes entitled to make any other *requisition*, the purchaser can make it only by *serving* it –
- 5.2.1 if it arises out of this contract or it is a general question about the *property* or title - *within* 21 days after the contract date;
- 5.2.2 if it arises out of anything *served* by the vendor - *within* 21 days after the later of the contract date and that *service*; and
- 5.2.3 in any other case - *within* a reasonable time.
- 6 Error or misdescription**
- 6.1 *Normally*, the purchaser can (but only before completion) claim compensation for an error or misdescription in this contract (as to the *property*, the title or anything else and whether substantial or not).
- 6.2 This clause applies even if the purchaser did not take notice of or rely on anything in this contract containing or giving rise to the error or misdescription.
- 6.3 However, this clause does not apply to the extent the purchaser knows the true position.

7 Claims by purchaser

Normally, the purchaser can make a claim (including a claim under clause 6) before completion only by *servicing* it with a statement of the amount claimed, and if the purchaser makes one or more claims before completion –

- 7.1 the vendor can *rescind* if in the case of claims that are not claims for delay –
- 7.1.1 the total amount claimed exceeds 5% of the price;
- 7.1.2 the vendor *serves* notice of intention to *rescind*; and
- 7.1.3 the purchaser does not *serve* notice waiving the claims *within* 14 days after that *service*; and
- 7.2 if the vendor does not *rescind*, the *parties* must complete and if this contract is completed –
- 7.2.1 the lesser of the total amount claimed and 10% of the price must be paid out of the price to and held by the *depositholder* until the claims are finalised or lapse;
- 7.2.2 the amount held is to be invested in accordance with clause 2.9;
- 7.2.3 the claims must be finalised by an arbitrator appointed by the *parties* or, if an appointment is not made *within* 1 month of completion, by an arbitrator appointed by the President of the Law Society at the request of a *party* (in the latter case the *parties* are bound by the terms of the Conveyancing Arbitration Rules approved by the Law Society as at the date of the appointment);
- 7.2.4 the purchaser is not entitled, in respect of the claims, to more than the total amount claimed and the costs of the purchaser;
- 7.2.5 net interest on the amount held must be paid to the *parties* in the same proportion as the amount held is paid; and
- 7.2.6 if the *parties* do not appoint an arbitrator and neither *party* requests the President to appoint an arbitrator *within* 3 months after completion, the claims lapse and the amount belongs to the vendor.

8 Vendor's rights and obligations

- 8.1 The vendor can *rescind* if –
- 8.1.1 the vendor is, on reasonable grounds, unable or unwilling to comply with a *requisition*;
- 8.1.2 the vendor *serves* a notice of intention to *rescind* that specifies the *requisition* and those grounds; and
- 8.1.3 the purchaser does not *serve* a notice waiving the *requisition within* 14 days after that *service*.
- 8.2 If the vendor does not comply with this contract (or a notice under or relating to it) in an essential respect, the purchaser can *terminate* by *servicing* a notice. After the *termination* –
- 8.2.1 the purchaser can recover the deposit and any other money paid by the purchaser under this contract;
- 8.2.2 the purchaser can sue the vendor to recover damages for breach of contract; and
- 8.2.3 if the purchaser has been in possession a *party* can claim for a reasonable adjustment.

9 Purchaser's default

If the purchaser does not comply with this contract (or a notice under or relating to it) in an essential respect, the vendor can *terminate* by *servicing* a notice. After the *termination* the vendor can –

- 9.1 keep or recover the deposit (to a maximum of 10% of the price);
- 9.2 hold any other money paid by the purchaser under this contract as security for anything recoverable under this clause –
- 9.2.1 for 12 months after the *termination*; or
- 9.2.2 if the vendor commences proceedings under this clause *within* 12 months, until those proceedings are concluded; and
- 9.3 sue the purchaser either –
- 9.3.1 where the vendor has resold the *property* under a contract made *within* 12 months after the *termination*, to recover –
- the deficiency on resale (with credit for any of the deposit kept or recovered and after allowance for any capital gains tax or goods and services tax payable on anything recovered under this clause); and
 - the reasonable costs and expenses arising out of the purchaser's non-compliance with this contract or the notice and of resale and any attempted resale; or
- 9.3.2 to recover damages for breach of contract.

10 Restrictions on rights of purchaser

- 10.1 The purchaser cannot make a claim or *requisition* or *rescind* or *terminate* in respect of –
- 10.1.1 the ownership or location of any fence as defined in the Dividing Fences Act 1991;
- 10.1.2 a service for the *property* being a joint service or passing through another property, or any service for another property passing through the *property* ('service' includes air, communication, drainage, electricity, garbage, gas, oil, radio, sewerage, telephone, television or water service);
- 10.1.3 a wall being or not being a party wall in any sense of that term or the *property* being affected by an easement for support or not having the benefit of an easement for support;
- 10.1.4 any change in the *property* due to fair wear and tear before completion;
- 10.1.5 a promise, representation or statement about this contract, the *property* or the title, not set out or referred to in this contract;
- 10.1.6 a condition, exception, reservation or restriction in a Crown grant;

- 10.1.7 the existence of any authority or licence to explore or prospect for gas, minerals or petroleum;
- 10.1.8 any easement or restriction on use the substance of either of which is disclosed in this contract or any non-compliance with the easement or restriction on use; or
- 10.1.9 anything the substance of which is disclosed in this contract (except a caveat, charge, mortgage, priority notice or writ).
- 10.2 The purchaser cannot *rescind* or *terminate* only because of a defect in title to or quality of the inclusions.
- 10.3 *Normally*, the purchaser cannot make a claim or *requisition* or *rescind* or *terminate* or require the vendor to change the nature of the title disclosed in this contract (for example, to remove a caution evidencing qualified title, or to lodge a plan of survey as regards limited title).
- 11 Compliance with work orders**
- 11.1 *Normally*, the vendor must by completion comply with a *work order* made on or before the contract date and if this contract is completed the purchaser must comply with any other *work order*.
- 11.2 If the purchaser complies with a *work order*, and this contract is *rescinded* or *terminated*, the vendor must pay the expense of compliance to the purchaser.
- 12 Certificates and inspections**
- The vendor must do everything reasonable to enable the purchaser, subject to the rights of any tenant –
- 12.1 to have the *property* inspected to obtain any certificate or report reasonably required;
- 12.2 to apply (if necessary in the name of the vendor) for –
- 12.2.1 any certificate that can be given in respect of the *property* under *legislation*; or
- 12.2.2 a copy of any approval, certificate, consent, direction, notice or order in respect of the *property* given under *legislation*, even if given after the contract date; and
- 12.3 to make 1 inspection of the *property* in the 3 days before a time appointed for completion.
- 13 Goods and services tax (GST)**
- 13.1 Terms used in this clause which are not defined elsewhere in this contract and have a defined meaning in the *GST Act* have the same meaning in this clause.
- 13.2 *Normally*, if a *party* must pay the price or any other amount to the other *party* under this contract, GST is not to be added to the price or amount.
- 13.3 If under this contract a *party* must make an adjustment or payment for an expense of another party or pay an expense payable by or to a third party (for example, under clauses 14 or 20.7) –
- 13.3.1 the *party* must adjust or pay on completion any GST added to or included in the expense; but
- 13.3.2 the amount of the expense must be reduced to the extent the party receiving the adjustment or payment (or the representative member of a GST group of which that party is a member) is entitled to an input tax credit for the expense; and
- 13.3.3 if the adjustment or payment under this contract is consideration for a taxable supply, an amount for GST must be added at the *GST rate*.
- 13.4 If this contract says this sale is the supply of a going concern –
- 13.4.1 the *parties* agree the supply of the *property* is a supply of a going concern;
- 13.4.2 the vendor must, between the contract date and completion, carry on the enterprise conducted on the land in a proper and business-like way;
- 13.4.3 if the purchaser is not registered by the date for completion, the *parties* must complete and the purchaser must pay on completion, in addition to the price, an amount being the price multiplied by the *GST rate* ("the retention sum"). The retention sum is to be held by the *depositholder* and dealt with as follows
- if *within* 3 months of completion the purchaser *serves* a letter from the Australian Taxation Office stating the purchaser is registered with a date of effect of registration on or before completion; the *depositholder* is to pay the retention sum to the purchaser; but
 - if the purchaser does not *serve* that letter *within* 3 months of completion, the *depositholder* is to pay the retention sum to the vendor; and
- 13.4.4 if the vendor, despite clause 13.4.1, *serves* a letter from the Australian Taxation Office stating the vendor has to pay GST on the supply, the purchaser must pay to the vendor on demand the amount of GST assessed.
- 13.5 *Normally*, the vendor promises the margin scheme will not apply to the supply of the *property*.
- 13.6 If this contract says the margin scheme is to apply in making the taxable supply, the *parties* agree that the margin scheme is to apply to the sale of the *property*.
- 13.7 If this contract says the sale is not a taxable supply –
- 13.7.1 the purchaser promises that the *property* will not be used and represents that the purchaser does not intend the *property* (or any part of the *property*) to be used in a way that could make the sale a taxable supply to any extent; and
- 13.7.2 the purchaser must pay the vendor on completion in addition to the price an amount calculated by multiplying the price by the *GST rate* if this sale is a taxable supply to any extent because of –
- a breach of clause 13.7.1; or
 - something else known to the purchaser but not the vendor.
- 13.8 If this contract says this sale is a taxable supply in full and does not say the margin scheme applies to the *property*, the vendor must pay the purchaser on completion an amount of one-eleventh of the price if –

- 13.8.1 this sale is not a taxable supply in full; or
 13.8.2 the margin scheme applies to the *property* (or any part of the *property*).
- 13.9 If this contract says this sale is a taxable supply to an extent –
 13.9.1 clause 13.7.1 does not apply to any part of the *property* which is identified as being a taxable supply; and
 13.9.2 the payments mentioned in clauses 13.7 and 13.8 are to be recalculated by multiplying the relevant payment by the proportion of the price which represents the value of that part of the *property* to which the clause applies (the proportion to be expressed as a number between 0 and 1). Any evidence of value must be obtained at the expense of the vendor.
- 13.10 *Normally*, on completion the vendor must give the recipient of the supply a tax invoice for any taxable supply by the vendor by or under this contract.
- 13.11 The vendor does not have to give the purchaser a tax invoice if the margin scheme applies to a taxable supply.
- 13.12 If the vendor is liable for GST on rents or profits due to issuing an invoice or receiving consideration before completion, any adjustment of those amounts must exclude an amount equal to the vendor's GST liability.
- 13.13 If the purchaser must make a *GSTRW payment* the purchaser must –
 13.13.1 at least 5 days before the date for completion, *serve* evidence of submission of a *GSTRW payment* notification form to the Australian Taxation Office by the purchaser or, if a direction under clause 4.3 has been *served*, by the transferee named in the transfer *served* with that direction;
 13.13.2 produce on completion a *settlement cheque* for the *GSTRW payment* payable to the Deputy Commissioner of Taxation;
 13.13.3 forward the *settlement cheque* to the payee immediately after completion; and
 13.13.4 *serve* evidence of receipt of payment of the *GSTRW payment* and a copy of the settlement date confirmation form submitted to the Australian Taxation Office.

14 Adjustments

- 14.1 *Normally*, the vendor is entitled to the rents and profits and will be liable for all rates, water, sewerage and drainage service and usage charges, land tax, levies and all other periodic outgoings up to and including the *adjustment date* after which the purchaser will be entitled and liable.
- 14.2 The *parties* must make any necessary adjustment on completion.
- 14.3 If an amount that is adjustable under this contract has been reduced under *legislation*, the *parties* must on completion adjust the reduced amount.
- 14.4 The *parties* must not adjust surcharge land tax (as defined in the Land Tax Act 1956) but must adjust any other land tax for the year current at the *adjustment date* –
 14.4.1 only if land tax has been paid or is payable for the year (whether by the vendor or by a predecessor in title) and this contract says that land tax is adjustable;
 14.4.2 by adjusting the amount that would have been payable if at the start of the year –
 • the person who owned the land owned no other land;
 • the land was not subject to a special trust or owned by a non-concessional company; and
 • if the land (or part of it) had no separate taxable value, by calculating its separate taxable value on a proportional area basis.
- 14.5 If any other amount that is adjustable under this contract relates partly to the land and partly to other land, the *parties* must adjust it on a proportional area basis.
- 14.6 *Normally*, the vendor can direct the purchaser to produce a *settlement cheque* on completion to pay an amount adjustable under this contract and if so –
 14.6.1 the amount is to be treated as if it were paid; and
 14.6.2 the *cheque* must be forwarded to the payee immediately after completion (by the purchaser if the *cheque* relates only to the *property* or by the vendor in any other case).
- 14.7 If on completion the last bill for a water, sewerage or drainage usage charge is for a period ending before the *adjustment date*, the vendor is liable for an amount calculated by dividing the bill by the number of days in the period then multiplying by the number of unbilled days up to and including the *adjustment date*.
- 14.8 The vendor is liable for any amount recoverable for work started on or before the contract date on the *property* or any adjoining footpath or road.

15 Date for completion

The *parties* must complete by the date for completion and, if they do not, a *party* can *serve* a notice to complete if that *party* is otherwise entitled to do so.

16 Completion

• Vendor

- 16.1 On completion the vendor must give the purchaser any *document of title* that relates only to the *property*.
- 16.2 If on completion the vendor has possession or control of a *document of title* that relates also to other property, the vendor must produce it as and where necessary.
- 16.3 *Normally*, on completion the vendor must cause the legal title to the *property* (being an estate in fee simple) to pass to the purchaser free of any mortgage or other interest, subject to any necessary registration.
- 16.4 The legal title to the *property* does not pass before completion.

- 16.5 If the vendor gives the purchaser a document (other than the transfer) that needs to be lodged for registration, the vendor must pay the lodgment fee to the purchaser.
- 16.6 If a *party serves* a land tax certificate showing a charge on any of the land, by completion the vendor must do all things and pay all money required so that the charge is no longer effective against the land.
- **Purchaser**
- 16.7 On completion the purchaser must pay to the vendor, by cash (up to \$2,000) or *settlement cheque* –
- 16.7.1 the price less any:
- deposit paid;
 - *FRCGW remittance payable*;
 - *GSTRW payment*; and
 - amount payable by the vendor to the purchaser under this contract; and
- 16.7.2 any other amount payable by the purchaser under this contract.
- 16.8 If the vendor requires more than 5 *settlement cheques*, the vendor must pay \$10 for each extra *cheque*.
- 16.9 If any of the deposit is not covered by a bond or guarantee, on completion the purchaser must give the vendor an order signed by the purchaser authorising the *depositholder* to account to the vendor for the deposit.
- 16.10 On completion the deposit belongs to the vendor.
- **Place for completion**
- 16.11 *Normally*, the *parties* must complete at the completion address, which is –
- 16.11.1 if a special completion address is stated in this contract - that address; or
- 16.11.2 if none is stated, but a first mortgagee is disclosed in this contract and the mortgagee would usually discharge the mortgage at a particular place - that place; or
- 16.11.3 in any other case - the vendor's *solicitor's* address stated in this contract.
- 16.12 The vendor by reasonable notice can require completion at another place, if it is in NSW, but the vendor must pay the purchaser's additional expenses, including any agency or mortgagee fee.
- 16.13 If the purchaser requests completion at a place that is not the completion address, and the vendor agrees, the purchaser must pay the vendor's additional expenses, including any agency or mortgagee fee.
- 17 Possession**
- 17.1 *Normally*, the vendor must give the purchaser vacant possession of the *property* on completion.
- 17.2 The vendor does not have to give vacant possession if –
- 17.2.1 this contract says that the sale is subject to existing tenancies; and
- 17.2.2 the contract discloses the provisions of the tenancy (for example, by attaching a copy of the lease and any relevant memorandum or variation).
- 17.3 *Normally*, the purchaser can claim compensation (before or after completion) or *rescind* if any of the land is affected by a protected tenancy (a tenancy affected by Schedule 2, Part 7 of the Residential Tenancies Act 2010).
- 18 Possession before completion**
- 18.1 This clause applies only if the vendor gives the purchaser possession of the *property* before completion.
- 18.2 The purchaser must not before completion –
- 18.2.1 let or part with possession of any of the *property*;
- 18.2.2 make any change or structural alteration or addition to the *property*; or
- 18.2.3 contravene any agreement between the *parties* or any direction, document, *legislation*, notice or order affecting the *property*.
- 18.3 The purchaser must until completion –
- 18.3.1 keep the *property* in good condition and repair having regard to its condition at the giving of possession; and
- 18.3.2 allow the vendor or the vendor's authorised representative to enter and inspect it at all reasonable times.
- 18.4 The risk as to damage to the *property* passes to the purchaser immediately after the purchaser enters into possession.
- 18.5 If the purchaser does not comply with this clause, then without affecting any other right of the vendor –
- 18.5.1 the vendor can before completion, without notice, remedy the non-compliance; and
- 18.5.2 if the vendor pays the expense of doing this, the purchaser must pay it to the vendor with interest at the rate prescribed under s101 Civil Procedure Act 2005.
- 18.6 If this contract is *rescinded* or *terminated* the purchaser must immediately vacate the *property*.
- 18.7 If the *parties* or their *solicitors* on their behalf do not agree in writing to a fee or rent, none is payable.
- 19 Rescission of contract**
- 19.1 If this contract expressly gives a *party* a right to *rescind*, the *party* can exercise the right –
- 19.1.1 only by *servicing* a notice before completion; and
- 19.1.2 in spite of any making of a claim or *requisition*, any attempt to satisfy a claim or *requisition*, any arbitration, litigation, mediation or negotiation or any giving or taking of possession.
- 19.2 *Normally*, if a *party* exercises a right to *rescind* expressly given by this contract or any *legislation* –
- 19.2.1 the deposit and any other money paid by the purchaser under this contract must be refunded;
- 19.2.2 a *party* can claim for a reasonable adjustment if the purchaser has been in possession;
- 19.2.3 a *party* can claim for damages, costs or expenses arising out of a breach of this contract; and
- 19.2.4 a *party* will not otherwise be liable to pay the other *party* any damages, costs or expenses.

20 Miscellaneous

- 20.1 The *parties* acknowledge that anything stated in this contract to be attached was attached to this contract by the vendor before the purchaser signed it and is part of this contract.
- 20.2 Anything attached to this contract is part of this contract.
- 20.3 An area, bearing or dimension in this contract is only approximate.
- 20.4 If a *party* consists of 2 or more persons, this contract benefits and binds them separately and together.
- 20.5 A *party's solicitor* can receive any amount payable to the *party* under this contract or direct in writing that it is to be paid to another person.
- 20.6 A document under or relating to this contract is --
- 20.6.1 signed by a *party* if it is signed by the *party* or the *party's solicitor* (apart from a direction under clause 4.3);
- 20.6.2 *served* if it is *served* by the *party* or the *party's solicitor*;
- 20.6.3 *served* if it is *served* on the *party's solicitor*, even if the *party* has died or any of them has died;
- 20.6.4 *served* if it is *served* in any manner provided in s170 of the Conveyancing Act 1919;
- 20.6.5 *served* if it is sent by email or fax to the *party's solicitor*, unless in either case it is not received;
- 20.6.6 *served* on a person if it (or a copy of it) comes into the possession of the person; and
- 20.6.7 *served* at the earliest time it is *served*, if it is *served* more than once.
- 20.7 An obligation to pay an expense of another *party* of doing something is an obligation to pay --
- 20.7.1 if the *party* does the thing personally - the reasonable cost of getting someone else to do it; or
- 20.7.2 if the *party* pays someone else to do the thing - the amount paid, to the extent it is reasonable.
- 20.8 Rights under clauses 11, 13, 14, 17, 24, 30 and 31 continue after completion, whether or not other rights continue.
- 20.9 The vendor does not promise, represent or state that the purchaser has any cooling off rights.
- 20.10 The vendor does not promise, represent or state that any attached survey report is accurate or current.
- 20.11 A reference to any *legislation* (including any percentage or rate specified in *legislation*) is also a reference to any corresponding later *legislation*.
- 20.12 Each *party* must do whatever is necessary after completion to carry out the *party's* obligations under this contract.
- 20.13 Neither taking possession nor *servicing* a transfer of itself implies acceptance of the *property* or the title.
- 20.14 The details and information provided in this contract (for example, on pages 1 - 3) are, to the extent of each *party's* knowledge, true, and are part of this contract.
- 20.15 Where this contract provides for choices, a choice in BLOCK CAPITALS applies unless a different choice is marked.

21 Time limits in these provisions

- 21.1 If the time for something to be done or to happen is not stated in these provisions, it is a reasonable time.
- 21.2 If there are conflicting times for something to be done or to happen, the latest of those times applies.
- 21.3 The time for one thing to be done or to happen does not extend the time for another thing to be done or to happen.
- 21.4 If the time for something to be done or to happen is the 29th, 30th or 31st day of a month, and the day does not exist, the time is instead the last day of the month.
- 21.5 If the time for something to be done or to happen is a day that is not a *business day*, the time is extended to the next *business day*, except in the case of clauses 2 and 3.2.
- 21.6 *Normally*, the time by which something must be done is fixed but not essential.

22 Foreign Acquisitions and Takeovers Act 1975

- 22.1 The purchaser promises that the Commonwealth Treasurer cannot prohibit and has not prohibited the transfer under the Foreign Acquisitions and Takeovers Act 1975.
- 22.2 This promise is essential and a breach of it entitles the vendor to *terminate*.

23 Strata or community title**• Definitions and modifications**

- 23.1 This clause applies only if the land (or part of it) is a lot in a strata, neighbourhood, precinct or community scheme (or on completion is to be a lot in a scheme of that kind).
- 23.2 In this contract--
- 23.2.1 'change', in relation to a scheme, means --
- a registered or registrable change from by-laws set out in this contract;
 - a change from a development or management contract or statement set out in this contract; or
 - a change in the boundaries of common property;
- 23.2.2 'common property' includes association property for the scheme or any higher scheme;
- 23.2.3 'contribution' includes an amount payable under a by-law;
- 23.2.4 'information certificate' includes a certificate under s184 Strata Schemes Management Act 2015 and s26 Community Land Management Act 1989;
- 23.2.5 'information notice' includes a strata information notice under s22 Strata Schemes Management Act 2015 and a notice under s47 Community Land Management Act 1989;

- 23.2.6 'normal expenses', in relation to an owners corporation for a scheme, means normal operating expenses usually payable from the administrative fund of an owners corporation for a scheme of the same kind;
- 23.2.7 'owners corporation' means the owners corporation or the association for the scheme or any higher scheme;
- 23.2.8 'the *property*' includes any interest in common property for the scheme associated with the lot; and
- 23.2.9 'special expenses', in relation to an owners corporation, means its actual, contingent or expected expenses, except to the extent they are –
- normal expenses;
 - due to fair wear and tear;
 - disclosed in this contract; or
 - covered by moneys held in the capital works fund.
- 23.3 Clauses 11, 14.8 and 18.4 do not apply to an obligation of the owners corporation, or to property insurable by it.
- 23.4 Clauses 14.4.2 and 14.5 apply but on a unit entitlement basis instead of an area basis.
- **Adjustments and liability for expenses**
- 23.5 The *parties* must adjust under clause 14.1 –
- 23.5.1 a regular periodic contribution;
- 23.5.2 a contribution which is not a regular periodic contribution but is disclosed in this contract; and
- 23.5.3 on a unit entitlement basis, any amount paid by the vendor for a normal expense of the owners corporation to the extent the owners corporation has not paid the amount to the vendor.
- 23.6 If a contribution is not a regular periodic contribution and is not disclosed in this contract –
- 23.6.1 the vendor is liable for it if it was determined on or before the contract date, even if it is payable by instalments; and
- 23.6.2 the purchaser is liable for all contributions determined after the contract date.
- 23.7 The vendor must pay or allow to the purchaser on completion the amount of any unpaid contributions for which the vendor is liable under clause 23.6.1.
- 23.8 *Normally*, the purchaser cannot make a claim or *requisition* or *rescind* or *terminate* in respect of –
- 23.8.1 an existing or future actual, contingent or expected expense of the owners corporation;
- 23.8.2 a proportional unit entitlement of the lot or a relevant lot or former lot, apart from a claim under clause 6; or
- 23.8.3 a past or future change in the scheme or a higher scheme.
- 23.9 However, the purchaser can *rescind* if –
- 23.9.1 the special expenses of the owners corporation at the later of the contract date and the creation of the owners corporation when calculated on a unit entitlement basis (and, if more than one lot or a higher scheme is involved, added together), less any contribution paid by the vendor, are more than 1% of the price;
- 23.9.2 in the case of the lot or a relevant lot or former lot in a higher scheme, a proportional unit entitlement for the lot is disclosed in this contract but the lot has a different proportional unit entitlement at the contract date or at any time before completion;
- 23.9.3 a change before the contract date or before completion in the scheme or a higher scheme materially prejudices the purchaser and is not disclosed in this contract; or
- 23.9.4 a resolution is passed by the owners corporation before the contract date or before completion to give to the owners in the scheme for their consideration a strata renewal plan that has not lapsed at the contract date and there is not attached to this contract a strata renewal proposal or the strata renewal plan.
- **Notices, certificates and inspections**
- 23.10 The purchaser must give the vendor 2 copies of an information notice addressed to the owners corporation and signed by the purchaser.
- 23.11 The vendor must complete and sign 1 copy of the notice and give it to the purchaser on completion.
- 23.12 Each *party* can sign and give the notice as agent for the other.
- 23.13 The vendor must *serve* an information certificate issued after the contract date in relation to the lot, the scheme or any higher scheme at least 7 days before the date for completion.
- 23.14 The purchaser does not have to complete earlier than 7 days after *service* of the certificate and clause 21.3 does not apply to this provision. On completion the purchaser must pay the vendor the prescribed fee for the certificate.
- 23.15 The vendor authorises the purchaser to apply for the purchaser's own certificate.
- 23.16 The vendor authorises the purchaser to apply for and make an inspection of any record or other document in the custody or control of the owners corporation or relating to the scheme or any higher scheme.
- **Meetings of the owners corporation**
- 23.17 If a general meeting of the owners corporation is convened before completion –
- 23.17.1 if the vendor receives notice of it, the vendor must immediately notify the purchaser of it; and
- 23.17.2 after the expiry of any cooling off period, the purchaser can require the vendor to appoint the purchaser (or the purchaser's nominee) to exercise any voting rights of the vendor in respect of the lot at the meeting.

24 Tenancies

- 24.1 If a tenant has not made a payment for a period preceding or current at the *adjustment date* –
- 24.1.1 for the purposes of clause 14.2, the amount is to be treated as if it were paid; and
- 24.1.2 the purchaser assigns the debt to the vendor on completion and will if required give a further assignment at the vendor's expense.
- 24.2 If a tenant has paid in advance of the *adjustment date* any periodic payment in addition to rent, it must be adjusted as if it were rent for the period to which it relates.
- 24.3 If the *property* is to be subject to a tenancy on completion or is subject to a tenancy on completion –
- 24.3.1 the vendor authorises the purchaser to have any accounting records relating to the tenancy inspected and audited and to have any other document relating to the tenancy inspected;
- 24.3.2 the vendor must *serve* any information about the tenancy reasonably requested by the purchaser before or after completion; and
- 24.3.3 *normally*, the purchaser can claim compensation (before or after completion) if –
- a disclosure statement required by the Retail Leases Act 1994 was not given when required;
 - such a statement contained information that was materially false or misleading;
 - a provision of the lease is not enforceable because of a non-disclosure in such a statement; or
 - the lease was entered into in contravention of the Retail Leases Act 1994.
- 24.4 If the *property* is subject to a tenancy on completion –
- 24.4.1 the vendor must allow or transfer –
- any remaining bond money or any other security against the tenant's default (to the extent the security is transferable);
 - any money in a fund established under the lease for a purpose and compensation for any money in the fund or interest earned by the fund that has been applied for any other purpose; and
 - any money paid by the tenant for a purpose that has not been applied for that purpose and compensation for any of the money that has been applied for any other purpose;
- 24.4.2 if the security is not transferable, each *party* must do everything reasonable to cause a replacement security to issue for the benefit of the purchaser and the vendor must hold the original security on trust for the benefit of the purchaser until the replacement security issues;
- 24.4.3 the vendor must give to the purchaser –
- a proper notice of the transfer (an attornment notice) addressed to the tenant;
 - any certificate given under the Retail Leases Act 1994 in relation to the tenancy;
 - a copy of any disclosure statement given under the Retail Leases Act 1994;
 - a copy of any document served on the tenant under the lease and written details of its service, if the document concerns the rights of the landlord or the tenant after completion; and
 - any document served by the tenant under the lease and written details of its service, if the document concerns the rights of the landlord or the tenant after completion;
- 24.4.4 the vendor must comply with any obligation to the tenant under the lease, to the extent it is to be complied with by completion; and
- 24.4.5 the purchaser must comply with any obligation to the tenant under the lease, to the extent that the obligation is disclosed in this contract and is to be complied with after completion.

25 Qualified title, limited title and old system title

- 25.1 This clause applies only if the land (or part of it) –
- 25.1.1 is under qualified, limited or old system title; or
- 25.1.2 on completion is to be under one of those titles.
- 25.2 The vendor must *serve* a proper abstract of title *within 7 days* after the contract date.
- 25.3 If an abstract of title or part of an abstract of title is attached to this contract or has been lent by the vendor to the purchaser before the contract date, the abstract or part is *served* on the contract date.
- 25.4 An abstract of title can be or include a list of documents, events and facts arranged (apart from a will or codicil) in date order, if the list in respect of each document –
- 25.4.1 shows its date, general nature, names of parties and any registration number; and
- 25.4.2 has attached a legible photocopy of it or of an official or registration copy of it.
- 25.5 An abstract of title –
- 25.5.1 must start with a good root of title (if the good root of title must be at least 30 years old, this means 30 years old at the contract date);
- 25.5.2 in the case of a leasehold interest, must include an abstract of the lease and any higher lease;
- 25.5.3 *normally*, need not include a Crown grant; and
- 25.5.4 need not include anything evidenced by the Register kept under the Real Property Act 1900.
- 25.6 In the case of land under old system title –
- 25.6.1 in this contract 'transfer' means conveyance;
- 25.6.2 the purchaser does not have to *serve* the form of transfer until after the vendor has *served* a proper abstract of title; and
- 25.6.3 each vendor must give proper covenants for title as regards that vendor's interest.
- 25.7 In the case of land under limited title but not under qualified title –

- 25.7.1 *normally*, the abstract of title need not include any document which does not show the location, area or dimensions of the land (for example, by including a metes and bounds description or a plan of the land);
- 25.7.2 clause 25.7.1 does not apply to a document which is the good root of title; and
- 25.7.3 the vendor does not have to provide an abstract if this contract contains a delimitation plan (whether in registrable form or not).
- 25.8 The vendor must give a proper covenant to produce where relevant.
- 25.9 The vendor does not have to produce or covenant to produce a document that is not in the possession of the vendor or a mortgagee.
- 25.10 If the vendor is unable to produce an original document in the chain of title, the purchaser will accept a photocopy from the Registrar-General of the registration copy of that document.
- 26 Crown purchase money**
- 26.1 This clause applies only if purchase money is payable to the Crown, whether or not due for payment.
- 26.2 The vendor is liable for the money, except to the extent this contract says the purchaser is liable for it.
- 26.3 To the extent the vendor is liable for it, the vendor is liable for any interest until completion.
- 26.4 To the extent the purchaser is liable for it, the *parties* must adjust any interest under clause 14.1.
- 27 Consent to transfer**
- 27.1 This clause applies only if the land (or part of it) cannot be transferred without consent under *legislation* or a *planning agreement*.
- 27.2 The purchaser must properly complete and then serve the purchaser's part of an application for consent to transfer of the land (or part of it) *within 7 days* after the contract date.
- 27.3 The vendor must apply for consent *within 7 days* after *service* of the purchaser's part.
- 27.4 If consent is refused, either *party* can *rescind*.
- 27.5 If consent is given subject to one or more conditions that will substantially disadvantage a *party*, then that *party* can *rescind within 7 days* after receipt by or *service* upon the *party* of written notice of the conditions.
- 27.6 If consent is not given or refused –
- 27.6.1 *within 42 days* after the purchaser serves the purchaser's part of the application, the purchaser can *rescind*; or
- 27.6.2 *within 30 days* after the application is made, either *party* can *rescind*.
- 27.7 Each period in clause 27.6 becomes 90 days if the land (or part of it) is –
- 27.7.1 under a *planning agreement*; or
- 27.7.2 in the Western Division.
- 27.8 If the land (or part of it) is described as a lot in an unregistered plan, each time in clause 27.6 becomes the later of the time and 35 days after creation of a separate folio for the lot.
- 27.9 The date for completion becomes the later of the date for completion and 14 days after *service* of the notice granting consent to transfer.
- 28 Unregistered plan**
- 28.1 This clause applies only if some of the land is described as a lot in an unregistered plan.
- 28.2 The vendor must do everything reasonable to have the plan registered *within 6 months* after the contract date, with or without any minor alteration to the plan or any document to be lodged with the plan validly required or made under *legislation*.
- 28.3 If the plan is not registered *within* that time and in that manner –
- 28.3.1 the purchaser can *rescind*; and
- 28.3.2 the vendor can *rescind*, but only if the vendor has complied with clause 28.2 and with any *legislation* governing the rescission.
- 28.4 Either *party* can *serve* notice of the registration of the plan and every relevant lot and plan number.
- 28.5 The date for completion becomes the later of the date for completion and 21 days after *service* of the notice.
- 28.6 Clauses 28.2 and 28.3 apply to another plan that is to be registered before the plan is registered.
- 29 Conditional contract**
- 29.1 This clause applies only if a provision says this contract or completion is conditional on an event.
- 29.2 If the time for the event to happen is not stated, the time is 42 days after the contract date.
- 29.3 If this contract says the provision is for the benefit of a *party*, then it benefits only that *party*.
- 29.4 If anything is necessary to make the event happen, each *party* must do whatever is reasonably necessary to cause the event to happen.
- 29.5 A *party* can *rescind* under this clause only if the *party* has substantially complied with clause 29.4.
- 29.6 If the event involves an approval and the approval is given subject to a condition that will substantially disadvantage a *party* who has the benefit of the provision, the *party* can *rescind within 7 days* after either *party* serves notice of the condition.
- 29.7 If the *parties* can lawfully complete without the event happening –
- 29.7.1 if the event does not happen *within* the time for it to happen, a *party* who has the benefit of the provision can *rescind within 7 days* after the end of that time;
- 29.7.2 if the event involves an approval and an application for the approval is refused, a *party* who has the benefit of the provision can *rescind within 7 days* after either *party* serves notice of the refusal; and

- 29.7.3 the date for completion becomes the later of the date for completion and 21 days after the earliest of –
- either *party serving* notice of the event happening;
 - every *party* who has the benefit of the provision *serving* notice waiving the provision; or
 - the end of the time for the event to happen.
- 29.8 If the *parties* cannot lawfully complete without the event happening –
- 29.8.1 if the event does not happen *within* the time for it to happen, either *party* can *rescind*;
- 29.8.2 if the event involves an approval and an application for the approval is refused, either *party* can *rescind*;
- 29.8.3 the date for completion becomes the later of the date for completion and 21 days after either *party* *serves* notice of the event happening.
- 29.9 A *party* cannot *rescind* under clauses 29.7 or 29.8 after the event happens.
- 30 Electronic transaction**
- 30.1 This *Conveyancing Transaction* is to be conducted as an *electronic transaction* if –
- 30.1.1 this contract says that it is an *electronic transaction*;
- 30.1.2 the *parties* otherwise agree that it is to be conducted as an *electronic transaction*; or
- 30.1.3 the *conveyancing rules* require it to be conducted as an *electronic transaction*.
- 30.2 However, this *Conveyancing Transaction* is not to be conducted as an *electronic transaction* –
- 30.2.1 if the land is not *electronically tradeable* or the transfer is not eligible to be lodged electronically; or
- 30.2.2 if, at any time after the *effective date*, but at least 14 days before the date for completion, a *party* *serves* a notice stating a valid reason why it cannot be conducted as an *electronic transaction*.
- 30.3 If, because of clause 30.2.2, this *Conveyancing Transaction* is not to be conducted as an *electronic transaction* –
- 30.3.1 each *party* must –
- bear equally any disbursements or fees; and
 - otherwise bear that *party's* own costs;
- incurred because this *Conveyancing Transaction* was to be conducted as an *electronic transaction*; and
- 30.3.2 if a *party* has paid all of a disbursement or fee which, by reason of this clause, is to be borne equally by the *parties*, that amount must be adjusted under clause 14.2.
- 30.4 If this *Conveyancing Transaction* is to be conducted as an *electronic transaction* –
- 30.4.1 to the extent that any other provision of this contract is inconsistent with this clause, the provisions of this clause prevail;
- 30.4.2 *normally*, words and phrases used in this clause 30 (italicised and in Title Case, such as *Electronic Workspace* and *Lodgment Case*) have the same meaning which they have in the *participation rules*;
- 30.4.3 the *parties* must conduct the *electronic transaction* –
- in accordance with the *participation rules* and the *ECNL*; and
 - using the nominated *ELN*, unless the *parties* otherwise agree;
- 30.4.4 a *party* must pay the fees and charges payable by that *party* to the *ELNO* and the *Land Registry* as a result of this transaction being an *electronic transaction*;
- 30.4.5 any communication from one *party* to another *party* in the *Electronic Workspace* made –
- after the *effective date*; and
 - before the receipt of a notice given under clause 30.2.2;
- is taken to have been received by that *party* at the time determined by s13A of the *Electronic Transactions Act 2000*; and
- 30.4.6 a document which is an *electronic document* is *served* as soon as it is first *Digitally Signed* in the *Electronic Workspace* on behalf of the *party* required to *serve* it.
- 30.5 *Normally*, the vendor must *within 7 days of the effective date* –
- 30.5.1 create an *Electronic Workspace*;
- 30.5.2 *populate* the *Electronic Workspace* with *title data*, the date for completion and, if applicable, *mortgagee details*; and
- 30.5.3 invite the purchaser and any *discharging mortgagee* to the *Electronic Workspace*.
- 30.6 If the vendor has not created an *Electronic Workspace* in accordance with clause 30.5, the purchaser may create an *Electronic Workspace*. If the purchaser creates the *Electronic Workspace* the purchaser must –
- 30.6.1 *populate* the *Electronic Workspace* with *title data*;
- 30.6.2 create and *populate* an *electronic transfer*;
- 30.6.3 *populate* the *Electronic Workspace* with the date for completion and a nominated *completion time*; and
- 30.6.4 invite the vendor and any *incoming mortgagee* to join the *Electronic Workspace*.
- 30.7 *Normally*, *within 7 days* of receiving an invitation from the vendor to join the *Electronic Workspace*, the purchaser must –
- 30.7.1 join the *Electronic Workspace*;
- 30.7.2 create and *populate* an *electronic transfer*;
- 30.7.3 invite any *incoming mortgagee* to join the *Electronic Workspace*; and
- 30.7.4 *populate* the *Electronic Workspace* with a nominated *completion time*.

- 30.8 If the purchaser has created the *Electronic Workspace* the vendor must *within 7 days* of being invited to the *Electronic Workspace* –
- 30.8.1 join the *Electronic Workspace*;
 - 30.8.2 *populate* the *Electronic Workspace* with *mortgagee details*, if applicable; and
 - 30.8.3 invite any *discharging mortgagee* to join the *Electronic Workspace*.
- 30.9 To complete the financial settlement schedule in the *Electronic Workspace* –
- 30.9.1 the purchaser must provide the vendor with *adjustment figures* at least *2 business days* before the date for completion;
 - 30.9.2 the vendor must confirm the *adjustment figures* at least *1 business day* before the date for completion; and
 - 30.9.3 if the purchaser must make a *GSTRW payment* or an *FRCGW remittance*, the purchaser must *populate* the *Electronic Workspace* with the payment details for the *GSTRW payment* or *FRCGW remittance* payable to the Deputy Commissioner of Taxation at least *2 business days* before the date for completion.
- 30.10 Before completion, the *parties* must ensure that –
- 30.10.1 all *electronic documents* which a *party* must *Digitally Sign* to complete the *electronic transaction* are *populated* and *Digitally Signed*;
 - 30.10.2 all certifications required by the *ECNL* are properly given; and
 - 30.10.3 they do everything else in the *Electronic Workspace* which that *party* must do to enable the *electronic transaction* to proceed to completion.
- 30.11 If completion takes place in the *Electronic Workspace* –
- 30.11.1 payment electronically on completion of the price in accordance with clause 16.7 is taken to be payment by a single *settlement cheque*;
 - 30.11.2 the completion address in clause 16.11 is the *Electronic Workspace*; and
 - 30.11.3 clauses 13.13.2 to 13.13.4, 16.8, 16.12, 16.13 and 31.2.2 to 31.2.4 do not apply.
- 30.12 If the computer systems of any of the *Land Registry*, the *ELNO* or the Reserve Bank of Australia are inoperative for any reason at the *completion time* agreed by the *parties*, a failure to complete this contract for that reason is not a default under this contract on the part of either *party*.
- 30.13 If the computer systems of the *Land Registry* are inoperative for any reason at the *completion time* agreed by the *parties*, and the *parties* choose that financial settlement is to occur despite this, then on financial settlement occurring –
- 30.13.1 all *electronic documents Digitally Signed* by the vendor, the *certificate of title* and any discharge of mortgage, withdrawal of caveat or other *electronic document* forming part of the *Lodgment Case* for the *electronic transaction* shall be taken to have been unconditionally and irrevocably delivered to the purchaser or the purchaser's mortgagee at the time of financial settlement together with the right to deal with the land comprised in the *certificate of title*; and
 - 30.13.2 the vendor shall be taken to have no legal or equitable interest in the *property*.
- 30.14 A *party* who holds a *certificate of title* must act in accordance with any *Prescribed Requirement* in relation to the *certificate of title* but if there is no *Prescribed Requirement*, the vendor must *serve* the *certificate of title* after completion.
- 30.15 If the *parties* do not agree about the delivery before completion of one or more documents or things that cannot be delivered through the *Electronic Workspace*, the *party* required to deliver the documents or things –
- 30.15.1 holds them on completion in escrow for the benefit of; and
 - 30.15.2 must immediately after completion deliver the documents or things to, or as directed by; the *party* entitled to them.
- 30.16 In this clause 30, these terms (in any form) mean –
- adjustment figures* details of the adjustments to be made to the price under clause 14;
 - certificate of title* the paper duplicate of the folio of the register for the land which exists immediately prior to completion and, if more than one, refers to each such paper duplicate;
 - completion time* the time of day on the date for completion when the *electronic transaction* is to be settled;
 - conveyancing rules* the rules made under s12E of the Real Property Act 1900;
 - discharging mortgagee* any discharging mortgagee, chargee, covenant chargee or caveator whose provision of a *Digitally Signed* discharge of mortgage, discharge of charge or withdrawal of caveat is required in order for unencumbered title to the *property* to be transferred to the purchaser;
 - ECNL* the Electronic Conveyancing National Law (NSW);
 - effective date* the date on which the *Conveyancing Transaction* is agreed to be an *electronic transaction* under clause 30.1.2 or, if clauses 30.1.1 or 30.1.3 apply, the contract date;
 - electronic document* a dealing as defined in the Real Property Act 1900 which may be created and *Digitally Signed* in an *Electronic Workspace*;
 - electronic transfer* a transfer of land under the Real Property Act 1900 for the *property* to be prepared and *Digitally Signed* in the *Electronic Workspace* established for the purposes of the *parties' Conveyancing Transaction*;

<i>electronic transaction</i>	a <i>Conveyancing Transaction</i> to be conducted for the <i>parties</i> by their legal representatives as <i>Subscribers</i> using an <i>ELN</i> and in accordance with the <i>ECNL</i> and the <i>participation rules</i> ;
<i>electronically tradeable</i>	a land title that is Electronically Tradeable as that term is defined in the <i>conveyancing rules</i> ;
<i>incoming mortgagee</i>	any mortgagee who is to provide finance to the purchaser on the security of the <i>property</i> and to enable the purchaser to pay the whole or part of the price;
<i>mortgagee details</i>	the details which a <i>party</i> to the <i>electronic transaction</i> must provide about any <i>discharging mortgagee</i> of the <i>property</i> as at completion;
<i>participation rules</i>	the participation rules as determined by the <i>ECNL</i> ;
<i>populate</i>	to complete data fields in the <i>Electronic Workspace</i> ; and
<i>title data</i>	the details of the title to the <i>property</i> made available to the <i>Electronic Workspace</i> by the <i>Land Registry</i> .

31 Foreign Resident Capital Gains Withholding

31.1 This clause applies only if –

- 31.1.1 the sale is not an excluded transaction within the meaning of s14-215 of Schedule 1 to the *TA Act*; and
- 31.1.2 a *clearance certificate* in respect of every vendor is not attached to this contract.

31.2 The purchaser must –

- 31.2.1 at least 5 days before the date for completion, *serve* evidence of submission of a purchaser payment notification to the Australian Taxation Office by the purchaser or, if a direction under clause 4.3 has been *served*, by the transferee named in the transfer *served* with that direction;
- 31.2.2 produce on completion a *settlement cheque* for the *FRCGW remittance* payable to the Deputy Commissioner of Taxation;
- 31.2.3 forward the *settlement cheque* to the payee immediately after completion; and
- 31.2.4 *serve* evidence of receipt of payment of the *FRCGW remittance*.

31.3 The vendor cannot refuse to complete if the purchaser complies with clauses 31.2.1 and 31.2.2.

31.4 If the vendor *serves* any *clearance certificate* or *variation*, the purchaser does not have to complete earlier than 7 days after that *service* and clause 21.3 does not apply to this provision.

31.5 If the vendor *serves* in respect of every vendor either a *clearance certificate* or a *variation* to 0.00 percent, clauses 31.2 and 31.3 do not apply.

32 Residential off the plan contract

32.1 This clause applies if this contract is an off the plan contract within the meaning of Division 10 of Part 4 of the *Conveyancing Act 1919* (the *Division*).

32.2 No provision of this contract has the effect of excluding, modifying or restricting the operation of the *Division*.

32.3 If the purchaser makes a claim for compensation under the terms prescribed by clause 6A of the *Conveyancing (Sale of Land) Regulation 2017* –

- 32.3.1 the purchaser cannot make a claim under this contract about the same subject matter, including a claim under clauses 6 or 7; and
- 32.3.2 the claim for compensation is not a claim under this contract.

32.4 This clause does not apply to a contract made before the commencement of the amendments to the *Division* under the *Conveyancing Legislation Amendment Act 2018*.

winding up presented or have a liquidator, receiver, official manager, manager & receiver, or controller appointed, Then the other party can rescind this contract under clause 19.

42. In the event that the vendor requires the whole or part of the deposit referred to on the front page of the contract to be released for the purchase of another property, or for paying the vendor's mortgagee purposes and/or land tax, the purchaser hereby authorizes the release of such deposit, provided that should the deposit be required for the vendor's purchase then the deposit is to be placed in the Trust Account of the estate Agent or vendor solicitor's trust account in such subsequent purchase.

43. The purchaser warrants that he was not introduced to the property by a real estate agent other than the agent shown as the Vendor's Agent on the front page of this contract and agrees to indemnify and keep indemnified the vendor against any claim or claims by any other agent for commission. This condition shall not merge on completion.

44. (a) If a party is unable or unwilling to complete this contract on the completion date then the other party can at any time after the completion date serve a Notice to Complete requiring completion to occur on a specified date and making time of the essence. A Notice to Complete must give at least 14 days notice (excluding the day of service but including the day completion is specified in the Notice. A Notice to complete under this clause will be reasonable and sufficient to make time for completion essential.

(b) The party that issued the Notice to Complete may withdraw any Notice to Complete shall be without prejudice to that party's right to issue and serve a subsequent Notice to Complete.

(c) In the event that Vendor issues a Notice to Complete, then the Purchaser agrees to pay \$330 at completion by way of compensation for the vendor's legal costs in issuing the notice to complete.

45. If completion does not take place by the completion date for any reason other than due to the default of the Vendor, the Purchaser shall pay to the Vendor on completion by way of liquidated damages a sum equal to interest on the balance of the purchase monies at the rate of ten per centum (10%) per annum calculated daily from and including the day being one day after the completion date until and including the day completion actually takes place. The payment of interest in accordance with this clause on completion is an essential term of this contract.

46. In the event that a swimming pool is in this sale, the purchaser will make no requisition, objection, claim or claim for compensation in relation to:

- (a) Any non-compliance by the vendor or any provision of the Swimming Pools Act 1992 and/ or
- (b) Any notice issued pursuant to the Swimming Pools Act 1992 after the date of this contract

47. In the event that, on exchange of this contract, less than ten per centum (10%) of the purchase price is paid as a deposit the Purchaser acknowledges that in the event that the Vendor is entitled to forfeit the deposit paid herein, the Vendor shall in addition, be entitled to recover from the Purchaser a sum equal to the difference between the deposit herein paid and the ten per centum (10%) of the purchase price.

This provision is in addition to and not in substitution for any other rights of the vendor under this contract. This clause shall not merge on completion.

48 In the circumstances where this contract is exchanged with cooling off period then notwithstanding that a deposit of 10% is payable under this contract, the Vendor will accept a deposit of 0.25% of the purchase price on the date of this contract. The balance of the 10% deposit is payable before the fifth business day after this contract. In this clause time is essential.

49. (a) if the vendor does not have a building certificate or survey report and the purchaser is not entitled to require the vendor to apply for or to do anything to obtain a building certificate or survey report or to comply with the local council's requirements for the issue of a building certificate or survey report.

(c) Completion of the contract is not conditional on the vendor or the purchaser obtaining a building certificate or survey report.

50. If the purchaser fails to attend settlement or otherwise cancel the settlement (through no fault of the vendor) and particularly after appropriate arrangements have been made with all concerned parties, the purchaser allows on settlement to the vendor an amount of \$150 for each time a failure occurs.

51. In the event that purchaser fails to deliver the transfer to the vendor solicitor in accordance with the clause 4, the purchaser agrees to pay to the vendor the sum of \$75.00 towards the cost of arranging for the execution of transfer at short notice.

52. For purpose of clause 5, the vendor is required to answer the requisitions to the Law Society 2007 Residential Property Requisitions on title.



LAND
REGISTRY
SERVICES

Title Search

Information Provided Through
triSearch (Website)
Ph. 1300 064 452 Fax.

NEW SOUTH WALES LAND REGISTRY SERVICES - TITLE SEARCH

FOLIO: 3/568438

SEARCH DATE	TIME	EDITION NO	DATE
19/4/2021	10:29 AM	6	8/9/2018

NO CERTIFICATE OF TITLE HAS ISSUED FOR THE CURRENT EDITION OF THIS FOLIO.
CONTROL OF THE RIGHT TO DEAL IS HELD BY WESTPAC BANKING CORPORATION.

LAND

LOT 3 IN DEPOSITED PLAN 568438
AT WENTWORTHVILLE
LOCAL GOVERNMENT AREA CITY OF PARRAMATTA
PARISH OF ST JOHN COUNTY OF CUMBERLAND
TITLE DIAGRAM DP568438

FIRST SCHEDULE

MELINDA NER

(CN AE658835)

SECOND SCHEDULE (4 NOTIFICATIONS)

- 1 RESERVATIONS AND CONDITIONS IN THE CROWN GRANT(S)
- 2 F351838 COVENANT
- 3 N894858 COVENANT
- 4 AE658836 MORTGAGE TO WESTPAC BANKING CORPORATION

NOTATIONS

UNREGISTERED DEALINGS: NIL

*** END OF SEARCH ***

NF351838

LODGED BY Walter Smith & Co. Solicitors
 59 Hunter Street, Sydney.

I, _____ mortgagee under Mortgage No. _____
 release and discharge the land comprised in the within transfer from such mortgage and all claims thereon but without prejudice to my rights and remedies as regards the balance of the land comprised in such mortgage.

This consent is appropriate only to a transfer of part of the land in the Certificate of Title or Crown Grant. The mortgagee should execute a formal discharge where the land transferred is the whole or the residue of the land in the Certificate of Title or Crown Grant of the whole of the land in the mortgage.

Dated at _____ this _____ day of _____ 19 _____

Signed in my presence by _____

who is personally known to me.

Mortgagee.

MEMORANDUM AS TO NON-REVOCATION OF POWER OF ATTORNEY.

(To be signed at the time of executing the within instrument.)

Memorandum whereby the undersigned states that he has no notice of the revocation of the Power of Attorney registered No. _____ Miscellaneous Register under the authority of which he has just executed the within transfer.

Signed at _____ the _____ day of _____ 19 _____

Signed in the presence of _____

Strike out unnecessary words. Add any other matter necessary to show that the power is effective.

CERTIFICATE OF J.P., &c, TAKING DECLARATION OF ATTESTING WITNESS.

Appeared before me at _____, the _____ day of _____, one thousand nine hundred and _____ the attesting witness to this instrument signing the same, and whose signature thereto he has attested; and that the name purporting to be such signature of the said _____ is _____ own handwriting, and that he was of sound mind and freely and voluntarily signed the same.

To be signed by Registrar-General, Deputy Registrar-General, a Notary Public, J.P., Commissioner for Affidavits, or other functionary before whom the attesting witness appears. Not required if the instrument itself be signed or acknowledged before one of those parties.

INDEXED	MEMORANDUM OF TRANSFER	DOCUMENTS LODGED HEREWITH.	
	<i>Subject to covenant</i>	To be filled in by person lodging dealing.	
Checked by	Particulars entered in Register Book, Volume <u>5716</u> Folio <u>74</u>	1. <u>cf. Order 100</u>	Received Docs.
Passed (in S.D.B.) by		2.	No.
Signed by	the <u>20th</u> day of <u>December</u> 19 <u>52</u> at _____ minutes past <u>12</u> o'clock in the _____	3.	Receiving Clerk.
	<i>J. H. Bell</i> Registrar-General	4.	
		5.	
		6.	
		7.	

LEAVE THESE SPACES FOR DEPARTMENTAL USE.

PROGRESS RECORD.

	Initials	Date
Sent to Survey Branch...		
Received from Records...		
Draft written ...	<i>[initials]</i>	<u>22-12</u>
Draft examined...	<i>[initials]</i>	<u>23-12</u>
Diagram prepared ...	<i>[initials]</i>	<u>24-12</u>
Diagram examined ...	<i>[initials]</i>	<u>25-12</u>
Draft forwarded ...	<i>[initials]</i>	<u>26-12</u>
Supt. of Engrossers ...	<i>[initials]</i>	<u>28-12</u>
Cancellation Clerk ...	<i>[initials]</i>	<u>28-12</u>
Vol.	<u>6245</u>	<u>231</u>

EXECUTION OUTSIDE NEW SOUTH WALES.
 If the parties be resident without the State, but in any other part of the British Dominion the instrument must be signed or acknowledged before the Registrar-General or Recorder of Title of such Possession, or before any Judge, Notary Public, Justice of the Peace for New South Wales, or Commissioner for taking affidavits for New South Wales, or the Mayor or Chief Officer of any municipal or local government corporation of such part, or Justice of the Peace for such part, or the Governor, Government Resident, or Chief Secretary of such part or such other person as the Chief Justice of New South Wales may appoint.
 If resident in the United Kingdom then before the Mayor or Chief Officer of any corporation or a Notary Public.
 If resident at any foreign place, then the parties should sign or acknowledge before a British Minister, Ambassador, Envoy, Minister, Chargé d'Affaires, Secretary of the Embassy or Legation, Consul-General, Consul, Vice-Consul, Acting-Consul, Pro-Consul, or Consular Agent; who should affix his seal of office, or the attesting witness may make a declaration of the due execution thereof before one of such persons (who should sign and affix his seal to such declaration), or such other person as the said Chief Justice may appoint.
 The fees are:—Upon lodgment (a) 1s/-, if accompanied by the relevant title or evidence of production thereof, (b) 1s/- otherwise. This fee includes endorsement on the first Certificate. In addition the following fees are payable:—(a) 5/- for each additional Certificate included in the Transfer, (b) 2s/- for each new Certificate of Title issued, (c) 5/- where the Transfer contains covenant purporting to affect the user of any land, (d) 10/- where the Transfer is expressed to be in easement, (e) 2/- where partial discharge of a mortgage is endorsed on the Transfer, (f) 2s/- for each additional folio where the Certificate exceeds ten folios, (g) as approved, in cases involving more than one simple diagram or any diagram other than a simple diagram.
 Transfers in common must receive separate Certificates.
 If part only of the land is transferred a new Certificate must issue for that part, and the old Certificate will be retained in the Office. A new Certificate may be taken out for the residue

RP 13A



MEMORANDUM OF TRANSFER

REAL PROPERTY ACT, 1900

OFFICE USE ONLY

N 894858

25

ES

12

This form is for use where the right, form of transfer is un-
 defined.

Typewriting and handwriting
 should be clear, legible and in
 permanent black indelible
 ink. No alterations should be
 made by erasures; the words
 deleted must be ruled through
 and verified by signature of
 the transferor.

(c) Full name, address and
 occupation of transferee.

(a) **ROBERT FRANCIS FITZPATRICK** formerly of Westmead but now
 of 131 Old Windsor Road, Wentworthville, Electrical Fitter,
 and **BEVERLY GAIL FITZPATRICK** his wife.

hereinafter referred to as the TRANSFEROR

(b) If a late estate strike out
 in fee simple and add
 appropriate estate.

being registered proprietor of an estate in fee simple^(b)
 in the land hereinafter described, subject to the following encumbrances and interests

(c) A short note will suffice,
 if an encumbrance is not yet
 registered particulars suffi-
 cient for identification must
 be furnished.

(e) Covenant contained in Transfer No. F35183B

In consideration of FIFTEEN THOUSAND SIX HUNDRED DOLLARS (\$ 15,600.00)

(d) Insert appropriate words,
 if desired, this space may be
 used in the case of a transfer
 by direction.

(the receipt whereof is hereby acknowledged), paid to the transferor by^(d) **KENNETH GREY and IRENE GREY**

hereby transfers to

(c) Full name, address and
 occupation of transferee.
 If more than one transferee
 state whether joint tenants
 or tenants in common.
 Unless otherwise stated
 tenants in common will be
 presumed to hold in equal
 shares.

(f) **KENNETH GREY** of 106 Bogalara Road, Old Toongabie, Production Planner
 and **IRENE GREY** his wife, of the same address

hereinafter referred to as the TRANSFeree

an estate in fee simple^(b) as joint tenants

In the land described in the following schedule

Set out lot and plan number,
 also the Sec. also
 sections 227 and 227AA
 Local Government Act,
 1919.

Reference to title		Whole or Part	Description of land if part only ⁽¹⁾	Coun.y	Parish
Volume	Folio				
6242	231	Part	Lot 3, Deposited Plan 568438	Cumberland	St, John
12418	3				
12418	4				
12418	5	Whole			

12418-244
25/6

X 1108

G 427-2

RULE UP ALL BLANKS

delivered to CSB 17/5/74

(4) Here insert any entire-
relative covenants
exceptions intended to
included. This is a
provision contained in
section 88(1) of the
Conveyancing Act 1919
If the space provided
is sufficient, additional
of the same file and size
of paper as this form the
be used. A binding size
of 11 inches and a
weight of not less than
170 lbs should be printed.
Each additional sheet to
be signed by the parties to
the abutting documents.

AND the Transferees for themselves and their assigns COVENANT with the Transferors and their assigns for the benefit of any adjoining land owned by the Transferors but only during the ownership thereof by the Transferors and their assigns other than purchasers on sale that no fence shall be erected on the property hereby sold to divide it from such adjoining land without the consent of the Transferors but such consent shall not be withheld if such fence is erected without expense to the Transferors and their assigns and in favour of any person dealing with the Transferees or their assigns such consent shall be deemed to have been given in respect of every fence for the time being erected.

AND for the purpose of Section 88 of the Conveyancing Act 1919-1953 (as amended) IT IS HEREBY AGREED AND DECLARED THAT :-

- (a) The land to which the benefit of the above covenant is intended to be appurtenant is the whole of the land in Deposited Plan 568438 other than the land hereby transferred;
- (b) The land which is to be subject to the burden of the above covenant is the land hereby transferred; and
- (c) The persons by whom the above covenant may be released varied or modified are the Transferors their executors administrators or assigns.

Signed in my presence by the transferees who are personally known to me

.....
Signature of Witness

BRIAN MANNING DODD
Name of Witness (BLOCK LETTERS)

8/11 HUNTER ST SYDNEY
Address of Witness

J. Gray
Ken Gray

[Signature]

Solicitor for the Transferee

[Signature]

<p style="text-align: center;">N 894858 DEPARTMENTAL USE ONLY</p> <p>TRANSFER</p> <p style="text-align: center;"><i>Subject to Covenant.</i></p> <p>Checked <i>[initials]</i></p> <p>Passed</p> <p>Signed <i>[initials]</i></p> <p style="text-align: center;">REGISTERED</p> <p style="text-align: center;">1. 7. 1977</p> <p style="text-align: center;"><i>Jawatson</i> Registrar General</p> 	<p style="text-align: center;">TO BE COMPLETED BY LODGING PARTY</p> <p>Lodged by: <i>Wickworth Trust & Co. Solicitors</i></p> <p>Address: <i>Solicitors</i></p> <p>Phone No.: <i>211 Bondar St</i></p> <p>Documents lodged herewith</p> <p>1. <i>107 177-77 2/1</i></p> <p>2. _____</p> <p>3. _____</p> <p>4. _____</p> <p>5. _____</p> <p>Received Documents _____</p> <p style="text-align: right;">Receiving Clerk <i>[Signature]</i></p> <p>AUTHORITY FOR USE OF INSTRUMENT OF TITLE</p> <p>Authority is hereby given for the use of _____</p> <p style="text-align: center;">(insert reference to certificates, grants or dealings)</p> <p>lodged in connection with _____ for the</p> <p style="text-align: center;">(insert number of plan or dealing)</p> <p>registration of this dealing and for delivery to _____</p> <p style="text-align: center;">(BLOCK LETTERS)</p> <p style="text-align: center;">Signature _____</p> <p style="text-align: center;">Name (BLOCK LETTERS) _____</p> <p>MEMORANDUM AS TO NON-REVOCATION OF POWER OF ATTORNEY</p> <p style="text-align: center;">(To be signed at the time of executing the within dealing)</p> <p>The undersigned states that he has no notice of the revocation of the Power of Attorney registered No. _____</p> <p>Miscellaneous Register under the authority of which he has just executed the within dealing.</p> <p>Signed at _____</p> <p>the _____ day of _____ 19 _____</p> <p style="text-align: center;">Signature of attorney _____</p> <p style="text-align: center;">Signature of witness _____</p> <p>CERTIFICATE OF J.P. &c. TAKING DECLARATION OF ATTESTING WITNESS(es)</p> <p>I certify that _____</p> <p>the attesting witness to this dealing, appeared before me at _____</p> <p style="text-align: center;">the _____ day of _____ 19 _____</p> <p>and declared that he personally knew _____</p> <p>the person signing the same, and whose signature thereto he has attested, and that the name purporting to be such signature of the said _____</p> <p style="text-align: center;">+</p> <p>is his own handwriting and that he was of sound mind and freely and voluntarily signed the same.</p> <p style="text-align: center;">Signature _____</p> <p style="text-align: center;">Name (BLOCK LETTERS) _____</p> <p style="text-align: center;">Qualification _____</p>
---	---

(1) Unless the instrument of title has been lodged by the person lodging the dealing, or if it has been authorised previously, its authority must be furnished by the person otherwise entitled to delivery of the certificate of title, grant &c.

(2) Not required where dealing attested in accordance with note (3). In other cases to be signed by one of the persons referred to in note (3).

Sewer Service Diagram

Application Number: 8000639253

METROPOLITAN WATER SEWERAGE AND DRAINAGE BOARD
SEWERAGE SERVICE DIAGRAM
Municipality of Parramatta
No. 876326 *GREY*

SYMBOLS AND ABBREVIATIONS

□	Boundary Trap	■ RV	Reflux Valve	IP	Induct Pipe	Bsn	Basin
⊕	Inspection Shaft	○	Cleaning Eye	MF	Mica Flap	Shr	Shower
■	Pit	○ VERT	Vertical Pipe	T	Tubs	WIP	Wrought Iron Pipe
■ G	Grease Interceptor	○ VP	Vent Pipe	KS	Kitchen Sink	CIP	Cast Iron Pipe
■	Gully	○ SVP	Soil Vent Pipe	WC	Water Closet	FW	Floor Waste
■ PT	P Trap	○ DCC	Down Cast Cowl	BW	Bath Waste	WM	Washing Machine

SEWER AVAILABLE

Where the sewer is not available and a special inspection is involved the Board accepts no responsibility for the suitability of the drainage in relation to the eventual position of the Board's Sewer.

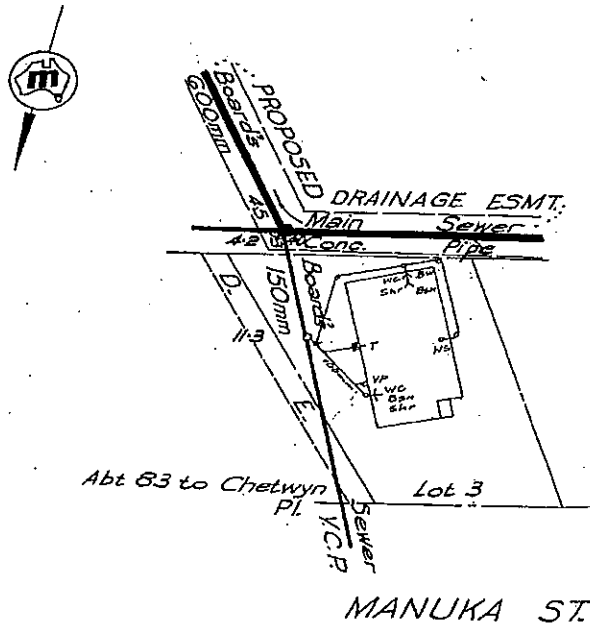

RATE No. W.C.s.
SHEET No. **5300** U.C.s. **Scale 1 : 500** For House Services Engineer

DRAINAGE		BRANCH OFFICE		PLUMBING	
.....W.C.	Supervised by	Date	Date	Supervised by	Date
.....Bth.	Inspector	HL	Inspector	
.....Shr.		LL		
.....Bsn.	Examined by		Drainer	1429 558	
.....K.S.	Chief Inspector		Plumber		
.....T.	Tracing Checked		Boundary Trap		
.....Plg.			■/is not required		
.....Dgs. Int.					
.....Dgs. Ext.					

Disclaimer

The information in this diagram shows the private wastewater pipes on this property. It may not be accurate or to scale and may not show our pipes, structures or all property boundaries. If you'd like to see these, please buy a Service location print.

Service Location Print
Application Number: 8000639252

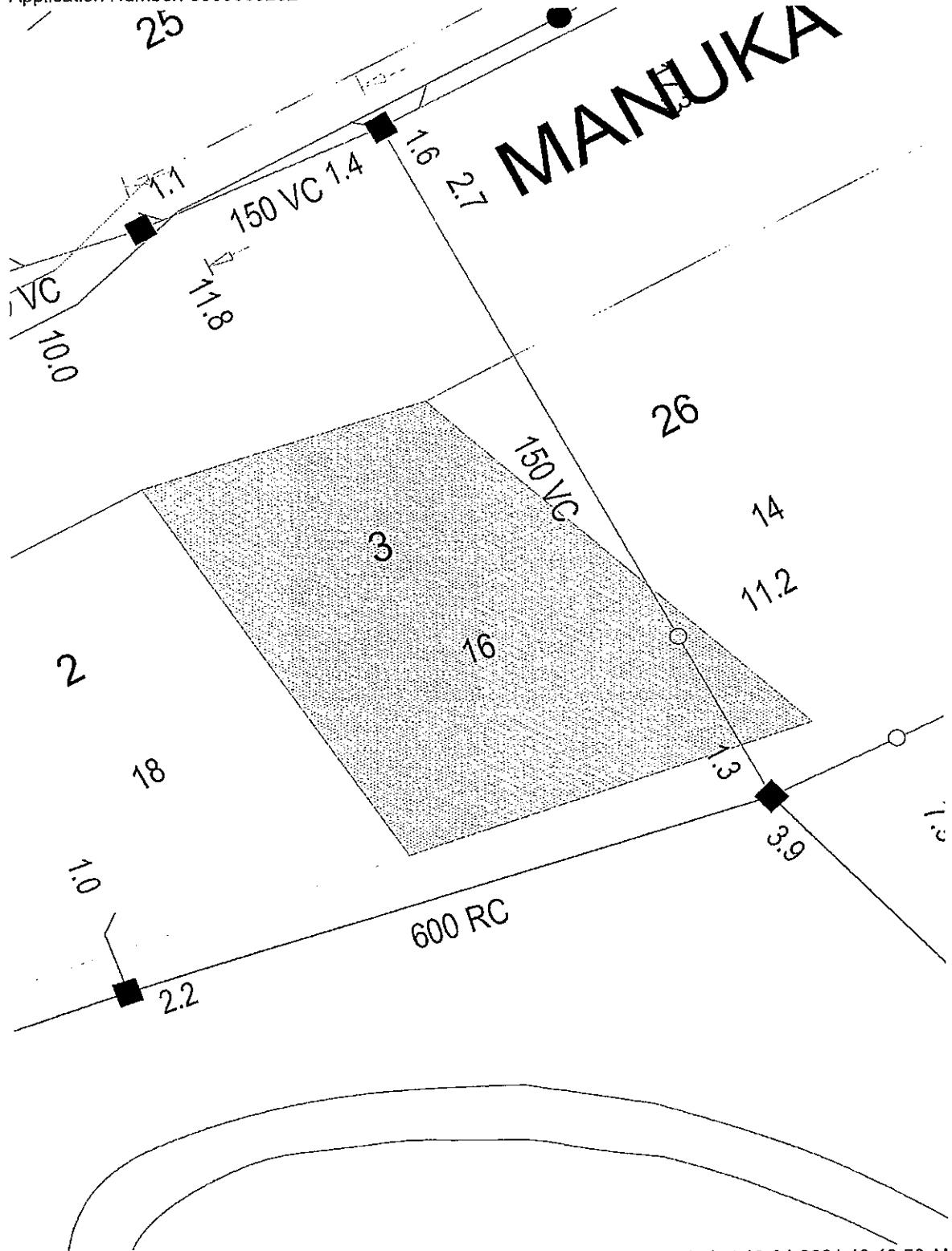

Document generated at 19-04-2021 10:43:56 AM

Disclaimer

The information on this print shows if we provide any water, wastewater or stormwater services to this property. It may not be accurate or to scale. If you'd like to see the location of private wastewater pipes on the property, please buy a Sewer service diagram.

Asset Information

Legend

Sewer		Property Details	
Sewer Main (with flow arrow & size type text)		Boundary Line	
Disused Main		Easement Line	
Rising Main		House Number	
Maintenance Hole (with upstream depth to Invert)		Lot Number	
Sub-surface chamber		Proposed Land	
Maintenance Hole with Overflow chamber		Sydney Water Heritage Site (please call 132 092 and ask for the Heritage Unit)	
Ventshaft EDUCT			
Ventshaft INDUCT			
Property Connection Point (with chainage to downstream MH)			
Concrete Encased Section			
Terminal Maintenance Shaft			
Maintenance Shaft			
Rodding Point			
Lamphole			
Vertical			
Pumping Station			
Sewer Rehabilitation			
Pressure Sewer		Water	
Pressure Sewer Main		WaterMain - Potable (with size type text)	
Pump Unit (Alarm, Electrical Cable, Pump Unit)		Disconnected Main - Potable	
Property Valve Boundary Assembly		Proposed Main - Potable	
Stop Valve		Water Main - Recycled	
Reducer / Taper		Special Supply Conditions - Potable	
Flushing Point		Special Supply Conditions - Recycled	
		Restrained Joints - Potable	
		Restrained Joints - Recycled	
		Hydrant	
		Maintenance Hole	
		Stop Valve	
		Stop Valve with By-pass	
		Stop Valve with Tapers	
		Closed Stop Valve	
		Air Valve	
		Valve	
		Scour	
		Reducer / Taper	
		Vertical Bends	
		Reservoir	
		Recycled Water is shown as per Potable above. Colour as Indicated	
Vacuum Sewer		Private Mains	
Pressure Sewer Main		Potable Water Main	
Division Valve		Recycled Water Main	
Vacuum Chamber		Sewer Main	
Clean Out Point		Symbols for Private Mains shown grey	
Stormwater			
Stormwater Pipe			
Stormwater Channel			
Stormwater Gully			
Stormwater Maintenance Hole			

Disclaimer

The information on this print shows if we provide any water, wastewater or stormwater services to this property. It may not be accurate or to scale. If you'd like to see the location of private wastewater pipes on the property, please buy a Sewer service diagram.

Pipe Types

ABS	Acrylonitrile Butadiene Styrene	AC	Asbestos Cement
BRICK	Brick	CI	Cast Iron
CICL	Cast Iron Cement Lined	CONC	Concrete
COPPER	Copper	DI	Ductile Iron
DICL	Ductile Iron Cement (mortar) Lined	DIPL	Ductile Iron Polymeric Lined
EW	Earthenware	FIBG	Fibreglass
FL BAR	Forged Locking Bar	GI	Galvanised Iron
GRP	Glass Reinforced Plastics	HDPE	High Density Polyethylene
MS	Mild Steel	MSCL	Mild Steel Cement Lined
PE	Polyethylene	PC	Polymer Concrete
PP	Polypropylene	PVC	Polyvinylchloride
PVC - M	Polyvinylchloride, Modified	PVC - O	Polyvinylchloride, Oriented
PVC - U	Polyvinylchloride, Unplasticised	RC	Reinforced Concrete
RC-PL	Reinforced Concrete Plastics Lined	S	Steel
SCL	Steel Cement (mortar) Lined	SCL IBL	Steel Cement Lined Internal Bitumen Lined
SGW	Salt Glazed Ware	SPL	Steel Polymeric Lined
SS	Stainless Steel	STONE	Stone
VC	Vitrified Clay	WI	Wrought Iron
WS	Woodstave		

Further Information

Please consult the Dial Before You Dig enquiries page on the Sydney Water website.

For general enquiries please call the Customer Contact Centre on 132 092

In an emergency, or to notify Sydney Water of damage or threats to its structures, call 13 20 90 (24 hours, 7 days)



CITY OF PARRAMATTA

PLANNING CERTIFICATE

CERTIFICATE UNDER SECTION 10.7

Environmental Planning and Assessment Act, 1979 as amended

Leap Searching
DX 578
SYDNEY

Certificate No: 2021/2843
Fee: \$53.00
Issue Date: 19 April 2021
Receipt No: 6336471
Applicant Ref: 1052/21:148004

DESCRIPTION OF LAND

Address: 16 Manuka Street
CONSTITUTION HILL NSW 2145

Lot Details: LOT 3 DP 568438

SECTION A

The following Environmental Planning Instrument to which this certificate relates applies to the land:

Parramatta Local Environmental Plan 2011

For the purpose of **Section 10.7(2)** it is advised that as the date of this certificate the abovementioned land is affected by the matters referred to as follows:

The land is zoned: **R2 Low Density Residential PLEP2011**

Zone R2 - Low Density Residential (Parramatta Local Environmental Plan 2011)

Issued pursuant to Section 10.7 of the Environmental Planning and Assessment Act, 1979.

NOTE: This table is an excerpt from Parramatta Local Environmental Plan 2011 and must be read in conjunction with and subject to the other provisions of that instrument, and in force at that date.

Zone R2 Low Density Residential

1 Objectives of zone

- To provide for the housing needs of the community within a low density residential environment.
- To enable other land uses that provide facilities or services to meet the day to day needs of residents.
- To ensure that non-residential land uses are located in a context and setting that minimises impacts on the amenity of a low density residential environment.
- To allow for a range of community facilities to be provided to serve the needs of residents, workers and visitors in residential neighbourhoods.

2 Permitted without consent

Home occupations

3 Permitted with consent

Bed and breakfast accommodation; Boarding houses; Building identification signs; Business identification signs; Centre-based child care facilities; Community facilities; Dual occupancies; Dwelling houses; Educational establishments; Emergency services facilities; Environmental facilities; Environmental protection works; Exhibition homes; Exhibition villages; Flood mitigation works; Group homes; Health consulting rooms; Home-based child care; Home businesses; Home industries; Hospitals; Hostels; Neighbourhood shops; Oyster aquaculture; Pond-based aquaculture; Public administration buildings; Recreation areas; Recreation facilities (indoor); Recreation facilities (outdoor); Respite day care centres; Roads; Seniors housing; Tank-based aquaculture; Water recycling facilities

4 Prohibited

Any development not specified in item 2 or 3

SECTION B

State Policies and Regional Environmental Plans

The land is also affected by the following State Environmental Planning Policies (SEPP) and Regional Environmental Plans (SREP):

State Environmental Planning Policy (SEPP) No.19 - Bushland in Urban Areas

State Environmental Planning Policy (SEPP) No.21 - Caravan Parks

State Environmental Planning Policy (SEPP) No.33 - Hazardous and Offensive Development

State Environmental Planning Policy (SEPP) No.55 - Remediation of Land

State Environmental Planning Policy (SEPP) No.64 - Advertising and Signage

State Environmental Planning Policy (SEPP) No.65 – Design Quality of Residential Flat Development.

State Environmental Planning Policy (SEPP) No.70 -Affordable Housing (Revised Schemes)
State Environmental Planning Policy (SEPP) (Housing for Seniors or People with a Disability) 2004
State Environmental Planning Policy (SEPP) (Building Sustainability Index: BASIX) 2004
State Environmental Planning Policy (SEPP) (State Significant Precincts) 2005
State Environmental Planning Policy (SEPP) (Mining, Petroleum Production and Extractive Industries) 2007
State Environmental Planning Policy (SEPP) (Infrastructure) 2007
State Environmental Planning Policy (SEPP) (Exempt and Complying Development Codes) 2008
State Environmental Planning Policy (SEPP) (Affordable Rental Housing) 2009
State Environmental Planning Policy (SEPP) (Vegetation in Non-Rural Areas) 2017
State Environmental Planning Policy (SEPP) (Educational Establishments and Child Care Facilities) 2017
State Environmental Planning Policy (SEPP) (Concurrences) 2018
State Environmental Planning Policy (SEPP) (Primary Production and Rural Development) 2019

Sydney Regional Environmental Plan (SREP) No.9 (No.2) - Extractive Industries
Sydney Regional Environmental Plan (SREP) – (Sydney Harbour Catchment) 2005

DRAFT State Environmental Planning Policy to amend State Environmental Planning Policy (SEPP) (Sydney Region Growth Centres) 2006 – Amendment to include the Greater Parramatta Priority Growth Area as a Growth Centre
DRAFT State Environmental Planning Policy (Draft SEPP) – Environment

N.B. All enquiries as to the application of Draft State Environmental Planning Policies should be directed to The NSW Department of Planning, Industry and Environment.

Draft Local Environmental Plan

The land is affected by a Draft Local Environmental Plan which has been placed on Public Exhibition and has not yet been published. The Draft Local Environmental Plan is described below.

Planning Proposal – Draft Parramatta Local Environmental Plan 2020 (Harmonisation LEP)

This land is affected by a planning proposal seeking to create a single consolidated Local Environmental Plan (LEP) that will apply to the whole City of Parramatta Local Government Area (LGA). The new LEP will replace five (5) existing LEPs where they apply to land within the Parramatta LGA. These include:

- *Auburn Local Environmental Plan 2010*
- *Holroyd Local Environmental Plan 2013*
- *Hornsby Local Environmental Plan 2013*
- *Parramatta Local Environmental Plan 2011*
- *Parramatta (former The Hills) Local Environmental Plan 2012*

The new Parramatta LEP will create a common set of objectives, land use tables and provisions for all land within the LGA. This will result in some changes to the current planning controls applying to certain areas, including:

- Changes to land uses permitted in certain areas, because of the creation of a common set of land use tables.

- Prohibiting dual occupancy developments in certain locations.
- A minimum lot size of 600sqm and frontage to a public road of 15 metres development standards for Dual Occupancies or Manor Houses where they are permitted;
- Changes to height and FSR controls applying to residential zones – these include:
 - applying a FSR of 0.5:1 to R2 Low Density Residential zoned land and a FSR of 0.6:1 to R3 Medium Density Residential zoned land in the Parramatta (former The Hills) LEP 2012 and Hornsby Council LEP 2013 (where none currently applies);
 - reducing the FSR from 0.75:1 to 0.6:1 applying to R3 Medium Density Residential zoned land in Silverwater;
 - increasing the height limit from 8.5 metres to 9 metres applying to R2 Low Density Residential zoned land in the Hornsby Council LEP 2013;
 - applying a 11 metre height limit to R3 Medium Density Residential zoned land in the Parramatta (former The Hills) LEP 2012, Hornsby LEP 2013 and Auburn LEP 2010;
 - applying a FSR control to R4 High Density Residential zoned land in the former Parramatta (former The Hills) LEP 2012, Hornsby LEP 2013 and Auburn LEP 2010 (where none is currently applied); and,
 - A limited number of targeted site-specific changes associated with changes of zoning or to address anomalies.
- Applying a 550sqm minimum subdivision lot size to residential land (except R2 Low Density Residential zoned land in the Parramatta (former The Hills) LEP 2012, which will retain the existing 700sqm requirement)
- Mapping of additional Biodiversity Land and Riparian Land and Waterways
- A limited number of changes to the zoning of some sites to address inconsistencies and anomalies across current land use plans, this includes:
 - Removing the R1 General Residential zone, and rezoning this land to R4 High Density Residential or R3 Medium Density Residential;
 - Rezoning all public bushland reserves to E2 Environmental Conservation;
 - Rezoning some R3 Medium Density Residential zoned land in Northmead, North Rocks and Carlingford to R2 Low Density Residential; and,
 - Rezoning existing lawful places of public worship in the former Parramatta Council area from SP1 Special Activities to R2 Low Density Residential.

Further information on the Planning Proposal for the new Parramatta Local Environmental Plan (LEP) can be found at: www.cityofparramatta.nsw.gov.au/planningharmonisation or by contacting Council

Please note. Council is separately progressing a number of planning proposals relating to specific sites in the LGA. The intention is that, should these site-specific planning proposals be finalised before the new consolidated LEP is made, the respective amendments to planning controls will be carried over into the new LEP and the Harmonisation Planning Proposal will be updated as needed.

Proposed Zoning Draft Parramatta LEP 2020

The land is proposed to be zoned in the in the Draft Parramatta LEP 2020:

R2 Zone Low Density Residential PLEP2020

Proposed Zone R2 Low Density Residential (Draft Parramatta LEP 2020)

Note: *The following land use table is an excerpt from the Draft Parramatta Local Environmental Plan 2020 (Harmonisation LEP) document exhibited on 31 August 2020 and must be read in conjunction with and subject to other provisions of that draft instrument.*

Zone R2 Low Density Residential

1 Objectives of zone

- To provide for the housing needs of the community within a low density residential environment.
- To enable other land uses that provide facilities or services to meet the day to day needs of residents.
- To maintain the existing low density residential character of the area.
- To protect and enhance tree canopy, existing vegetation and other natural features.
- To ensure that non-residential land uses are located in a context and setting that minimises impacts on the amenity of a low density residential environment.
- To allow for a range of community facilities to be provided to serve the needs of residents, workers and visitors in residential neighbourhoods.

2 Permitted without consent

Home occupations

3 Permitted with consent

Bed and breakfast accommodation; Boarding houses; Building identification signs; Business identification signs; Centre-based child care facilities; Community facilities; Dual occupancies; Dwelling houses; Educational establishments; Emergency services facilities; Environmental protection works; Exhibition homes; Exhibition villages; Flood mitigation works; Group homes;; Home-based child care; Home businesses; Home industries;; Hostels; Neighbourhood shops; Oyster aquaculture; Pond-based aquaculture; Public administration buildings; Recreation areas;; Recreation facilities (outdoor); Respite day care centres; Roads; School-based child care; Seniors housing; Tank-based aquaculture; Water recycling facilities

4 Prohibited

Any development not specified in item 2 or 3

Dual Occupancy Prohibition Map – Draft Parramatta LEP 2020

The land is located on land shown coloured purple and edged heavy black on the proposed Dual Occupancy Prohibition Map of the Draft Parramatta LEP 2020.

It is proposed that despite any other provision of the Draft Parramatta LEP 2020, development consent must not be granted to development for the purpose of a dual occupancy on land shown coloured purple and edged heavy black on the Dual Occupancy Prohibition Map of the Draft Parramatta LEP 2020.

It is also proposed under Clause 4.1(7) of the Draft Parramatta LEP 2020, that development consent must not be granted for the subdivision of a lot on which a dual occupancy is erected if:

- (a) the lot is located on land shown coloured purple and edged heavy black on the Dual Occupancy Prohibition Map, and
- (b) development consent for the dual occupancy was issued after the 31 August 2020.

Development Control Plan

The land is affected by Parramatta Development Control Plan 2011.

The Minister for Planning has issued directions that provisions of an EPI do not apply to certain Part 4 development where a concept plan has been approved under Part 3A.

Development Standards

The land is affected by a minimum lot size of 600 square metres for a Dual Occupancy under Clause 6.11 of the Parramatta Local Environmental Plan 2011.

The land is affected by a minimum lot size of 550 square metres on the Minimum Lot Size map of Parramatta Local Environmental Plan 2011.

Development Contribution Plan

The Parramatta Section 94A Development Contributions Plan (Amendment No. 5) applies to the land.

Heritage Item/Heritage Conservation Area

An item of environmental heritage is not situated on the land.

The land is not located in a heritage conservation area.

Road Widening

The land is not affected by road widening or road realignment under:

- (a) Division 2 of Part 3 of the Roads Act 1993.
- (b) Any Environmental Planning Instrument.
- (c) Any Resolution of Council.

Land Reservation Acquisition

The land is not affected by Land Reservation Acquisition in Parramatta Local Environmental Plan 2011.

Site Compatibility Certificate (Seniors Housing, Infrastructure and Affordable Rental Housing)

At the date of issue of this certificate Council is not aware of any

- a. Site compatibility certificate (affordable rental housing),
- b. Site compatibility certificate (infrastructure) or site compatibility certificate (schools or TAFE establishments),
- c. Site compatibility certificate (seniors housing)

in respect to the land issued pursuant to the Environmental Planning & Assessment Amendment (Site Compatibility Certificates) Regulation 2009 (NSW).

Contamination

Matters contained in Clause 59(2) as amended in the Contaminated Land Management Act 1997 – as listed:

Clause 59(2)(a) - is the land to which the certificate relates is significantly contaminated land?

NO

Clause 59(2)(b) - is the land to which the certificate relates is subject to a management order?

NO

Clause 59(2)(c) - is the land to which the certificate relates is the subject of an approved voluntary management proposal?

NO

Clause 59(2)(d) - is the land to which the certificate relates is subject to an ongoing maintenance order?

NO

Clause 59(2)(e) - is the land to which the certificate relates is the subject of a site audit statement?

NO

Tree Preservation

The land is subject to Section 5.4 Preservation of Trees or Vegetation in Parramatta Development Control Plan 2011.

Council has not been notified of an order under the Trees (Disputes Between Neighbours) Act 2006 to carry out work in relation to a tree on the land.

Coastal Protection

Has the owner (or any previous owner) of the land been consented in writing to the land being subject to annual charges under section 496B of the Local Government Act 1993 for coastal protection services that relate to existing coastal protection works (within the meaning of section 553B of that Act)?

NO

Council Policy

Council has not adopted a policy to restrict the development of the land by reason of the likelihood of projected sea level rise (coastal protection), tidal inundation, subsidence or any other risk.

Council has adopted a policy covering the entire City of Parramatta to restrict development of any land by reason of the likelihood of flooding.

Council has adopted by resolution a policy on contaminated land that applies to all land within the City of Parramatta. The Policy will restrict the development of the land if the circumstances set out in the policy prevail. A copy of the policy is available on Councils website at www.cityofparramatta.nsw.gov.au or from the Customer Service Centre.

Mine Subsidence

The land is not affected by the Coal Mine Subsidence Compensation Act 2017 proclaiming land to be a Mine Subsidence District.

Bushfire Land

The land is not bushfire prone land.

Threatened Species

The Environment Agency Head with responsibility for the Biodiversity Conservation Act 2016 has not advised Council that the land includes or comprises an area of outstanding biodiversity value.

Biodiversity certified land

The land is not biodiversity certified land under Part 8 of the Biodiversity Conservation Act 2016.

Note. Biodiversity certified land includes land certified under Part 7AA of the Threatened Species Conservation Act 1995 that is taken to be certified under Part 8 of the Biodiversity Conservation Act 2016.

Biodiversity stewardship sites

The Chief Executive of the Office of Environment and Heritage has not notified the Council if the land is a biodiversity stewardship site under a biodiversity stewardship agreement under Part 5 of the Biodiversity Conservation Act 2016.

Note: Biodiversity stewardship agreements include biobanking agreements under Part 7A of the Threatened Species Conservation Act 1995 that are taken to be biodiversity stewardship agreements under Part 5 of the Biodiversity Conservation Act 2016.

Native vegetation clearing set asides

Council has not been notified of the land containing a set aside area under section 60ZC of the Local Land Services Act 2013.

Property vegetation plans

Council has not been notified of the existence of the property vegetation plan approved under Part 4 of the Native Vegetation Act 2003 on the land.

Paper Subdivision information

The land is not subject to any development plan adopted by a relevant authority or that is proposed to be subject to a consent ballot. A subdivision order does not apply to the land.

Note: Words and expressions used in this clause have the same meaning as they have in Part 16C of the Environmental Planning and Assessment Regulation 2000.

Loose-Fill Asbestos Register

Council has not been notified by NSW Fair Trading of the property being listed on the loose-fill asbestos insulation register maintained by the Secretary of NSW Fair Trading.

Site verification certificates

Council is not aware of whether there is a current site verification certificate in respect of the land.

Affected Building Notices and Building Product Rectification Orders

Council is not aware of whether there is any affected building notice, building product rectification order or notice of intention to make a building product rectification order that is in force in respect of the land.

Note: *affected building notice* has the same meaning as in the *Building Products (Safety) Act 2017*. *building product rectification order* has the same meaning as in the *Building Products (Safety) Act 2017*.

**State Environmental Planning Policy
(Exempt and Complying Development Codes) 2008**

Note: This does not constitute a Complying Development Certificate under section 4.27 of the Environmental Planning and Assessment Act 1979

The following information only addresses whether or not the land is land on which complying development may be carried out under each of the codes for complying development because of the provisions of **Clauses 1.17A (1) (c) to (e), (2), (3) and (4), 1.18 (1)(c3) and 1.19** of State Environmental Planning Policy (Exempt and Complying Development Codes) 2008. It is not a statement that complying development is permissible on the land.

Other land exemptions within of the State Environmental Planning Policy (Exempt and Complying Development Codes) 2008 may also apply. Furthermore, other provisions within the relevant Local Environmental Plan or a State Environmental Planning Policy which restrict complying development on the land may also apply.

It is your responsibility to ensure that you comply with the relevant complying development provisions for the land. Failure to comply with these provisions may mean that a Complying Development Certificate is invalid.

Housing Code; Low Rise Housing Diversity Code; Rural Housing Code

Complying Development pursuant to the Housing Code, Low Rise Housing Diversity Code and Rural Housing Code may be carried out on the land under **Clause 1.17A (1) (c) to (e), (2), (3) and (4) and Clause 1.18 (1)(c3) and Clause 1.19** of State Environmental Planning Policy (Exempt and Complying Development Codes) 2008.

Commercial and Industrial (New Buildings and Additions) Code

Complying Development pursuant to the Commercial and Industrial (New Buildings and Additions) Code may be carried out on the land under **Clause 1.17A (1) (c) to (e), (2), (3) and (4) and Clause 1.18 (1)(c3) and Clause 1.19** of State Environmental Planning Policy (Exempt and Complying Development Codes) 2008.

Housing Alterations Code; General Development Code; General Commercial and Industrial (Alterations) Code; Container Recycling Facilities Code; Subdivision Code; Demolition Code; Fire Safety Code

Complying Development pursuant to the Housing Alterations Code, General Development Code, General Commercial and Industrial (Alterations) Code, Container Recycling Facilities Code, Subdivision Code, Demolition Code and Fire Safety Code may be carried out on the land under **Clause 1.17A (1) (c) to (e), (2), (3) and (4) and Clause 1.18 (1)(c3) and Clause 1.19** of State Environmental Planning Policy (Exempt and Complying Development Codes) 2008.

SPECIAL NOTES

The land is not identified on the Acid Sulfate Soils map in Parramatta Local Environmental Plan 2011. Future development on the land may require investigation.

Applicants for Sections 10.7 Certificates are advised that Council does not hold sufficient information to fully detail the effect of any encumbrances on the title of the subject land. The information available to Council is provided on the basis that neither Council nor its servants hold out advice or warrant to you in any way its accuracy, nor shall Council or its servants, be liable for any negligence in the preparation of that information. Further information should be sought from relevant Statutory Departments.

Brett Newman
Chief Executive Officer

per

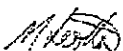

dated 19 April 2021