



Contract of Sale

ANTONELLA CATHERINE
COMMISSO AS THE EXECUTOR OF
THE ESTATE OF PASQUALE DE
GENNARO AND RITA DE GENNARO
and IPPOLITO DE GENNARO

8 Carmel Court, Sydenham

310-312 Bay Street
Port Melbourne 3207

92 Ferguson Street
Williamstown VIC 3016

55 Anderson Street
Yarraville 3013

Phone 9681 9888

www.indeedconvey.com

This firm holds Professional Indemnity Insurance

Contract of sale of land

The vendor agrees to sell and the purchaser agrees to buy the property, being the land and the goods, for the price and on the terms set out in this contract.

The terms of this contract are contained in the -

- particulars of sale; and
- special conditions, if any; and
- general conditions (which are in standard form: see general condition 6.1)

in that order of priority.

SIGNING OF THIS CONTRACT

WARNING: THIS IS A LEGALLY BINDING AGREEMENT. YOU SHOULD READ THIS CONTRACT BEFORE SIGNING IT.

Purchasers should ensure that they have received a section 32 statement from the vendor before signing this contract. In this contract, "section 32 statement" means the statement required to be given by a vendor under section 32 of the *Sale of Land Act 1962*.

The authority of a person signing -

- under power of attorney; or
- as director of a corporation; or
- as agent authorised in writing by one of the parties - must be noted beneath the signature.

Any person whose signature is secured by an estate agent acknowledges being given by the agent at the time of signing a copy of the terms of this contract.

SIGNED BY THE PURCHASER:

..... on/...../2022

Print name(s) of person(s) signing:

State nature of authority, if applicable:

This offer will lapse unless accepted within [] clear business days (3 clear business days if none specified)
In this contract, "business day" has the same meaning as in section 30 of the *Sale of Land Act 1962*

SIGNED BY THE VENDOR:

..... on/...../2022

Print name(s) of person(s) signing:

ANTONELLA CATHERINE COMMISSO AS THE EXECUTOR OF THE ESTATE OF PASQUALE DE GENNARO AND RITA DE GENNARO AND IPPOLITO DE GENNARO

State nature of authority, if applicable:

The **DAY OF SALE** is the date by which both parties have signed this contract.

IMPORTANT NOTICE TO PURCHASERS – COOLING-OFF

Cooling-off period (Section 31 of the *Sale of Land Act 1962*)

You may end this contract within 3 clear business days of the day that you sign the contract if none of the exceptions listed below applies to you.

You must either give the vendor or the vendor's agent **written** notice that you are ending the contract or leave the notice at the address of the vendor or the vendor's agent to end this contract within this time in accordance with this cooling-off provision.

You are entitled to a refund of all the money you paid EXCEPT for \$100 or 0.2% of the purchase price (whichever is more) if you end the contract in this way.

EXCEPTIONS: The 3-day cooling-off period does not apply if:

- you bought the property at a publicly advertised auction or on the day on which the auction was held; or
- you bought the land within 3 clear business days before a publicly advertised auction was to be held; or
- you bought the land within 3 clear business days after a publicly advertised auction was held; or
- the property is used primarily for industrial or commercial purposes; or
- the property is more than 20 hectares in size and is used primarily for farming; or
- you and the vendor have previously signed a contract for the sale of the same land in substantially the same terms; or
- you are an estate agent or a corporate body.

Table of contents

Particulars of Sale

Special Conditions

General Conditions

1.	ELECTRONIC SIGNATURE	8
2.	LIABILITY OF SIGNATORY	8
3.	GUARANTEE	8
4.	NOMINEE	8
5.	ENCUMBRANCES	8
6.	VENDOR WARRANTIES	8
7.	IDENTITY OF THE LAND	9
8.	SERVICES	9
9.	CONSENTS	9
10.	TRANSFER & DUTY	9
11.	RELEASE OF SECURITY INTEREST	9
12.	BUILDING WARRANTY INSURANCE	10
13.	GENERAL LAW LAND	10
14.	DEPOSIT	11
15.	DEPOSIT BOND	12
16.	BANK GUARANTEE	12
17.	SETTLEMENT	13
18.	ELECTRONIC SETTLEMENT	13
19.	GST	14
20.	LOAN	14
21.	BUILDING REPORT	14
22.	PEST REPORT	15
23.	ADJUSTMENTS	15
24.	FOREIGN RESIDENT CAPITAL GAINS WITHHOLDING	15
25.	GST WITHHOLDING	16
26.	TIME & CO OPERATION	17
27.	SERVICE	17
28.	NOTICES	18
29.	INSPECTION	18
30.	TERMS CONTRACT	18
31.	LOSS OR DAMAGE BEFORE SETTLEMENT	18
32.	BREACH	18
33.	INTEREST	19
34.	DEFAULT NOTICE	19
35.	DEFAULT NOT REMEDIED	19

NOTICE TO PURCHASERS OF PROPERTY OFF-THE-PLAN

Off-the-plan sales (Section 9AA(1A) of the *Sale of Land Act 1962*)

You may negotiate with the vendor about the amount of the deposit moneys payable under the contract of sale, up to 10 per cent of the purchase price.

A substantial period of time may elapse between the day on which you sign the contract of sale and the day on which you become the registered proprietor of the lot.

The value of the lot may change between the day on which you sign the contract of sale of that lot and the day on which you become the registered proprietor.

Particulars of sale

Vendor's estate agent

White Knight Estate Agents

Office 118A/118-120 Westwood Drive, Burnside, VIC 3023 Australia

Email: dalexo@whiteknightestateagents.com.au

Tel: 0403 491 845

Mob:

Fax:

Ref: Dimitri Alexo

Vendor

ANTONELLA CATHERINE COMMISSO AS THE EXECUTOR OF THE ESTATE OF PASQUALE DE GENNARO AND RITA DE GENNARO AND IPPOLITO DE GENNARO

Vendor's legal practitioner or conveyancer

Indeed Convey

310-312 Bay Street, Port Melbourne 3207

92 Ferguson Street, Williamstown 3016

55 Anderson Street, Yarraville 3013

Email: dayjelle@indeedconvey.com

Tel: 9681 9888

Mary Commisso and Dayjelle Smith

Ref: DS:11275/DS

Purchaser

Name:

.....

Address:

ABN/ACN:

Email:

Purchaser's legal practitioner or conveyancer

Name:

Address:

Email:

Tel: Mob: Fax: Ref:

Land (general conditions 7 and 13)

The land is described in the table below –

Certificate of Title reference	being lot	on plan
Volume 10026 Folio 037	142	221666A

If no title or plan references in the table, the land is as described in the section 32 statement or the register search statement and the document referred to as the diagram location in the register search statement attached to the section 32 statement

The land includes all improvements and fixtures.

Property address

The address of the land is: **8 Carmel Court, Sydenham 3037**

Goods sold with the land (general condition 6.3(f)) *(list or attach schedule)*

All fixed floor coverings, light fittings, window furnishings

Payment

Price	\$		
Deposit	\$	by	(of which \$ has been paid)
Balance	\$		payable at settlement

Deposit bond

☐ General condition 15 applies only if the box is checked

Bank guarantee

☐ General condition 16 applies only if the box is checked

GST (general condition 19)

Subject to general condition 19.2, the price includes GST (if any), unless the next box is checked

- ☐ GST (if any) must be paid in addition to the price if the box is checked
- ☐ This sale is a sale of land on which a 'farming business' is carried on which the parties consider meets the requirements of section 38-480 of the GST Act if the box is checked
- ☐ This sale is a sale of a going concern' if the box is checked
- ☐ The margin scheme will be used to calculate GST if the box is checked

Settlement (general conditions 17 & 26.2)**is due on**

unless the land is a lot on an unregistered plan of subdivision, in which case settlement is due on the later of:

- the above date; and
- the 14th day after the vendor gives notice in writing to the purchaser of registration of the plan of subdivision.

Lease (general condition 5.1)

☐ At settlement the purchaser is entitled to vacant possession of the property unless the box is checked, in which case the property is sold subject to*:

*(*only one of the boxes below should be checked after carefully reading any applicable lease or tenancy document)*

☐ a lease for a term ending on with options to renew, each of years

OR

☐ a residential tenancy for a fixed term ending on

OR

☐ a periodic tenancy determinable by notice

Terms contract (general condition 30)

☐ This contract is intended to be a terms contract within the meaning of the Sale of Land Act 1962 if the box is checked. *(Reference should be made to general condition 30 and any further applicable provisions should be added as special conditions)*

Loan (general condition 20)

☐ This contract is subject to a loan being approved and the following details apply if the box is checked:

Lender:

(or another lender chosen by the purchaser)

Loan amount: no more than

Approval date:

Building report

☐ General condition 21 applies only if the box is checked

Pest report

☐ General condition 22 applies only if the box is checked

Special Conditions

Instructions: *It is recommended that when adding special conditions:*

- *each special condition is numbered;*
- *the parties initial each page containing special conditions;*
- *a line is drawn through any blank space remaining on the last page; and*
- *attach additional pages if there is not enough space*

☒ **Special condition 1 – Restriction**

- 1.1. The purchaser acknowledges that by enquiry of the appropriate local authorities, it has satisfied itself as to the zoning and planning restrictions (including all planning approvals, permits and consents) on and in respect of the land sold and the use to which the land may be put and the development thereof.
- 1.2. The property is sold subject to any restriction as to use under any order, plan, scheme, regulation or by law made by any authority empowered by any legislation to control the use of land. No such restriction constitutes a defect in the vendor's title or affects the validity of this contract. The purchaser must not make any requisition or objection and is not entitled to any compensation from the vendor in respect of any such restriction.
- 1.3. The purchaser shall assume liability for compliance with any notices or orders relating to the Property (other than those referring to the apportionable outgoings) which are made or issued on or after the Date of Sale and the purchaser shall assume liability arising there from and indemnify the vendor against such liability. This Special Condition shall not merge upon settlement and shall ensure for the benefit of the vendor.

☒ **Special condition 2 – Use of the Land**

- 2.1 The purchaser acknowledges that the vendor gives no warranty as to the use to which the land sold may be put if the use is permissible only with the consent of any authority under or in pursuance of any statute, ordinance, regulations, by-law, town planning scheme or interim development order or other enactment or order of the Court the purchaser shall obtain such consent at the purchaser's own expense.

☒ **Special condition 3 –Condition of Property**

- 3.1. The property and any chattels are sold in their present condition and state of repair and subject to any defects, fair, wear and tear inclusive. The Purchaser acknowledges having inspected the property and accepts it in an "as is" condition.
- 3.2. No failure of any buildings or improvements to comply with any planning or building legislation regulations or by-laws or any planning permit constitutes a defect in the vendor's title or affects the validity of this contract. The Purchaser shall not make any objection, requisition or claim compensation in respect of any non-compliance of the improvements or any alterations thereto with the provisions of the Local Government Act 1989 (Vic), the Building Act 1993 (Vic) or any other Act relating to such improvements or to any requisitions made under such Acts or with the requirements of the relevant authorities.
- 3.3. The purchaser acknowledges that the property may have been filled and shall not make any claims or demands whatsoever on the vendor in regard thereto or arising there from.
- 3.4. The purchaser:
 - (a) accepts the property:
 - (i) with all existing and future planning, environmental and building controls and approvals; and
 - (ii) in it's present condition with all defects and non-compliance with any of those controls or approvals;
 - (b) acknowledges that the decision to purchase the property was based on the purchaser's own investigation and that no representations were made by or on behalf of the vendor as to the condition of the property or any of the matters referred to in sub-paragraph (b) hereof; and waives any right it might otherwise have to make any requisition or enquiry in relation to any of the matters referred to in this special condition and agrees that those matters do not affect the Vendor's title to the property

☐ **Special Condition 4 - Swimming pool/spa**

In the event that the property includes a swimming pool/spa, the Purchaser hereby acknowledges by signing this Contract of Sale that the swimming pool/spa located on the property may not have fencing or safety measures that comply with Building Regulations 2018. The Purchaser further acknowledges and agrees that it has made its own enquiries in relation to compliance with current building regulations and the Purchaser agrees that they cannot terminate this Contract in the event that the swimming pool/spa does not comply with current building regulations, nor will the Purchaser require the Vendor to comply with any notice issued by any authority nor seek any compensation from the Vendor for any non-compliance.

☒ **Special condition 5 – Auction Conditions (if applicable)**

The property is offered for sale by auction subject to the Vendor's reserve price. The rules for the conduct of the auction shall be as set out in Schedule 1 to the Sale of Land Regulations 2005, or any rules prescribed by regulation which modify or replace those Rules.

☒ **Special condition 6 –Interest in Default**

General Condition 33 does not apply to this Contract If the purchaser defaults in payment of any money due under this contract the purchaser must pay to the vendor interest at the rate of 14% per annum on the money overdue during the period of default without any demand and without prejudice to any other rights of the vendor

☒ **Special condition 7 - DEFAULT COSTS CHARGES & EXPENSES**

In the event that the purchaser fails to complete the purchase of the property on the due date specified in the contract between the vendor and the purchaser ('the contract') for the payment of the residue as defined in the contract ('the due date'), the vendor will or may suffer the following losses and expenses which the purchaser shall be required to pay to the vendor, in addition to the interest payable in accordance with the terms of the contract:

- 7.1. All costs associated with obtaining bridging finance to complete the vendor's purchase of another property and interest charged on such bridging finance;
- 7.2. Interest payable by the vendor under any existing mortgage over the property sold calculated from the due date;
- 7.3. Accommodation and removalist expenses including storage of goods that may be incurred by the vendor;
- 7.4. Costs and expenses between the vendor's legal representative and the vendor;
- 7.5. Penalties payable by the vendor to a third party or any costs incurred through any delay in completion of the vendor's purchase.
- 7.6. A fee for rescheduling settlement on the day of settlement or after set at \$150.00 for each rebooking.
- 7.7. In the event a default notice has been served upon the purchaser all monies due under the terms of the Contract of Sale will immediately become payable to the vendor where the default has been caused by the purchaser and has not been remedied in the specified time (under the terms of the default notice) and the costs and interest have not been paid, then:
 - (a) the purchaser and vendor both acknowledge that the Contract of Sale is at an end;
 - (b) the deposit up to 10% of the contract price is forfeited to the vendor as their right of entitlement, irrespective of whether the deposit has or has not been paid; and

- (c) the vendor is entitled to immediate re-possession of their property.
- 7.8 In addition to but not limited to other remedies, within one year of the Contract ending, the vendor may either:
 - (a) retain the property and sue for damages for breach of contract; or
 - (b) put the property back on the market in any manner and recover any shortfall in the price on the re-sale and any resulting expenses by way of liquidated damages; and
 - (c) the vendor has the right to keep any part of the purchase price paid until the vendor's damages have been established and may direct that money towards those damages; and
- 7.9. In the event a default notice has been served upon the vendor the vendor acknowledges that all deposit monies paid under the Contract of Sale are to be refunded direct to the purchaser.

☒ **Special Condition 8 - Christmas Closure Period**

INDEED CONVEY will be closing for the 2022/2023 Christmas period between 23 December 2022 and 6 January 2023. Should the due date for settlement as stipulated in the Particulars of Sale fall between 23 December 2022 and 6 January 2023 (inclusive), this Special Condition shall prevail and have the effect of altering the due date for settlement to read **16 January 2023**. Neither party shall have any recourse against the other or shall be entitled to make any claim, requisition or request for compensation should the due date for settlement be required to be changed to **16 January 2023**.

☒ **Special condition 9 - Probate**

The Vendor advises and the Purchaser acknowledges that the Registered Proprietors Pasquale De Gennaro and Rita De Gennaro are both deceased. The Purchaser acknowledges that the Vendor is selling in her capacity as Executor of the deceased registered proprietor's Estate; the sale is conditional on Probate being granted within six (6) months from the date of exchange; and settlement will take place 14 days after the Vendors notify the Purchasers that Probate has been granted.

**GST WITHHOLDING NOTICE-
RESIDENTIAL PREMISES OR POTENTIAL RESIDENTIAL LAND**

Pursuant to section 14-255 Schedule 1 *Taxation Administration Act 1953 (C'wlth)*

To the Purchaser

Property: **8 Carmel Court, Sydenham 3037**

Vendor: **ANTONELLA CATHERINE COMMISSO AS THE EXECUTOR OF THE
ESTATE OF PASQUALE DE GENNARO AND RITA DE GENNARO AND
IPPOLITO DE GENNARO**

ABN (if applicable):

Date payable (if applicable):

Notice is required to be given by the vendor ☒ YES – the property is residential
☐ NO

Withholding required by Purchaser ☐ YES – the amount to be withheld _____
☒ NO – the premises are not new
☐ NO – the premises were created by substantial renovation
☐ NO- the premises are commercial residential premises
☐ NO -the land includes a building used for commercial purposes
☐ NO – the purchaser is registered for GST and acquires the property for a creditable purpose
☐ NO – there is no taxable supply

General Conditions

Contract signing

1. ELECTRONIC SIGNATURE

- 1.1 In this general condition “electronic signature” means a digital signature or a visual representation of a person’s handwritten signature or mark which is placed on a physical or electronic copy of this contract by electronic or mechanical means, and “electronically signed” has a corresponding meaning.
- 1.2 The parties consent to this contract being signed by or on behalf of a party by an electronic signature.
- 1.3 Where this contract is electronically signed by or on behalf of a party, the party warrants and agrees that the electronic signature has been used to identify the person signing and to indicate that the party intends to be bound by the electronic signature.
- 1.4 This contract may be electronically signed in any number of counterparts which together will constitute the one document.
- 1.5 Each party consents to the exchange of counterparts of this contract by delivery by email or such other electronic means as may be agreed in writing.
- 1.6 Each party must upon request promptly deliver a physical counterpart of this contract with the handwritten signature or signatures of the party and all written evidence of the authority of a person signing on their behalf, but a failure to comply with the request does not affect the validity of this contract.

2. LIABILITY OF SIGNATORY

Any signatory for a proprietary limited company purchaser is personally liable for the due performance of the purchaser’s obligations as if the signatory were the purchaser in the case of a default by a proprietary limited company purchaser.

3. GUARANTEE

The vendor may require one or more directors of the purchaser to guarantee the purchaser’s performance of this contract if the purchaser is a proprietary limited company.

4. NOMINEE

The purchaser may no later than 14 days before the due date for settlement nominate a substitute or additional person to take a transfer of the land, but the named purchaser remains personally liable for the due performance of all the purchase’s obligations under this contract.

Title

5. ENCUMBRANCES

- 5.1 The purchaser buys the property subject to:
 - (a) any encumbrance shown in the section 32 statement other than mortgages or caveats; and
 - (b) any reservations, exceptions and conditions in the crown grant; and
 - (c) any lease or tenancy referred to in the particulars of sale.
- 5.2 The purchaser indemnifies the vendor against all obligations under any lease or tenancy that are to be performed by the landlord after settlement.

6. VENDOR WARRANTIES

- 6.1 The vendor warrants that these general conditions 1 to 35 are identical to the general conditions 1 to 35 in the form of contract of sale of land published by the Law Institute of Victoria Limited and the Real Estate Institute of Victoria Pty Ltd in the month and year set out at the foot of this page.
- 6.2 The warranties in general conditions 6.3 and 6.4 replace the purchaser’s right to make requisitions and inquiries.
- 6.3 The vendor warrants that the vendor:
 - (a) has, or by the due date for settlement will have, the right to sell the land; and
 - (b) is under no legal disability; and
 - (c) is in possession of the land, either personally or through a tenant; and
 - (d) has not previously sold or granted any option to purchase, agreed to lease or granted a pre-emptive right which is current over the land and which gives another party rights which have priority over the interest of the purchaser; and
 - (e) will at settlement be the holder of an unencumbered estate in fee simple in the land; and
 - (f) will at settlement be the unencumbered owner of any improvements, fixtures, fittings and goods sold with the land.

- 6.4 The vendor further warrants that the vendor has no knowledge of any of the following:
- (a) public rights of way over the land;
 - (b) easements over the land;
 - (c) lease or other possessory agreement affecting the land;
 - (d) notice or order directly or indirectly affecting the land which will not be dealt with at settlement, other than the usual rate notices and any land tax notices;
 - (e) legal proceedings which would render the sale of the land void or voidable or capable of being set aside.
- 6.5 The warranties in general conditions 6.3 and 6.4 are subject to any contrary provisions in this contract and disclosures in the section 32 statement.
- 6.6 If sections 137B and 137C of the *Building Act* 1993 apply to this contract, the vendor warrants that:
- (a) all domestic building work carried out in relation to the construction by or on behalf of the vendor of the home was carried out in a proper and workmanlike manner; and
 - (b) all materials used in that domestic building work were good and suitable for the purpose for which they were used and that, unless otherwise stated in the contract, those materials were new; and
 - (c) domestic building work was carried out in accordance with all laws and legal requirements, including, without limiting the generality of this warranty, the *Building Act* 1993 and regulations made under the *Building Act* 1993.
- 6.7 Words and phrases used in general condition 6.6 which are defined in the *Building Act* 1993 have the same meaning in general condition 6.6.

7. IDENTITY OF THE LAND

- 7.1 An omission or mistake in the description of the property or any deficiency in the area, description or measurements of the land does not invalidate the sale.
- 7.2 The purchaser may not:
- (a) make any objection or claim for compensation for any alleged misdescription of the property or any deficiency in its area or measurements; or
 - (b) require the vendor to amend title or pay any cost of amending title.

8. SERVICES

- 8.1 The vendor does not represent that the services are adequate for the purchaser's proposed use of the property and the vendor advises the purchaser to make appropriate inquiries. The condition of the services may change between the day of sale and settlement and the vendor does not promise that the services will be in the same condition at settlement as they were on the day of sale.
- 8.2 The purchaser is responsible for the connection of all services to the property after settlement and the payment of any associated cost.

9. CONSENTS

The vendor must obtain any necessary consent or licence required for the vendor to sell the property. The contract will be at an end and all money paid must be refunded if any necessary consent or licence is not obtained by settlement.

10. TRANSFER & DUTY

- 10.1 The purchaser must prepare and deliver to the vendor at least 7 days before the due date for settlement any paper transfer of land document which is necessary for this transaction. The delivery of the transfer of land document is not acceptance of title.
- 10.2 The vendor must promptly initiate the Duties on Line or other form required by the State Revenue Office in respect of this transaction, and both parties must co-operate to complete it as soon as practicable.

11. RELEASE OF SECURITY INTEREST

- 11.1 This general condition applies if any part of the property is subject to a security interest to which the *Personal Property Securities Act* 2009 (Cth) applies.
- 11.2 For the purposes of enabling the purchaser to search the Personal Property Securities Register for any security interests affecting any personal property for which the purchaser may be entitled to a release, statement, approval or correction in accordance with general condition 11.4, the purchaser may request the vendor to provide the vendor's date of birth to the purchaser. The vendor must comply with a request made by the purchaser under this condition if the purchaser makes the request at least 21 days before the due date for settlement.
- 11.3 If the purchaser is given the details of the vendor's date of birth under condition 11.2, the purchaser must
- (a) only use the vendor's date of birth for the purposes specified in condition 11.2; and
 - (b) keep the date of birth of the vendor secure and confidential.

- 11.4 The vendor must ensure that at or before settlement, the purchaser receives –
- (a) a release from the secured party releasing the property from the security interest; or
 - (b) a statement in writing in accordance with section 275(1)(b) of the *Personal Property Securities Act 2009* (Cth) setting out that the amount or obligation that is secured is nil at settlement; or
 - (c) a written approval or correction in accordance with section 275(1)(c) of the *Personal Property Securities Act 2009* (Cth) indicating that, on settlement, the personal property included in the contract is not or will not be property in which the security interest is granted.
- 11.5 Subject to general condition 11.6, the vendor is not obliged to ensure that the purchaser receives a release, statement, approval or correction in respect of personal property –
- (a) that –
 - (i) the purchaser intends to use predominately for personal, domestic or household purposes; and
 - (ii) has a market value of not more than \$5000 or, if a greater amount has been prescribed for the purposes of section 47(1) of the *Personal Property Securities Act 2009* (Cth), not more than that prescribed amount; or
 - (b) that is sold in the ordinary course of the vendor's business of selling personal property of that kind.
- 11.6 The vendor is obliged to ensure that the purchaser receives a release, statement, approval or correction in respect of personal property described in general condition 11.5 if –
- (a) the personal property is of a kind that may be described by a serial number in the Personal Property Securities Register; or
 - (b) the purchaser has actual or constructive knowledge that the sale constitutes a breach of the security agreement that provides for the security interest.
- 11.7 A release for the purposes of general condition 11.4(a) must be in writing.
- 11.8 A release for the purposes of general condition 11.4(a) must be effective in releasing the goods from the security interest and be in a form which allows the purchaser to take title to the goods free of that security interest.
- 11.9 If the purchaser receives a release under general condition 11.4(a) the purchaser must provide the vendor with a copy of the release at or as soon as practicable after settlement.
- 11.10 In addition to ensuring a release is received under general condition 11.4(a), the vendor must ensure that at or before settlement the purchaser receives a written undertaking from a secured party to register a financing change statement to reflect that release if the property being released includes goods of a kind that are described by serial number in the Personal Property Securities Register.
- 11.11 The purchaser must advise the vendor of any security interest that is registered on or before the day of sale on the Personal Property Securities Register, which the purchaser reasonably requires to be released, at least 21 days before the due date for settlement.
- 11.12 The vendor may delay settlement until 21 days after the purchaser advises the vendor of the security interests that the purchaser reasonably requires to be released if the purchaser does not provide an advice under general condition 11.11.
- 11.13 If settlement is delayed under general condition 11.12, the purchaser must pay the vendor –
- (a) interest from the due date for settlement until the date on which settlement occurs or 21 days after the vendor receives the advice, whichever is the earlier; and
 - (b) any reasonable costs incurred by the vendor as a result of the delay – as though the purchaser was in default.
- 11.14 The vendor is not required to ensure that the purchaser receives a release in respect of the land. This general condition 11.14 applies despite general condition 11.1.
- 11.15 Words and phrases which are defined in the *Personal Property Securities Act 2009* (Cth) have the same meaning in general condition 11 unless the context requires otherwise.

12. BUILDING WARRANTY INSURANCE

The vendor warrants that the vendor will provide at settlement details of any current builder warranty insurance in the vendor's possession relating to the property if requested in writing to do so at least 21 days before settlement.

13. GENERAL LAW LAND

- 13.1 The vendor must complete a conversion of title in accordance with section 14 of the *Transfer of Land Act 1958* before settlement if the land is the subject of a provisional folio under section 23 of that Act.
- 13.2 The remaining provisions of this general condition 13 only apply if any part of the land is not under the operation of the *Transfer of Land Act 1958*.

- 13.3 The vendor is taken to be the holder of an unencumbered estate in fee simple in the land if there is an unbroken chain of title starting at least 30 years before the day of sale proving on the face of the documents the ownership of the entire legal and equitable estate without the aid of other evidence.
- 13.4 The purchaser is entitled to inspect the vendor's chain of title on request at such place in Victoria as the vendor nominates.
- 13.5 The purchaser is taken to have accepted the vendor's title if:
- (a) 21 days have elapsed since the day of sale; and
 - (b) the purchaser has not reasonably objected to the title or reasonably required the vendor to remedy a defect in the title.
- 13.6 The contract will be at an end if:
- (a) the vendor gives the purchaser a notice that the vendor is unable or unwilling to satisfy the purchaser's objection or requirement and that the contract will end if the objection or requirement is not withdrawn within 14 days of the giving of the notice; and
 - (b) the objection or requirement is not withdrawn in that time.
- 13.7 If the contract ends in accordance with general condition 13.6, the deposit must be returned to the purchaser and neither party has a claim against the other in damages.
- 13.8 General condition 17.1 [settlement] should be read as if the reference to 'registered proprietor' is a reference to 'owner' in respect of that part of the land which is not under the operation of the *Transfer of Land Act 1958*.
-

Money

14. DEPOSIT

- 14.1 The purchaser must pay the deposit:
- (a) to the vendor's licensed estate agent; or
 - (b) if there is no estate agent, to the vendor's legal practitioner or conveyancer; or
 - (c) if the vendor directs, into a special purpose account in an authorised deposit-taking institution in Victoria specified by the vendor in the joint names of the purchaser and the vendor.
- 14.2 If the land is sold on an unregistered plan of subdivision, the deposit:
- (a) must not exceed 10% of the price; and
 - (b) must be paid to the vendor's estate agent, legal practitioner or conveyancer and held by the estate agent, legal practitioner or conveyancer on trust for the purchaser until registration of the plan of subdivision.
- 14.3 The deposit must be released to the vendor if:
- (a) the vendor provides particulars, to the satisfaction of the purchaser; that either
 - (i) there are no debts secured against the property; or
 - (ii) if there are any debts, the total amount of those debts together with any amounts to be withheld in accordance with general conditions 24 and 25 does not exceed 80% of the sale price; and
 - (b) at least 28 days have elapsed since the particulars were given to the purchaser under paragraph (a); and
 - (c) all conditions of section 27 of the *Sale of Land Act 1962* have been satisfied.
- 14.4 The stakeholder must pay the deposit and any interest to the party entitled when the deposit is released, the contract is settled, or the contract is ended.
- 14.5 The stakeholder may pay the deposit and any interest into court if it is reasonable to do so.
- 14.6 Where the purchaser is deemed by section 27(7) of the *Sale of Land Act 1962* to have given the deposit release authorisation referred to in section 27(1), the purchaser is also deemed to have accepted title in the absence of any prior express objection to title.
- 14.7 Payment of the deposit may be made or tendered:
- (a) in cash up to \$1,000 or 0.2% of the price, whichever is greater; or
 - (b) by cheque drawn on an authorised deposit-taking institution; or
 - (c) by electronic funds transfer to a recipient having the appropriate facilities for receipt.
- However, unless otherwise agreed:

- (d) payments may not be made by credit card, debit card or any other financial transfer system that allows for any chargeback or funds reversal other than for fraud or mistaken payment, and
 - (e) any financial transfer or similar fees or deductions from the funds transferred, other than any fees charged by the recipient's authorised deposit-taking institution, must be paid by the remitter.
- 14.8 Payment by electronic transfer is made when cleared funds are received in the recipient's bank account.
- 14.9 Before the funds are electronically transferred the intended recipient must be notified in writing and given sufficient particulars to readily identify the relevant transaction.
- 14.10 As soon as the funds have been electronically transferred the intended recipient must be provided with the relevant transaction number or reference details.
- 14.11 For the purposes of this general condition 'authorised deposit-taking institution' means a body corporate for which an authority under section 9(3) of the *Banking Act 1959* (Cth) is in force.

15. DEPOSIT BOND

- 15.1 This general condition only applies if the applicable box in the particulars of sale is checked.
- 15.2 In this general condition "deposit bond" means an irrevocable undertaking to pay on demand an amount equal to the deposit or any unpaid part of the deposit. The issuer and the form of the deposit bond must be satisfactory to the vendor. The deposit bond must have an expiry date at least 45 days after the due date for settlement.
- 15.3 The purchaser may deliver a deposit bond to the vendor's estate agent, legal practitioner or conveyancer within 7 days after the day of sale.
- 15.4 The purchaser may at least 45 days before a current deposit bond expires deliver a replacement deposit bond on the same terms and conditions.
- 15.5 Where a deposit bond is delivered, the purchaser must pay the deposit to the vendor's legal practitioner or conveyancer on the first to occur of:
- (a) settlement;
 - (b) the date that is 45 days before the deposit bond or any replacement deposit bond expires;
 - (c) the date on which this contract ends in accordance with general condition 35.2 [default not remedied] following breach by the purchaser; and
 - (d) the date on which the vendor ends this contract by accepting repudiation of it by the purchaser.
- 15.6 The vendor may claim on the deposit bond without prior notice if the purchaser defaults under this contract or repudiates this contract and the contract is ended. The amount paid by the issuer satisfies the obligations of the purchaser under general condition 15.5 to the extent of the payment.
- 15.7 Nothing in this general condition limits the rights of the vendor if the purchaser defaults under this contract or repudiates this contract, except as provided in general condition 15.6.
- 15.8 This general condition is subject to general condition 14.2 [deposit].

16. BANK GUARANTEE

- 16.1 This general condition only applies if the applicable box in the particulars of sale is checked.
- 16.2 In this general condition:
- (a) "bank guarantee" means an unconditional and irrevocable guarantee or undertaking by a bank in a form satisfactory to the vendor to pay on demand any amount under this contract agreed in writing, and
 - (b) "bank" means an authorised deposit-taking institution under the *Banking Act 1959* (Cth).
- 16.3 The purchaser may deliver a bank guarantee to the vendor's legal practitioner or conveyancer.
- 16.4 The purchaser must pay the amount secured by the bank guarantee to the vendor's legal practitioner or conveyancer on the first to occur of:
- (a) settlement;
 - (b) the date that is 45 days before the bank guarantee expires;
 - (c) the date on which this contract ends in accordance with general condition 35.2 [default not remedied] following breach by the purchaser; and
 - (d) the date on which the vendor ends this contract by accepting repudiation of it by the purchaser.
- 16.5 The vendor must return the bank guarantee document to the purchaser when the purchaser pays the amount secured by the bank guarantee in accordance with general condition 16.4.
- 16.6 The vendor may claim on the bank guarantee without prior notice if the purchaser defaults under this contract or repudiates this contract and the contract is ended. The amount paid by the bank satisfies the obligations of the purchaser under general condition 16.4 to the extent of the payment.

- 16.7 Nothing in this general condition limits the rights of the vendor if the purchaser defaults under this contract or repudiates this contract except as provided in general condition 16.6.
- 16.8 This general condition is subject to general condition 14.2 [deposit].

17. SETTLEMENT

- 17.1 At settlement:
- (a) the purchaser must pay the balance; and
 - (b) the vendor must:
 - (i) do all things necessary to enable the purchaser to become the registered proprietor of the land; and
 - (ii) give either vacant possession or receipt of rents and profits in accordance with the particulars of sale.
- 17.2 Settlement must be conducted between the hours of 10.00 a.m. and 4.00 p.m. unless the parties agree otherwise.
- 17.3 The purchaser must pay all money other than the deposit in accordance with a written direction of the vendor or the vendor's legal practitioner or conveyancer.

18. ELECTRONIC SETTLEMENT

- 18.1 Settlement and lodgment of the instruments necessary to record the purchaser as registered proprietor of the land will be conducted electronically in accordance with the Electronic Conveyancing National Law. This general condition 18 has priority over any other provision of this contract to the extent of any inconsistency.
- 18.2 A party must immediately give written notice if that party reasonably believes that settlement and lodgment can no longer be conducted electronically. Special condition 18 ceases to apply from when such a notice is given.
- 18.3 Each party must:
- (a) be, or engage a representative who is, a subscriber for the purposes of the Electronic Conveyancing National Law,
 - (b) ensure that all other persons for whom that party is responsible and who are associated with this transaction are, or engage, a subscriber for the purposes of the Electronic Conveyancing National Law, and
 - (c) conduct the transaction in accordance with the Electronic Conveyancing National Law.
- 18.4 The vendor must open the electronic workspace ("workspace") as soon as reasonably practicable and nominate a date and time for settlement. The inclusion of a specific date for settlement in a workspace is not of itself a promise to settle on that date or at that time. The workspace is an electronic address for the service of notices and for written communications for the purposes of any electronic transactions legislation.
- 18.5 This general condition 18.5 applies if there is more than one electronic lodgment network operator in respect of the transaction. In this general condition 18.5 "the transaction" means this sale and purchase and any associated transaction involving any of the same subscribers.
- To the extent that any interoperability rules governing the relationship between electronic lodgment network operators do not provide otherwise:
- (a) the electronic lodgment network operator to conduct all the financial and lodgment aspects of the transaction after the workspace locks must be one which is willing and able to conduct such aspects of the transaction in accordance with the instructions of all the subscribers in the workspaces of all the electronic lodgment network operators after the workspace locks;
 - (b) if two or more electronic lodgment network operators meet that description, one may be selected by purchaser's incoming mortgagee having the highest priority but if there is no mortgagee of the purchaser, the vendor must make the selection.
- 18.6 Settlement occurs when the workspace records that:
- (a) there has been an exchange of funds or value between the exchange settlement account or accounts in the Reserve Bank of Australia of the relevant financial institutions or their financial settlement agents in accordance with the instructions of the parties; or
 - (b) if there is no exchange of funds or value, the documents necessary to enable the purchaser to become registered proprietor of the land have been accepted for electronic lodgment
- 18.7 The parties must do everything reasonably necessary to effect settlement:
- (a) electronically on the next business day; or
 - (b) at the option of either party, otherwise than electronically as soon as possible –
- if, after the locking of the workspace at the nominated settlement time, settlement in accordance with special condition 18.6 has not occurred by 4.00 pm, or 6.00 pm if the nominated time for settlement is after 4.00 pm.
- 18.8 Each party must do everything reasonably necessary to assist the other party to trace and identify the recipient of any missing or mistaken payment and to recover the missing or mistaken payment.
- 18.9 The vendor must before settlement:
- (a) deliver any keys, security devices and codes ("keys") to the estate agent named in the contract,
 - (b) direct the estate agent to give the keys to the purchaser or the purchaser's nominee on notification of settlement by the vendor, the vendors subscriber or the electronic lodgment network operator,

- (c) deliver all other physical documents and items (other than the goods sold by the contract) to which the purchaser is entitled at settlement, and any keys if not delivered to the estate agent, to the vendor's subscriber or, if there is no vendor's subscriber, confirm in writing to the purchaser that the vendor holds those documents, items and keys at the vendor's address set out in the contract, and

give, or direct its subscriber to give, all those documents and items and any such keys to the purchaser or the purchaser's nominee on notification by the electronic lodgment network operator of settlement.

19. GST

- 19.1 The purchaser does not have to pay the vendor any amount in respect of GST in addition to the price if the particulars of sale specify that the price includes GST (if any).
- 19.2 The purchaser must pay to the vendor any GST payable by the vendor in respect of a taxable supply made under this contract in addition to the price if:
 - (a) the particulars of sale specify that GST (if any) must be paid in addition to the price; or
 - (b) GST is payable solely as a result of any action taken or intended to be taken by the purchaser after the day of sale, including a change of use; or
 - (c) the particulars of sale specify that the supply made under this contract is of land on which a 'farming business' is carried on and the supply (or part of it) does not satisfy the requirements of section 38-480 of the GST Act; or
 - (d) the particulars of sale specify that the supply made under this contract is of a going concern and the supply (or a part of it) does not satisfy the requirements of section 38-325 of the GST Act.
- 19.3 The purchaser is not obliged to pay any GST under this contract until a tax invoice has been given to the purchaser.
- 19.4 If the particulars of sale specify that the supply made under this contract is of land on which a 'farming business' is carried on:
 - (a) the vendor warrants that the property is land on which a farming business has been carried on for the period of 5 years preceding the date of supply; and
 - (b) the purchaser warrants that the purchaser intends that a farming business will be carried on after settlement on the property.
- 19.5 If the particulars of sale specify that the supply made under this contract is a 'going concern':
 - (a) the parties agree that this contract is for the supply of a going concern; and
 - (b) the purchaser warrants that the purchaser is, or prior to settlement will be, registered for GST; and
 - (c) the vendor warrants that the vendor will carry on the going concern until the date of supply.
- 19.6 If the particulars of sale specify that the supply made under this contract is a 'margin scheme' supply, the parties agree that the margin scheme applies to this contract.
- 19.7 In this general condition:
 - (a) 'GST Act' means *A New Tax System (Goods and Services Tax) Act 1999* (Cth); and
 - (b) 'GST' includes penalties and interest.

20. LOAN

- 20.1 If the particulars of sale specify that this contract is subject to a loan being approved, this contract is subject to the lender approving the loan on the security of the property by the approval date or any later date allowed by the vendor.
- 20.2 The purchaser may end the contract if the loan is not approved by the approval date, but only if the purchaser:
 - (a) immediately applied for the loan; and
 - (b) did everything reasonably required to obtain approval of the loan; and
 - (c) serves written notice ending the contract, together with written evidence of rejection or non-approval of the loan, on the vendor within 2 clear business days after the approval date or any later date allowed by the vendor; and
 - (d) is not in default under any other condition of this contract when the notice is given.
- 20.3 All money must be immediately refunded to the purchaser if the contract is ended.

21. BUILDING REPORT

- 21.1 This general condition only applies if the applicable box in the particulars of sales is checked.
- 21.2 The purchaser may end this contract within 14 days from the days of sale if the purchaser:
 - (a) obtains a written report from a registered building practitioner or architect which discloses a current defect in a structure on the land and designates it as a major building defect;
 - (b) gives the vendor a copy of the report and a written notice ending this contract; and
 - (c) is not in then in default.
- 21.3 All money paid must be immediately refunded to the purchaser if the contract ends in accordance with this general condition.

- 21.4 A notice under this general condition may be served on the vendor's legal practitioner, conveyancer or estate agent even if the estate agent's authority has formally expired at the time of service.
- 21.5 The registered building practitioner may inspect the property at any reasonable time for the purpose of preparing the report.

22. PEST REPORT

- 22.1 This general condition only applies if the applicable box in the particulars of sale is checked.
- 22.2 The purchaser may end this contract within 14 days from the day of sale if the purchaser:
- (a) obtains a written report from a pest control operator licensed under Victorian law which discloses a current pest infestation on the land and designates it as a major infestation affecting the structure of a building on the land;
 - (b) gives the vendor a copy of the report and a written notice ending this contract; and
 - (c) is not then in default.
- 22.3 All money paid must be immediately refunded to the purchaser if the contract ends in accordance with this general condition.
- 22.4 A notice under this general condition may be served on the vendor's legal practitioner, conveyancer or estate agent even if the estate agent's authority has formally expired at the time of service.
- 22.5 The pest control operator may inspect the property at any reasonable time for the purpose of preparing the report.

23. ADJUSTMENTS

- 23.1 All periodic outgoings payable by the vendor, and any rent and other income received in respect of the property must be apportioned between the parties on the settlement date and any adjustment paid and received as appropriate.
- 23.2 The periodic outgoings and rent and other income must be apportioned on the following basis:
- (a) the vendor is liable for the periodic outgoings and entitled to the rent and other income up to and including the day of settlement; and
 - (b) the land is treated as the only land of which the vendor is owner (as defined in the *Land Tax Act 2005*); and
 - (c) the vendor is taken to own the land as a resident Australian beneficial owner; and
 - (d) any personal statutory benefit available to each party is disregarded in calculating apportionment.
- 23.3 The purchaser must provide copies of all certificates and other information used to calculate the adjustments under general condition 23, if requested by the vendor.

24. FOREIGN RESIDENT CAPITAL GAINS WITHHOLDING

- 24.1 Words defined or used in Subdivision 14-D of Schedule 1 to the *Taxation Administration Act 1953* (Cth) have the same meaning in this general condition unless the context requires otherwise.
- 24.2 Every vendor under this contract is a foreign resident for the purposes of this general condition unless the vendor gives the purchaser a clearance certificate issued by the Commissioner under section 14-220 (1) of Schedule 1 to the *Taxation Administration Act 1953* (Cth). The specified period in the clearance certificate must include the actual date of settlement.
- 24.3 The remaining provisions of this general condition 24 only apply if the purchaser is required to pay the Commissioner an amount in accordance with section 14-200(3) or section 14-235 of Schedule 1 to the *Taxation Administration Act 1953* (Cth) ("the amount") because one or more of the vendors is a foreign resident, the property has or will have a market value not less than the amount set out in section 14-215 of the legislation just after the transaction, and the transaction is not excluded under section 14-215(1) of the legislation.
- 24.4 The amount is to be deducted from the vendor's entitlement to the contract consideration. The vendor must pay to the purchaser at settlement such part of the amount as is represented by non-monetary consideration.
- 24.5 The purchaser must:
- (a) engage a legal practitioner or conveyancer ("representative") to conduct all legal aspects of settlement, including the performance of the purchaser's obligations under the legislation and this general condition; and
 - (b) ensure that the representative does so.
- 24.6 The terms of the representative's engagement are taken to include instructions to have regard to the vendor's interests and instructions that the representative must:
- (a) pay, or ensure payment of, the amount to the Commissioner in the manner required by the Commissioner and as soon as reasonably and practicably possible, from moneys under the control or direction of the representative in accordance with this general condition if the sale of the property settles;
 - (b) promptly provide the vendor with proof of payment; and
 - (c) otherwise comply, or ensure compliance with, this general condition;
- despite:
- (d) any contrary instructions, other than from both the purchaser and the vendor; and
 - (e) any other provision in this contract to the contrary.
- 24.7 The representative is taken to have complied with the requirements in special condition 24.6 if:
- (a) the settlement is conducted through an electronic lodgement network; and

- (b) the amount is included in the settlement statement requiring payment to the Commissioner in respect of this transaction.
- 24.8 Any clearance certificate or document evidencing variation of the amount in accordance with section 14-235(2) of Schedule 1 to the *Taxation Administration Act 1953* (Cth) must be given to the purchaser at least 5 business days before the due date for settlement.
- 24.9 The vendor must provide the purchaser with such information as the purchaser requires to comply with the purchaser's obligation to pay the amount in accordance with section 14-200 of Schedule 1 to the *Taxation Administration Act 1953* (Cth). The information must be provided within 5 business days of request by the purchaser. The vendor warrants that the information the vendor provides is true and correct.
- 24.10 The purchaser is responsible for any penalties or interest payable to the Commissioner on account of late payment of the amount.

25. GST WITHHOLDING

- 25.1 Words and expressions defined or used in Subdivision 14-E of Schedule 1 to the *Taxation Administration Act 1953* (Cth) or in *A New Tax System (Goods and Services Tax) Act 1999* (Cth) have the same meaning in this general condition unless the context requires otherwise. Words and expressions first used in this general condition and shown in italics and marked with an asterisk are defined or described in at least one of those Acts.
- 25.2 The purchaser must notify the vendor in writing of the name of the recipient of the *supply for the purposes of section 14-255 of Schedule 1 to the *Taxation Administration Act 1953* (Cth) at least 21 days before the due date for settlement unless the recipient is the purchaser named in the contract.
- 25.3 The vendor must at least 14 days before the due date for settlement provide the purchaser and any person nominated by the purchaser under general condition 4 with GST withholding notice in accordance with section 14-255 of Schedule 1 to the *Taxation Administration Act 1953* (Cth), and must provide all information required by the purchaser or any person so nominated to confirm the accuracy of the notice.
- 25.4 The remaining provisions of this general condition 25 apply if the purchaser is or may be required to pay the Commissioner an *amount in accordance with section 14-250 of Schedule 1 to the *Taxation Administration Act 1953* (Cth) because the property is *new residential premise or *potential residential land in either case falling within the parameters of that section, and also if the sale attracts the operation of section 14-255 of the legislation. Nothing in this general condition 25 is to be taken as relieving the vendor from compliance with section 14-255.
- 25.5 The amount is to be deducted from the vendor's entitlement to the contract *consideration and is then taken to be paid to the vendor, whether or not the vendor provides the purchaser with a GST withholding notice in accordance with section 14-255 of Schedule 1 to the *Taxation Administration Act 1953* (Cth). The vendor must pay to the purchaser at settlement such part of the amount as is represented by non-monetary consideration.
- 25.6 The purchaser must:
 - (a) engage a legal practitioner or conveyancer ("representative") to conduct all the legal aspects of settlement, including the performance of the purchaser's obligations under the legislation and this general condition; and
 - (b) ensure that the representative does so.
- 25.7 The terms of the representative's engagement are taken to include instructions to have regard to the vendor's interests relating to the payment of the amount to the Commissioner and instructions that the representative must:
 - (a) pay, or ensure payment of, the amount to the Commissioner in the manner required by the Commissioner and as soon as reasonably and practicably possible, from moneys under the control or direction of the representative in accordance with this general condition on settlement of the sale of the property;
 - (b) promptly provide the vendor with evidence of payment, including any notification or other document provided by the purchaser to the Commissioner relating to payment; and
 - (c) otherwise comply, or ensure compliance, with this general condition;
 despite:
 - (d) any contrary instructions, other than from both the purchaser and the vendor; and
 - (e) any other provision in this contract to the contrary.
- 25.8 The representative is taken to have complied with the requirements of general condition 25.7 if:
 - (a) settlement is conducted through the electronic lodgement network; and
 - (b) the amount is included in the settlement statement requiring payment to the Commissioner in respect of this transaction.
- 25.9 The purchaser may at settlement give the vendor a bank cheque for the amount in accordance with section 16-30 (3) of Schedule 1 to the *Taxation Administration Act 1953* (Cth), but only if:
 - (a) so agreed by the vendor in writing; and
 - (b) the settlement is not conducted through an electronic lodgement network.
 However, if the purchaser gives the bank cheque in accordance with this general condition 25.9, the vendor must:
 - (c) immediately after settlement provide the bank cheque to the Commissioner to pay the amount in relation to the supply; and

- (d) give the purchaser a receipt for the bank cheque which identifies the transaction and includes particulars of the bank cheque, at the same time the purchaser gives the vendor the bank cheque.
- 25.10 A party must provide the other party with such information as the other party requires to:
- (a) decide if an amount is required to be paid or the quantum of it, or
 - (b) comply with the purchaser's obligation to pay the amount,
- in accordance with section 14-250 of Schedule 1 to the *Taxation Administration Act 1953* (Cth). The information must be provided within 5 business days of a written request. The party providing the information warrants that it is true and correct.
- 25.11 The vendor warrants that:
- (a) at settlement, the property is not new residential premises or potential residential land in either case falling within the parameters of section 14-250 of Schedule 1 to the *Taxation Administration Act 1953* (Cth) if the vendor gives the purchaser a written notice under section 14-255 to the effect that the purchaser will not be required to make a payment under section 14-250 in respect of the supply, or fails to give a written notice as required by and within the time specified in section 14-255; and
 - (b) the amount described in a written notice given by the vendor to the purchaser under section 14-255 of Schedule 1 to the *Taxation Administration Act 1953* (Cth) is the correct amount required to be paid under section 14-250 of the legislation.
- 25.12 The purchaser is responsible for any penalties or interest payable to the Commissioner on account of non-payment or late payment of the amount, except to the extent that:
- (a) the penalties or interest arise from any failure on the part of the vendor, including breach of a warranty in general condition 25.11; or
 - (b) the purchaser's reasonable belief that the property is neither new residential premises nor potential residential land requiring the purchaser to pay an amount to the Commissioner in accordance with section 14-250 (1) of Schedule 1 to the *Taxation Administration Act 1953* (Cth)
- The vendor is responsible for any penalties or interest payable to the Commissioner on account of non-payment or late payment of the amount if either exception applies.
-

Transactional

26. TIME & CO OPERATION

- 26.1 Time is of the essence of this contract.
- 26.2 Time is extended until the next business day if the time for performing any action falls on a day which is not a business day.
- 26.3 Each party must do all things reasonably necessary to enable this contract to proceed to settlement, and must act in a prompt and efficient manner.
- 26.4 Any unfulfilled obligation will not merge on settlement.

27. SERVICE

- 27.1 Any document required to be served by or on any party may be served by or on the legal practitioner or conveyancer for that party.
- 27.2 A cooling off notice under section 31 of the *Sale of Land Act 1962* or a notice under general condition 20 [loan approval], 21 [building report] or 22 [pest report] may be served on the vendor's legal practitioner, conveyancer or estate agent even if the estate agent's authority has formally expired at the time of service.
- 27.3 A document is sufficiently served:
 - (a) personally; or
 - (b) by pre-paid post; or
 - (c) in any manner authorised by law or by the Supreme Court for service of documents, including any manner authorised for service on or by a legal practitioner; whether or not the person serving or receiving the document is a legal practitioner, or
 - (d) by email.
- 27.4 Any document properly sent by:
 - (a) express post is taken to have been served on the next business day after posting, unless proved otherwise;
 - (b) priority post is taken to have been served on the fourth business day after posting, unless proved otherwise;
 - (c) regular post is taken to have been served on the sixth business day after posting, unless proved otherwise;
 - (d) email is taken to have been served at the time of receipt within the meaning of section 13A of the *Electronic Transactions (Victoria) Act 2000*.
- 27.5 In this contract 'document' includes 'demand' and 'notice', 'serve' includes 'give' and 'served' and 'service' have corresponding meanings.

28. NOTICES

- 28.1 The vendor is responsible for any notice, order, demand or levy imposing liability on the property that is issued or made before the day of sale, and does not relate to periodic outgoings.
- 28.2 The purchaser is responsible for any notice, order, demand or levy imposing liability on the property that is issued or made on or after the day of sale that does not relate to periodic outgoings.
- 28.3 The purchaser may enter the property to comply with that responsibility where action is required before settlement.

29. INSPECTION

The purchaser and/or another person authorised by the purchaser may inspect the property at any reasonable time during the 7 days preceding and including the settlement day.

30. TERMS CONTRACT

- 30.1 If this is a 'terms contract' as defined in the *Sale of Land Act 1962*:
 - (a) any mortgage affecting the land sold must be discharged as to that land before the purchaser becomes entitled to possession or to the receipt of rents and profits unless the vendor satisfies section 29M of the Sale of Land Act 1962; and
 - (b) the deposit and all other money payable under the contract (other than any money payable in excess of the amount required to so discharge the mortgage) must be paid to a legal practitioner or conveyancer or a licensed estate agent to be applied in or towards discharging the mortgage.
- 30.2 While any money remains owing each of the following applies:
 - (a) the purchaser must maintain full damage and destruction insurance of the property and public risk insurance noting all parties having an insurable interest with an insurer approved in writing by the vendor;
 - (b) the purchaser must deliver copies of the signed insurance application forms, the policies and the insurance receipts to the vendor not less than 10 days before taking possession of the property or becoming entitled to receipt of the rents and profits;
 - (c) the purchaser must deliver copies of any amendments to the policies and the insurance receipts on each amendment or renewal as evidence of the status of the policies from time to time;
 - (d) the vendor may pay any renewal premiums or take out the insurance if the purchaser fails to meet these obligations;
 - (e) insurance costs paid by the vendor under paragraph (d) must be refunded by the purchaser on demand without affecting the vendor's other rights under this contract;
 - (f) the purchaser must maintain and operate the property in good repair (fair wear and tear excepted) and keep the property safe, lawful, structurally sound, weatherproof and free from contaminations and dangerous substances;
 - (g) the property must not be altered in any way without the written consent of the vendor which must not be unreasonably refused or delayed;
 - (h) the purchaser must observe all obligations that affect owners or occupiers of land;
 - (i) the vendor and/or other person authorised by the vendor may enter the property at any reasonable time to inspect it on giving 7 days written notice, but not more than twice in a year.

31. LOSS OR DAMAGE BEFORE SETTLEMENT

- 31.1 The vendor carries the risk of loss or damage to the property until settlement.
- 31.2 The vendor must deliver the property to the purchaser at settlement in the same condition it was in on the day of sale, except for fair wear and tear.
- 31.3 The purchaser must not delay settlement because one or more of the goods is not in the condition required by general condition 31.2, but may claim compensation from the vendor after settlement.
- 31.4 The purchaser may nominate an amount not exceeding \$5,000 to be held by a stakeholder to be appointed by the parties if the property is not in the condition required by general condition 31.2 at settlement.
- 31.5 The nominated amount may be deducted from the amount due to the vendor at settlement and paid to the stakeholder, but only if the purchaser also pays an amount equal to the nominated amount to the stakeholder.
- 31.6 The stakeholder must pay the amounts referred to in general condition 31.5 in accordance with the determination of the dispute, including any order for payment of the costs of the resolution of the dispute.

32. BREACH

A party who breaches this contract must pay to the other party on demand:

- (a) compensation for any reasonably foreseeable loss to the other party resulting from the breach; and
- (b) any interest due under this contract as a result of the breach.

Default

33. INTEREST

Interest at a rate of 2% per annum plus the rate for the time being fixed by section 2 of the *Penalty Interest Rates Act 1983* is payable at settlement on any money owing under the contract during the period of default, without affecting any other rights of the offended party.

34. DEFAULT NOTICE

- 34.1 A party is not entitled to exercise any rights arising from the other party's default, other than the right to receive interest and the right to sue for money owing, until the other party is given and fails to comply with a written default notice.
- 34.2 The default notice must:
- (a) specify the particulars of the default; and
 - (b) state that it is the offended party's intention to exercise the rights arising from the default unless, within 14 days of the notice being given-
 - (i) the default is remedied; and
 - (ii) the reasonable costs incurred as a result of the default and any interest payable are paid.

35. DEFAULT NOT REMEDIED

- 35.1 All unpaid money under the contract becomes immediately payable to the vendor if the default has been made by the purchaser and is not remedied and the costs and interest are not paid.
- 35.2 The contract immediately ends if:
- (a) the default notice also states that unless the default is remedied and the reasonable costs and interest are paid, the contract will be ended in accordance with this general condition; and
 - (b) the default is not remedied and the reasonable costs and interest are not paid by the end of the period of the default notice.
- 35.3 If the contract ends by a default notice given by the purchaser:
- (a) the purchaser must be repaid any money paid under the contract and be paid any interest and reasonable costs payable under the contract; and
 - (b) all those amounts are a charge on the land until payment; and
 - (c) the purchaser may also recover any loss otherwise recoverable.
- 35.4 If the contract ends by a default notice given by the vendor:
- (a) the deposit up to 10% of the price is forfeited to the vendor as the vendor's absolute property, whether the deposit has been paid or not; and
 - (b) the vendor is entitled to possession of the property; and
 - (c) in addition to any other remedy, the vendor may within one year of the contract ending either:
 - (i) retain the property and sue for damages for breach of contract; or
 - (ii) resell the property in any manner and recover any deficiency in the price on the resale and any resulting expenses by way of liquidated damages; and
 - (d) the vendor may retain any part of the price paid until the vendor's damages have been determined and may apply that money towards those damages; and
 - (e) any determination of the vendor's damages must take into account the amount forfeited to the vendor.
- 35.5 The ending of the contract does not affect the rights of the offended party as a consequence of the default.
-

GUARANTEE

The following guarantee shall be executed by each person who executed this Contract for and on behalf of the purchaser (if not the same person) and by each Director of the purchaser (if the purchaser is a Corporation):

I/We, _____ of _____
and _____ of _____

(hereinafter called the "Guarantors") IN CONSIDERATION of the within-named vendor selling to the within-named purchaser(s) at our request the land described in the within Contract for the price and upon the terms and conditions contained therein DO HEREBY for ourselves and our respective executors and administrators JOINTLY AND SEVERALLY COVENANT with the said vendor and their assigns that if at any time default shall be made in payment of the deposit or residue of purchase money or interest or any other moneys payable by the purchaser(s) to the vendor under the within Contract or in the performance or observance of any term or condition of the within Contract to be performed or observed by the purchaser(s) I/we will forthwith on demand by the vendor pay to the vendor the whole of the deposit money, residue or purchase money, interest or other moneys which shall then be due and payable to the vendor and hereby indemnify and agree to keep the vendor indemnified against all loss of deposit money, residue or purchase money, interest and other moneys payable under the within Contract and all losses, costs charges and expenses whatsoever which the vendor may incur by reason of any default on the part of the purchaser(s). This Guarantee is a continuing Guarantee and Indemnity and shall not be released or the Guarantors liability diminished by:-

- (a) any neglect or forbearance on the part of the vendor in enforcing payment of any of the moneys payable under the within Contract;
- (b) the performance or observance of any of the agreements, obligations or conditions under the within Contract;
- (c) by time given to the purchaser(s) for any such payment performance or observance;
- (d) by reason of the vendor assigning his, her or their rights under the said Contract; and
- (e) by any other thing which under the law relating to sureties would but for this provision have the effect of releasing us, our executors or administrators or diminishing our liability.

IN WITNESS whereof the parties hereto have set their hands and seals the _____ day of _____

SIGNED SEALED AND DELIVERED by the said _____)
_____)
in the presence of _____) _____

.....witness

SIGNED SEALED AND DELIVERED by the said _____)
_____)
in the presence of _____) _____

.....witness

Vendor Statement

The vendor makes this statement in respect of the land in accordance with section 32 of the *Sale of Land Act* 1962.

This statement must be signed by the vendor and given to the purchaser before the purchaser signs the contract.

The vendor may sign by electronic signature.

The purchaser acknowledges being given this statement signed by the vendor with the attached documents before the purchaser signed any contract.

Land

8 Carmel Court, Sydenham 3037

Vendor's name

Antonella Catherine Commisso as the Executor of the Estate of Pasquale De Gennaro and Rita De Gennaro

Date
/ /

Vendor's signature

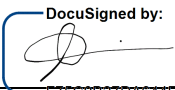
DocuSigned by:

F75C0B27DA644F9...

26/9/2022

Vendor's name

Ippolito De Gennaro

Date
/ /

Vendor's signature

DocuSigned by:

F5C20D99BCA44C2

26/9/2022

Purchaser's name

Date
/ /

Purchaser's signature

1 FINANCIAL MATTERS

1.1 Particulars of any Rates, Taxes, Charges or Other Similar Outgoings (and any interest on them)

- (a) Are contained in the attached certificate/s.

1.2 Particulars of any Charge (whether registered or not) imposed by or under any Act to secure an amount due under that Act, including the amount owing under the charge

	To	
--	----	--

Other particulars (including dates and times of payments):

1.3 Terms Contract

This section 1.3 only applies if this vendor statement is in respect of a terms contract where the purchaser is obliged to make 2 or more payments (other than a deposit or final payment) to the vendor after the execution of the contract and before the purchaser is entitled to a conveyance or transfer of the land.

Not Applicable

1.4 Sale Subject to Mortgage

This section 1.4 only applies if this vendor statement is in respect of a contract which provides that any mortgage (whether registered or unregistered), is NOT to be discharged before the purchaser becomes entitled to possession or receipts of rents and profits.

Not Applicable

2 INSURANCE

2.1 Damage and Destruction

This section 2.1 only applies if this vendor statement is in respect of a contract which does NOT provide for the land to remain at the risk of the vendor until the purchaser becomes entitled to possession or receipt of rents and profits.

Not Applicable.

2.2 Owner Builder

This section 2.2 only applies where there is a residence on the land that was constructed by an owner-builder within the preceding 6 years and section 137B of the *Building Act* 1993 applies to the residence.

Not Applicable.

3 LAND USE

3.1 Easements, Covenants or Other Similar Restrictions

- (a) A description of any easement, covenant or other similar restriction affecting the land (whether registered or unregistered): -

Is in the attached copies of title documents.

- (b) Particulars of any existing failure to comply with that easement, covenant or other similar restriction are:

To the best of the vendors knowledge there is no existing failure to comply with the terms of any easement, covenant or other similar restriction.

3.2 Road Access

There is NO access to the property by road if the square box is marked with an 'X'

☐

3.3 Designated Bushfire Prone Area

The land is in a designated bushfire prone area under section 192A of the *Building Act* 1993 if the square box is marked with an 'X'

☐

3.4. Planning Scheme

Attached is a certificate with the required specified information.

4 NOTICES**4.1. Notice, Order, Declaration, Report or Recommendation**

Particulars of any notice, order, declaration, report or recommendation of a public authority or government department or approved proposal directly and currently affecting the land, being a notice, order, declaration, report, recommendation or approved proposal of which the vendor might reasonably be expected to have knowledge:

Not Applicable.

4.2. Agricultural Chemicals

There are NO notices, property management plans, reports or orders in respect of the land issued by a government department or public authority in relation to livestock disease or contamination by agricultural chemicals affecting the ongoing use of the land for agricultural purposes. However, if this is not the case, the details of any such notices, property management plans, reports or orders, are as follows:

Not Applicable.

4.3. Compulsory Acquisition

The particulars of any notices of intention to acquire that have been served under section 6 of the *Land Acquisition and Compensation Act* 1986 are as follows:

Not Applicable.

5 BUILDING PERMITS

Particulars of any building permit issued under the *Building Act* 1993 in the preceding 7 years (required only where there is a residence on the land):

Not Applicable.

6 OWNERS CORPORATION

This section 6 only applies if the land is affected by an owners corporation within the meaning of the *Owners Corporations Act* 2006.

Not Applicable.

7 GROWTH AREAS INFRASTRUCTURE CONTRIBUTION ("GAIC")

Not Applicable.

8 SERVICES

The services which are marked with an 'X' in the accompanying square box are NOT connected to the land:

Electricity supply <input type="checkbox"/>	Gas supply <input type="checkbox"/>	Water supply <input type="checkbox"/>	Sewerage <input type="checkbox"/>	Telephone services <input checked="" type="checkbox"/>
---	-------------------------------------	---------------------------------------	-----------------------------------	--

9 TITLE

Attached are copies of the following documents:

9.1 (a) Registered Title

A Register Search Statement and the document, or part of a document, referred to as the 'diagram location' in that statement which identifies the land and its location.

9.2 Evidence of the vendor's right or power to sell (where the vendor is not the registered proprietor or the owner in fee simple).

10 SUBDIVISION

10.1. Unregistered Subdivision

This section 10.1 only applies if the land is subject to a subdivision which is not registered.

Not Applicable.

10.2. Staged Subdivision

This section 10.2 only applies if the land is part of a staged subdivision within the meaning of section 37 of the *Subdivision Act* 1988.

Not Applicable.

10.3. Further Plan of Subdivision

This section 10.3 only applies if the land is subject to a subdivision in respect of which a further plan within the meaning of the *Subdivision Act* 1988 is proposed.

Not Applicable.

11 DISCLOSURE OF ENERGY INFORMATION

(Disclosure of this information is not required under section 32 of the Sale of Land Act 1962 but may be included in this vendor statement for convenience.)

Details of any energy efficiency information required to be disclosed regarding a disclosure affected building or disclosure area affected area of a building as defined by the *Building Energy Efficiency Disclosure Act* 2010 (Cth)

- (a) to be a building or part of a building used or capable of being used as an office for administrative, clerical, professional or similar based activities including any support facilities; and
- (b) which has a net lettable area of at least 1000m²; (but does not include a building under a strata title system or if an occupancy permit was issued less than 2 years before the relevant date):

Not Applicable.

12 DUE DILIGENCE CHECKLIST

(The Sale of Land Act 1962 provides that the vendor or the vendor's licensed estate agent must make a prescribed due diligence checklist available to purchasers before offering land for sale that is vacant residential land or land on which there is a residence. The due diligence checklist is NOT required to be provided with, or attached to, this vendor statement but the checklist may be attached as a matter of convenience.)

- ☐ Vacant Residential Land or Land with a Residence
- ☒ Attach Due Diligence Checklist (this will be attached if ticked)

13 ATTACHMENTS

(Any certificates, documents and other attachments may be annexed to this section 13)

(Additional information may be added to this section 13 where there is insufficient space in any of the earlier sections)

(Attached is an "Additional Vendor Statement" if section 1.3 (Terms Contract) or section 1.4 (Sale Subject to Mortgage) applies)

--

REGISTER SEARCH STATEMENT (Title Search) Transfer of Land Act 1958

Page 1 of 1

VOLUME 10026 FOLIO 037

Security no : 124100236269M
Produced 12/09/2022 02:16 PM

LAND DESCRIPTION

Lot 145 on Plan of Subdivision 221666A.
PARENT TITLE Volume 09995 Folio 359
Created by instrument LP221666A 05/07/1991

REGISTERED PROPRIETOR

Estate Fee Simple
TENANTS IN COMMON
As to 1 of a total of 4 equal undivided shares
Sole Proprietor
IPPOLITO DE GENNARO of 8 CARMEL COURT SYDENHAM VIC 3037
As to 3 of a total of 4 equal undivided shares
Joint Proprietors
PASQUALE DE GENNARO
RITA DE GENNARO both of 8 CARMEL COURT SYDENHAM VIC 3037
AD939534C 14/10/2005

ENCUMBRANCES, CAVEATS AND NOTICES

MORTGAGE AE110031U 11/01/2006
WESTPAC BANKING CORPORATION

COVENANT (as to whole or part of the land) in instrument S080119N

Any encumbrances created by Section 98 Transfer of Land Act 1958 or Section 24 Subdivision Act 1988 and any other encumbrances shown or entered on the plan or imaged folio set out under DIAGRAM LOCATION below.

DIAGRAM LOCATION

SEE LP221666A FOR FURTHER DETAILS AND BOUNDARIES

ACTIVITY IN THE LAST 125 DAYS

NIL

-----END OF REGISTER SEARCH STATEMENT-----

Additional information: (not part of the Register Search Statement)

Street Address: 8 CARMEL COURT SYDENHAM VIC 3037

ADMINISTRATIVE NOTICES

NIL

eCT Control 16320Q WESTPAC BANKING CORPORATION
Effective from 23/10/2016

DOCUMENT END

Imaged Document Cover Sheet

The document following this cover sheet is an imaged document supplied by LANDATA®, Secure Electronic Registries Victoria.

Document Type	Plan
Document Identification	LP221666A
Number of Pages (excluding this cover sheet)	1
Document Assembled	12/09/2022 14:17

Copyright and disclaimer notice:

© State of Victoria. This publication is copyright. No part may be reproduced by any process except in accordance with the provisions of the Copyright Act 1968 (Cth) and for the purposes of Section 32 of the Sale of Land Act 1962 or pursuant to a written agreement. The information is only valid at the time and in the form obtained from the LANDATA® System. None of the State of Victoria, LANDATA®, Secure Electronic Registries Victoria Pty Ltd (ABN 86 627 986 396) as trustee for the Secure Electronic Registries Victoria Trust (ABN 83 206 746 897) accept responsibility for any subsequent release, publication or reproduction of the information.

The document is invalid if this cover sheet is removed or altered.

OFFICE USE ONLY

LP221666A

EDITION 3

NOTATIONS

LAND SUBJECT TO EASEMENT

(E-1),(E-5) : TO THE M M B W VIDE: C/E 0997657

LAND APPROPRIATED OR SET APART

- (E-2) : DRAINAGE AND SEWERAGE
- (E-3) : USE OF THE STATE ELECTRICITY COMMISSION OF VICTORIA FOR POWERLINE PURPOSES PURSUANT TO SECTION 103B OF THE SECT ACT

ROADS WITHIN THICK LINES FOR WAY, DRAINAGE, SEWERAGE, AND SUPPLY OF WATER, ELECTRICITY, TELEPHONE, AND GAS

OTHER NOTATIONS

ALL TANGENT POINTS ARE SHOWN THIS!
REFERENCE MARKS PLACED AT ALL STREET INTERSECTIONS
LOTS 1 TO 124 (INCLUSIVE) HAVE BEEN OMITTED FROM
THIS PLAN * DEPTH LIMITATION 15.24m

TO BE COMPLETED WHERE APPLICABLE
THIS SURVEY HAS BEEN CONNECTED TO PERMANENT MARKS
IN PROCLAIMED SURVEY AREA NO.

THE LAND TO BE SUBDIVIDED IS SHOWN ENCLOSED
BY CONTINUOUS THICK LINES
TITLE REF: VOL: 9945 FOL: 359
LAST PLAN REF: LOT A on L.P. 2216665C

PLAN OF SUBDIVISION

COUNTY BOURKE
PARISH MARIBYONG
CROWN ALLOTMENT 20 (PART)
SECTION B

NUMBER OF SHEETS IN PLAN : 1
NUMBER OF SHEETS IN THIS SHEET : 1

ORIGINAL SCALE : 1:750
LENGTHS ARE IN METRES

LP 221666A

VICTORIA

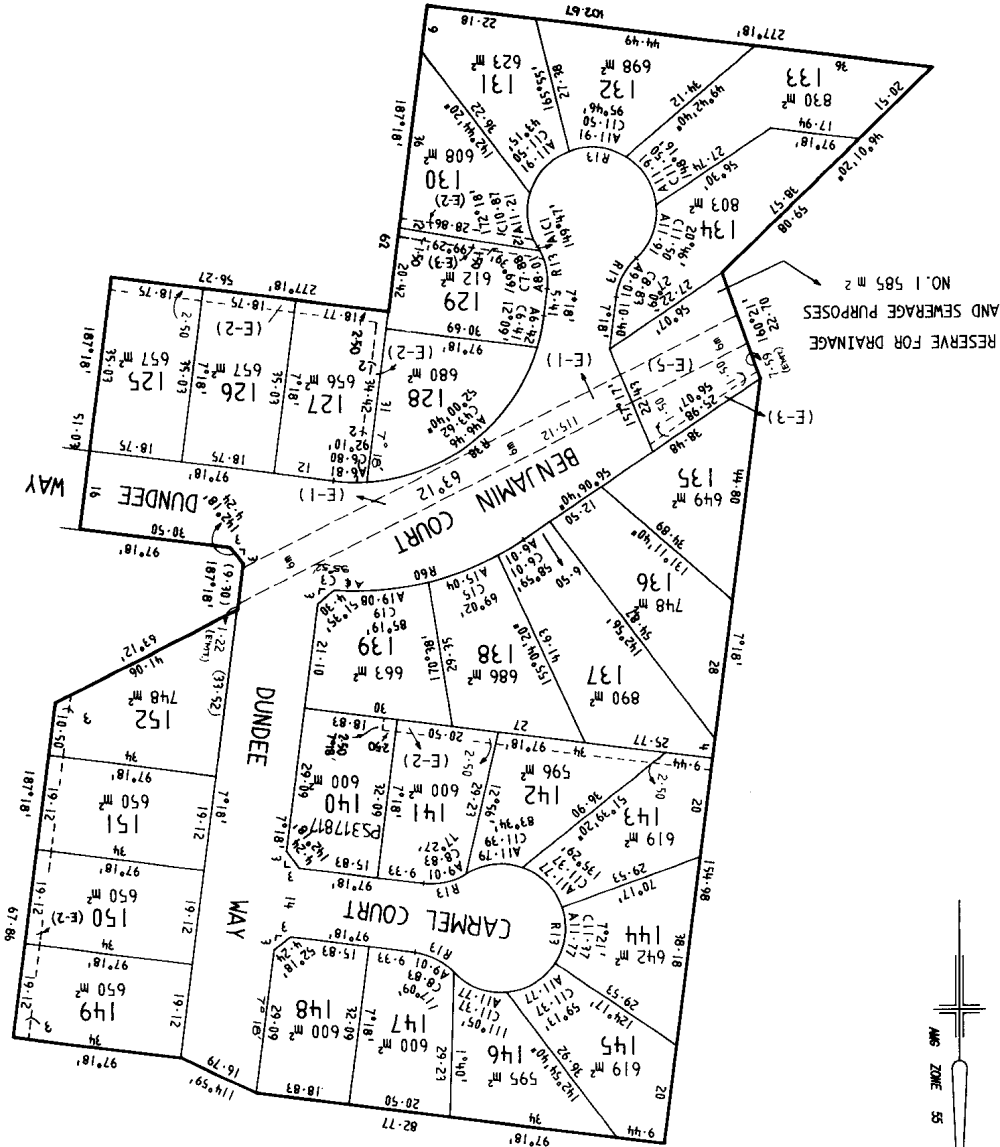

OFFICE USE ONLY

CERTIFICATE OF MUNICIPAL CLERK

MUNICIPALITY		COUNCIL REF.	
LAND	MODIFICATION	DEALING No.	A.T. EDN.
ALL	DEPTH LIMITATION	R 854143 G	2
LOT 140	SUBDIVISION	PS317817 G	3

PLAN APPROVED
5-7-91

(ASSISTANT) REGISTRAR OF TITLES

CERTIFICATION BY SURVEYOR

I, **EVANLEPITT** of **1 ALFRED STREET HAWTHORN 3122** certify that this plan has been prepared from a survey made under my immediate direction and supervision, in accordance with the provisions of the Survey Act 1958 and that this plan is accurate and correctly represents the adopted boundaries and the classification of the survey is
Date:

Licensed Surveyor
Surveyors Act 1958

APPOINTMENTS
21.5.90 - EASEMENTS LOTS 127, 128-130, 140, 145-152 (incl.)

SURVEYORS REF.
2601/4B
breeze pitt dixon Pty Ltd
1 Alfred Street, Hawthorn, Vic 3122
818 0301

MUNICIPAL CLERK

DATE

ONLY CERTIFICATE A OR CERTIFICATE B TO BE COMPLETED
* DELETE WORDS NOT APPLICABLE

10 20 30 40 50 60 70 80 90 100 110 120 130 140 150m

Imaged Document Cover Sheet

The document following this cover sheet is an imaged document supplied by LANDATA®, Secure Electronic Registries Victoria.

Document Type	Instrument
Document Identification	S080119N
Number of Pages (excluding this cover sheet)	4
Document Assembled	12/09/2022 14:18

Copyright and disclaimer notice:

© State of Victoria. This publication is copyright. No part may be reproduced by any process except in accordance with the provisions of the Copyright Act 1968 (Cth) and for the purposes of Section 32 of the Sale of Land Act 1962 or pursuant to a written agreement. The information is only valid at the time and in the form obtained from the LANDATA® System. None of the State of Victoria, LANDATA®, Secure Electronic Registries Victoria Pty Ltd (ABN 86 627 986 396) as trustee for the Secure Electronic Registries Victoria Trust (ABN 83 206 746 897) accept responsibility for any subsequent release, publication or reproduction of the information.

The document is invalid if this cover sheet is removed or altered.

04
\$904-
\$952-



Titles Office Use Only



210892 1027 45 114 S080119N

100808692 1401 756238

Lodged at the Titles Office by

CONVEYANCING DEPT
COMMONWEALTH BANK OF AUSTR.

Code DX 407
MELBOURNE
VICTORIA

TRANSFER OF LAND

Subject to the encumbrances affecting the land including any created by dealings lodged for registration prior to the lodging of this instrument the transferor for the consideration expressed at the request and by the direction of the directing party (if any) transfers to the transferee the estate and the interest specified in the land described together with any easement hereby created and subject to any easement hereby reserved or restrictive covenant herein contained or covenant created pursuant to statute and included herein. (Notes 1-4)

Land (Note 5)

Lot 145 on Plan of Subdivision No. 221666A Parish of Maribyrnong and being the whole of the land described in Certificate of Title Volume 10026 Folio 037.

Consideration (Note 6)
\$46,000.00 paid by Northeven Developments Pty. Ltd. to Keilor Gateway Estate Pty. Victoria
\$114,900.00 paid by Mark James Longley and Marlene Longley to Northeven Developments Pty. Ltd.
Trn 050239828 RDC 52 20/08/92
Rgn 63567 Amt \$ 1,852.00
Stamp Duty, Victoria
360771805730126

Transferor (Note 7)

KEILOR GATEWAY ESTATE PTY. LTD. A.C.N. 007 089 303

Transferee (Note 8)
MARK JAMES LONGLEY and MARLENE LONGLEY
both of 30 Joan Street, Ardeer as joint proprietors
Trn 050239906 RDC 52 20/08/92
Rgn 63567 Amt \$ 4.00
Stamp Duty, Victoria
360771805730126

Estate and Interest (Note 9)

All its estate and interest in the fee simple

Comptroller of Stamps Use Only

Directing Party (Note 10)

NORTHEVEN DEVELOPMENTS PTY. LTD. A.C.N. 007 090 084

Creation (or Reservation) of Easement and/or Covenant (Notes 11-12)

The covenant set out on the next page

8/856
952
904
wed

T2 Office Use Only



18/9/92

Approval No. T2/1

AND the said MARK JAMES LONGLEY and MARLENE LONGLEY for themselves their heirs executors administrators and transferees the registered proprietor or proprietors for the time being of the lot hereby transferred and of every part thereof DO HEREBY as separate covenants COVENANT with the said KEILOR GATEWAY ESTATE PTY. LTD. its successors assigns and transferees and other the registered proprietor or proprietors for the time being of each and every lot comprised in the said Plan of Subdivision No. 221666A and every part or parts thereof (other than the lot hereby transferred) that they will not erect or cause to be erected or constructed on the lot hereby transferred:-

- (a) for a period of eighteen (18) months from the date hereof whilst the said lot remains vacant any signboard or notice advertising the sale of the said lot or any other lot excepting signs advertising house and land packages;
- (b) erect or cause to be erected or remain erected on the land hereby transferred or any part thereof any building having not less than eighty five percent (85%) of external walls of brick, brick veneer or stone (including any garage, carport or other building which fronts into any street);
- (c) not to construct or erect a fence across the frontage of any allotment and no fence shall be erected or constructed where:-
 - (i) a footpath is to be provided 5.5 metres from the front boundary;
 - (ii) where no footpath is to be provided 4.5 metres from the front boundary;
- (d) not to construct or erect or permit to construct or erect or to remain constructed any dwelling or appertaining building which has a set back from boundaries less than the following:-
 - (i) where a footpath is to be constructed 5.5 metres from the front boundary
 - (ii) where no footpath is to be constructed 4.5 metres from the front boundary.

Date 14th August 1992

(Note 13)

Execution and Attestation

THE COMMON SEAL of KEILOR GATEWAY)
ESTATE PTY. LTD. A.C.N. 007 089 303)
was hereunto affixed in accordance)
with its Articles of Association in)
the presence of:-)

.....  Director

..... Secretary

THE COMMON SEAL of NORTHEVEN)
DEVELOPMENTS PTY. LTD. A.C.N. 007 090 084)
was hereunto affixed in accordance) *seal*
with its Articles of Association in)
the presence of:-)

X  Director

X  Secretary

SIGNED by the said MARK JAMES LONGLEY)
in the presence of:-)



SIGNED by the said MARLENE LONGLEY in)
the presence of:-)





(Note 14)

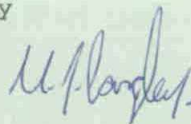

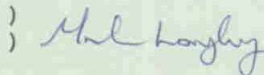

LONGLEY from KESLER GUNAWAN
 Estate of
 by direction NORTHVEN DEV. PL.

NOTES

1. This form must be used for any transfer by the registered proprietor—
 - (a) of other than the whole of an estate and interest in fee simple
 - (b) by direction
 - (c) in which an easement is created or reserved
 - (d) which contains a restrictive covenant or a covenant created pursuant to statute.
2. Transfers may be lodged as an original only and must be typed or completed in ink.
3. All signatures must be in ink.
4. If there is insufficient space in any panel to accommodate the required information use an annexure sheet (Form A1) or (if there is space available) enter the information under the appropriate heading after any creation or reservation of easement or covenant. Insert only the words "See Annexure A" (or as the case may be) or "See overleaf" in the panel as appropriate.
 Multiple annexures may appear on the same annexure sheet but each must be correctly headed.
 All annexure sheets should be properly identified and signed by the parties and securely attached to the instrument.
5. Volume and folio references must be given. If the whole of the land in a title is to be transferred no other description should be used. If the transfer affects part only of the land in a title the lot and plan number or Crown description should also be given. Any necessary diagram should be endorsed hereon or on an annexure sheet (Form A1).
6. Set out the amount (in figures) or the nature of the consideration. If the transfer is by direction show the various considerations
 e.g. \$ paid by B to A
 \$ paid by C to B
 In a transfer on sale of land subject to a mortgage it should be clearly shown whether or not the amount owing under the mortgage is included in the consideration e.g. \$ which includes the amount owing under mortgage No.
7. Insert full name. Address is not required.
8. Insert full name and address. If two or more transferees state whether as joint tenants or tenants in common. If tenants in common specify shares.
9. Set out "All my estate and interest in the fee simple" (or other as the case may be).
10. If the transfer is by direction give the full name of any directing party and show the various considerations under the consideration heading.
11. Set out any easement being created or reserved and define the dominant and servient tenements.
12. Set out full details of any covenant and define the covenantee and the land to bear the burden and to take the benefit of the covenant.
13. The transfer must be dated.
14. If an executing party is a natural person execution should read "Signed by the transferor (transferee, directing party) in the presence of". The witness must be an independent person. If an executing party is a body corporate execution should conform to any prescribed formalities relating to the affixing of the common seal.

PLANNING CERTIFICATE

Official certificate issued under Section 199 Planning & Environment Act 1987
and the Planning and Environment Regulations 2005

CERTIFICATE REFERENCE NUMBER

872805

APPLICANT'S NAME & ADDRESS

INDEED CONVEY C/- INFOTRACK C/- LANDATA
MELBOURNE

VENDOR

COMMISSO, PASQUALE DE GEN

PURCHASER

N/A, N/A

REFERENCE

63036

This certificate is issued for:

LOT 145 PLAN LP221666 ALSO KNOWN AS 8 CARMEL COURT SYDENHAM
BRIMBANK CITY

The land is covered by the:

BRIMBANK PLANNING SCHEME

The Minister for Planning is the responsible authority issuing the Certificate.

The land:

- is included in a NEIGHBOURHOOD RESIDENTIAL ZONE - SCHEDULE 1
- is within a DEVELOPMENT CONTRIBUTIONS PLAN OVERLAY - SCHEDULE 2

A detailed definition of the applicable Planning Scheme is available at :
(<http://planningschemes.dpcd.vic.gov.au/schemes/brimbank>)

Historic buildings and land protected under the Heritage Act 1995 are recorded in the Victorian Heritage Register at:

<http://vhd.heritage.vic.gov.au/>

12 September 2022

Hon. Richard Wynne MP
Minister for Planning

Additional site-specific controls may apply.
The Planning Scheme Ordinance should be checked carefully.

The above information includes all amendments to planning scheme maps placed on public exhibition up to the date of issue of this certificate and which are still the subject of active consideration

Copies of Planning Schemes and Amendments can be inspected at the relevant municipal offices.

LANDATA®
T: (03) 9102 0402
E: landata.enquiries@servictoria.com.au

The attached certificate is issued by the Minister for Planning of the State of Victoria and is protected by statute.

The document has been issued based on the property information you provided. You should check the map below - it highlights the property identified from your information.

If this property is different to the one expected, you can phone (03) 9102 0402 or email landata.enquiries@servictoria.com.au

Please note: The map is for reference purposes only and does not form part of the certificate.

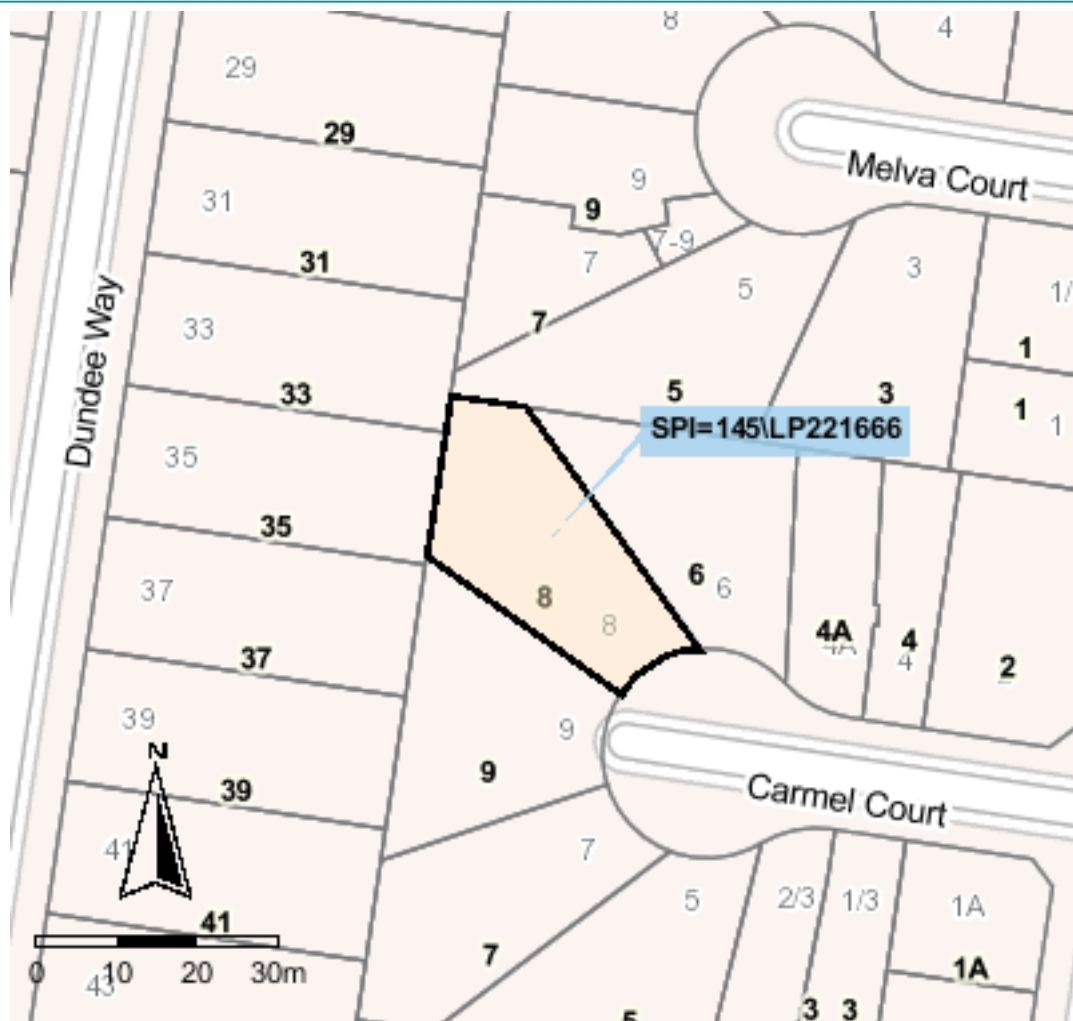

Copyright © State Government of Victoria. Service provided by maps.land.vic.gov.au

Choose the authoritative Planning Certificate

Why rely on anything less?

As part of your section 32 statement, the authoritative Planning Certificate provides you and / or your customer with the statutory protection of the State of Victoria.
Order online before 4pm to receive your authoritative Planning Certificate the same day, in most cases within the hour.
Next business day delivery, if further information is required from you.

Privacy Statement

The information obtained from the applicant and used to produce this certificate was collected solely for the purpose of producing this certificate. The personal information on the certificate has been provided by the applicant and has not been verified by LANDATA®. The property information on the certificate has been verified by LANDATA®. The zoning information on the certificate is protected by statute. The information on the certificate will be retained by LANDATA® for auditing purposes and will not be released to any third party except as required by law.

PLANNING PROPERTY REPORT

From www.planning.vic.gov.au at 12 September 2022 03:00 PM

PROPERTY DETAILS

Address: **8 CARMEL COURT SYDENHAM 3037**

Lot and Plan Number: **Lot 145 LP221666**

Standard Parcel Identifier (SPI): **145\LP221666**

Local Government Area (Council): **BRIMBANK**

Council Property Number: **397646**

Planning Scheme: **Brimbank**

Directory Reference: **Melway 3 A12**

www.brimbank.vic.gov.au

[Planning Scheme - Brimbank](#)

UTILITIES

Rural Water Corporation: **Southern Rural Water**

Melbourne Water Retailer: **Greater Western Water**

Melbourne Water: **Inside drainage boundary**

Power Distributor: **JEMENA**

STATE ELECTORATES

Legislative Council: **WESTERN METROPOLITAN**

Legislative Assembly: **SYDENHAM**

OTHER

Registered Aboriginal Party: **Wurundjeri Woi Wurrung Cultural
Heritage Aboriginal Corporation**

[View location in VicPlan](#)

Planning Zones

[NEIGHBOURHOOD RESIDENTIAL ZONE \(NRZ\)](#)

[NEIGHBOURHOOD RESIDENTIAL ZONE - SCHEDULE 1 \(NRZ1\)](#)



Note: labels for zones may appear outside the actual zone - please compare the labels with the legend.

Planning Overlays

[DEVELOPMENT CONTRIBUTIONS PLAN OVERLAY \(DCPO\)](#)

[DEVELOPMENT CONTRIBUTIONS PLAN OVERLAY - SCHEDULE 2 \(DCPO2\)](#)



 **DCPO - Development Contributions Plan Overlay**

Note: due to overlaps, some overlays may not be visible, and some colours may not match those in the legend

OTHER OVERLAYS

Other overlays in the vicinity not directly affecting this land

[SPECIAL BUILDING OVERLAY \(SBO\)](#)

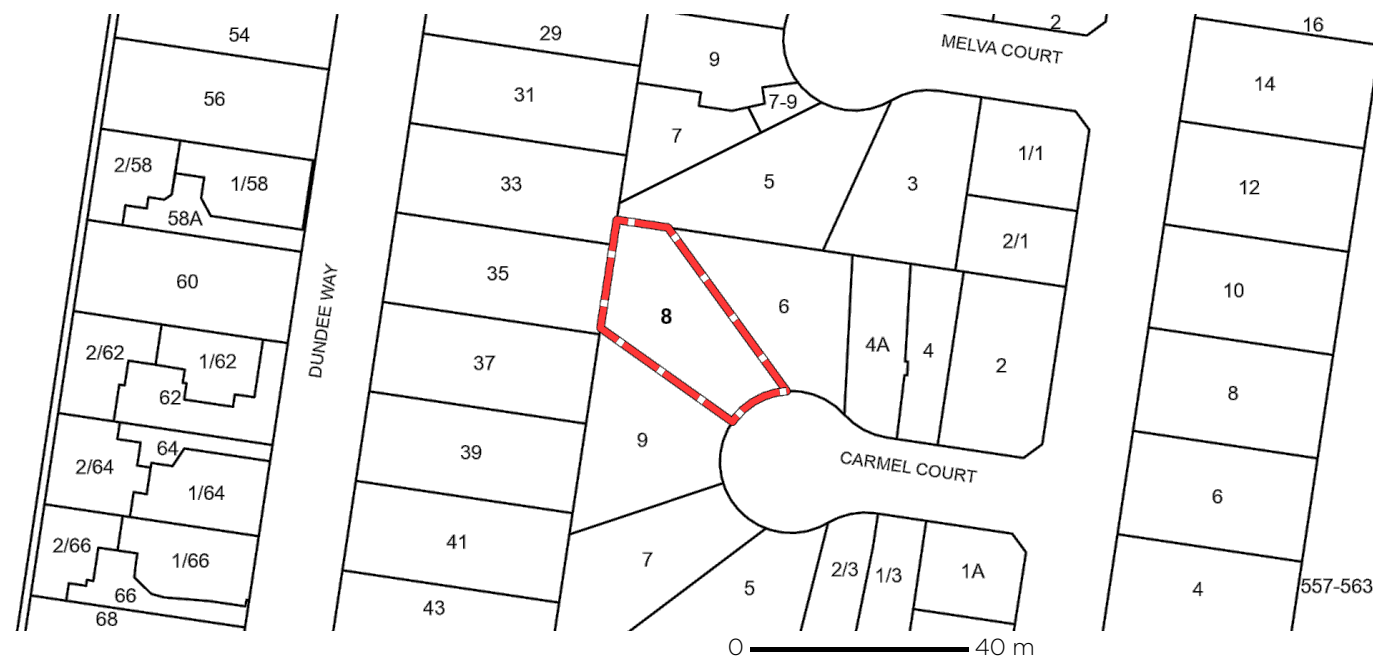

 **SBO - Special Building Overlay**

Note: due to overlaps, some overlays may not be visible, and some colours may not match those in the legend

Further Planning Information

Planning scheme data last updated on 9 September 2022.

A **planning scheme** sets out policies and requirements for the use, development and protection of land. This report provides information about the zone and overlay provisions that apply to the selected land. Information about the State and local policy, particular, general and operational provisions of the local planning scheme that may affect the use of this land can be obtained by contacting the local council or by visiting <https://www.planning.vic.gov.au>

This report is NOT a **Planning Certificate** issued pursuant to Section 199 of the **Planning and Environment Act 1987**. It does not include information about exhibited planning scheme amendments, or zonings that may affect the land. To obtain a Planning Certificate go to Titles and Property Certificates at Landata - <https://www.landata.vic.gov.au>

For details of surrounding properties, use this service to get the Reports for properties of interest.

To view planning zones, overlay and heritage information in an interactive format visit <https://mapshare.maps.vic.gov.au/vicplan>

For other information about planning in Victoria visit <https://www.planning.vic.gov.au>

Designated Bushfire Prone Areas

This property is not in a designated bushfire prone area.
No special bushfire construction requirements apply. Planning provisions may apply.

Where part of the property is mapped as BPA, if no part of the building envelope or footprint falls within the BPA area, the BPA construction requirements do not apply.

Note: the relevant building surveyor determines the need for compliance with the bushfire construction requirements.

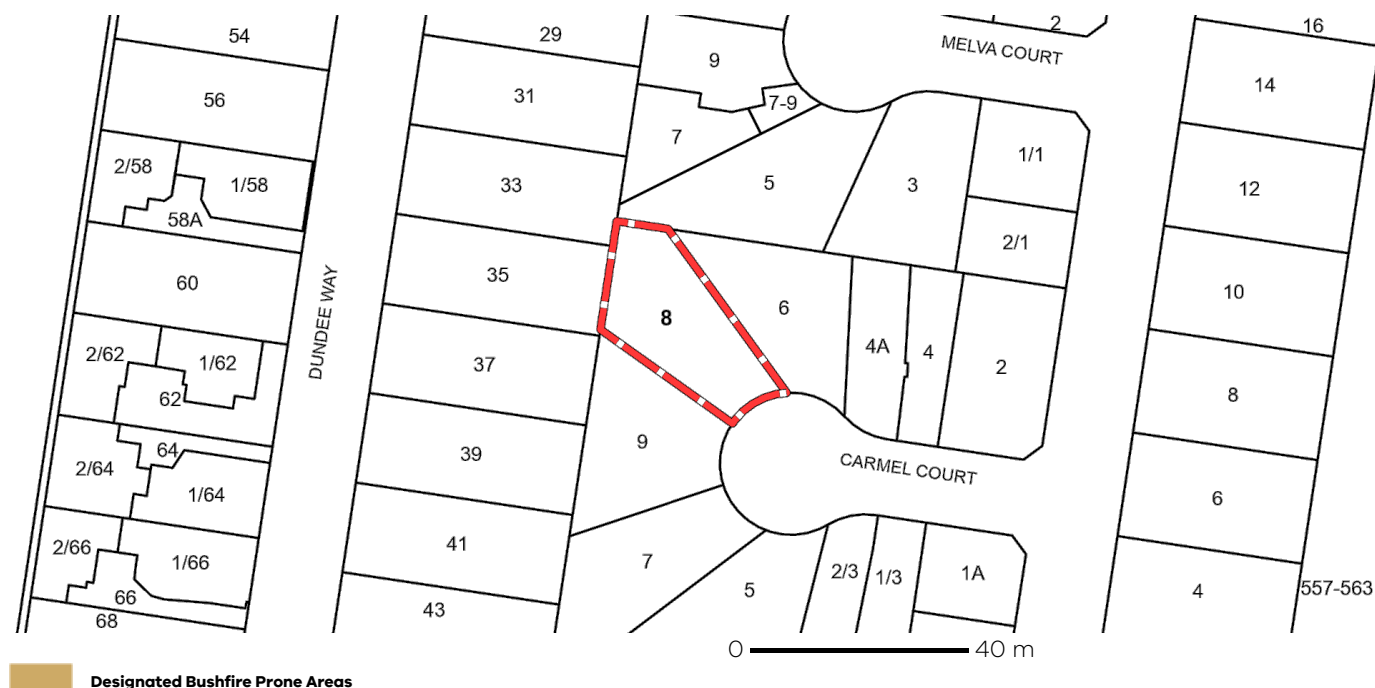

Designated BPA are determined by the Minister for Planning following a detailed review process. The Building Regulations 2018, through adoption of the Building Code of Australia, apply bushfire protection standards for building works in designated BPA.

Designated BPA maps can be viewed on VicPlan at <https://mapshare.vic.gov.au/vicplan/> or at the relevant local council.

Create a BPA definition plan in [VicPlan](#) to measure the BPA.

Information for lot owners building in the BPA is available at <https://www.planning.vic.gov.au>.

Further information about the building control system and building in bushfire prone areas can be found on the Victorian Building Authority website <https://www.vba.vic.gov.au>. Copies of the Building Act and Building Regulations are available from <http://www.legislation.vic.gov.au>. For Planning Scheme Provisions in bushfire areas visit <https://www.planning.vic.gov.au>.

Native Vegetation

Native plants that are indigenous to the region and important for biodiversity might be present on this property. This could include trees, shrubs, herbs, grasses or aquatic plants. There are a range of regulations that may apply including need to obtain a planning permit under Clause 52.17 of the local planning scheme. For more information see [Native Vegetation \(Clause 52.17\)](#) with local variations in [Native Vegetation \(Clause 52.17\) Schedule](#)

To help identify native vegetation on this property and the application of Clause 52.17 please visit the Native Vegetation Information Management system <https://nvim.delwp.vic.gov.au/> and [Native vegetation \(environment.vic.gov.au\)](https://www.environment.vic.gov.au) or please contact your relevant council.

You can find out more about the natural values on your property through NatureKit [NatureKit \(environment.vic.gov.au\)](https://www.environment.vic.gov.au)

LAND INFORMATION CERTIFICATE

Section 229 Local Government Act, 1989.

T 9249 4000
W brimbank.vic.gov.au
E info@brimbank.vic.gov.au
PO BOX 70
Sunshine, Victoria 3020

Rates and Charges for period 1 July 2022 to 30 June 2023.

Your Reference: 66027015-014-2
Assessment Number: 397646

Certificate Number: 104066
Issue date: 12/09/2022

APPLICANT:

LANDATA
GPO Box 527
MELBOURNE VIC 3001

PROPERTY LOCATION: 8 CARMEL COURT SYDENHAM 3037

Title: LOT: 145 PLN: 221666
Volume No:
Folio No.
Ward: Taylors

Capital Improved Value: \$570,000
Net Annual Value: \$28,500
Site Value: \$540,000
Effective Date: 1/07/2022
Base Date: 01/01/2022

RATES CHARGES AND OTHER MONIES:

Residential Rate Levied 01/07/2022	\$1,029.02
Municipal Charge Date Levied 01/07/2022	\$78.99
140ltr Environmental Charge Date Levied 01/07/2022	\$324.10
140ltr Green Waste Charge Date Levied 01/07/2022	\$93.79
Public Amenities Cleansing Levy Date Levied 01/07/2022	\$83.63
Fire Service Levy Residential Charge Date Levied 01/07/2022	\$117.00
Fire Service Levy Residential Rate Date Levied 01/07/2022	\$30.21
Rate Arrears to 30/06/2022:	\$0.00
Interest to 11/08/2021:	\$0.00
Other Monies:	\$0.00
Less Rebates:	\$0.00
Less Payments:	\$0.00
Less Other Adjustments:	\$0.00
Total Rates & Charges Due:	\$1,756.74
Additional Monies Owed:	
Debtor Balance Owing	
Special Charge:	
nil	nil
TOTAL DUE:	\$1,756.74

In accordance with section 175(1) & (2) Local Government Act 1989, a person who becomes the owner of rateable land must pay any rate or charge on the land which is current and any arrears of rates or charges (including any interest on those rates or charges) on the land which are due and payable. OVERDUE AMOUNTS ACCRUE INTEREST ON A DAILY BASIS AT 10.00% P.A.

For further information contact: Revenue/Rating Department Ph: (03) 9249 4000.

Assessment Number: 397646
 Certificate Number: 104066



Biller Code: 93948
Reference No: 00000397646
Amount: \$1,756.74

Contact your bank or financial institution to make this payment directly from your cheque, savings or credit account.
More info: bpay.com.au

ADDITIONAL INFORMATION:

IMPORTANT INFORMATION:

This certificate provides information regarding valuation, rates, charges, other monies owing and any orders and notices made under the Local Government Act 1958, Local Government Act 1989 or under a Local Law of the Council.

This certificate is not required to include information regarding planning, building, health, land fill, land slip, other flooding information or service easements. Information regarding these matters may be available from the Council or the relevant authority. A fee may be charged for such information.

After the issue of this Certificate, Council may be prepared to provide up to date verbal information to the Applicant about matters disclosed in this Certificate, but if it does so, Council accepts no responsibility whatsoever for the accuracy of the verbal information given and no employee of the Council is authorised to bind Council by the giving of such verbal information. Verbal confirmation of any variation to the amount will only be given for a period of 120 days after the issue date. For settlement purposes after 120 days, a new Certificate must be applied for.

 AUTHORISED OFFICER



Information Statement & Certificate

SECTION 158 WATER ACT 1989

ABN 70 066 902 467

CONTACT
13 44 99

REFERENCE NO.

1224 8454 4104

DATE OF ISSUE - 12/09/2022

APPLICATION NO.

1070584

LANDATA COUNTER SERVICES

YOUR REF.
66027015-025-8

SOURCE NO. 99904685210

PROPERTY: 8 CARMEL COURT SYDENHAM VIC 3037

Statement & Certificate as to Waterways & Drainage, Parks Service and Greater Western Water Charges

The sum of six hundred and thirty nine dollars and sixty seven cents is payable in respect of the property listed above to the end of the financial year.

If applicable, additional volumetric charges may be raised for periods after the date of the last meter read.

Service Charge Type	Annual charge 1/07/2022 - 30/06/2023	Billing Frequency	Date Billed To	Year to Date Billed Amount	Outstanding Amount
WATERWAYS AND DRAINAGE CHARGE - RES	109.68	Quarterly	30/09/2022	27.42	27.42
PARKS SERVICE CHARGES	81.60	Annually	30/06/2023	81.60	81.60
WATER NETWORK CHARGE RESIDENTIAL	206.28	Quarterly	30/09/2022	51.57	51.57
SEWERAGE NETWORK CHARGE RESIDENTIAL	238.72	Quarterly	30/09/2022	59.68	59.68
TOTAL	636.28			220.27	220.27

Service charges owing to 30/06/2022 0.00

Service charges owing for this financial year 220.27

Volumetric charges owing to 28/07/2022. 3.39

Adjustments 0.00

Current amount outstanding 223.66

Plus remainder service charges to be billed 416.01

BALANCE including unbilled service charges 639.67

Greater Western Water property settlement payments can be made via BPAY. Please use the BPAY Biller code and reference below.

Biller Code: 8789

Reference: 1224 8454 4104



Information Statement & Certificate

SECTION 158 WATER ACT 1989

ABN 70 066 902 467

CONTACT
13 44 99

REFERENCE NO.

1224 8454 4104

DATE OF ISSUE - 12/09/2022

APPLICATION NO.

1070584

Please note the water meter on this property was last read on 28/07/2022.

The information supplied below could be used to calculate the estimated volumetric charges from last meter read date 28/07/2022 to the settlement date.

Based on the water consumption from the last bill for this property, the average daily cost of volumetric charges is as follows:

Drinking Water Usage	\$0.03 per day
Sewerage Disposal Charge	\$0.01 per day

If a final meter reading is required for settlement purposes please contact Greater Western Water on 13 44 99 at least 7 business days prior to the settlement date. Please note that results of the final meter reading will not be available for at least two business days after the meter is read. An account for charges from the last meter read date 28/07/2022 to the final meter read date will be forwarded to the vendor of the property.

Where applicable, this statement gives particulars of Greater Western Water service charges as well as Parks Service and Waterways & Drainage service charges. Parks Service and Waterways & Drainage service charges are levied and collected on behalf of Parks Victoria and Melbourne Water Corporation respectively.

Section 274(4A) of the Water Act 1989 provides that all amounts in relation to this property that are owed by the owner are a charge on this property.

Section 275 of the Water Act 1989 provides that a person who becomes the owner of a property must pay to the Authority at the time the person becomes the owner of the property any amount that is, under Section 274(4A), a charge on the property.



Information Statement & Certificate

SECTION 158 WATER ACT 1989

ABN 70 066 902 467

CONTACT
13 44 99

REFERENCE NO.

1224 8454 4104

DATE OF ISSUE - 12/09/2022

APPLICATION NO.

1070584

Information given pursuant to section 158 of the Water Act 1989

Information available at Melbourne Water indicates that this property is not subject to flooding from Melbourne Water's drainage system, based on a flood level that has a probability of occurrence of 1% in any one year.

Sewer & or Water Assets if available are shown on the attached Plan. Should this plan not display all of the requested property please contact Greater Western Water on 13 44 99.

AUTHORISED OFFICER:

A handwritten signature in black ink, appearing to read "R. Charrett", with a horizontal line extending from the end.

ROHAN CHARRETT
GENERAL MANAGER
CUSTOMER EXPERIENCE

GREATER WESTERN WATER CORPORATION

Unless prior consent has been obtained from both GREATER WESTERN WATER and MELBOURNE WATER (Section 148 Water Act 1989), the erection and/or replacement of any structure or filling over or under any easement, sewer or drain, any interference with, any sewer, drain or watercourse, or any connection to any sewer drain or watercourse is PROHIBITED.

Greater Western Water provides information in this statement relating to waterways and drainage pursuant to Section 158 of the Water Act 1989, as an agent for Melbourne Water.

Please contact Greater Western Water prior to settlement for an update on these charges and remit payment to Greater Western Water immediately following settlement. Updates of rates and other charges will only be provided for up to three months from the date of this statement.



Encumbrance Plan

8 CARMEL COURT SYDENHAM 3037

Application No. 1070584

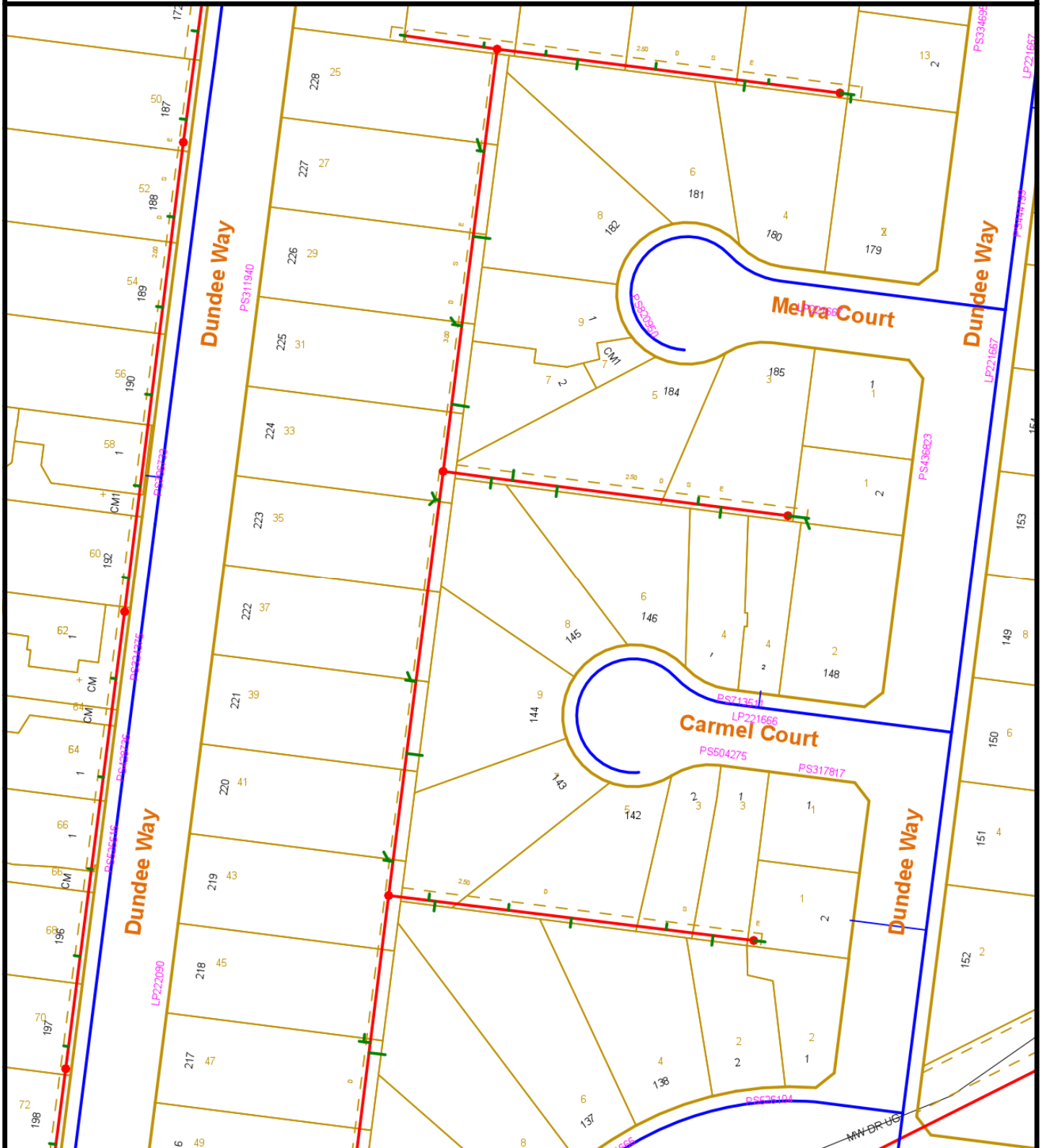

LEGEND

	Circular Manhole		Recycled Water Main		MW Sewer Main
	Inspection Shaft		MW Channel		MW Abandoned Sewer Main
	Sewer Main		MW Abandoned Channel		MW Water Main
	Abandoned Sewer Main		MW Natural Waterway		MW Abandoned Water Main
	Water Main		MW Underground Drain		MW Manhole
	Abandoned Water Main		MW Abandoned Underground Drain		MW Abandoned Manhole

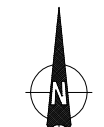

Date: 12/09/2022

Disclaimer: The location of assets must be proved in the field prior to the commencement of work. A separate plan showing asset labels should be obtained for any proposed works. These plans do not indicate private services. Greater Western Water does not guarantee and makes no representation or warranty as to the accuracy or scale of this plan. This corporation accepts no liability for any loss, damage or injury by any person as a result of any inaccuracy in this plan.



**** Delivered by the LANDATA® System, Department of Environment, Land, Water & Planning ****

ROADS PROPERTY CERTIFICATE

The search results are as follows:

Indeed Convey C/- InfoTrack
135 King St
SYDNEY 2000
AUSTRALIA

Client Reference: 63036

NO PROPOSALS. As at the 12th September 2022, VicRoads has no approved proposals requiring any part of the property described in your application. You are advised to check your local Council planning scheme regarding land use zoning of the property and surrounding area.

This certificate was prepared solely on the basis of the Applicant-supplied address described below, and electronically delivered by LANDATA®.

8 CARMEL COURT, SYDENHAM 3037
CITY OF BRIMBANK

This certificate is issued in respect of a property identified above. VicRoads expressly disclaim liability for any loss or damage incurred by any person as a result of the Applicant incorrectly identifying the property concerned.

Date of issue: 12th September 2022

Telephone enquiries regarding content of certificate: 13 11 71

[Vicroads Certificate] # 66027015 - 66027015144454 '63036'

Property Clearance Certificate
Taxation Administration Act 1997



INFOTRACK / INDEED CONVEY

Your Reference:	11275/DS
Certificate No:	57566318
Issue Date:	13 SEP 2022
Enquiries:	AXH7

Land Address: 8 CARMEL COURT SYDENHAM VIC 3037

Land Id	Lot	Plan	Volume	Folio	Tax Payable
23098155	145	221666	10026	37	\$0.00

Vendor: PASQUALE DE GE COMMISSO
Purchaser: FOR INFORMATION PURPOSES

Current Land Tax	Year	Taxable Value	Proportional Tax	Penalty/Interest	Total
RITA DEGENNARO	2022	\$490,000	\$0.00	\$0.00	\$0.00

Comments: Property is exempt: LTX Principal Place of Residence.

Current Vacant Residential Land Tax	Year	Taxable Value	Proportional Tax	Penalty/Interest	Total
-------------------------------------	------	---------------	------------------	------------------	-------

Comments:

Arrears of Land Tax	Year	Proportional Tax	Penalty/Interest	Total
---------------------	------	------------------	------------------	-------

This certificate is subject to the notes that appear on the reverse. The applicant should read these notes carefully.

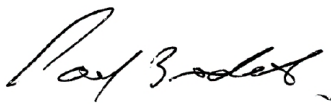
Paul Broderick
Commissioner of State Revenue

CAPITAL IMP VALUE:	\$520,000
SITE VALUE:	\$490,000
AMOUNT PAYABLE:	\$0.00



Notes to Certificates Under Section 95AA of the *Taxation Administration Act 1997*

Certificate No: 57566318

Power to issue Certificate

1. The Commissioner of State Revenue can issue a Property Clearance Certificate (Certificate) to an owner, mortgagee or bona fide purchaser of land who makes an application specifying the land for which the Certificate is sought and pays the application fee.

Amount shown on Certificate

2. The Certificate shows any land tax (including Vacant Residential Land Tax, interest and penalty tax) that is due and unpaid on the land described in the Certificate at the date of issue. In addition, it may show:
 - Land tax that has been assessed but is not yet due,
 - Land tax for the current tax year that has not yet been assessed, and
 - Any other information that the Commissioner sees fit to include, such as the amount of land tax applicable to the land on a single holding basis and other debts with respect to the property payable to the Commissioner.

Land tax is a first charge on land

3. Unpaid land tax (including Vacant Residential Land Tax, interest and penalty tax) is a first charge on the land to which it relates. This means it has priority over any other encumbrances on the land, such as a mortgage, and will continue as a charge even if ownership of the land is transferred. Therefore, a purchaser may become liable for any such unpaid land tax.

Information for the purchaser

4. If a purchaser of the land described in the Certificate has applied for and obtained a Certificate, the amount recoverable from the purchaser cannot exceed the 'amount payable' shown. A purchaser cannot rely on a Certificate obtained by the vendor.

Information for the vendor

5. Despite the issue of a Certificate, the Commissioner may recover a land tax liability from a vendor, including any amount identified on this Certificate.

General information

6. A Certificate showing no liability for the land does not mean that the land is exempt from land tax. It means that there is nothing to pay at the date of the Certificate.
7. An updated Certificate may be requested free of charge via our website, if:
 - The request is within 90 days of the original Certificate's issue date, and
 - There is no change to the parties involved in the transaction for which the Certificate was originally requested.

For Information Only

LAND TAX CALCULATION BASED ON SINGLE OWNERSHIP

Land Tax = \$755.00

Taxable Value = \$490,000

Calculated as \$375 plus (\$490,000 - \$300,000) multiplied by 0.200 cents.

Property Clearance Certificate - Payment Options

BPAY



Billers Code: 5249
Ref: 57566318

Telephone & Internet Banking - BPAY®

Contact your bank or financial institution to make this payment from your cheque, savings, debit or transaction account.

www.bpay.com.au

CARD



Ref: 57566318

Visa or Mastercard

Pay via our website or phone 13 21 61.
A card payment fee applies.

sro.vic.gov.au/paylandtax



CERTIFICATE

Pursuant to Section 58 of the *Heritage Act* 2017

**Indeed Convey C/- InfoTrack
135 King St
SYDNEY 2000**

**CERTIFICATE NO:
66027015**

**PROPERTY ADDRESS:
8 CARMEL COURT
SYDENHAM**

**PARCEL DESCRIPTION:
Lot 145 LP221666A**

1. The place or object is not included in the Heritage Register.
2. The place is not in a World Heritage Environs Area.
3. The place or object is not subject to an interim protection order.
4. A nomination has not been made for inclusion of the place or object in the Heritage Register.
5. The place or object is not being considered for inclusion in the Heritage Register.
6. The site is not included in the Heritage Inventory.
7. A repair order is not in force in respect of the place or object.
8. There is not an order of the Supreme Court under Division 3 of Part 10 in force in respect of the place or object.
9. There is not a Governor in Council declaration made under section 227 in force against the owner of the place or object.
10. There is not a court order made under section 229 in force against a person in respect of the place or object.
11. There are no current proceedings for a contravention of this Act in respect of the place or object.
12. There has not been a rectification order issued in respect of the place or object.



CERTIFICATE

Pursuant to Section 58 of the *Heritage Act 2017*

Executive Director

DATED: 12/09/2022

Note: This Certificate is valid at the date of issue.

Extract of EPA Priority Site Register

Page 1 of 2

**** Delivered by the LANDATA® System, Department of Environment, Land, Water & Planning ****

PROPERTY INQUIRY DETAILS:

STREET ADDRESS: 8 CARMEL COURT

SUBURB: SYDENHAM

MUNICIPALITY: BRIMBANK

MAP REFERENCES: Melways 40th Edition, Street Directory, Map 3 Reference A12

DATE OF SEARCH: 12th September 2022

PRIORITY SITES REGISTER REPORT:

A search of the Priority Sites Register for the above map references, corresponding to the address given above, has indicated that this site is not listed on, and is not in the vicinity of a site listed on the Priority Sites Register at the above date.

IMPORTANT INFORMATION ABOUT THE PRIORITY SITES REGISTER:

You should be aware that the Priority Sites Register lists only those sites for which:

Priority Sites are sites for which EPA has issued a:

- Clean Up Notice pursuant to section 62A) of the Environment Protection Act 1970
- Pollution Abatement Notice pursuant to section 31A or 31B (relevant to land and/or groundwater) of the Environment Protection Act 1970
- Environment Action Notice pursuant to Section 274 of the Environment Protection Act 2017
- Site Management Order (related to land and groundwater) pursuant to Section 275 of the Environment Protection Act 2017
- Improvement Notice (related to land and groundwater) pursuant to Section 271 of the Environment Protection Act 2017
- Prohibition Notices (related to land and groundwater) pursuant to Section 272 of the Environment Protection Act 2017 on the occupier or controller of the site to require active management of these sites, or where EPA believes it is in the community interest to be notified of a potential contaminated site and this cannot be communicated by any other legislative means. Sites are removed from the Priority Sites Register once all conditions of a Notice have been complied with.

The Priority Sites Register does not list all sites known to be contaminated in Victoria. A site should not be presumed to be free of contamination just because it does not appear on the Priority Sites Register. Persons intending to enter into property transactions should be aware that many properties may have been contaminated by past land uses and EPA may not be aware of the presence of contamination. EPA has published information advising of potential contaminating land uses. Council and other planning authorities hold information about previous land uses, and it is advisable that such sources of information should also be consulted.

The Environment Protection Authority does not warrant the accuracy or completeness

[Extract of Priority Sites Register] # 66027015 - 66027015144454
'63036'

Extract of EPA Priority Site Register

**** Delivered by the LANDATA® System, Department of Environment, Land, Water & Planning ****

of information in this Extract and any person using or relying upon such information does so on the basis that the Environment Protection Authority shall bear no responsibility or liability whatsoever for any errors, faults, defects or omissions in the information. Users of this site accept all risks and responsibilities for losses, damages, costs and other consequences resulting directly or indirectly from use of this site and information from it. To the maximum permitted by law, the EPA excludes all liability to any person directly or indirectly from using this site and information from it.

For sites listed on the Priority Sites Register, a copy of the relevant Notice, detailing the reasons for issue of the Notice, and management requirements, is available on request from EPA through the contact centre (details below). For more information relating to the Priority Sites Register, refer to the EPA website at: <https://www.epa.vic.gov.au/for-community/environmental-information/land-groundwater-pollution/priority-sites-register>

Environment Protection Authority Victoria
200 Victoria Street
Carlton VIC 3053
1300 EPA VIC (1300 372 842)

Building Information Certificate 51(1)

Building Act 1993
Building Regulations 2018
Regulation 51(1)



Your Reference: 66027015-015-9
Our Reference: 20627
Contact: Michelle Baxter
Telephone no: 9249 4603

T 9249 4000
W brimbank.vic.gov.au
E info@brimbank.vic.gov.au

PO BOX 70
Sunshine Victoria 3020

301 Hampshire Road
Sunshine

LANDATA
GPO Box 527
MELBOURNE VIC 3001

Property Address:	8 CARMEL COURT SYDENHAM 3037
Title Information:	LOT: 145 PLN: 221666

(a) Details of any permit or certificate of final inspection issued in the preceding 10 years;

Building Permit/ Approval No.	Date Issued	Description of Work	Occupancy Permit/Certificate of Final Inspection	
			Date	No.
Nil				

(b) Details of any current determination made under regulation 64(1) or exemption granted under regulation 231(2);

Statement Details	Date Issued	RBS Name
Nil		

(c) Details of any current notice or order issued by the relevant building surveyor under the Act;

Building Enforcement Type	Date Issued	RBS Name
Nil		

PLEASE NOTE:

- Permit, certificate, notice, order and report dates are accurate to the extent of Council's computer database information. If you wish to confirm actual issue dates you will be required to make application for copies of documents.
- In addition, the existence of permits or certificates does not indicate whether all construction on a property complies with approvals. Independent enquiries should be made if in any doubt or if any problem is anticipated or encountered.
- All residential properties with existing swimming pools or spas must have compliant safety pool fencing.
- All dwellings must have approved self-contained smoke alarms installed in appropriate locations.

Jeffrey Winbanks

JEFFREY WINBANKS
MUNICIPAL BUILDING SURVEYOR
BRIMBANK CITY COUNCIL

DATE: 15 September 2022



Date: 15 September 2022

Council Reference 1774
Contact: Erica Szentpaly
Phone: 03 9249 4603

Company: LANDATA
Attn:
Your Ref: 66027015-016-6
Email: landata.online@servictoria.com.au

RE: Property Information Certificate | Building Regulations 2018, Regulation 51(2)

PROPERTY ADDRESS:	8 CARMEL COURT SYDENHAM 3037 LOT: 145 PLN: 221666
-------------------	--

PROPERTY INFORMATION	YES/NO
Is the property designated under Regulation 150 as an area in which buildings are likely to be subjected to attack by termites (However, property owners should obtain a report from a suitably qualified person to determine if termites are present within the property concerned)	NO
Is this property likely to be subject to significant snowfalls within the meaning of Regulation 152	NO
Whether the building or land is in an area for which a bushfire attack level has been specified in a planning scheme (Please note that a final determination of a BAL requirement will be determined by the relevant Building Surveyor in consultation with mapping of designated bushfire prone areas and AS3959. Refer to: https://mapshare.vic.gov.au/vicplan/ to obtain a planning property report.)	NO
Is this property LIABLE TO FLOODING within the meaning of Regulation 5(2), designated land or designated works within the meaning of Regulation 154	A separate response will be supplied to THE APPLICANT ONLY by Engineering Services within approx.5 working days. APPLICANTS ONLY please call 9249 4430 to follow up on this application.

Please contact Council's Engineering Services Department on 9249 4430 prior to building works commencing to ensure that all aspects of Asset Protection and the General Local Law 2018 have been complied with.

For information regarding Town Planning requirements, please contact Council's Town Planning Department on 9249 4606.

Property Information regarding sewage services should be directed to Greater Western Water on 1300 299 228.

Jeffrey Winbanks

JEFFREY WINBANKS
MUNICIPAL BUILDING SURVEYOR
BRIMBANK CITY COUNCIL



Property Information

(Land Liable to Flooding (LLF) Advice)

Applicant: **Landata**

Property Details

Street Address: **8 Carmel Court Sydenham VIC 3037**

I refer to your application for information as follows:

- Is the property in an area liable to flooding pursuant to regulation 153 of the Building Regulations 2018?
- Is the area of land or works as designated land or works pursuant to regulation 154 of the Building Regulation 2018?

I wish to advise as follows:

- A** ☒ The property **is not in** an area liable to flooding or in an area of designated land or works.
- B** ☐ The property **is in** an area liable to flooding as indicated in a planning scheme overlay. Therefore, you **will require** a Town Planning Permit to build or construct works. You must contact Council's **Town Planning Department** who will advise you further of their requirements.
- C** ☐ The property **is in** an area liable to flooding as indicated in Melbourne Water flooding model. Therefore, you are required to obtain consent from Council in accordance with sub-regulation 153(2) of the Building Regulations 2018 to build on this land. Council's fee for this service is **\$294.70**. Council requires that you gain details regarding flood levels by following means (fees may be applicable):
- City West Water:** by obtaining a "Property Information Statement" directly from them by telephoning 9313 8390.
- Melbourne Water:** by using their "Application for Planning and/or Building Advice"
- Note:** If you receive information from either City West Water or Melbourne Water that suggests the land is subject to flooding, then Council also requires that you engage a licenced surveyor to determine the exact effect of the applicable flood level on the property and forward your application to Council's **Engineering Services Department** for **consent to build on a flood prone area** along with:
- Applicable application fee, as mentioned above, and properly filled application form
 - Information supplied by City West water or Melbourne Water
 - Land surveyor's plan with levels to Australian Height Datum (AHD)
 - Details of proposed development with proposed level to Australian Height Datum (AHD)
- D** ☐ The property **is not believed to be** in an area liable to flooding or designated land. **However**, information documented on plan of subdivision **Plan No** recommends that the floor level for any construction will be a minimum of **Height meters** to Australian Height Datum (AHD)
- Note:** Responsibility for the enforcement of this notice of restriction under the Subdivision Act 1988 and/or the Transfer of Land Act 1958 lies with the benefited lands and not with the Brimbank City Council.

Date: 21/09/2022

Issued By: **Shruthi Rajkumar**

Confirm No: **1106236**

Due Diligence Checklist

What you need to know before buying a residential property

Before buying a home, you should be aware of a range of issues that may affect that property and impose restrictions or obligations on you, if you buy it. This checklist aims to help you identify whether any of these issues will affect you. The questions are a starting point only and you may need to seek professional advice to answer some of them. You can find links to organisations and web pages that can help you learn more, by visiting consumer.vic.gov.au/duediligencechecklist.

Urban living

Moving to the inner city?

High density areas are attractive for their entertainment and service areas, but these activities create increased traffic as well as noise and odours from businesses and people. Familiarising yourself with the character of the area will give you a balanced understanding of what to expect.

Is the property subject to an owners corporation?

If the property is part of a subdivision with common property such as driveways or grounds, it may be subject to an owners corporation. You may be required to pay fees and follow rules that restrict what you can do on your property, such as a ban on pet ownership.

Growth areas

Are you moving to a growth area?

You should investigate whether you will be required to pay a growth areas infrastructure contribution.

Flood and fire risk

Does this property experience flooding or bushfire?

Properties are sometimes subject to the risk of fire and flooding due to their location. You should properly investigate these risks and consider their implications for land management, buildings and insurance premiums.

Rural properties

Moving to the country?

If you are looking at property in a rural zone, consider:

- Is the surrounding land use compatible with your lifestyle expectations? Farming can create noise or odour that may be at odds with your expectations of a rural lifestyle.
- Are you considering removing native vegetation? There are regulations which affect your ability to remove native vegetation on private property.
- Do you understand your obligations to manage weeds and pest animals?
- Can you build new dwellings?
- Does the property adjoin crown land, have a water frontage, contain a disused government road, or are there any crown licences associated with the land?

Is there any earth resource activity such as mining in the area?

You may wish to find out more about exploration, mining and quarrying activity on or near the property and consider the issue of petroleum, geothermal and greenhouse gas sequestration permits, leases and licences, extractive industry authorisations and mineral licences.

Soil and groundwater contamination

Has previous land use affected the soil or groundwater?

You should consider whether past activities, including the use of adjacent land, may have caused contamination at the site and whether this may prevent you from doing certain things on or on the land in the future.

Land boundaries

Do you know the exact boundary of the property?

You should compare the measurements shown on the title document with actual fences and buildings on the property, to make sure the boundaries match. If you have concerns about this, you can speak to your lawyer or conveyancer, or commission a site survey to establish property boundaries.

Planning controls

Can you change how the property is used, or the buildings on it?

All land is subject to a planning scheme, run by the local council. How the property is zoned and any overlays that may apply, will determine how the land can be used. This may restrict such things as whether you can build on vacant land or how you can alter or develop the land and its buildings over time.

The local council can give you advice about the planning scheme, as well as details of any other restrictions that may apply, such as design guidelines or bushfire safety design. There may also be restrictions – known as encumbrances – on the property's title, which prevent you from developing the property. You can find out about encumbrances by looking at the section 32 statement.

Are there any proposed or granted planning permits?

The local council can advise you if there are any proposed or issued planning permits for any properties close by. Significant developments in your area may change the local 'character' (predominant style of the area) and may increase noise or traffic near the property.

Safety

Is the building safe to live in?

Building laws are in place to ensure building safety. Professional building inspections can help you assess the property for electrical safety, possible illegal building work, adequate pool or spa fencing and the presence of asbestos, termites, or other potential hazards.

Building permits

Have any buildings or retaining walls on the property been altered, or do you plan to alter them?

There are laws and regulations about how buildings and retaining walls are constructed, which you may wish to investigate to ensure any completed or proposed building work is approved. The local council may be able to give you information about any building permits issued for recent building works done to the property, and what you must do to plan new work. You can also commission a private building surveyor's assessment.

Are any recent building or renovation works covered by insurance?

Ask the vendor if there is any owner-builder insurance or builder's warranty to cover defects in the work done to the property.

Utilities and essential services

Does the property have working connections for water, sewerage, electricity, gas, telephone and internet?

Unconnected services may not be available, or may incur a fee to connect. You may also need to choose from a range of suppliers for these services. This may be particularly important in rural areas where some services are not available.

Buyers' rights

Do you know your rights when buying a property?

The contract of sale and section 32 statement contain important information about the property, so you should request to see these and read them thoroughly. Many people engage a lawyer or conveyancer to help them understand the contracts and ensure the sale goes through correctly. If you intend to hire a professional, you should consider speaking to them before you commit to the sale. There are also important rules about the way private sales and auctions are conducted. These may include a cooling-off period and specific rights associated with 'off the plan' sales. The important thing to remember is that, as the buyer, you have rights.