



Contract of Sale of Land & Vendor Statement

TO THE PURCHASER OF REAL ESTATE PURSUANT
TO SECTION 32 OF THE SALE OF LAND ACT 1962 ("the ACT")

Property:

6 MARILYN CLOSE, CORIO VIC 3214

 0435 533 050
 www.starpc.com.au
 setara@starpc.com.au
 Level 1, 280 Thomas St
Dandenong VIC 3175
ABN: 79 940 647 062



Contract of sale of land

IMPORTANT NOTICE TO PURCHASERS – COOLING-OFF

Cooling-off period (Section 31 of the *Sale of Land Act 1962* (Vic))

You may end this contract within 3 clear business days of the day that you sign the contract if none of the exceptions listed below applies to you.

You must either give the vendor or the vendor's agent **written** notice that you are ending the contract or leave the notice at the address of the vendor or the vendor's agent to end this contract within this time in accordance with this cooling-off provision.

You are entitled to a refund of all the money you paid EXCEPT for \$100 or 0.2% of the purchase price (whichever is more) if you end the contract in this way.

EXCEPTIONS: the 3-day cooling-off period does not apply if:

- you bought the property at a publicly advertised auction or on the day on which the auction was held; or
- you bought the land within 3 clear business days before a publicly advertised auction was to be held; or
- you bought the land within 3 clear business days after a publicly advertised auction was held; or
- the property is used primarily for industrial or commercial purposes; or
- the property is more than 20 hectares in size and is used primarily for farming; or
- you and the vendor previously signed a contract for the sale of the same land in substantially the same terms; or
- you are an estate agent or a corporate body.

NOTICE TO PURCHASERS OF PROPERTY OFF-THE-PLAN

Off-the-plan sales (Section 9AA(1A) of the *Sale of Land Act 1962* (Vic))

You may negotiate with the vendor about the amount of the deposit moneys payable under the contract of sale, up to 10 per cent of the purchase price.

A substantial period of time may elapse between the day on which you sign the contract of sale and the day on which you become the registered proprietor of the lot.

The value of the lot may change between the day on which you sign the contract of sale of that lot and the day on which you become the registered proprietor.

WARNING TO ESTATE AGENTS

DO NOT USE THIS CONTRACT FOR SALES OF 'OFF THE PLAN' PROPERTIES UNLESS IT HAS BEEN PREPARED BY A LEGAL PRACTITIONER

Contract of Sale of Land

The vendor agrees to sell and the purchaser agrees to buy the property, being the land and the goods, for the price and on the terms set out in this contract.

The terms of this contract are contained in the –

- particulars of sale; and
- special conditions, if any; and
- general conditions (which are in standard form: see general condition 6.1)

in that order of priority.

SIGNING OF THIS CONTRACT

WARNING: THIS IS A LEGALLY BINDING CONTRACT. YOU SHOULD READ THIS CONTRACT BEFORE SIGNING IT.

Purchasers should ensure that they have received a section 32 statement from the vendor before signing this contract. In this contract, "section 32 statement" means the statement required to be given by a vendor under section 32 of the *Sale of Land Act 1962* (Vic).

The authority of a person signing –

- under power of attorney; or
 - as director of a corporation; or
 - as agent authorised in writing by one of the parties –
- must be noted beneath the signature.

Any person whose signature is secured by an estate agent acknowledges being given by the agent at the time of signing a copy of the terms of this contract.

SIGNED BY THE PURCHASER:

WHERE SIGNATORY IS AN INDIVIDUAL

SIGNED on/...../2026

for and on behalf of:

.....
Name of individual

.....
Signature of individual

State nature of authority, if applicable:

WHERE SIGNATORY IS AN INDIVIDUAL

SIGNED on/...../2026

for and on behalf of:

.....
Name of individual

.....
Signature of individual

State nature of authority, if applicable:

WHERE SIGNATORY IS A COMPANY

EXECUTED by

ABN
in accordance with the requirements of s.127
Corporations Act 2001 (Cth) by:

.....
Name of director

.....
Signature of director

.....
Name of director/secretary

.....
Signature of director/secretary

This offer will lapse unless accepted within [] clear business days (3 clear business days if none specified)
In this contract, "business day" has the same meaning as in section 30 of the *Sale of Land Act 1962* (Vic)

SIGNED BY THE VENDOR:

WHERE SIGNATORY IS AN INDIVIDUAL

SIGNED on/...../2026

for and on behalf of:

MAQUILE WILLIAMS OCTAVIANO and
FRANCIS ANGELO DE LEON PAMPOLINA

.....
Name of individual

.....
Signature of individual

State nature of authority, if applicable:

WHERE SIGNATORY IS AN INDIVIDUAL

SIGNED on/...../2026

for and on behalf of:

.....
Name of individual

.....
Signature of individual

State nature of authority, if applicable:

WHERE SIGNATORY IS A COMPANY

EXECUTED by

ABN
in accordance with the requirements of s.127
Corporations Act 2001 (Cth) by:

.....
Name of director

.....
Signature of director

.....
Name of director/secretary

.....
Signature of director/secretary

The **DAY OF SALE** is the date by which both parties have signed this contract.

Particulars of Sale

Vendor's estate agent

Name: Area Specialist
 Address: 68-70 Ryrie Street, Geelong VIC 3220
 Email: ali.bandari@areaspecialist.com.au
 Tel: _____ Mob: 0426 842 483 Ref: Ali Bandari

Vendor

Name: MAQUILE WILLIAMS OCTAVIANO and FRANCIS ANGELO DE LEON PAMPOLINA
 Address: _____
 ABN/ACN: _____
 Email: _____

Vendor's legal practitioner or conveyancer

Name: Star Property Conveyancing
 Address: Level 1, 280 Thomas Street, Dandenong VIC 3175
 Email: setara@starpc.com.au
 Tel: (03) 8905 4270 Mob: 0435 533 050 Ref: SPC832

Purchaser

Name: _____
 Address: _____
 ABN/ACN: _____
 Email: _____

Purchaser's legal practitioner or conveyancer

Name: _____
 Address: _____
 Email: _____
 Tel: _____ Ref: _____

Land (general conditions 7 and 13)

The land is described in the table below –

Certificate of Title reference		being lot		on plan
Volume	08989	Folio	944	1
				TP 521729B

If no title or plan references are recorded in the table, the land is as described in the section 32 statement or the register search statement and the document referred to as the diagram location in the register search statement attached to the section 32 statement

The land includes all improvements and fixtures.

Property address

The address of the land is: 6 Marilyn Close, Corio VIC 3214

Goods sold with the land (general condition 6.3(f)) *(list or attach schedule)*

Fixtures and Fittings of Permanent Nature.

Payment

Price \$
Deposit \$ by (of which has been paid)
Balance \$ payable at settlement

Deposit bond

General condition 15 applies only if the box is checked

Bank guarantee

General condition 16 applies only if the box is checked

GST (general condition 19)

Subject to general condition 19.2, the price includes GST (if any), unless the next box is checked

- GST (if any) must be paid in addition to the price if the box is checked
- This sale is a sale of land on which a 'farming business' is carried on which the parties consider meets the requirements of section 38-480 of the GST Act if the box is checked
- This sale is a sale of a 'going concern' if the box is checked
- The margin scheme will be used to calculate GST if the box is checked

Settlement (general conditions 17 & 26.2)

is due on

unless the land is a lot on an unregistered plan of subdivision, in which case settlement is due on the later of:

- the above date; and
- the 21st day after the vendor gives notice in writing to the purchaser of registration of the plan of subdivision.

Lease (general condition 5.1)

At settlement the purchaser is entitled to vacant possession of the property unless the box is checked, in which case the property is sold subject to*:

(*only one of the boxes below should be checked after carefully reading any applicable lease or tenancy document)

a lease for a term ending on / /20..... with [.....] options to renew, each of [.....] years

OR

a periodic tenancy determinable by notice

Terms contract (general condition 30)

This contract is intended to be a terms contract within the meaning of the *Sale of Land Act 1962 (Vic)* if the box is checked. *(Reference should be made to general condition 30 and any further applicable provisions should be added as special conditions)*

Loan (general condition 20)

This contract is subject to a loan being approved and the following details apply if the box is checked:

Lender:

(or another lender chosen by the purchaser)

Loan amount: Approval date:

Building report

General condition 21 applies only if the box is checked

Pest report

General condition 22 applies only if the box is checked

SPECIAL CONDITIONS

Instructions: It is recommended that when adding special conditions:

- each special condition is numbered.
- the parties initial each page containing special conditions.
- a line is drawn through any blank space remaining on this page; and
- attach additional pages if there is not enough space and number pages accordingly (e.g., 4a, 4b, 4c, etc.)

1. FOREIGN RESIDENT CAPITAL GAINS WITHHOLDING

- 1.1 Words defined or used in Subdivision 14-D of Schedule 1 to the Taxation Administration Act 1953 (Cth) have the same meaning in this special condition unless the context requires otherwise.
- 1.2 Every vendor under this contract is a foreign resident for the purposes of this special condition unless the vendor gives the purchaser a clearance certificate issued by the Commissioner under section 14-220 (1) of Schedule 1 to the Taxation Administration Act 1953 (Cth). The specified period in the clearance certificate must include the actual date of settlement.
- 1.3 This special condition only applies if the purchaser is required to pay the Commissioner an amount in accordance with section 14-200(3) or section 14-235 of Schedule 1 to the Taxation Administration Act 1953 (Cth) ("the amount") because one or more of the vendors is a foreign resident, the property is or will have a market value of \$750,000.00 or more just after the transaction, and the transaction is not excluded under section 14-215(1) of Schedule 1 to the Taxation Administration Act 1953 (Cth).
- 1.4 The amount is to be deducted from the vendor's entitlement to the contract consideration. The vendor must pay to the purchaser at settlement such part of the amount as is represented by non-monetary consideration.
- 1.5 The purchaser must:
 - a) engage a legal practitioner or conveyancer ("representative") to conduct all the legal aspects of settlement, including the performance of the purchaser's obligations in this special condition; and
 - b) ensure that the representative does so.
- 1.6 The terms of the representative's engagement are taken to include instructions to have regard to the vendor's interests and instructions that the representative must:
 - a) pay, or ensure payment of, the amount to the Commissioner in the manner required by the Commissioner and as soon as reasonably and practicably possible, from moneys under the control or direction of the representative in accordance with this special condition if the sale of the property settles;
 - b) promptly provide the vendor with proof of payment; and
 - c) otherwise comply, or ensure compliance with, this special condition despite:
 - d) any contrary instructions, other than from both the purchaser and the vendor; and
 - e) any other provision in this contract to the contrary.
- 1.7 The representative is taken to have complied with the obligations in special condition 18.6 if:
 - (a) the settlement is conducted through the electronic conveyancing system operated by Property Exchange Australia Ltd or any other electronic conveyancing system agreed by the parties; and
 - (b) the amount is included in the settlement statement requiring payment to the Commissioner in respect of this transaction.

- 1.8 Any clearance certificate or document evidencing variation of the amount in accordance with section 14-235(2) of Schedule 1 to the Taxation Administration Act 1953 (Cth) must be given to the purchaser at least 5 business days before the due date for settlement.
- 1.9 The vendor must provide the purchaser with such information as the purchaser requires to comply with the purchaser's obligation to pay the amount in accordance with section 14-200 of Schedule 1 to the Taxation Administration Act 1953(Cth). The information must be provided within 5 business days of request by the purchaser. The vendor warrants that the information the vendor provides is true and correct.
- 1.10 The purchaser is responsible for any penalties or interest payable to the Commissioner on account of late payment of the amount.

2. ELECTRONIC CONVEYANCING

Settlement and lodgment will be conducted electronically in accordance with the Electronic Conveyancing National Law and Special Condition 2 applies.

- 2.1 This special condition has priority over any other provision to the extent of any inconsistency. This special condition applies if the contract of sale specifies, or the parties subsequently agree in writing, that settlement and lodgment of the instruments necessary to record the purchaser as registered proprietor of the land will be conducted electronically in accordance with the Electronic Conveyancing National Law.
- 2.2 A party must immediately give written notice if that party reasonably believes that settlement and lodgment can no longer be conducted electronically. Special condition 2 ceases to apply from when such a notice is given.
- 2.3 Each party must:
 - (a) be, or engage a representative who is, a subscriber for the purposes of the Electronic Conveyancing National Law,
 - (b) ensure that all other persons for whom that party is responsible and who are associated with this transaction are, or engage, a subscriber for the purposes of the Electronic Conveyancing National Law, and
 - (c) conduct the transaction in accordance with the Electronic Conveyancing National Law.
- 2.4 The vendor must open the Electronic Workspace ("workspace") as soon as reasonably practicable. The workspace is an electronic address for the service of notices and for written communications for the purposes of any electronic transactions legislation.
- 2.5 The vendor must nominate a time of the day for locking of the workspace at least 7 days before the due date for settlement.
- 2.6 Settlement occurs when the workspace records that:
 - a) the exchange of funds or value between financial institutions in accordance with the instructions of the parties has occurred; or
 - b) if there is no exchange of funds or value, the documents necessary to enable the purchaser to become registered proprietor of the land have been accepted for electronic lodgment.
- 2.7 The parties must do everything reasonably necessary to effect settlement:
 - a) electronically on the next business day, or
 - b) at the option of either party, otherwise than electronically as soon as possible — if, after the locking of the workspace at the nominated settlement time, settlement in accordance with special condition 2.6 has not occurred by 4.00 pm, or 6.00 pm if the nominated time for settlement is after 4.00 pm.
- 2.8 Each party must do everything reasonably necessary to assist the other party to trace and identify the recipient of any mistaken payment and to recover the mistaken payment.

3. IDENTITY OF LAND

- 3.1 Without limiting the generality of general condition 3, the Purchaser admits, agrees and accepts that:
- a) any boundary fence or wall is correctly located on the title boundary of the Land; and
 - b) all structures or improvements on the Land are contained wholly within the title boundaries and no structure or improvement of any adjoining property encroaches over or under the title boundaries to the Land.
- 3.2 The Purchaser may not make any claim, nor require the Vendor to take or refrain from taking any action (including amending the title or contributing to any expense of amending the title) in respect of any matters referred to in special condition 3.1.

4. PRIOR REPRESENTATIONS AND CONDITION OF LAND

- 4.1 The Purchaser acknowledges that except as is contained in this Contract and the Vendor's Statement (and as is prescribed by the Law), there are no other conditions, warranties or other terms affecting or relating to the sale of the Land. To the extent permitted by Law, the Purchaser shall not be entitled in any way to rely on (or make any Claims against the Vendor in connection with) any information, representation or warranty made or claimed to have been made by the Vendor or on the Vendor's behalf (including but not limited to by the Vendor's estate agent or solicitor) including but not limited to in relation to compliance with any Laws affecting the Land or the compliance of any improvements on the Land with any Building Law.
- 4.2 It is further acknowledged by the Purchaser that:
- a) they buy the Land subject to:
 - i. Any Laws affecting the Land;
 - ii. any restriction or condition affecting or imposed on the Land and its use and development (including as imposed under any planning permit, approval or agreement or planning controls),
 - b) any improvements on the Land may be subject to or require compliance with the Building Law and any failure to comply with any one or more of those laws shall not constitute and shall not be deemed to constitute a defect in the Vendor's title and the Purchaser shall not make any requisition or objection, claim any compensation or refuse or delay payment of the Price or any part thereof on any such ground; and
 - c) except as is required by law and/or is otherwise stated hereunder, the Vendor gives no warranty as to the state of repair and condition or suitability of the Land or of the Goods any of the fittings and fixtures thereon and the Purchaser purchases the Land and the Goods subject to all faults and defects (both latent or patent) and in its present state of repair or condition.
- 4.3 The Purchaser acknowledges and agrees that the Land is sold and the Purchaser takes title subject to any easements (both express or implied) affecting the land by virtue of the provisions of the Sale of Land Act 1962 (Victoria) Act (the "Act") and subject to all statutory planning controls and the restrictions on the use of the Land thereby imposed by all competent authorities, including without limiting the generality of the foregoing, the Land is sold subject to any controls and restrictions imposed by any other town planning Acts or schemes (including the terms of any planning permit issued in relation to the Land and the Plan of Subdivision and/or the terms of any Section 173 Agreement (including but not limited to as entered after the date of this Contract). The Purchaser shall not make any requisition, objection or claim for compensation concerning any such easements controls and restrictions (including the terms of such planning permit and/or any Section 173 Agreement) upon the Land sold.

5. SERVICES

To the extent permitted by law, the Purchaser may not make any claim, nor require the Vendor to take or refrain from taking any action, in relation to:

- a) the nature, location, availability or non-availability of any services;
- b) any defects in any services;
- c) there being or not being an easement or other right in respect of any services;
- d) any service being a joint service with any other land or building;
- e) any service for any other land or building passing through or over the Land;
- f) any service installed in, on or under the Land not having been approved by an authority; or
- g) any sewer, vent, manhole or water or sewerage main or connection passing through, in or over the land.

6. PLANNING SCHEMES

The purchaser buys subject to any restrictions imposed by and to the provisions of the Melbourne Metropolitan Planning Scheme and any other Town Planning Acts or Schemes.

7. NO REPRESENTATIONS

It is hereby agreed between the parties hereto that there are no conditions, warranties or other terms affecting this sale other than those embodied herein and the purchaser shall not be entitled to rely on any representations made by the vendor or his Agent except such as are made conditions of this contract.

8. DWELLING

The land and buildings (if any) as sold hereby and inspected by the purchaser is sold on the basis of existing improvements thereon and the purchaser shall not make any requisition or claim any compensation for any deficiency or defect in the said improvements as to their suitability for occupation or otherwise including any requisition in relation to the issue or non-issue of Building Permits and/or completion of inspections by the relevant authorities in respect of any improvements herein.

9. DEPOSIT

Not used

10. GUARANTEE

If a company purchases the property:

- a) Any person who signs this contract will be personally responsible to comply with the terms and conditions of this contract; and
- b) The directors of the company must sign the guarantee attached to this contract and deliver it to the vendor within 7 days of the day of sale.

11. DEFAULT/BREACH INTEREST

The purchaser must pay to the vendor interest at 12% per annum on an amount in default/breach from the time it fell due until the default/breach ceases. If a default notice is issued, then the cost of \$800 + GST for issuing default notice shall be paid by the purchasers.

12. LOSS ARISING FROM DEFAULT

The purchaser hereby agrees and acknowledges that should the purchaser for any reason be unable to perform its obligations under this contract as and when required by the contract and should the vendor suffer loss, damage and expense as a result of such failure, in addition to any interest due under Special Condition

11, then the purchaser shall reimburse the vendor for any and all reasonably foreseeable losses, damages or expenses, including but not limited to:

- a) Any interest, fees, charges or other costs incurred as a result of additional financing being required by the vendor in order that the vendor may satisfy its obligations under any other contract entered into by the vendor for the purchase of any other property, whereby such additional finance would not be required but for the default of the purchaser;
- b) Any interest, fees, charges or other costs incurred by the vendor in relation to any loan where the property subject to this contract has been provided as a security for such loan;
- c) Any expenses or costs incurred by the vendor for any temporary accommodation required by the vendor as a result of the purchaser not being able to satisfy its obligations under this contract, including where the vendor is not able to enter into occupation of premises purchased by him as a result of the default of the purchaser;
- d) Any expenses or costs incurred by the vendor in relation to any transport or removalist agreement entered into by the vendor in anticipation of the purchaser being able to satisfy his obligations under this contract as and when required;
- e) Any fees, charges, penalty interest or other penalties or expenses incurred by the vendor as a result of any delay in completion of the vendors purchase of another property, as a result of the default of the purchaser under this contract: and
- f) Any legal fees, costs or expenses as between solicitor and client incurred by the vendor as a result of the default of the purchaser.

13. FIRB APPROVAL

The purchaser warrants that the provisions of the Foreign Acquisitions and Takeovers Act 1975 (Cth) do not require the purchaser to obtain consent to enter this contract.

If there is a breach of the warranty contained in clause 8.1 (whether intentional or not) the purchaser must indemnify and compensate the vendor for any loss, damage or cost which the vendor incurs as a result of the breach;

This warranty and indemnity do not merge on completion of this contract.

14. RESCHEDULED SETTLEMENT

Without limiting any other rights of the Vendor, if the purchaser fails to settle on the due date for settlement as set out in the particulars of this Contract (Due Date) or request an extension or variation to the Due Date, the Purchaser must pay the Vendor's representative \$220.00 + GST at the at the settlement for each request.

15. ADJUSTMENTS

Statement of Adjustments and all relevant certificates must be prepared on behalf of the Purchasers and provided to the Vendors representative not less than 3 business days prior to the due date of settlement and any failure to do so, will cause the Purchasers to pay administration fee to the Vendors representative of \$150.00 + GST for the delay in receiving the Statement of Adjustments and all relevant certificates.

16. LICENSE AGREEMENT

In the event that the Vendor allows the Purchaser to take possession of the subject property prior to settlement then the Purchaser shall execute a license agreement as prepared by the Vendor's representative and shall prior to taking possession pay the costs associated with said preparation.

17. NOMINATION

Should the Purchaser do a nomination, the Purchaser will pay the Vendor Conveyancer's costs in the sum of \$200.00 + GST.

18. OUTGOINGS

- 18.1 In the event that the Land is not separately rated or assessed in respect of any of the outgoings referred to in General condition 15 the proportion thereof to be apportioned between the Vendor and the Purchaser shall be in the same proportion as the lot liability that the Land bears to the total lot liability of all the land in the Plan of Subdivision as is reasonably determined by the Vendor.
- 18.2 If as a result of a breach of this Contract by the Purchaser the Property is owned by the Vendor as at midnight on 31 December following the Settlement Date then land tax is to be adjusted on the basis that the Purchaser pays all of the land tax assessed, charged and levied on the Vendor in respect of the Property after the Settlement Date.
- 18.3 The Purchaser must solely bear and pay any:
- (a) supplementary rates and taxes;
 - (b) infrastructure levies; and
 - (c) services connection fees or levies,
- assessed or levied on the Property on or after the registration at Titles Office of the Plan of Subdivision.

19. VARIATION/DELETION OF OTHER GENERAL CONDITIONS

- 19.1 General conditions 6.6 does not apply.
- 19.2 A new General Condition 14.12 is added to this contract as follows: "Where the purchaser is deemed by section 27(7) of the Sale of Land Act 1962 to have given the deposit release authorization referred to in section 27(1), the purchaser is also deemed to have accepted title in the absence of any prior express objection to title."
- 19.3 General Condition 31.3 is amended to remove the words "but may claim compensation from the vendor after settlement." General conditions 12, 31.4 – 31.6 are deleted.
- 19.4 A new general condition 20.4 is added "If the purchaser rescinds the contract based on finance clause, then they need to provide satisfactory evidence from financial institution. Any evidence from mortgage broker will not be deemed as sufficient evidence."

20. PRECEDENCE OF SPECIAL CONDITIONS

The Special Conditions shall take precedence over and prevail to the extent of any inconsistency with any other term or condition of this Contract, including Part 1 of the form of contract, the Particulars of Sale, the General Conditions and Vendor's Statement.

21. TRUST

If the Purchaser is buying the Land as trustee of a trust ("Trust") then the Purchaser:

- a) must not do anything to prejudice any right of indemnity the Purchaser may have under the Trust;
- b) warrants that the Purchaser has power under the Trust to enter into this Contract
- c) is personally liable under this Contract;
- d) warrants that the Purchaser has a right of indemnity under the Trust; and
- e) must not allow the variation of the Trust or the advance or distribution of capital of the Trust or resettlement of any property belonging to the Trust.

22. SOLAR PANELS (if applicable)

The Vendor makes no representations or gives any warranties whatsoever with respect to any solar panels installed on the property hereby sold in relation to their condition, state of repair, fitness for purpose, their input, feed in tariff or any benefits arising from the electricity generated by any solar panels, save that they are owned by the Vendor and not encumbered in any way.

23. POOL COMPLIANCE (if applicable)

The purchaser agrees that he will be responsible to comply with any notice, order, demand or levy imposed in relation to the safety of any pool or spa on the property regardless of whether such notice, order, demand or levy was issued or made before or after the day of sale.

The purchaser is aware that he may have to:

- a) Register the pool or spa with the local council if the vendor has not already done so.
- b) Arrange a private inspection and obtain a report at his cost;
- c) Comply with all the requirements of the report;
- d) Arrange any further inspections at his cost; and
- e) Provide the local council with a Certificate of Compliance and pay the required fee.

The Purchaser acknowledges that he shall not have any right to seek any contribution either directly or indirectly from the vendor towards any costs, fees, charges or disbursements whatsoever or howsoever arising in relation to any pool or spa on the property.

24. Outgoings

The purchaser shall be responsible for any notice, demand or levy imposing any liability on the property without limitation and including but not limited to any liability for the payment of any Windfall Gains Tax or any other tax or imposition that does not specifically relate to periodic outgoings made on or after the Day of Sale. If the Vendor is required to pay such tax before settlement, the Purchaser shall reimburse the Vendor the amount paid at settlement.

25. AUCTION

The Rules for the conduct of the auction shall be as set out in Schedule 1 of the Sale of Land Regulations 2014 or any rules prescribed by regulation which modify or replace those Rules.

26. CHRISTMAS PERIOD SETTLEMENT VARIATION

The parties acknowledge and agree that the Vendor's Conveyancer will not be available for settlements between 21st December 2026 and 8th January 2027 (the "Christmas Break"). If the settlement date specified in the Particulars of Sale falls within this period, it is mutually agreed that settlement shall be extended and occur on 11 January 2026. This extension shall be completed without penalty or compensation being sought by either the Vendor or the Purchaser, and no party shall raise any objection for demand compensation due to the settlement date being extended or delayed as a consequence of this special condition. This term is an essential element of the contract.

General conditions

Contract signing

1. ELECTRONIC SIGNATURE

- 1.1 In this general condition "electronic signature" means a digital signature or a visual representation of a person's handwritten signature or mark which is placed on a physical or electronic copy of this contract by electronic or mechanical means, and "electronically signed" has a corresponding meaning.
- 1.2 The parties' consent to this contract being signed by or on behalf of a party by an electronic signature.
- 1.3 Where this contract is electronically signed by or on behalf of a party, the party warrants and agrees that the electronic signature has been used to identify the person signing and to indicate that the party intends to be bound by the electronic signature.
- 1.4 This contract may be electronically signed in any number of counterparts which together will constitute the one document.
- 1.5 Each party consents to the exchange of counterparts of this contract by delivery by email or such other electronic means as may be agreed in writing.
- 1.6 Each party must upon request promptly deliver a physical counterpart of this contract with the handwritten signature or signatures of the party and all written evidence of the authority of a person signing on their behalf, but a failure to comply with the request does not affect the validity of this contract.

2. LIABILITY OF SIGNATORY

Any signatory for a proprietary limited company purchaser is personally liable for the due performance of the purchaser's obligations as if the signatory were the purchaser in the case of a default by a proprietary limited company purchaser.

3. GUARANTEE

The vendor may require one or more directors of the purchaser to guarantee the purchaser's performance of this contract if the purchaser is a proprietary limited company.

4. NOMINEE

The purchaser may no later than 14 days before the due date for settlement nominate a substitute or additional person to take a transfer of the land, but the named purchaser remains personally liable for the due performance of all the purchaser's obligations under this contract.

Title

5. ENCUMBRANCES

- 5.1 The purchaser buys the property subject to:
 - (a) any encumbrance shown in the section 32 statement other than mortgages or caveats; and
 - (b) any reservations, exceptions and conditions in the crown grant; and
 - (c) any lease or tenancy referred to in the particulars of sale.
- 5.2 The purchaser indemnifies the vendor against all obligations under any lease or tenancy that are to be performed by the landlord after settlement.

6. VENDOR WARRANTIES

- 6.1 The vendor warrants that these general conditions 1 to 35 are identical to the general conditions 1 to 35 in the form of contract of sale of land published by the Law Institute of Victoria Limited and the Real Estate Institute of Victoria Ltd in the month and year set out at the foot of this page.
- 6.2 The warranties in general conditions 6.3 and 6.4 replace the purchaser's right to make requisitions and inquiries.
- 6.3 The vendor warrants that the vendor:
 - (a) has, or by the due date for settlement will have, the right to sell the land; and
 - (b) is under no legal disability; and
 - (c) is in possession of the land, either personally or through a tenant; and
 - (d) has not previously sold or granted any option to purchase, agreed to a lease or granted a pre-emptive right which is current over the land and which gives another party rights which have priority over the interest of the purchaser; and
 - (e) will at settlement be the holder of an unencumbered estate in fee simple in the land; and
 - (f) will at settlement be the unencumbered owner of any improvements, fixtures, fittings and goods sold with the land.

- 6.4 The vendor further warrants that the vendor has no knowledge of any of the following:
- (a) public rights of way over the land;
 - (b) easements over the land;
 - (c) lease or other possessory agreement affecting the land;
 - (d) notice or order directly and currently affecting the land which will not be dealt with at settlement, other than the usual rate notices and any land tax notices;
 - (e) legal proceedings which would render the sale of the land void or voidable or capable of being set aside.
- 6.5 The warranties in general conditions 6.3 and 6.4 are subject to any contrary provisions in this contract and disclosures in the section 32 statement.
- 6.6 If sections 137B and 137C of the *Building Act* 1993 apply to this contract, the vendor warrants that:
- (a) all domestic building work carried out in relation to the construction by or on behalf of the vendor of the home was carried out in a proper and workmanlike manner; and
 - (b) all materials used in that domestic building work were good and suitable for the purpose for which they were used and that, unless otherwise stated in the contract, those materials were new; and
 - (c) domestic building work was carried out in accordance with all laws and legal requirements, including, without limiting the generality of this warranty, the *Building Act* 1993 and regulations made under the *Building Act* 1993.
- 6.7 Words and phrases used in general condition 6.6 which are defined in the *Building Act* 1993 have the same meaning in general condition 6.6.

7. IDENTITY OF THE LAND

- 7.1 An omission or mistake in the description of the property or any deficiency in the area, description or measurements of the land does not invalidate the sale.
- 7.2 The purchaser may not:
- (a) make any objection or claim for compensation for any alleged misdescription of the property or any deficiency in its area or measurements; or
 - (b) require the vendor to amend title or pay any cost of amending title.

8. SERVICES

- 8.1 The vendor does not represent that the services are adequate for the purchaser's proposed use of the property and the vendor advises the purchaser to make appropriate inquiries. The condition of the services may change between the day of sale and settlement and the vendor does not promise that the services will be in the same condition at settlement as they were on the day of sale.
- 8.2 The purchaser is responsible for the connection of all services to the property after settlement and the payment of any associated cost.

9. CONSENTS

The vendor must obtain any necessary consent or licence required for the vendor to sell the property. The contract will be at an end and all money paid must be refunded if any necessary consent or licence is not obtained by settlement.

10. TRANSFER & DUTY

- 10.1 The purchaser must prepare and deliver to the vendor at least 7 days before the due date for settlement any paper transfer of land document which is necessary for this transaction. The delivery of the transfer of land document is not acceptance of title.
- 10.2 The vendor must promptly initiate the Duties on Line or other form required by the State Revenue Office in respect of this transaction, and both parties must co-operate to complete it as soon as practicable.

11. RELEASE OF SECURITY INTEREST

- 11.1 This general condition applies if any part of the property is subject to a security interest to which the *Personal Property Securities Act* 2009 (Cth) applies.
- 11.2 For the purposes of enabling the purchaser to search the Personal Property Securities Register for any security interests affecting any personal property for which the purchaser may be entitled to a release, statement, approval or correction in accordance with general condition 11.4, the purchaser may request the vendor to provide the vendor's date of birth to the purchaser. The vendor must comply with a request made by the purchaser under this condition if the purchaser makes the request at least 21 days before the due date for settlement.
- 11.3 If the purchaser is given the details of the vendor's date of birth under general condition 11.2, the purchaser must
- (a) only use the vendor's date of birth for the purposes specified in general condition 11.2; and
 - (b) keep the date of birth of the vendor secure and confidential.

- 11.4 The vendor must ensure that at or before settlement, the purchaser receives—
- (a) a release from the secured party releasing the property from the security interest; or
 - (b) a statement in writing in accordance with section 275(1)(b) of the *Personal Property Securities Act 2009* (Cth) setting out that the amount or obligation that is secured is nil at settlement; or
 - (c) a written approval or correction in accordance with section 275(1)(c) of the *Personal Property Securities Act 2009* (Cth) indicating that, on settlement, the personal property included in the contract is not or will not be property in which the security interest is granted.
- 11.5 Subject to general condition 11.6, the vendor is not obliged to ensure that the purchaser receives a release, statement, approval or correction in respect of personal property—
- (a) that—
 - (i) the purchaser intends to use predominantly for personal, domestic or household purposes; and
 - (ii) has a market value of not more than \$5000 or, if a greater amount has been prescribed for the purposes of section 47(1) of the *Personal Property Securities Act 2009* (Cth), not more than that prescribed amount; or
 - (b) that is sold in the ordinary course of the vendor's business of selling personal property of that kind.
- 11.6 The vendor is obliged to ensure that the purchaser receives a release, statement, approval or correction in respect of personal property described in general condition 11.5 if—
- (a) the personal property is of a kind that may or must be described by serial number in the Personal Property Securities Register; or
 - (b) the purchaser has actual or constructive knowledge that the sale constitutes a breach of the security agreement that provides for the security interest.
- 11.7 A release for the purposes of general condition 11.4(a) must be in writing.
- 11.8 A release for the purposes of general condition 11.4(a) must be effective in releasing the goods from the security interest and be in a form which allows the purchaser to take title to the goods free of that security interest.
- 11.9 If the purchaser receives a release under general condition 11.4(a) the purchaser must provide the vendor with a copy of the release at or as soon as practicable after settlement.
- 11.10 In addition to ensuring that a release is received under general condition 11.4(a), the vendor must ensure that at or before settlement the purchaser receives a written undertaking from a secured party to register a financing change statement to reflect that release if the property being released includes goods of a kind that are described by serial number in the Personal Property Securities Register.
- 11.11 The purchaser must advise the vendor of any security interest that is registered on or before the day of sale on the Personal Property Securities Register, which the purchaser reasonably requires to be released, at least 21 days before the due date for settlement.
- 11.12 The vendor may delay settlement until 21 days after the purchaser advises the vendor of the security interests that the purchaser reasonably requires to be released if the purchaser does not provide an advice under general condition 11.11.
- 11.13 If settlement is delayed under general condition 11.12 the purchaser must pay the vendor—
- (a) interest from the due date for settlement until the date on which settlement occurs or 21 days after the vendor receives the advice, whichever is the earlier; and
 - (b) any reasonable costs incurred by the vendor as a result of the delay—
as though the purchaser was in default.
- 11.14 The vendor is not required to ensure that the purchaser receives a release in respect of the land. This general condition 11.14 applies despite general condition 11.1.
- 11.15 Words and phrases which are defined in the *Personal Property Securities Act 2009* (Cth) have the same meaning in general condition 11 unless the context requires otherwise.

12. BUILDER WARRANTY INSURANCE

The vendor warrants that the vendor will provide at settlement details of any current builder warranty insurance in the vendor's possession relating to the property if requested in writing to do so at least 21 days before settlement.

13. GENERAL LAW LAND

- 13.1 The vendor must complete a conversion of title in accordance with section 14 of the *Transfer of Land Act 1958* before settlement if the land is the subject of a provisional folio under section 23 of that Act.
- 13.2 The remaining provisions of this general condition 13 only apply if any part of the land is not under the operation of the *Transfer of Land Act 1958*.

- 13.3 The vendor is taken to be the holder of an unencumbered estate in fee simple in the land if there is an unbroken chain of title starting at least 30 years before the day of sale proving on the face of the documents the ownership of the entire legal and equitable estate without the aid of other evidence.
- 13.4 The purchaser is entitled to inspect the vendor's chain of title on request at such place in Victoria as the vendor nominates.
- 13.5 The purchaser is taken to have accepted the vendor's title if:
- (a) 21 days have elapsed since the day of sale; and
 - (b) the purchaser has not reasonably objected to the title or reasonably required the vendor to remedy a defect in the title.
- 13.6 The contract will be at an end if:
- (a) the vendor gives the purchaser a notice that the vendor is unable or unwilling to satisfy the purchaser's objection or requirement and that the contract will end if the objection or requirement is not withdrawn within 14 days of the giving of the notice; and
 - (b) the objection or requirement is not withdrawn in that time.
- 13.7 If the contract ends in accordance with general condition 13.6, the deposit must be returned to the purchaser and neither party has a claim against the other in damages.
- 13.8 General condition 17.1 [settlement] should be read as if the reference to 'registered proprietor' is a reference to 'owner' in respect of that part of the land which is not under the operation of the *Transfer of Land Act 1958*.
-

Money

14. DEPOSIT

- 14.1 The purchaser must pay the deposit:
- (a) to the vendor's licensed estate agent; or
 - (b) if there is no estate agent, to the vendor's legal practitioner or conveyancer; or
 - (c) if the vendor directs, into a special purpose account in an authorised deposit-taking institution in Victoria specified by the vendor in the joint names of the purchaser and the vendor.
- 14.2 If the land sold is a lot on an unregistered plan of subdivision, the deposit:
- (a) must not exceed 10% of the price; and
 - (b) must be paid to the vendor's estate agent, legal practitioner or conveyancer and held by the estate agent, legal practitioner or conveyancer on trust for the purchaser until the registration of the plan of subdivision.
- 14.3 The deposit must be released to the vendor if:
- (a) the vendor provides particulars, to the satisfaction of the purchaser, that either:
 - (i) there are no debts secured against the property; or
 - (ii) if there are any debts, the total amount of those debts together with any amounts to be withheld in accordance with general conditions 24 and 25 does not exceed 80% of the sale price; and
 - (b) at least 28 days have elapsed since the particulars were given to the purchaser under paragraph (a); and
 - (c) all conditions of section 27 of the *Sale of Land Act 1962* have been satisfied.
- 14.4 The stakeholder must pay the deposit and any interest to the party entitled when the deposit is released, the contract is settled, or the contract is ended.
- 14.5 The stakeholder may pay the deposit and any interest into court if it is reasonable to do so.
- 14.6 Where the purchaser is deemed by section 27(7) of the *Sale of Land Act 1962* to have given the deposit release authorisation referred to in section 27(1), the purchaser is also deemed to have accepted title in the absence of any prior express objection to title.
- 14.7 Payment of the deposit may be made or tendered:
- (a) in cash up to \$1,000 or 0.2% of the price, whichever is greater; or
 - (b) by cheque drawn on an authorised deposit-taking institution; or
 - (c) by electronic funds transfer to a recipient having the appropriate facilities for receipt.

However, unless otherwise agreed:

- (d) payment may not be made by credit card, debit card or any other financial transfer system that allows for any chargeback or funds reversal other than for fraud or mistaken payment, and
 - (e) any financial transfer or similar fees or deductions from the funds transferred, other than any fees charged by the recipient's authorised deposit-taking institution, must be paid by the remitter.
- 14.8 Payment by electronic funds transfer is made when cleared funds are received in the recipient's bank account.
- 14.9 Before the funds are electronically transferred the intended recipient must be notified in writing and given sufficient particulars to readily identify the relevant transaction.
- 14.10 As soon as the funds have been electronically transferred the intended recipient must be provided with the relevant transaction number or reference details.
- 14.11 For the purpose of this general condition 'authorised deposit-taking institution' means a body corporate for which an authority under section 9(3) of the *Banking Act 1959* (Cth) is in force.

15. DEPOSIT BOND

- 15.1 This general condition only applies if the applicable box in the particulars of sale is checked.
- 15.2 In this general condition "deposit bond" means an irrevocable undertaking to pay on demand an amount equal to the deposit or any unpaid part of the deposit. The issuer and the form of the deposit bond must be satisfactory to the vendor. The deposit bond must have an expiry date at least 45 days after the due date for settlement.
- 15.3 The purchaser may deliver a deposit bond to the vendor's estate agent, legal practitioner or conveyancer within 7 days after the day of sale.
- 15.4 The purchaser may at least 45 days before a current deposit bond expires deliver a replacement deposit bond on the same terms and conditions.
- 15.5 Where a deposit bond is delivered, the purchaser must pay the deposit to the vendor's legal practitioner or conveyancer on the first to occur of:
- (a) settlement;
 - (b) the date that is 45 days before the deposit bond or any replacement deposit bond expires;
 - (c) the date on which this contract ends in accordance with general condition 35.2 [default not remedied] following breach by the purchaser; and
 - (d) the date on which the vendor ends this contract by accepting repudiation of it by the purchaser.
- 15.6 The vendor may claim on the deposit bond without prior notice if the purchaser defaults under this contract or repudiates this contract and the contract is ended. The amount paid by the issuer satisfies the obligations of the purchaser under general condition 15.5 to the extent of the payment.
- 15.7 Nothing in this general condition limits the rights of the vendor if the purchaser defaults under this contract or repudiates this contract, except as provided in general condition 15.6.
- 15.8 This general condition is subject to general condition 14.2 [deposit].

16. BANK GUARANTEE

- 16.1 This general condition only applies if the applicable box in the particulars of sale is checked.
- 16.2 In this general condition:
- (a) "bank guarantee" means an unconditional and irrevocable guarantee or undertaking by a bank in a form satisfactory to the vendor to pay on demand any amount under this contract agreed in writing, and
 - (b) "bank" means an authorised deposit-taking institution under the *Banking Act 1959* (Cth).
- 16.3 The purchaser may deliver a bank guarantee to the vendor's legal practitioner or conveyancer.
- 16.4 The purchaser must pay the amount secured by the bank guarantee to the vendor's legal practitioner or conveyancer on the first to occur of:
- (a) settlement;
 - (b) the date that is 45 days before the bank guarantee expires;
 - (c) the date on which this contract ends in accordance with general condition 35.2 [default not remedied] following breach by the purchaser; and
 - (d) the date on which the vendor ends this contract by accepting repudiation of it by the purchaser.
- 16.5 The vendor must return the bank guarantee document to the purchaser when the purchaser pays the amount secured by the bank guarantee in accordance with general condition 16.4.
- 16.6 The vendor may claim on the bank guarantee without prior notice if the purchaser defaults under this contract or repudiates this contract and the contract is ended. The amount paid by the bank satisfies the obligations of the purchaser under general condition 16.4 to the extent of the payment.

16.7 Nothing in this general condition limits the rights of the vendor if the purchaser defaults under this contract or repudiates this contract except as provided in general condition 16.6.

16.8 This general condition is subject to general condition 14.2 [deposit].

17. SETTLEMENT

17.1 At settlement:

- (a) the purchaser must pay the balance; and
- (b) the vendor must:
 - (i) do all things necessary to enable the purchaser to become the registered proprietor of the land; and
 - (ii) give either vacant possession or receipt of rents and profits in accordance with the particulars of sale.

17.2 Settlement must be conducted between the hours of 10.00 am and 4.00 pm unless the parties agree otherwise.

17.3 The purchaser must pay all money other than the deposit in accordance with a written direction of the vendor or the vendor's legal practitioner or conveyancer.

18. ELECTRONIC SETTLEMENT

18.1 Settlement and lodgement of the instruments necessary to record the purchaser as registered proprietor of the land will be conducted electronically in accordance with the Electronic Conveyancing National Law. This general condition 18 has priority over any other provision of this contract to the extent of any inconsistency.

18.2 A party must immediately give written notice if that party reasonably believes that settlement and lodgement can no longer be conducted electronically. General condition 18 ceases to apply from when such a notice is given.

18.3 Each party must:

- (a) be, or engage a representative who is, a subscriber for the purposes of the Electronic Conveyancing National Law,
- (b) ensure that all other persons for whom that party is responsible and who are associated with this transaction are, or engage, a subscriber for the purposes of the Electronic Conveyancing National Law, and
- (c) conduct the transaction in accordance with the Electronic Conveyancing National Law.

18.4 The vendor must open the electronic workspace ("workspace") as soon as reasonably practicable and nominate a date and time for settlement. The inclusion of a specific date and time for settlement in a workspace is not of itself a promise to settle on that date or at that time. The workspace is an electronic address for the service of notices and for written communications for the purposes of any electronic transactions legislation.

18.5 This general condition 18.5 applies if there is more than one electronic lodgement network operator in respect of the transaction. In this general condition 18.5 "the transaction" means this sale and purchase and any associated transaction involving any of the same subscribers.

To the extent that any interoperability rules governing the relationship between electronic lodgement network operators do not provide otherwise:

- (a) the electronic lodgement network operator to conduct all the financial and lodgement aspects of the transaction after the workspace locks must be one which is willing and able to conduct such aspects of the transaction in accordance with the instructions of all the subscribers in the workspaces of all the electronic lodgement network operators after the workspace locks;
- (b) if two or more electronic lodgement network operators meet that description, one may be selected by purchaser's incoming mortgagee having the highest priority but if there is no mortgagee of the purchaser, the vendor must make the selection.

18.6 Settlement occurs when the workspace records that:

- (a) there has been an exchange of funds or value between the exchange settlement account or accounts in the Reserve Bank of Australia of the relevant financial institutions or their financial settlement agents in accordance with the instructions of the parties; or
- (b) if there is no exchange of funds or value, the documents necessary to enable the purchaser to become registered proprietor of the land have been accepted for electronic lodgement.

18.7 The parties must do everything reasonably necessary to effect settlement:

- (a) electronically on the next business day, or
- (b) at the option of either party, otherwise than electronically as soon as possible –

if, after the locking of the workspace at the nominated settlement time, settlement in accordance with general condition 18.6 has not occurred by 4.00 pm, or 6.00 pm if the nominated time for settlement is after 4.00 pm.

18.8 Each party must do everything reasonably necessary to assist the other party to trace and identify the recipient of any missing or mistaken payment and to recover the missing or mistaken payment.

18.9 The vendor must before settlement:

- (a) deliver any keys, security devices and codes ("keys") to the estate agent named in the contract,
- (b) direct the estate agent to give the keys to the purchaser or the purchaser's nominee on notification of settlement by the vendor, the vendor's subscriber or the electronic lodgement network operator;

- (c) deliver all other physical documents and items (other than the goods sold by the contract) to which the purchaser is entitled at settlement, and any keys if not delivered to the estate agent, to the vendor's subscriber or, if there is no vendor's subscriber, confirm in writing to the purchaser that the vendor holds those documents, items and keys at the vendor's address set out in the contract, and

give, or direct its subscriber to give, all those documents and items and any such keys to the purchaser or the purchaser's nominee on notification by the electronic lodgement network operator of settlement.

19. GST

- 19.1 The purchaser does not have to pay the vendor any amount in respect of GST in addition to the price if the particulars of sale specify that the price includes GST (if any).
- 19.2 The purchaser must pay to the vendor any GST payable by the vendor in respect of a taxable supply made under this contract in addition to the price if:
 - (a) the particulars of sale specify that GST (if any) must be paid in addition to the price; or
 - (b) GST is payable solely as a result of any action taken or intended to be taken by the purchaser after the day of sale, including a change of use; or
 - (c) the particulars of sale specify that the supply made under this contract is of land on which a 'farming business' is carried on and the supply (or part of it) does not satisfy the requirements of section 38-480 of the GST Act; or
 - (d) the particulars of sale specify that the supply made under this contract is of a going concern and the supply (or a part of it) does not satisfy the requirements of section 38-325 of the GST Act.
- 19.3 The purchaser is not obliged to pay any GST under this contract until a tax invoice has been given to the purchaser, unless the margin scheme applies.
- 19.4 If the particulars of sale specify that the supply made under this contract is of land on which a 'farming business' is carried on:
 - (a) the vendor warrants that the property is land on which a farming business has been carried on for the period of 5 years preceding the date of supply; and
 - (b) the purchaser warrants that the purchaser intends that a farming business will be carried on after settlement on the property.
- 19.5 If the particulars of sale specify that the supply made under this contract is a 'going concern':
 - (a) the parties agree that this contract is for the supply of a going concern; and
 - (b) the purchaser warrants that the purchaser is, or prior to settlement will be, registered for GST; and
 - (c) the vendor warrants that the vendor will carry on the going concern until the date of supply.
- 19.6 If the particulars of sale specify that the supply made under this contract is a 'margin scheme' supply, the parties agree that the margin scheme applies to this contract.
- 19.7 In this general condition:
 - (a) 'GST Act' means *A New Tax System (Goods and Services Tax) Act 1999* (Cth); and
 - (b) 'GST' includes penalties and interest.

20. LOAN

- 20.1 If the particulars of sale specify that this contract is subject to a loan being approved, this contract is subject to the lender approving the loan on the security of the property by the approval date or any later date allowed by the vendor.
- 20.2 The purchaser may end the contract if the loan is not approved by the approval date, but only if the purchaser:
 - (a) immediately applied for the loan; and
 - (b) did everything reasonably required to obtain approval of the loan; and
 - (c) serves written notice ending the contract, together with written evidence of rejection or non-approval of the loan, on the vendor within 2 clear business days after the approval date or any later date allowed by the vendor; and
 - (d) is not in default under any other condition of this contract when the notice is given.
- 20.3 All money must be immediately refunded to the purchaser if the contract is ended.

21. BUILDING REPORT

- 21.1 This general condition only applies if the applicable box in the particulars of sale is checked.
- 21.2 The purchaser may end this contract within 14 days from the day of sale if the purchaser:
 - (a) obtains a written report from a registered building practitioner or architect which discloses a current defect in a structure on the land and designates it as a major building defect;
 - (b) gives the vendor a copy of the report and a written notice ending this contract; and
 - (c) is not then in default.
- 21.3 All money paid must be immediately refunded to the purchaser if the contract ends in accordance with this general condition.

- 21.4 A notice under this general condition may be served on the vendor's legal practitioner, conveyancer or estate agent even if the estate agent's authority has formally expired at the time of service.
- 21.5 The registered building practitioner may inspect the property at any reasonable time for the purpose of preparing the report.

22. PEST REPORT

- 22.1 This general condition only applies if the applicable box in the particulars of sale is checked.
- 22.2 The purchaser may end this contract within 14 days from the day of sale if the purchaser:
 - (a) obtains a written report from a pest control operator licensed under Victorian law which discloses a current pest infestation on the land and designates it as a major infestation affecting the structure of a building on the land;
 - (b) gives the vendor a copy of the report and a written notice ending this contract; and
 - (c) is not then in default.
- 22.3 All money paid must be immediately refunded to the purchaser if the contract ends in accordance with this general condition.
- 22.4 A notice under this general condition may be served on the vendor's legal practitioner, conveyancer or estate agent even if the estate agent's authority has formally expired at the time of service.
- 22.5 The pest control operator may inspect the property at any reasonable time for the purpose of preparing the report.

23. ADJUSTMENTS

- 23.1 All periodic outgoings payable by the vendor, and any rent and other income received in respect of the property must be apportioned between the parties on the settlement date and any adjustments paid and received as appropriate.
- 23.2 The periodic outgoings and rent and other income must be apportioned on the following basis:
 - (a) the vendor is liable for the periodic outgoings and entitled to the rent and other income up to and including the day of settlement; and
 - (b) the land is treated as the only land of which the vendor is owner (as defined in the *Land Tax Act 2005*); and
 - (c) the vendor is taken to own the land as a resident Australian beneficial owner; and
 - (d) any personal statutory benefit available to each party is disregarded in calculating apportionment.
- 23.3 The purchaser must provide copies of all certificates and other information used to calculate the adjustments under general condition 23, if requested by the vendor.

24. FOREIGN RESIDENT CAPITAL GAINS WITHHOLDING

- 24.1 Words defined or used in Subdivision 14-D of Schedule 1 to the *Taxation Administration Act 1953* (Cth) have the same meaning in this general condition unless the context requires otherwise.
- 24.2 Every vendor under this contract is a foreign resident for the purposes of this general condition unless the vendor gives the purchaser a clearance certificate issued by the Commissioner under section 14-220 (1) of Schedule 1 to the *Taxation Administration Act 1953* (Cth). The specified period in the clearance certificate must include the actual date of settlement.
- 24.3 The remaining provisions of this general condition 24 only apply if the purchaser is required to pay the Commissioner an amount in accordance with section 14-200(3) or section 14-235 of Schedule 1 to the *Taxation Administration Act 1953* (Cth) ("the amount") because one or more of the vendors is a foreign resident, the property has or will have a market value not less than the amount set out in section 14-215 of the legislation just after the transaction, and the transaction is not excluded under section 14-215(1) of the legislation.
- 24.4 The amount is to be deducted from the vendor's entitlement to the contract consideration. The vendor must pay to the purchaser at settlement such part of the amount as is represented by non-monetary consideration.
- 24.5 The purchaser must:
 - (a) engage a legal practitioner or conveyancer ("representative") to conduct all the legal aspects of settlement, including the performance of the purchaser's obligations under the legislation and this general condition; and
 - (b) ensure that the representative does so.
- 24.6 The terms of the representative's engagement are taken to include instructions to have regard to the vendor's interests and instructions that the representative must:
 - (a) pay, or ensure payment of, the amount to the Commissioner in the manner required by the Commissioner and as soon as reasonably and practicably possible, from moneys under the control or direction of the representative in accordance with this general condition if the sale of the property settles;
 - (b) promptly provide the vendor with proof of payment; and
 - (c) otherwise comply, or ensure compliance, with this general condition;despite:
 - (d) any contrary instructions, other than from both the purchaser and the vendor; and
 - (e) any other provision in this contract to the contrary.
- 24.7 The representative is taken to have complied with the requirements of general condition 24.6 if:
 - (a) the settlement is conducted through an electronic lodgement network; and

- (b) the amount is included in the settlement statement requiring payment to the Commissioner in respect of this transaction.
- 24.8 Any clearance certificate or document evidencing variation of the amount in accordance with section 14-235(2) of Schedule 1 to the *Taxation Administration Act 1953* (Cth) must be given to the purchaser at least 5 business days before the due date for settlement.
- 24.9 The vendor must provide the purchaser with such information as the purchaser requires to comply with the purchaser's obligation to pay the amount in accordance with section 14-200 of Schedule 1 to the *Taxation Administration Act 1953* (Cth). The information must be provided within 5 business days of request by the purchaser. The vendor warrants that the information the vendor provides is true and correct.
- 24.10 The purchaser is responsible for any penalties or interest payable to the Commissioner on account of late payment of the amount.

25. GST WITHHOLDING

- 25.1 Words and expressions defined or used in Subdivision 14-E of Schedule 1 to the *Taxation Administration Act 1953* (Cth) or in *A New Tax System (Goods and Services Tax) Act 1999* (Cth) have the same meaning in this general condition unless the context requires otherwise. Words and expressions first used in this general condition and shown in italics and marked with an asterisk are defined or described in at least one of those Acts.
- 25.2 The purchaser must notify the vendor in writing of the name of the recipient of the *supply for the purposes of section 14-255 of Schedule 1 to the *Taxation Administration Act 1953* (Cth) at least 21 days before the due date for settlement unless the recipient is the purchaser named in the contract.
- 25.3 The vendor must at least 14 days before the due date for settlement provide the purchaser and any person nominated by the purchaser under general condition 4 with a GST withholding notice in accordance with section 14-255 of Schedule 1 to the *Taxation Administration Act 1953* (Cth), and must provide all information required by the purchaser or any person so nominated to confirm the accuracy of the notice.
- 25.4 The remaining provisions of this general condition 25 apply if the purchaser is or may be required to pay the Commissioner an *amount in accordance with section 14-250 of Schedule 1 to the *Taxation Administration Act 1953* (Cth) because the property is *new residential premises or *potential residential land in either case falling within the parameters of that section, and also if the sale attracts the operation of section 14-255 of the legislation. Nothing in this general condition 25 is to be taken as relieving the vendor from compliance with section 14-255.
- 25.5 The amount is to be deducted from the vendor's entitlement to the contract *consideration and is then taken to be paid to the vendor, whether or not the vendor provides the purchaser with a GST withholding notice in accordance with section 14-255 of Schedule 1 to the *Taxation Administration Act 1953* (Cth). The vendor must pay to the purchaser at settlement such part of the amount as is represented by non-monetary consideration.
- 25.6 The purchaser must:
 - (a) engage a legal practitioner or conveyancer ("representative") to conduct all the legal aspects of settlement, including the performance of the purchaser's obligations under the legislation and this general condition; and
 - (b) ensure that the representative does so.
- 25.7 The terms of the representative's engagement are taken to include instructions to have regard to the vendor's interests relating to the payment of the amount to the Commissioner and instructions that the representative must:
 - (a) pay, or ensure payment of, the amount to the Commissioner in the manner required by the Commissioner and as soon as reasonably and practicably possible, from moneys under the control or direction of the representative in accordance with this general condition on settlement of the sale of the property;
 - (b) promptly provide the vendor with evidence of payment, including any notification or other document provided by the purchaser to the Commissioner relating to payment; and
 - (c) otherwise comply, or ensure compliance, with this general condition;despite:
 - (d) any contrary instructions, other than from both the purchaser and the vendor; and
 - (e) any other provision in this contract to the contrary.
- 25.8 The representative is taken to have complied with the requirements of general condition 25.7 if:
 - (a) settlement is conducted through an electronic lodgement network; and
 - (b) the amount is included in the settlement statement requiring payment to the Commissioner in respect of this transaction.
- 25.9 The purchaser may at settlement give the vendor a bank cheque for the amount in accordance with section 16-30 (3) of Schedule 1 to the *Taxation Administration Act 1953* (Cth), but only if:
 - (a) so agreed by the vendor in writing; and
 - (b) the settlement is not conducted through an electronic lodgement network.However, if the purchaser gives the bank cheque in accordance with this general condition 25.9, the vendor must:
 - (c) immediately after settlement provide the bank cheque to the Commissioner to pay the amount in relation to the supply; and

- (d) give the purchaser a receipt for the bank cheque which identifies the transaction and includes particulars of the bank cheque, at the same time the purchaser gives the vendor the bank cheque.
- 25.10 A party must provide the other party with such information as the other party requires to:
- (a) decide if an amount is required to be paid or the quantum of it, or
 - (b) comply with the purchaser's obligation to pay the amount,
- in accordance with section 14-250 of Schedule 1 to the *Taxation Administration Act 1953* (Cth). The information must be provided within 5 business days of a written request. The party providing the information warrants that it is true and correct.
- 25.11 The vendor warrants that:
- (a) at settlement, the property is not new residential premises or potential residential land in either case falling within the parameters of section 14-250 of Schedule 1 to the *Taxation Administration Act 1953* (Cth) if the vendor gives the purchaser a written notice under section 14-255 to the effect that the purchaser will not be required to make a payment under section 14-250 in respect of the supply, or fails to give a written notice as required by and within the time specified in section 14-255; and
 - (b) the amount described in a written notice given by the vendor to the purchaser under section 14-255 of Schedule 1 to the *Taxation Administration Act 1953* (Cth) is the correct amount required to be paid under section 14-250 of the legislation.
- 25.12 The purchaser is responsible for any penalties or interest payable to the Commissioner on account of non-payment or late payment of the amount, except to the extent that:
- (a) the penalties or interest arise from any failure on the part of the vendor, including breach of a warranty in general condition 25.11; or
 - (b) the purchaser has a reasonable belief that the property is neither new residential premises nor potential residential land requiring the purchaser to pay an amount to the Commissioner in accordance with section 14-250 (1) of Schedule 1 to the *Taxation Administration Act 1953* (Cth).
- The vendor is responsible for any penalties or interest payable to the Commissioner on account of non-payment or late payment of the amount if either exception applies.
-

Transactional

26. TIME & CO OPERATION

- 26.1 Time is of the essence of this contract.
- 26.2 Time is extended until the next business day if the time for performing any action falls on a day which is not a business day.
- 26.3 Each party must do all things reasonably necessary to enable this contract to proceed to settlement, and must act in a prompt and efficient manner.
- 26.4 Any unfulfilled obligation will not merge on settlement.

27. SERVICE

- 27.1 Any document required to be served by or on any party may be served by or on the legal practitioner or conveyancer for that party.
- 27.2 A cooling off notice under section 31 of the *Sale of Land Act 1962* or a notice under general condition 20 [loan approval], 21 [building report] or 22 [pest report] may be served on the vendor's legal practitioner, conveyancer or estate agent even if the estate agent's authority has formally expired at the time of service.
- 27.3 A document is sufficiently served:
 - (a) personally, or
 - (b) by pre-paid post, or
 - (c) in any manner authorized by law or by the Supreme Court for service of documents, including any manner authorised for service on or by a legal practitioner, whether or not the person serving or receiving the document is a legal practitioner, or
 - (d) by email.
- 27.4 Any document properly sent by:
 - (a) express post is taken to have been served on the next business day after posting, unless proved otherwise;
 - (b) priority post is taken to have been served on the fourth business day after posting, unless proved otherwise;
 - (c) regular post is taken to have been served on the sixth business day after posting, unless proved otherwise;
 - (d) email is taken to have been served at the time of receipt within the meaning of section 13A of the *Electronic Transactions (Victoria) Act 2000*.
- 27.5 In this contract 'document' includes 'demand' and 'notice', 'serve' includes 'give', and 'served' and 'service' have corresponding meanings.

28. NOTICES

- 28.1 The vendor is responsible for any notice, order, demand or levy imposing liability on the property that is issued or made before the day of sale, and does not relate to periodic outgoings.
- 28.2 The purchaser is responsible for any notice, order, demand or levy imposing liability on the property that is issued or made on or after the day of sale, and does not relate to periodic outgoings.
- 28.3 The purchaser may enter the property to comply with that responsibility where action is required before settlement.

29. INSPECTION

The purchaser and/or another person authorised by the purchaser may inspect the property at any reasonable time during the 7 days preceding and including the settlement day.

30. TERMS CONTRACT

- 30.1 If this is a 'terms contract' as defined in the *Sale of Land Act 1962*:
 - (a) any mortgage affecting the land sold must be discharged as to that land before the purchaser becomes entitled to possession or to the receipt of rents and profits unless the vendor satisfies section 29M of the *Sale of Land Act 1962*; and
 - (b) the deposit and all other money payable under the contract (other than any money payable in excess of the amount required to so discharge the mortgage) must be paid to a legal practitioner or conveyancer or a licensed estate agent to be applied in or towards discharging the mortgage.
- 30.2 While any money remains owing each of the following applies:
 - (a) the purchaser must maintain full damage and destruction insurance of the property and public risk insurance noting all parties having an insurable interest with an insurer approved in writing by the vendor;
 - (b) the purchaser must deliver copies of the signed insurance application forms, the policies and the insurance receipts to the vendor not less than 10 days before taking possession of the property or becoming entitled to receipt of the rents and profits;
 - (c) the purchaser must deliver copies of any amendments to the policies and the insurance receipts on each amendment or renewal as evidence of the status of the policies from time to time;
 - (d) the vendor may pay any renewal premiums or take out the insurance if the purchaser fails to meet these obligations;
 - (e) insurance costs paid by the vendor under paragraph (d) must be refunded by the purchaser on demand without affecting the vendor's other rights under this contract;
 - (f) the purchaser must maintain and operate the property in good repair (fair wear and tear excepted) and keep the property safe, lawful, structurally sound, weatherproof and free from contaminations and dangerous substances;
 - (g) the property must not be altered in any way without the written consent of the vendor which must not be unreasonably refused or delayed;
 - (h) the purchaser must observe all obligations that affect owners or occupiers of land;
 - (i) the vendor and/or other person authorised by the vendor may enter the property at any reasonable time to inspect it on giving 7 days written notice, but not more than twice in a year.

31. LOSS OR DAMAGE BEFORE SETTLEMENT

- 31.1 The vendor carries the risk of loss or damage to the property until settlement.
- 31.2 The vendor must deliver the property to the purchaser at settlement in the same condition it was in on the day of sale, except for fair wear and tear.
- 31.3 The purchaser must not delay settlement because one or more of the goods is not in the condition required by general condition 31.2, but may claim compensation from the vendor after settlement.
- 31.4 The purchaser may nominate an amount not exceeding \$5,000 to be held by a stakeholder to be appointed by the parties if the property is not in the condition required by general condition 31.2 at settlement.
- 31.5 The nominated amount may be deducted from the amount due to the vendor at settlement and paid to the stakeholder, but only if the purchaser also pays an amount equal to the nominated amount to the stakeholder.
- 31.6 The stakeholder must pay the amounts referred to in general condition 31.5 in accordance with the determination of the dispute, including any order for payment of the costs of the resolution of the dispute.

32. BREACH

A party who breaches this contract must pay to the other party on demand:

- (a) compensation for any reasonably foreseeable loss to the other party resulting from the breach; and
 - (b) any interest due under this contract as a result of the breach.
-

Default

33. INTEREST

Interest at a rate of 2% per annum plus the rate for the time being fixed by section 2 of the *Penalty Interest Rates Act 1983* is payable at settlement on any money owing under the contract during the period of default, without affecting any other rights of the offended party.

34. DEFAULT NOTICE

34.1 A party is not entitled to exercise any rights arising from the other party's default, other than the right to receive interest and the right to sue for money owing, until the other party is given and fails to comply with a written default notice.

34.2 The default notice must:

- (a) specify the particulars of the default; and
- (b) state that it is the offended party's intention to exercise the rights arising from the default unless, within 14 days of the notice being given -
 - (i) the default is remedied; and
 - (ii) the reasonable costs incurred as a result of the default and any interest payable are paid.

35. DEFAULT NOT REMEDIED

35.1 All unpaid money under the contract becomes immediately payable to the vendor if the default has been made by the purchaser and is not remedied and the costs and interest are not paid.

35.2 The contract immediately ends if:

- (a) the default notice also states that unless the default is remedied and the reasonable costs and interest are paid, the contract will be ended in accordance with this general condition; and
- (b) the default is not remedied and the reasonable costs and interest are not paid by the end of the period of the default notice.

35.3 If the contract ends by a default notice given by the purchaser:

- (a) the purchaser must be repaid any money paid under the contract and be paid any interest and reasonable costs payable under the contract; and
- (b) all those amounts are a charge on the land until payment; and
- (c) the purchaser may also recover any loss otherwise recoverable.

35.4 If the contract ends by a default notice given by the vendor:

- (a) the deposit up to 10% of the price is forfeited to the vendor as the vendor's absolute property, whether the deposit has been paid or not; and
- (b) the vendor is entitled to possession of the property; and
- (c) in addition to any other remedy, the vendor may within one year of the contract ending either:
 - (i) retain the property and sue for damages for breach of contract; or
 - (ii) resell the property in any manner and recover any deficiency in the price on the resale and any resulting expenses by way of liquidated damages; and
- (d) the vendor may retain any part of the price paid until the vendor's damages have been determined and may apply that money towards those damages; and
- (e) any determination of the vendor's damages must take into account the amount forfeited to the vendor.

35.5 The ending of the contract does not affect the rights of the offended party as a consequence of the default.

ANNEXURE "A"

GUARANTEE AND INDEMNITY

THIS DEED OF GUARANTEE AND INDEMNITY ("Guarantee") is made the Date of Guarantee and Indemnity detailed in the Schedule hereto

BY: The Guarantors detailed in the Schedule hereto (hereinafter referred to as "the Guarantor")

IN CONSIDERATION of the Vendor detailed in the Schedule hereto (the "Vendor") at our request having agreed to enter into the Contract detailed in in the Schedule hereto with the Purchaser detailed in the Schedule hereto for the sale of the Property detailed in the Schedule hereto and for the Price and upon the conditions specified in the within Contract, we the Guarantor on behalf of ourselves and our respective executors and administrators HEREBY jointly and severally agree to GUARANTEE AND INDEMNIFY the Vendor as follows:

1. the Guarantor GUARANTEES to the Vendor that the Purchaser will perform all of the obligations of the Purchaser under the Contract, including payment of the Purchase Price ("Price"), interest and all other monies;
2. the Guarantor shall pay to the Vendor on demand by the Vendor all monies payable pursuant to the Contract which are not paid by the Purchaser pursuant to the Contract whether demand for the same has been made by the Vendor on the Purchaser or not;
3. the Guarantor shall observe and perform on demand by the Vendor all of the covenants conditions obligations and liabilities binding the Purchaser which the Purchaser does not comply whether demand for such observance or performance has been made by the Vendor on the Purchaser or not;
4. the Guarantor INDEMNIFIES and agree to keep indemnified the Vendor against all loss of Purchase Price ("Price") or purchase money interest and other monies payable under the within Contract and all losses costs charges and expenses whatsoever which the Vendor may incur by reason of any default on the part of the Purchaser under the Contract (including but not limited to, the Purchaser having exceeded the powers of the Purchaser or being incompetent to enter into the Contract or going into liquidation);
5. the Guarantor ACKNOWLEDGES AND AGREES that this Guarantee and Indemnity shall be a continuing Guarantee and Indemnity and shall not be released or affected by any neglect or indulgence shown or any extension granted by the Vendor in enforcing the Contract, nor by any alteration made by the Vendor and the Purchaser (in the terms and conditions of the Contract), nor by any part payment or part performance under the Contract, nor by reason of the Vendor assigning its rights under the Contract, or by any other thing which under the law relating to sureties which would but for this provision have the effect of releasing the Guarantor.
6. ANY demand or notice to be made upon the Guarantor by or on behalf of the Vendor pursuant to this Guarantee shall be deemed to be duly made if the same be in writing and executed by the Vendor or by the Solicitor of the Vendor or by any person duly authorised by the Vendor to make such demand on his behalf and the same may be left at or sent through the post in a prepaid registered letter addressed to the Guarantor at his address hereinbefore specified or be delivered personally to the Guarantor.
7. Without limiting any other term or condition of this Deed, a judgment entered by the Vendor against the Purchaser is conclusive evidence of an amount owing by a Guarantor under this guarantee and indemnity and in the case of such judgment having been entered against the Purchaser, then the Vendor in any proceedings issued against a Guarantor, does not have to prove the amounts owing under this guarantee and indemnity and is entitled to rely (without having to prove the same) on the judgment sum made against the Purchaser.

SCHEDULE

Date of Guarantee and Indemnity:

Guarantor:

..... of

..... of

Vendor: MAQUILE WILLIAMS OCTAVIANO and FRANCIS ANGELO DE LEON PAMPOLINA

Purchaser:

Contract: made between the Vendor and Purchaser dated

Property: 6 Marilyn Close, Corio VIC 3214

EXECUTED AS A DEED:

SIGNED SEALED AND DELIVERED)
by the said)
in the presence of:)

.....
Witness sign
Print Name:
Print Address:

SIGNED SEALED AND DELIVERED)
by the said)
in the presence of:)

.....
Witness sign
Print Name:
Print Address:

Vendor Statement

The vendor makes this statement in respect of the land in accordance with section 32 of the *Sale of Land Act* 1962.

This statement must be signed by the vendor and given to the purchaser before the purchaser signs the contract.
The vendor may sign by electronic signature.

The purchaser acknowledges being given this statement signed by the vendor with the attached documents before the purchaser signed any contract.

Land	6 MARILYN CLOSE, CORIO VIC 3214
-------------	---------------------------------

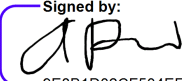
Vendor's name	MAQUILE WILLIAMS OCTAVIANO	Date	/ /
Vendor's signature	 Signed by: 990557BEDB85407...	16/6/2026	
Vendor's name	FRANCIS ANGELO DE LEON PAMPOLINA	Date	/ /
Vendor's signature	 Signed by: 9E8B1D02CF504EE...	16/6/2026	

Purchaser's name		Date	/ /
Purchaser's signature	_____		
Purchaser's name		Date	/ /
Purchaser's signature	_____		

1. FINANCIAL MATTERS

1.1 Particulars of any Rates, Taxes, Charges or Other Similar Outgoings (and any interest on them)

(a) Are contained in the attached certificate/s.

1.2 Particulars of any Charge (whether registered or not) imposed by or under any Act to secure an amount due under that Act, including the amount owing under the charge

\$0.00	To	
--------	----	--

Other particulars (including dates and times of payments):
--

1.3 Terms Contract

This section 1.3 only applies if this vendor statement is in respect of a terms contract where the purchaser is obliged to make 2 or more payments (other than a deposit or final payment) to the vendor after the execution of the contract and before the purchaser is entitled to a conveyance or transfer of the land.

Not Applicable

1.4 Sale Subject to Mortgage

This section 1.4 only applies if this vendor statement is in respect of a contract which provides that any mortgage (whether registered or unregistered), is NOT to be discharged before the purchaser becomes entitled to possession or receipts of rents and profits.

Not Applicable

1.5 Commercial and Industrial Property Tax Reform Act 2024 (Vic) (CIPT Act)

(a) The Australian Valuation Property Classification Code (within the meaning of the CIPT Act) most recently allocated to the land is set out in the attached Municipal rates notice or property clearance certificate or is as follows	AVPC No.
(b) Is the land tax reform scheme land within the meaning of the CIPT Act?	<input type="checkbox"/> YES <input checked="" type="checkbox"/> NO
(c) If the land is tax reform scheme land within the meaning of the CIPT Act, the entry date within the meaning of the CIPT Act is set out in the attached Municipal rates notice or property clearance certificate or is as follows	Date: OR <input checked="" type="checkbox"/> Not applicable

2. INSURANCE

2.1 Damage and Destruction

This section 2.1 only applies if this vendor statement is in respect of a contract which does NOT provide for the land to remain at the risk of the vendor until the purchaser becomes entitled to possession or receipt of rents and profits.

Not Applicable

2.2 Owner Builder

This section 2.2 only applies where there is a residence on the land that was constructed by an owner-builder within the preceding 6 years and section 137B of the Building Act 1993 applies to the residence.

Not Applicable

3. LAND USE

3.1 Easements, Covenants or Other Similar Restrictions

(a) A description of any easement, covenant or other similar restriction affecting the land (whether registered or unregistered):

Is in the attached copies of title document/s

(b) Particulars of any existing failure to comply with that easement, covenant or other similar restriction are:

To the best of the Vendor's knowledge there is no existing failure to comply with the terms of any easements, covenants or other similar restriction.

3.2 Road Access

There is NO access to the property by road if the square box is marked with an 'X'

3.3 Designated Bushfire Prone Area

The land is in a designated bushfire prone area within the meaning of section 192A of the *Building Act* 1993 if the square box is marked with an 'X'

3.4 Planning Scheme

Attached is a certificate with the required specified information.

4. NOTICES

4.1 Notice, Order, Declaration, Report or Recommendation

Particulars of any notice, order, declaration, report or recommendation of a public authority or government department or approved proposal directly and currently affecting the land, being a notice, order, declaration, report, recommendation or approved proposal of which the vendor might reasonably be expected to have knowledge:

Not Applicable

4.2 Agricultural Chemicals

There are NO notices, property management plans, reports or orders in respect of the land issued by a government department or public authority in relation to livestock disease or contamination by agricultural chemicals affecting the ongoing use of the land for agricultural purposes. However, if this is not the case, the details of any such notices, property management plans, reports or orders, are as follows:

NIL

4.3 Compulsory Acquisition

The particulars of any notices of intention to acquire that have been served under section 6 of the *Land Acquisition and Compensation Act* 1986 are as follows:

NIL

5. BUILDING PERMITS

Particulars of any building permit issued under the *Building Act* 1993 in the preceding 7 years (required only where there is a residence on the land):

Not Applicable

6. OWNERS CORPORATION

This section 6 only applies if the land is affected by an owners corporation within the meaning of the *Owners Corporations Act* 2006.

Not Applicable

7. GROWTH AREAS INFRASTRUCTURE CONTRIBUTION (“GAIC”)

Words and expressions in this section 7 have the same meaning as in Part 9B of the *Planning and Environment Act* 1987.

Not Applicable

8. SERVICES

The services which are marked with an 'X' in the accompanying square box are NOT connected to the land:

Electricity supply <input type="checkbox"/>	Gas supply <input type="checkbox"/>	Water supply <input type="checkbox"/>	Sewerage <input type="checkbox"/>	Telephone services <input checked="" type="checkbox"/>
---	-------------------------------------	---------------------------------------	-----------------------------------	--

9. TITLE

Attached are copies of the following documents:

9.1 (a) Registered Title

A Register Search Statement and the document, or part of a document, referred to as the 'diagram location' in that statement which identifies the land and its location.

10. SUBDIVISION

10.1 Unregistered Subdivision

This section 10.1 only applies if the land is subject to a subdivision which is not registered.

Not Applicable

10.2 Staged Subdivision

This section 10.2 only applies if the land is part of a staged subdivision within the meaning of section 37 of the *Subdivision Act 1988*.

(a) Attached is a copy of the plan for the first stage if the land is in the second or subsequent stage.

(b) The requirements in a statement of compliance relating to the stage in which the land is included that have Not been complied With are As follows:

NIL

(c) The proposals relating to subsequent stages that are known to the vendor are as follows:

NIL

(d) The contents of any permit under the Planning and Environment Act 1987 authorising the staged subdivision are:

NIL

10.3 Further Plan of Subdivision

This section 10.3 only applies if the land is subject to a subdivision in respect of which a further plan within the meaning of the *Subdivision Act 1988* is proposed.

Not Applicable

11. DISCLOSURE OF ENERGY INFORMATION

(Disclosure of this information is not required under section 32 of the Sale of Land Act 1962 but may be included in this vendor statement for convenience.)

Details of any energy efficiency information required to be disclosed regarding a disclosure affected building or disclosure area affected area of a building as defined by the *Building Energy Efficiency Disclosure Act 2010* (Cth)

(a) to be a building or part of a building used or capable of being used as an office for administrative, clerical, professional or similar based activities including any support facilities; and

(b) which has a net lettable area of at least 1000m²; (but does not include a building under a strata title system or if an occupancy permit was issued less than 2 years before the relevant date):

Not Applicable

12. DUE DILIGENCE CHECKLIST

(The Sale of Land Act 1962 provides that the vendor or the vendor's licensed estate agent must make a prescribed due diligence checklist available to purchasers before offering land for sale that is vacant residential land or land on which there is a residence. The due diligence checklist is NOT required to be provided with, or attached to, this vendor statement but the checklist may be attached as a matter of convenience.)

Is attached

13. ATTACHMENTS

(Any certificates, documents and other attachments may be annexed to this section 13)

(Additional information may be added to this section 13 where there is insufficient space in any of the earlier sections)

(Attached is an "Additional Vendor Statement" if section 1.3 (Terms Contract) or section 1.4 (Sale Subject to Mortgage) applies)

Due diligence checklist

What you need to know before buying a residential property

Before you buy a home, you should be aware of a range of issues that may affect that property and impose restrictions or obligations on you, if you buy it. This checklist aims to help you identify whether any of these issues will affect you. The questions are a starting point only and you may need to seek professional advice to answer some of them. You can find links to organisations and web pages that can help you learn more, by visiting the [Due diligence checklist page on the Consumer Affairs Victoria website](https://consumer.vic.gov.au/duediligencechecklist) (consumer.vic.gov.au/duediligencechecklist).

Urban living

Moving to the inner city?

High density areas are attractive for their entertainment and service areas, but these activities create increased traffic as well as noise and odours from businesses and people. Familiarising yourself with the character of the area will give you a balanced understanding of what to expect.

Is the property subject to an owners corporation?

If the property is part of a subdivision with common property such as driveways or grounds, it may be subject to an owners corporation. You may be required to pay fees and follow rules that restrict what you can do on your property, such as a ban on pet ownership.

Growth areas

Are you moving to a growth area?

You should investigate whether you will be required to pay a growth areas infrastructure contribution.

Flood and fire risk

Does this property experience flooding or bushfire?

Properties are sometimes subject to the risk of fire and flooding due to their location. You should properly investigate these risks and consider their implications for land management, buildings and insurance premiums.

Rural properties

Moving to the country?

If you are looking at property in a rural zone, consider:

- Is the surrounding land use compatible with your lifestyle expectations? Farming can create noise or odour that may be at odds with your expectations of a rural lifestyle.
- Are you considering removing native vegetation? There are regulations which affect your ability to remove native vegetation on private property.
- Do you understand your obligations to manage weeds and pest animals?

Can you build new dwellings?

Does the property adjoin crown land, have a water frontage, contain a disused government road, or are there any crown licences associated with the land?

Is there any earth resource activity such as mining in the area?

You may wish to find out more about exploration, mining and quarrying activity on or near the property and consider the issue of petroleum, geothermal and greenhouse gas sequestration permits, leases and licences, extractive industry authorisations and mineral licences.

Soil and groundwater contamination

Has previous land use affected the soil or groundwater?

You should consider whether past activities, including the use of adjacent land, may have caused contamination at the site and whether this may prevent you from doing certain things to or on the land in the future.

Land boundaries

Do you know the exact boundary of the property?

You should compare the measurements shown on the title document with actual fences and buildings on the property, to make sure the boundaries match. If you have concerns about this, you can speak to your lawyer or conveyancer, or commission a site survey to establish property boundaries.

Planning controls

Can you change how the property is used, or the buildings on it?

All land is subject to a planning scheme, run by the local council. How the property is zoned and any overlays that may apply, will determine how the land can be used. This may restrict such things as whether you can build on vacant land or how you can alter or develop the land and its buildings over time.

The local council can give you advice about the planning scheme, as well as details of any other restrictions that may apply, such as design guidelines or bushfire safety design. There may also be restrictions – known as encumbrances – on the property's title, which prevent you from developing the property. You can find out about encumbrances by looking at the section 32 statement.

Are there any proposed or granted planning permits?

The local council can advise you if there are any proposed or issued planning permits for any properties close by. Significant developments in your area may change the local 'character' (predominant style of the area) and may increase noise or traffic near the property.

Safety

Is the building safe to live in?

Building laws are in place to ensure building safety. Professional building inspections can help you assess the property for electrical safety, possible illegal building work, adequate pool or spa fencing and the presence of asbestos, termites, or other potential hazards.

Building permits

Have any buildings or retaining walls on the property been altered, or do you plan to alter them?

There are laws and regulations about how buildings and retaining walls are constructed, which you may wish to investigate to ensure any completed or proposed building work is approved. The local council may be able to give you information about any building permits issued for recent building works done to the property, and what you must do to plan new work. You can also commission a private building surveyor's assessment.

Are any recent building or renovation works covered by insurance?

Ask the vendor if there is any owner-builder insurance or builder's warranty to cover defects in the work done to the property.

Utilities and essential services

Does the property have working connections for water, sewerage, electricity, gas, telephone and internet?

Unconnected services may not be available, or may incur a fee to connect. You may also need to choose from a range of suppliers for these services. This may be particularly important in rural areas where some services are not available.

Buyers' rights

Do you know your rights when buying a property?

The contract of sale and section 32 statement contain important information about the property, so you should request to see these and read them thoroughly. Many people engage a lawyer or conveyancer to help them understand the contracts and ensure the sale goes through correctly. If you intend to hire a professional, you should consider speaking to them before you commit to the sale. There are also important rules about the way private sales and auctions are conducted. These may include a cooling-off period and specific rights associated with 'off the plan' sales. The important thing to remember is that, as the buyer, you have rights.



Copyright State of Victoria. No part of this publication may be reproduced except as permitted by the Copyright Act 1968 (Cth), to comply with a statutory requirement or pursuant to a written agreement. The information is only valid at the time and in the form obtained from the LANDATA REGD TM System. None of the State of Victoria, its agents or contractors, accepts responsibility for any subsequent publication or reproduction of the information.

The Victorian Government acknowledges the Traditional Owners of Victoria and pays respects to their ongoing connection to their Country, History and Culture. The Victorian Government extends this respect to their Elders, past, present and emerging.

**REGISTER SEARCH STATEMENT (Title Search) Transfer of
Land Act 1958**

VOLUME 08989 FOLIO 944

Security no : 124135585702Q
Produced 16/06/2026 01:42 PM

LAND DESCRIPTION

Lot 1 on Title Plan 521729B.
PARENT TITLE Volume 07336 Folio 147
Created by instrument E922654 31/07/1973

REGISTERED PROPRIETOR

Estate Fee Simple
Joint Proprietors
FRANCIS ANGELO DE LEON PAMPOLINA
MAQUILE WILLIAMS OCTAVIANO both of 22 BARCELONA AVENUE CLYDE NORTH VIC 3978
AY488650D 11/10/2024

ENCUMBRANCES, CAVEATS AND NOTICES

MORTGAGE AY488651B 11/10/2024
PEPPER FINANCE CORPORATION LTD

Any encumbrances created by Section 98 Transfer of Land Act 1958 or Section 24 Subdivision Act 1988 and any other encumbrances shown or entered on the plan set out under DIAGRAM LOCATION below.

DIAGRAM LOCATION

SEE TP521729B FOR FURTHER DETAILS AND BOUNDARIES

ACTIVITY IN THE LAST 125 DAYS

NIL

-----END OF REGISTER SEARCH STATEMENT-----

Additional information: (not part of the Register Search Statement)

Street Address: 6 MARILYN CLOSE CORIO VIC 3214

ADMINISTRATIVE NOTICES

NIL

eCT Control 18478R FIRST LEGAL
Effective from 11/10/2024

DOCUMENT END



Imaged Document Cover Sheet

The document following this cover sheet is an imaged document supplied by LANDATA®, Secure Electronic Registries Victoria.

Document Type	Plan
Document Identification	TP521729B
Number of Pages (excluding this cover sheet)	1
Document Assembled	16/06/2026 13:42

Copyright and disclaimer notice:

© State of Victoria. This publication is copyright. No part may be reproduced by any process except in accordance with the provisions of the Copyright Act 1968 (Cth) and for the purposes of Section 32 of the Sale of Land Act 1962 or pursuant to a written agreement. The information is only valid at the time and in the form obtained from the LANDATA® System. None of the State of Victoria, LANDATA®, Secure Electronic Registries Victoria Pty Ltd (ABN 86 627 986 396) as trustee for the Secure Electronic Registries Victoria Trust (ABN 83 206 746 897) accept responsibility for any subsequent release, publication or reproduction of the information.

The document is invalid if this cover sheet is removed or altered.

TITLE PLAN	EDITION 1	TP 521729B
Location of Land Parish: MOORPANYAL Township: Section: Crown Allotment: Crown Portion: Last Plan Reference: LP12935 Derived From: VOL 8989 FOL 944 Depth Limitation: NIL		Notations ANY REFERENCE TO MAP IN THE TEXT MEANS THE DIAGRAM SHOWN ON THIS TITLE PLAN

Description of Land / Easement Information

ENCUMBRANCES REFERRED TO

As to the land coloured blue - - -
THE EASEMENTS (if any) existing -
 over the same by virtue of Section
 98 of the Transfer of Land Act - -

THIS PLAN HAS BEEN PREPARED FOR THE LAND REGISTRY, LAND VICTORIA, FOR TITLE DIAGRAM PURPOSES AS PART OF THE LAND TITLES AUTOMATION PROJECT
 COMPILED: 17/11/2003
 VERIFIED: CL

COLOUR CODE
 BL=BLUE

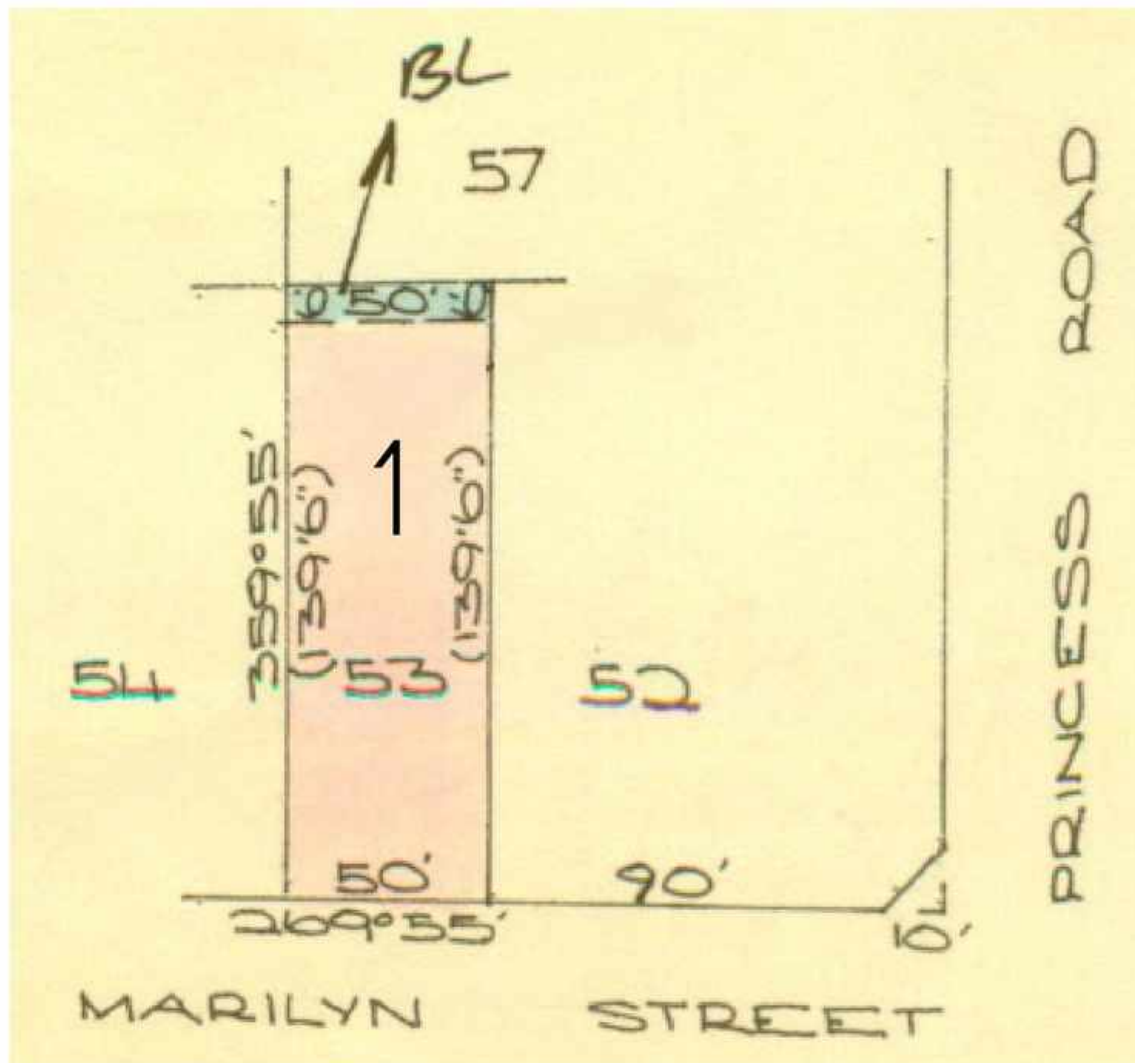

TABLE OF PARCEL IDENTIFIERS

WARNING: Where multiple parcels are referred to or shown on this Title Plan this does not imply separately disposable parcels under Section 8A of the Sale of Land Act 1962

PARCEL 1 = LOT 53 ON LP12935

Property Clearance Certificate

Land Tax



STAR PROPERTY CONVEYANCING

Your Reference:	SPC832
Certificate No:	10085827
Issue Date:	16 JUN 2026
Enquiries:	ESYSPROD

Land Address: 6 MARILYN CLOSE CORIO VIC 3214

Land Id	Lot	Plan	Volume	Folio	Tax Payable
7220378	1	521729	8989	944	\$1,530.00

Vendor: MAQUILE OCTAVIANO & FRANCIS ANGELO PAMPOLINA
Purchaser: FOR INFORMATION PURPOSES

Current Land Tax	Year Taxable Value (SV)	Proportional Tax	Penalty/Interest	Total
MRS MAQUILE WILLIAMS OCTAVIANO	2026	\$360,000	\$1,530.00	\$1,530.00

Comments: Land Tax will be payable but is not yet due - please see notes on reverse.

Current Vacant Residential Land Tax	Year Taxable Value (CIV)	Tax Liability	Penalty/Interest	Total

Comments:

Arrears of Land Tax	Year	Proportional Tax	Penalty/Interest	Total

Arrears of Vacant Residential Land Tax	Year	Proportional Tax	Penalty/Interest	Total

This certificate is subject to the notes that appear on the reverse. The applicant should read these notes carefully.

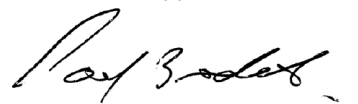
Paul Broderick
 Commissioner of State Revenue

CAPITAL IMPROVED VALUE (CIV):	\$450,000
SITE VALUE (SV):	\$360,000
CURRENT LAND TAX AND VACANT RESIDENTIAL LAND TAX CHARGE:	\$1,530.00



Notes to Certificate - Land Tax

Certificate No: 10085827

Power to issue Certificate

1. Pursuant to section 95AA of the *Taxation Administration Act 1997*, the Commissioner of State Revenue must issue a Property Clearance Certificate (Certificate) to an owner, mortgagee or bona fide purchaser of land who makes an application specifying the land for which the Certificate is sought and pays the application fee.

Amount shown on Certificate

2. The Certificate shows any land tax (including Vacant Residential Land Tax, interest and penalty tax) that is due and unpaid on the land described in the Certificate at the date of issue. In addition, it may show:
 - Land tax that has been assessed but is not yet due,
 - Land tax for the current tax year that has not yet been assessed, and
 - Any other information that the Commissioner sees fit to include, such as the amount of land tax applicable to the land on a single holding basis and other debts with respect to the property payable to the Commissioner.

Land tax is a first charge on land

3. Unpaid land tax (including Vacant Residential Land Tax, interest and penalty tax) is a first charge on the land to which it relates. This means it has priority over any other encumbrances on the land, such as a mortgage, and will continue as a charge even if ownership of the land is transferred. Therefore, a purchaser may become liable for any such unpaid land tax.

Information for the purchaser

4. Pursuant to section 96 of the *Land Tax Act 2005*, if a purchaser of the land described in the Certificate has applied for and obtained a certificate, the amount recoverable from the purchaser by the Commissioner cannot exceed the amount set out in the certificate, described as the "Current Land Tax Charge and Vacant Residential Land Tax Charge" overleaf. A purchaser cannot rely on a Certificate obtained by the vendor.

Information for the vendor

5. Despite the issue of a Certificate, the Commissioner may recover a land tax liability from a vendor, including any amount identified on this Certificate.

Apportioning or passing on land tax to a purchaser

6. A vendor is prohibited from apportioning or passing on land tax including vacant residential land tax, interest and penalty tax to a purchaser under a contract of sale of land entered into on or after 1 January 2024, where the purchase price is less than \$10 million (to be indexed annually from 1 January 2025, as set out on the website for Consumer Affairs Victoria).

General information

7. A Certificate showing no liability for the land does not mean that the land is exempt from land tax. It means that there is nothing to pay at the date of the Certificate.
8. An updated Certificate may be requested free of charge via our website, if:
 - The request is within 90 days of the original Certificate's issue date, and
 - There is no change to the parties involved in the transaction for which the Certificate was originally requested.

For Information Only

LAND TAX CALCULATION BASED ON SINGLE OWNERSHIP

Land Tax = \$1,530.00

Taxable Value = \$360,000

Calculated as \$1,350 plus (\$360,000 - \$300,000) multiplied by 0.300 cents.

VACANT RESIDENTIAL LAND TAX CALCULATION

Vacant Residential Land Tax = \$4,500.00

Taxable Value = \$450,000

Calculated as \$450,000 multiplied by 1.000%.

Land Tax - Payment Options

BPAY



Biller Code: 5249
Ref: 10085827

Telephone & Internet Banking - BPAY®

Contact your bank or financial institution to make this payment from your cheque, savings, debit or transaction account.

www.bpay.com.au

CARD



Ref: 10085827

Visa or Mastercard

Pay via our website or phone 13 21 61. A card payment fee applies.

sro.vic.gov.au/paylandtax

Property Clearance Certificate

Commercial and Industrial Property Tax



STAR PROPERTY CONVEYANCING

Your Reference:	SPC832
Certificate No:	10085827
Issue Date:	16 JUN 2026
Enquires:	ESYSPROD

Land Address: 6 MARILYN CLOSE CORIO VIC 3214

Land Id	Lot	Plan	Volume	Folio	Tax Payable
7220378	1	521729	8989	944	\$0.00
AVPCC	Date of entry into reform	Entry interest	Date land becomes CIPT taxable land	Comment	
110	N/A	N/A	N/A	The AVPCC allocated to the land is not a qualifying use.	

This certificate is subject to the notes found on the reverse of this page. The applicant should read these notes carefully.

Paul Broderick
Commissioner of State Revenue

CAPITAL IMPROVED VALUE:	\$450,000
SITE VALUE:	\$360,000
CURRENT CIPT CHARGE:	\$0.00



Notes to Certificate - Commercial and Industrial Property Tax

Certificate No: 10085827

Power to issue Certificate

1. Pursuant to section 95AA of the *Taxation Administration Act 1997*, the Commissioner of State Revenue must issue a Property Clearance Certificate (Certificate) to an owner, mortgagee or bona fide purchaser of land who makes an application specifying the land for which the Certificate is sought and pays the application fee.

Amount shown on Certificate

2. The Certificate shows any commercial and industrial property tax (including interest and penalty tax) that is due and unpaid on the land described in the Certificate at the date of issue.

Australian Valuation Property Classification Code (AVPCC)

3. The Certificate may show one or more AVPCC in respect of land described in the Certificate. The AVPCC shown on the Certificate is the AVPCC allocated to the land in the most recent of the following valuation(s) of the land under the *Valuation of Land Act 1960*:
 - a general valuation of the land;
 - a supplementary valuation of the land returned after the general valuation.
4. The AVPCC(s) shown in respect of land described on the Certificate can be relevant to determine if the land has a qualifying use, within the meaning given by section 4 of the *Commercial and Industrial Property Tax Reform Act 2024* (CIPT Act). Section 4 of the CIPT Act Land provides that land will have a qualifying use if:
 - the land has been allocated one, or more than one, AVPCC in the latest valuation, all of which are in the range 200-499 and/or 600-699 in the Valuation Best Practice Specifications Guidelines (the requisite range);
 - the land has been allocated more than one AVPCC in the latest valuation, one or more of which are inside the requisite range and one or more of which are outside the requisite range, and the land is used solely or primarily for a use described in an AVPCC in the requisite range; or
 - the land is used solely or primarily as eligible student accommodation, within the meaning of section 3 of the CIPT Act.

Commercial and industrial property tax information

5. If the Commissioner has identified that land described in the Certificate is tax reform scheme land within the meaning given by section 3 of the CIPT Act, the Certificate may show in respect of the land:
 - the date on which the land became tax reform scheme land;
 - whether the entry interest (within the meaning given by section 3 of the Duties Act 2000) in relation to the tax reform scheme land was a 100% interest (a whole interest) or an interest of less than 100% (a partial interest); and
 - the date on which the land will become subject to the commercial and industrial property tax.
6. A Certificate that does not show any of the above information in respect of land described in the Certificate does not mean that the land is not tax reform scheme land. It means that the Commissioner has not identified that the land is tax reform scheme land at the date of issue of the Certificate. The Commissioner may identify that the land is tax reform scheme land after the date of issue of the Certificate.

Change of use of tax reform scheme land

7. Pursuant to section 34 of the CIPT Act, an owner of tax reform scheme land must notify the Commissioner of certain changes of use of tax reform scheme land (or part of the land) including if the actual use of the land changes to a use not described in any AVPCC in the range 200-499 and/or 600-699. The notification

must be given to the Commissioner within 30 days of the change of use.

Commercial and industrial property tax is a first charge on land

8. Commercial and industrial property tax (including any interest and penalty tax) is a first charge on the land to which the commercial and industrial property tax is payable. This means it has priority over any other encumbrances on the land, such as a mortgage, and will continue as a charge even if ownership of the land is transferred. Therefore, a purchaser may become liable for any unpaid commercial and industrial property tax.

Information for the purchaser

9. Pursuant to section 27 of the CIPT Act, if a bona fide purchaser for value of the land described in the Certificate applies for and obtains a Certificate in respect of the land, the maximum amount recoverable from the purchaser is the amount set out in the Certificate. A purchaser cannot rely on a Certificate obtained by the vendor.

Information for the vendor

10. Despite the issue of a Certificate, the Commissioner may recover a commercial and industrial property tax liability from a vendor, including any amount identified on this Certificate.

Passing on commercial and industrial property tax to a purchaser

11. A vendor is prohibited from apportioning or passing on commercial and industrial property tax to a purchaser under a contract of sale of land entered into on or after 1 July 2024 where the purchase price is less than \$10 million (to be indexed annually from 1 January 2025, as set out on the website for Consumer Affairs Victoria).

General information

12. Land enters the tax reform scheme if there is an entry transaction, entry consolidation or entry subdivision in respect of the land (within the meaning given to those terms in the CIPT Act). Land generally enters the reform on the date on which an entry transaction occurs in respect of the land (or the first date on which land from which the subject land was derived (by consolidation or subdivision) entered the reform).
13. The Duties Act includes exemptions from duty, in certain circumstances, for an eligible transaction (such as a transfer) of tax reform scheme land that has a qualifying use on the date of the transaction. The exemptions apply differently based on whether the entry interest in relation to the land was a whole interest or a partial interest. For more information, please refer to www.sro.vic.gov.au/CIPT.
14. A Certificate showing no liability for the land does not mean that the land is exempt from commercial and industrial property tax. It means that there is nothing to pay at the date of the Certificate.
15. An updated Certificate may be requested free of charge via our website, if:
 - the request is within 90 days of the original Certificate's issue date, and
 - there is no change to the parties involved in the transaction for which the Certificate was originally requested.

Property Clearance Certificate

Windfall Gains Tax



STAR PROPERTY CONVEYANCING

Your Reference:	SPC832
Certificate No:	10085827
Issue Date:	16 JUN 2026

Land Address: 6 MARILYN CLOSE CORIO VIC 3214

Lot	Plan	Volume	Folio
1	521729	8989	944

Vendor: MAQUILE OCTAVIANO & FRANCIS ANGELO PAMPOLINA

Purchaser: FOR INFORMATION PURPOSES

WGT Property Id	Event ID	Windfall Gains Tax	Deferred Interest	Penalty/Interest	Total
		\$0.00	\$0.00	\$0.00	\$0.00

Comments: No windfall gains tax liability identified.

This certificate is subject to the notes that appear on the reverse. The applicant should read these notes carefully.

CURRENT WINDFALL GAINS TAX CHARGE:
\$0.00

Paul Broderick
Commissioner of State Revenue

Notes to Certificate - Windfall Gains Tax

Certificate No: 10085827

Power to issue Certificate

1. Pursuant to section 95AA of the *Taxation Administration Act 1997*, the Commissioner of State Revenue must issue a Property Clearance Certificate (Certificate) to an owner, mortgagee or bona fide purchaser of land who makes an application specifying the land for which the Certificate is sought and pays the application fee.

Amount shown on Certificate

2. The Certificate shows in respect of the land described in the Certificate:
 - Windfall gains tax that is due and unpaid, including any penalty tax and interest
 - Windfall gains tax that is deferred, including any accrued deferral interest
 - Windfall gains tax that has been assessed but is not yet due
 - Windfall gains tax that has not yet been assessed (i.e. a WGT event has occurred that rezones the land but any windfall gains tax on the land is yet to be assessed)
 - Any other information that the Commissioner sees fit to include such as the amount of interest accruing per day in relation to any deferred windfall gains tax.

Windfall gains tax is a first charge on land

3. Pursuant to section 42 of the *Windfall Gains Tax Act 2021*, windfall gains tax, including any accrued interest on a deferral, is a first charge on the land to which it relates. This means it has priority over any other encumbrances on the land, such as a mortgage, and will continue as a charge even if ownership of the land is transferred. Therefore, a purchaser may become liable for any unpaid windfall gains tax.

Information for the purchaser

4. Pursuant to section 42 of the *Windfall Gains Tax Act 2021*, if a bona fide purchaser for value of land applies for and obtains a Certificate in respect of the land, the maximum amount recoverable from the purchaser by the Commissioner is the amount set out in the certificate, described as the "Current Windfall Gains Tax Charge" overleaf.
5. If the certificate states that a windfall gains tax is yet to be assessed, note 4 does not apply.
6. A purchaser cannot rely on a Certificate obtained by the vendor.

Information for the vendor

7. Despite the issue of a Certificate, the Commissioner may recover a windfall gains tax liability from a vendor, including any amount identified on this Certificate.



Passing on windfall gains tax to a purchaser

8. A vendor is prohibited from passing on a windfall gains tax liability to a purchaser where the liability has been assessed under a notice of assessment as at the date of the contract of sale of land or option agreement. This prohibition does not apply to a contract of sale entered into before 1 January 2024, or a contract of sale of land entered into on or after 1 January 2024 pursuant to the exercise of an option granted before 1 January 2024.

General information

9. A Certificate showing no liability for the land does not mean that the land is exempt from windfall gains tax. It means that there is nothing to pay at the date of the Certificate.
10. An updated Certificate may be requested free of charge via our website, if:
 - The request is within 90 days of the original Certificate's issue date, and
 - There is no change to the parties involved in the transaction for which the Certificate was originally requested.
11. Where a windfall gains tax liability has been deferred, interest accrues daily on the deferred liability. The deferred interest shown overleaf is the amount of interest accrued to the date of issue of the certificate.

Windfall Gains Tax - Payment Options

<p>BPAY</p>  <p>Billers Code: 416073 Ref: 10085827</p> <p>Telephone & Internet Banking - BPAY®</p> <p>Contact your bank or financial institution to make this payment from your cheque, savings, debit or transaction account.</p> <p>www.bpay.com.au</p>	<p>CARD</p>  <p>Ref: 10085827</p> <p>Visa or Mastercard</p> <p>Pay via our website or phone 13 21 61. A card payment fee applies.</p> <p>sro.vic.gov.au/payment-options</p>	<p>Important payment information</p> <p>Windfall gains tax payments must be made using only these specific payment references.</p> <p>Using the incorrect references for the different tax components listed on this property clearance certificate will result in misallocated payments.</p>
---	--	--

CITY OF GREATER GEELONG

WADAWURRUNG COUNTRY P: 03 5272 5272
 PO Box 104, Geelong VIC 3220 E: contactus@geelongcity.vic.gov.au
www.geelongaustralia.com.au

**2025-2026 LAND INFORMATION CERTIFICATE**

In accordance with Section 121 of the Local Government Act 2020

Date of Issue: **16-Jun-2026**

Certificate No: **248453**

Applicants Ref:

SPC832:227344

Assessment Number: **86247**

Property Address: **6 Marilyn Close, CORIO VIC 3214**

Property Description: **Lot 53 LP 12935**

AVPCC / Land Use: **110 - Detached Dwelling**

Applicant:

**Public
 City Hall
 30 Gheringhap Street
 GEELONG VIC 3220**

Operative Valuation Date:	01-Jul-2025
Level of Valuation Date:	01-Jan-2025
Capital Improved Value:	450,000
Site Value:	360,000
Net Annual Value:	22,500

This certificate provides information regarding Valuation, Rates, Charges, other monies owing and any orders and notices made under the Local Government Act 1958, Local Government Act 1989, Local Government Act 2020 or under a local law or By-Law of the Council.

This certificate is not required to include information regarding Planning, Building, Health, Land Fill, Land Slip, other Flooding Information or Service Easements. Information regarding these matters may be available from the Council or the relevant Authority. A fee may be charged for such information.

Particular of Rates & Charges, Outstanding Notices and Works for which a charge has been made:

- ◆ The **current rating year** is for the period **01/07/2025** to **30/06/2026**. Lump sum payment – due by **15/02/2026** or by instalment **30/09/2025**, **30/11/2025**, **28/02/2026** and **31/05/2026**. Interest is chargeable after these dates on any outstanding amount.
- ◆ Interest on outstanding charges and additional payments or charges may have affected the balance, please check with this office at time of settlement for an update amount. Telephone ☎ **03 5272 5272**.

Please Note: Council is not involved in the settlement process. On request any overpayment of rates at settlement will be refunded to the payee.

Confirmation of any variation to this certificate will only be given for up to 90 days from the date of issue

(ie. **14-Sep-2026**) and within the current financial year.

The Local Government Act 2020 requires a Notice of Acquisition be submitted to ensure Purchasers correct name and address details are held by Council. Council cannot accept liability for incorrect addresses when notification in writing has not been supplied.

Notice can be emailed to: transfers@geelongcity.vic.gov.au

2025-2026 LAND INFORMATION CERTIFICATE (cont.)In accordance with Section 121 of the
Local Government Act 2020Date of Issue: **16-Jun-2026**

eService

Certificate No: **248453**Property Address: **6 Marilyn Close, CORIO VIC 3214**Assessment Number: **86247.4**

	<u>Rate, Charges & Other Monies</u>	<u>Amount \$</u>
Arrears:	Balance Brought Forward	0.00
	Legal Fees Arrears	0.00
Current:	General Rates	946.25
	State Government Levies	213.85
	Waste Management	509.55
	Municipal Charge	0.00
	Refunds	0.00
	Concession Rebates	0.00
	Interest Arrears	0.00
	Interest Current	0.00
	Legal Fees	0.00
Other:	Special Charges (<i>subject to Final Costs</i>)	0.00
	Sundry Charges	0.00
Payment:	Amount Received	-1,460.97
	Overpayment	0.00
	All Overdue amounts should be paid at settlement. The purchaser is liable for all outstanding rates and charges after transfer and settlement.	
	Total Due:	208.68

General Notes: Supplementary Valuations are conducted by Council when a property's characteristics change. Examples of this (but not exclusive) are: A building is altered, erected, or demolished. A property is amalgamated, subdivided, rezoned, part sold, or affected by road construction. As a result of this, an Adjusted Valuation may be returned in due course, and a subsequent rate adjustment may be levied within the financial year.

Condition:

I hereby certify that as the date of issue, the information given in this certificate is a correct disclosure of the rates, charges, interest and other monies payable to the **City of Greater Geelong** together with any Notices pursuant to the Local Government Act 1989 and 2020, Local Laws or any other legislation.



Authorised Officer

Reference: 10000862474

 Payment via internet or phone banking,
from your cheque or savings account.

Your Ref: SPC832:227344

Page 2 of 2

 Standard Property
Sec 121 LGA 2020

Barwon Region Water Corporation
 ABN 86 348 316 514

Date of Issue
 13 April 2026

1300 656 007

www.barwonwater.vic.gov.au

Tax Invoice/Statement



M W Octaviano & F A De Leon Pampolina
 c/- Buxton Geelong North
 UNIT 3/222 Anakie Rd
 BELL PARK, VIC 3215

Account number
69000001 00345930

Payment due
13 May 2026

Total amount due
\$ 197.79

Your account summary

Service Address: 6 MARILYN CL CORIO 3214

Previous balance	\$197.79	DR
Payments/adjustments	\$197.79	CR
Your balance	\$0.00	
New charges	\$197.79	DR
Total	\$197.79	DR

2025-2026 Pricing Schedule

Our prices are changing from 1 July 2025.

The average bill will increase by \$1.04 per month for residential owner-occupiers and \$1.23 per month for renters.

Full fees and charges are available at www.barwonwater.vic.gov.au or via 1300 656 007.

If you have a Centrelink Pension or Health Care Card, or Department of Veterans Affairs Gold Card, you may be eligible for a discount. Contact us for details.

Geelong’s water storages are at a six-year low.

There are simple things you can do to save water.

Keep your showers short – Aim for 4 minutes

30% of water use happens in the shower.

Mulch your garden

Reduce water evaporation by up to 70%! 50% of household water use happens outdoors.

Check for leaks

10% of our region’s water is lost in leaks. Take a photo of your water meter reading before you go to bed, then check your water meter again in the morning. If your meter has gone up while no-one was using water, you’ve got a leak!

Permanent water saving rules are in place. Visit the Barwon Water website for details.



Installation Type: Residential House

Bill Details as at 13 APR 2026		Value	GST	Price
WATER SERVICE CHARGE	1 APR 2026 to 30 JUN 2026	37.12	0.00	37.12
SEWERAGE SERVICE CHARGE	1 APR 2026 to 30 JUN 2026	160.67	0.00	160.67
Total		\$ 197.79	\$ 0.00	\$ 197.79
Balance brought forward				0.00
Please pay				\$ 197.79



Need help paying your bill?

Contact us to set up a payment plan and talk about grants, rebates and concessions.



Residential Tenants and Landlords

Tenants with separate meters pay water volume charges only.



Moving house?

Please let us know at least 2 days before you move in or out so we can arrange a meter reading and update your details.



Communication assistance

Hearing or speech impaired? Contact us via the National Relay Service on 13 36 77. We provide a free interpreter service. Contact the Translation and Interpreter Service on 13 14 50.



Servizio Interpreti
Dolmetschdienst

Služba za usluge tumačenja
Служба за преведување

Услуге тумача
传译服务

Contact Us

☎ 1300 656 007

Email info@barwonwater.vic.gov.au

General enquiries, billing and payment options

Mon - Fri, 9.00am - 5.00pm

Emergencies and faults

24 hours, 7 days

Statement No 7120534467

Payment Options



Direct Debit

To arrange a direct debit, please call or visit our website.



Billers Code: 585224

Ref: 6900 0001 0034 5930 5

Contact your financial institution to pay from your cheque, savings or credit account.



Centrelink

Centrelink recipients can arrange automatic payments through Centrepay. Contact us for details.



By Cheque

Post the payment slip with your cheque payable to Barwon Water to: PO Box 14206, Melbourne City MC VIC 8001. Please do not use staples or pins.



Billpay Code: 0803

Ref: 6900 0001 0034 5930 5

- In person at any post office
- Online at www.postbillpay.com.au
- Call 13 18 16 for credit card payments

Account number

69000001 00345930

Payment due

13 May 2026

Total amount due

\$ 197.79

Statement No 7120534467

POST billpay®



*803 69000001003459305 \$197.79 8



Support and payment assistance



**Are you having difficulty paying your water bill?
We offer a range of payment and support options.**

Payment plans

We offer a range of flexible and tailored solutions to help you pay your water bill, whatever your circumstances.

One-off payment extensions: for when life throws up unexpected challenges.

Bill smoothing: split your bill and pay in regular instalments: weekly, monthly or fortnightly. Pay in person or direct debit from your bank account.

Centrepay: if you receive a Centrelink benefit, you can pay your utility bills automatically.

Support programs

We understand that any of us can sometimes face financial challenges. We provide a range of customer support programs and can tailor an option to suit your needs. There is no cost to access these services.

'Arrange and save': if you have an overdue bill, this program can help get you back on track. As a bonus, if you make five instalment payments

– on time and in full, we'll cover the sixth as an incentive.

Utility relief grant: this is a Victorian Government program to help pay an overdue electricity, gas or water bill due to temporary financial crisis. If you are eligible, you may receive up to \$650 towards your utilities bills, available every two years.

High water bill due to undetectable leak?

Received an unusually high water bill? If it's because of a leak that you could not have known about, you may be eligible for a one-off allowance to help cover the extra cost.

Medical conditions and life support machines

If you have a medical condition that requires high water consumption (e.g. for bathing or laundering) you could be eligible for a rebate. If you use a haemodialysis machine and have a concession card, you're eligible for a government rebate plus a further 50% discount on remaining water volume charges.

Support for customers experiencing family violence

Our staff are trained in identifying and responding to the complex issues associated with family violence.

This includes the utmost respect for your privacy and confidentiality, and access to specialised support networks.

Connections with counsellors

A number of local organisations provide free financial counselling services. We can connect you to them for additional support and advice.

Similarly, if you're referred to us by one of these organisations, we'll work together to access the support you're eligible for.

Bill appear higher than usual?

If you're using more water than usual, the extra litres over a few months can easily add up to some extra dollars on your bill.

For ways to save water around the home, visit www.barwonwater.vic.gov.au/saving-water

Business customers

We offer a range of flexible and tailored solutions to help you pay your business water bill.

We can also provide advice on how your business can be more water efficient or manage a leak – all of which can help reduce your bills in the future.

Get in touch - we're here to help

If you're having trouble paying your bill, or simply want to learn more about our options for customers in financial hardship, get in touch - we're here to help.

We will put you in touch with a specialist who will help you with your enquiry promptly, sensitively and confidentially.

Our friendly, Geelong-based customer contact centre is available weekdays 8 am to 6 pm on **1300 656 007**.

For detailed information about concessions, support and payment assistance, including eligibility criteria, visit www.barwonwater.vic.gov.au/billhelp.



For further information

☎ 1300 656 007 | ✉ info@barwonwater.vic.gov.au

www.barwonwater.vic.gov.au

f t y i in



PLANNING PROPERTY REPORT

From www.planning.vic.gov.au at 16 June 2026 01:42 PM

PROPERTY DETAILS

Address: **6 MARILYN CLOSE CORIO 3214**
 Lot and Plan Number: **Lot 1 TP521729**
 Standard Parcel Identifier (SPI): **1\TP521729**
 Local Government Area (Council): **GREATER GEELONG**
 Council Property Number: **289520**
 Planning Scheme: **Greater Geelong**
 Directory Reference: **Melway 431 J9**

www.geelongaustralia.com.au

[Planning Scheme - Greater Geelong](#)

UTILITIES

Rural Water Corporation: **Southern Rural Water**
 Urban Water Corporation: **Barwon Water**
 Melbourne Water: **Outside drainage boundary**
 Power Distributor: **POWERCOR**

STATE ELECTORATES

Legislative Council: **WESTERN VICTORIA**
 Legislative Assembly: **LARA**
 Registered Aboriginal Party: **Wadawurrung Traditional Owners Aboriginal Corporation**
 Fire Authority: **Fire Rescue Victoria & Country Fire Authority**

[View location in VicPlan](#)

Planning Zones

[GENERAL RESIDENTIAL ZONE \(GRZ\)](#)

[GENERAL RESIDENTIAL ZONE - SCHEDULE 1 \(GRZ1\)](#)

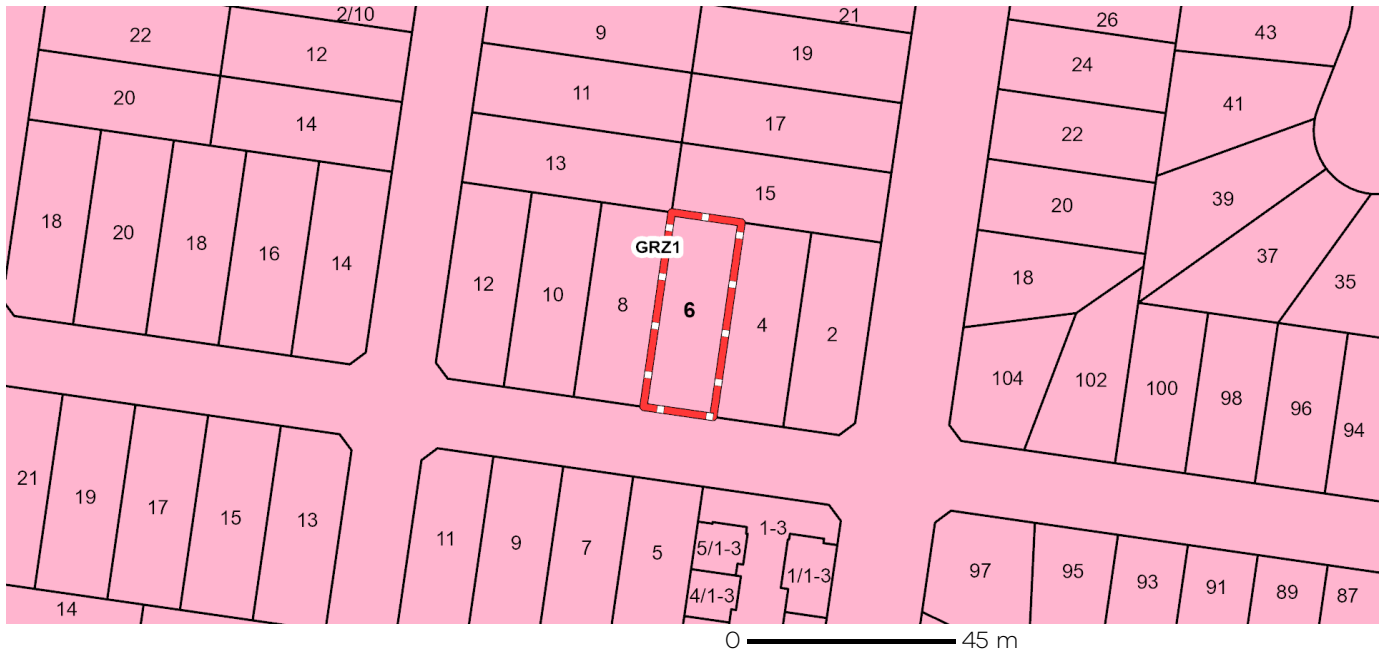

GRZ - General Residential

Note: labels for zones may appear outside the actual zone - please compare the labels with the legend.

PLANNING PROPERTY REPORT

Planning Overlay

None affecting this land - there are overlays in the vicinity

OTHER OVERLAYS

Other overlays in the vicinity not directly affecting this land

SPECIAL BUILDING OVERLAY (SBO)

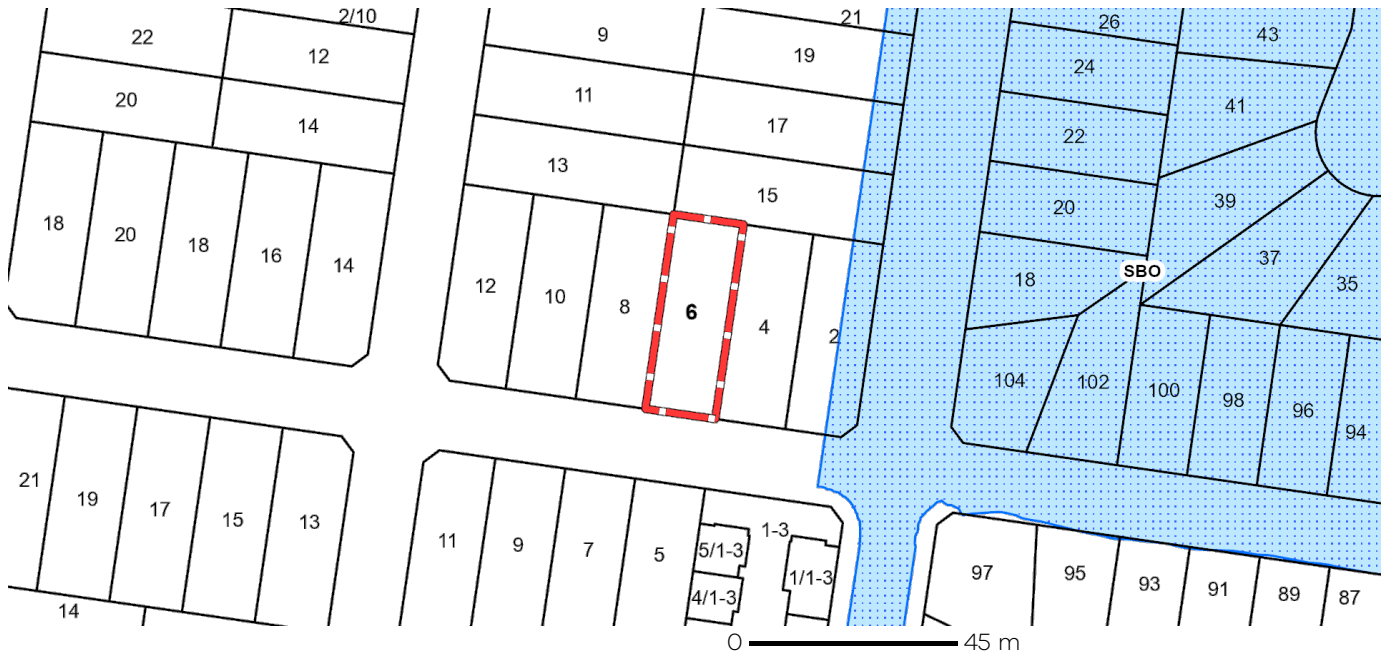

SBO - Special Building Overlay

Note: due to overlaps, some overlays may not be visible, and some colours may not match those in the legend

Further Planning Information

Planning scheme data last updated on 11 June 2026.

A **planning scheme** sets out policies and requirements for the use, development and protection of land. This report provides information about the zone and overlay provisions that apply to the selected land. Information about the State and local policy, particular, general and operational provisions of the local planning scheme that may affect the use of this land can be obtained by contacting the local council or by visiting <https://www.planning.vic.gov.au>

This report is NOT a **Planning Certificate** issued pursuant to Section 199 of the **Planning and Environment Act 1987**. It does not include information about exhibited planning scheme amendments, or zonings that may affect the land. To obtain a Planning Certificate go to Titles and Property Certificates at Landata - <https://www.landata.vic.gov.au>

For details of surrounding properties, use this service to get the Reports for properties of interest.

To view planning zones, overlay and heritage information in an interactive format visit <https://mapshare.vic.gov.au/vicplan/>

For other information about planning in Victoria visit <https://www.planning.vic.gov.au>

PLANNING PROPERTY REPORT

Designated Bushfire Prone Areas

This property is not in a designated bushfire prone area.
No special bushfire construction requirements apply. Planning provisions may apply.

Where part of the property is mapped as BPA, if no part of the building envelope or footprint falls within the BPA area, the BPA construction requirements do not apply.

Note: the relevant building surveyor determines the need for compliance with the bushfire construction requirements.

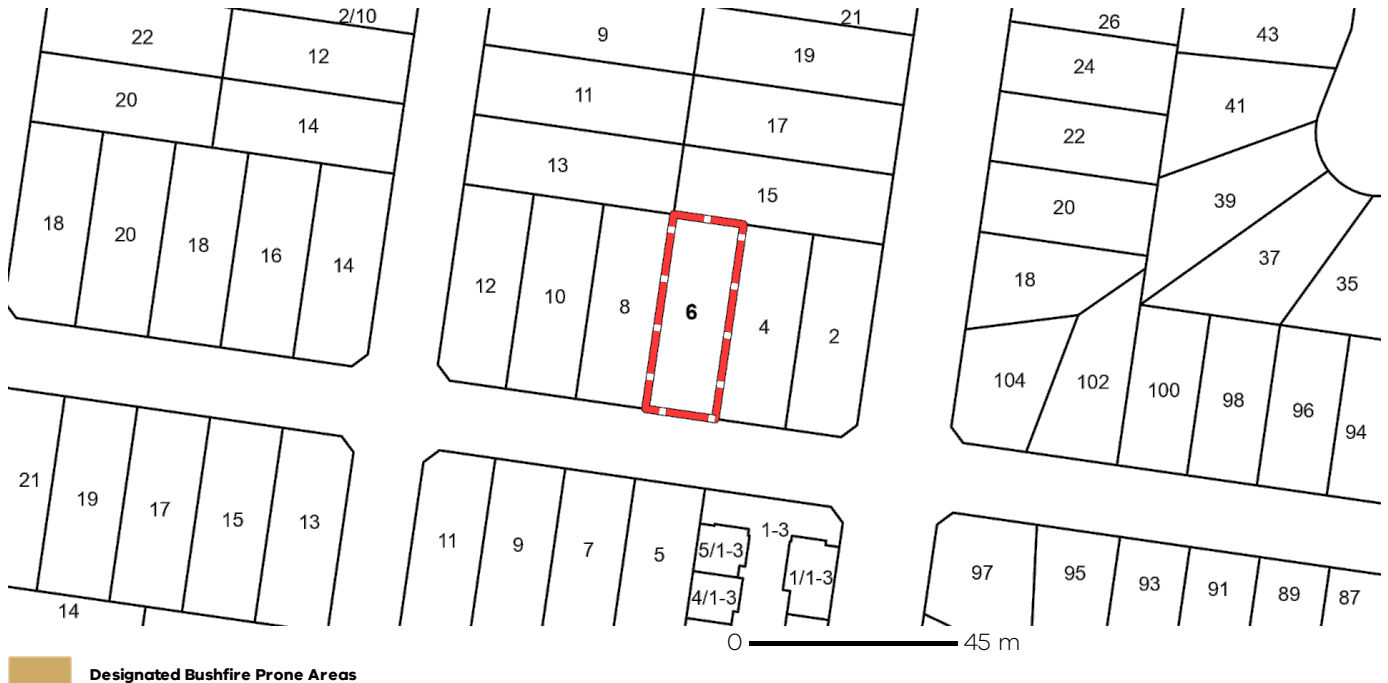

Designated BPA are determined by the Minister for Planning following a detailed review process. The Building Regulations 2018, through adoption of the Building Code of Australia, apply bushfire protection standards for building works in designated BPA.

Designated BPA maps can be viewed on VicPlan at <https://mapshare.vic.gov.au/vicplan/> or at the relevant local council.

Create a BPA definition plan in [VicPlan](#) to measure the BPA.

Information for lot owners building in the BPA is available at <https://www.planning.vic.gov.au>.

Further information about the building control system and building in bushfire prone areas can be found on the Victorian Building Authority website <https://www.vba.vic.gov.au>. Copies of the Building Act and Building Regulations are available from <http://www.legislation.vic.gov.au>. For Planning Scheme Provisions in bushfire areas visit <https://www.planning.vic.gov.au>.

Native Vegetation

Native plants that are indigenous to Victoria and important for biodiversity might be present on this property. This could include trees, shrubs, herbs, grasses or aquatic plants. There are a range of regulations that may apply including need to obtain a planning permit under Clause 52.17 of the local planning scheme. For more information see [Native Vegetation \(Clause 52.17\)](#) with local variations in [Native Vegetation \(Clause 52.17\) Schedule](#)

To help identify native vegetation on this property and the application of Clause 52.17 please visit the Native Vegetation Regulations Map (NVR Map) <https://mapshare.vic.gov.au/nvr/> and [Native vegetation \(environment.vic.gov.au\)](https://www.environment.vic.gov.au) or please contact your relevant council.

You can find out more about the natural values on your property through NatureKit [NatureKit \(environment.vic.gov.au\)](https://www.environment.vic.gov.au)

Copyright © - State Government of Victoria

Disclaimer: This content is provided for information purposes only. No claim is made as to the accuracy or authenticity of the content. The Victorian Government does not accept any liability to any person for the information provided.
Read the full disclaimer at <https://www.vic.gov.au/disclaimer>

Notwithstanding this disclaimer, a vendor may rely on the information in this report for the purpose of a statement that land is in a bushfire prone area as required by section 32C (b) of the Sale of Land 1962 (Vic).

PROPERTY REPORT

Created at 16 June 2026 01:42 PM

PROPERTY DETAILS

Address: **6 MARILYN CLOSE CORIO 3214**
 Lot and Plan Number: **Lot 1 TP521729**
 Standard Parcel Identifier (SPI): **1\TP521729**
 Local Government Area (Council): **GREATER GEELONG**
 Council Property Number: **289520**
 Directory Reference: **Melway 431 J9**

www.geelongaustralia.com.au

SITE DIMENSIONS

All dimensions and areas are approximate. They may not agree with those shown on a title or plan.

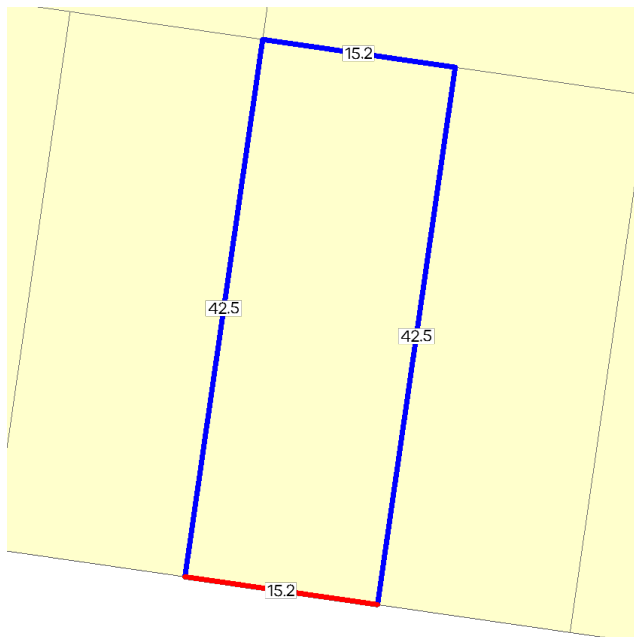

Area: 648 sq. m

Perimeter: 116 m

For this property:

— Site boundaries

— Road frontages

Dimensions for individual parcels require a separate search, but dimensions for individual units are generally not available.

Calculating the area from the dimensions shown may give a different value to the area shown above

For more accurate dimensions get copy of plan at

[Title and Property Certificates](#)

UTILITIES

Rural Water Corporation: **Southern Rural Water**
 Urban Water Corporation: **Barwon Water**
 Melbourne Water: **Outside drainage boundary**
 Power Distributor: **POWERCOR**

STATE ELECTORATES

Legislative Council: **WESTERN VICTORIA**
 Legislative Assembly: **LARA**

PLANNING INFORMATION

Property Planning details have been removed from the Property Reports to avoid duplication with the Planning Property Reports from the Department of Transport and Planning which are the authoritative source for all Property Planning information.

The Planning Property Report for this property can found here - [Planning Property Report](#)

Planning Property Reports can be found via these two links

Vicplan <https://mapshare.vic.gov.au/vicplan/>

Property and parcel search <https://www.land.vic.gov.au/property-and-parcel-search>

PROPERTY REPORT

Area Map



 Selected Property



MR FRANCIS ANGELO PAMPOLINA
C/- SETARA NADIRI
LEVEL 1/280 THOMAS STREET
DANDENONG VIC 3175

Our reference: 7171056769672

Phone: 13 28 66

16 June 2026

Your foreign resident capital gains withholding clearance certificate

- › Purchasers are not required to withhold and pay an amount
- › Provide a copy to the purchaser and retain a copy for your records

Hello FRANCIS ANGELO,

We have decided that purchasers are not required to withhold and pay an amount. Your certificate is below:

Notice number	2411211032246
Vendor name	FRANCIS ANGELO PAMPOLINA
Clearance Certificate Period	16 June 2026 to 16 June 2027

The Commissioner may withdraw this clearance certificate at any time if we obtain further information indicating you are a foreign resident.

Yours sincerely,

Ben Kelly

Deputy Commissioner of Taxation

Need help?

Learn more about foreign resident capital gains withholding at ato.gov.au/FRCGW

Contact us

In Australia? Phone us on **13 28 66**

If you're calling from overseas, phone **+61 2 6216 1111** and ask for **13 28 66** between 8:00 am and 5:00 pm Australian Eastern Standard time, Monday to Friday.



MISS MAQUILE OCTAVIANO
C/- SETARA NADIRI
LEVEL 1/280 THOMAS STREET
DANDENONG VIC 3175

Our reference: 7171056786953

Phone: 13 28 66

16 June 2026

Your foreign resident capital gains withholding clearance certificate

- › Purchasers are not required to withhold and pay an amount
- › Provide a copy to the purchaser and retain a copy for your records

Hello MAQUILE,

We have decided that purchasers are not required to withhold and pay an amount. Your certificate is below:

Notice number	2411211032824
Vendor name	MAQUILE OCTAVIANO
Clearance Certificate Period	16 June 2026 to 16 June 2027

The Commissioner may withdraw this clearance certificate at any time if we obtain further information indicating you are a foreign resident.

Yours sincerely,

Ben Kelly

Deputy Commissioner of Taxation

Need help?

Learn more about foreign resident capital gains withholding at ato.gov.au/FRCGW

Contact us

In Australia? Phone us on **13 28 66**

If you're calling from overseas, phone **+61 2 6216 1111** and ask for **13 28 66** between 8:00 am and 5:00 pm Australian Eastern Standard time, Monday to Friday.

Vendor GST Withholding Notice

Pursuant to Section 14-255 Schedule 1 Taxation Administration Act 1953 (Cwlth)

To:

From: MAQUILE WILLIAMS OCTAVIANO and FRANCIS ANGELO DE LEON PAMPOLINA, 22
Barcelona Avenue, Clyde North VIC 3978

Property Address: 6 Marilyn Close, Corio VIC 3214

Lot: 1 Plan of subdivision: 521729B

The Purchaser is not required to make a payment under Section 14-250 of Schedule 1 of the Taxation Administration Act 1953 (Cwlth) in relation to the supply of the above property

Dated:

Signed for an on behalf of the Vendor: *Star Property Conveyancing*

Signed by:

990557BEDB85407...

16/6/2026

Signed by:

9E8B1D02CF504EE...

16/6/2026