

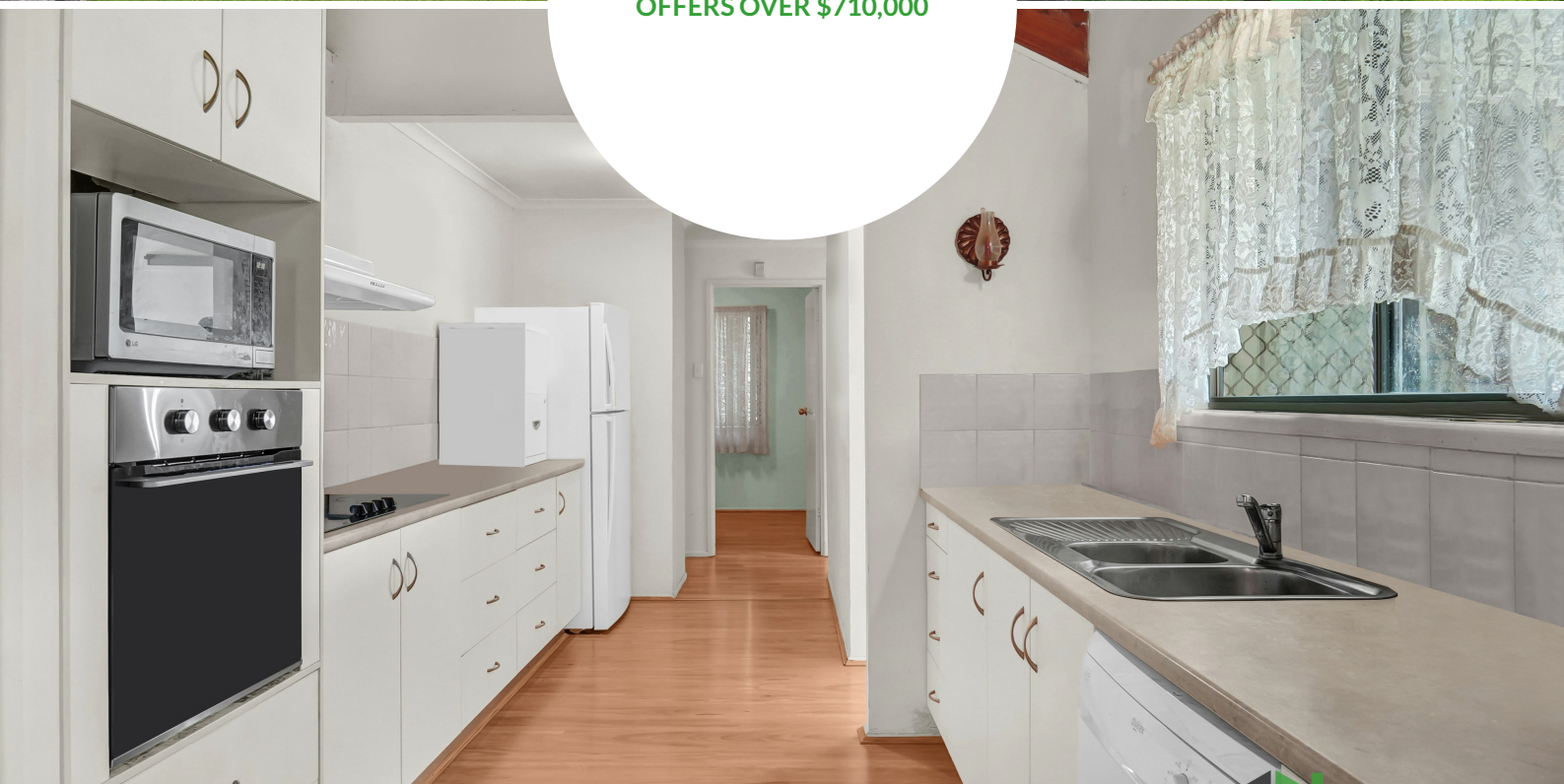

OFFERS OVER \$710,000



Nestled in a lovely cul-de-sac 3 Eltham Court
Mt Warren Park, is a lovely low-set home
perfect for investors or first-home buyers

3 Eltham Court, Mount Warren Park, QLD 4207



Laurell
Veivers

0412 205 807



Alison
Veivers-Russell

0419 786 511

3 Eltham Ct Mt Warren Park

771m²
3 Bed
1 Bath
2 Car

Internal 92.47 m²
External 43 m²
Total 135.47 m²

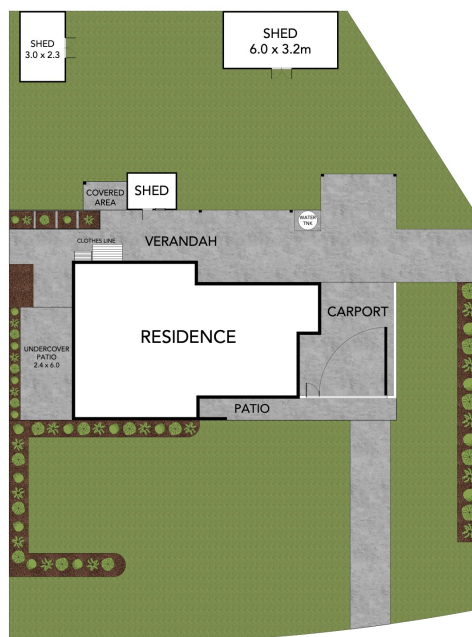

Whilst every attempt has been made to ensure the accuracy of the floor plan contained here, measurements of doors, windows, rooms and any other items are approximate and no responsibility is taken for any error, omission, or missed. This plan is for illustrative purposes only and should be used as such by any prospective purchaser.

771 sqm block

3 1 2

- Three bedrooms and main bathroom with separate toilet
- Solar panels