

AREA SPECIALIST

STATEMENT OF INFORMATION

2 HARRIER COURT, DINGLEY VILLAGE, VIC 3172

PREPARED BY JAYMEE HANH LE, AREA SPECIALIST, PHONE: 0416 336 902

AREA SPECIALIST

STATEMENT OF INFORMATION

Section 47AF of the Estate Agents Act 1980

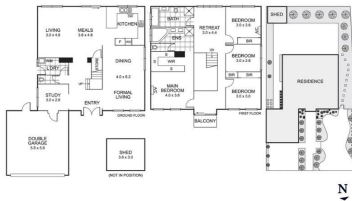

2 HARRIER COURT, DINGLEY VILLAGE,

4 2 2

Indicative Selling Price

For the meaning of this price see consumer.vic.au/underquoting

Price Range: **\$1,390,000 to \$1,450,000**

Provided by: Jaymee Hanh Le, Area Specialist

MEDIAN SALE PRICE

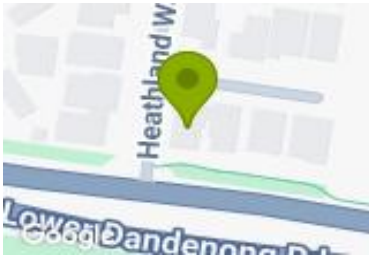

DINGLEY VILLAGE, VIC, 3172

Suburb Median Sale Price (House)

\$1,147,500

01 July 2024 to 30 June 2025

Provided by: pricefinder

COMPARABLE PROPERTIES

The estate agent or agents representative reasonably believes that fewer than three comparable properties were sold within two kilometres of the property for sale in the last six months.

This report has been compiled on 29/07/2025 by Area Specialist. Property Data Solutions Pty Ltd 2025 - www.pricefinder.com.au

© The State of Victoria owns the copyright in the property sales data and reproduction of that data in any way without the consent of the State of Victoria will constitute a breach of the Copyright Act 1968 (Cth). The State of Victoria does not warrant the accuracy or completeness of the licensed material and any person using or relying upon such information does so on the basis that the State of Victoria accepts no responsibility or liability whatsoever for any errors, faults, defects or omissions in the information supplied.

Statement of Information

Single residential property located in the Melbourne metropolitan area

Sections 47AF of the Estate Agents Act 1980

Instructions: The instructions in this box do not form part of this Statement of Information and are not required to be included in the completed Statement of Information for the property being offered for sale.

The Director of Consumer Affairs Victoria has approved this form of the Statement of Information for section 47AF of the *Estate Agents Act 1980*.

The estate agent or agent's representative engaged to sell the property is required to prepare this Statement of Information. It must be used when **a single residential property located in the Melbourne metropolitan area** is being offered for sale. The Determination setting out the local government areas that comprise the Melbourne metropolitan area is published on the Consumer Affairs Victoria website at **consumer.vic.gov.au/underquoting**. The indicative selling price in this Statement of Information may be expressed as a single price, or as a price range with the difference between the upper and lower amounts not more than 10% of the lower amount.

This Statement of Information must be provided to a prospective buyer within two business days of a request and displayed at any open for inspection for the property for sale.

It is recommended that the address of the property being offered for sale be checked at services.land.vic.gov.au/landchannel/content/addressSearch before being entered in this Statement of Information.

Property offered for sale

Address Including suburb and postcode	2 HARRIER COURT, DINGLEY VILLAGE, VIC 3172
---	--

Indicative selling price

For the meaning of this price see consumer.vic.gov.au/underquoting

Price Range:	\$1,390,000 to \$1,450,000
--------------	----------------------------

Median sale price

Median price	\$1,147,500	Property type	House	Suburb	DINGLEY VILLAGE
Period	01 July 2024 to 30 June 2025	Source			

Comparable property sales

The estate agent or agents representative reasonably believes that fewer than three comparable properties were sold within two kilometres of the property for sale in the last six months.

This Statement of Information was prepared on:	29/07/2025
--	------------