



**first
national**
REAL ESTATE

| Peoples' Choice RLA222770



3/32A Jacob Street **Gawler**



firstnationalgawler.com.au

8523 4111



BLUESTONE BEAUTY

Located in the heart of Gawler, this fantastic blue stone fronted property is the epitome of convenience and suitability. Located within walking distance to all of Gawler's amenities, this property is perfectly situated to those slowing down or even a savvy investor.

Built in 1994 this strata titled unit is one of three units. Units 2 and 3 are located down a secluded driveway meaning peace and quiet can always be had. Featuring two well sized bedrooms, a front living area, large kitchen and main bathroom as well as solar power, this property is priced to sell and wont last long.

The home features;

- Large front lounge between the entry of the home and kitchen
- Large hardwood kitchen with plenty of cupboard and bench space
- Meals or flexible second living area that sits adjacent to the kitchen
- The master bedroom is complete with a large bay window and built-in wardrobe

- Large second bedroom complete with built-in -robe
- Main three-way bathroom is spacious and includes large bath/shower and character tiling
- Backyard and entertaining areas are neat and tidy while also being low in maintenance requirements

If convenience and suitability is what you are after, hit the brakes and don't go past...

First National Real Estate Peoples' Choice -
RLA 222770

Grant Fielke
0427 300 049

grant@firstnationalgawler.com.au



Bailey Fielke
0427 716 886

bailey@firstnationalgawler.com.au



Floor Plan

3/32 Jacob Street,
GAWLER

Year Built 1994 (Approx)
Council Area Town of Gawler
CT Number 5468/644

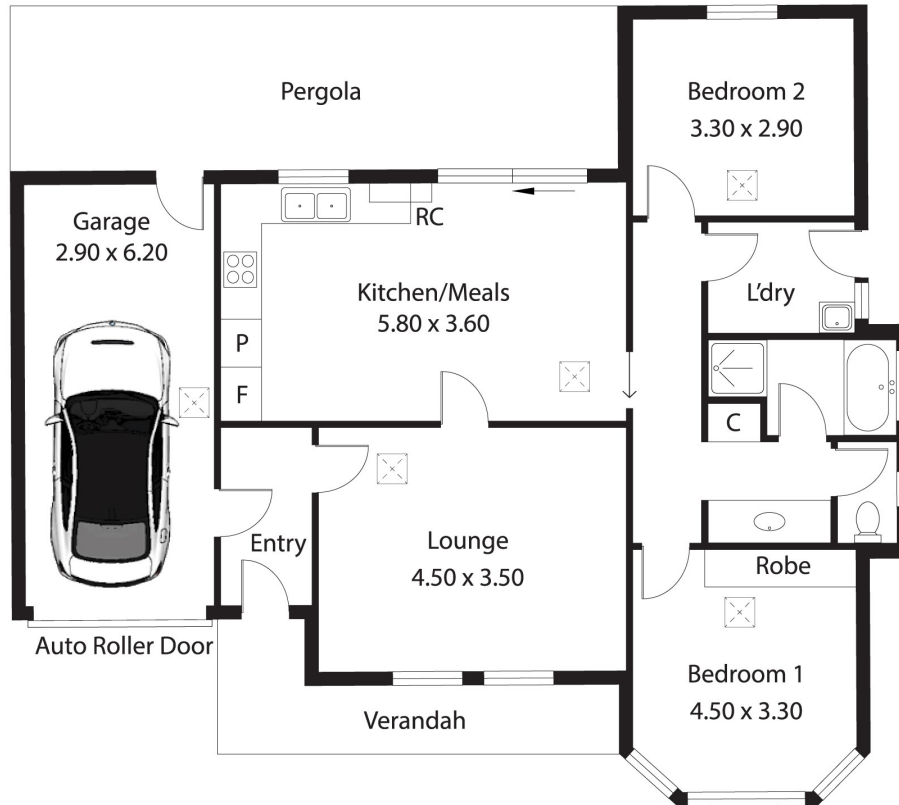

Like us on Facebook to view all of our
new properties first!
facebook.com/fnpeopleschoice

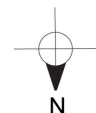
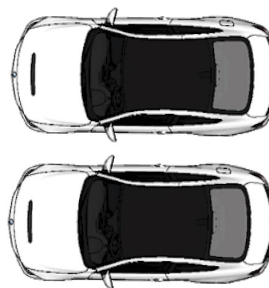

Living:	90.57SQ.M
Garage:	17.98SQ.M
Verandah:	8.35SQ.M
Pergola:	23.70SQ.M
TOTAL:	140.60SQ.M

This Drawing is for illustration purposes only. All measurements are internal and approximate. Details intended to be relied upon should be independently verified.

This brochure & floorplan are for illustration purposes only & all measurements are approximate. Any fixtures shown may not necessarily be included in the sale contract & it is essential that any queries are directed to the agent, & any information that is intended to be relied upon should be independently verified. Neither the agent, vendor or contracted illustrators take any responsibility for any omissions, wrongful inclusion or typographical error which may occur in this brochure as it is intended as an artistic impression only. While every endeavor has been made to verify the correct details in this publication, neither the agent or the vendors accept liability for any error or omission.

First National Real Estate Peoples' Choice - RLA222770



We Put You First

First National Real Estate Peoples' Choice - RLA222770

8523 4111

82 Adelaide Road GAWLER SOUTH