



**first
national**
REAL ESTATE

| Peoples' Choice RLA222770



7 Turner Street **Gawler East**



firstnationalgawler.com.au

8523 4111



CHARACTER CHARM - HUGE PRICE DROP

Situated amid the most convenient locations in Gawler East, this character filled home abounds with desirable features. Gawler main street and Walking trails are all within minutes of your front door!

The nearest winery is 15 minutes away in the Barossa, while Adelaide is 35 minutes to the South.

This home is situated on a large 1770sqm allotment (approx) with a charming elevated rear view. Set in a quiet Cul-de-sac, this home sits amongst Heritage listed homes, and established gardens and trees.

As you enter this home, the warmth of natural finishes is evident. Timber flooring, exposed beams, and a Cathedral ceiling, create a visual flow between interior and exterior spaces.

The Master bedroom has built in robes and a spacious ensuite, placed tactfully at one end of the house for privacy. The remaining bedrooms have floor to ceiling built in robes.

The heart of this home is the kitchen/living area, made cosy by a wood burning heater. The kitchen is a chefs dream, with a large wooden island bench, holding a 6 burner Bosch stovetop, and a 90cm Bosch oven. A double butlers sink, and a huge walk in pantry complete the vision.

- Solar system
- Skylights
- Reverse cycle air conditioning

First National Real Estate Peoples' Choice - RLA 222770

Like us on Facebook to view all of our
new properties first!
facebook.com/fnpeopleschoice



Grant Fielke
0427 300 049

grant@firstnationalgawler.com.au



Bailey Fielke
0427 716 886

bailey@firstnationalgawler.com.au



Price: \$550,000

Allotment Size: 1770sqm(approx)

Year Built 1972 (approx)

Council Area Town of Gawler

CT Number 5197/924

Floor Plan

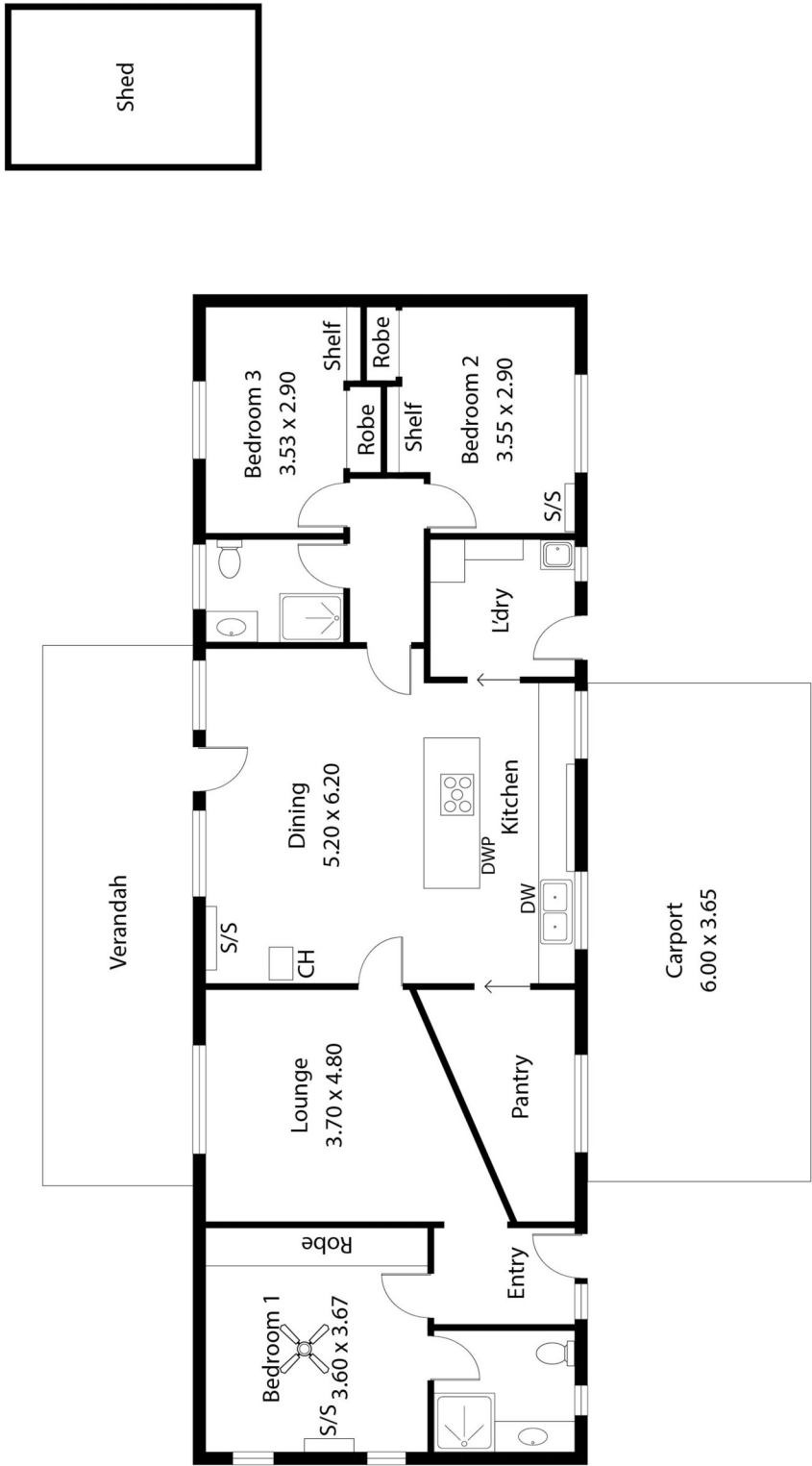

Living:	116.16SQ.M
Verandah:	22.23SQ.M
Carport:	21.90SQ.M
Shed:	10.57SQ.M
TOTAL:	170.86SQ.M

This Drawing is for illustration purposes only. All measurements are internal and approximate. Details intended to be relied upon should be independently verified.

This brochure & floorplan are for illustration purposes only & all measurements are approximate. Any fixtures shown may not necessarily be included in the sale contract & it is essential that any queries are directed to the agent, & any information that is intended to be relied upon should be independently verified. Neither the agent, vendor or contracted illustrators take any responsibility for any omissions, wrongful inclusion or typographical error which may occur in this brochure as it is intended as an artistic impression only. While every endeavor has been made to verify the correct details in this publication, neither the agent or the vendors accept liability for any error or omission.



We Put You First

First National Real Estate Peoples' Choice - RLA222770

8523 4111

82 Adelaide Road GAWLER SOUTH