



**first
national**
REAL ESTATE

| Peoples' Choice RLA222770



24 Bright Terrace **Gawler East**



firstnationalgawler.com.au

8523 4111



FIRST CLASS FAMILY HOME ON 975SQM

Welcome to 24 Bright Terrace, Gawler East. Set back on a wonderful 975sqm approximately, this modern Spanish Colonial inspired home is full of great features which will have any family wanting to move in straight away. Being within walking distance of Gawler's Main Street, public transport, schools and much more this property has the added bonus of pure convenience.

Five bedrooms, two bathrooms, multiple living spaces, a five car length carport, pool, and great sized backyard are just some of things that this home has that makes it so special.

Other features include:

- * Large front living area with combustion fire and feature wall
- * The large designer kitchen includes plenty of cupboard and bench space, stainless steel appliances and walk-in pantry
- * Second living area looks out onto the fantastic pool and undercover entertainment spaces
- * The master bedrooms includes built-in robes and large ensuite
- * All remaining bedrooms are spacious and surround the modern family bathroom with feature tiling
- * The home also includes a study room, walk-in linen press, sitting room and recessed laundry

- * Large family pool with feature water feature
- * Multiple entertaining spaces which surround the five car length carport and fully established rear yard which includes storage space for garden tools and chicken coop

Other features include:

- * Gas heating
- * Evaporative cooling
- * Split system air conditioning
- * Solar power

First National Real Estate Peoples' Choice - RLA 222770

Grant Fielke
0427 300 049

grant@firstnationalgawler.com.au



Bailey Fielke
0427 716 886

bailey@firstnationalgawler.com.au

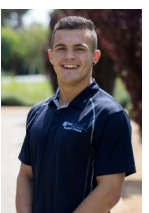

Price Guide: \$649,000 - \$689,000

Floor Plans

24 Bright Terrace,
GAWLER EAST

Allotment Size: 975sqm(approx)

Year Built 1973 (approx)

Council Area Town of Gawler

CT Number 5776/536

Like us on Facebook to view all of our new properties first!

facebook.com/fnpeopleschoice



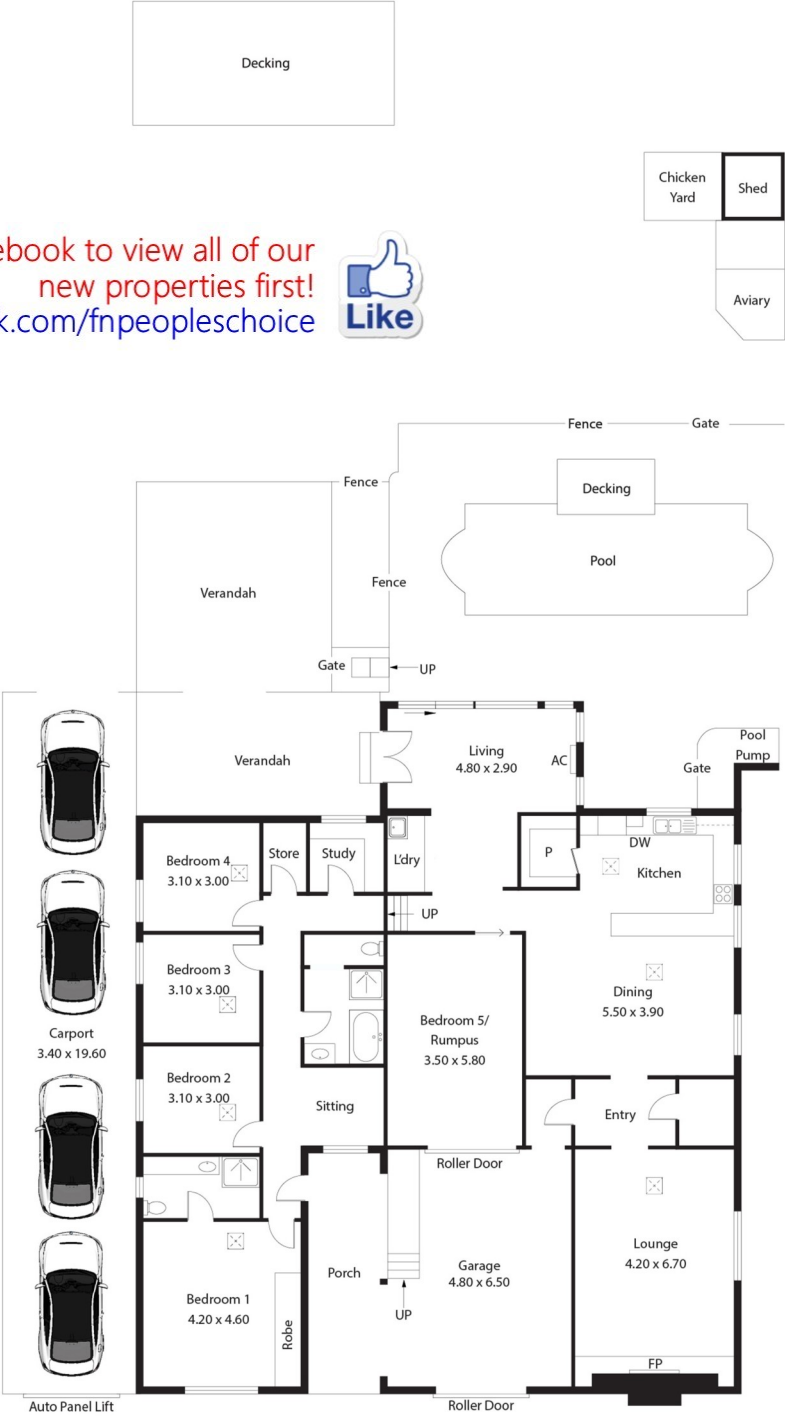

Living:	212.79SQ.M
Garage:	55.22SQ.M
Carport:	73.07SQ.M
Verandah:	53.77SQ.M
Porch:	12.73SQ.M
TOTAL:	407.58SQ.M

Produced by 

This Drawing is for illustration purposes only. All measurements are internal and approximate. Details intended to be relied upon should be independently verified.

This brochure & floorplan are for illustration purposes only & all measurements are approximate. Any fixtures shown may not necessarily be included in the sale contract & it is essential that any queries are directed to the agent, & any information that is intended to be relied upon should be independently verified. Neither the agent, vendor or contracted illustrators take any responsibility for any omissions, wrongful inclusion or typographical error which may occur in this brochure as it is intended as an artistic impression only. While every endeavor has been made to verify the correct details in this publication, neither the agent or the vendors accept liability for any error or omission.



We Put You First
First National Real Estate Peoples' Choice - RLA222770

8523 4111
82 Adelaide Road GAWLER SOUTH