



first
national
REAL ESTATE

Peoples' Choice RLA222770



Site 154, 925-693 Port Wakefield Road, **Bolivar**



firstnationalgawler.com.au

8523 4111



NEAT, TIDY AND CONVENIENT

Situated in Highway 1 Holiday and Lifestyle Park, this could be the ideal location for a hassle-free & quiet lifestyle, as well as the potential of building everlasting friendships.

FEATURES:

3 bedrooms

Master Bedroom with built in robe, ceiling fan and access into main bathroom

Bedrooms 2 and 3 are spacious in size and front the façade of the home

Kitchen with stone benches and stainless steel appliances

Open floorplan including kitchen, dining and lounge space

Laundry space in the master bedroom

Split system air-conditioning

Gas hot water

Ramp entry

Front decking

Low maintenance exterior with a garden shed

Under cover front decking

Double length car park with double street entry

Pull down blinds

Plus so much more

What a better time than now to relax and enjoy hassle free living at its most convenient, Highway 1 Holiday and Lifestyle Park has much on offer including in-ground swimming pools, manicured gardens, BBQ areas and walking trails! Getting to know your neighbours and settling in is made easy community spirit within the park with recreation rooms available as well as being pet friendly!

First National Real Estate Peoples' Choice - RLA 222770

Grant Fielke
0427 300 049

grant@firstnationalgawler.com.au



Bailey Fielke
0427 716 886

bailey@firstnationalgawler.com.au



Floor Plan

Site 153, Port Wakefield Road
Port Wakefield

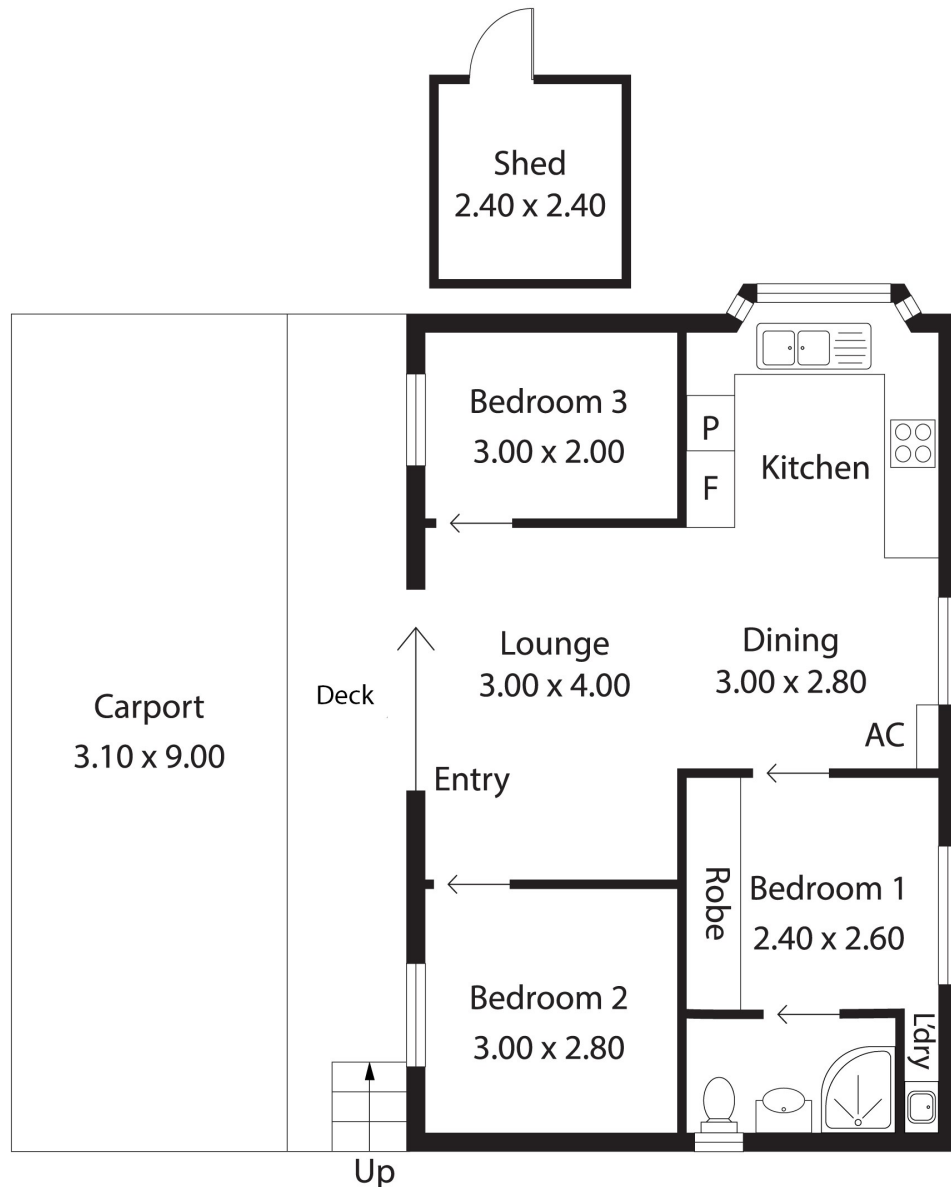

Like us on Facebook to view all of our
new properties first!
facebook.com/fnpeopleschoice



Living: 54.87SQ.M
Carport/Shed: 33.66SQ.M
Porch: 12.60SQ.M

TOTAL: 101.13SQ.M

This Drawing is for illustration purposes only. All measurements are internal and approximate. Details intended to be relied upon should be independently verified.

This brochure & floorplan are for illustration purposes only & all measurements are approximate. Any fixtures shown may not necessarily be included in the sale contract & it is essential that any queries are directed to the agent, & any information that is intended to be relied upon should be independently verified. Neither the agent, vendor or contracted illustrators take any responsibility for any omissions, wrongful inclusion or typographical error which may occur in this brochure as it is intended as an artistic impression only. While every endeavor has been made to verify the correct details in this publication, neither the agent or the vendors accept liability for any error or omission.

First National Real Estate Peoples' Choice - RLA222770



We Put You First

First National Real Estate Peoples' Choice - RLA222770

8523 4111

82 Adelaide Road GAWLER SOUTH