



**first
national**
REAL ESTATE

Peoples' Choice



17 Angas Avenue **Evanston Park**



firstnationalgawler.com.au

8523 4111



FAMILY LIVING AT ITS FINEST - PERFECT LOCATION

A Welcome to 17 Angas Avenue, Evanston Park. Built in 2000 this fantastic family home is set back on a spacious 648sqm allotment and is nestled within a quiet street. Within meters of the rear entry to Trinity College, walking distance to public transport, shopping precincts and more, convenience hasn't been better.

This large home has a great flexible floorplan! Comprising four large main bedrooms, three different living areas, an updated kitchen and a great entertainment area and established garden, the entire family has something to enjoy!

The home includes: Master bedroom to the front of the home with walk-in robe, large ensuite with shower, vanity, and spa bath with 3/4 wall tiling and roller shutters. The front lounge is spacious and also includes roller shutters to its front windows. A second living area which could act as a dining area, study room or something of your choice. Open planned kitchen, meals and living area surrounded by large windows allowing natural light to flood the room. An updated kitchen with soft close draws and doors includes stainless steel appliances, walk-in pantry and ample amounts of bench and cupboard space.

The remaining three bedrooms all surround the three-way main bathroom with the convenience of a separate toilet and a laundry with direct access outside.

To the exterior of the home the large gabled entertaining area with ceiling fans is screened by a fantastic garden and has drive through access from the double carport with panel lift door. The rear yard is well established with grass area and multiple storage sheds to store all your garden tools. Other features include: Evaporative Cooling, Gas heating, Split system reverse cycle heating and cooling, Ceiling fans present throughout the home, Roller shutters, Bedrooms also include built in robes.

Grant Fielke
0427 300 049

grant@firstnationalgawler.com.au



Bailey Fielke
0427 716 886

bailey@firstnationalgawler.com.au

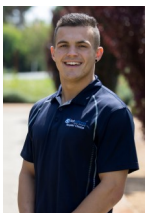

Floor Plan

Allotment Size: 648sqm (Approx)
Year Built 2000 (Approx)
Council Area Gawler
CT Reference Number 5579/71

17 Angas Avenue,
EVANSTON PARK

Like us on Facebook to view all of our
new properties first!
facebook.com/fnpeopleschoice

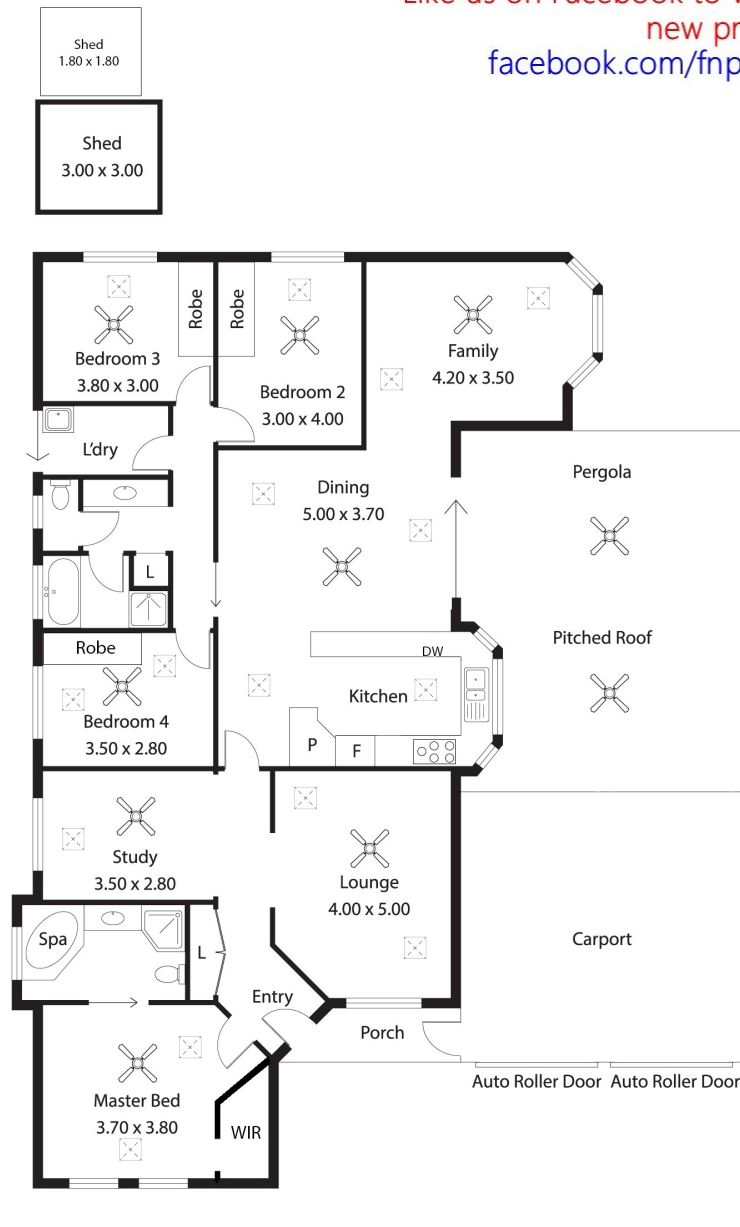

Living: 173.00SQ.M
Pergola: 45.00SQ.M
Carport: 33.00SQ.M
Porch/Shed: 15.00SQ.M
Pool: 15.00SQ.M

TOTAL: 281.00SQ.M

This Drawing is for illustration purposes only. All measurements are internal and approximate. Details intended to be relied upon should be independently verified.

This brochure & floorplan are for illustration purposes only & all measurements are approximate. Any fixtures shown may not necessarily be included in the sale contract & it is essential that any queries are directed to the agent, & any information that is intended to be relied upon should be independently verified. Neither the agent, vendor or contracted illustrators take any responsibility for any omissions, wrongful inclusion or typographical error which may occur in this brochure as it is intended as an artistic impression only. While every endeavour has been made to verify the correct details in this publication, neither the agent or the vendors accept liability for any error or omission.

RLA222770



Grant Fielke
Jade Stell

0427 300 049
0438 828 815

8523 4111
82 Adelaide Road GAWLER SOUTH