

Contract of sale of land

The vendor agrees to sell and the purchaser agrees to buy the property, being the land and the goods, for the price and on the terms set out in this contract.

The terms of this contract are contained in the -

- particulars of sale; and
- special conditions, if any; and
- general conditions (which are in standard form: see general condition 6.1)

in that order of priority.

SIGNING OF THIS CONTRACT

WARNING: THIS IS A LEGALLY BINDING AGREEMENT. YOU SHOULD READ THIS CONTRACT BEFORE SIGNING IT.

Purchasers should ensure that they have received a section 32 statement from the vendor before signing this contract. In this contract, "section 32 statement" means the statement required to be given by a vendor under section 32 of the *Sale of Land Act 1962*.

The authority of a person signing -

- under power of attorney; or
- as director of a corporation; or
- as agent authorised in writing by one of the parties - must be noted beneath the signature.

Any person whose signature is secured by an estate agent acknowledges being given by the agent at the time of signing a copy of the terms of this contract.

SIGNED BY THE PURCHASER:

..... on...../...../2025

Print name(s) of person(s) signing:

State nature of authority, if applicable:

This offer will lapse unless accepted within [] clear business days (3 clear business days if none specified)
In this contract, "business day" has the same meaning as in section 30 of the *Sale of Land Act 1962*

SIGNED BY THE VENDOR:

..... on...../...../2025

Print name(s) of person(s) signing: HIRAL NATAVARBHAI PATEL

State nature of authority, if applicable:

The **DAY OF SALE** is the date by which both parties have signed this contract.

IMPORTANT NOTICE TO PURCHASERS – COOLING-OFF

Cooling-off period (Section 31 of the *Sale of Land Act 1962*)

You may end this contract within 3 clear business days of the day that you sign the contract if none of the exceptions listed below applies to you.

You must either give the vendor or the vendor's agent **written** notice that you are ending the contract or leave the notice at the address of the vendor or the vendor's agent to end this contract within this time in accordance with this cooling-off provision.

You are entitled to a refund of all the money you paid EXCEPT for \$100 or 0.2% of the purchase price (whichever is more) if you end the contract in this way.

EXCEPTIONS: The 3-day cooling-off period does not apply if:

- you bought the property at a publicly advertised auction or on the day on which the auction was held; or
- you bought the land within 3 clear business days before a publicly advertised auction was to be held; or
- you bought the land within 3 clear business days after a publicly advertised auction was held; or
- the property is used primarily for industrial or commercial purposes; or
- the property is more than 20 hectares in size and is used primarily for farming; or
- you and the vendor have previously signed a contract for the sale of the same land in substantially the same terms; or
- you are an estate agent or a corporate body.

*This contract is approved as a standard form of contract under section 53A of the *Estate Agents Act 1980* by the Law Institute of Victoria Limited. The Law Institute of Victoria Limited is authorised to approve this form under the *Legal Profession Uniform Law Application Act 2014*.

Table of contents

Particulars of Sale

Special Conditions

General Conditions

1.	ELECTRONIC SIGNATURE	10
2.	LIABILITY OF SIGNATORY	10
3.	GUARANTEE	10
4.	NOMINEE.....	10
5.	ENCUMBRANCES	10
6.	VENDOR WARRANTIES.....	10
7.	IDENTITY OF THE LAND	11
8.	SERVICES	11
9.	CONSENTS.....	11
10.	TRANSFER & DUTY	11
11.	RELEASE OF SECURITY INTEREST	11
12.	BUILDING WARRANTY INSURANCE	12
13.	GENERAL LAW LAND.....	12
14.	DEPOSIT.....	13
15.	DEPOSIT BOND.....	14
16.	BANK GUARANTEE.....	14
17.	SETTLEMENT	15
18.	ELECTRONIC SETTLEMENT.....	15
19.	GST.....	16
20.	LOAN	16
21.	BUILDING REPORT	16
22.	PEST REPORT	17
23.	ADJUSTMENTS	17
24.	FOREIGN RESIDENT CAPITAL GAINS WITHHOLDING.....	17
25.	GST WITHHOLDING	18
26.	TIME & CO OPERATION.....	19
27.	SERVICE.....	19
28.	NOTICES.....	20
29.	INSPECTION.....	20
30.	TERMS CONTRACT	20
31.	LOSS OR DAMAGE BEFORE SETTLEMENT	20
32.	BREACH	20
33.	INTEREST.....	21
34.	DEFAULT NOTICE.....	21
35.	DEFAULT NOT REMEDIED	21

NOTICE TO PURCHASERS OF PROPERTY OFF-THE-PLAN

Off-the-plan sales (Section 9AA(1A) of the *Sale of Land Act 1962*)

You may negotiate with the vendor about the amount of the deposit moneys payable under the contract of sale, up to 10 per cent of the purchase price.

A substantial period of time may elapse between the day on which you sign the contract of sale and the day on which you become the registered proprietor of the lot.

The value of the lot may change between the day on which you sign the contract of sale of that lot and the day on which you become the registered proprietor.

Particulars of sale

Vendor's estate agent

Name:

.....

Address:

.....

Email:

Tel: Mob: Fax: Ref:

Vendor: HIRAL NATAVARBHAI PATEL

Email:

Vendor's legal practitioner

MND Lawyers

1/530 Little Collins St. Melbourne VIC 3000

Email: info@mndlawyers.com.au

Tel: 03 9909 7780

Mob:

Fax: 03 9909 7788

Ref: MD:YS: 07/25

Purchaser

Name

Address

Purchaser's legal practitioner or conveyancer

Name:

Address:

Email:

Tel: Mob: Fax: Ref:

Land (general conditions 7 and 13)

The land is described in the table below –

Certificate of Title reference	being lot	on plan
Volume 11546 Folio 248	138	PS 644330L

If no title or plan references in the table, the land is as described in the section 32 statement or the register search statement and the document referred to as the diagram location in the register search statement attached to the section 32 statement

The land includes all improvements and fixtures as inspected.

Property address: 13 FEODORA CRESCENT NARRE WARREN VIC 3805

The address of the land is:

Goods sold with the land (general condition 6.3(f)) (*list or attach schedule*) as inspected. The Projector and the allied equipment (screens / speakers etc) is not part of the sale.

Payment

Price	\$	
Deposit	\$	by (of which \$ has been paid)
Balance	\$	payable at settlement

Deposit bond

☐ General condition 15 applies only if the box is checked

Bank guarantee

☐ General condition 16 applies only if the box is checked

GST (general condition 19)

Subject to general condition 19.2, the price includes GST (if any), unless the next box is checked

- ☐ GST (if any) must be paid in addition to the price if the box is checked
- ☐ This sale is a sale of land on which a 'farming business' is carried on which the parties consider meets the requirements of section 38-480 of the GST Act if the box is checked
- ☐ This sale is a sale of a going concern' if the box is checked
- ☐ The margin scheme will be used to calculate GST if the box is checked

Settlement (general conditions 17 & 26.2)

is due on

unless the land is a lot on an unregistered plan of subdivision, in which case settlement is due on the later of:

- the above date; or
- the 14th day after the vendor gives notice in writing to the purchaser of registration of the plan of subdivision; or
- the 14th day after the vendor gives notice in writing to the purchaser of grant of Occupancy Permit.

Lease (general condition 5.1)

☐ At settlement the purchaser is entitled to vacant possession of the property unless the box is checked, in which case the property is sold subject to*:

(*only one of the boxes below should be checked after carefully reading any applicable lease or tenancy document)

- ☐ a lease for a term ending on with options to renew, each of years
- OR
- ☐ a residential tenancy for a fixed term ending on
- OR
- ☐ a periodic tenancy determinable by notice

Terms contract (general condition 30)

☐ This contract is intended to be a terms contract within the meaning of the *Sale of Land Act 1962* if the box is checked. (*Reference should be made to general condition 30 and any further applicable provisions should be added as special conditions*)

Loan (general condition

☐ This contract is subject to a loan being approved and the following details apply if the box is checked:

Lender:

(or another lender chosen by the purchaser)

Loan amount: no more than

Approval date:

Building report

☐ General condition 21 applies only if the box is checked

Pest report

☐ General condition 22 applies only if the box is checked

Special Conditions

Instructions: *It is recommended that when adding special conditions:*

- *each special condition is numbered;*
- *the parties initial each page containing special conditions;*
- *a line is drawn through any blank space remaining on the last page; and*
- *attach additional pages if there is not enough space*
- *special condition will apply if the box next to it is crossed out*

☐ **Special condition 1 – Tax invoice.**

General condition 13.3 is replaced with the following:

- 13.3 If the vendor makes a taxable supply under this contract (that is not a margin scheme supply) and
- (a) the price includes GST; or
 - (b) the purchaser is obliged to pay an amount for GST in addition to the price (because the price is "plus GST" or under general condition 13.1(a), (b) or (c)),

the purchaser is not obliged to pay the GST included in the price, or the additional amount payable for GST, until a tax invoice has been provided.

☒ **Special condition 2 – Adjustments**

(i) General condition 23.4 is added:

- 23.4 The purchaser must deliver the statement of adjustments to the Vendor no less than four (4) business days before the Settlement Date. The Vendor shall not be obliged to complete this Contract until the expiration of four (4) business days from the receipt of the Statement of Adjustments. The Purchaser will be deemed to have made default in payment of the residue of purchase moneys as from the settlement date where the Statement of Adjustments is not delivered in accordance with this Special Condition. The Purchaser must pay an administration fee of \$330.00 if such default occurs.

- 23.5 In addition to the general conditions all the rates, taxes, Owners corporation charges and other out goings must be adjusted between the vendor and the purchaser from the date of the contract.

(ii) The purchaser agrees that if this property has not been separately assessed by the council for finalising the rates payable by the Vendor. The purchaser agrees not to make any claim against the vendor or seek reimbursement or payment for any rates due and payable for the parent lot.

(iii) The purchaser must not delay Settlement on the grounds that the council rates (for the parent lot) are unpaid at settlement.

☒ **Special condition 3 – Delay**

3.1 In case the Vendors shall be restrained or prevented in any manner whatsoever from conveying title by the original date for completion, the Vendors may extend the date for completion for a period(s), the total of which shall not exceed thirty (30) days from the original date for completion, by notice in writing to the Purchaser, which notice shall specify such extended date(s) for completion.

3.2 If there is such an extension and if the Vendors shall still be restrained or prevented from conveying title in terms of this Contract, the Vendors may terminate this contract by notice in writing to the Purchaser and all deposit and other monies received by the Vendors or stakeholder, on account of the purchase price, shall be refunded to the Purchaser.

3.3. If this Contract is validly terminated by the Purchaser as a result of the default of the vendors, all monies paid under this Contract shall be refunded to the Purchaser without interest, costs or damages and the same shall be accepted by the Purchaser in full and final satisfaction of all claims.

☒ **Special condition 4– Default**

4.1 Default Under the Contract

If the Purchaser makes default under this Contract and the Vendor serves on the Purchaser a notice in respect of that default in accordance with general condition 34, the Purchaser must pay all the Vendor's legal costs of and incidental to that default and notice and the Purchaser will be deemed not to have remedied that default until those costs have been paid.

4.2 Default Interest

General Condition 33 is deleted and replaced by the following:

"33.1- Interest at a rate of 5% per annum plus the rate for the time being fixed by section 2 of the *Penalty Interest Rates*

Act 1983 is payable at settlement on any money owing under the contract during the period of default, without affecting any other rights of the offended party.”

33.2- The Vendor gives notice to the Purchaser that, in the event that the Purchaser fails to complete the purchase of the Property on the due date under the Contract, the Vendor will or may suffer the following losses and expenses which the Purchaser would be required to pay, in addition to the interest chargeable (as per special condition 33.1) on the balance of purchase moneys, in accordance with the terms of the Contract:-

- (a) The cost of obtaining bridging finance to complete the Vendor's purchase of another property and interest charged on such bridging finance.
- (b) Interest payable to the Vendor under any existing mortgage over the Property calculated from the due date for settlement.
- (c) Accommodation expenses necessarily incurred by the Vendor.
- (d) Legal costs and expenses as between Solicitor and our client.
- (e) Penalties payable by the Vendor through any delay in completion of the Vendor's purchase of another property.”

☒ **Special condition 5– Guarantors (if applicable)**

If the Purchaser is a company then upon the signing hereof the Purchaser shall also procure the execution by the Directors of the Purchaser Company of the Guarantee annexed hereto and the Guarantor/s shall pay the duty payable, if any, on the Guarantee.

☒ **Special condition 6 – Purchaser's Acknowledgments**

6.1 The Purchaser has Received Documents

The Purchaser acknowledges that before signing this Contract or any other binding agreement or document in relation to the purchase of the Property the Purchaser:

- (a) Has received a signed copy of the Vendor's Statement; and
- (b) A copy of this Contract.

☒ **Special Condition 7 – Inspection**

7.1 Property is as inspected

- (a) The Purchaser admits that the Property as offered for sale and inspected by it is identical with that described in the title particulars given in the Particulars of Sale to this Contract.
- (b) The Purchaser acknowledges that they are purchasing the property as a result of their own enquiries and inspection and not relying upon any representation made by the vendor or any other person on the vendor's behalf.
 - i) In its present condition and state of repair;
 - ii) Subject to all defects latent and patent;
 - iii) Subject to any infestations and dilapidation;
 - iv) Subject to all existing water, sewerage, drainage and plumbing services and connections in respect of the property; and
 - v) Subject to any non-compliance, that is disclosed herein, with the Local Government Act or any Ordinance under that Act in respect of any building on the land.

The Purchaser agrees not to seek to terminate/ rescind or make any objections requisition or claim for compensation arising out of any of the matters covered by this clause.

7.2 Property Purchased on “As Is” Basis

The Purchaser acknowledges that it purchases the Property on an “as is” basis and after making all enquiries as to the past uses and the present nature and condition of the Property. The price has been agreed upon the basis of the existing amenities and the Purchaser assume responsibility for and indemnifies the Vendor against all charges or other liabilities in respect of any road making, fencing or other works whatsoever which have not actually been commenced as at the date of this Contract, notwithstanding that any notice in respect of any such works may have been received by the Vendor prior to the date of this Contract.

☒ **Special condition 8 – Property Sold Subject to Planning Restrictions**

- (a) The Purchaser accepts and purchases the property subject to all existing and proposed restrictions affecting the use, development or enjoyment of the property under any act, order, regulations, by-law, local law, restriction or condition imposed upon the property by or with semi-governmental or judicial entity or authority including without limitation any applicable environment planning instrument or deemed environmental planning instrument or resolution of any responsible authority made or which may later be made under the *Local Government Act 1989* (Vic), the *Planning and Environment Act 1987* (Vic), the *Environment Protection Act 1970* (Vic), the conditions of any planning permit or other act, planning approval or instrument applicable to the Property.
- (b) The Purchaser shall take title subject to all such restrictions and conditions described in the preceding subparagraph and shall not make any requisition or objection or claim on that ground any compensation with respect thereto or in respect of any proposed amendment to any planning control now or later applicable to the Property.
- (c) The restriction and conditions described in this Special Condition do not constitute a defect in the Vendor's title to the Property.

☒ **Special condition 9– Inconsistency**

If there is any inconsistency between these special conditions and the general conditions, the special conditions are to prevail to the extent of the inconsistency and each party agrees to take any steps which are necessary to procure the general conditions are altered to eliminate the inconsistency.

☒ **Special condition 10 - Restriction on Re-Sale**

The Purchaser must not prior to settlement without the written consent of the Vendor sell, transfer, assign, mortgage or otherwise encumber or deal with the Property or the Purchaser's rights or interest pursuant to this Contract.

☐ **Special condition 11- Occupancy permit**

11.1. This Contract is subject to and conditional upon the vendor obtaining the occupancy permit within 6 months from the Day of Sale ('End Date').

11.2. If occupancy permit is, or in the Vendor's reasonable opinion is likely to be delayed as a result of any one or more of the following events;

- a) Conditions or requirements being imposed by:
 - (i) Any act or law;
 - (ii) Any statutory, government or like body; or
 - (iii) A building surveyor or other building practitioner (as defined by the Building Act 1993);
- b) Any delay by any statutory, government or like body or building surveyor or other building practitioner in providing any necessary approvals or consents, provided that reasonable steps have been taken by the Vendor to obtain such approvals or consents; or;
- c) Strikes or lockouts or other such industrial action which affects any person employed in the construction of the property or the building or the supply of materials or service to be used in the construction of the property or the building.
- d) Riots, civil commotion, terrorist attacks, malicious damage, burglary or theft.
- e) Any act of God, fire, flood, storm, tempest, lightning, earthquake, or explosion or inclement weather; or
- f) Any other cause beyond the control of the Vendor or the builder;

Then the vendor can extend the End Date to such other date as the vendor nominate and the Vendor must give the Purchaser written notice of the new End Date.

11.3. If any condition or requirement imposed by any relevant authority in respect of issuing the occupancy permit and in the Vendor's opinion, too onerous, or if the occupancy permit is refused, the Vendor may terminate this Contract by notice in writing to the Purchaser or the Purchaser's solicitor, whereupon the Deposit must be repaid to the Purchaser.

11.4. If the occupancy permit is not obtained by the end date either party has the right, before the Plan is registered, to rescind this Contract by giving notice in writing to that effect to the other party or their solicitor whereupon the Deposit must be repaid to the Purchaser.

11.5. The Vendor and the Purchaser agree that neither party can object to, make any requisition or claim or claim any compensation from the other party for any matter under this Contract or arising from, or out of, the recession of this contract under this special condition 12 or the failure of the Vendor to procure occupancy permit.

☐ **Special condition 12 - Building Contract**

12.1. The Purchaser acknowledges that:

- a) the Vendor is not and will not be the Builder of the Building Works;
- b) the Dwelling will be constructed under the Building Contract and the construction of the Dwelling will be generally in accordance with the Plans and Specifications; and
- c) this Contract is not a major domestic building contract for the purposes of the Domestic Building Contracts Act 1995 (Vic).

12.2. Construction

The Vendor has entered into, or intends to enter into, or has caused, or will cause entry into the Building Contract.

12.3. Completion of Building

The issuing of:

- (i) The Occupancy Permit; and
- (ii) A certificate of practical completion

For the Property will be conclusive evidence that the Dwelling on the Property is completed. The Purchaser must not make any requisition or objection, or exercise any of the Purchaser Rights even if defective materials or faulty workmanship are evident on or before the Settlement Date.

☐ **Special condition 13 -Natural Products and other finishes**

13.1 The Purchaser acknowledges and agrees that the materials used in the construction of the Property (particularly in the finishes and fittings):

- (i) may comprise natural products (such as stone, timber and the like);
- (ii) may exhibit variations in the shade, colour, texture, surface, finish, markings or the like that contain natural fissures, lines, indentations or the like, and may fade or change colour over time;
- (iii) may expand, contract, or distort over time as a result of exposure to heat, cold, weather, or the like;
- (iv) may mark or stain if exposed to certain substances;
- (v) may be damaged or disfigured by impact or scratching or other means; and
- (vi) may be subject to shade variations and manufacture batching (for example: in carpet, tiles, and other finishes).

13.2 The Purchaser must not exercise any Purchaser Rights because of any of the occurrences referred to in special condition 13.1.

☒ **Special condition 14 - Stamp Duty**

14.1 The Purchaser acknowledges and agrees that:

- a) For the calculation of stamp duty under the Duties Act 2000 (Vic), the Vendor estimate that the percentage of the construction completed as at the Day of Sale is as set out in the Particular of Sale.
- b) Neither the Vendor nor anyone acting on the Vendor's behalf has made any warranty as to the amount of stamp duty payable on the transfer to the Purchaser.
- c) The Purchaser has made its own enquiries and investigations as to the amount of stamp duty payable on the transfer to the Purchaser, and the Purchaser acknowledges that it will be liable for all stamp duty payable on the transfer.

d) The Purchaser will not make claim against the Vendor because of the amount of stamp duty that the State Revenue Office may assess.

14.2. The Purchaser will have no right to object to any information contained in the Land and Building Packages Statutory Declaration sworn by the Vendor and provided to the Purchaser prior to or on the Settlement Date.

☒ **Special condition 15 – Finance Decline (if applicable)**

In the event of failure to obtain finance the Purchaser agrees to provide the Vendor upon request a copy of the Formal Finance Decline letter from the Registered Lending Institution. For avoidance of any doubt any letter by the broker (who is engaged to secure the finance) is unacceptable.

☒ **Special condition 16 – Land Tax**

- (i) Notwithstanding any condition to the contrary, the land tax is not an adjustable item, and it must be paid by the vendor. For avoidance of any doubt, there will be no apportionment of land tax between the vendor and purchaser.
- (ii) General Condition 23 (2) (b) is deleted.

☒ **Special condition 17- Notices**

The Purchaser is responsible for any notice, order, demand or levy imposing liability on the Property that is issued or made on or after the Day of Sale that does not relate to periodic outgoings. The Purchaser may enter the Property, by giving the Vendor reasonable prior notice and at reasonable times, to comply with that responsibility where action is required before Settlement. The Purchaser must use reasonable endeavours not to disrupt the use and occupation of the Property by the Vendor (or the occupants, where the Property is leased) and indemnifies the Vendor for any loss or damage suffered by the Vendor as a consequence of the Purchaser exercising its rights under this Special Condition. The Purchaser enters the Property at its own risk.

☒ **Special condition 18- Multiple Purchasers**

- (a) If there is more than one purchaser, it is the purchaser's responsibility to ensure the contract correctly records at the date of sale the proportions in which they are buying the property (the proportions).
- (b) If the proportions recorded in the transfer differ from those recorded in the contract, it is the purchaser's responsibility to pay any additional duty which may be assessed as a result of the variation.
- (c) The purchasers fully indemnify the vendor, the vendors agent and the vendors legal practitioner against any claims or demands which may be made against any or all of them in relation to any additional duty payable as a result of the proportions in the transfer differing from those in the contract.
- (d) This Special Condition will not merge on completion.

☒ **Special condition 19– ADDITIONAL FEES**

The purchaser agrees to pay the following fees and charges (if applicable):

- (a) Default Notice fee: \$990.00
- (b) Rescission Notice Fee: \$990.00
- (c) Reschedule fees \$440.00

General Conditions

Contract signing

1. ELECTRONIC SIGNATURE

- 1.1 In this general condition “electronic signature” means a digital signature or a visual representation of a person’s handwritten signature or mark which is placed on a physical or electronic copy of this contract by electronic or mechanical means, and “electronically signed” has a corresponding meaning.
- 1.2 The parties consent to this contract being signed by or on behalf of a party by an electronic signature.
- 1.3 Where this contract is electronically signed by or on behalf of a party, the party warrants and agrees that the electronic signature has been used to identify the person signing and to indicate that the party intends to be bound by the electronic signature.
- 1.4 This contract may be electronically signed in any number of counterparts which together will constitute the one document.
- 1.5 Each party consents to the exchange of counterparts of this contract by delivery by email or such other electronic means as may be agreed in writing.
- 1.6 Each party must upon request promptly deliver a physical counterpart of this contract with the handwritten signature or signatures of the party and all written evidence of the authority of a person signing on their behalf, but a failure to comply with the request does not affect the validity of this contract.

2. LIABILITY OF SIGNATORY

Any signatory for a proprietary limited company purchaser is personally liable for the due performance of the purchaser’s obligations as if the signatory were the purchaser in the case of a default by a proprietary limited company purchaser.

3. GUARANTEE

The vendor may require one or more directors of the purchaser to guarantee the purchaser’s performance of this contract if the purchaser is a proprietary limited company.

4. NOMINEE

The purchaser may no later than 14 days before the due date for settlement nominate a substitute or additional person to take a transfer of the land, but the named purchaser remains personally liable for the due performance of all the purchase’s obligations under this contract.

Title

5. ENCUMBRANCES

- 5.1 The purchaser buys the property subject to:
 - (a) any encumbrance shown in the section 32 statement other than mortgages or caveats; and
 - (b) any reservations, exceptions and conditions in the crown grant; and
 - (c) any lease or tenancy referred to in the particulars of sale.
- 5.2 The purchaser indemnifies the vendor against all obligations under any lease or tenancy that are to be performed by the landlord after settlement.

6. VENDOR WARRANTIES

- 6.1 The vendor warrants that these general conditions 1 to 35 are identical to the general conditions 1 to 35 in the form of contract of sale of land published by the Law Institute of Victoria Limited and the Real Estate Institute of Victoria Pty Ltd in the month and year set out at the foot of this page.
- 6.2 The warranties in general conditions 6.3 and 6.4 replace the purchaser’s right to make requisitions and inquiries.
- 6.3 The vendor warrants that the vendor:
 - (a) has, or by the due date for settlement will have, the right to sell the land; and
 - (b) is under no legal disability; and
 - (c) is in possession of the land, either personally or through a tenant; and
 - (d) has not previously sold or granted any option to purchase, agreed to lease or granted a pre-emptive right which is current over the land and which gives another party rights which have priority over the interest of the purchaser; and
 - (e) will at settlement be the holder of an unencumbered estate in fee simple in the land; and
 - (f) will at settlement be the unencumbered owner of any improvements, fixtures, fittings and goods sold with the land.

- 6.4 The vendor further warrants that the vendor has no knowledge of any of the following:
- (a) public rights of way over the land;
 - (b) easements over the land;
 - (c) lease or other possessory agreement affecting the land;
 - (d) notice or order directly or indirectly affecting the land which will not be dealt with at settlement, other than the usual rate notices and any land tax notices;
 - (e) legal proceedings which would render the sale of the land void or voidable or capable of being set aside.
- 6.5 The warranties in general conditions 6.3 and 6.4 are subject to any contrary provisions in this contract and disclosures in the section 32 statement.
- 6.6 If sections 137B and 137C of the *Building Act* 1993 apply to this contract, the vendor warrants that:
- (a) all domestic building work carried out in relation to the construction by or on behalf of the vendor of the home was carried out in a proper and workmanlike manner; and
 - (b) all materials used in that domestic building work were good and suitable for the purpose for which they were used and that, unless otherwise stated in the contract, those materials were new; and
 - (c) domestic building work was carried out in accordance with all laws and legal requirements, including, without limiting the generality of this warranty, the *Building Act* 1993 and regulations made under the *Building Act* 1993.
- 6.7 Words and phrases used in general condition 6.6 which are defined in the *Building Act* 1993 have the same meaning in general condition 6.6.

7. IDENTITY OF THE LAND

- 7.1 An omission or mistake in the description of the property or any deficiency in the area, description or measurements of the land does not invalidate the sale.
- 7.2 The purchaser may not:
- (a) make any objection or claim for compensation for any alleged misdescription of the property or any deficiency in its area or measurements; or
 - (b) require the vendor to amend title or pay any cost of amending title.

8. SERVICES

- 8.1 The vendor does not represent that the services are adequate for the purchaser's proposed use of the property and the vendor advises the purchaser to make appropriate inquiries. The condition of the services may change between the day of sale and settlement and the vendor does not promise that the services will be in the same condition at settlement as they were on the day of sale.
- 8.2 The purchaser is responsible for the connection of all services to the property after settlement and the payment of any associated cost.

9. CONSENTS

The vendor must obtain any necessary consent or licence required for the vendor to sell the property. The contract will be at an end and all money paid must be refunded if any necessary consent or licence is not obtained by settlement.

10. TRANSFER & DUTY

- 10.1 The purchaser must prepare and deliver to the vendor at least 7 days before the due date for settlement any paper transfer of land document which is necessary for this transaction. The delivery of the transfer of land document is not acceptance of title.
- 10.2 The vendor must promptly initiate the Duties on Line or other form required by the State Revenue Office in respect of this transaction, and both parties must co-operate to complete it as soon as practicable.

11. RELEASE OF SECURITY INTEREST

- 11.1 This general condition applies if any part of the property is subject to a security interest to which the *Personal Property Securities Act* 2009 (Cth) applies.
- 11.2 For the purposes of enabling the purchaser to search the Personal Property Securities Register for any security interests affecting any personal property for which the purchaser may be entitled to a release, statement, approval or correction in accordance with general condition 11.4, the purchaser may request the vendor to provide the vendor's date of birth to the purchaser. The vendor must comply with a request made by the purchaser under this condition if the purchaser makes the request at least 21 days before the due date for settlement.
- 11.3 If the purchaser is given the details of the vendor's date of birth under condition 11.2, the purchaser must
- (a) only use the vendor's date of birth for the purposes specified in condition 11.2; and
 - (b) keep the date of birth of the vendor secure and confidential.

- 11.4 The vendor must ensure that at or before settlement, the purchaser receives –
- (a) a release from the secured party releasing the property from the security interest; or
 - (b) a statement in writing in accordance with section 275(1)(b) of the *Personal Property Securities Act 2009* (Cth) setting out that the amount or obligation that is secured is nil at settlement; or
 - (c) a written approval or correction in accordance with section 275(1)(c) of the *Personal Property Securities Act 2009* (Cth) indicating that, on settlement, the personal property included in the contract is not or will not be property in which the security interest is granted.
- 11.5 Subject to general condition 11.6, the vendor is not obliged to ensure that the purchaser receives a release, statement, approval or correction in respect of personal property –
- (a) that –
 - (i) the purchaser intends to use predominately for personal, domestic or household purposes; and
 - (ii) has a market value of not more than \$5000 or, if a greater amount has been prescribed for the purposes of section 47(1) of the *Personal Property Securities Act 2009* (Cth), not more than that prescribed amount; or
 - (b) that is sold in the ordinary course of the vendor's business of selling personal property of that kind.
- 11.6 The vendor is obliged to ensure that the purchaser receives a release, statement, approval or correction in respect of personal property described in general condition 11.5 if –
- (a) the personal property is of a kind that may be described by a serial number in the Personal Property Securities Register; or
 - (b) the purchaser has actual or constructive knowledge that the sale constitutes a breach of the security agreement that provides for the security interest.
- 11.7 A release for the purposes of general condition 11.4(a) must be in writing.
- 11.8 A release for the purposes of general condition 11.4(a) must be effective in releasing the goods from the security interest and be in a form which allows the purchaser to take title to the goods free of that security interest.
- 11.9 If the purchaser receives a release under general condition 11.4(a) the purchaser must provide the vendor with a copy of the release at or as soon as practicable after settlement.
- 11.10 In addition to ensuring a release is received under general condition 11.4(a), the vendor must ensure that at or before settlement the purchaser receives a written undertaking from a secured party to register a financing change statement to reflect that release if the property being released includes goods of a kind that are described by serial number in the Personal Property Securities Register.
- 11.11 The purchaser must advise the vendor of any security interest that is registered on or before the day of sale on the Personal Property Securities Register, which the purchaser reasonably requires to be released, at least 21 days before the due date for settlement.
- 11.12 The vendor may delay settlement until 21 days after the purchaser advises the vendor of the security interests that the purchaser reasonably requires to be released if the purchaser does not provide an advice under general condition 11.11.
- 11.13 If settlement is delayed under general condition 11.12, the purchaser must pay the vendor –
- (a) interest from the due date for settlement until the date on which settlement occurs or 21 days after the vendor receives the advice, whichever is the earlier; and
 - (b) any reasonable costs incurred by the vendor as a result of the delay – as though the purchaser was in default.
- 11.14 The vendor is not required to ensure that the purchaser receives a release in respect of the land. This general condition 11.14 applies despite general condition 11.1.
- 11.15 Words and phrases which are defined in the *Personal Property Securities Act 2009* (Cth) have the same meaning in general condition 11 unless the context requires otherwise.

12. BUILDING WARRANTY INSURANCE

The vendor warrants that the vendor will provide at settlement details of any current builder warranty insurance in the vendor's possession relating to the property if requested in writing to do so at least 21 days before settlement.

13. GENERAL LAW LAND

- 13.1 The vendor must complete a conversion of title in accordance with section 14 of the *Transfer of Land Act 1958* before settlement if the land is the subject of a provisional folio under section 23 of that Act.
- 13.2 The remaining provisions of this general condition 13 only apply if any part of the land is not under the operation of the *Transfer of Land Act 1958*.

- 13.3 The vendor is taken to be the holder of an unencumbered estate in fee simple in the land if there is an unbroken chain of title starting at least 30 years before the day of sale proving on the face of the documents the ownership of the entire legal and equitable estate without the aid of other evidence.
- 13.4 The purchaser is entitled to inspect the vendor's chain of title on request at such place in Victoria as the vendor nominates.
- 13.5 The purchaser is taken to have accepted the vendor's title if:
- (a) 21 days have elapsed since the day of sale; and
 - (b) the purchaser has not reasonably objected to the title or reasonably required the vendor to remedy a defect in the title.
- 13.6 The contract will be at an end if:
- (a) the vendor gives the purchaser a notice that the vendor is unable or unwilling to satisfy the purchaser's objection or requirement and that the contract will end if the objection or requirement is not withdrawn within 14 days of the giving of the notice; and
 - (b) the objection or requirement is not withdrawn in that time.
- 13.7 If the contract ends in accordance with general condition 13.6, the deposit must be returned to the purchaser and neither party has a claim against the other in damages.
- 13.8 General condition 17.1 [settlement] should be read as if the reference to 'registered proprietor' is a reference to 'owner' in respect of that part of the land which is not under the operation of the *Transfer of Land Act 1958*.
-

Money

14. DEPOSIT

- 14.1 The purchaser must pay the deposit:
- (a) to the vendor's licensed estate agent; or
 - (b) if there is no estate agent, to the vendor's legal practitioner or conveyancer; or
 - (c) if the vendor directs, into a special purpose account in an authorised deposit-taking institution in Victoria specified by the vendor in the joint names of the purchaser and the vendor.
- 14.2 If the land is sold on an unregistered plan of subdivision, the deposit:
- (a) must not exceed 10% of the price; and
 - (b) must be paid to the vendor's estate agent, legal practitioner or conveyancer and held by the estate agent, legal practitioner or conveyancer on trust for the purchaser until registration of the plan of subdivision.
- 14.3 The deposit must be released to the vendor if:
- (a) the vendor provides particulars, to the satisfaction of the purchaser; that either
 - (i) there are no debts secured against the property; or
 - (ii) if there are any debts, the total amount of those debts together with any amounts to be withheld in accordance with general conditions 24 and 25 does not exceed 80% of the sale price; and
 - (b) at least 28 days have elapsed since the particulars were given to the purchaser under paragraph (a); and
 - (c) all conditions of section 27 of the *Sale of Land Act 1962* have been satisfied.
- 14.4 The stakeholder must pay the deposit and any interest to the party entitled when the deposit is released, the contract is settled, or the contract is ended.
- 14.5 The stakeholder may pay the deposit and any interest into court if it is reasonable to do so.
- 14.6 Where the purchaser is deemed by section 27(7) of the *Sale of Land Act 1962* to have given the deposit release authorisation referred to in section 27(1), the purchaser is also deemed to have accepted title in the absence of any prior express objection to title.
- 14.7 Payment of the deposit may be made or tendered:
- (a) in cash up to \$1,000 or 0.2% of the price, whichever is greater; or
 - (b) by cheque drawn on an authorised deposit-taking institution; or
 - (c) by electronic funds transfer to a recipient having the appropriate facilities for receipt.
- However, unless otherwise agreed:

- (d) payments may not be made by credit card, debit card or any other financial transfer system that allows for any chargeback or funds reversal other than for fraud or mistaken payment, and
 - (e) any financial transfer or similar fees or deductions from the funds transferred, other than any fees charged by the recipient's authorised deposit-taking institution, must be paid by the remitter.
- 14.8 Payment by electronic transfer is made when cleared funds are received in the recipient's bank account.
- 14.9 Before the funds are electronically transferred the intended recipient must be notified in writing and given sufficient particulars to readily identify the relevant transaction.
- 14.10 As soon as the funds have been electronically transferred the intended recipient must be provided with the relevant transaction number or reference details.
- 14.11 For the purposes of this general condition 'authorised deposit-taking institution' means a body corporate for which an authority under section 9(3) of the *Banking Act 1959* (Cth) is in force.

15. DEPOSIT BOND

- 15.1 This general condition only applies if the applicable box in the particulars of sale is checked.
- 15.2 In this general condition "deposit bond" means an irrevocable undertaking to pay on demand an amount equal to the deposit or any unpaid part of the deposit. The issuer and the form of the deposit bond must be satisfactory to the vendor. The deposit bond must have an expiry date at least 45 days after the due date for settlement.
- 15.3 The purchaser may deliver a deposit bond to the vendor's estate agent, legal practitioner or conveyancer within 7 days after the day of sale.
- 15.4 The purchaser may at least 45 days before a current deposit bond expires deliver a replacement deposit bond on the same terms and conditions.
- 15.5 Where a deposit bond is delivered, the purchaser must pay the deposit to the vendor's legal practitioner or conveyancer on the first to occur of:
- (a) settlement;
 - (b) the date that is 45 days before the deposit bond or any replacement deposit bond expires;
 - (c) the date on which this contract ends in accordance with general condition 35.2 [default not remedied] following breach by the purchaser; and
 - (d) the date on which the vendor ends this contract by accepting repudiation of it by the purchaser.
- 15.6 The vendor may claim on the deposit bond without prior notice if the purchaser defaults under this contract or repudiates this contract and the contract is ended. The amount paid by the issuer satisfies the obligations of the purchaser under general condition 15.5 to the extent of the payment.
- 15.7 Nothing in this general condition limits the rights of the vendor if the purchaser defaults under this contract or repudiates this contract, except as provided in general condition 15.6.
- 15.8 This general condition is subject to general condition 14.2 [deposit].

16. BANK GUARANTEE

- 16.1 This general condition only applies if the applicable box in the particulars of sale is checked.
- 16.2 In this general condition:
- (a) "bank guarantee" means an unconditional and irrevocable guarantee or undertaking by a bank in a form satisfactory to the vendor to pay on demand any amount under this contract agreed in writing, and
 - (b) "bank" means an authorised deposit-taking institution under the *Banking Act 1959* (Cth).
- 16.3 The purchaser may deliver a bank guarantee to the vendor's legal practitioner or conveyancer.
- 16.4 The purchaser must pay the amount secured by the bank guarantee to the vendor's legal practitioner or conveyancer on the first to occur of:
- (a) settlement;
 - (b) the date that is 45 days before the bank guarantee expires;
 - (c) the date on which this contract ends in accordance with general condition 35.2 [default not remedied] following breach by the purchaser; and
 - (d) the date on which the vendor ends this contract by accepting repudiation of it by the purchaser.
- 16.5 The vendor must return the bank guarantee document to the purchaser when the purchaser pays the amount secured by the bank guarantee in accordance with general condition 16.4.
- 16.6 The vendor may claim on the bank guarantee without prior notice if the purchaser defaults under this contract or repudiates this contract and the contract is ended. The amount paid by the bank satisfies the obligations of the purchaser under general condition 16.4 to the extent of the payment.

- 16.7 Nothing in this general condition limits the rights of the vendor if the purchaser defaults under this contract or repudiates this contract except as provided in general condition 16.6.
- 16.8 This general condition is subject to general condition 14.2 [deposit].

17. SETTLEMENT

- 17.1 At settlement:
- (a) the purchaser must pay the balance; and
 - (b) the vendor must:
 - (i) do all things necessary to enable the purchaser to become the registered proprietor of the land; and
 - (ii) give either vacant possession or receipt of rents and profits in accordance with the particulars of sale.
- 17.2 Settlement must be conducted between the hours of 10.00 a.m. and 4.00 p.m. unless the parties agree otherwise.
- 17.3 The purchaser must pay all money other than the deposit in accordance with a written direction of the vendor or the vendor's legal practitioner or conveyancer.

18. ELECTRONIC SETTLEMENT

- 18.1 Settlement and lodgement of the instruments necessary to record the purchaser as registered proprietor of the land will be conducted electronically in accordance with the Electronic Conveyancing National Law. This general condition 18 has priority over any other provision of this contract to the extent of any inconsistency.
- 18.2 A party must immediately give written notice if that party reasonably believes that settlement and lodgement can no longer be conducted electronically. Special condition 18 ceases to apply from when such a notice is given.
- 18.3 Each party must:
- (a) be, or engage a representative who is, a subscriber for the purposes of the Electronic Conveyancing National Law,
 - (b) ensure that all other persons for whom that party is responsible and who are associated with this transaction are, or engage, a subscriber for the purposes of the Electronic Conveyancing National Law, and
 - (c) conduct the transaction in accordance with the Electronic Conveyancing National Law.
- 18.4 The vendor must open the electronic workspace ("workspace") as soon as reasonably practicable and nominate a date and time for settlement. The inclusion of a specific date for settlement in a workspace is not of itself a promise to settle on that date or at that time. The workspace is an electronic address for the service of notices and for written communications for the purposes of any electronic transactions legislation.
- 18.5 This general condition 18.5 applies if there is more than one electronic lodgement network operator in respect of the transaction. In this general condition 18.5 "the transaction" means this sale and purchase and any associated transaction involving any of the same subscribers.
- To the extent that any interoperability rules governing the relationship between electronic lodgement network operators do not provide otherwise:
- (a) the electronic lodgement network operator to conduct all the financial and lodgement aspects of the transaction after the workspace locks must be one which is willing and able to conduct such aspects of the transaction in accordance with the instructions of all the subscribers in the workspaces of all the electronic lodgement network operators after the workspace locks;
 - (b) if two or more electronic lodgement network operators meet that description, one may be selected by purchaser's incoming mortgagee having the highest priority but if there is no mortgagee of the purchaser, the vendor must make the selection.
- 18.6 Settlement occurs when the workspace records that:
- (a) there has been an exchange of funds or value between the exchange settlement account or accounts in the Reserve Bank of Australia of the relevant financial institutions or their financial settlement agents in accordance with the instructions of the parties; or
 - (b) if there is no exchange of funds or value, the documents necessary to enable the purchaser to become registered proprietor of the land have been accepted for electronic lodgement
- 18.7 The parties must do everything reasonably necessary to effect settlement:
- (a) electronically on the next business day; or
 - (b) at the option of either party, otherwise than electronically as soon as possible –
- if, after the locking of the workspace at the nominated settlement time, settlement in accordance with special condition 18.6 has not occurred by 4.00 pm, or 6.00 pm if the nominated time for settlement is after 4.00 pm.
- 18.8 Each party must do everything reasonably necessary to assist the other party to trace and identify the recipient of any missing or mistaken payment and to recover the missing or mistaken payment.
- 18.9 The vendor must before settlement:
- (a) deliver any keys, security devices and codes ("keys") to the estate agent named in the contract,
 - (b) direct the estate agent to give the keys to the purchaser or the purchaser's nominee on notification of settlement by the vendor, the vendors subscriber or the electronic lodgement network operator,

- (c) deliver all other physical documents and items (other than the goods sold by the contract) to which the purchaser is entitled at settlement, and any keys if not delivered to the estate agent, to the vendor's subscriber or, if there is no vendor's subscriber, confirm in writing to the purchaser that the vendor holds those documents, items and keys at the vendor's address set out in the contract, and

give, or direct its subscriber to give, all those documents and items and any such keys to the purchaser or the purchaser's nominee on notification by the electronic lodgement network operator of settlement.

19. GST

- 19.1 The purchaser does not have to pay the vendor any amount in respect of GST in addition to the price if the particulars of sale specify that the price includes GST (if any).
- 19.2 The purchaser must pay to the vendor any GST payable by the vendor in respect of a taxable supply made under this contract in addition to the price if:
 - (a) the particulars of sale specify that GST (if any) must be paid in addition to the price; or
 - (b) GST is payable solely as a result of any action taken or intended to be taken by the purchaser after the day of sale, including a change of use; or
 - (c) the particulars of sale specify that the supply made under this contract is of land on which a 'farming business' is carried on and the supply (or part of it) does not satisfy the requirements of section 38-480 of the GST Act; or
 - (d) the particulars of sale specify that the supply made under this contract is of a going concern and the supply (or a part of it) does not satisfy the requirements of section 38-325 of the GST Act.
- 19.3 The purchaser is not obliged to pay any GST under this contract until a tax invoice has been given to the purchaser.
- 19.4 If the particulars of sale specify that the supply made under this contract is of land on which a 'farming business' is carried on:
 - (a) the vendor warrants that the property is land on which a farming business has been carried on for the period of 5 years preceding the date of supply; and
 - (b) the purchaser warrants that the purchaser intends that a farming business will be carried on after settlement on the property.
- 19.5 If the particulars of sale specify that the supply made under this contract is a 'going concern':
 - (a) the parties agree that this contract is for the supply of a going concern; and
 - (b) the purchaser warrants that the purchaser is, or prior to settlement will be, registered for GST; and
 - (c) the vendor warrants that the vendor will carry on the going concern until the date of supply.
- 19.6 If the particulars of sale specify that the supply made under this contract is a 'margin scheme' supply, the parties agree that the margin scheme applies to this contract.
- 19.7 In this general condition:
 - (a) 'GST Act' means *A New Tax System (Goods and Services Tax) Act 1999* (Cth); and
 - (b) 'GST' includes penalties and interest.

20. LOAN

- 20.1 If the particulars of sale specify that this contract is subject to a loan being approved, this contract is subject to the lender approving the loan on the security of the property by the approval date or any later date allowed by the vendor.
- 20.2 The purchaser may end the contract if the loan is not approved by the approval date, but only if the purchaser:
 - (a) immediately applied for the loan; and
 - (b) did everything reasonably required to obtain approval of the loan; and
 - (c) serves written notice ending the contract, together with written evidence of rejection or non-approval of the loan, on the vendor within 2 clear business days after the approval date or any later date allowed by the vendor; and
 - (d) is not in default under any other condition of this contract when the notice is given.
- 20.3 All money must be immediately refunded to the purchaser if the contract is ended.

21. BUILDING REPORT

- 21.1 This general condition only applies if the applicable box in the particulars of sales is checked.
- 21.2 The purchaser may end this contract within 14 days from the days of sale if the purchaser:
 - (a) obtains a written report from a registered building practitioner or architect which discloses a current defect in a structure on the land and designates it as a major building defect;
 - (b) gives the vendor a copy of the report and a written notice ending this contract; and
 - (c) is not in then in default.
- 21.3 All money paid must be immediately refunded to the purchaser if the contract ends in accordance with this general condition.

- 21.4 A notice under this general condition may be served on the vendor's legal practitioner, conveyancer or estate agent even if the estate agent's authority has formally expired at the time of service.
- 21.5 The registered building practitioner may inspect the property at any reasonable time for the purpose of preparing the report.

22. PEST REPORT

- 22.1 This general condition only applies if the applicable box in the particulars of sale is checked.
- 22.2 The purchaser may end this contract within 14 days from the day of sale if the purchaser:
- (a) obtains a written report from a pest control operator licensed under Victorian law which discloses a current pest infestation on the land and designates it as a major infestation affecting the structure of a building on the land;
 - (b) gives the vendor a copy of the report and a written notice ending this contract; and
 - (c) is not then in default.
- 22.3 All money paid must be immediately refunded to the purchaser if the contract ends in accordance with this general condition.
- 22.4 A notice under this general condition may be served on the vendor's legal practitioner, conveyancer or estate agent even if the estate agent's authority has formally expired at the time of service.
- 22.5 The pest control operator may inspect the property at any reasonable time for the purpose of preparing the report.

23. ADJUSTMENTS

- 23.1 All periodic outgoings payable by the vendor, and any rent and other income received in respect of the property must be apportioned between the parties on the settlement date and any adjustment paid and received as appropriate.
- 23.2 The periodic outgoings and rent and other income must be apportioned on the following basis:
- (a) the vendor is liable for the periodic outgoings and entitled to the rent and other income up to and including the day of settlement; and
 - (b) the land is treated as the only land of which the vendor is owner (as defined in the *Land Tax Act 2005*); and
 - (c) the vendor is taken to own the land as a resident Australian beneficial owner; and
 - (d) any personal statutory benefit available to each party is disregarded in calculating apportionment.
- 23.3 The purchaser must provide copies of all certificates and other information used to calculate the adjustments under general condition 23, if requested by the vendor.

24. FOREIGN RESIDENT CAPITAL GAINS WITHHOLDING

- 24.1 Words defined or used in Subdivision 14-D of Schedule 1 to the *Taxation Administration Act 1953* (Cth) have the same meaning in this general condition unless the context requires otherwise.
- 24.2 Every vendor under this contract is a foreign resident for the purposes of this general condition unless the vendor gives the purchaser a clearance certificate issued by the Commissioner under section 14-220 (1) of Schedule 1 to the *Taxation Administration Act 1953* (Cth). The specified period in the clearance certificate must include the actual date of settlement.
- 24.3 The remaining provisions of this general condition 24 only apply if the purchaser is required to pay the Commissioner an amount in accordance with section 14-200(3) or section 14-235 of Schedule 1 to the *Taxation Administration Act 1953* (Cth) ("the amount") because one or more of the vendors is a foreign resident, the property has or will have a market value not less than the amount set out in section 14-215 of the legislation just after the transaction, and the transaction is not excluded under section 14-215(1) of the legislation.
- 24.4 The amount is to be deducted from the vendor's entitlement to the contract consideration. The vendor must pay to the purchaser at settlement such part of the amount as is represented by non-monetary consideration.
- 24.5 The purchaser must:
- (a) engage a legal practitioner or conveyancer ("representative") to conduct all legal aspects of settlement, including the performance of the purchaser's obligations under the legislation and this general condition; and
 - (b) ensure that the representative does so.
- 24.6 The terms of the representative's engagement are taken to include instructions to have regard to the vendor's interests and instructions that the representative must:
- (a) pay, or ensure payment of, the amount to the Commissioner in the manner required by the Commissioner and as soon as reasonably and practicably possible, from moneys under the control or direction of the representative in accordance with this general condition if the sale of the property settles;
 - (b) promptly provide the vendor with proof of payment; and
 - (c) otherwise comply, or ensure compliance with, this general condition;
- despite:
- (d) any contrary instructions, other than from both the purchaser and the vendor; and
 - (e) any other provision in this contract to the contrary.
- 24.7 The representative is taken to have complied with the requirements in special condition 24.6 if:
- (a) the settlement is conducted through an electronic lodgement network; and

- (b) the amount is included in the settlement statement requiring payment to the Commissioner in respect of this transaction.
- 24.8 Any clearance certificate or document evidencing variation of the amount in accordance with section 14-235(2) of Schedule 1 to the *Taxation Administration Act 1953* (Cth) must be given to the purchaser at least 5 business days before the due date for settlement.
- 24.9 The vendor must provide the purchaser with such information as the purchaser requires to comply with the purchaser's obligation to pay the amount in accordance with section 14-200 of Schedule 1 to the *Taxation Administration Act 1953* (Cth). The information must be provided within 5 business days of request by the purchaser. The vendor warrants that the information the vendor provides is true and correct.
- 24.10 The purchaser is responsible for any penalties or interest payable to the Commissioner on account of late payment of the amount.

25. GST WITHHOLDING

- 25.1 Words and expressions defined or used in Subdivision 14-E of Schedule 1 to the *Taxation Administration Act 1953* (Cth) or in *A New Tax System (Goods and Services Tax) Act 1999* (Cth) have the same meaning in this general condition unless the context requires otherwise. Words and expressions first used in this general condition and shown in italics and marked with an asterisk are defined or described in at least one of those Acts.
- 25.2 The purchaser must notify the vendor in writing of the name of the recipient of the *supply for the purposes of section 14-255 of Schedule 1 to the *Taxation Administration Act 1953* (Cth) at least 21 days before the due date for settlement unless the recipient is the purchaser named in the contract.
- 25.3 The vendor must at least 14 days before the due date for settlement provide the purchaser and any person nominated by the purchaser under general condition 4 with GST withholding notice in accordance with section 14-255 of Schedule 1 to the *Taxation Administration Act 1953* (Cth), and must provide all information required by the purchaser or any person so nominated to confirm the accuracy of the notice.
- 25.4 The remaining provisions of this general condition 25 apply if the purchaser is or may be required to pay the Commissioner an *amount in accordance with section 14-250 of Schedule 1 to the *Taxation Administration Act 1953* (Cth) because the property is *new residential premise or *potential residential land in either case falling within the parameters of that section, and also if the sale attracts the operation of section 14-255 of the legislation. Nothing in this general condition 25 is to be taken as relieving the vendor from compliance with section 14-255.
- 25.5 The amount is to be deducted from the vendor's entitlement to the contract *consideration and is then taken to be paid to the vendor, whether or not the vendor provides the purchaser with a GST withholding notice in accordance with section 14-255 of Schedule 1 to the *Taxation Administration Act 1953* (Cth). The vendor must pay to the purchaser at settlement such part of the amount as is represented by non-monetary consideration.
- 25.6 The purchaser must:
 - (a) engage a legal practitioner or conveyancer ("representative") to conduct all the legal aspects of settlement, including the performance of the purchaser's obligations under the legislation and this general condition; and
 - (b) ensure that the representative does so.
- 25.7 The terms of the representative's engagement are taken to include instructions to have regard to the vendor's interests relating to the payment of the amount to the Commissioner and instructions that the representative must:
 - (a) pay, or ensure payment of, the amount to the Commissioner in the manner required by the Commissioner and as soon as reasonably and practicably possible, from moneys under the control or direction of the representative in accordance with this general condition on settlement of the sale of the property;
 - (b) promptly provide the vendor with evidence of payment, including any notification or other document provided by the purchaser to the Commissioner relating to payment; and
 - (c) otherwise comply, or ensure compliance, with this general condition;
 despite:
 - (d) any contrary instructions, other than from both the purchaser and the vendor; and
 - (e) any other provision in this contract to the contrary.
- 25.8 The representative is taken to have complied with the requirements of general condition 25.7 if:
 - (a) settlement is conducted through the electronic lodgement network; and
 - (b) the amount is included in the settlement statement requiring payment to the Commissioner in respect of this transaction.
- 25.9 The purchaser may at settlement give the vendor a bank cheque for the amount in accordance with section 16-30 (3) of Schedule 1 to the *Taxation Administration Act 1953* (Cth), but only if:
 - (a) so agreed by the vendor in writing; and
 - (b) the settlement is not conducted through an electronic lodgement network.
 However, if the purchaser gives the bank cheque in accordance with this general condition 25.9, the vendor must:
 - (c) immediately after settlement provide the bank cheque to the Commissioner to pay the amount in relation to the supply; and

- (d) give the purchaser a receipt for the bank cheque which identifies the transaction and includes particulars of the bank cheque, at the same time the purchaser gives the vendor the bank cheque.
- 25.10 A party must provide the other party with such information as the other party requires to:
- (a) decide if an amount is required to be paid or the quantum of it, or
 - (b) comply with the purchaser's obligation to pay the amount,
- in accordance with section 14-250 of Schedule 1 to the *Taxation Administration Act 1953* (Cth). The information must be provided within 5 business days of a written request. The party providing the information warrants that it is true and correct.
- 25.11 The vendor warrants that:
- (a) at settlement, the property is not new residential premises or potential residential land in either case falling within the parameters of section 14-250 of Schedule 1 to the *Taxation Administration Act 1953* (Cth) if the vendor gives the purchaser a written notice under section 14-255 to the effect that the purchaser will not be required to make a payment under section 14-250 in respect of the supply, or fails to give a written notice as required by and within the time specified in section 14-255; and
 - (b) the amount described in a written notice given by the vendor to the purchaser under section 14-255 of Schedule 1 to the *Taxation Administration Act 1953* (Cth) is the correct amount required to be paid under section 14-250 of the legislation.
- 25.12 The purchaser is responsible for any penalties or interest payable to the Commissioner on account of non-payment or late payment of the amount, except to the extent that:
- (a) the penalties or interest arise from any failure on the part of the vendor, including breach of a warranty in general condition 25.11; or
 - (b) the purchaser's reasonable belief that the property is neither new residential premises nor potential residential land requiring the purchaser to pay an amount to the Commissioner in accordance with section 14-250 (1) of Schedule 1 to the *Taxation Administration Act 1953* (Cth)
- The vendor is responsible for any penalties or interest payable to the Commissioner on account of non-payment or late payment of the amount if either exception applies.
-

Transactional

26. TIME & CO OPERATION

- 26.1 Time is of the essence of this contract.
- 26.2 Time is extended until the next business day if the time for performing any action falls on a day which is not a business day.
- 26.3 Each party must do all things reasonably necessary to enable this contract to proceed to settlement, and must act in a prompt and efficient manner.
- 26.4 Any unfulfilled obligation will not merge on settlement.

27. SERVICE

- 27.1 Any document required to be served by or on any party may be served by or on the legal practitioner or conveyancer for that party.
- 27.2 A cooling off notice under section 31 of the *Sale of Land Act 1962* or a notice under general condition 20 [loan approval], 21 [building report] or 22 [pest report] may be served on the vendor's legal practitioner, conveyancer or estate agent even if the estate agent's authority has formally expired at the time of service.
- 27.3 A document is sufficiently served:
- (a) personally; or
 - (b) by pre-paid post; or
 - (c) in any manner authorised by law or by the Supreme Court for service of documents, including any manner authorised for service on or by a legal practitioner; whether or not the person serving or receiving the document is a legal practitioner, or
 - (d) by email.
- 27.4 Any document properly sent by:
- (a) express post is taken to have been served on the next business day after posting, unless proved otherwise;
 - (b) priority post is taken to have been served on the fourth business day after posting, unless proved otherwise;
 - (c) regular post is taken to have been served on the sixth business day after posting, unless proved otherwise;
 - (d) email is taken to have been served at the time of receipt within the meaning of section 13A of the *Electronic Transactions (Victoria) Act 2000*.
- 27.5 In this contract 'document' includes 'demand' and 'notice', 'serve' includes 'give' and 'served' and 'service' have corresponding meanings.

28. NOTICES

- 28.1 The vendor is responsible for any notice, order, demand or levy imposing liability on the property that is issued or made before the day of sale, and does not relate to periodic outgoings.
- 28.2 The purchaser is responsible for any notice, order, demand or levy imposing liability on the property that is issued or made on or after the day of sale that does not relate to periodic outgoings.
- 28.3 The purchaser may enter the property to comply with that responsibility where action is required before settlement.

29. INSPECTION

The purchaser and/or another person authorised by the purchaser may inspect the property at any reasonable time during the 7 days preceding and including the settlement day.

30. TERMS CONTRACT

- 30.1 If this is a 'terms contract' as defined in the *Sale of Land Act 1962*:
 - (a) any mortgage affecting the land sold must be discharged as to that land before the purchaser becomes entitled to possession or to the receipt of rents and profits unless the vendor satisfies section 29M of the *Sale of Land Act 1962*; and
 - (b) the deposit and all other money payable under the contract (other than any money payable in excess of the amount required to so discharge the mortgage) must be paid to a legal practitioner or conveyancer or a licensed estate agent to be applied in or towards discharging the mortgage.
- 30.2 While any money remains owing each of the following applies:
 - (a) the purchaser must maintain full damage and destruction insurance of the property and public risk insurance noting all parties having an insurable interest with an insurer approved in writing by the vendor;
 - (b) the purchaser must deliver copies of the signed insurance application forms, the policies and the insurance receipts to the vendor not less than 10 days before taking possession of the property or becoming entitled to receipt of the rents and profits;
 - (c) the purchaser must deliver copies of any amendments to the policies and the insurance receipts on each amendment or renewal as evidence of the status of the policies from time to time;
 - (d) the vendor may pay any renewal premiums or take out the insurance if the purchaser fails to meet these obligations;
 - (e) insurance costs paid by the vendor under paragraph (d) must be refunded by the purchaser on demand without affecting the vendor's other rights under this contract;
 - (f) the purchaser must maintain and operate the property in good repair (fair wear and tear excepted) and keep the property safe, lawful, structurally sound, weatherproof and free from contaminations and dangerous substances;
 - (g) the property must not be altered in any way without the written consent of the vendor which must not be unreasonably refused or delayed;
 - (h) the purchaser must observe all obligations that affect owners or occupiers of land;
 - (i) the vendor and/or other person authorised by the vendor may enter the property at any reasonable time to inspect it on giving 7 days written notice, but not more than twice in a year.

31. LOSS OR DAMAGE BEFORE SETTLEMENT

- 31.1 The vendor carries the risk of loss or damage to the property until settlement.
- 31.2 The vendor must deliver the property to the purchaser at settlement in the same condition it was in on the day of sale, except for fair wear and tear.
- 31.3 The purchaser must not delay settlement because one or more of the goods is not in the condition required by general condition 31.2, but may claim compensation from the vendor after settlement.
- 31.4 The purchaser may nominate an amount not exceeding \$5,000 to be held by a stakeholder to be appointed by the parties if the property is not in the condition required by general condition 31.2 at settlement.
- 31.5 The nominated amount may be deducted from the amount due to the vendor at settlement and paid to the stakeholder, but only if the purchaser also pays an amount equal to the nominated amount to the stakeholder.
- 31.6 The stakeholder must pay the amounts referred to in general condition 31.5 in accordance with the determination of the dispute, including any order for payment of the costs of the resolution of the dispute.

32. BREACH

A party who breaches this contract must pay to the other party on demand:

- (a) compensation for any reasonably foreseeable loss to the other party resulting from the breach; and
- (b) any interest due under this contract as a result of the breach.

Default

33. INTEREST

Interest at a rate of 2% per annum plus the rate for the time being fixed by section 2 of the *Penalty Interest Rates Act* 1983 is payable at settlement on any money owing under the contract during the period of default, without affecting any other rights of the offended party.

34. DEFAULT NOTICE

- 34.1 A party is not entitled to exercise any rights arising from the other party's default, other than the right to receive interest and the right to sue for money owing, until the other party is given and fails to comply with a written default notice.
- 34.2 The default notice must:
- (a) specify the particulars of the default; and
 - (b) state that it is the offended party's intention to exercise the rights arising from the default unless, within 14 days of the notice being given-
 - (i) the default is remedied; and
 - (ii) the reasonable costs incurred as a result of the default and any interest payable are paid.

35. DEFAULT NOT REMEDIED

- 35.1 All unpaid money under the contract becomes immediately payable to the vendor if the default has been made by the purchaser and is not remedied and the costs and interest are not paid.
- 35.2 The contract immediately ends if:
- (a) the default notice also states that unless the default is remedied and the reasonable costs and interest are paid, the contract will be ended in accordance with this general condition; and
 - (b) the default is not remedied and the reasonable costs and interest are not paid by the end of the period of the default notice.
- 35.3 If the contract ends by a default notice given by the purchaser:
- (a) the purchaser must be repaid any money paid under the contract and be paid any interest and reasonable costs payable under the contract; and
 - (b) all those amounts are a charge on the land until payment; and
 - (c) the purchaser may also recover any loss otherwise recoverable.
- 35.4 If the contract ends by a default notice given by the vendor:
- (a) the deposit up to 10% of the price is forfeited to the vendor as the vendor's absolute property, whether the deposit has been paid or not; and
 - (b) the vendor is entitled to possession of the property; and
 - (c) in addition to any other remedy, the vendor may within one year of the contract ending either:
 - (i) retain the property and sue for damages for breach of contract; or
 - (ii) resell the property in any manner and recover any deficiency in the price on the resale and any resulting expenses by way of liquidated damages; and
 - (d) the vendor may retain any part of the price paid until the vendor's damages have been determined and may apply that money towards those damages; and
 - (e) any determination of the vendor's damages must take into account the amount forfeited to the vendor.
- 35.5 The ending of the contract does not affect the rights of the offended party as a consequence of the default

DATED: 08/07/2025

HIRAL NATAVARBHAI PATEL

to

..... PURCHASER

CONTRACT OF SALE OF LAND

Property: 13 FEODORA CRESCENT NARRE WARREN VIC 3805

VENDORS REPRESENTATIVE

MND LAWYERS

Level 1 530 Little Collins St

MELBOURNE VIC 3000

Tel: (03) 9909 7780

Fax: (03) 9909 7788

Email: info@mndlawyers.com.au

Ref: MD:YS: 07/25

SECTION 32 **STATEMENT**

PURSUANT TO DIVISION 2 OF PART II
SECTION 32 OF THE SALE OF LAND ACT 1962 (VIC)

Vendor:

HIRAL NATAVARBHAI PATEL

Property:

13 FEODORA CRESCENT NARRE WARREN VIC 3805

1. FINANCIAL MATTERS

1.1 Particulars of any Rates, Taxes, Charges or Other Similar Outgoings (and any interest on them)

(a) are provided with the attached certificates

1.2 Particulars of any Charge (whether registered or not) imposed by or under any Act to secure an amount due under that Act, including the amount owing under the charge.

Not Applicable

1.3 Terms Contract

This section 1.3 only applies if this vendor statement is in respect of a terms contract where the purchaser is obliged to make 2 or more payments (other than a deposit or final payment) to the vendor after the execution of the contract and before the purchaser is entitled to a conveyance or transfer of the land.

Not Applicable

1.4 Sale Subject to Mortgage

This section 1.4 only applies if this vendor statement is in respect of a contract which provides that any mortgage (whether registered or unregistered), is NOT to be discharged before the purchaser becomes entitled to possession or receipts of rents and profits.

Not Applicable

1.5 Commercial and Industrial Property Tax Reform Act 2024 (Vic) (CIPT Act) N/A

(a) The Australian Valuation Property Classification Code (within the meaning of the CIPT Act) most recently allocated to the land is set out in the attached Municipal rates notice or property clearance certificate or is as follows	AVPC No.
(b) Is the land tax reform scheme land within the meaning of the CIPT Act?	<input type="checkbox"/> YES <input checked="" type="checkbox"/> NO
(c) If the land is tax reform scheme land within the meaning of the CIPT Act, the entry date within the meaning of the CIPT Act is set out in the attached Municipal rates notice or property clearance certificate or is as follows	Date: OR <input checked="" type="checkbox"/> Not applicable

2. INSURANCE

2.1 Damage and Destruction

This section 2.1 only applies if this vendor statement is in respect of a contract which does NOT provide for the land to remain at the risk of the vendor until the purchaser becomes entitled to possession or receipt of rents and profits.

Not Applicable

2.2 Owner Builder

This section 2.2 only applies where there is a residence on the land that was constructed by an owner-builder within the preceding 6 years and section 137B of the Building Act 1993 applies to the residence.

Not Applicable

3. LAND USE

3.1 Easements, Covenants or Other Similar Restrictions

(a) A description of any easement, covenant or other similar restriction affecting the land (whether registered or unregistered):

Is in the attached copies of title document/s



(b) Particulars of any existing failure to comply with that easement, covenant or other similar restriction are:

To the best of the Vendor's knowledge, there is no existing failure to comply with the terms of any easements, covenants or other similar restrictions.

3.2 Road Access

There is NO access to the property by road if the square box is marked with an 'X' ☐

3.3 Designated Bushfire Prone Area

The land is in a designated bushfire-prone area within the meaning of section 192A of the *Building Act* 1993 if the square box is marked with an 'X' ☒

3.4 Planning Scheme

Refer to the attached certificate for more information

3.5 EPA Priority Site

This property is NOT listed in the EPA Priority Sites Register

4. NOTICES

4.1 Notice, Order, Declaration, Report or Recommendation

Particulars of any notice, order, declaration, report or recommendation of a public authority or government department or approved proposal directly and currently affecting the land, being a notice, order, declaration, report, recommendation or approved proposal of which the vendor might reasonably be expected to have knowledge:

Not Applicable

4.2 Agricultural Chemicals

There are NO notices, property management plans, reports or orders in respect of the land issued by a government department or public authority in relation to livestock disease or contamination by agricultural chemicals affecting the ongoing use of the land for agricultural purposes. However, if this is not the case, the details of any such notices, property management plans, reports or orders, are as follows:

NIL

4.3 Compulsory Acquisition

The particulars of any notices of intention to acquire that have been served under section 6 of the *Land Acquisition and Compensation Act* 1986 are as follows:

NIL

5. BUILDING PERMITS

Particulars of any building permit issued under the *Building Act* 1993 in the preceding 7 years (required only where there is a residence on the land):

N/A

6. OWNERS CORPORATION

This section 6 only applies if the land is affected by an owners corporation within the meaning of the *Owners Corporations Act* 2006.

N/A

7. GROWTH AREAS INFRASTRUCTURE CONTRIBUTION ("GAIC")

SECTION 32 STATEMENT
13 FEODORA CRESCENT NARRE WARREN VIC 3805

Words and expressions in this section 7 have the same meaning as in Part 9B of the *Planning and Environment Act 1987*.

N/A

8. SERVICES

The services which are marked with an 'X' in the accompanying square box are NOT connected to the land:

Electricity supply ☐ Gas supply ☐ Water supply ☐ Sewerage ☐

Telephone services ☒

9. TITLE

Attached are copies of the following documents:

9.1 (a) Registered Title ☒

A Register Search Statement and the document, or part of a document, referred to as the 'diagram location' in that statement which identifies the land and its location.

10. SUBDIVISION

10.1 Unregistered Subdivision

This section 10.1 only applies if the land is subject to a subdivision which is not registered.

Not Applicable

10.2 Staged Subdivision

This section 10.2 only applies if the land is part of a staged subdivision within the meaning of section 37 of the *Subdivision Act 1988*.

(a) Attached is a copy of the plan for the first stage if the land is in the second or subsequent stage.

N/A

SECTION 32 STATEMENT
13 FEODORA CRESCENT NARRE WARREN VIC 3805

(b) The requirements in a statement of compliance relating to the stage in which the land is included that have Not been complied with are as follows:

NIL

(c) The proposals relating to subsequent stages that are known to the vendor are as follows:

NIL

(d) The contents of any permit under the Planning and Environment Act 1987 authorising the staged subdivision are:

NIL

10.3 Further Plan of Subdivision

This section 10.3 only applies if the land is subject to a subdivision in respect of which a further plan within the meaning of the *Subdivision Act* 1988 is proposed.

Not Applicable

11. DISCLOSURE OF ENERGY INFORMATION

Details of any energy efficiency information required to be disclosed regarding a disclosure affected building or disclosure area affected area of a building as defined by the *Building Energy Efficiency Disclosure Act* 2010 (Cth)

(a) to be a building or part of a building used or capable of being used as an office for administrative, clerical, professional or similar based activities including any support facilities; and

(b) which has a net lettable area of at least 1000m²; (but does not include a building under a strata title system or if an occupancy permit was issued less than 2 years before the relevant date):

Not Applicable

12. DUE DILIGENCE CHECKLIST

☒ Attached

13. ATTACHMENTS: refer to attached documents

SECTION 32 STATEMENT
13 FEODORA CRESCENT NARRE WARREN VIC 3805

DATE OF THIS STATEMENT: 21/07/2025

Name of the Vendor/s

HIRAL NATAVARBHAI PATEL

Signature/s of the Vendor

x *Hiral Natarbhai Patel*

The Purchaser acknowledges being given a duplicate of this statement signed by the Vendor before the Purchaser signed any contract.

The Purchaser further acknowledges being directed to the DUE DILIGENCE CHECKLIST.

DATE OF THIS ACKNOWLEDGMENT

/

2025

Name of the Purchaser/s

Signature/s of the Purchaser

x

REGISTER SEARCH STATEMENT (Title Search) Transfer of Land Act 1958

Page 1 of 1

VOLUME 11546 FOLIO 248

Security no : 124126012951E
Produced 08/07/2025 12:19 PM

LAND DESCRIPTION

Lot 138 on Plan of Subdivision 644330L.
PARENT TITLE Volume 11486 Folio 314
Created by instrument PS644330L 15/01/2015

REGISTERED PROPRIETOR

Estate Fee Simple
Sole Proprietor
HIRAL NATAVARBHAI PATEL of 3/14 WALLOWES CRESCENT NARRE WARREN VIC 3805
AL672135H 10/02/2015

ENCUMBRANCES, CAVEATS AND NOTICES

MORTGAGE AW266478U 14/11/2022
PERPETUAL TRUSTEE COMPANY LTD

COVENANT PS644330L 15/01/2015

COVENANT AL672135H 10/02/2015

Any encumbrances created by Section 98 Transfer of Land Act 1958 or Section 24 Subdivision Act 1988 and any other encumbrances shown or entered on the plan set out under DIAGRAM LOCATION below.

DIAGRAM LOCATION

SEE PS644330L FOR FURTHER DETAILS AND BOUNDARIES

ACTIVITY IN THE LAST 125 DAYS

NIL

-----END OF REGISTER SEARCH STATEMENT-----

Additional information: (not part of the Register Search Statement)

Street Address: 13 FEODORA CRESCENT NARRE WARREN VIC 3805

ADMINISTRATIVE NOTICES

NIL

eCT Control 18440T MSA NATIONAL
Effective from 14/11/2022

DOCUMENT END

Imaged Document Cover Sheet

The document following this cover sheet is an imaged document supplied by LANDATA®, Secure Electronic Registries Victoria.

Document Type	Plan
Document Identification	PS644330L
Number of Pages (excluding this cover sheet)	7
Document Assembled	08/07/2025 12:19

Copyright and disclaimer notice:

© State of Victoria. This publication is copyright. No part may be reproduced by any process except in accordance with the provisions of the Copyright Act 1968 (Cth) and for the purposes of Section 32 of the Sale of Land Act 1962 or pursuant to a written agreement. The information is only valid at the time and in the form obtained from the LANDATA® System. None of the State of Victoria, LANDATA®, Secure Electronic Registries Victoria Pty Ltd (ABN 86 627 986 396) as trustee for the Secure Electronic Registries Victoria Trust (ABN 83 206 746 897) accept responsibility for any subsequent release, publication or reproduction of the information.

The document is invalid if this cover sheet is removed or altered.

PLAN OF SUBDIVISION		LV USE ONLY EDITION 1	PS 644330L	
Location of Land Parish: BERWICK Township: Section: 3A Crown Allotment: 1 (PART) Crown Portion: Title References: Vol.11486 Fol.314 Last Plan Reference: PS 710885V (Lot D) Postal Address: 505 PLAYER DRIVE (At time of subdivision) NARRE WARREN VIC 3805 MGA Co-ordinates: E 351 694 Zone: 55 (GDA 94) (Of approx. centre of plan) N 5788 159		Council : CITY OF CASEY		
VESTING OF ROADS AND/OR RESERVES		NOTATIONS		
IDENTIFIER	COUNCIL/BODY/PERSON	LOT NUMBERS 12 to 102 (both inclusive) AND 106 to 111 (both inclusive) HAVE BEEN OMITTED FROM THIS PLAN THE OTHER PURPOSE OF THIS PLAN IS TO CREATE THE RESTRICTIONS AS SHOWN ON SHEET 5 OF THIS PLAN		
ROADS R-1 RESERVE N° 1	CITY OF CASEY CITY OF CASEY			
NOTATIONS				
DEPTH LIMITATION - 15.24m APPLIES				
Survey: This plan is based on survey To be completed where applicable. This survey has been connected to permanent marks no(s). MB 5679 (MELBPOS) in Proclaimed Survey Area no. 45 Staging: This is not a staged subdivision. Planning Permit No. P789/10A				
EASEMENT INFORMATION				
* DATA TRANSMISSION - THE TRANSMISSION OF DATA BY UNDERGROUND CABLE				
Legend: A - Appurtenant Easement E - Encumbering Easement R - Encumbering Easement (Road)				
Easement Reference	Purpose	Width (Metres)	Origin	Land Benefited/in Favour Of
E-1	DRAINAGE SEWERAGE	See diag See diag	PS 528596T PS 528596T	CASEY CITY COUNCIL SOUTH EAST WATER LTD
E-3,E-4	SEWERAGE	See diag	PS 710885V	SOUTH EAST WATER CORPORATION
E-4	DRAINAGE	See diag	PS 710885V	CASEY CITY COUNCIL
E-5,E-6	SEWERAGE	See diag	THIS PLAN	SOUTH EAST WATER CORPORATION
E-6	DRAINAGE	See diag	THIS PLAN	CASEY CITY COUNCIL
E-2	SUPPLY OF GAS & DATA TRANSMISSION * (*See definition above)	See diag	THIS PLAN	LOTS ON THIS PLAN
E-2	PIPELINE OR ANCILLARY PURPOSES	See diag	THIS PLAN (SEC 136 WATER ACT 1989)	SOUTH EAST WATER CORPORATION
STAGE 3 - 3.086 49 LOTS		DIGITALLY SIGNED BY LICENSED SURVEYOR: ROBERT G BORTOLI		Sheet 1 of 5 Sheets
 BORTOLI WELLINGTON PTY.LTD. ABN 46 069 841 498 CONSULTING LAND SURVEYORS Unit 14/104 FERNTREE GULLY ROAD OAKLEIGH EAST VIC 3166 PO BOX 776 MOUNT WAVERLEY VIC 3149 Phone (03) 9543 5855 FAX (03) 9543 2755		REF 1989C-3B 3A		ORIGINAL SHEET SIZE A3
				PLAN REGISTERED: TIME: 3.09PM DATE: 15/01/2015 GARY M ROBERTSON Assistant Registrar of Titles
2014-01-31 1989C-3b-1 2014-02-04				

Plan Number

PS 644330L

FOR MORE DETAILS ON THE LOTS
SEE SHEETS 3 AND 4

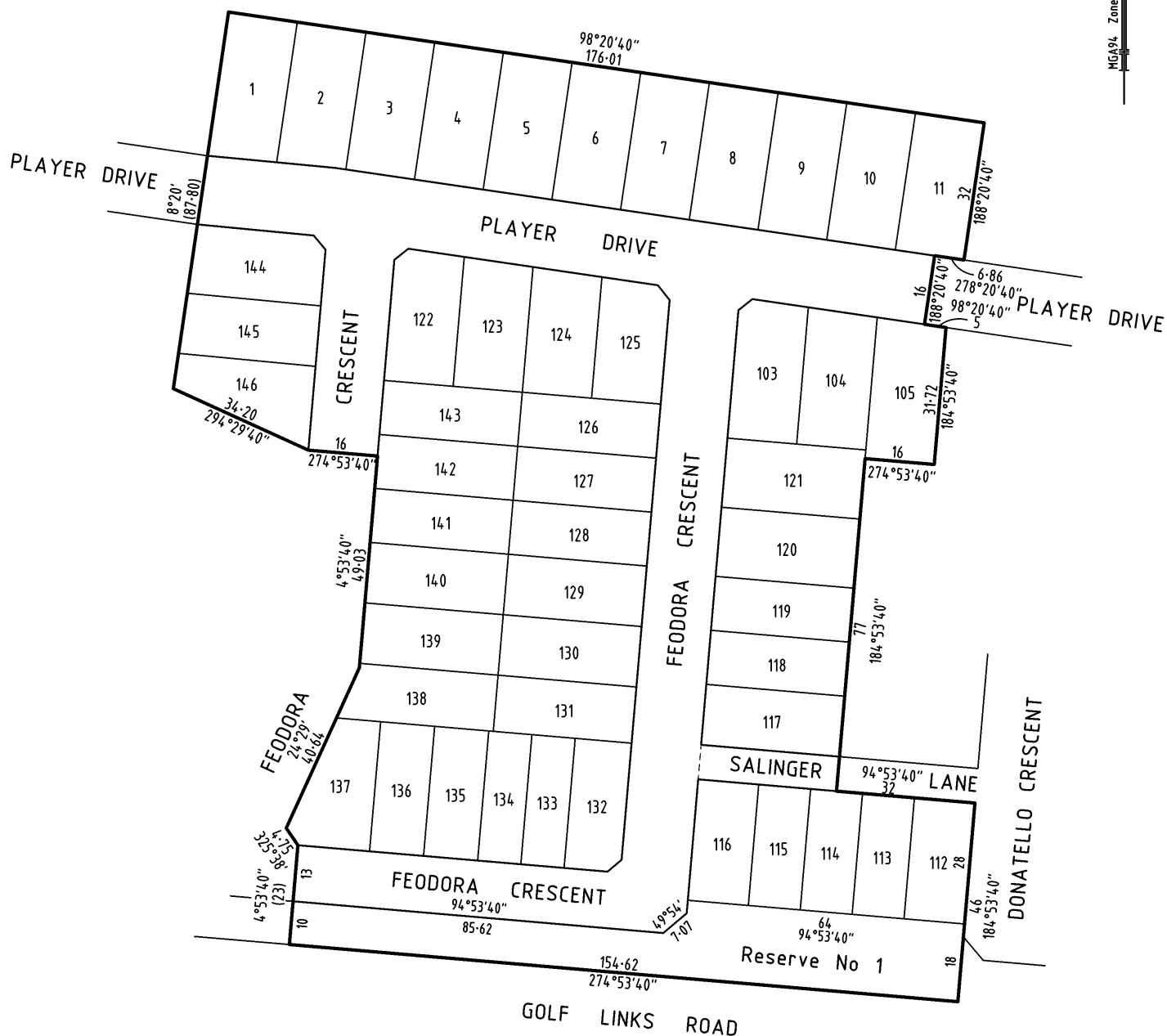
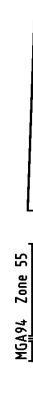

BORTOLI WELLINGTON PTY.LTD.
ABN 46 069 841 498
CONSULTING LAND SURVEYORS
Unit 14/104 FERNTREE GULLY ROAD OAKLEIGH EAST VIC 3166
PO BOX 776 MOUNT WAVERLEY VIC 3149
Phone (03) 9543 5855 FAX (03) 9543 2755

2014-01-31 1989C-3B-2

1/31/14

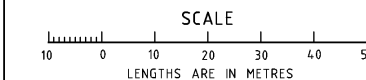

REF 1989C-3B
VERSION 3A

Digitally signed by
LICENSED SURVEYOR: Robert G Bortoli

ORIGINAL

SCALE
1:1000

SHEET
SIZE
A3

Sheet 2

Plan Number

PS 644330L

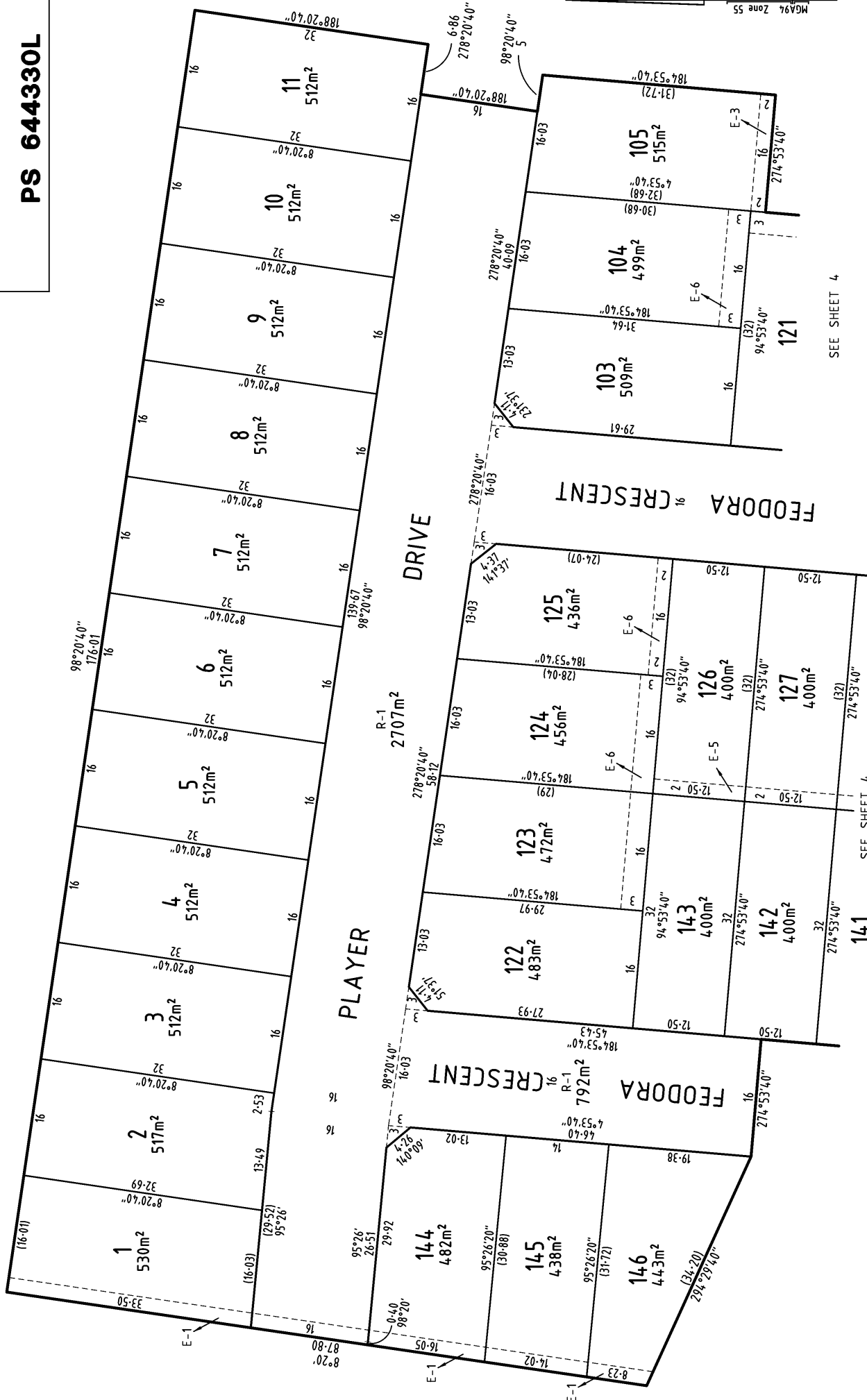

Sheet 3

DIGITALLY SIGNED BY

LICENSED SURVEYOR: Robert G Bortoli

ORIGINAL

SHEET
SCALE
1:500
A3

SCALE
LENGTHS ARE IN METRES
0 5 10 15 20 25

1989C-3B

VERSION 3A

BORTOLI WELLINGTON PTY.LTD.
ABN 46 069 841 498
CONSULTING LAND SURVEYORS
Unit 14/104, Fernside Gully Road Oakleigh East VIC 3166
PO BOX 776 Mount Waverley VIC 3149
Phone (03) 9543 5855 FAX (03) 9543 2755

1/31/14

Plan Number

PS 644330L

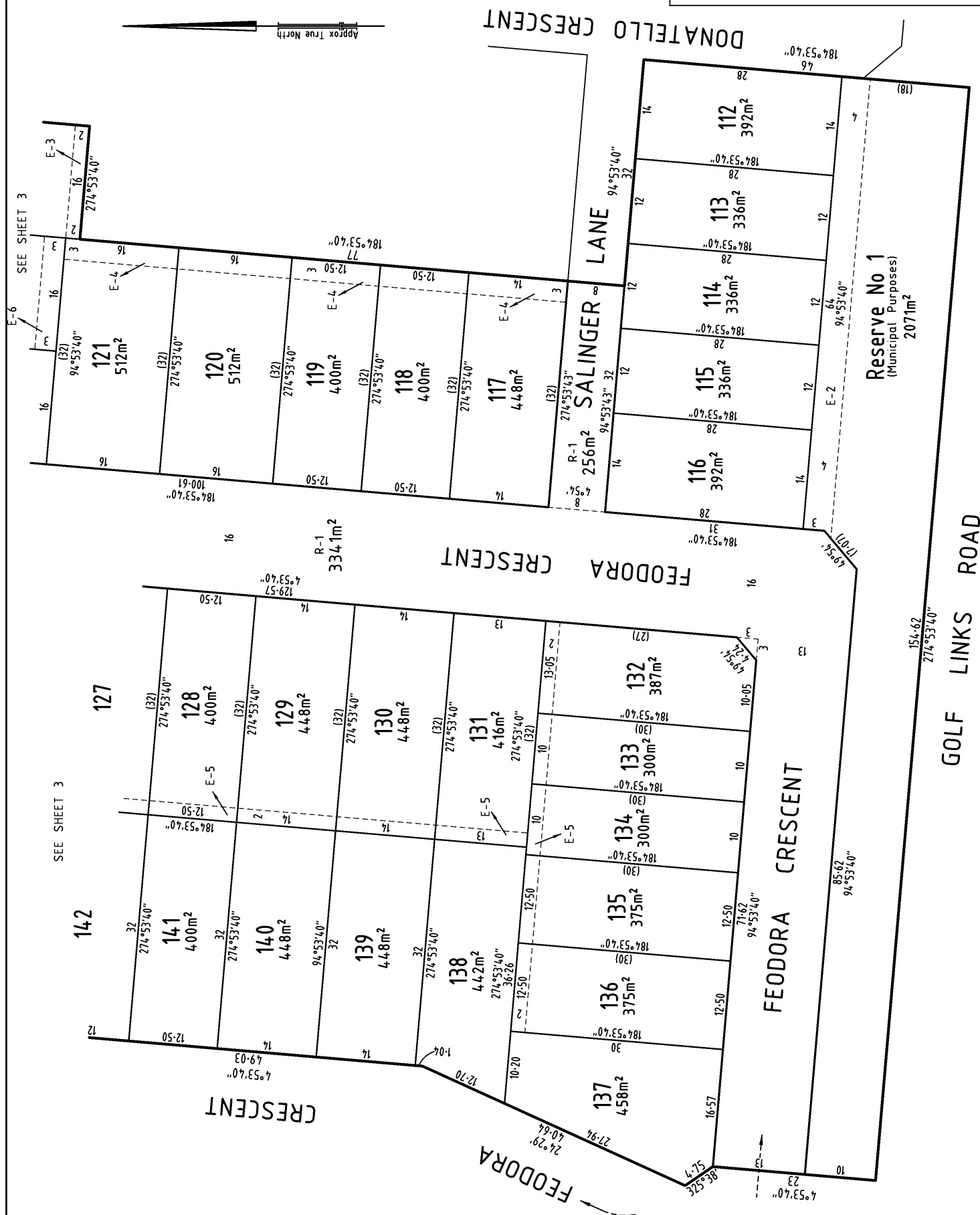

CONSULTING LAND SURVEYORS
Unit 14/104 FERNTREE GULLY ROAD OAKLEIGH EAST VIC 3166
PO BOX 776 MOUNT WAVERLEY VIC 3149
Phone (03) 9543 5855 FAX (03) 9543 2755

2014-01-31 1989C-3B-4

1/31/14

SCALE

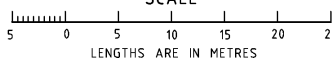

REF 1989C-3B

VERSION 3A

ORIGINAL

SCALE

SHEET

SIZE
A3

Sheet 4

Digitally signed by
LICENSED SURVEYOR: Robert G Bortoli

Plan Number

PS 644330L

CREATION OF RESTRICTIONS

(Regulation 15 Subdivision (Procedures) Regulations 2000)

UPON REGISTRATION OF THIS PLAN THE FOLLOWING RESTRICTIONS ARE TO BE CREATED

RESTRICTION N° 1

LAND TO BENEFIT: LOTS 1 to 11 (BOTH INCLUSIVE), 103 to 105 (BOTH INCLUSIVE), 112 to 146 (BOTH INCLUSIVE) ON THIS PLAN PS 644330L

LAND TO BE BURDENED: LOTS 1 to 11 (BOTH INCLUSIVE), 104, 105, 112 to 121 (BOTH INCLUSIVE), 123, 124, 126 to 143 (BOTH INCLUSIVE), 145 AND 146 ON THIS PLAN PS 644330L

DESCRIPTION OF RESTRICTION:

EXCEPT WITH THE WRITTEN CONSENT OF COUNCIL THE REGISTERED PROPRIETOR OR PROPRIETORS FOR THE TIME BEING OF THE BURDENED LOTS ON THIS PLAN SHALL NOT BUILD ERECT OR CONSTRUCT OR CAUSE TO BE BUILT ERECTED OR CONSTRUCTED ON EACH LOT MORE THAN ONE DWELLING HOUSE TOGETHER WITH THE USUAL OUTBUILDINGS.

THIS RESTRICTION SHALL CEASE TO EFFECT THE BURDENED LAND 5 YEARS AFTER THE REGISTRATION OF THIS PLAN.

RESTRICTION N° 2

LAND TO BENEFIT: LOTS 1 to 11 (BOTH INCLUSIVE), 103 to 105 (BOTH INCLUSIVE), 117 to 146 (BOTH INCLUSIVE) ON THIS PLAN PS 644330L

LAND TO BE BURDENED: LOTS 1 to 11 (BOTH INCLUSIVE), 103 to 105 (BOTH INCLUSIVE), 117 to 146 (BOTH INCLUSIVE) ON THIS PLAN PS 644330L

DESCRIPTION OF RESTRICTION:

EXCEPT WITH THE WRITTEN CONSENT OF COUNCIL THE REGISTERED PROPRIETOR OR PROPRIETORS FOR THE TIME BEING OF THE BURDENED LOTS ON THIS PLAN SHALL NOT BUILD ERECT OR CONSTRUCT OR CAUSE TO BE BUILT ERECTED OR CONSTRUCTED ANY BUILDING OTHER THAN IN ACCORDANCE WITH THE FOLLOWING "BUILDING ENVELOPE SPECIFICATION"

"BUILDING ENVELOPE SPECIFICATION"

- GARAGES AND CARPORTS MUST BE SETBACK A MINIMUM OF 0.84 metres BEHIND THE FRONT WALL OF THE DWELLING AND MUST BE A SETBACK A MINIMUM OF 5.50 metres FROM THE LOT FRONTAGE.
- GARAGE OPENINGS MUST NOT EXCEED 40% OF THE LOT FRONTAGE DIMENSION.

THIS RESTRICTION SHALL CEASE TO EFFECT THE BURDENED LAND 5 YEARS AFTER THE REGISTRATION OF THIS PLAN.

RESTRICTION N° 3

LAND TO BENEFIT: LOTS 112 to 116 (BOTH INCLUSIVE) ON THIS PLA PS 644330L

LAND TO BE BURDENED: LOTS 112 to 116 (BOTH INCLUSIVE) ON THIS PLA PS 644330L

DESCRIPTION OF RESTRICTION:

EXCEPT WITH THE WRITTEN CONSENT OF THE RESPONSIBLE AUTHORITY THE REGISTERED PROPRIETOR OR PROPRIETORS FOR THE TIME BEING OF LOTS 112 to 116 (both inclusive) ON THIS PLAN PS 644329U SHALL NOT BUILD ERECT OR CONSTRUCT OR CAUSE TO BE BUILT ERECTED OR CONSTRUCTED ANY BUILDING OTHER THAN IN ACCORDANCE WITH THE FOLLOWING "BUILDING ENVELOPE SPECIFICATION" AND "SCHEDULE".

"BUILDING ENVELOPE SPECIFICATION"

NO DWELLING OR GARAGE MAY BE CONSTRUCTED WITHIN THE SETBACK AREA SHOWN HATCHED THUS  ON THE SCHEDULE.

PORCHES AND OPEN VERANDAS MAY PROJECT INTO THE SETBACK AREA SHOWN HATCHED

SETBACKS FROM OTHER FROM OTHER BOUNDARIES - NO DWELLING OR GARAGE SHALL BE LOCATED CLOSER TO OTHER BOUNDARIES THAN THE DISTANCE SHOWN IN METRES EG. 2m. WHERE THE OPTION IS GIVEN OF SITING A DWELLING ON THE BOUNDARY OR SETTING BACK THE MINIMUM ALTERNATIVE DISTANCE SHOWN IN METRES EG. 0 OR 1, THE DWELLING MUST BE LOCATED EITHER ON THE BOUNDARY OR SETBACK AT LEAST THE PRESCRIBED MINIMUM ALTERNATIVE DISTANCE.

ALLOWABLE ENCROACHMENTS INTO SETBACKS - ENCROACHMENTS AND EXCEPTIONS TO SETBACKS ARE PERMITTED IN ACCORDANCE WITH THE VICTORIAN BUILDING REGULATIONS. ALL SETBACK DISTANCES ON THIS PLAN ARE IN METRES.

"SCHEDULE"

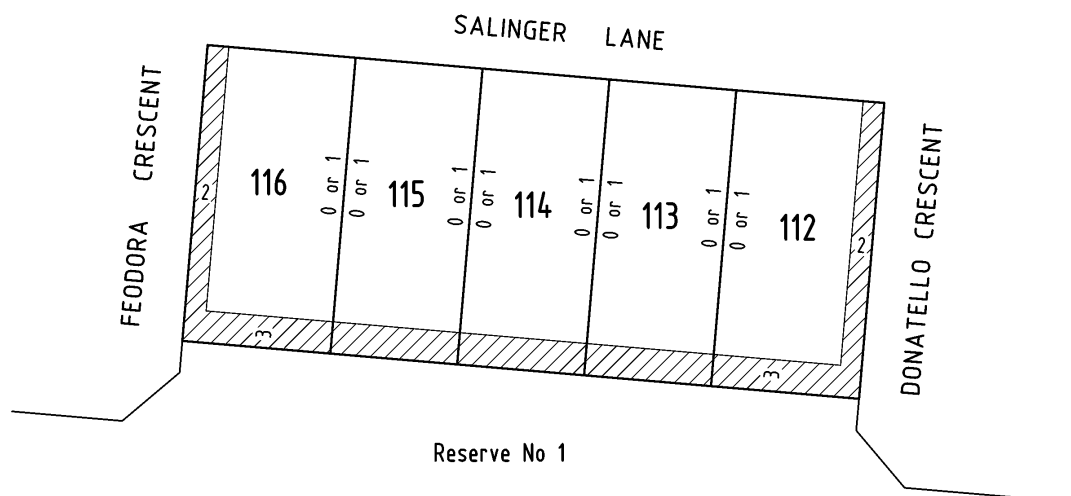



Plan of Subdivision PS644330L
Certification of plan by Council (Form 2)

SUBDIVISION (PROCEDURES) REGULATIONS 2011

SPEAR Reference Number: S017235T
Plan Number: PS644330L
Responsible Authority Name: Casey City Council
Responsible Authority Reference Number 1: S252/11
Surveyor's Plan Version: 3a

Certification

This plan is certified under section 6 of the Subdivision Act 1988

Public Open Space

A requirement for public open space under section 18 of the Subdivision Act 1988

Has not been made at Certification

Digitally signed by Council Delegate: Phil Polson
Organisation: Casey City Council
Date: 04/02/2014

Plan of Subdivision PS644330L

Statement of Compliance (Form 15)



Regulation 32(6) Subdivision (Procedures) Regulations 2011

Section 21

Subdivision Act 1988

To Narre Warren Springs Pty Ltd, Level 1/20 Council Street, HAWTHORN EAST, VIC, 3123

Statement of Compliance

SPEAR Reference Number: S017235T

Council Ref. No.: S252/11

Office of Titles Plan No.: PS644330L

Surveyor's Plan Version: 3a

Original Date certified by Council: 04/02/2014 09:59:26 am

This is a Statement of Compliance issued under section 21 of the **Subdivision Act 1988** for the whole of the above plan.

Requirements under Parts 2 and 3 of the **Subdivision Act 1988** have now been satisfied.

You should now lodge the certified plan for registration together with this statement at the Office of Titles in accordance with section 5 (3)(e) of the **Subdivision Act 1988**.

This document issued by Michele Annette Scarlett of Casey City Council and signed on 18/12/2014 at 02:34 pm



Department of Environment, Land, Water & Planning

Electronic Instrument Statement

Mortgage Form version 1.5

Copyright State of Victoria. No part of this publication may be reproduced except as permitted by the Copyright Act 1968 (Cth), to comply with a statutory requirement or pursuant to a written agreement. The information is only valid at the time and in the form obtained from the LANDATA REGD TM System. None of the State of Victoria, its agents or contractors, accepts responsibility for any subsequent publication or reproduction of the information.

The Victorian Government acknowledges the Traditional Owners of Victoria and pays respects to their ongoing connection to their Country, History and Culture. The Victorian Government extends this respect to their Elders, past, present and emerging.

Produced 08/07/2025 12:19:17 PM

Status	Registered	Dealing Number	AW266478U
Date and Time Lodged	14/11/2022 05:08:01 PM		

Lodger Details

Lodger Code	18440T
Name	MSA NATIONAL
Address	
Lodger Box	
Phone	
Email	
Reference	EBJ: 3456949 VIC RES

MORTGAGE

Jurisdiction	VICTORIA
--------------	----------

Privacy Collection Statement

The information in this form is collected under statutory authority and used for the purpose of maintaining publicly searchable registers and indexes.

Estate and/or Interest being mortgaged

FEE SIMPLE

Land Title Reference

11546/248

Mortgagor

Given Name(s)	HIRAL NATAVARBHAI
Family Name	PATEL
Name on Title	HIRAL PATEL
Reason for Difference	ERROR IN REGISTER

Mortgagee

Name	PERPETUAL TRUSTEE COMPANY LIMITED
ACN	000001007
Address	
Floor Type	LEVEL
Floor Number	18
Street Number	123
Street Name	PITT



Department of Environment, Land, Water & Planning

Electronic Instrument Statement

Mortgage Form version 1.5

Street Type	STREET
Locality	SYDNEY
State	NSW
Postcode	2000

The mortgagor mortgages the estate and/or interest in land specified in this mortgage to the mortgagee as security for the debt or liability described in the terms and conditions set out or referred to in this mortgage, and covenants with the mortgagee to comply with those terms and conditions.

Terms and Conditions of this Mortgage

(a) Document Reference	AA6817
(b) Additional terms and conditions	NIL

Mortgagee Execution

1. The Certifier has retained the evidence supporting this Registry Instrument or Document.
2. The Certifier has taken reasonable steps to ensure that this Registry Instrument or Document is correct and compliant with relevant law and any Prescribed Requirement.
3. The Certifier, or the Certifier is reasonably satisfied that the mortgagee it represents,:
 - (a) has taken reasonable steps to verify the identity of the mortgagor or his, her or its administrator or attorney; and
 - (b) holds a mortgage granted by the mortgagor on the same terms as this Registry Instrument or Document.
4. The Certifier has taken reasonable steps to verify the identity of the mortgagee or his, her or its administrator or attorney.
5. The Certifier holds a properly completed Client Authorisation for the Conveyancing Transaction including this Registry Instrument or Document.

Executed on behalf of	PERPETUAL TRUSTEE COMPANY LIMITED
Signer Name	RICHARD SOONG
Signer Organisation	MSA NATIONAL
Signer Role	AUSTRALIAN LEGAL PRACTITIONER
Execution Date	14 NOVEMBER 2022

File Notes:

NIL

This is a representation of the digitally signed Electronic Instrument or Document certified by Land Use Victoria.

Statement End.

Imaged Document Cover Sheet

The document following this cover sheet is an imaged document supplied by LANDATA®, Secure Electronic Registries Victoria.

Document Type	Instrument
Document Identification	AL672135H
Number of Pages (excluding this cover sheet)	2
Document Assembled	08/07/2025 12:19

Copyright and disclaimer notice:

© State of Victoria. This publication is copyright. No part may be reproduced by any process except in accordance with the provisions of the Copyright Act 1968 (Cth) and for the purposes of Section 32 of the Sale of Land Act 1962 or pursuant to a written agreement. The information is only valid at the time and in the form obtained from the LANDATA® System. None of the State of Victoria, LANDATA®, Secure Electronic Registries Victoria Pty Ltd (ABN 86 627 986 396) as trustee for the Secure Electronic Registries Victoria Trust (ABN 83 206 746 897) accept responsibility for any subsequent release, publication or reproduction of the information.

The document is invalid if this cover sheet is removed or altered.

AL672135H

Approved Form T2
Victorian Land Titles Office

TRANSFER OF LAND

Section 45 Transfer of Land Act 1958

Lodged by:

Name: _____

Phone: _____

Address: _____ **ARE Retail**

Ref: _____ **15314 Q**

Customer Code: _____

MADE AVAILABLE / CHANGE CONTROL

Land Titles Office Use Only

The transferor at the direction of the directing party (if any) transfers to the transferee the estate and interest specified in the land described for the consideration expressed-

- together with any easements created by this transfer;
- subject to the encumbrances affecting the land including any created by dealings lodged for registration before the lodging of this transfer; and
- subject to any easements reserved by this transfer or restrictive covenant contained or covenant created pursuant to statute and included in this transfer.

Land: (volume and folio reference)

Volume: **11546** Folio: **248**

Estate and Interest: (e.g. "all my estate in fee simple")

All it's Estate in fee simple.

Consideration:

Two Hundred and Fifty Five Thousand Dollars (\$255,000.00)

Transferor: (full name)

NARRE WARREN SPRINGS PTY LTD ACN 140 554 552

Transferee: (full name and address including postcode)

HIRAL PATEL
of 3/14 Wallows Crescent, Narre Warren, Victoria 3805.

Directing Party: (full name)

Creation and/or Reservation and/or Covenant:

And the said transferee for himself, his heirs, executors, administrators and transferees the registered proprietor or proprietors for the time being of the land hereby transferred and of every part or parts thereof do hereby and as a separate covenant with Narre Warren Springs Pty Ltd ACN 140 554 552, it's successors, assigns and transferees and other registered proprietor or proprietors for the time being of all land comprised in the Plan of Subdivision and every part or parts thereof (other than the land hereby transferred) shall not erect or cause to be erected or construct on the land hereby sold a dwelling house other than constructed of brick, brick or masonry veneer, or other approved texture coated material of which such building materials must be new.

Continued on T2 Page 2.

Approval No. 325955A

ORDER TO REGISTER

STAMP DUTY USE ONLY

Please register and issue title to

T2

Signed

Cust. Code:



THE BACK OF THIS FORM MUST NOT BE USED

ANNEXURE PAGE

Transfer of Land Act 1958

AL672135H

The information from this form is collected under statutory authority and is used for the purpose of maintaining publicly searchable registers and indexes in the Victorian Land Registry.

This is page _____ of *Approved Form* dated 30/01/15 between
NARRE WARREN SPRINGS PTY LTD ACN 140 554 552 and HIRAL
Signatures of the parties PATEL.

Panel Heading

EXECUTED BY NARRE WARREN SPRINGS)
PTY LTD ACN 140 554 552 in)
accordance with Section 127 (1) of)
the Corporations Act 2001 by)
authority of the Directors)

Director:
Michael Joseph Corcoris of 31 Casey Drive,
Berwick 3806

Director:
Nicole Hendriks of 1/12 Aikman Crescent,
Chadstone 3148.

Signed by the Transferee
in the presence of:

.....
witness.

Sayal Patel

)
) Patel Hiral N.
)

Approval No. 325955A

A1



1. If there is insufficient space to accommodate the required information in a panel of the *Approved Form* insert the words "See Annexure Page 2" (or as the case may be) and enter all the information on the Annexure Page under the appropriate panel heading. **THE BACK OF THE ANNEXURE PAGE IS NOT TO BE USED.**
2. If multiple copies of the instrument are lodged, original Annexure Pages must be attached to each.
3. The Annexure Pages must be properly identified and signed by the parties to the *Approved Form* to which it is annexed.
4. All pages must be attached together by being stapled in the top left corner.

PLANNING PROPERTY REPORT



VICTORIA
State
Government

Department
of Transport
and Planning

From www.planning.vic.gov.au at 08 July 2025 12:19 PM

PROPERTY DETAILS

Address: **13 FEODORA CRESCENT NARRE WARREN 3805**
Lot and Plan Number: **Lot 138 PS644330**
Standard Parcel Identifier (SPI): **138\PS644330**
Local Government Area (Council): **CASEY**
Council Property Number: **118570**
Planning Scheme: **Casey**
Directory Reference: **Melway 110 F11**

www.casey.vic.gov.au

[Planning Scheme - Casey](#)

UTILITIES

Rural Water Corporation: **Southern Rural Water**
Melbourne Water Retailer: **South East Water**
Melbourne Water: **Inside drainage boundary**
Power Distributor: **AUSNET**

STATE ELECTORATES

Legislative Council: **SOUTH-EASTERN METROPOLITAN**
Legislative Assembly: **NARRE WARREN NORTH**

OTHER

Registered Aboriginal Party: **Bunurong Land Council
Aboriginal Corporation**

[View location in VicPlan](#)

Planning Zones

[GENERAL RESIDENTIAL ZONE \(GRZ\)](#)

[GENERAL RESIDENTIAL ZONE - SCHEDULE 1 \(GRZ1\)](#)

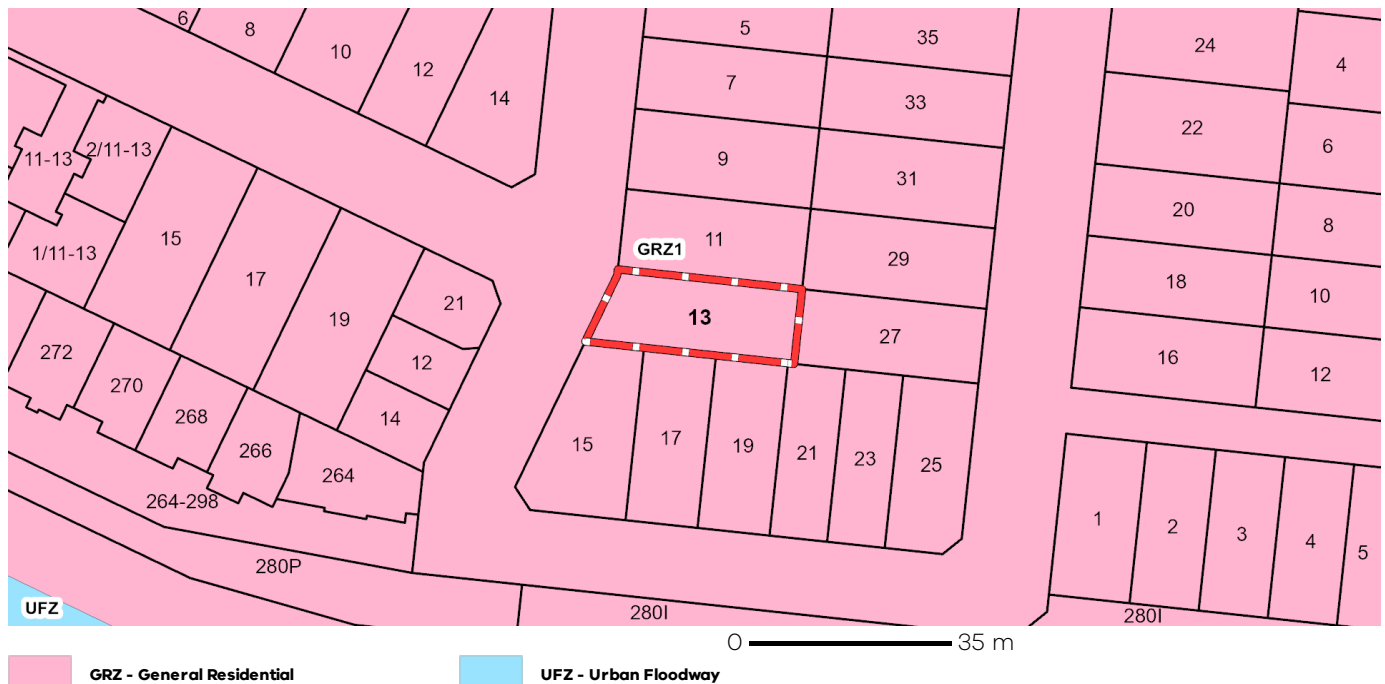

Note: labels for zones may appear outside the actual zone - please compare the labels with the legend.

Copyright © - State Government of Victoria

Disclaimer: This content is provided for information purposes only. No claim is made as to the accuracy or authenticity of the content. The Victorian Government does not accept any liability to any person for the information provided.

Read the full disclaimer at <https://www.delwp.vic.gov.au/disclaimer>

Notwithstanding this disclaimer, a vendor may rely on the information in this report for the purpose of a statement that land is in a bushfire prone area as required by section 32C (b) of the Sale of Land 1962 (Vic).

PLANNING PROPERTY REPORT: 13 FEODORA CRESCENT NARRE WARREN 3805

Page 1 of 5

Planning Overlay

None affecting this land - there are overlays in the vicinity

OTHER OVERLAYS

Other overlays in the vicinity not directly affecting this land

LAND SUBJECT TO INUNDATION OVERLAY (LSIO)



 **LSIO - Land Subject to Inundation Overlay**

Note: due to overlaps, some overlays may not be visible, and some colours may not match those in the legend

Areas of Aboriginal Cultural Heritage Sensitivity

All or part of this property is an 'area of cultural heritage sensitivity'.

'Areas of cultural heritage sensitivity' are defined under the Aboriginal Heritage Regulations 2018, and include registered Aboriginal cultural heritage places and land form types that are generally regarded as more likely to contain Aboriginal cultural heritage.

Under the Aboriginal Heritage Regulations 2018, 'areas of cultural heritage sensitivity' are one part of a two part trigger which require a 'cultural heritage management plan' be prepared where a listed 'high impact activity' is proposed.

If a significant land use change is proposed (for example, a subdivision into 3 or more lots), a cultural heritage management plan may be triggered. One or two dwellings, works ancillary to a dwelling, services to a dwelling, alteration of buildings and minor works are examples of works exempt from this requirement.

Under the Aboriginal Heritage Act 2006, where a cultural heritage management plan is required, planning permits, licences and work authorities cannot be issued unless the cultural heritage management plan has been approved for the activity.

For further information about whether a Cultural Heritage Management Plan is required go to <http://www.aav.nrms.net.au/aavQuestion1.aspx>

More information, including links to both the Aboriginal Heritage Act 2006 and the Aboriginal Heritage Regulations 2018, can also be found here - <https://www.aboriginalvictoria.vic.gov.au/aboriginal-heritage-legislation>



Further Planning Information

Planning scheme data last updated on 3 July 2025.

A **planning scheme** sets out policies and requirements for the use, development and protection of land.

This report provides information about the zone and overlay provisions that apply to the selected land.

Information about the State and local policy, particular, general and operational provisions of the local planning scheme that may affect the use of this land can be obtained by contacting the local council

or by visiting <https://www.planning.vic.gov.au>

This report is NOT a **Planning Certificate** issued pursuant to Section 199 of the **Planning and Environment Act 1987**.

It does not include information about exhibited planning scheme amendments, or zonings that may affect the land.

To obtain a Planning Certificate go to Titles and Property Certificates at Landata - <https://www.landata.vic.gov.au>

For details of surrounding properties, use this service to get the Reports for properties of interest.

To view planning zones, overlay and heritage information in an interactive format visit

<https://mapshare.maps.vic.gov.au/vicplan>

For other information about planning in Victoria visit <https://www.planning.vic.gov.au>

Designated Bushfire Prone Areas

This property is in a designated bushfire prone area. Special bushfire construction requirements apply to the part of the property mapped as a designated bushfire prone area (BPA). Planning provisions may apply.

Where part of the property is mapped as BPA, if no part of the building envelope or footprint falls within the BPA area, the BPA construction requirements do not apply.

Note: the relevant building surveyor determines the need for compliance with the bushfire construction requirements.



Designated BPA are determined by the Minister for Planning following a detailed review process. The Building Regulations 2018, through adoption of the Building Code of Australia, apply bushfire protection standards for building works in designated BPA.

Designated BPA maps can be viewed on VicPlan at <https://mapshare.vic.gov.au/vicplan/> or at the relevant local council.

Create a BPA definition plan in [VicPlan](#) to measure the BPA.

Information for lot owners building in the BPA is available at <https://www.planning.vic.gov.au>.

Further information about the building control system and building in bushfire prone areas can be found on the Victorian Building Authority website <https://www.vba.vic.gov.au>. Copies of the Building Act and Building Regulations are available from <http://www.legislation.vic.gov.au>. For Planning Scheme Provisions in bushfire areas visit <https://www.planning.vic.gov.au>.

Native Vegetation

Native plants that are indigenous to the region and important for biodiversity might be present on this property. This could include trees, shrubs, herbs, grasses or aquatic plants. There are a range of regulations that may apply including need to obtain a planning permit under Clause 52.17 of the local planning scheme. For more information see [Native Vegetation \(Clause 52.17\)](#) with local variations in [Native Vegetation \(Clause 52.17\) Schedule](#)

To help identify native vegetation on this property and the application of Clause 52.17 please visit the Native Vegetation Information Management system <https://nvim.delwp.vic.gov.au/> and [Native vegetation \(environment.vic.gov.au\)](#) or please contact your relevant council.

You can find out more about the natural values on your property through NatureKit [NatureKit \(environment.vic.gov.au\)](#)

PLANNING CERTIFICATE

Official certificate issued under Section 199 Planning & Environment Act 1987
and the Planning and Environment Regulations 2005

CERTIFICATE REFERENCE NUMBER

1154699

APPLICANT'S NAME & ADDRESS

**MND LAWYERS C/- LANDATA
MELBOURNE**

VENDOR

PATEL, HIRAL NATVARBHAI

PURCHASER

X, X

REFERENCE

HIRAL

This certificate is issued for:

LOT 138 PLAN PS644330 ALSO KNOWN AS 13 FEODORA CRESCENT NARRE WARREN
CASEY CITY

The land is covered by the:

CASEY PLANNING SCHEME

The Minister for Planning is the responsible authority issuing the Certificate.

The land:

- is included in a GENERAL RESIDENTIAL ZONE - SCHEDULE 1

A detailed definition of the applicable Planning Scheme is available at :
(<http://planningschemes.dpcd.vic.gov.au/schemes/casey>)

Historic buildings and land protected under the Heritage Act 1995 are recorded in the Victorian Heritage Register at:

<http://vhd.heritage.vic.gov.au/>

08 July 2025

**Sonya Kilkenny
Minister for Planning**

Additional site-specific controls may apply.
The Planning Scheme Ordinance should be checked carefully.

The above information includes all amendments to planning scheme maps placed on public exhibition up to the date of issue of this certificate and which are still the subject of active consideration

Copies of Planning Schemes and Amendments can be inspected at the relevant municipal offices.

LANDATA®
T: (03) 9102 0402
E: landata.enquiries@servictoria.com.au

The attached certificate is issued by the Minister for Planning of the State of Victoria and is protected by statute.

The document has been issued based on the property information you provided. You should check the map below - it highlights the property identified from your information.

If this property is different to the one expected, you can phone (03) 9102 0402 or email landata.enquiries@servictoria.com.au

Please note: The map is for reference purposes only and does not form part of the certificate.



Choose the authoritative Planning Certificate

Why rely on anything less?

As part of your section 32 statement, the authoritative Planning Certificate provides you and / or your customer with the statutory protection of the State of Victoria.
Order online before 4pm to receive your authoritative Planning Certificate the same day, in most cases within the hour.
Next business day delivery, if further information is required from you.

Privacy Statement

The information obtained from the applicant and used to produce this certificate was collected solely for the purpose of producing this certificate. The personal information on the certificate has been provided by the applicant and has not been verified by LANDATA®. The property information on the certificate has been verified by LANDATA®. The zoning information on the certificate is protected by statute. The information on the certificate will be retained by LANDATA® for auditing purposes and will not be released to any third party except as required by law.

Extract of EPA Priority Site Register

Page 1 of 1

PROPERTY INQUIRY DETAILS:

STREET ADDRESS: 13 FEODORA CRESCENT

SUBURB: NARRE WARREN

MUNICIPALITY: CASEY

MAP REFERENCES: Melways 40th Edition, Street Directory, Map 110 Reference F11

DATE OF SEARCH: 8th July 2025

ACKNOWLEDGMENT AND IMPORTANT INFORMATION ABOUT THE PRIORITY SITES REGISTER AND THIS EXTRACT:

A search of the Priority Sites Register for the above map reference(Melways), corresponding to the street address provided above, has indicated there is no Priority Site within the same map reference based on the most recent file provided to LANDATA by the Environment Protection Authority, Victoria (EPA).

The Priority Sites Register is not an exhaustive or comprehensive list of contaminated sites in Victoria. A site should not be presumed to be free of contamination just because it does not appear on the Priority Sites Register. Persons intending to enter into property transactions should be aware that EPA may not have information regarding all contaminated sites. While EPA has published information regarding potentially contaminating land uses, local councils and other relevant planning authorities may hold additional records or data concerning historical land uses. It is recommended that these sources of information should also be consulted in addition to this Extract.

Prospective buyers or parties to property transactions should undertake their own independent investigations and due diligence. This Extract should not be relied upon as the sole source of information regarding site contamination.

To the maximum extent permitted by law:

- Neither LANDATA, SERV nor EPA warrants the accuracy or completeness of the information in this Extract. Any person using or relying upon such information does so on the basis that LANDATA, SERV and EPA assume no liability whatsoever for any errors, faults, defects or omissions in the information in this Extract. Users are advised to undertake independent due diligence and seek professional advice before relying on this information
- Users of this Extract accept all risks and responsibilities for losses, damages, costs or other consequences resulting directly or indirectly from reliance on the information in this Extract or any related information; and
- LANDATA, SERV and EPA expressly disclaim all liability to any person for any claims arising from the use of this Extract or information therein. In circumstances where liability cannot be excluded, the total liability of LANDATA, SERV and EPA is limited to the payment made by you for the supply by LANDATA of this Extract.

For sites listed on the Priority Sites Register, copies of the relevant Notices, including reasons for issuance and associated management requirements, is available on request from EPA through the contact centre via 1300 EPA VIC (1300 372 842). For more information relating to the Priority Sites Register, refer to the EPA website at: <https://www.epa.vic.gov.au/for-community/environmental-information/land-groundwater-pollution/priority-sites-register>

Contact City of Casey

03 9705 5200

NRS: 133 677 (for the deaf,
hearing or speech impaired)TIS: 131 450 (Translating
and Interpreting Service)

caseycc@casey.vic.gov.au

PO Box 1000
Narre Warren VIC 3805

ABN: 43 320 295 742

Customer Service Centres**Narre Warren**

Bunjil Place, Patrick Northeast Drive

Cranbourne

Cranbourne Park Shopping Centre



LAND INFORMATION CERTIFICATE

SECTION 229 LOCAL GOVERNMENT ACT 1989

Certificate Number: wCerR/C069439

Issue Date: 14 July 2025

Your Reference: HIRAL

Landata - Rates Web Certificates
C/- Victorian Land Registry Services Pty Ltd
L 13 697 Collins St
DOCKLANDS VIC 3008

Property Number:	118570
Property Address:	13 Feodora Crescent NARRE WARREN VIC 3805
Property Description:	Lot 138 PS 644330L
Land Area:	442 sqm

Valuation Date	01/07/2025	Effective Date	01/07/2025
Site Value	\$435,000		
Capital Improved Value	\$835,000		
Net Annual Value	\$41,750		

This certificate provides information regarding valuation, rates, charges, other moneys owing and any orders and notices made under the **Local Government Act 1989**, or under a local law of the Council and specified flood level by the Council (if any). This certificate is not required to include information regarding planning, building, health, land fill, land slip, flooding information or service easements. Information regarding these matters may be available from Council or the relevant authority. A fee may be charged for such information.

Details for financial year ending 30th June 2026

Rate Category		
Current Year's General Rates	1,831.28	
Current Year's Garbage Charge	468.00	
Current Year's ESVF Levy	280.46	
Current Rates Year's Charges - SUB TOTAL		2,579.74
Current Rates Year Adjust\Payments - SUB TOTAL		0.00
Arrears		6,983.62
Scheme Charges		
Scheme Charges - TOTAL		0.00
TOTAL BALANCE OUTSTANDING		\$9,563.36

PLEASE NOTE: In accordance with section 175(1) of the Local Government Act 1989, the purchaser must pay all overdue rates and charges at the time that person becomes the

Contact City of Casey

03 9705 5200

NRS: 133 677 (for the deaf, hearing or speech impaired)

TIS: 131 450 (Translating and Interpreting Service)

caseycc@casey.vic.gov.au

PO Box 1000
Narre Warren VIC 3805

ABN: 43 320 295 742

Customer Service Centres

Narre Warren

Bunjil Place, Patrick Northeast Drive

Cranbourne

Cranbourne Park Shopping Centre



owner of the land. All other amounts must be paid by their due dates to avoid penalty interest at 10.00% p.a. Full rate payments are due by 16/02/2026.

PLEASE NOTE: Council will only give verbal updates to the applicant within 60 days of this certificate and it should be noted that Council will only be held responsible for information given in writing, i.e. a new certificate, and not information provided or confirmed verbally. For further information contact Council's Rate Department.

PLEASE NOTE: If property is assessed as a Part Lot (PT) - multiple notices may be required, contact council for further information.

Should you have any queries regarding this Certificate, please contact City of Casey and quote reference **wCerR/C069439**.

A handwritten signature in black ink, appearing to read "T. Riches".

Trevor Riches

Team Leader Rates and Valuations

PLEASE NOTE:

Interest continues to accrue at 10% until paid in full.

Electronic Payments



Billers Code: **8995**
Ref: 01185705

Telephone & Internet Banking - BPAY®

Contact your bank or financial institution to make this payment from your cheque, savings, debit, credit card or transaction account.

More info: www.bpay.com.au

Property Clearance Certificate

Land Tax



MND LAWYERS

Your Reference:	LD:77354353-013-5.HIRAL
Certificate No:	92153134
Issue Date:	08 JUL 2025
Enquiries:	MXS26

Land Address:	13 FEODORA CRESCENT NARRE WARREN VIC 3805
---------------	---

Land Id	Lot	Plan	Volume	Folio	Tax Payable
REFER TO ATTACHMENT					

Vendor: HIRAL PATEL
Purchaser: X X

Current Land Tax	Year Taxable Value (SV)	Proportional Tax	Penalty/Interest	Total
REFER TO ATTACHMENT				

Comments: Refer to attachment

Current Vacant Residential Land Tax	Year Taxable Value (CIV)	Tax Liability	Penalty/Interest	Total
REFER TO ATTACHMENT				

Comments: Refer to attachment

Arrears of Land Tax	Year	Proportional Tax	Penalty/Interest	Total

This certificate is subject to the notes that appear on the reverse. The applicant should read these notes carefully.

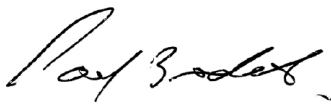
Paul Broderick
Commissioner of State Revenue

CAPITAL IMPROVED VALUE (CIV):	\$810,000
SITE VALUE (SV):	\$435,000
CURRENT LAND TAX AND VACANT RESIDENTIAL LAND TAX CHARGE:	\$6,790.00



Notes to Certificate - Land Tax

Certificate No: 92153134

Power to issue Certificate

1. Pursuant to section 95AA of the *Taxation Administration Act 1997*, the Commissioner of State Revenue must issue a Property Clearance Certificate (Certificate) to an owner, mortgagee or bona fide purchaser of land who makes an application specifying the land for which the Certificate is sought and pays the application fee.

Amount shown on Certificate

2. The Certificate shows any land tax (including Vacant Residential Land Tax, interest and penalty tax) that is due and unpaid on the land described in the Certificate at the date of issue. In addition, it may show:
 - Land tax that has been assessed but is not yet due,
 - Land tax for the current tax year that has not yet been assessed, and
 - Any other information that the Commissioner sees fit to include, such as the amount of land tax applicable to the land on a single holding basis and other debts with respect to the property payable to the Commissioner.

Land tax is a first charge on land

3. Unpaid land tax (including Vacant Residential Land Tax, interest and penalty tax) is a first charge on the land to which it relates. This means it has priority over any other encumbrances on the land, such as a mortgage, and will continue as a charge even if ownership of the land is transferred. Therefore, a purchaser may become liable for any such unpaid land tax.

Information for the purchaser

4. Pursuant to section 96 of the *Land Tax Act 2005*, if a purchaser of the land described in the Certificate has applied for and obtained a certificate, the amount recoverable from the purchaser by the Commissioner cannot exceed the amount set out in the certificate, described as the "Current Land Tax Charge and Vacant Residential Land Tax Charge" overleaf. A purchaser cannot rely on a Certificate obtained by the vendor.

Information for the vendor

5. Despite the issue of a Certificate, the Commissioner may recover a land tax liability from a vendor, including any amount identified on this Certificate.

Apportioning or passing on land tax to a purchaser

6. A vendor is prohibited from apportioning or passing on land tax including vacant residential land tax, interest and penalty tax to a purchaser under a contract of sale of land entered into on or after 1 January 2024, where the purchase price is less than \$10 million (to be indexed annually from 1 January 2025, as set out on the website for Consumer Affairs Victoria).

General information

7. A Certificate showing no liability for the land does not mean that the land is exempt from land tax. It means that there is nothing to pay at the date of the Certificate.
8. An updated Certificate may be requested free of charge via our website, if:
 - The request is within 90 days of the original Certificate's issue date, and
 - There is no change to the parties involved in the transaction for which the Certificate was originally requested.

For Information Only

LAND TAX CALCULATION BASED ON SINGLE OWNERSHIP

Land Tax = \$1,755.00

Taxable Value = \$435,000

Calculated as \$1,350 plus (\$435,000 - \$300,000) multiplied by 0.300 cents.

VACANT RESIDENTIAL LAND TAX CALCULATION

Vacant Residential Land Tax = \$8,100.00

Taxable Value = \$810,000

Calculated as \$810,000 multiplied by 1.000%.

Land Tax - Payment Options

BPAY



Billers Code: 5249
Ref: 92153134

Telephone & Internet Banking - BPAY®

Contact your bank or financial institution to make this payment from your cheque, savings, debit or transaction account.

www.bpay.com.au

CARD



Ref: 92153134

Visa or Mastercard

Pay via our website or phone 13 21 61.
A card payment fee applies.

sro.vic.gov.au/paylandtax

Property Clearance Certificate

Land Tax

Certificate No: 92153134

Land Address: 13 FEODORA CRESCENT NARRE WARREN VIC 3805

Land Id	Lot	Plan	Volume	Folio	Tax Payable
41895521	138	644330	11546	248	\$6,790.00

Land Tax Details	Year	Taxable Value	Proportional Tax	Penalty/Interest	Total
MR HIRAL PATEL	2025	\$435,000	\$1,755.00	\$0.00	\$1,755.00
MR HIRAL PATEL	2024	\$420,000	\$1,710.00	\$0.00	\$1,710.00
MR HIRAL PATEL	2023	\$460,000	\$695.00	\$0.00	\$695.00
MR HIRAL PATEL	2022	\$380,000	\$535.00	\$0.00	\$535.00
MR HIRAL PATEL	2021	\$365,000	\$505.00	\$0.00	\$505.00
MR HIRAL PATEL	2020	\$370,000	\$515.00	\$0.00	\$515.00
MR HIRAL PATEL	2019	\$375,000	\$525.00	\$0.00	\$525.00
MR HIRAL PATEL	2018	\$250,000	\$275.00	\$0.00	\$275.00
MR HIRAL PATEL	2017	\$250,000	\$275.00	\$0.00	\$275.00

Comments:

Vacant Residential Land Tax Details	Year	Taxable Value	Tax Liability	Penalty/Interest	Total
-------------------------------------	------	---------------	---------------	------------------	-------

Comments:

Current Land Tax Charge: 41895521 \$6,790.00

Total: \$6,790.00

Property Clearance Certificate

Commercial and Industrial Property Tax



MND LAWYERS

Your Reference: LD:77354353-013-5.HIRAL

Certificate No: 92153134

Issue Date: 08 JUL 2025

Enquires: MXS26

Land Address: 13 FEODORA CRESCENT NARRE WARREN VIC 3805

Land Id	Lot	Plan	Volume	Folio	Tax Payable
41895521	138	644330	11546	248	\$0.00
AVPCC	Date of entry into reform	Entry interest	Date land becomes CIPT taxable land	Comment	
110	N/A	N/A	N/A	The AVPCC allocated to the land is not a qualifying use.	

This certificate is subject to the notes found on the reverse of this page. The applicant should read these notes carefully.

Paul Broderick
Commissioner of State Revenue

CAPITAL IMPROVED VALUE:	\$810,000
SITE VALUE:	\$435,000
CURRENT CIPT CHARGE:	\$0.00

Notes to Certificate - Commercial and Industrial Property Tax

Certificate No: 92153134

Power to issue Certificate

1. Pursuant to section 95AA of the *Taxation Administration Act 1997*, the Commissioner of State Revenue must issue a Property Clearance Certificate (Certificate) to an owner, mortgagee or bona fide purchaser of land who makes an application specifying the land for which the Certificate is sought and pays the application fee.

Amount shown on Certificate

2. The Certificate shows any commercial and industrial property tax (including interest and penalty tax) that is due and unpaid on the land described in the Certificate at the date of issue.

Australian Valuation Property Classification Code (AVPCC)

3. The Certificate may show one or more AVPCC in respect of land described in the Certificate. The AVPCC shown on the Certificate is the AVPCC allocated to the land in the most recent of the following valuation(s) of the land under the *Valuation of Land Act 1960*:
 - a general valuation of the land;
 - a supplementary valuation of the land returned after the general valuation.
4. The AVPCC(s) shown in respect of land described on the Certificate can be relevant to determine if the land has a qualifying use, within the meaning given by section 4 of the *Commercial and Industrial Property Tax Reform Act 2024* (CIPT Act). Section 4 of the CIPT Act Land provides that land will have a qualifying use if:
 - the land has been allocated one, or more than one, AVPCC in the latest valuation, all of which are in the range 200-499 and/or 600-699 in the Valuation Best Practice Specifications Guidelines (the requisite range);
 - the land has been allocated more than one AVPCC in the latest valuation, one or more of which are inside the requisite range and one or more of which are outside the requisite range, and the land is used solely or primarily for a use described in an AVPCC in the requisite range; or
 - the land is used solely or primarily as eligible student accommodation, within the meaning of section 3 of the CIPT Act.

Commercial and industrial property tax information

5. If the Commissioner has identified that land described in the Certificate is tax reform scheme land within the meaning given by section 3 of the CIPT Act, the Certificate may show in respect of the land:
 - the date on which the land became tax reform scheme land;
 - whether the entry interest (within the meaning given by section 3 of the Duties Act 2000) in relation to the tax reform scheme land was a 100% interest (a whole interest) or an interest of less than 100% (a partial interest); and
 - the date on which the land will become subject to the commercial and industrial property tax.
6. A Certificate that does not show any of the above information in respect of land described in the Certificate does not mean that the land is not tax reform scheme land. It means that the Commissioner has not identified that the land is tax reform scheme land at the date of issue of the Certificate. The Commissioner may identify that the land is tax reform scheme land after the date of issue of the Certificate.

Change of use of tax reform scheme land

7. Pursuant to section 34 of the CIPT Act, an owner of tax reform scheme land must notify the Commissioner of certain changes of use of tax reform scheme land (or part of the land) including if the actual use of the land changes to a use not described in any AVPCC in the range 200-499 and/or 600-699. The notification

must be given to the Commissioner within 30 days of the change of use.

Commercial and industrial property tax is a first charge on land

8. Commercial and industrial property tax (including any interest and penalty tax) is a first charge on the land to which the commercial and industrial property tax is payable. This means it has priority over any other encumbrances on the land, such as a mortgage, and will continue as a charge even if ownership of the land is transferred. Therefore, a purchaser may become liable for any unpaid commercial and industrial property tax.

Information for the purchaser

9. Pursuant to section 27 of the CIPT Act, if a bona fide purchaser for value of the land described in the Certificate applies for and obtains a Certificate in respect of the land, the maximum amount recoverable from the purchaser is the amount set out in the Certificate. A purchaser cannot rely on a Certificate obtained by the vendor.

Information for the vendor

10. Despite the issue of a Certificate, the Commissioner may recover a commercial and industrial property tax liability from a vendor, including any amount identified on this Certificate.

Passing on commercial and industrial property tax to a purchaser

11. A vendor is prohibited from apportioning or passing on commercial and industrial property tax to a purchaser under a contract of sale of land entered into on or after 1 July 2024 where the purchase price is less than \$10 million (to be indexed annually from 1 January 2025, as set out on the website for Consumer Affairs Victoria).

General information

12. Land enters the tax reform scheme if there is an entry transaction, entry consolidation or entry subdivision in respect of the land (within the meaning given to those terms in the CIPT Act). Land generally enters the reform on the date on which an entry transaction occurs in respect of the land (or the first date on which land from which the subject land was derived (by consolidation or subdivision) entered the reform).
13. The Duties Act includes exemptions from duty, in certain circumstances, for an eligible transaction (such as a transfer) of tax reform scheme land that has a qualifying use on the date of the transaction. The exemptions apply differently based on whether the entry interest in relation to the land was a whole interest or a partial interest. For more information, please refer to www.sro.vic.gov.au/CIPT.
14. A Certificate showing no liability for the land does not mean that the land is exempt from commercial and industrial property tax. It means that there is nothing to pay at the date of the Certificate.
15. An updated Certificate may be requested free of charge via our website, if:
 - the request is within 90 days of the original Certificate's issue date, and
 - there is no change to the parties involved in the transaction for which the Certificate was originally requested.

Property Clearance Certificate

Windfall Gains Tax



MND LAWYERS

Your Reference:	LD:77354353-013-5.HIRAL
Certificate No:	92153134
Issue Date:	08 JUL 2025

Land Address: 13 FEODORA CRESCENT NARRE WARREN VIC 3805

Lot	Plan	Volume	Folio
138	644330	11546	248

Vendor: HIRAL PATEL

Purchaser: X X

WGT Property Id	Event ID	Windfall Gains Tax	Deferred Interest	Penalty/Interest	Total
		\$0.00	\$0.00	\$0.00	\$0.00

Comments: No windfall gains tax liability identified.

This certificate is subject to the notes that appear on the reverse. The applicant should read these notes carefully.

Paul Broderick
Commissioner of State Revenue

CURRENT WINDFALL GAINS TAX CHARGE:
\$0.00



Notes to Certificate - Windfall Gains Tax

Certificate No: 92153134

Power to issue Certificate

1. Pursuant to section 95AA of the *Taxation Administration Act 1997*, the Commissioner of State Revenue must issue a Property Clearance Certificate (Certificate) to an owner, mortgagee or bona fide purchaser of land who makes an application specifying the land for which the Certificate is sought and pays the application fee.

Amount shown on Certificate

2. The Certificate shows in respect of the land described in the Certificate:
- Windfall gains tax that is due and unpaid, including any penalty tax and interest
 - Windfall gains tax that is deferred, including any accrued deferral interest
 - Windfall gains tax that has been assessed but is not yet due
 - Windfall gains tax that has not yet been assessed (i.e. a WGT event has occurred that rezones the land but any windfall gains tax on the land is yet to be assessed)
 - Any other information that the Commissioner sees fit to include such as the amount of interest accruing per day in relation to any deferred windfall gains tax.

Windfall gains tax is a first charge on land

3. Pursuant to section 42 of the *Windfall Gains Tax Act 2021*, windfall gains tax, including any accrued interest on a deferral, is a first charge on the land to which it relates. This means it has priority over any other encumbrances on the land, such as a mortgage, and will continue as a charge even if ownership of the land is transferred. Therefore, a purchaser may become liable for any unpaid windfall gains tax.

Information for the purchaser

4. Pursuant to section 42 of the *Windfall Gains Tax Act 2021*, if a bona fide purchaser for value of land applies for and obtains a Certificate in respect of the land, the maximum amount recoverable from the purchaser by the Commissioner is the amount set out in the certificate, described as the "Current Windfall Gains Tax Charge" overleaf.
5. If the certificate states that a windfall gains tax is yet to be assessed, note 4 does not apply.
6. A purchaser cannot rely on a Certificate obtained by the vendor.

Information for the vendor

7. Despite the issue of a Certificate, the Commissioner may recover a windfall gains tax liability from a vendor, including any amount identified on this Certificate.

Passing on windfall gains tax to a purchaser

8. A vendor is prohibited from passing on a windfall gains tax liability to a purchaser where the liability has been assessed under a notice of assessment as at the date of the contract of sale of land or option agreement. This prohibition does not apply to a contract of sale entered into before 1 January 2024, or a contract of sale of land entered into on or after 1 January 2024 pursuant to the exercise of an option granted before 1 January 2024.

General information

9. A Certificate showing no liability for the land does not mean that the land is exempt from windfall gains tax. It means that there is nothing to pay at the date of the Certificate.
10. An updated Certificate may be requested free of charge via our website, if:
- The request is within 90 days of the original Certificate's issue date, and
 - There is no change to the parties involved in the transaction for which the Certificate was originally requested.
11. Where a windfall gains tax liability has been deferred, interest accrues daily on the deferred liability. The deferred interest shown overleaf is the amount of interest accrued to the date of issue of the certificate.

Windfall Gains Tax - Payment Options

<p>BPAY</p> <div><div><p>Billers Code: 416073 Ref: 92153139</p></div></div> <p>Telephone & Internet Banking - BPAY®</p> <p>Contact your bank or financial institution to make this payment from your cheque, savings, debit or transaction account.</p> <p>www.bpay.com.au</p>	<p>CARD</p> <div><div><p>Ref: 92153139</p></div></div> <p>Visa or Mastercard</p> <p>Pay via our website or phone 13 21 61. A card payment fee applies.</p> <p>sro.vic.gov.au/payment-options</p>	<p>Important payment information</p> <p>Windfall gains tax payments must be made using only these specific payment references.</p> <p>Using the incorrect references for the different tax components listed on this property clearance certificate will result in misallocated payments.</p>
--	---	--



**** Delivered by the LANDATA® System, Department of Environment, Land, Water & Planning ****

ROADS PROPERTY CERTIFICATE

The search results are as follows:

MND Lawyers
1/530 Little Collins St.
MELBOURNE 3000

Client Reference: HIRAL

NO PROPOSALS. As at the 8th July 2025, VicRoads has no approved proposals requiring any part of the property described in your application. You are advised to check your local Council planning scheme regarding land use zoning of the property and surrounding area.

This certificate was prepared solely on the basis of the Applicant-supplied address described below, and electronically delivered by LANDATA®.

13 FEODORA CRESCENT, NARRE WARREN 3805
CITY OF CASEY

This certificate is issued in respect of a property identified above. VicRoads expressly disclaim liability for any loss or damage incurred by any person as a result of the Applicant incorrectly identifying the property concerned.

Date of issue: 8th July 2025

Telephone enquiries regarding content of certificate: 13 11 71

[Vicroads Certificate] # 77354353 - 77354353115454 'HIRAL'

MND Lawyers
E-mail: certificates@landata.vic.gov.au

Statement for property:
LOT 138 13 FEODORA CRESCENT
NARRE WARREN 3805
138 PS 644330

REFERENCE NO.	YOUR REFERENCE	DATE OF ISSUE	CASE NUMBER
54F//15208/00018	LANDATA CER 77354353-029-6	08 JULY 2025	49741405

1. Statement of Fees Imposed

The property is classified as a serviced property with respect to charges which as listed below in the Statement of Fees.

(a) By Other Authorities

Parks Victoria - Parks Service Charge	01/07/2025 to 30/09/2025	\$22.45
Melbourne Water Corporation Total Service Charges	01/07/2025 to 30/09/2025	\$31.25

(b) By South East Water

Water Service Charge	01/07/2025 to 30/09/2025	\$21.97
Sewerage Service Charge	01/07/2025 to 30/09/2025	\$100.41
Subtotal Service Charges		\$176.08
Usage Charges*	Billed until 1/5/2025	\$4,807.20
Arrears		\$3,740.40
TOTAL UNPAID BALANCE		\$8,723.68

- The meter at the property was last read on 01/05/2025. Fees accrued since that date may be estimated by reference to the following historical information about the property:

Water Usage Charge **\$3.34 per day**

- Financial Updates (free service) are only available online please go to (type / copy the complete address shown below): <https://secureapp.southeastwater.com.au/PropertyConnect/#/order/info/update>

* Please Note: if usage charges appear above, the amount shown includes one or more of the following:

Water Usage, Recycled Water Usage, Sewage Disposal, Fire Service Usage and Trade Waste Volumetric Fees.

Interest may accrue on the South East Water charges listed in this statement if they are not paid by the due date as set out in the bill.

AUTHORISED OFFICER:



LARA SALEMBIER
GENERAL MANAGER
CUSTOMER EXPERIENCE

South East Water
Information Statement Applications
PO Box 2268, Seaford, VIC 3198

- The total annual service fees and volumetric fees for water usage and sewerage disposal for each class of property are set out at www.southeastwater.com.au.
- Updates of rates and other charges will only be provided for up to six months from the date of this statement.
- If this property has recently been subdivided from a "parent" title, there may be service or other charges owing on the "parent" which will be charged to this property, once sold, that do not appear on this statement. You must contact us to see if there are any such charges as they may be charged to this property on sale and should therefore be adjusted with the owner of the parent title beforehand.
- If the property is sold, the vendor is liable to pay all fees incurred in relation to the property until the vendor gives South East Water a Notice of Disposition of Land required by the Water (General) Regulations 2021, please include the Reference Number set out above in that Notice.
- Fees relating to the property may change from year-to-year in accordance with the Essential Service Commission's Price Determination for South East Water.
- Every fee referred to above is a charge against the property and will be recovered from a purchaser of the property if it is not paid by the vendor.
- Information about when and how outstanding fees may be paid, collected and recovered is set out in the Essential Services Commission's Customer Service Code, Urban Water Businesses.
- If this Statement only sets out rates and fees levied by Parks Victoria and Melbourne Water, the property may not be connected to South East Water's works. To find out whether the property is, or could be connected upon payment of the relevant charges, or whether it is separately metered, telephone 131 694.
- For a new connection to our water or sewer services, fees / charges will be levied.

2. Encumbrance Summary

Where available, the location of sewers is shown on the attached plan. Please ensure where manholes appear, that they remain accessible at all times "DO NOT COVER". Where driveways/paving is proposed to be constructed over easements for water supply/sewerage purposes, or within 1 metre of a South East Water asset, the owner will be responsible for all costs associated with any demolition and or re-instatement works, necessary to allow maintenance and or repair of the asset effected. Where changes to the surface levels requires maintenance shafts/holes to be altered, all works must be carried out by South East Water approved contractors only. For information call 131694. For all other works, prior consent is required from south East Water for any construction over easements for water supply/sewerage purposes, or within 1 metre of a South East Water asset.

The land is within an area declared an area of "Land Liable to Flooding" pursuant to Section 205 of the Water Act 1989. For further information contact Melbourne Water on 9679-7517.

The land has been filled in accordance with Melbourne Water requirements and is no longer considered to be "Land Liable to Flooding".

To assist in identifying if the property is connected to South East Waters sewerage system, connected by a shared, combined or encroaching drain, it is recommended you request a copy of the Property Sewerage Plan. A copy of the Property Sewerage Plan may be obtained for a fee at www.southeastwater.com.au. Part of the Property Sewerage Branch servicing the property may legally be the property owners responsibility to maintain not South East Waters. Refer to Section 11 of South East Waters Customer Charter to determine if this is the case. A copy of the Customer Charter can be found at www.southeastwater.com.au. When working in proximity of drains, care must be taken to prevent infiltration of foreign material and or ground water into South East Waters sewerage system. Any costs associated with rectification works will be charged to the property owner.

AUTHORISED OFFICER:

A handwritten signature in black ink, appearing to read "Lara Salembier".

LARA SALEMBIER
GENERAL MANAGER
CUSTOMER EXPERIENCE

South East Water
Information Statement Applications
PO Box 2268, Seaford, VIC 3198

ENCUMBRANCE ENQUIRY EMAIL infostatements@sew.com.au

If no plan is attached to this Statement, South East Water is not aware of any works belonging to South East Water being present on the property.

If a plan is attached to this Statement, it indicates the nature of works belonging to South East Water, their approximate location, and the approximate location of any easement relating to those works.

Important Warnings

The map base for any attached plan is not created by South East Water which cannot and does not guarantee the accuracy, adequacy or completeness of any information in the plan, especially the exact location of any of South East Water's works, which may have changes since the attached plan was prepared. Their location should therefore be proven by hand before any works are commenced on the land.

Unless South East Water's prior written approval is obtained, it is an offence to cause any structure to be built or any filling to be placed on a South East Water easement or within 1 metre laterally of any of its works or to permit any structure to be built above or below any such area.

Any work that requires any South East Water manhole or maintenance shaft to be altered may only be done by a contractor approved by South East Water at the property owner's cost.

If the owner builds or places filling in contravention of that requirement, the owner will be required to pay the cost of any demolition or re-instatement of work that South East Water considers necessary, in order to maintain, repair or replace its asset.

This Statement does not include any information about current or outstanding consent issued for plumbing works on at the property.

3. Disclaimer

This Statement does not contain all the information about the property that a prospective purchaser may wish to know. Accordingly, appropriate enquiries should be made of other sources and information.

South East Water has prepared the information in this Statement with due care and diligence. It cannot and does not accept liability for any loss or damage arising from reliance on the information given, beyond the extent set out in section 155 of the Water Act 1989 and sections 18 and 29 of the Australian Consumer Law.

AUTHORISED OFFICER:

A handwritten signature in black ink, appearing to read "Lara Salembier".

LARA SALEMBIER
GENERAL MANAGER
CUSTOMER EXPERIENCE

South East Water
Information Statement Applications
PO Box 2268, Seaford, VIC 3198

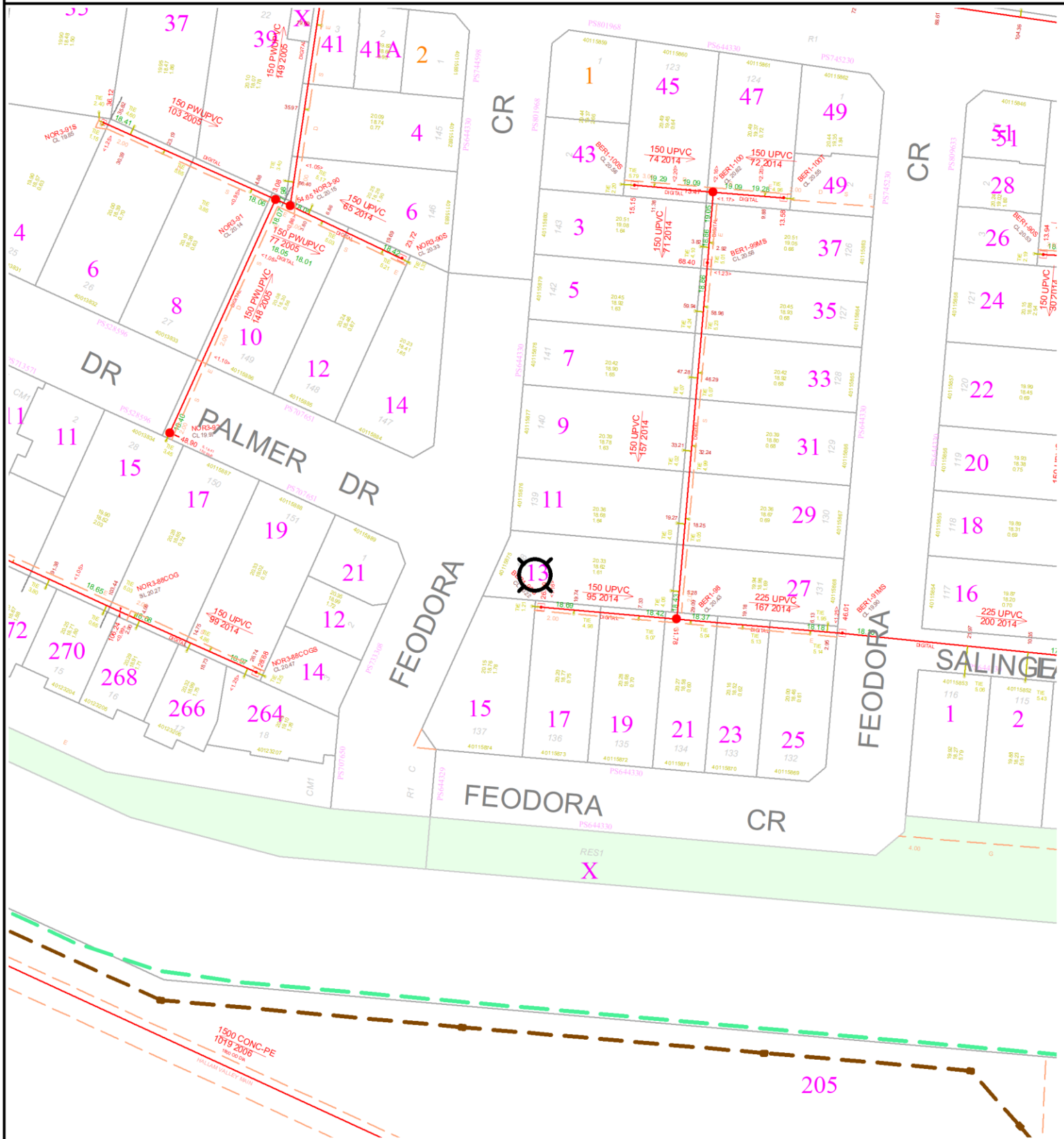

WARNING: This plan is issued solely for the purpose of assisting you in identifying South East Water's and Melbourne Water's specified assets through further investigation only. It is not to be used for any other purpose, including to identify any other assets, property boundaries or dimensions. Accordingly, the location of all assets should be proven by hand on site prior to the commencement of any work. (Refer to attached letter for further details). Assets labelled AC may contain asbestos and therefore works on these assets must be undertaken in accordance with OH&S Regulations. Abandoned and currently unused assets are shown in orange.

	Title/Road Boundary		Subject Property		Maintenance Hole
	Proposed Title/Road		Sewer Main & Property Connections		Inspection Shaft
	Easement		Direction of Flow		Offset from Boundary

	Sewer Main		Underground Drain		Natural Waterway
	Maintenance Hole		Channel Drain		Underground Drain M.H.

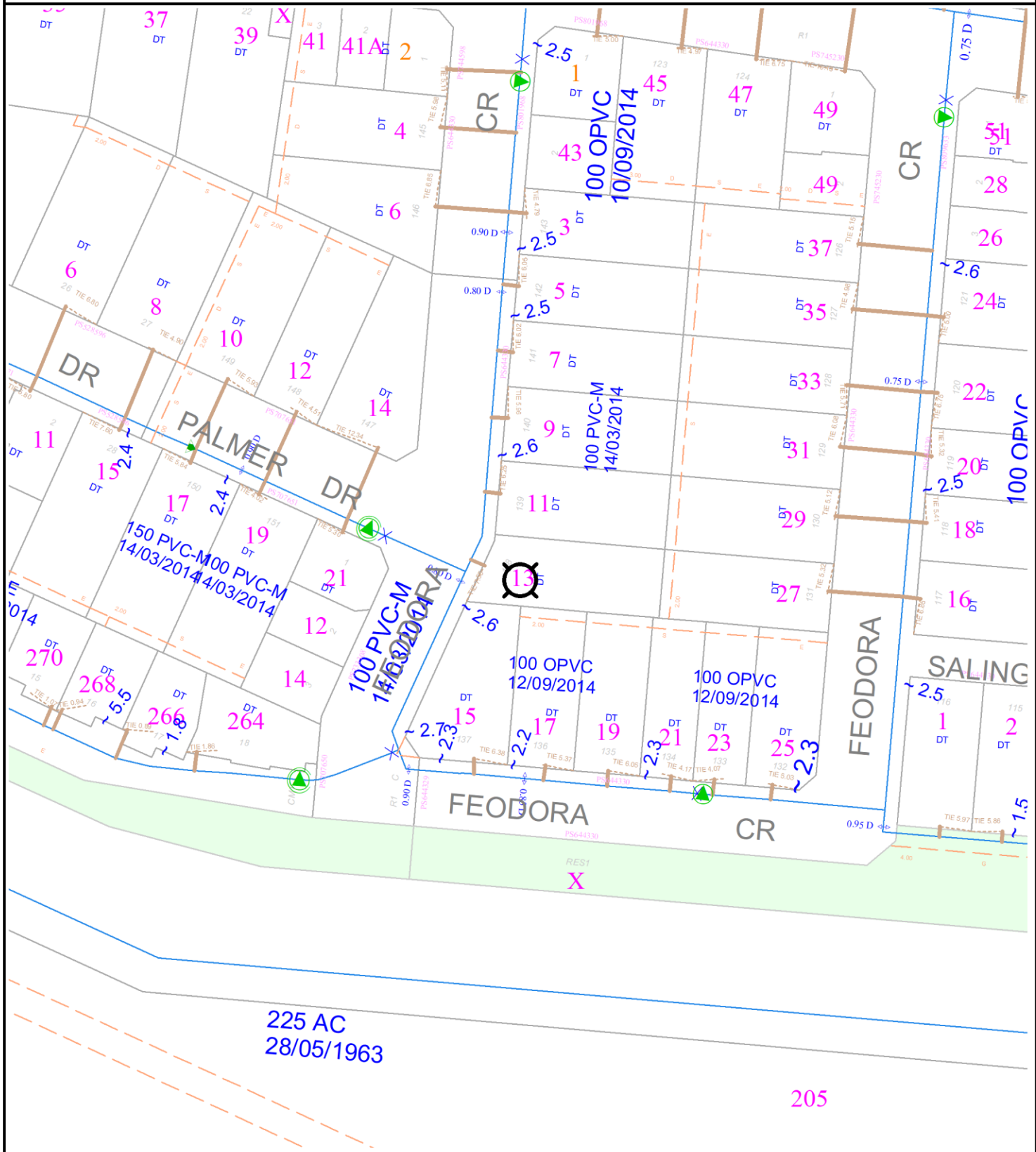

WARNING: This plan is issued solely for the purpose of assisting you in identifying South East Water's and Melbourne Water's specified assets through further investigation only. It is not to be used for any other purpose, including to identify any other assets, property boundaries or dimensions. Accordingly, the location of all assets should be proven by hand on site prior to the commencement of any work. (Refer to attached letter for further details). Assets labelled AC may contain asbestos and therefore works on these assets must be undertaken in accordance with OH&S Regulations. Abandoned and currently unused assets are shown in orange.

LEGEND			
	Title/Road Boundary		Subject Property
	Proposed Title/Road		Water Main Valve
	Easement		Water Main & Services
			Hydrant
			Fireplug/Washout
			Offset from Boundary



ASSET INFORMATION - RECYCLED WATER

(RECYCLE WATER WILL APPEAR IF IT'S AVAILABLE)

Property: Lot 138 13 FEODORA CRESCENT NARRE WARREN 3805

Case Number: 49741405

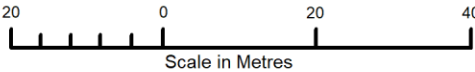

Date: 08JULY2025

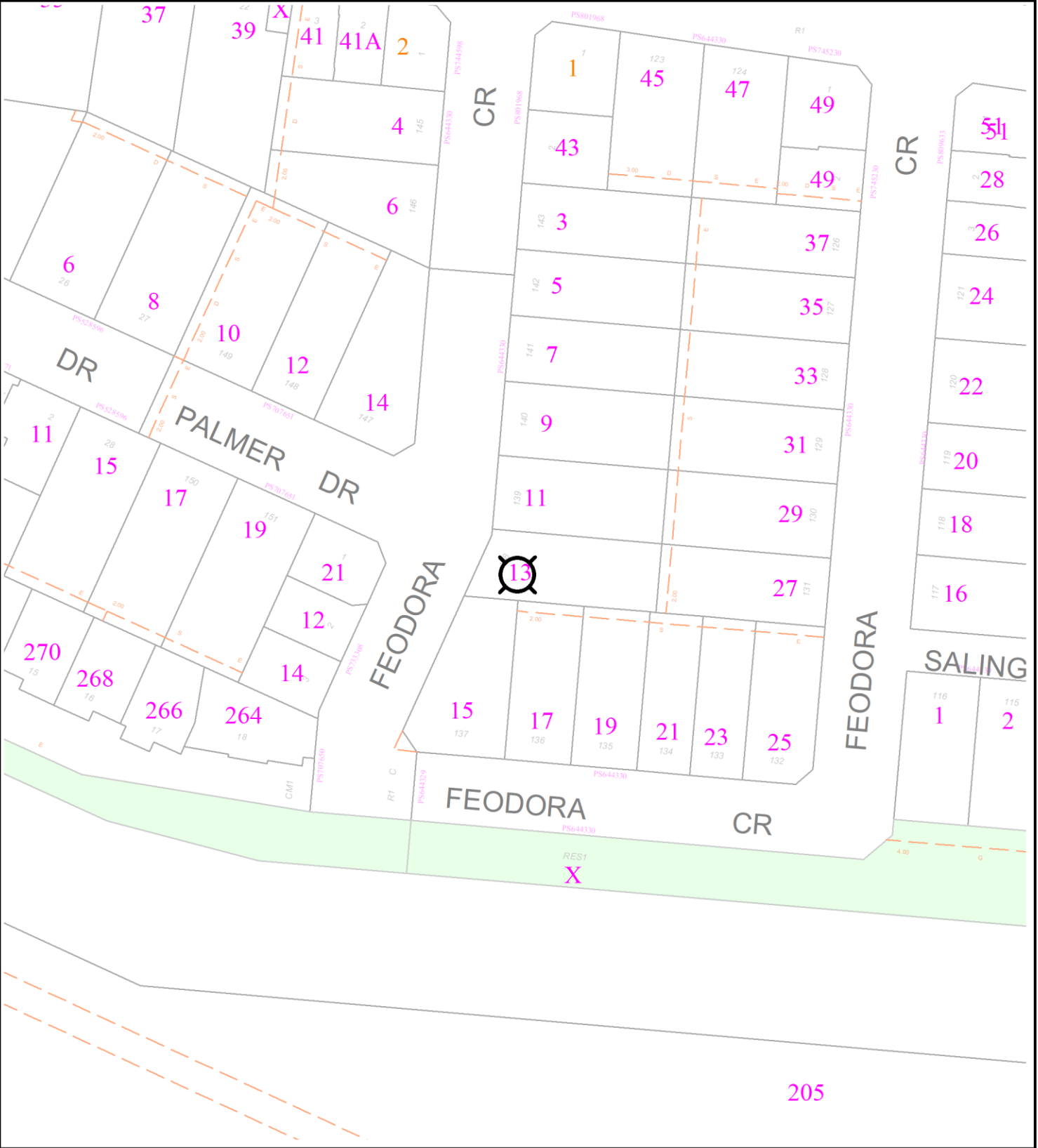

WARNING: This plan is issued solely for the purpose of assisting you in identifying South East Water's and Melbourne Water's specified assets through further investigation only. It is not to be used for any other purpose, including to identify any other assets, property boundaries or dimensions. Accordingly, the location of all assets should be proven by hand on site prior to the commencement of any work. (Refer to attached letter for further details). Assets labelled AC may contain asbestos and therefore works on these assets must be undertaken in accordance with OH&S Regulations. Abandoned and currently unused assets are shown in orange.

LEGEND					
	Title/Road Boundary		Subject Property		Hydrant
	Proposed Title/Road		Recycled Water Main Valve		Fireplug/Washout
	Easement		Recycled Water Main & Services		Offset from Boundary
				~ 1.0	

Due diligence checklist

What you need to know before buying a residential property

Before you buy a home, you should be aware of a range of issues that may affect that property and impose restrictions or obligations on you, if you buy it. This checklist aims to help you identify whether any of these issues will affect you. The questions are a starting point only and you may need to seek professional advice to answer some of them. You can find links to organisations and web pages that can help you learn more, by visiting the [Due diligence checklist page on the Consumer Affairs Victoria website](http://consumer.vic.gov.au/duediligencechecklist) (consumer.vic.gov.au/duediligencechecklist).

Urban living

Moving to the inner city?

High density areas are attractive for their entertainment and service areas, but these activities create increased traffic as well as noise and odours from businesses and people. Familiarising yourself with the character of the area will give you a balanced understanding of what to expect.

Is the property subject to an owners corporation?

If the property is part of a subdivision with common property such as driveways or grounds, it may be subject to an owners corporation. You may be required to pay fees and follow rules that restrict what you can do on your property, such as a ban on pet ownership.

Growth areas

Are you moving to a growth area?

You should investigate whether you will be required to pay a growth areas infrastructure contribution.

Flood and fire risk

Does this property experience flooding or bushfire?

Properties are sometimes subject to the risk of fire and flooding due to their location. You should properly investigate these risks and consider their implications for land management, buildings and insurance premiums.

Rural properties

Moving to the country?

If you are looking at property in a rural zone, consider:

- Is the surrounding land use compatible with your lifestyle expectations? Farming can create noise or odour that may be at odds with your expectations of a rural lifestyle.
- Are you considering removing native vegetation? There are regulations which affect your ability to remove native vegetation on private property.
- Do you understand your obligations to manage weeds and pest animals?

Can you build new dwellings?

Does the property adjoin crown land, have a water frontage, contain a disused government road, or are there any crown licences associated with the land?

Is there any earth resource activity such as mining in the area?

You may wish to find out more about exploration, mining and quarrying activity on or near the property and consider the issue of petroleum, geothermal and greenhouse gas sequestration permits, leases and licences, extractive industry authorisations and mineral licences.

Soil and groundwater contamination

Has previous land use affected the soil or groundwater?

You should consider whether past activities, including the use of adjacent land, may have caused contamination at the site and whether this may prevent you from doing certain things to or on the land in the future.

(04/10/2016)

Land boundaries

Do you know the exact boundary of the property?

You should compare the measurements shown on the title document with actual fences and buildings on the property, to make sure the boundaries match. If you have concerns about this, you can speak to your lawyer or conveyancer, or commission a site survey to establish property boundaries.

Planning controls

Can you change how the property is used, or the buildings on it?

All land is subject to a planning scheme, run by the local council. How the property is zoned and any overlays that may apply, will determine how the land can be used. This may restrict such things as whether you can build on vacant land or how you can alter or develop the land and its buildings over time.

The local council can give you advice about the planning scheme, as well as details of any other restrictions that may apply, such as design guidelines or bushfire safety design. There may also be restrictions – known as encumbrances – on the property's title, which prevent you from developing the property. You can find out about encumbrances by looking at the section 32 statement.

Are there any proposed or granted planning permits?

The local council can advise you if there are any proposed or issued planning permits for any properties close by. Significant developments in your area may change the local 'character' (predominant style of the area) and may increase noise or traffic near the property.

Safety

Is the building safe to live in?

Building laws are in place to ensure building safety. Professional building inspections can help you assess the property for electrical safety, possible illegal building work, adequate pool or spa fencing and the presence of asbestos, termites, or other potential hazards.

Building permits

Have any buildings or retaining walls on the property been altered, or do you plan to alter them?

There are laws and regulations about how buildings and retaining walls are constructed, which you may wish to investigate to ensure any completed or proposed building work is approved. The local council may be able to give you information about any building permits issued for recent building works done to the property, and what you must do to plan new work. You can also commission a private building surveyor's assessment.

Are any recent building or renovation works covered by insurance?

Ask the vendor if there is any owner-builder insurance or builder's warranty to cover defects in the work done to the property.

Utilities and essential services

Does the property have working connections for water, sewerage, electricity, gas, telephone and internet?

Unconnected services may not be available, or may incur a fee to connect. You may also need to choose from a range of suppliers for these services. This may be particularly important in rural areas where some services are not available.

Buyers' rights

Do you know your rights when buying a property?

The contract of sale and section 32 statement contain important information about the property, so you should request to see these and read them thoroughly. Many people engage a lawyer or conveyancer to help them understand the contracts and ensure the sale goes through correctly. If you intend to hire a professional, you should consider speaking to them before you commit to the sale. There are also important rules about the way private sales and auctions are conducted. These may include a cooling-off period and specific rights associated with 'off the plan' sales. The important thing to remember is that, as the buyer, you have rights.